

DATE	
BY	
DESIGNED	
DRAWN	
CHECKED	
IN CHARGE	
PROJECT	
NO.	

DATE	
BY	
DESIGNED	
DRAWN	
CHECKED	
IN CHARGE	
PROJECT	
NO.	

MATCH LINE STA. 74+50
(SEE SHEET NO. 17)

MATCH LINE STA. 74+50
(SEE SHEET NO. 17)

MATCH LINE STA. 79+50
(SEE SHEET NO. 19)

MATCH LINE STA. 79+50
(SEE SHEET NO. 19)

PRATT BOULEVARD
MATCH LINE STA. 408+70
(SEE SHEET NO. 21)

PRATT BOULEVARD
MATCH LINE STA. 410+80
(SEE SHEET NO. 22)

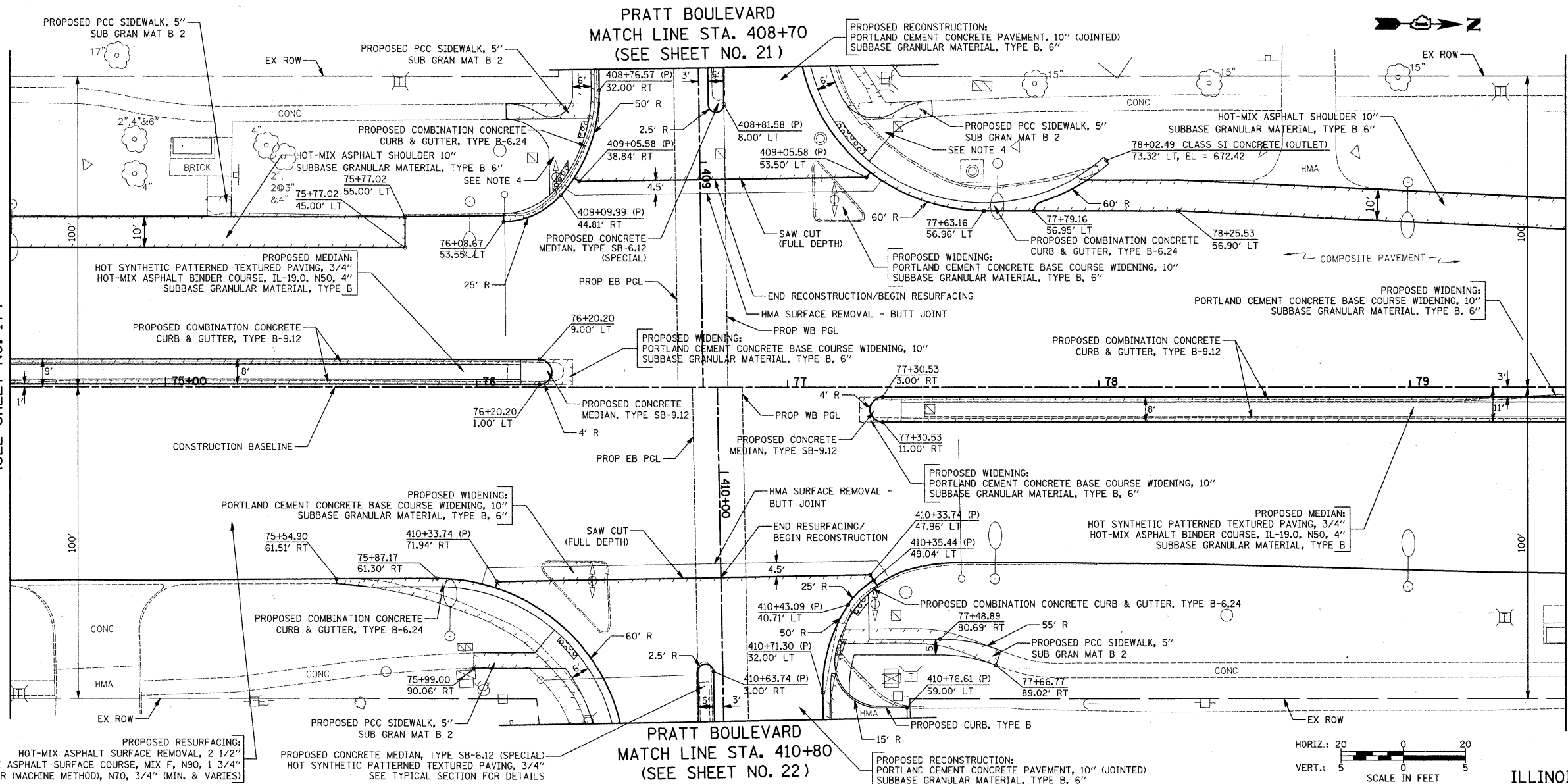

- NOTES:
- STATIONS NOTED WITH (P) REFERENCE THE PRATT BOULEVARD ALIGNMENT.
 - CONSTRUCT BASE COURSE MONOLITHICALLY WITH CURB & GUTTER OR CONCRETE MEDIAN WHEN WIDENING IS LESS THAN 2 FEET - SEE DETAIL.
 - ALL DRIVEWAYS SHALL BE REPLACED WITH PCC DRIVEWAY PAVEMENT, 8 INCH, SPECIAL.
 - SEE INTERSECTION GRADING PLAN FOR SIDEWALK LAYOUT DETAILS.

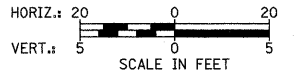

ILLINOIS ROUTE 83

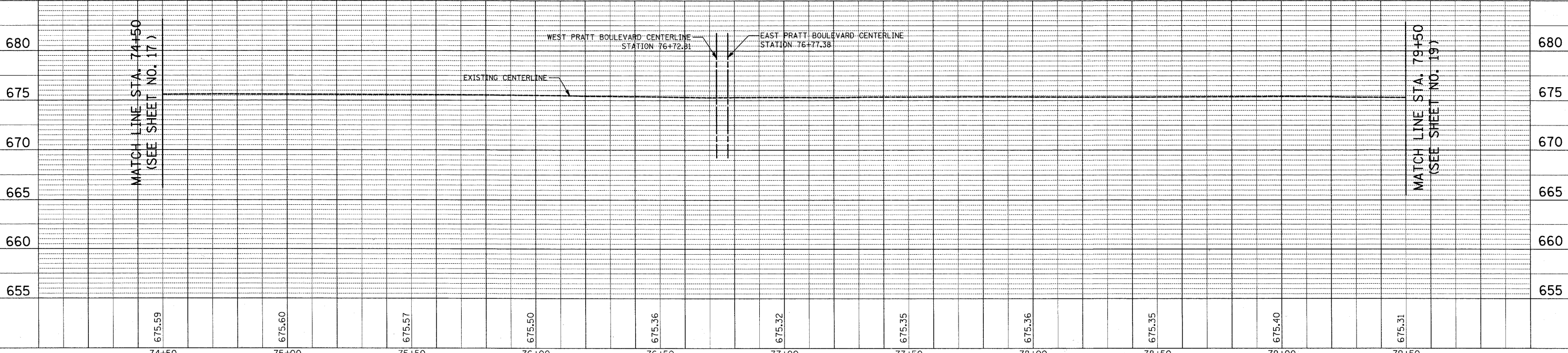

FILE NAME = ... \2363\oad\sheet\2363_PP_02.dgn

USER NAME = djk
PLOT SCALE = 20.0000' / IN.
PLOT DATE = 10/21/2010

DESIGNED - BLG
DRAWN - BLG
CHECKED - DJK
DATE - 10-22-10

REVISED -
REVISED -
REVISED -
REVISED -

STATE OF ILLINOIS
DEPARTMENT OF TRANSPORTATION

IL ROUTE 83 (BUSSE ROAD) AND PRATT BOULEVARD
PLAN AND PROFILE

SCALE: 1" = 20' SHEET NO. 2 OF 6 SHEETS STA. 74+50.00 TO STA. 79+50.00

F.A.P. RTE.	SECTION	COUNTY	TOTAL SHEETS	SHEET NO.
334	09-00057-00-CH	COOK	103	18
CONTRACT NO. 63523				
FED. ROAD DIST. NO. 1 ILLINOIS FED. AID PROJECT M-900316601				