

DATE	
BY	
REVISIONS	
PLAN	
NOTE BOOK	
NO.	
ALIGNED CHECKED	
PLANNED FILE NAME	

DATE	
BY	
REVISIONS	
PROFILE	
NOTE BOOK	
NO.	
GRADES CHECKED	
PLANNED FILE NAME	

MATCH LINE STA. 79+50
(SEE SHEET NO. 37)

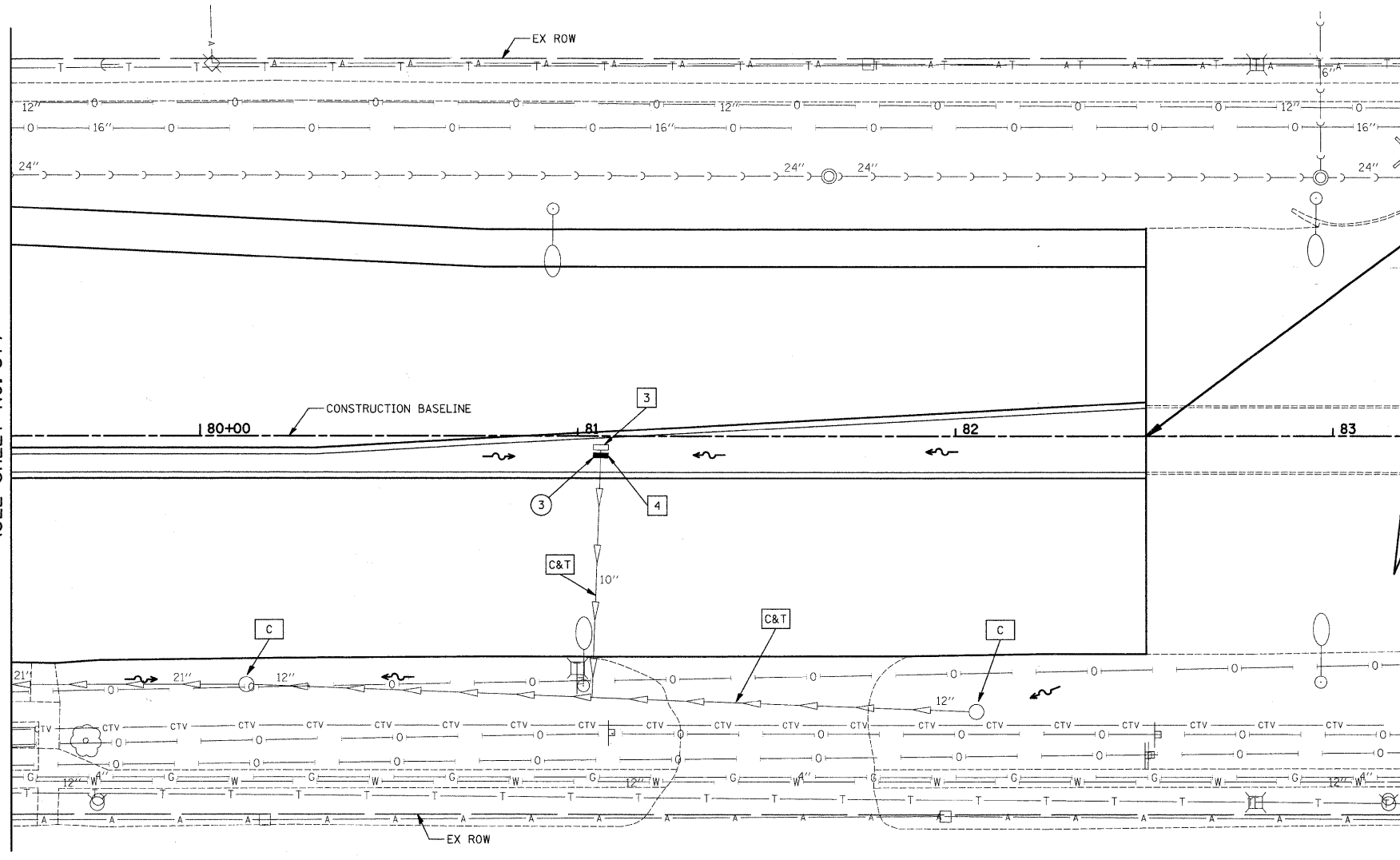

IMPROVEMENT ENDS
STA. 82+50.53

- 3 STA. 81+06, 2.9' RT
INLET TO BE REMOVED
- 4 STA. 81+06, 4.9' RT
INLET T-B
TYPE 1 FRAME, O.L.
RIM = 676.34
INV = 671.37 (EX 10" E)

3 3' - 10" S.S. REMOVAL
T.B.F. = 0.9 CU. YD.

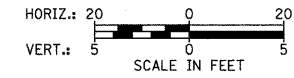

ILLINOIS ROUTE 83

IMPROVEMENT ENDS
STA. 82+50.53

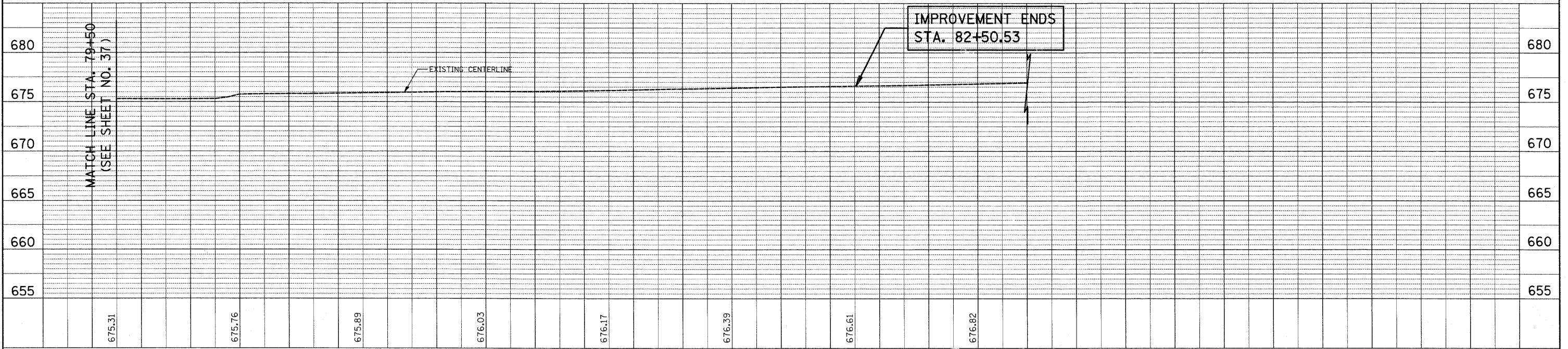

FILE NAME =	USER NAME = krk	DESIGNED - BLG	REVISED -	STATE OF ILLINOIS DEPARTMENT OF TRANSPORTATION	IL ROUTE 83 (BUSSE ROAD) AND PRATT BOULEVARD DRAINAGE AND UTILITIES	F.A.P. RTE.	SECTION	COUNTY	TOTAL SHEETS	SHEET NO.	
... \2363\cod\sheet\2363.DU.03.dgn	PLOT SCALE = 20,0000' / IN.	DRAWN - BLG	REVISED -			334	09-00057-00-CH	COOK	103	38	
	PLOT DATE = 11/2/2010	CHECKED - DJK	REVISED -			CONTRACT NO. 63523					
		DATE - 10-22-10	REVISED -			FED. ROAD DIST. NO. 1 ILLINOIS FED. AID PROJECT M-9003(660)					