

F.A.P. ROUTE	COUNTY SECTION	COUNTY	TOTAL SHEETS
99-00243-00-PV		KANE	268
336	CONTRACT NO.		133
	33782		
PROPOSED TRAFFIC SIGNAL PLAN			
F.H.W.A. REG.5 ILLINOIS PROJECT F--0356(008)			

CONSTRUCTION NOTES:

- ① REPLACE EXISTING CONTROLLER AND MALFUNCTION MANAGEMENT UNIT.
- ② ALL EXISTING CONFIRMATION BEACONS SHALL BE RETROFITTED WITH L.E.D. INDICATIONS. THIS WORK SHALL BE INCLUDED IN THE COST FOR THE PAY ITEM: UPGRADE EXISTING UNINTERRUPTIBLE POWER SUPPLY BATTERY BACK-UP SYSTEM.
- ③ REPLACE EXISTING FIBER OPTIC INTERCONNECT CENTER.
- ④ UPGRADE EXISTING UNINTERRUPTIBLE POWER SUPPLY TO ETHERNET AND REPLACE EXISTING UNINTERRUPTIBLE POWER SUPPLY CABINET ENCLOSURE.
- ⑤ UPGRADE EXISTING VIDEO DETECTION TO COMMUNICATE OVER ETHERNET.
- ⑥ INSTALL PTZ CAMERA ON THE COMBINATION MAST ARM AND POLE IN THE NORTHWEST CORNER.
- ⑦ INSTALL NEW 50"X67" PAD FOR UNINTERRUPTIBLE POWER SUPPLY.

THE FOLLOWING ITEMS SHALL BE REMOVED BY THE CONTRACTOR AND SHALL BE DISPOSED OF BY THEM OUTSIDE THE RIGHT-OF-WAY AT THEIR EXPENSE. THE SALVAGE VALUE OF THE REMOVED EQUIPMENT SHALL BE REFLECTED IN THE CONTRACT BID PRICE.

- 1 EACH CONTROLLER AND CONFLICT MONITOR

DATE	BY
DATE	BY
DATE	BY
DATE	BY

CHRISTOPHER B. BURKE ENGINEERING LTD.
9575 West Higgins Road, Suite 600
Rosemont, Illinois 60018
(847) 823-0500

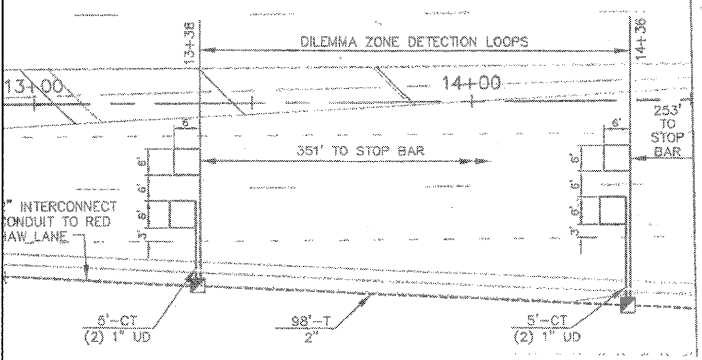
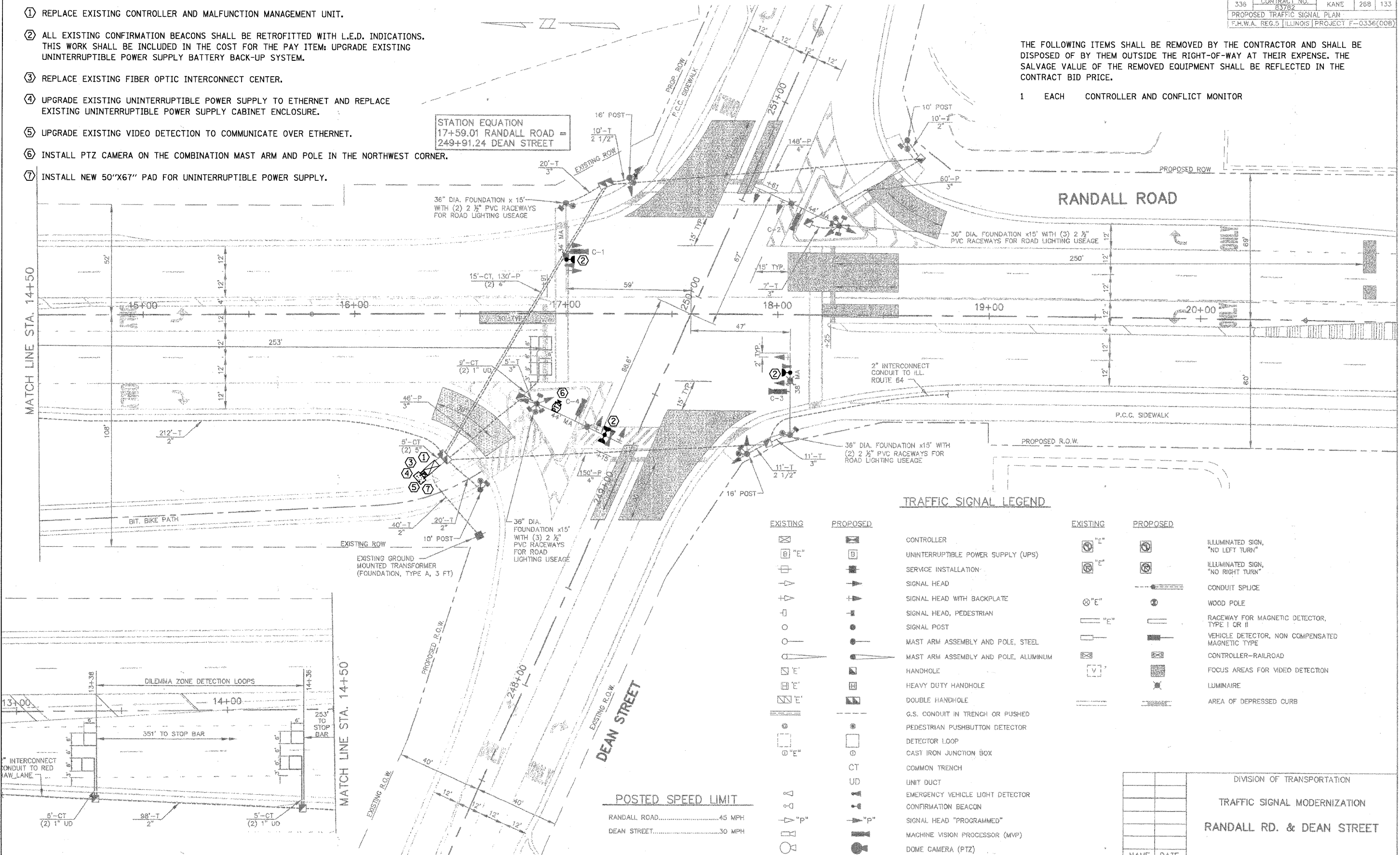

TRAFFIC SIGNAL LEGEND

EXISTING	PROPOSED	EXISTING	PROPOSED	DESCRIPTION
[Symbol]	[Symbol]	[Symbol]	[Symbol]	CONTROLLER
[Symbol]	[Symbol]	[Symbol]	[Symbol]	UNINTERRUPTIBLE POWER SUPPLY (UPS)
[Symbol]	[Symbol]	[Symbol]	[Symbol]	SERVICE INSTALLATION
[Symbol]	[Symbol]	[Symbol]	[Symbol]	SIGNAL HEAD
[Symbol]	[Symbol]	[Symbol]	[Symbol]	SIGNAL HEAD WITH BACKPLATE
[Symbol]	[Symbol]	[Symbol]	[Symbol]	SIGNAL HEAD, PEDESTRIAN
[Symbol]	[Symbol]	[Symbol]	[Symbol]	SIGNAL POST
[Symbol]	[Symbol]	[Symbol]	[Symbol]	MAST ARM ASSEMBLY AND POLE, STEEL
[Symbol]	[Symbol]	[Symbol]	[Symbol]	MAST ARM ASSEMBLY AND POLE, ALUMINUM
[Symbol]	[Symbol]	[Symbol]	[Symbol]	HANDHOLE
[Symbol]	[Symbol]	[Symbol]	[Symbol]	HEAVY DUTY HANDHOLE
[Symbol]	[Symbol]	[Symbol]	[Symbol]	DOUBLE HANDHOLE
[Symbol]	[Symbol]	[Symbol]	[Symbol]	G.S. CONDUIT IN TRENCH OR PUSHED
[Symbol]	[Symbol]	[Symbol]	[Symbol]	PEDESTRIAN PUSHBUTTON DETECTOR
[Symbol]	[Symbol]	[Symbol]	[Symbol]	DETECTOR LOOP
[Symbol]	[Symbol]	[Symbol]	[Symbol]	CAST IRON JUNCTION BOX
[Symbol]	[Symbol]	[Symbol]	[Symbol]	COMMON TRENCH
[Symbol]	[Symbol]	[Symbol]	[Symbol]	UNIT DUCT
[Symbol]	[Symbol]	[Symbol]	[Symbol]	EMERGENCY VEHICLE LIGHT DETECTOR
[Symbol]	[Symbol]	[Symbol]	[Symbol]	CONFIRMATION BEACON
[Symbol]	[Symbol]	[Symbol]	[Symbol]	SIGNAL HEAD "PROGRAMMED"
[Symbol]	[Symbol]	[Symbol]	[Symbol]	MACHINE VISION PROCESSOR (MVP)
[Symbol]	[Symbol]	[Symbol]	[Symbol]	DOMED CAMERA (PTZ)
[Symbol]	[Symbol]	[Symbol]	[Symbol]	ILLUMINATED SIGN, "NO LEFT TURN"
[Symbol]	[Symbol]	[Symbol]	[Symbol]	ILLUMINATED SIGN, "NO RIGHT TURN"
[Symbol]	[Symbol]	[Symbol]	[Symbol]	CONDUIT SPLICE
[Symbol]	[Symbol]	[Symbol]	[Symbol]	WOOD POLE
[Symbol]	[Symbol]	[Symbol]	[Symbol]	RACEWAY FOR MAGNETIC DETECTOR, TYPE I OR II
[Symbol]	[Symbol]	[Symbol]	[Symbol]	VEHICLE DETECTOR, NON COMPENSATED MAGNETIC TYPE
[Symbol]	[Symbol]	[Symbol]	[Symbol]	CONTROLLER-RAILROAD
[Symbol]	[Symbol]	[Symbol]	[Symbol]	FOCUS AREAS FOR VIDEO DETECTION
[Symbol]	[Symbol]	[Symbol]	[Symbol]	LUMINAIRE
[Symbol]	[Symbol]	[Symbol]	[Symbol]	AREA OF DEPRESSED CURB

POSTED SPEED LIMIT
RANDALL ROAD.....45 MPH
DEAN STREET.....30 MPH

DIVISION OF TRANSPORTATION	
TRAFFIC SIGNAL MODERNIZATION	
RANDALL RD. & DEAN STREET	
NAME	DATE