

TRAFFIC SIGNAL LEGEND

CONTROLLE:
 SERVICE DISMOUNT
 SIGNAL HEAD
 SIGNAL HEAD WITH BACKPLATE
 SIGNAL HEAD PEDESTRIAN
 SIGNAL POST
 MAST ARM ASSEMBLY AND POLE, STEEL
 HANDHOLE
 HEAVY DUT HANDHOLE
 DOUBLE HANDHOLE
 G.S. CONDUIT IN TRENCH OR PUSHED
 PEDESTRIAN PUSHBUTTON DETECTOR
 DETECTOR LOOP
 CONCRETE LOCATION BOX
 CAST IRON LOCATION BOX
 COMMON TRAFFIC
 MAST ARM ASSEMBLY AND POLE, ALUMINUM
 EMERGENCY VEHICLE SYSTEM DETECTOR
 SIGNAL HEAD OPTICALLY PROGRAMMED
 CONDUIT SERVICE
 WOOD POLE
 RACEWAY WITH MAGNETIC DETECTOR, TYPE I OR TYPE II
 VEHICLE DETECTOR, NON COMPENSATED MAGNETIC TYPE
 RAILROAD SIGNAL CABINET

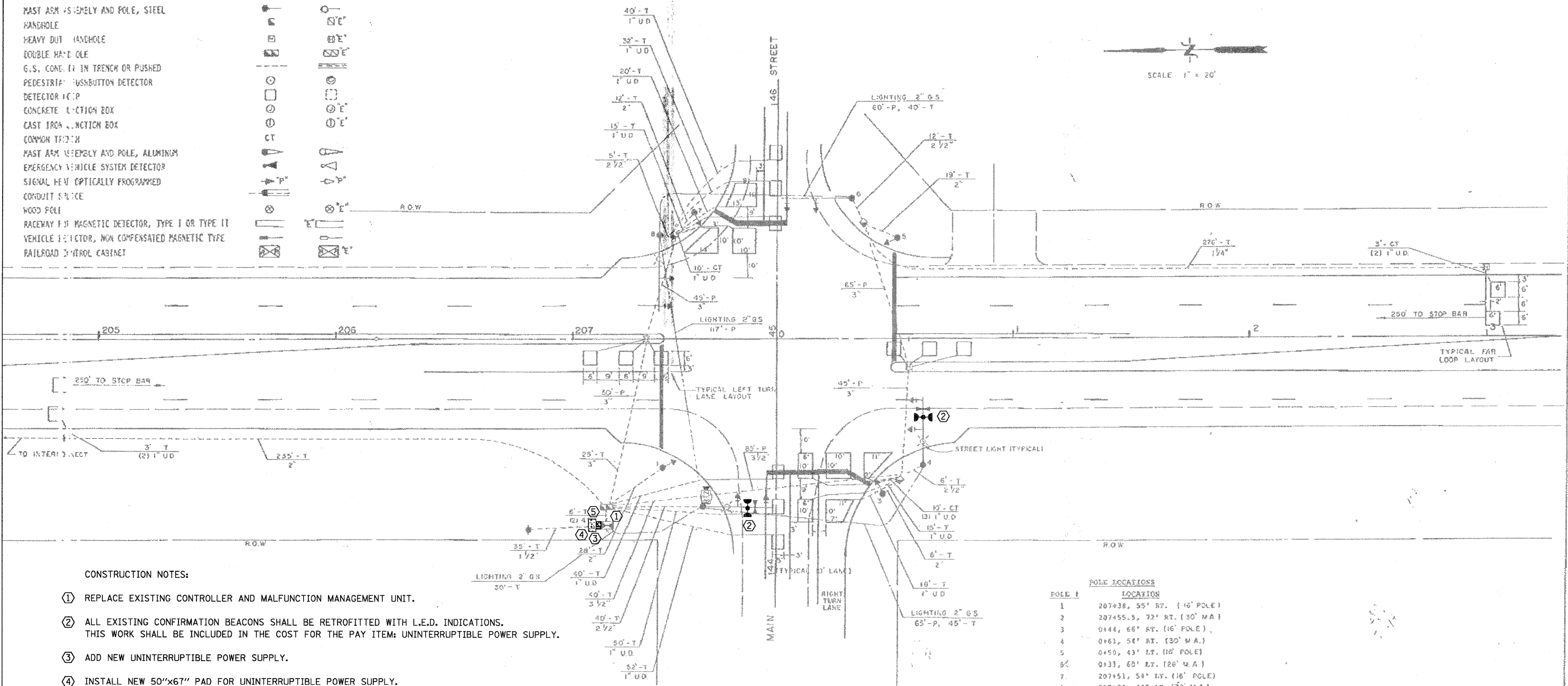
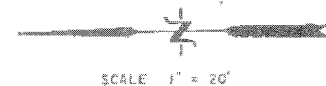
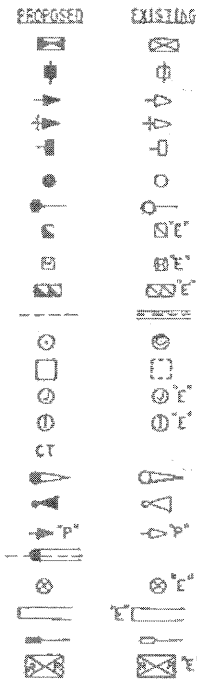

CONSTRUCTION NOTES:

- ① REPLACE EXISTING CONTROLLER AND MALFUNCTION MANAGEMENT UNIT.
- ② ALL EXISTING CONFIRMATION BEACONS SHALL BE RETROFITTED WITH L.E.D. INDICATIONS. THIS WORK SHALL BE INCLUDED IN THE COST FOR THE PAY ITEM: UNINTERRUPTIBLE POWER SUPPLY.
- ③ ADD NEW UNINTERRUPTIBLE POWER SUPPLY.
- ④ INSTALL NEW 50"x67" PAD FOR UNINTERRUPTIBLE POWER SUPPLY.
- ⑤ ADD NEW GROUNDING.

POLE LOCATIONS

POLE #	LOCATION
1	207+38, 55' RT. (16' POLE)
2	207+55.5, 72' RT. (30' M.A.)
3	0+44, 66' RT. (16' POLE)
4	0+63, 58' RT. (30' M.A.)
5	0+50, 43' LT. (16' POLE)
6	0+33, 60' LT. (26' M.A.)
7	207+51, 54' LT. (16' POLE)
8	207+36, 44' LT. (32' M.A.)

THE FOLLOWING ITEMS SHALL BE REMOVED BY THE CONTRACTOR AND SHALL BE DISPOSED OF BY THEM OUTSIDE THE RIGHT-OF-WAY AT THEIR EXPENSE. THE SALVAGE VALUE OF THE REMOVED EQUIPMENT SHALL BE REFLECTED IN THE CONTRACT BID PRICE.

- 1 EACH CONTROLLER AND CONFLICT MONITOR

REVISIONS		TRAFFIC SIGNAL PLAN	
NAME	DATE		
HDN	12-8-09	RANDALL ROAD AT MAIN STREET	
		SCALE: 1" = 20'	
		DATE: 9-15-09	
		DRAWN BY: KAG	
		CHECKED BY: HDN	

SURVIVED PLOTTED ALIGNED CHECKED
 PLAN NOTE BOOK NO. 1000
 DATE BY
 CHRISTOPHER B. BURKE ENGINEERING LTD.
 9575 West Higgins Road, Suite 600
 Rosemont, Illinois 60018
 (847) 823-0500
 PROFILE SURVIVED PLOTTED CHECKED
 NOTE BOOK NO. 1000
 DATE BY
 STRUCTURE NOTATIONS OK'D