

REVIEWED _____
 PLOTTED _____
 ALIGNMENT CHECKED _____
 NOTE BOOK NO. _____
 EXIST FILE NAME _____

PROFILE _____
 GRADES CHECKED _____
 B.M. NOTED _____
 STRUCTURE NOTATIONS CRYED _____
 NOTE BOOK NO. _____

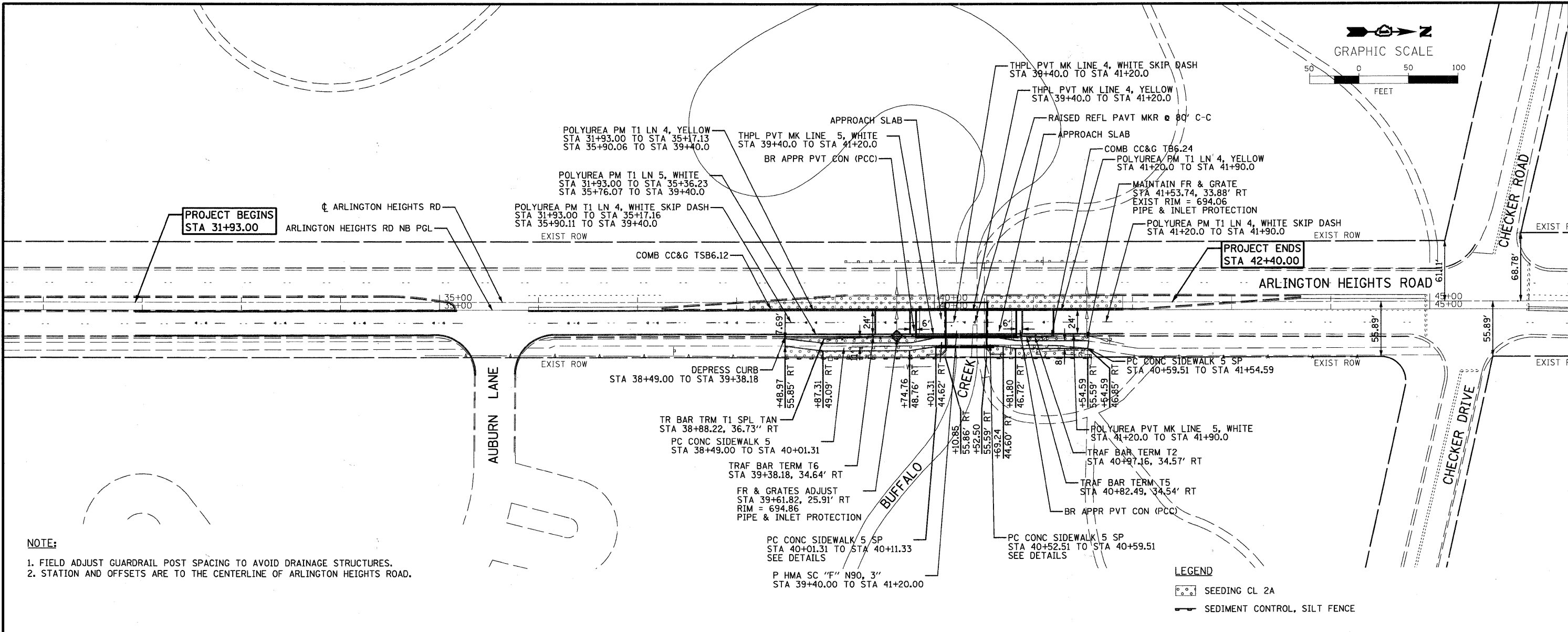

NOTE:
 1. FIELD ADJUST GUARDRAIL POST SPACING TO AVOID DRAINAGE STRUCTURES.
 2. STATION AND OFFSETS ARE TO THE CENTERLINE OF ARLINGTON HEIGHTS ROAD.

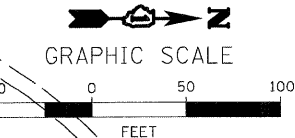
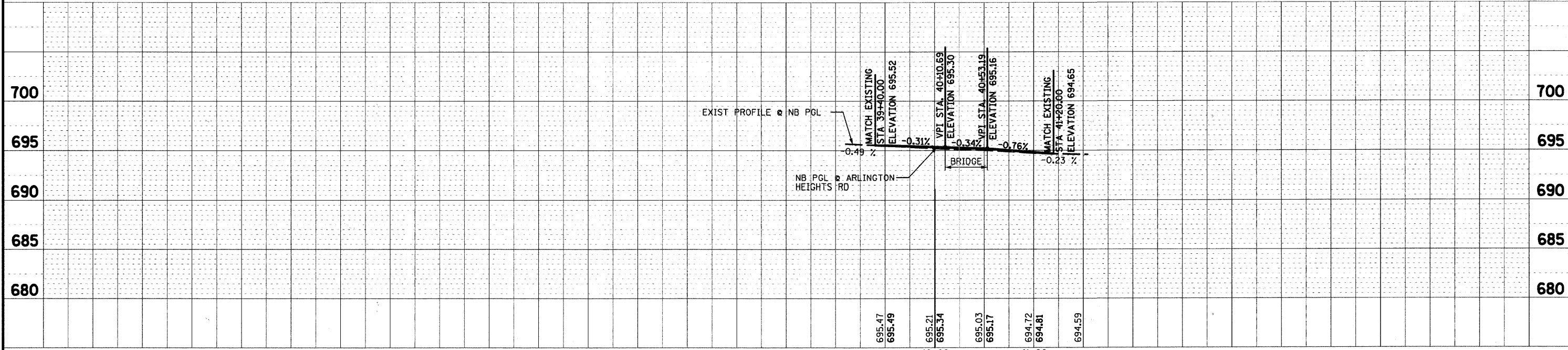

FILE NAME = LC0907-shr-plnprf.dgn	USER NAME = 3202000907	DESIGNED - TC	REVISED -	STATE OF ILLINOIS DEPARTMENT OF TRANSPORTATION	PLAN AND PROFILE STA. 31 + 93.00 TO STA 42 + 40.00		F.A.U. RTE. 2626	SECTION 05-00193-04-BR	COUNTY LAKE	TOTAL SHEETS 36	SHEET NO. 8
PLOT SCALE = 100.0000' / IN.	PLOT DATE = 10/25/2010	DRAWN - PWL	REVISED -		SCALE: 1" = 50'	SHEET NO. 1 OF 1 SHEETS	STA. 31+93.00 TO STA. 42+40.00	FED. ROAD DIST. NO. 1 ILLINOIS FED. AID PROJECT		CONTRACT NO. 63531	