

THRU LANE TO
TURN LANE CONVERSION

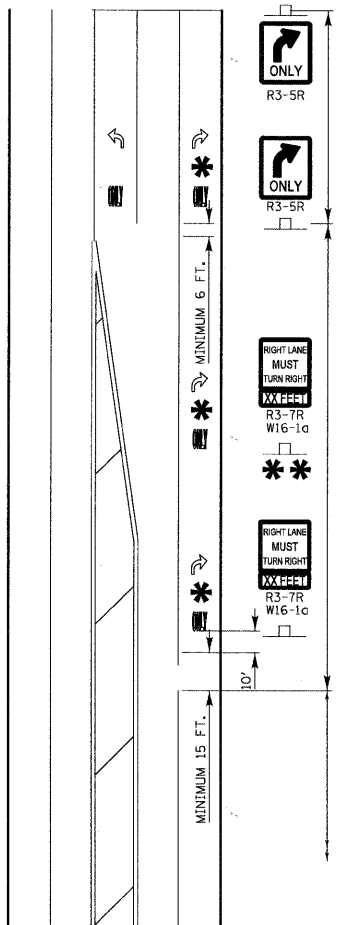

TYPICAL PAVEMENT MARKINGS AND RAISED PAVEMENT MARKERS

TURN BAY
6" WHITE LINE
(ADDITIONAL PAV'T MARKINGS AS SHOWN
ON SHEET ONE OF THE L.C.D.O.T. PAV'T
MARKINGS DETAIL SHEETS)

MINIMUM TRANSITION ZONE LENGTH

TRANSITION ZONE
6" WHITE 3/12" SKIP DASH
LANE LINE

POSTED SPEED	LENGTH
25 M.P.H.	255 FT.
30 M.P.H.	330 FT.
35 M.P.H.	405 FT.
40 M.P.H.	480 FT.
45 M.P.H.	555 FT.
50 M.P.H.	630 FT.
55 M.P.H.	705 FT.

* LOCATION OF PAV'T MARKINGS

(MEASURED FROM BEGINNING OF TRANSITION ZONE)

POSTED SPEED	LOCATION OF PAV'T MARKINGS
25 M.P.H.	10 FT., 260 FT.
30 M.P.H.	10 FT., 170 FT., 340 FT.
35 M.P.H.	10 FT., 210 FT., 410 FT.
40 M.P.H.	10 FT., 170 FT., 330 FT., 490 FT.
45 M.P.H.	10 FT., 190 FT., 370 FT., 560 FT.
50 M.P.H.	10 FT., 170 FT., 330 FT., 490 FT., 640 FT.
55 M.P.H.	10 FT., 180 FT., 350 FT., 520 FT., 710 FT.

THRU LANE
4" WHITE 10/30" SKIP DASH
LANE LINE

FOR POSTED SPEEDS 40 M.P.H. OR GREATER
A SECOND R3-7/W16-1c SIGN INSTALLATION
SHALL BE LOCATED HALFWAY BETWEEN THE
BEGINNING OF THE TRANSITION ZONE AND THE
BEGINNING OF THE TURN LANE

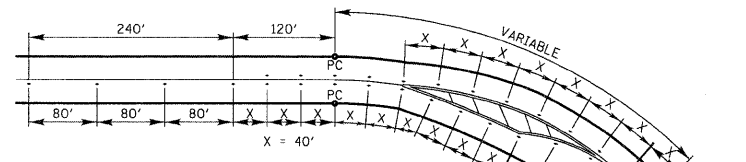

TYPICAL RAISED PAVEMENT MARKER INSTALLATION

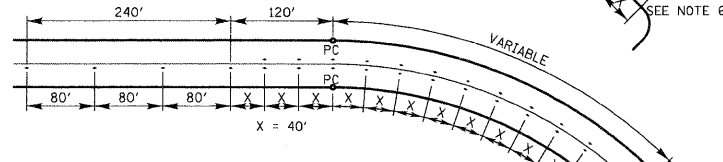

PAVEMENT MARKER LEGEND

 RAISED PAVEMENT MARKER, DOUBLE YELLOW
 RAISED PAVEMENT MARKER, WHITE AND RED

NOTES:

- CENTERLINE RAISED PAVEMENT MARKERS (RPM's) SHALL BE PLACED ON ALL CURVES OVER 3 1/2 DEGREES ON ALL TWO AND THREE LANE HIGHWAYS, UNLESS DIRECTED OTHERWISE BY THE ENGINEER..
- SPACING = 40' FOR CENTERLINE MARKERS.
- ALL RPM'S ON CENTERLINE ARE 2-WAY YELLOW. LANE LINE MARKERS ARE WHITE/RED.
- MARKERS SHALL BE INSTALLED IN ACCORDANCE WITH F.H.W.A. MEMORANDUM H10-21.
- MARKERS SHALL BE FIELD ADJUSTED TO BE LOCATED IN CENTER OF THE 30' GAP OF A 30'/10' SKIP-DASH CENTERLINE.
- RPM's WHICH ARE TO BE LOCATED WITHIN THE INTERSECTION OF A CROSS STREET, SHALL NOT BE INSTALLED.
- A MINIMUM OF 4 WHITE/RED MARKERS SHALL BE INSTALLED ALONG THE TURN LANE LINE.
- RPM'S INSTALLED ON MULTI-LANE ROAD SECTIONS SHALL BE INSTALLED ON THE WHITE SKIP-DASH LANE LINE ONLY. THESE RPM'S SHALL BE INSTALLED IN PAIRS AND SHALL BE 80' CENTER TO CENTER. SPACING WITHIN EACH PAIR SHALL BE 10', CENTERED WITHIN THE 30' SKIP.

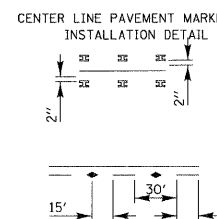
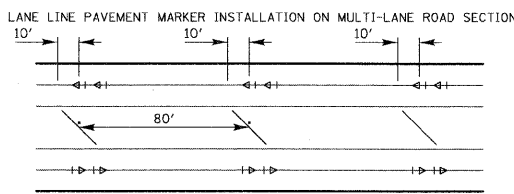

PAVEMENT CROSS SECTION SHOWING TYPICAL PAVEMENT MARKINGS (2-LANE ROADWAY)

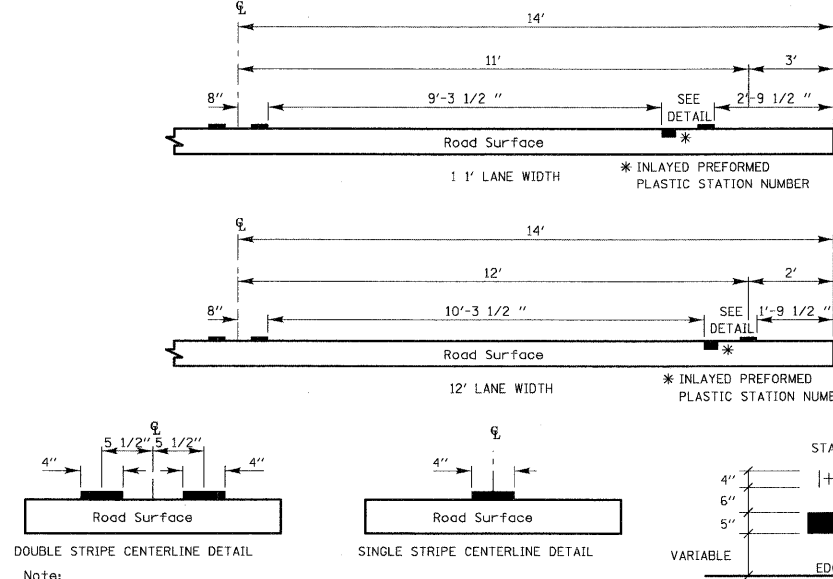

Note:
Centerline markings are 4" lines at 11" centers.

CROSSWALKS

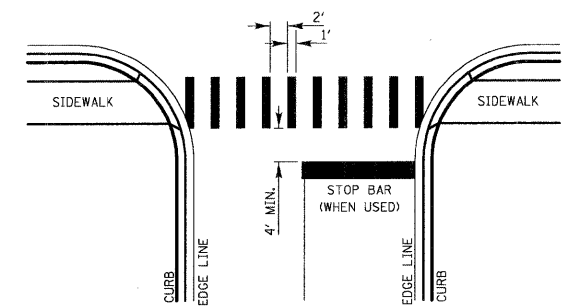

- WIDTH OF THE CROSSWALK IS GENERALLY 6' EXCEPT AT SCHOOL CROSSINGS AND BICYCLE CROSSINGS, WHICH CAN BE 8'.
- THE STOP BAR SHOULD BE INSTALLED A MINIMUM OF 4' IN ADVANCE OF THE CROSSWALK.

CURB MARKING

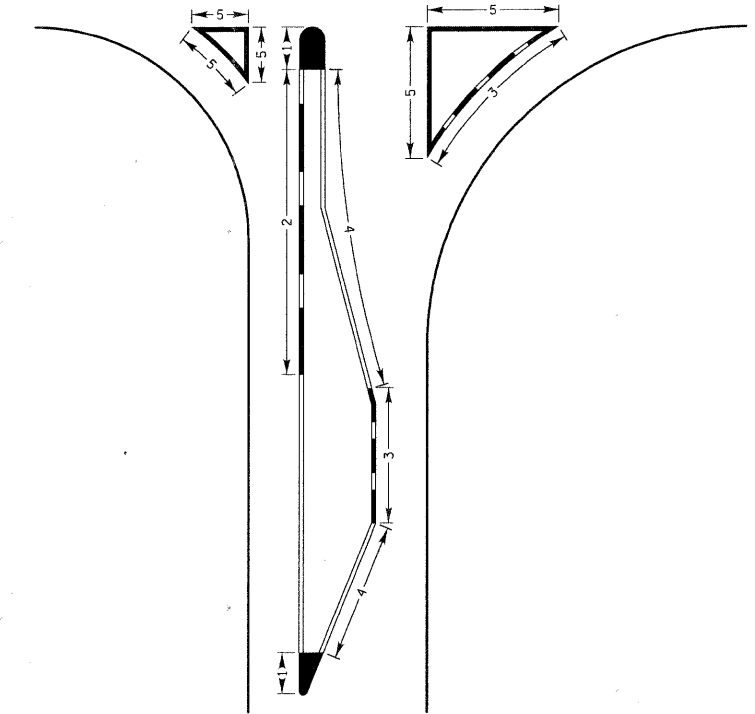

NOTES:

- PAINT CURB AND NOSE SOLID FOR 10' OR RADIUS OF NOSE, WHICHEVER IS GREATER.
- PAINT MINIMUM OF 3 STRIPES IN DIRECTION OF TRAFFIC.
- REDUCED SPACING USED TO OBTAIN 3 STRIPE MINIMUM.
- STRIPING RECOMMENDED ONLY WHERE OPERATIONAL PROBLEMS DICTATE.
- PAINT SOLID WHERE A MINIMUM OF 3 STRIPES CANNOT BE PLACED.

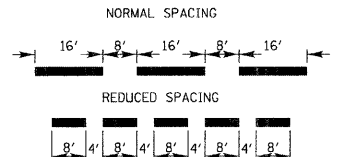

PAVEMENT MARKING GUIDELINES				
TYPE OF MARKING	WIDTH OF LINE	PATTERN	COLOR	SPACING / REMARKS
CENTERLINE OF 2 LANE PAVEMENT	4 IN.	SKIP-DASH	YELLOW	10 FT. LINE WITH 30 FT. SPACE
NO PASSING ZONE LINES FOR ONE DIRECTION FOR BOTH DIRECTIONS	4 IN.	SOLID	YELLOW	5 1/2 IN. C.C. FROM SKIP-DASH CENTERLINE
CENTERLINE ON MULTI-LANE UNDIVIDED LANE LINES	2 @ 4 IN.	SOLID	YELLOW	11 IN. C.C. BETWEEN
DOTTED LINES (EXTENSIONS OF CENTER, LANE OR TURN LANE MARKINGS)	4 IN.	SKIP-DASH	WHITE	10 FT. LINE WITH 30 FT. SPACE
EDGE LINES	4 IN.	SOLID	WHITE	2 FT. LINE WITH 6 FT. SPACE
TURN LANE MARKINGS	6 IN. LINE FULL SIZE LETTERS AND SYMBOLS (8 FT.)	SOLID	WHITE	TURN ARROW 156 SQ. FT. STRAIGHT ARROW 115 SQ. FT. COMB. ARROW 260 SQ. FT.
TWO WAY LEFT TURN MARKING	2 @ 4 IN. EACH DIRECTION	SKIP-DASH AND SOLID	YELLOW	10 FT. LINE WITH 30 FT. SPACE FOR SKIP-DASH 5 1/2 IN. C.C. BETWEEN SKIP-DASH LINE AND SOLID LINE.
CROSSWALK	8 FT. LEFT ARROW	IN PAIRS	WHITE	SEE TYPICAL TWO-WAY LEFT TURN MARKING DETAIL
STOP BARS	24 IN.	SOLID	WHITE	12 IN. LONGITUDINAL BAR WITH 24 IN. SPACE 6 FT. TO 12 FT. WIDE SEE TYPICAL CROSSWALK MARKING DETAIL
PAINTED MEDIANS	2 @ 4 IN. WITH 11 IN. DIAGONALS @ 45° NO DIAGONALS USED FOR 4 FT. WIDE MEDIAN	SOLID	YELLOW - 2-WAY TRAFFIC WHITE - 1-WAY TRAFFIC	11 IN. C.C. FOR THE DOUBLE LINE SEE TYPICAL PAINTED MEDIAN MARKING DETAIL MINIMUM OF 5 DIAGONALS
GORE MARKING AND CHANNELIZING LINES	8 IN. WITH 12 IN. DIAGONALS @ 45°	SOLID	WHITE	DIAGONALS 15 FT. C.C. (LESS THAN 30 M.P.H.) 20 FT. C.C. (30 TO 45 M.P.H.) 30 FT. C.C. (OVER 45 M.P.H.) MINIMUM OF 5 DIAGONALS
R.R. CROSSING	24 IN. TRANSVERSE LINES RR IS 6 FT. LETTER 16 IN. LINE FOR "X"	SOLID	WHITE	SEE I.D.O.T. STD. 780001 50 FT. AREA OF "X" 36 SQ. FT. "X" 540 SQ. FT.
SHOULDER DIAGONALS	12 IN. @ 45°	SOLID	WHITE - RIGHT YELLOW - LEFT	50 FT. C.C. (LESS THAN 30 M.P.H.) 75 FT. C.C. (30 TO 45 M.P.H.) 150 FT. C.C. (OVER 45 M.P.H.) MINIMUM OF 5 DIAGONALS

FOR FURTHER DETAILS ON PAVEMENT MARKING REFER TO PART III "MARKINGS" IN THE "ILLINOIS MANUAL ON UNIFORM TRAFFIC CONTROL DEVICES". THE "STANDARD SPECIFICATIONS FOR ROAD AND BRIDGE CONSTRUCTION AND I.D.O.T. HIGHWAY STANDARD 780001 EFFECTIVE JAN. 3, 1998.

NO.	DESCRIPTION	DATE	BY	SURVEYOR

FILE NAME: c:\pwworking\mactec01\pwl\lms00994\LC0907-sh1-deta1s6.dgn

REVISIONS	DATE	APPROVED BY
Superseded Railroad Sheet	6/2/2008	A. KHAWAJA

ROUTE	SECTION	SECTION NUMBER	SHEET	SHEETS
CHXX	XXX	XX-XXXXX-XX-XX	XXX	XXX

TYPICAL PAVEMENT MARKINGS FOR COUNTY HIGHWAYS SHEET 2 OF 2				
--	--	--	--	--



LAKE COUNTY STANDARDS & DETAILS

FILE NAME = LC0907-sh1-deta1s6.dgn

USER NAME	DESIGNED	REVISIONS
3202008907	TC	-
	PWL	-
	MRH	-
	10/25/2010	-

STATE OF ILLINOIS
DEPARTMENT OF TRANSPORTATION

DETAILS

SCALE: N/A SHEET NO. 1 OF 1 SHEETS STA. N/A TO STA. N/A

F.A.U. RTE.	SECTION	COUNTY	TOTAL SHEETS	SHEET NO.
2626	05-00193-04-BR	LAKE	36	32

CONTRACT NO. 63531