









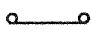

LEGEND

-  WORK AREA
-  IMPACT ATTENUATORS, TEMPORARY (NON-REDIRECTIVE, NARROW)
-  TYPE III BARRICADE
-  TEMPORARY CONCRETE BARRIER
-  DRUM WITH STEADY BURN MONODIRECTIONAL LIGHT (PER HWY. STD. 701321-10)
-  SIGN
-  DETECTOR LOOPS
-  TRAFFIC SIGNAL
-  TEMPORARY RUMBLE STRIPS
-  DOUBLE VERTICAL PANELS

STAGE II CONSTRUCTION

1. CLOSE EAST HALF OF IL-84 IN ACCORDANCE WITH HIGHWAY STANDARD 701321 AND AS SHOWN IN THE PLANS.
2. PERFORM EAST HALF STRUCTURAL AND APPROACH ROADWAY RECONSTRUCTION AS SHOWN IN THE PLANS.
3. APPLY PERMANENT PAVEMENT MARKINGS AND RAISED REFLECTIVE PAVEMENT MARKERS UNDER HIGHWAY STANDARD 701311.

NOTES:

1. SEE HIGHWAY STANDARD 701321 FOR PLACEMENT OF DEVICES, INFORMATION, ETC.
2. ACCESS TO BE MAINTAINED TO DRIVEWAYS AT ALL TIMES DURING CONSTRUCTION.

SEQUENCE OF OPERATIONS					
PHASE	A	B	C	D	E
INTERVAL	1	2	3	4	5
NORTHBOUND	G	Y	R	R	R
SOUTHBOUND	R	R	R	G	Y

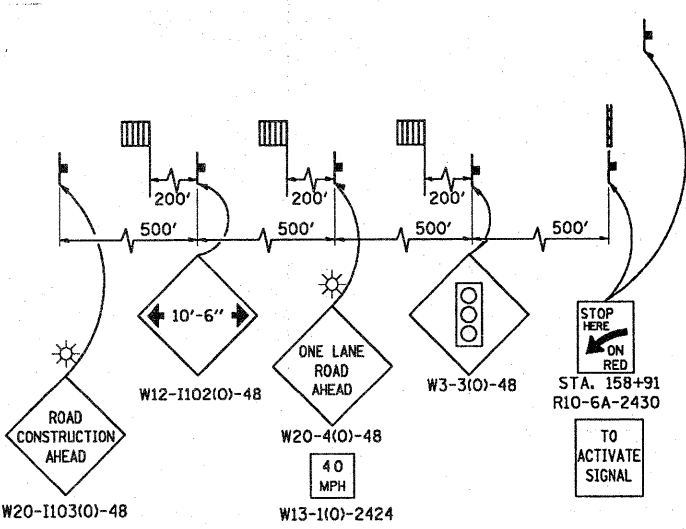
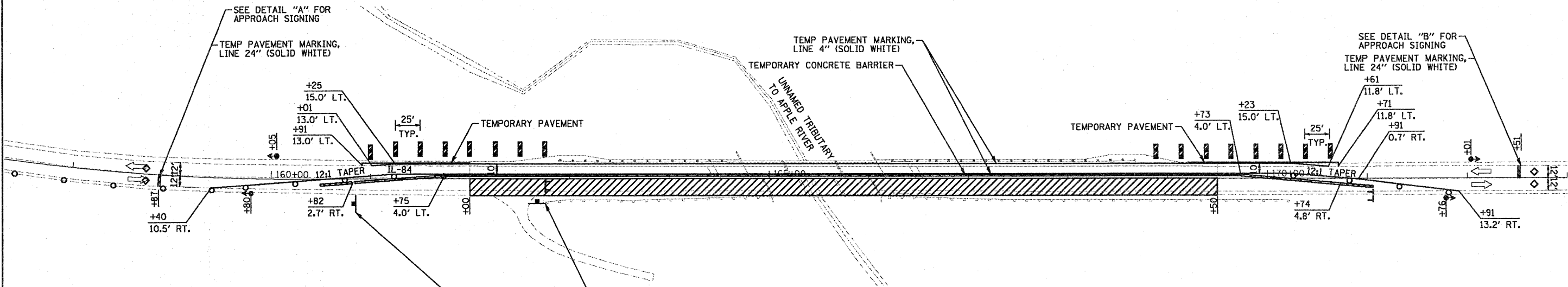
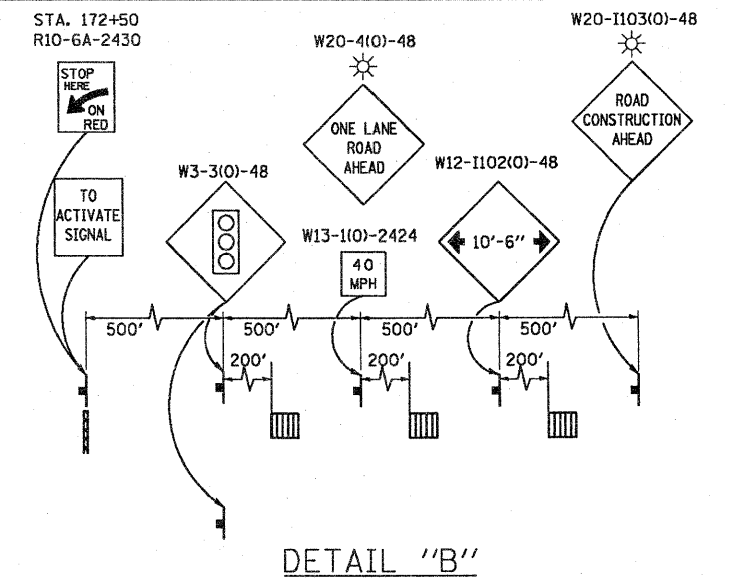

CAUTION
ONE LANE ROAD
FOLLOW TRAFFIC
FLOW
PER DIST. STD. 75.2

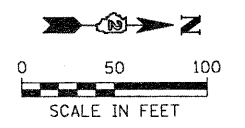
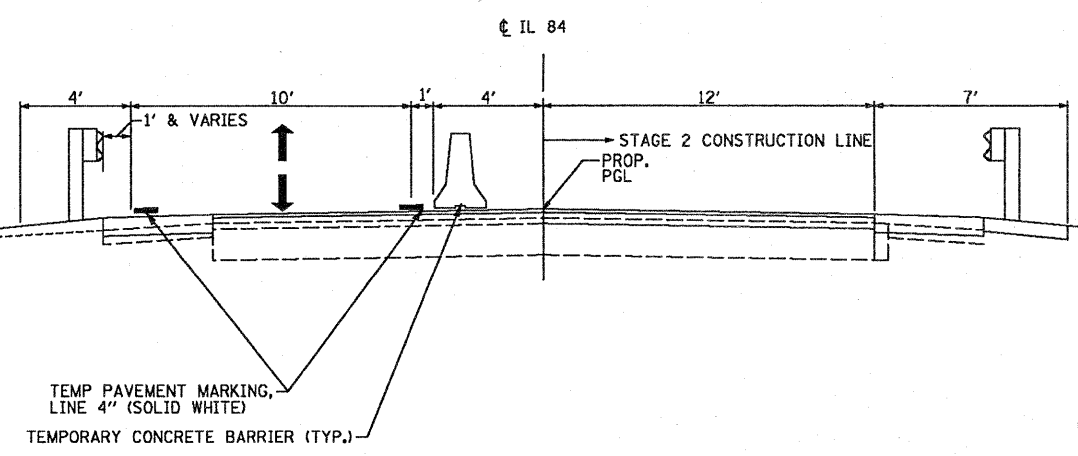

FILE NAME = ...N0464b26-sht-staging2.dgn	USER NAME = Plotted by Scott Wilkinson	DESIGNED - SEW	REVISED -	STATE OF ILLINOIS DEPARTMENT OF TRANSPORTATION	MAINTENANCE OF TRAFFIC PLAN - STAGE 2 IL-84 OVER TRIBUTARY TO APPLE RIVER			F.A.P. RTE. 308	SECTION 103BR-3 & 104BR-1	COUNTY JO DAVIESS	TOTAL SHEETS 126	SHEET NO. 25
	PLOT SCALE = 1/8" = 10' IN.	DRAWN - SEW	REVISED -		SCALE: 1" = 50'	SHEET NO. 1 OF 1 SHEETS	STA. 159+00 TO STA. 173+00	CONTRACT NO. 64B26				
	PLOT DATE = 12/1/2010	CHECKED - FML	REVISED -		ILLINOIS FED. AID PROJECT							
		DATE - 10-15-2010	REVISED -									