

STATE OF ILLINOIS
DEPARTMENT OF TRANSPORTATION

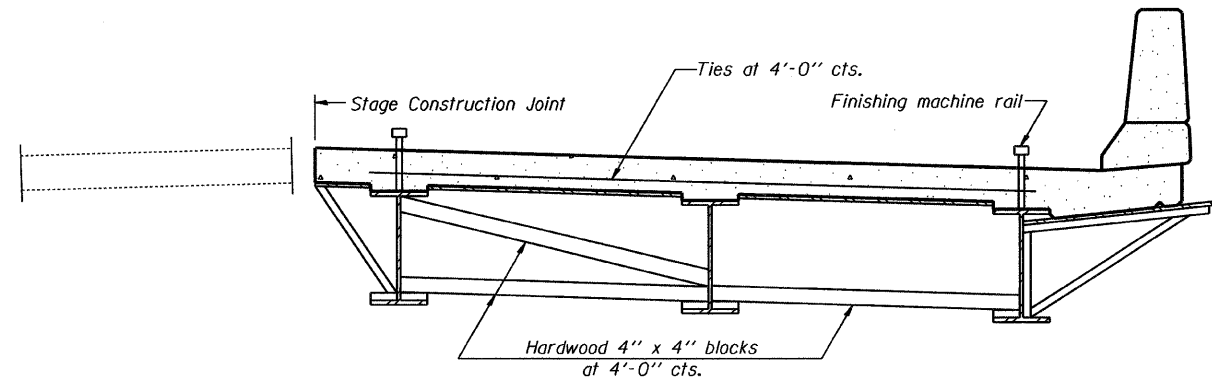

**FORM BRACES FOR
STAGE CONSTRUCTION**

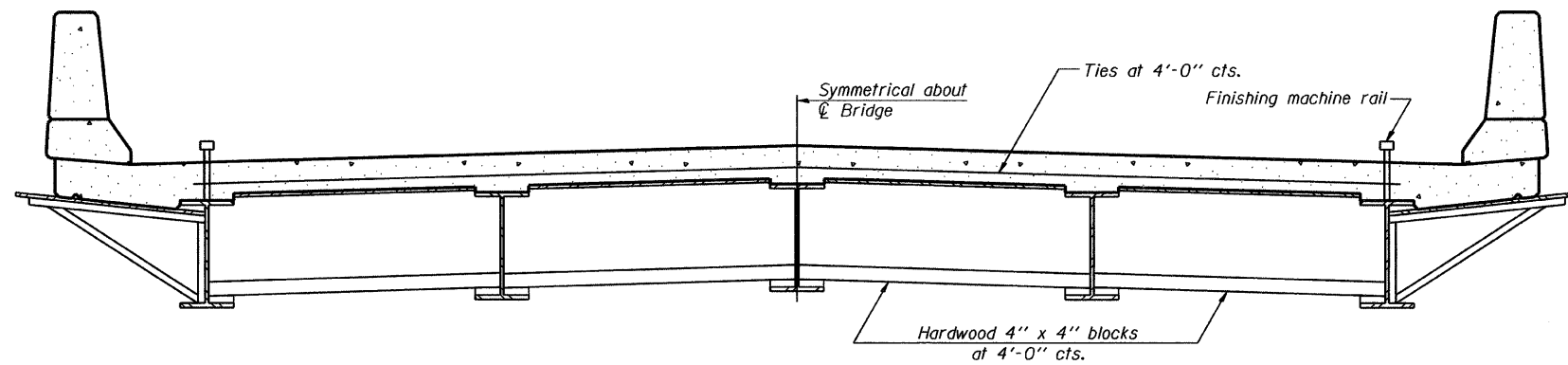

**FORM BRACES FOR
STANDARD CONSTRUCTION**

When cantilever forming brackets are used, the work shall be done according to Article 503.06(b) of the Standard Specifications, except as modified below and in the details shown on this sheet.

The finishing machine rails shall be placed on the top flange of the exterior beams.

The beams or girders, supporting cantilever forming brackets, shall be tied together at 4 foot intervals.

For Standard construction, or Stage Construction the Hardwood bracing materials shall be placed as shown between webs of beams in each bay.

I:\Jobs\2010\102010\20103021\Need\Structural\Drawn\SA21_SUPER_BRACKETS.dgn
 10/13/2010

DESIGNED	J.Z.
CHECKED	J.A.Z.
DRAWN	R.B.H.
CHECKED	J.A.Z.

SB-1

11-1-09

GRÄEF 8501 W. Higgins Road, Suite 280
Chicago, Illinois 60631
(773) 399-0112

CANTILEVER FORMING BRACKETS FOR SUPERSTRUCTURE					
<i>Illinois Rte. 84 Over Apple River Tributary</i>					
STATION 165+50.00			STRUCTURE NO. 043-0078		
SHEET NO. SA21 OF 25 SHEETS	F.A.P. RTE.	SECTION	COUNTY	TOTAL SHEETS	SHEET NO.
	308	104BR-1	JO DAVIESS	126	57
			CONTRACT NO. 64B26		
10-15-2010			ILLINOIS FED. AID PROJECT		