

DETOUR MAP

*TO BE PLACED WITH INTERSTATE IDENTIFICATION SIGNS, EXIT SIGNS AND US & ILLINOIS STATE ROUTE MARKERS.

NOTES:

- 1.) ALL TRAFFIC CONTROL DEVICES SHALL BE FURNISHED, ERECTED AND MAINTAINED BY THE CONTRACTOR.
- 2.) ALL SIGNS NOT ATTACHED TO BARRICADES SHALL BE POST MOUNTED, UNLESS OTHERWISE NOTED.
- 3.) LOCATIONS OF TRAFFIC CONTROL DEVICES MAY BE ADJUSTED BY THE ENGINEER.
- 4.) WORK SHALL BE DONE IN ACCORDANCE WITH BLR 21, EXCEPT THAT ALL WARNING SIGNS SHALL BE 48"x48"
- 5.) TRAFFIC CONTROL SHALL BE IN ACCORDANCE WITH THE STANDARD SPECIFICATIONS FOR ROAD AND BRIDGE CONSTRUCTION, THE MANUAL FOR UNIFORM TRAFFIC CONTROL DEVICES, THE HIGHWAY STANDARDS AND SPECIAL PROVISIONS.
- 6.) COVER ANY SIGNS DENOTING NORTH US ROUTE 34 WITHIN A MILE RADIUS OF THE INTERSECTION BETWEEN IL ROUTE 26 AND US ROUTE 34. COVER ANY SIGNS DENOTING SOUTH US ROUTE 34 WITHIN A MILE RADIUS OF THE INTERCHANGE BETWEEN IL ROUTE 92 AND US ROUTE 34. COVER ANY SIGNS DENOTING SOUTH US ROUTE 34 WITHIN A MILE RADIUS OF THE INTERSECTION BETWEEN IL ROUTE 89 AND US ROUTE 34.

LEGEND

- TT TYPE III BARRICADES CONFORMING TO STD. 701901 "ROAD CLOSED TO ALL TRAFFIC" WITH 2 FLASHING LIGHTS PER BARRICADE
- TT TYPE III BARRICADES CONFORMING TO STD. 701901 "ROAD CLOSED TO THRU TRAFFIC" WITH 2 FLASHING LIGHTS PER BARRICADE
- ⊥ SIGNS ON PERMANENT SUPPORTS
- ⊕ FLASHING LIGHT ABOVE SIGN
- ◊ 18"x18" ORANGE FLAG
- ▨ DETOUR ROUTE
- FO FLORESCENT ORANGE

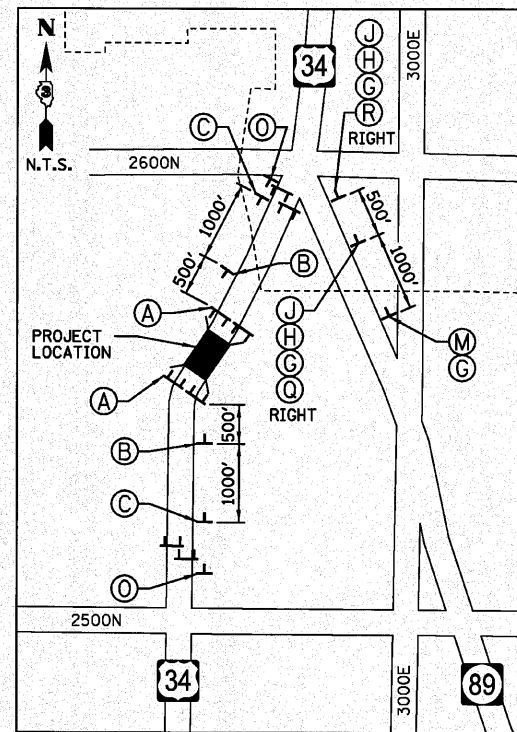

PROJECT LOCATION VICINITY (DETAIL "A")

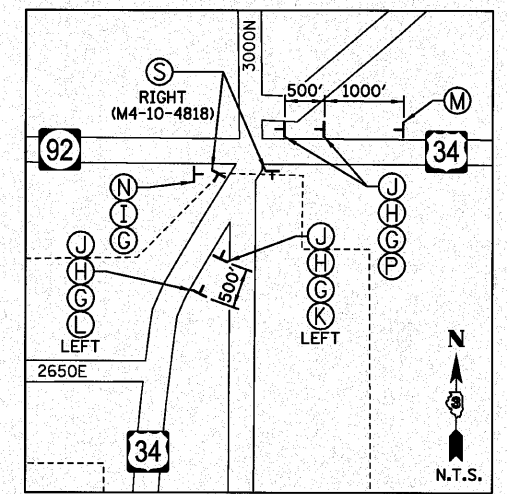

CITY OF LAMOILLE INTERCHANGE (DETAIL "B")

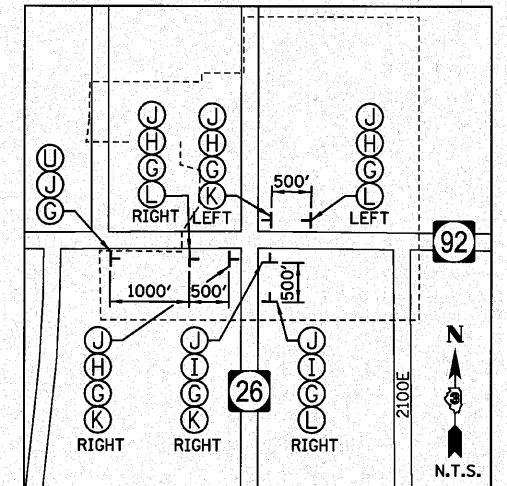

VILLAGE OF OHIO INTERCHANGE (DETAIL "C")

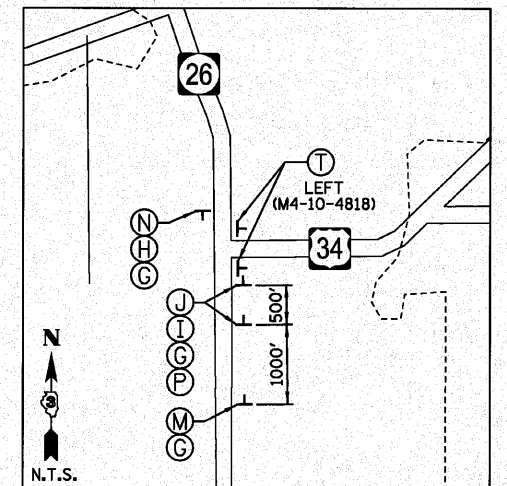

CITY OF PRINCETON INTERCHANGE (DETAIL "D")

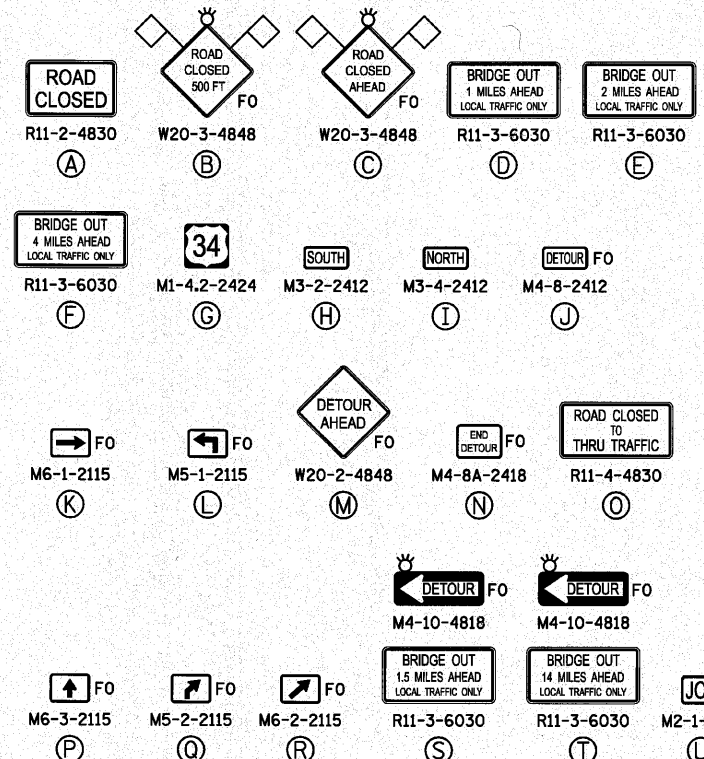

FILE NAME =	USER NAME = #USER#	DESIGNED - JML	REVISED -	STATE OF ILLINOIS DEPARTMENT OF TRANSPORTATION	DETOUR PLAN			F.A.S. RTE. 1249	SECTION (23 BR/BR)	COUNTY BUREAU	TOTAL SHEETS 39	SHEET NO. 12
#FILE#		DRAWN - JWK	REVISED -		SCALE:	SHEET NO. OF SHEETS	STA. TO STA.	CONTRACT NO. 66909				
		CHECKED - MSW	REVISED -					ILLINOIS FED. AID PROJECT				
		DATE - 10/08/10	REVISED -					24-8372				