

FINAL SURVEY	BY	DATE
SURVEYED		
PLOTTED		
NOTE BOOK		
AREAS CHECKED		
NO.		

ORIGINAL SURVEY	BY	DATE
SURVEYED		
PLOTTED		
NOTE BOOK		
AREAS CHECKED		
NO.		

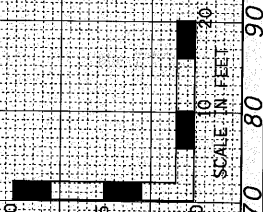
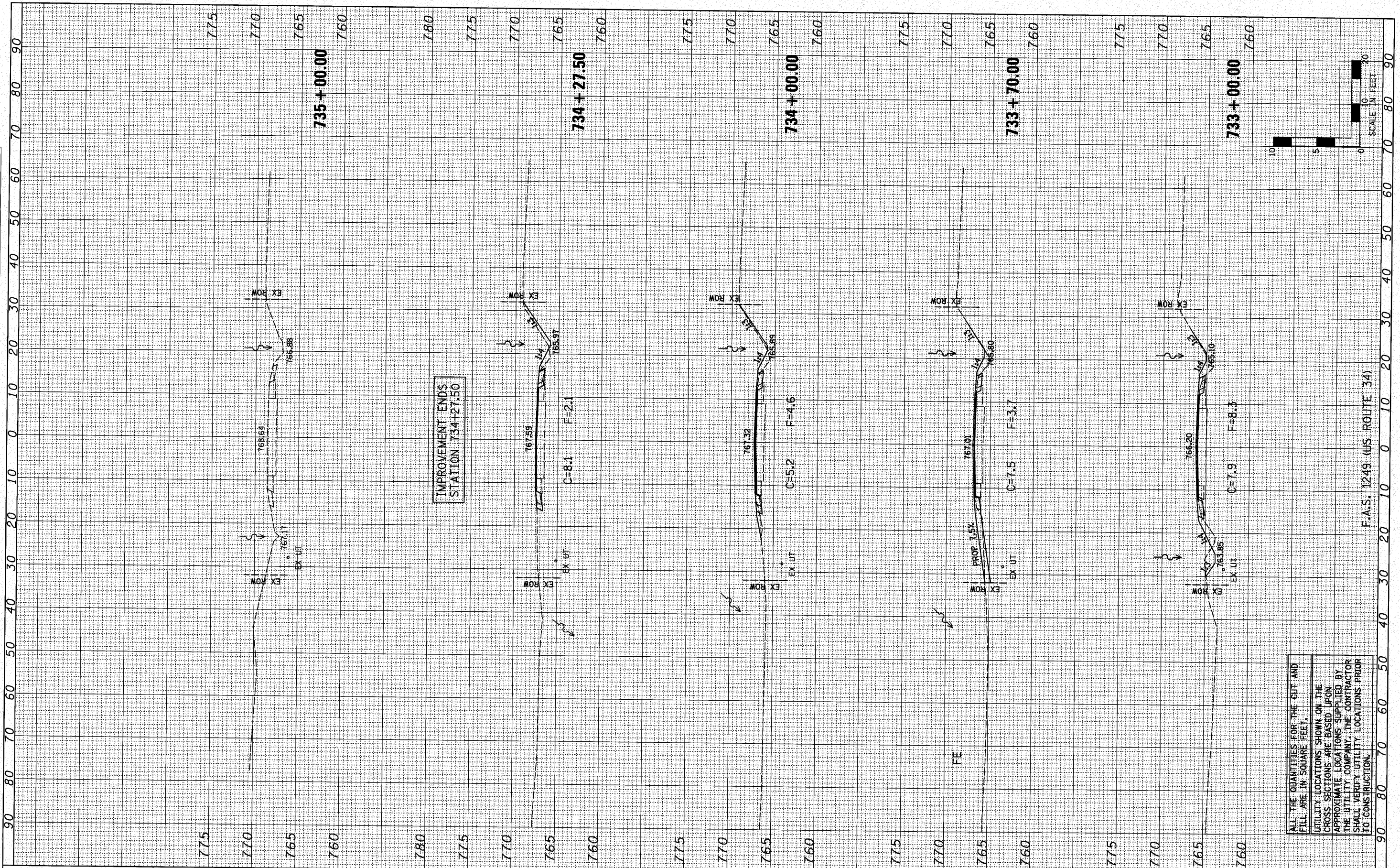

F.A.S. 1249 (US ROUTE 34)

ALL THE QUANTITIES FOR THE CUT AND FILL ARE IN SQUARE FEET.  
UTILITY LOCATIONS SHOWN ON THE CROSS SECTIONS ARE BASED UPON APPROXIMATE LOCATIONS SUPPLIED BY THE UTILITY COMPANY. THE CONTRACTOR SHALL VERIFY UTILITY LOCATIONS PRIOR TO CONSTRUCTION.

FILE NAME - #FILE#	USER NAME - #USER#	DESIGNED - JML	REVISED -	<b>STATE OF ILLINOIS</b> <b>DEPARTMENT OF TRANSPORTATION</b>	<b>CROSS SECTIONS</b>	F.A.S. RTE. 1249	SECTION (23 BROBR)	COUNTY BUREAU	TOTAL SHEETS 39	SHEET NO. 39	
	DESIGNED - JML	DRAWN - JJO	REVISED -			SCALE: 1"=10'	SHEET NO. OF SHEETS	STA. 733+00.00 TO STA. 735+00.00	FED. ROAD DIST. NO. ILLINOIS FED. AID PROJECT	CONTRACT NO. 66909	
	DESIGNED - JML	CHECKED - MSW	REVISED -								
	DESIGNED - JML	DATE - 10/08/10	REVISED -								

FARNSWORTH GROUP, INC.

CONSULTING ENGINEERS - 2709 MCGRAW DRIVE BLOOMINGTON, ILLINOIS 61704 (309) 663-8435 / (309) 663-1571 FAX