

DATE	
BY	
SURVEYED	
PLOTTED	
NOTE BOOK	
AREAS CHECKED	
NO.	

DATE	
BY	
ORIGINAL SURVEY	
TEMPLATE	
NOTE BOOK	
AREAS CHECKED	
NO.	

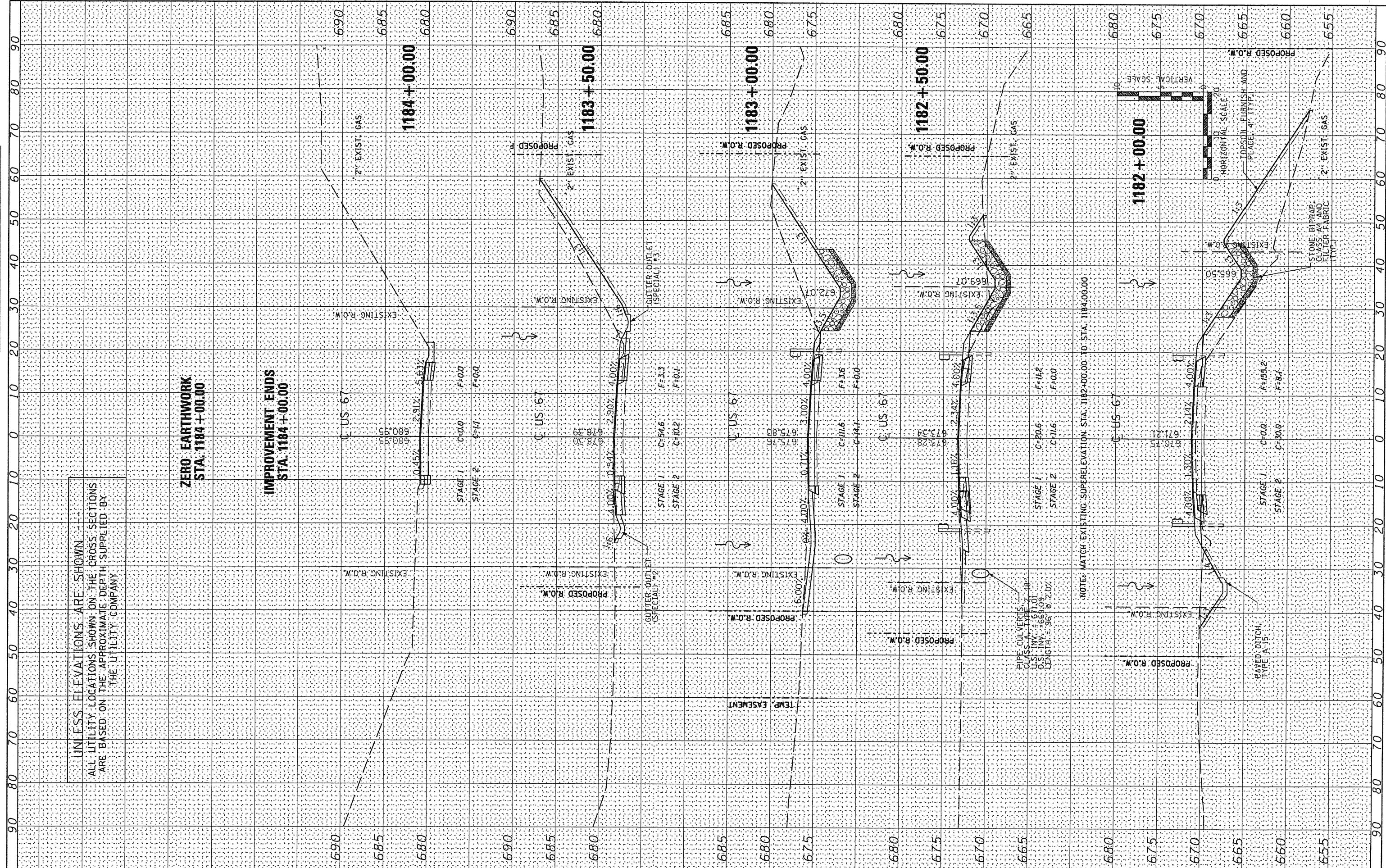

UNLESS ELEVATIONS ARE SHOWN
ALL UTILITY LOCATIONS SHOWN ON THE CROSS SECTIONS
ARE BASED ON THE APPROXIMATE DEPTH SUPPLIED BY
THE UTILITY COMPANY

ZERO EARTHWORK
STA. 1184+00.00

IMPROVEMENT ENDS
STA. 1184+00.00

FILE NAME =
S:\237\2008\2370802\US67CedarCreek\CADD\CADD

USER NAME = rbradla
Sheets\468661-sht-xsc.dgn
PLOT SCALE = 20.0000' / IN.
PLOT DATE = 10/23/2010

DESIGNED -	REVISED -
DRAWN -	REVISED -
CHECKED -	REVISED -
DATE -	REVISED -

STATE OF ILLINOIS
DEPARTMENT OF TRANSPORTATION

US 67 OVER CEDAR CREEK
CROSS SECTIONS

SCALE: SHEET NO. OF SHEETS STA. 1182+00.00 TO STA. 1184+00.00

F.A.P. RTE.	SECTION	COUNTY	TOTAL SHEETS	SHEET NO.
310	(28B)BR-1	WARREN	71	71
CONTRACT NO. 68661			ILLINOIS FED. AID PROJECT	