

DATE	
BY	
DESIGNED	
CHECKED	
DRAWN	
NOTED	
DATE	
BY	
DESIGNED	
CHECKED	
DRAWN	
NOTED	

DATE	
BY	
DESIGNED	
CHECKED	
DRAWN	
NOTED	
DATE	
BY	
DESIGNED	
CHECKED	
DRAWN	
NOTED	

SECTION 31. T. 27 N. R. 2 E. 3rd P.M.

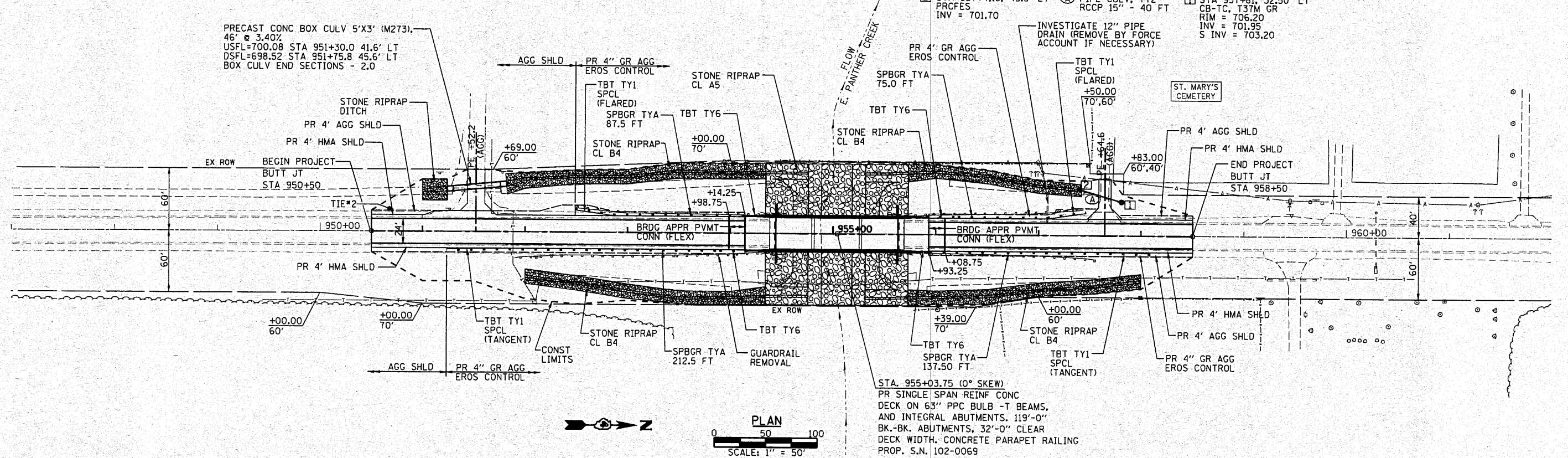

SECTION 32. T. 27 N. R. 2 E. 3rd P.M.

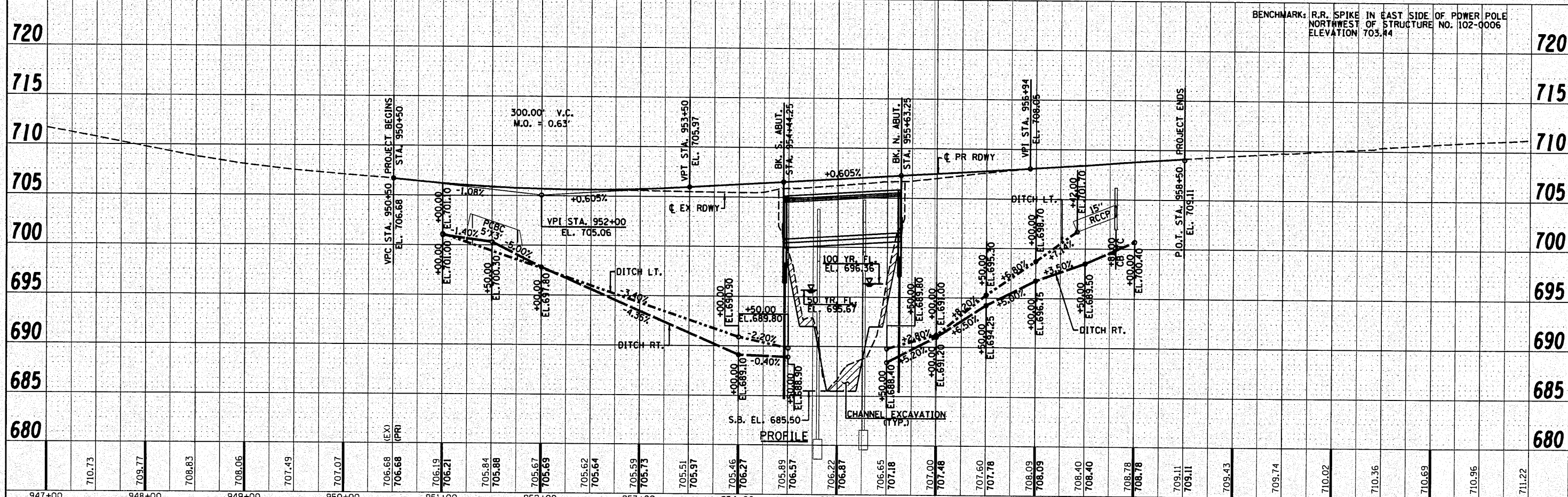

BENCHMARK: R.R. SPIKE IN EAST SIDE OF POWER POLE NORTHWEST OF STRUCTURE NO. 102-0006 ELEVATION 703.44

FILE NAME = Z:\2008 Jobs\08-027\CADD Sheets\0468785\htp\prof.dgn	USER NAME = USER8	DESIGNED -	REVISED -	<p>Allen Henderson & Associates, Inc. Civil and Structural Engineers Springfield, IL. 62703 Phone: (217)544-8033 IL Design Firm No. 184-001907</p>	<p>PLAN & PROFILE</p> <p>SCALE: 1" = 50' SHEET NO. 1 OF 1 SHEETS STA. 942+00.00 TO STA. 956+00.00</p>			F.A.S. RTE. 1360	SECTION (64-B-1)BR	COUNTY WOODFORD	TOTAL SHEETS 45	SHEET NO. 13
PLOT SCALE = 1/8" = 1'-0"	DRAWN -	REVISED -	FED. ROAD DIST. NO.					ILLINOIS FED. AID PROJECT	CONTRACT NO. 68785			
PLOT DATE = 10/25/2010	CHECKED -	REVISED -										