

STATE OF ILLINOIS
 DEPARTMENT OF TRANSPORTATION
 DIVISION OF HIGHWAYS

**PROPOSED
 HIGHWAY PLANS**

FAS ROUTE 1531 (CISCO - MONTICELLO RD)
 SECTION 10B-1 & 11B-1
 BRIDGE & CULVERT REPLACEMENT
 PIATT COUNTY
 WOLF RUN CREEK, STREAM 3.5 MI.
 E. OF CISCO, & WILDCAT CREEK
 PROJECT RS-1531(100)

C-95-007-05

F.A.S. RTE.	SECTION	COUNTY	TOTAL SHEETS	SHEET NO.
1531	10B-1 & 11B-1	PIATT	88	1
		ILLINOIS	CONTRACT NO. 70458	

FOR INDEX OF SHEETS, SEE SHEET NO. 2
 FOR SUMMARY OF QUANTITIES, SEE SHEETS 4-6

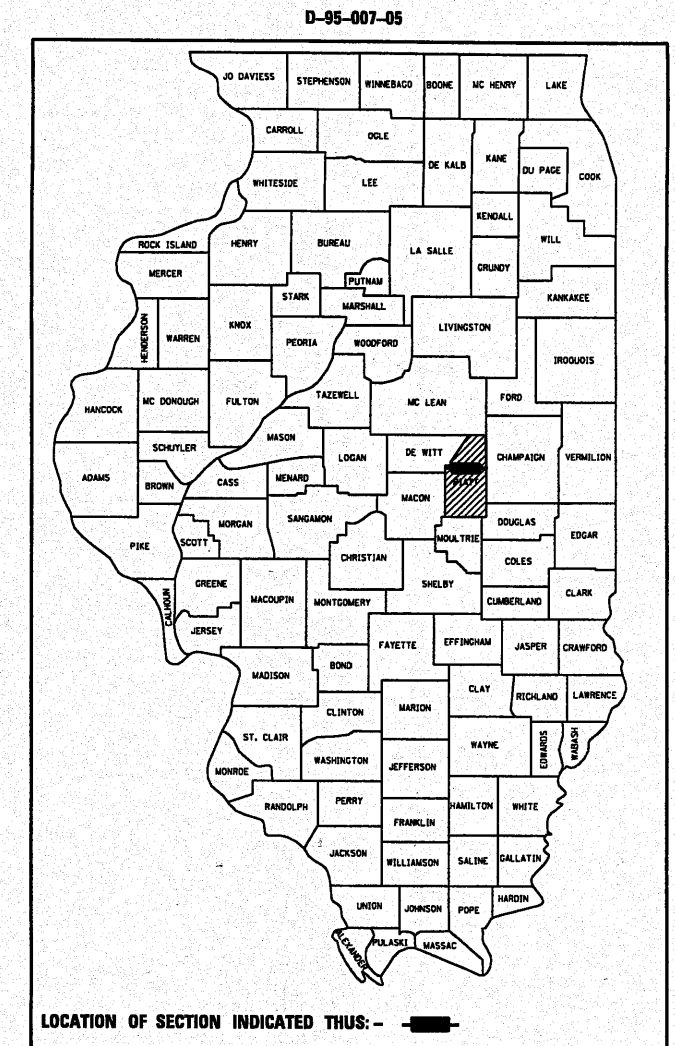

CURRENT ADT
 MAJOR COLLECTOR
 FAS 1531 (CISCO - MONTICELLO RD) = 1350 (2007)
 SU = 5.0% MU = 0.5%

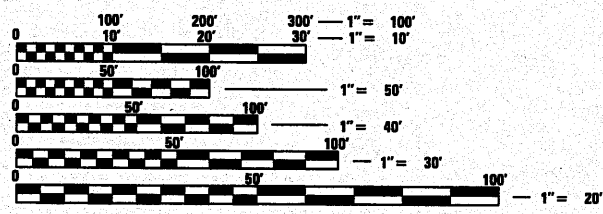

FULL SIZE PLANS HAVE BEEN PREPARED USING STANDARD ENGINEERING SCALES. REDUCED SIZED PLANS WILL NOT CONFORM TO STANDARD SCALES. IN MAKING MEASUREMENTS ON REDUCED PLANS, THE ABOVE SCALES MAY BE USED.

J.U.L.I.E.
 JOINT UTILITY LOCATION INFORMATION FOR EXCAVATION
 1-800-892-0123
 TOWNSHIPS
 OR 811 WILLOW BRANCH, MONTICELLO

PROJECT ENGINEER: NANCY FASIG
 SQUAD LEADER: STEVE COOMBS
 (217) 465-4181
 CONTRACT NO. 70458

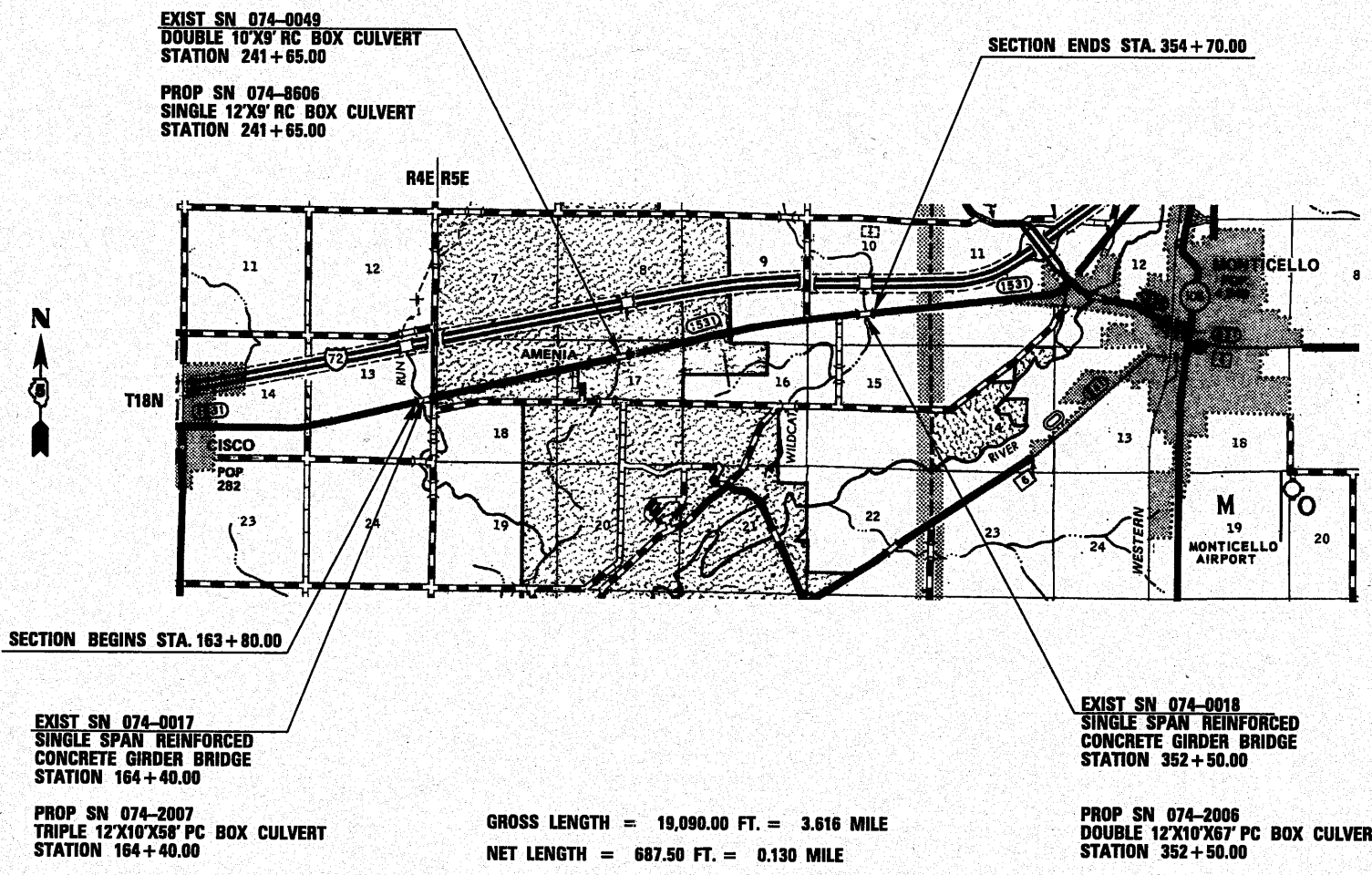

STATE OF ILLINOIS
 DEPARTMENT OF TRANSPORTATION
 DIVISION OF HIGHWAYS

SUBMITTED 10/20 20 10
[Signature]
 DEPUTY DIRECTOR OF HIGHWAYS, REGION ENGINEER

Dec 10 20 10
[Signature]
 ACTING ENGINEER OF DESIGN AND ENVIRONMENT

Dec 10 20 10
[Signature]
 DIRECTOR OF HIGHWAYS, CHIEF ENGINEER

**PRINTED BY THE AUTHORITY
 OF THE STATE OF ILLINOIS**