

EXIST. CURVE 36
 PI STA. = 65+61.02
 Δ = 62° 27' 35" (LT)
 D = 5° 39' 46"
 R = 1,011.79'
 T = 613.48'
 L = 1,102.98'
 E = 171.46'
 e = 8.0%
 T.R. = -----
 S.E. RUN = -----
 P.C. STA. = 59+47.54
 P.T. STA. = 70+50.52

FULL S.E.: (S.E.#2 = 8.0%) STA. 60+21.41 to 69+76.66 S.E. TRANSITION: STA. 58+50.97 to 60+40.30 (BK) = STA. 59+47.54 (AH) to 60+21.41 STA. 69+76.66 to 70+50.53 (BK) = STA. 70+74.06 (AH) to 72+63.39	FULL S.E.: (S.E.#2 = 8.0%) STA. 60+24.20 to 69+73.86 S.E. TRANSITION: STA. 58+86.97 to 60+40.30 (BK) = STA. 59+47.54 (AH) to 60+24.20 STA. 69+73.86 to 70+50.53 (BK) = STA. 70+74.06 (AH) to 72+27.39
---	---

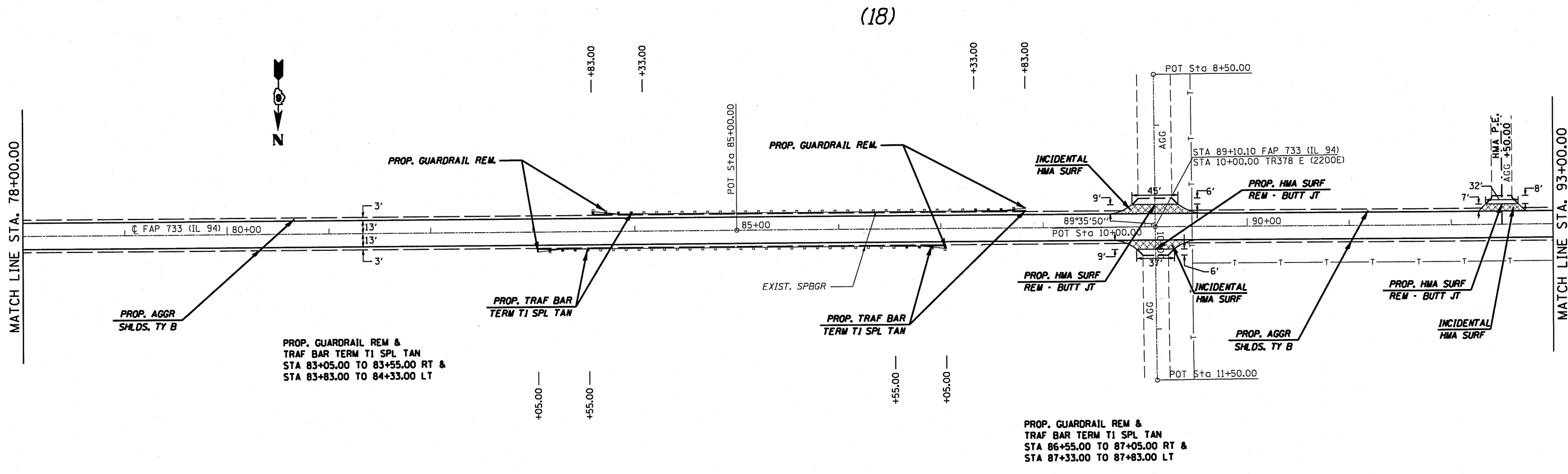

FILE NAME =	USER NAME = coxjw	DESIGNED -	REVISED -
c:\pwwork\pwwork\coxjw\d8215198\d672886-ah-plot.dgn		DRAWN - JWC	REVISED -
PLOT SCALE = 1/80.0000" / IN.		CHECKED - RSC	REVISED -
PLOT DATE = Sep-08-2010 10:42:38AM		DATE -	REVISED -

**STATE OF ILLINOIS
 DEPARTMENT OF TRANSPORTATION**

PLAN VIEW		
SCALE: 50	SHEET NO. 19 OF 23 SHEETS	STA. 64+00.00 TO STA. 93+00.00

F.A.P. RTE. 733	SECTION IRS-3, TRS-5	COUNTY	TOTAL SHEETS 48	SHEET NO. 34
CONTRACT NO. 72880				
[ILLINOIS] FED. AID PROJECT				

• ADAMS, HANCOCK