

DATE	
BY	
SURVEYED	
PLOTTED	
TEMPLATE	
NOTE BOOK	
AREAS CHECKED	
NO.	

DATE	
BY	
SURVEYED	
PLOTTED	
TEMPLATE	
NOTE BOOK	
AREAS CHECKED	
NO.	

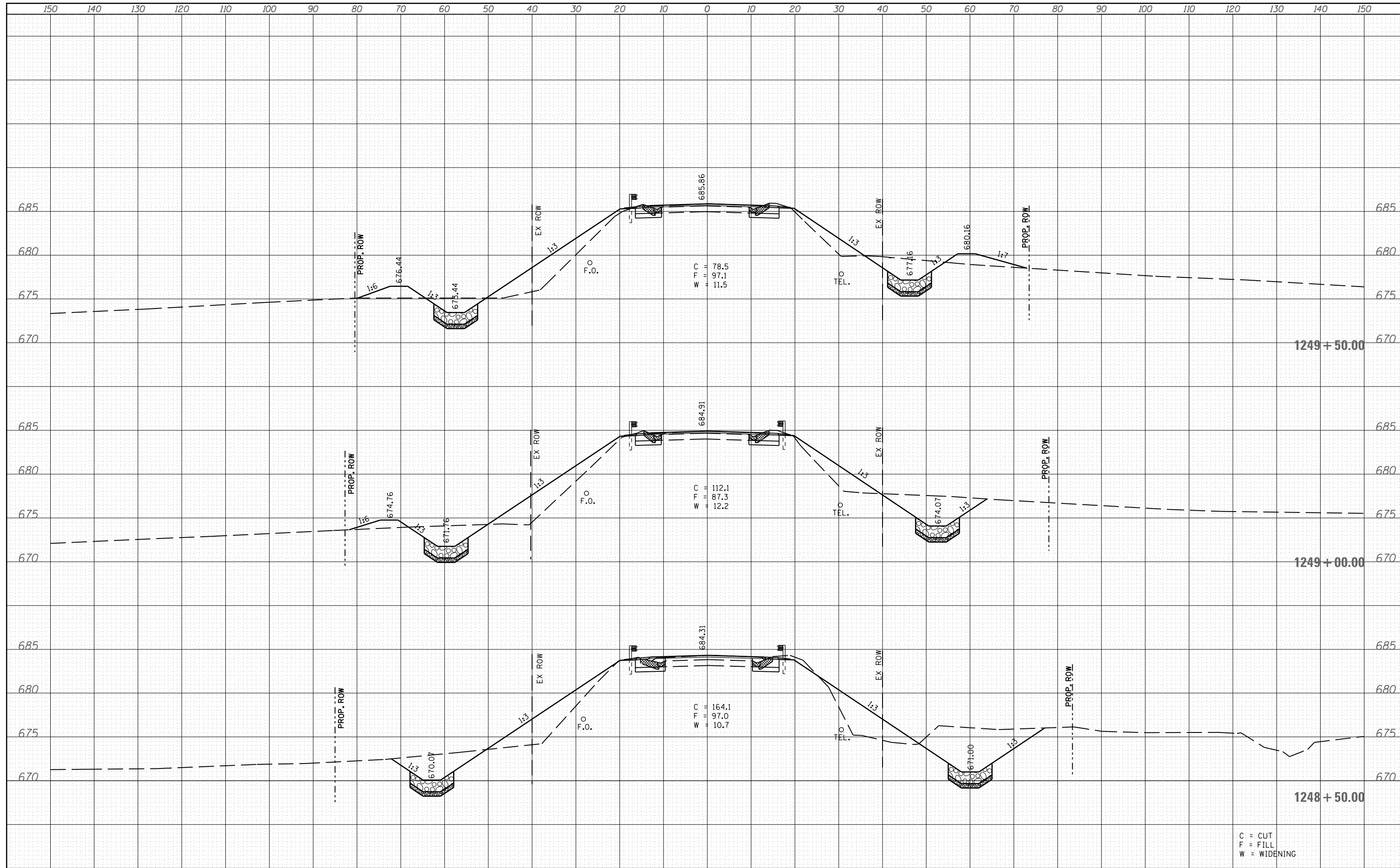

C = CUT
F = FILL
W = WIDENING

FILE NAME =	USER NAME = laughlinr1	DESIGNED - BKL	REVISED -	STATE OF ILLINOIS DEPARTMENT OF TRANSPORTATION	IL 104 OVER GRINDSTON CREEK CROSS SECTION SHEET		F.A.P. RTE. 745	SECTION 107B-1	COUNTY ADAMS	TOTAL SHEETS 86	SHEET NO. 70
es:\pw_work\pwidot\laughlinr1\d0215213\d672b98-sh	t-xssht.dgn	DRAWN - BKL	REVISED -		SCALE:	SHEET NO. OF SHEETS	STA. 1248+5000&TA. 1249+50.00	CONTRACT NO. 72B98		ILLINOIS FED. AID PROJECT	
		CHECKED - JPM	REVISED -								
		DATE - 8/25/10	REVISED -								