

P.I. STA= 301+23.57
 $\Delta = 23^{\circ} 27'$
 $D = 2^{\circ} 00'$
 $R = 2,864.93$
 $T = 594.62$
 $L = 1172.50$
 $E = 61.05$
 $e = 5.6\%$
 S.E. RUN= 293+98 to 295+96
 308+34 to 309+34
 P.C. STA= 295+28.95
 P.T. STA= 307+01.45

PROPOSED HOT-MIX ASPHALT SURFACE COURSE, MIX "C", N50, 1 1/2"
 PROPOSED LEVELING BINDER (MACHINE METHOD), N50, VARIABLE DEPTH

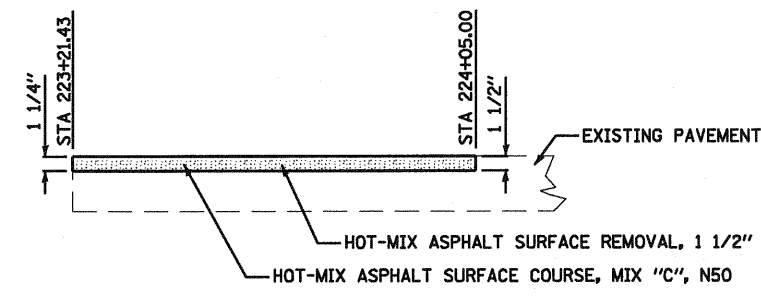
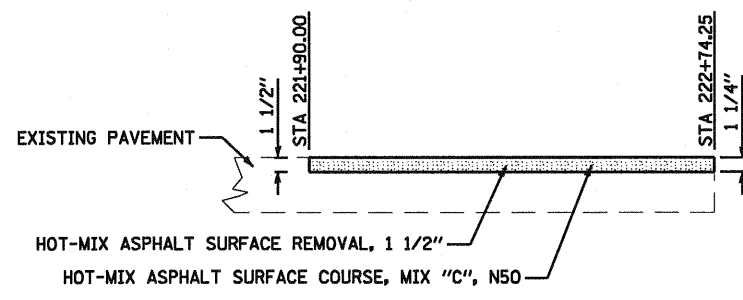
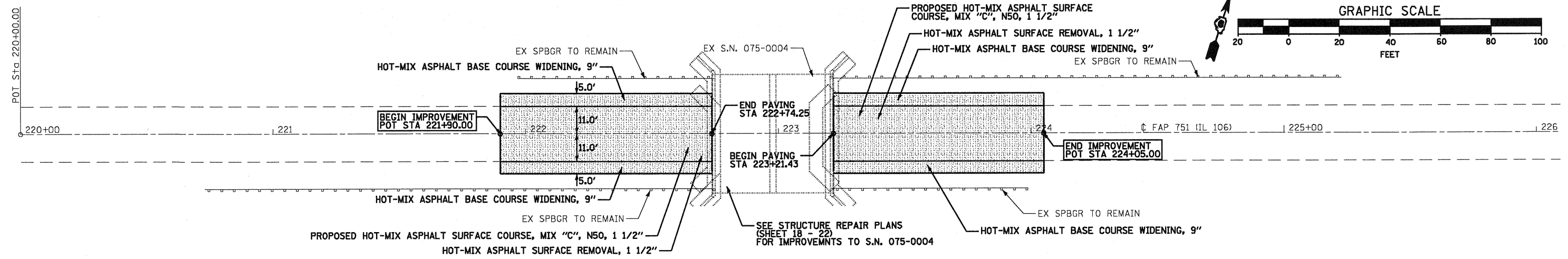
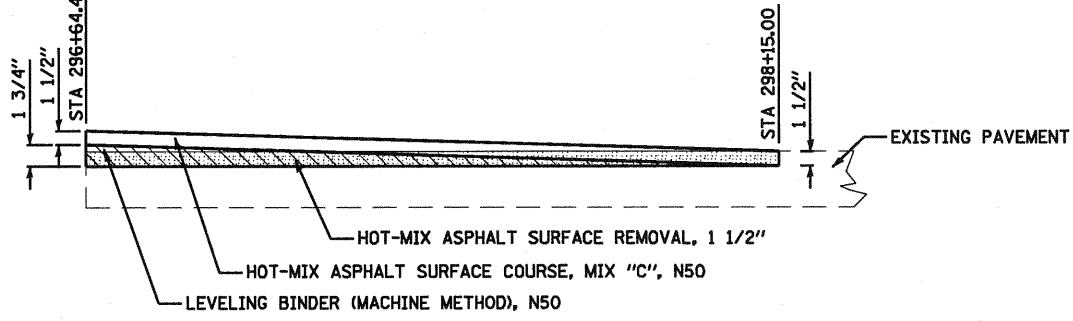
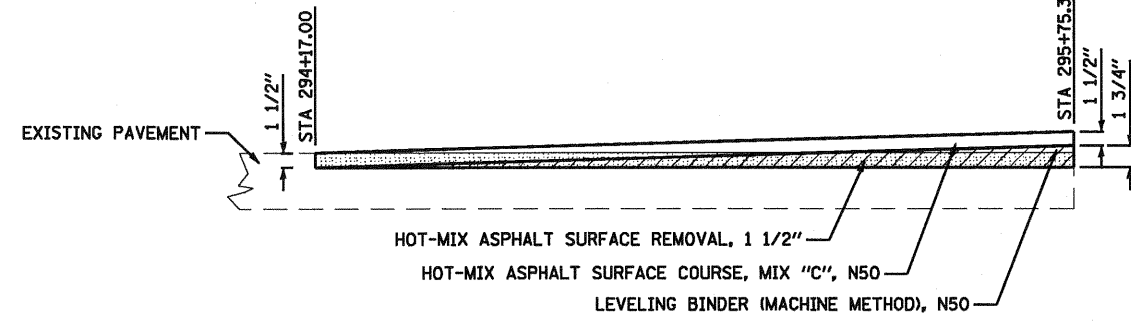
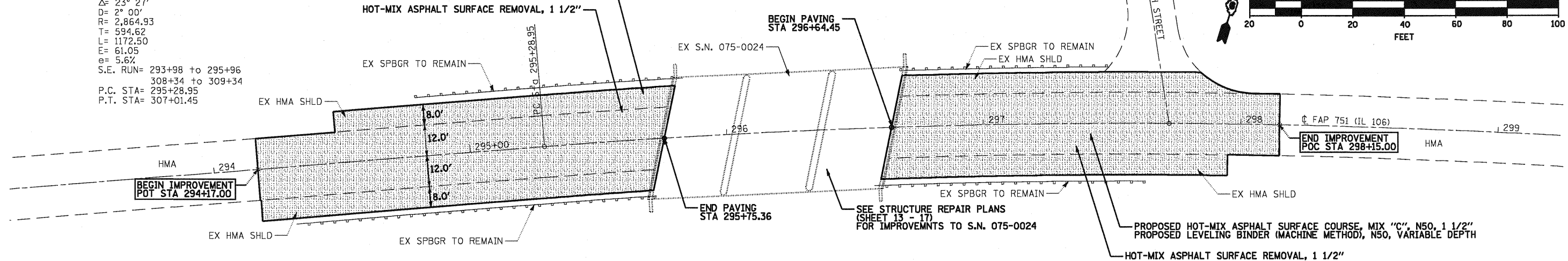

FILE NAME =	USER NAME = coxte	DESIGNED -	REVISED -	STATE OF ILLINOIS DEPARTMENT OF TRANSPORTATION	F.A.P. RTE.	SECTION	COUNTY	TOTAL SHEETS	SHEET NO.
c:\pwork\pwork\DOT\COXTE\d0183187\0672044\ahp\plan01.dgn	DRAWN -	REVISED -	REVISED -		751	D6 BRIDGE REPAIR 2009	PIKE	22	12
PLOT SCALE = 40.0000 1/ IN.	CHECKED -	REVISED -	REVISED -		CONTRACT NO. 72D44				
PLOT DATE = Feb-18-2010 01:52:29PM	DATE -	REVISED -	REVISED -		FED. ROAD DIST. NO. ILLINOIS FED. AID PROJECT				
					SCALE:	SHEET NO.	OF SHEETS	STA.	TO STA.