

Feb-10-2010 01:52:48PM

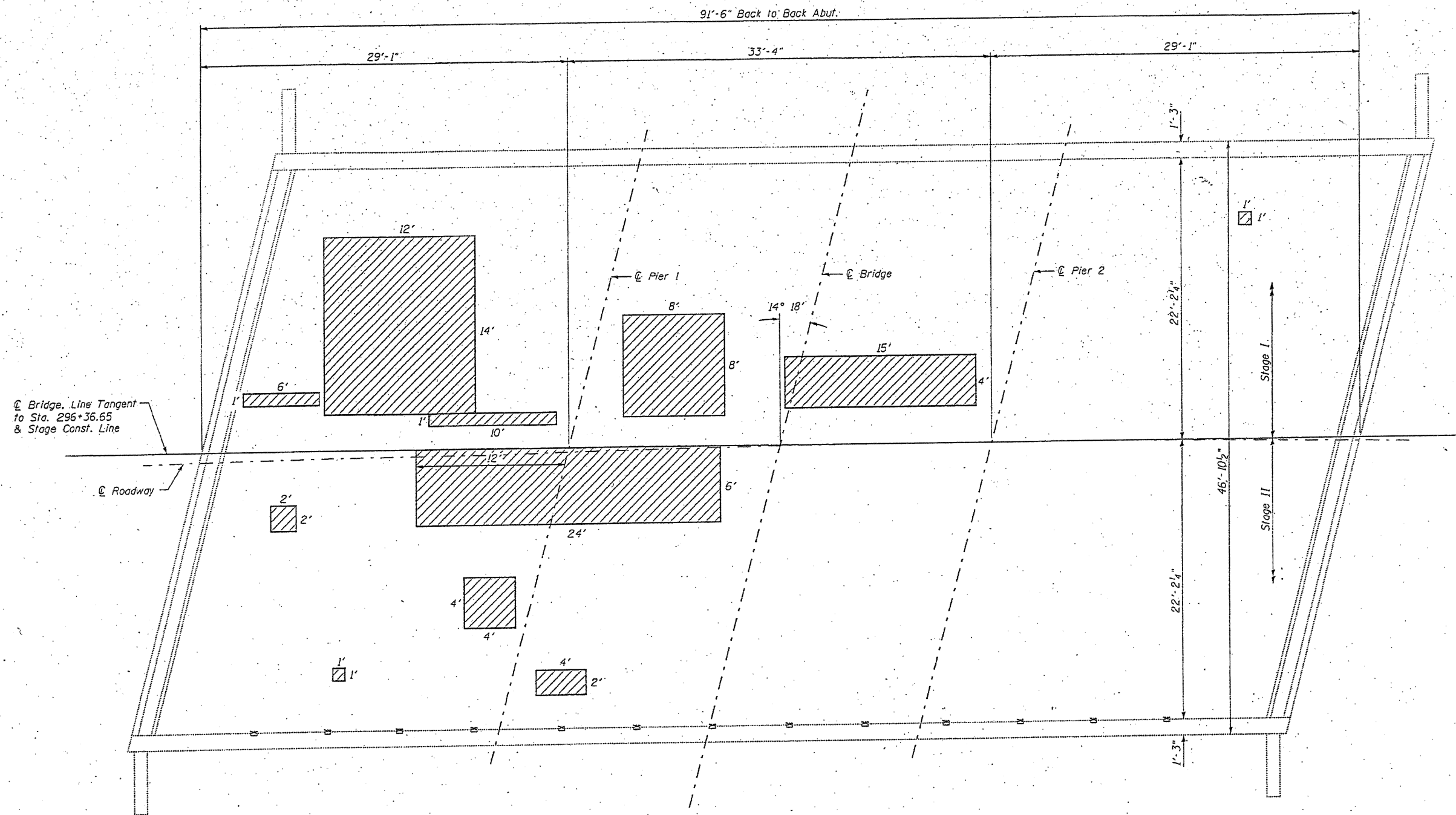

PLAN

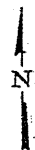

**DECK PATCHING PLAN**  
**IL 106 OVER THE SNY RIVER**  
**SN 075-0024**

DESIGNED	KTH
CHECKED	ADL
DRAWN	KTH/BGJ
CHECKED	ADL

**KLINGNER & ASSOCIATES, P.C.**  
 Engineers - Architects - Surveyors  
 111 North 7th Street, Spring, IL 60177-2070  
 111 North 7th Street, Spring, IL 60177-2070  
 111 North 7th Street, Spring, IL 60177-2070  
 111 North 7th Street, Spring, IL 60177-2070  
 STATE OF ILLINOIS DESIGN FIRM # 1842738

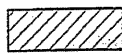
 Deck Slab Repair (Partial Depth) - 54 SQ. YD.  
 Note: Partial Depth Repair shall be achieved by bridge deck hydro-scarification and filled with microsilica concrete overlay. Cost included in "BRIDGE DECK HYDRO-SCARIFICATION 1/2" and BRIDGE DECK FLY ASH OR GGBF SLAG CONCRETE OVERLAY, 2 1/4"

SHEET NO. 5	F.A.P. RTE.	SECTION	COUNTY	TOTAL SHEETS	SHEET NO.
	751	06 BRIDGE REPAIR 2009	PIKE	22	17
5 SHEETS					
FED. ROAD DIST. NO.		ILLINOIS	FED. AID PROJECT		
CONTRACT NO. 72D44					

Klingner & Associates, P.C.