

F.A.P. RTE.	SECTION	COUNTY	TOTAL SHEETS	SHEET NO.
304	21-4	JERSEY/CALHOUN	14	1
		ILLINOIS	CONTRACT NO. 76E55	

STATE OF ILLINOIS
DEPARTMENT OF TRANSPORTATION
DIVISION OF HIGHWAYS

**PROPOSED
HIGHWAY PLANS**

FAP ROUTE 304 (IL 100)
SECTION 21-4

**BRUSSELS FERRY DOCKS
JERSEY & CALHOUN COUNTIES**

C-98-015-11

FOR INDEX OF SHEETS, SEE SHEET NO. 2

D-98-016-11



LOCATION OF SECTION INDICATED THIS: - [rectangle] -

PROJECT LOCATION
BRUSSELS FERRY
CALHOUN COUNTY SIDE

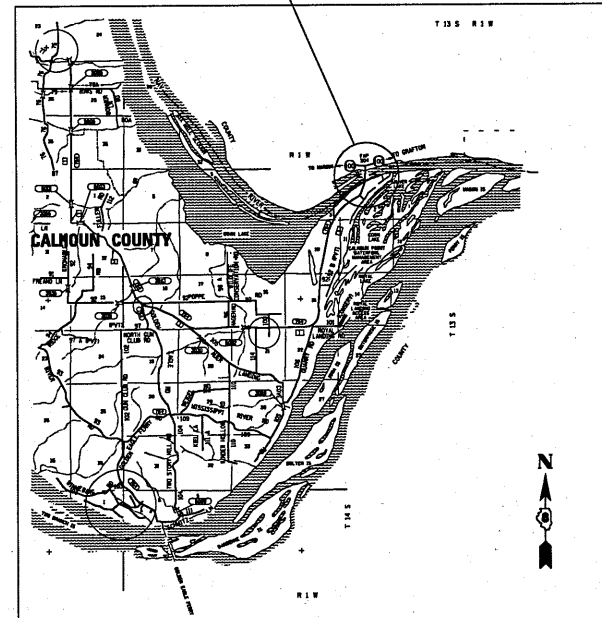

PROJECT LOCATION
BRUSSELS FERRY
JERSEY COUNTY SIDE

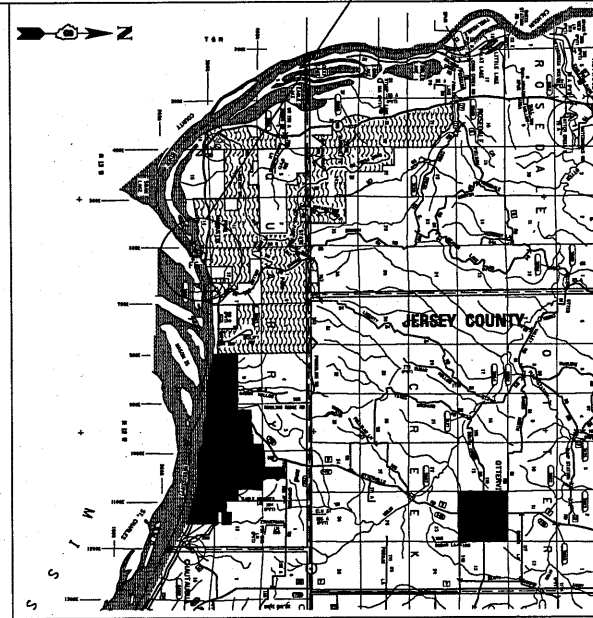

NOT TO SCALE

NET LENGTH = 850 FT. = 0.16 MILE

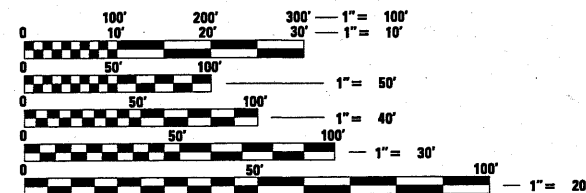

FULL SIZE PLANS HAVE BEEN PREPARED USING STANDARD ENGINEERING SCALES. REDUCED SIZED PLANS WILL NOT CONFORM TO STANDARD SCALES. IN MAKING MEASUREMENTS ON REDUCED PLANS, THE ABOVE SCALES MAY BE USED.

J.U.L.I.E.
JOINT UTILITY LOCATION INFORMATION FOR EXCAVATION
1-800-892-0123
OR 811

PROJECT ENGINEER: TIM PADGETT (618) 346-3325
PROJECT MANAGER: LIZ BURNSIDE (618) 346-3196

CONTRACT NO. 76E55

STATE OF ILLINOIS
DEPARTMENT OF TRANSPORTATION
DIVISION OF HIGHWAYS

SUBMITTED October 27 20 10
Mar C James
DEPUTY DIRECTOR OF HIGHWAYS, REGION ENGINEER
Dec 10 20 10
Scott E. Stitt, P.E.
ENGINEER OF DESIGN AND ENVIRONMENT
Dec 10 20 10
Christine M. Reeder
DIRECTOR OF HIGHWAYS, CHIEF ENGINEER

PRINTED BY THE AUTHORITY
OF THE STATE OF ILLINOIS