

ALIGNMENT COORDINATES - IL146			
IL-146	STATION	N	E
POT	1435+00.00	278968.6851	942092.4519
POT	1438+15.00	278717.6776	941902.1357
POT	1438+21.00	278712.8965	841898.5106
POT	1438+51.00	278688.9910	941880.3853
POT	1439+93.50	278575.4401	941794.2898
POT	1440+23.50	278551.5346	941776.1645
POT	1440+29.50	278546.7535	941772.5394
POT	1443+00.00	278331.2058	941609.1092

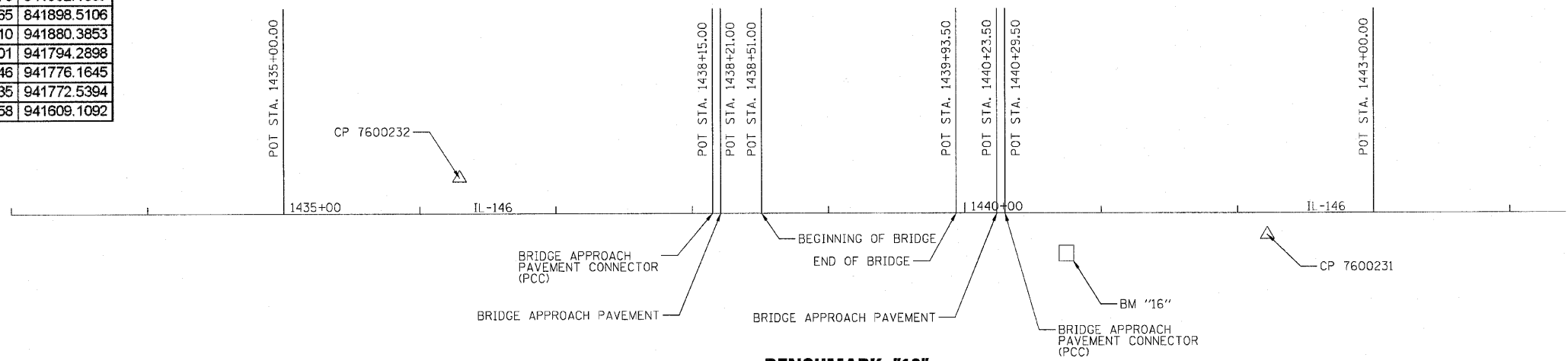

**BENCHMARK "16"**

ELEV. 359.95  
CHISELED "□" ON NORTHEAST CORNER,  
SOUTHWEST WING WALL OF  
STRUCTURE NO. 076-0023

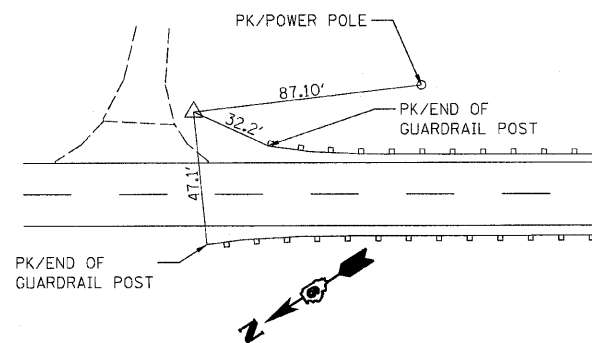

**CONTROL POINT 7600232**

IRON PIN WITH CAP  
STA. 1436+29.28 26,1836' LT  
N 278,849.8479  
E 610,035.2073  
ELEV. 363.5820

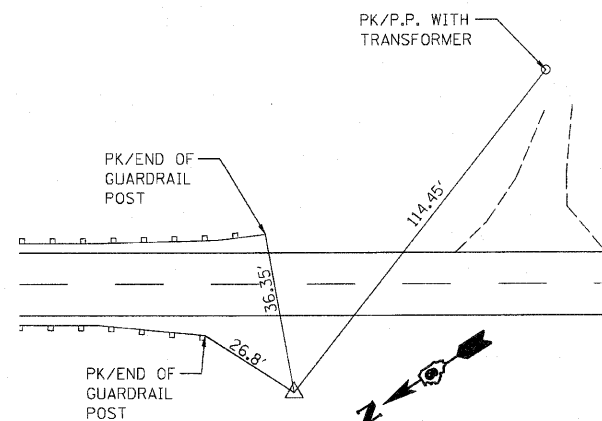

**CONTROL POINT 7600231**

IRON PIN WITH CAP  
STA. 1442+21.83 15,8354' RT  
N 278,403.0643  
E 941,643.7204  
ELEV. 357.0050

DATE	
BY	
SURVEYED	
PLOTTED	
AREAS	
AREAS	
CHECKED	
NO.	



DATE	
BY	
SURVEYED	
PLOTTED	
AREAS	
AREAS	
CHECKED	
NO.	

FILE NAME =	USER NAME = Cox01283	DESIGNED - JDW	REVISED -	<b>STATE OF ILLINOIS DEPARTMENT OF TRANSPORTATION</b>	<b>IL-146 (OVER SIMMONS CREEK) ALIGNMENT, TIES, &amp; BENCHMARKS</b>	F.A.P. RTE.	SECTION	COUNTY	TOTAL SHEETS	SHEET NO.	
ca:\working\cox01283\dms23631\0978141-sh	ATB.dgn	DRAWN - BKC	REVISED -			885	6B-2	POPE	48	8	
		CHECKED - MH	REVISED -			CONTRACT NO. 78141					
		DATE - 06-30-2010	REVISED -			SCALE: NTS	SHEET NO. 1 OF 1 SHEETS	STA. 1435+00.00 TO STA. 1443+00.00	FED. ROAD DIST. NO. ILLINOIS FED. AID PROJECT		