

DATE	
BY	
FINAL SURVEY	
SURVEYED	
PLOTTED	
NOTE BOOK	
AREAS CHECKED	
NO.	

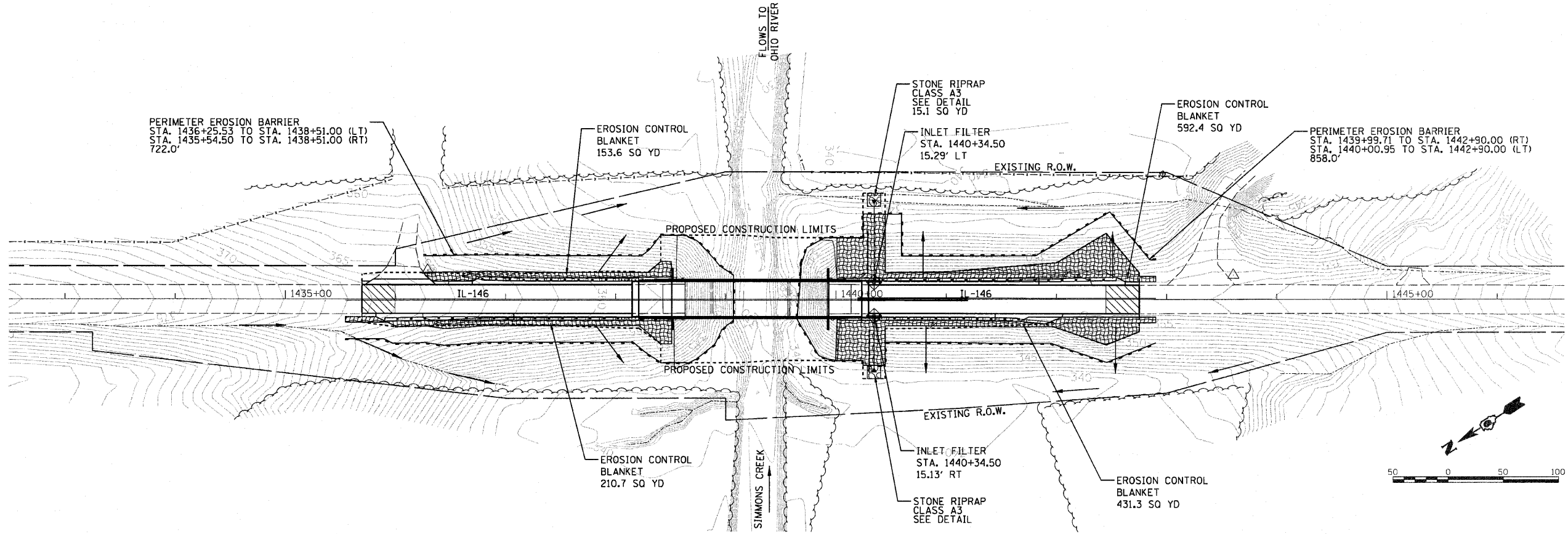

DATE	
BY	
ORIGINAL SURVEY	
SURVEYED	
PLOTTED	
NOTE BOOK	
AREAS CHECKED	
NO.	



EROSION CONTROL LEGEND

- EROSION CONTROL BLANKET
- INLET FILTER
- TEMPORARY DITCH CHECK
- PERIMETER EROSION BARRIER
- DRAINAGE PATTERN DIRECTION

INTENDED SEQUENCE

1. PLACEMENT OF PERIMETER EROSION BARRIER PRIOR TO COMMENCEMENT OF ANY WORK, SEE STANDARD 280001.
2. PLACEMENT OF TEMPORARY SEEDING ON GRADED SURFACES NOT HAVING PERMANENT SEEDING APPLIED.
3. PLACEMENT OF EROSION CONTROL BLANKET AFTER FINAL GRADING.
4. ONGOING MAINTENANCE OF EROSION CONTROL ELEMENTS PER THE SWPPP.
5. REMOVE TEMPORARY EROSION CONTROL ELEMENTS AFTER FINAL GRADING AND PERMANENT SEEDING ESTABLISHED AS PER THE SWPPP AND APPROVED BY THE ENGINEER.

NOTES

1. MAJOR GRADING SLOPES ALONG THE PROPOSED ROADWAY ARE 2:1 MAX.
2. SOILS DISTURBANCE SHALL ONLY OCCUR WITHIN THE AREAS SHOWN.
3. RECEIVING WATER FOR DRAINAGE FROM PROJECT IS SIMMONS CREEK, SIMMONS CREEK IS A TRIBUTARY OF THE OHIO RIVER.

FILE NAME =	USER NAME = Cox21283	DESIGNED - JDW	REVISED -	STATE OF ILLINOIS DEPARTMENT OF TRANSPORTATION	IL-146 (OVER SIMMONS CREEK) TEMPORARY EROSION CONTROL PLAN	F.A.P. RTE.	SECTION	COUNTY	TOTAL SHEETS	SHEET NO.	
os\working\cox21283\dms23631\N0978141-sh	eros.dgn	DRAWN - BKC	REVISED -			885	6B-2	POPE	48	13	
	PLOT SCALE = 99.9998' / 1"	CHECKED - MH	REVISED -			CONTRACT NO. 78141					
	PLOT DATE = 10/21/2010	DATE - 06-30-2010	REVISED -			SCALE: NTS	SHEET NO. 1 OF 1 SHEETS	STA. 1435+00.00 TO STA. 1443+00.00	FED. ROAD DIST. NO.	ILLINOIS	FED. AID PROJECT