

F.A.I. RTE.	SECTION	COUNTY	TOTAL SHEETS	SHEET NO.
57	D9 BSMART 2011-1	WILLIAMSON	11	1
		ILLINOIS	CONTRACT NO. 78226	

STATE OF ILLINOIS
DEPARTMENT OF TRANSPORTATION
DIVISION OF HIGHWAYS

**PROPOSED
HIGHWAY PLANS**

FAI ROUTE 57
OVER FAP 331 (IL 13) PROJECT: IM-057-2(153)053
SECTION D9 BSMART 2011-1
MICROSILICA CONCRETE OVERLAY
WILLIAMSON COUNTY

D-99-003-11

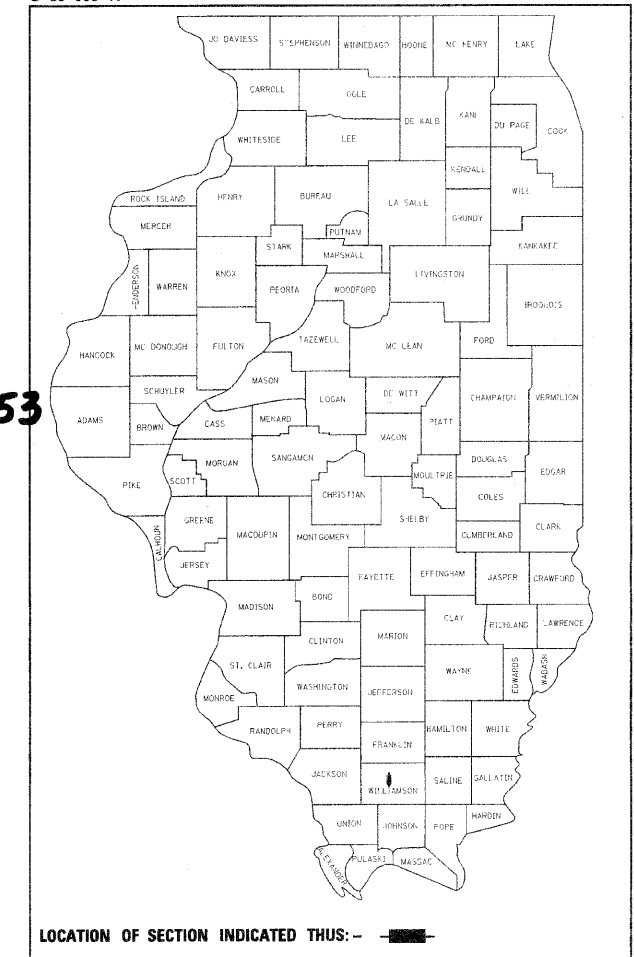

FOR INDEX OF SHEETS, SEE SHEET NO. 2

TRAFFIC DATA

I-57 TRAFFIC DATA

2009 ADT = 37,560
32% TRUCKS

TOWNSHIPS:

W. MARION

C-99-005-11

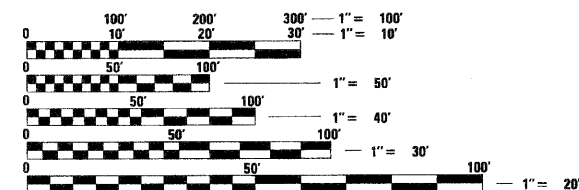

FULL SIZE PLANS HAVE BEEN PREPARED USING STANDARD ENGINEERING SCALES. REDUCED SIZED PLANS WILL NOT CONFORM TO STANDARD SCALES. IN MAKING MEASUREMENTS ON REDUCED PLANS, THE ABOVE SCALES MAY BE USED.

J.U.L.I.E.
JOINT UTILITY LOCATION INFORMATION FOR EXCAVATION
1-800-892-0123
OR 811

PROJECT LOCATION
SN 100-0009 (S.B.)

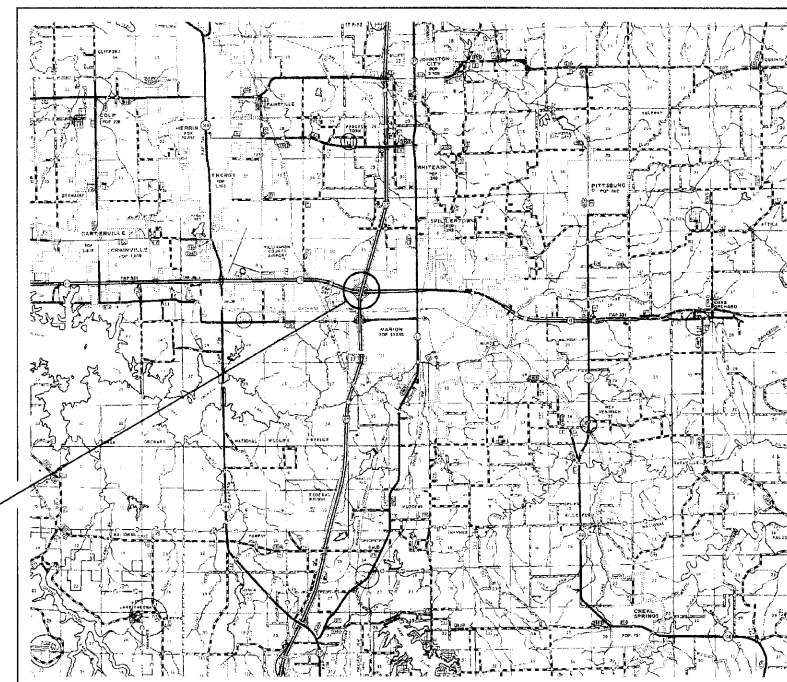

GROSS LENGTH = 210 FT.
NET LENGTH = 210 FT.

PROJECT ENGINEER T. WAYNE HALSTEAD
PROJECT MANAGER DAVID PICHE

CONTRACT NO. 78226

STATE OF ILLINOIS
DEPARTMENT OF TRANSPORTATION
DIVISION OF HIGHWAYS

SUBMITTED *Oct 15 20 10*
[Signature]
DEPUTY DIRECTOR OF HIGHWAYS, REGION ENGINEER

December 10 20 10
Scott E. Stitt P.E. Jr.
acting ENGINEER OF DESIGN AND ENVIRONMENT

December 10 20 10
Christine M. Reed
DIRECTOR OF HIGHWAYS, CHIEF ENGINEER

**PRINTED BY THE AUTHORITY
OF THE STATE OF ILLINOIS**

GENERAL NOTES

- 1) PRIOR TO PLACEMENT OF THE FINAL PAVEMENT MARKINGS THE RESIDENT ENGINEER SHOULD CONTACT THE BUREAU OF OPERATIONS AND ARRANGE FOR INSPECTION AND APPROVAL OF THE PAVEMENT MARKING LAYOUT.
- 2) IN ADDITION TO THE REQUIREMENTS OF ARTICLE 107.16 THE CONTRACTOR SHALL PROTECT THE SURFACE OF ALL BRIDGE DECKS AND BRIDGE APPROACH PAVEMENTS IN A MANNER SATISFACTORY TO THE ENGINEER BEFORE ANY EQUIPMENT IS ALLOWED TO CROSS THE STRUCTURE. PROTECTION SHALL BE PROVIDED FOR ALL EQUIPMENT AS DEFINED IN ARTICLE 101.16 REGARDLESS IF TRACK MOUNTED OR WHEELED.
- 3) COMMITMENTS: NONE AS OF OCTOBER 22, 2010.

STANDARDS

000001-06	STANDARD SYMBOLS, ABBREVIATIONS AND PATTERNS
001001-02	AREAS OF REINFORCEMENT BARS
642001-01	SHOULDER RUMBLE STRIPS
701101-02	OFF-ROAD, MULTILANE 15' TO PAVEMENT EDGE
701400-05	APPROACH TO LANE CLOSURE FREEWAY/EXPRESSWAY
701401-06	LANE CLOSURE FREEWAY/EXPRESSWAY
701402-08	LANE CLOSURE FREEWAY/EXPRESSWAY, WITH BARRIER
701426-04	LANE CLOSURE, MULTILANE, INTERMITTENT OR MOVING OPERATION, FOR SPEEDS \geq 45 MPH
701451-01	RAMP CLOSURE FREEWAY/EXPRESSWAY
701901-01	TRAFFIC CONTROL DEVICES
704001-06	TEMPORARY CONCRETE BARRIER
780001-02	TYPICAL PAVEMENT MARKINGS

INDEX OF SHEETS

1	COVER SHEET
2	INDEX OF SHEETS; GENERAL NOTES; STANDARDS
3	SUMMARY OF QUANTITIES
4	STAGE 1 TRAFFIC DETAILS
5	STAGE 1 TRAFFIC DETAILS
6	STAGE 2 TRAFFIC DETAILS
7	STAGE 2 TRAFFIC DETAILS
8	GENERAL PLAN AND ELEVATION
9	STAGING TYPICAL SECTION
10	DECK SLAB REPAIR DETAILS
11	TEMPORARY CONCRETE BARRIER

Prepared By: *Bob Nolan*
DISTRICT STUDIES & PLANS ENGINEER

Examined By: *James Louis Emery*
DISTRICT LAND ACQUISITION ENGINEER

Examined By: *Carrie Nelson*
DISTRICT PROGRAM DEVELOPMENT ENGINEER

Examined By: *Douglas J. Helfrich*
DISTRICT OPERATIONS ENGINEER

Examined By: *V. P. Kelly*
DISTRICT CONSTRUCTION ENGINEER

Examined By: *Bruno...*
DISTRICT MATERIALS ENGINEER

Examined By: *Kevin...*
DISTRICT PROJECT IMPLEMENTATION ENGINEER

Examined By: *W. L. Clayton*
ASSISTANT REGIONAL ENGINEER

Approved By: *...*
DEPUTY DIRECTOR OF HIGHWAYS, REGION ENGINEER

DATE: 10/22/2010 20 10

FILE NAME :	USER NAME : hsteeedt	DESIGNED :	REVISED :	STATE OF ILLINOIS DEPARTMENT OF TRANSPORTATION	INDEX OF SHEETS, GENERAL NOTES	F.A.I. RTE.:	SECTION	COUNTY	TOTAL SHEETS	SHEET NO.
000001-0009.sht.pln.dgn	DRAWN :	REVISED :	57			D9 BSMART 2011-1	WILLIAMSON	11	2	
PLOT SCALE = 50.0000 / IN.	CHECKED :	REVISED :	CONTRACT NO. 78226							
PLOT DATE = 9/22/2010	DATE :	REVISED :	ILLINOIS FED. AID PROJECT							

SUMMARY OF QUANTITIES

IM FUNDING
90% FEDERAL 10% STATE
CONSTRUCTION TYPE CODE
0005
WILLIAMSON
SN 100-0009

CODE NUMBER	ITEM DESCRIPTION	UNIT	QUANTITY
44001114	HOT-MIX ASPHALT SURFACE REMOVAL (ASBESTOS)	SQ YD	1030
42001300	PROTECTIVE COAT	SQ YD	1030
50300260	BRIDGE DECK GROOVING	SQ YD	998
67000400	ENGINEERS FIELD OFFICE, TYPE A	CAL MO	2
67100100	MOBILIZATION	L SUM	1
70100800	TRAFFIC CONTROL AND PROTECTION, STANDARD 701401	L SUM	1
70100207	TRAFFIC CONTROL AND PROTECTION, STANDARD 701402	EACH	1
70100820	TRAFFIC CONTROL AND PROTECTION, STANDARD 701451	L SUM	1
70106800	CHANGEABLE MESSAGE SIGN	CAL MO	3
70300100	SHORT-TERM PAVEMENT MARKING	FOOT	50
70300220	TEMPORARY PAVEMENT MARKING - LINE 4"	FOOT	528
70301000	WORK ZONE PAVEMENT MARKING REMOVAL	SQ FT	193
70400100	TEMPORARY CONCRETE BARRIER	FOOT	425
70400200	RELOCATE TEMPORARY CONCRETE BARRIER	FOOT	387.5
* 78004210	PREFORMED PLASTIC PAVEMENT MARKING, TYPE B - INLAID - LINE 4"	FOOT	528
* 78100105	RAISED REFLECTIVE PAVEMENT MARKER (BRIDGE)	EACH	4
78300100	PAVEMENT MARKING REMOVAL	SQ FT	175
78300200	RAISED REFLECTIVE PAVEMENT MARKER REMOVAL	EACH	4
X0323644	PAVEMENT MARKING GROOVING	FOOT	528
XZ191205	BRIDGE DECK MICROSILICA CONCRETE OVERLAY 3"	SQ YD	1030
Z0006202	BRIDGE DECK HYDRO-SCARIFICATION 3/4"	SQ YD	1030
Z0016001	DECK SLAB REPAIR (FULL DEPTH, TYPE I)	SQ YD	1
Z0016002	DECK SLAB REPAIR (FULL DEPTH, TYPE II)	SQ YD	21
Z0030250	IMPACT ATTENUATORS, TEMPORARY (NON-REDIRECTIVE), TEST LEVEL 3	EACH	1
Z0030350	IMPACT ATTENUATORS, RELOCATE (NON-REDIRECTIVE), TEST LEVEL 3	EACH	1
Z0041895	POLYMER CONCRETE	CU FT	5.8

*Specialty Items

FILE NAME =	USER NAME = ha.steadtw	DESIGNED -	REVISED -	STATE OF ILLINOIS DEPARTMENT OF TRANSPORTATION	SUMMARY OF QUANTITIES	F.A.I. RTE.	SECTION	COUNTY	TOTAL SHEETS	SHEET NO.	
cc:\pw\work\p\wdct\ha\steadtw\100235582\1120-0008-0009_sht-plm.dgn	PLLOT SCALE = 50.0000 1/4 IN.	DRAWN -	REVISED -			57	D9 BSMART 2011-1	WILLIAMSON	11	3	
	PLLOT DATE = 9/28/2010	CHECKED -	REVISED -			SHEET NO. OF SHEETS		CONTRACT NO. 78226			
		DATE -	REVISED -			ILLINOIS FED. AID PROJECT					

Rev.

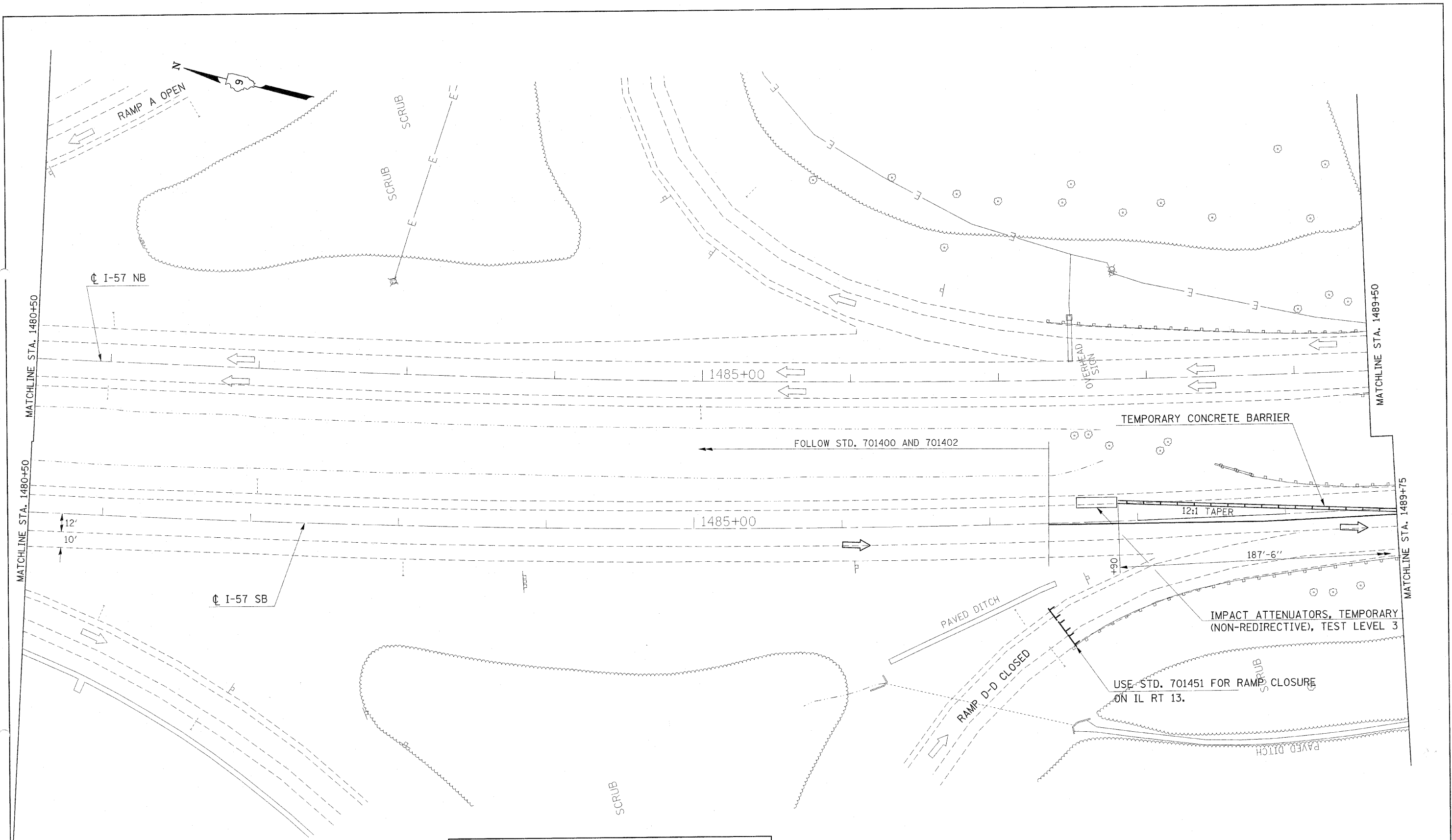

NOTE: SEE STANDARDS 701402, 701451, AND 701400 FOR ADDITIONAL REQUIREMENTS.

FILE NAME =	USER NAME = halsteadtw	DESIGNED - TWH	REVISED -
ct:\pw\work\p\dot\halsteadtw\02295983\10-0008-0009_sht-trafcon.dgn		DRAWN - TWH	REVISED -
		CHECKED - MAS	REVISED -
		DATE - 8/30/10	REVISED -

**STATE OF ILLINOIS
DEPARTMENT OF TRANSPORTATION**

STAGE 1 TRAFFIC				
SCALE:	SHEET NO.	OF	SHEETS	STA. TO STA.

F.A.I. RTE.	SECTION	COUNTY	TOTAL SHEETS	SHEET NO.
57	D9 BSMART 2011-1	WILLIAMSON	11	4
ILLINOIS FED. AID PROJECT				
CONTRACT NO. 78226				

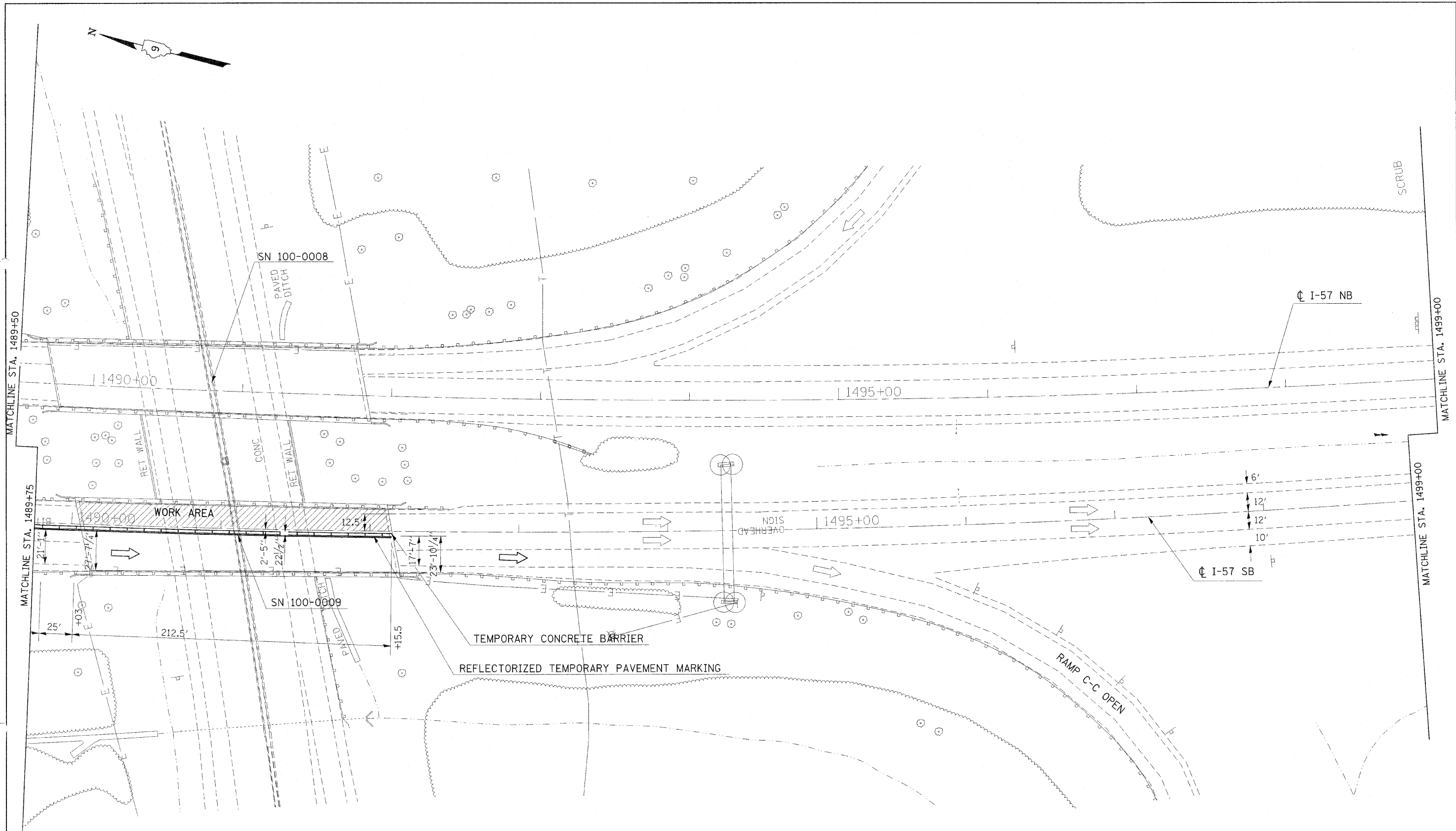

NOTE: SEE STANDARDS 701402 AND 701400 FOR ADDITIONAL REQUIREMENTS.

FILE NAME =
c:\work\pilot\halstead\100-0008-0009.sht-traffic.dgn

USER NAME = halsteadw
PLOT SCALE = 30,000 / IN.
PLOT DATE = 9/28/2010

DESIGNED - TWH
DRAWN - TWH
CHECKED - MAS
DATE - 8/30/10

REVISED -
REVISED -
REVISED -
REVISED -

**STATE OF ILLINOIS
DEPARTMENT OF TRANSPORTATION**

STAGE 1 TRAFFIC
SCALE: SHEET NO. OF SHEETS STA. TO STA.

F.A.I. RTE.	SECTION	COUNTY	TOTAL SHEETS	SHEET NO.
57	D9 BSMART 2011-1	WILLIAMSON	11	5
CONTRACT NO. 78226				
ILLINOIS FED. AID PROJECT				

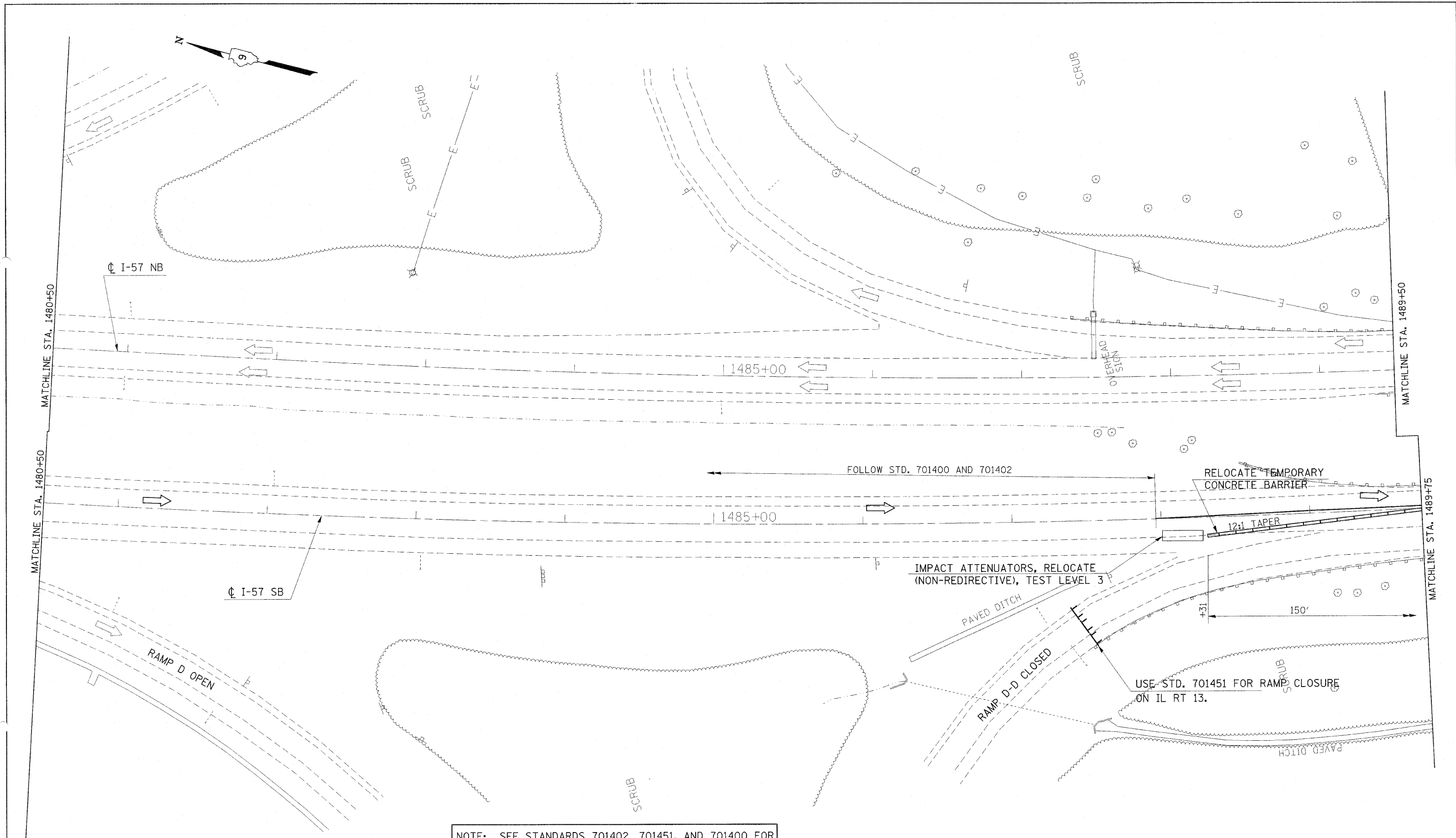

NOTE: SEE STANDARDS 701402, 701451, AND 701400 FOR ADDITIONAL REQUIREMENTS.

FILE NAME = c:\pwork\pwidot\halsteadw\d0235583\10	USER NAME = halsteadw 0-0008-0009_sht-01.dgn	DESIGNED - TWH DRAWN - TWH	REVISED - REVISED -	STATE OF ILLINOIS DEPARTMENT OF TRANSPORTATION	STAGE 2 TRAFFIC			F.A.I. RTE. 57	SECTION D9 BSMART 2011-1	COUNTY WILLIAMSON	TOTAL SHEETS 11	SHEET NO. 6
	PLOT SCALE = 30.0000' / IN. PLOT DATE = 9/28/2010	CHECKED - MAS DATE - 8/30/10	REVISED - REVISED -		SCALE:	SHEET NO.	OF	SHEETS	STA.	TO STA.	ILLINOIS FED. AID PROJECT CONTRACT NO. 78226	

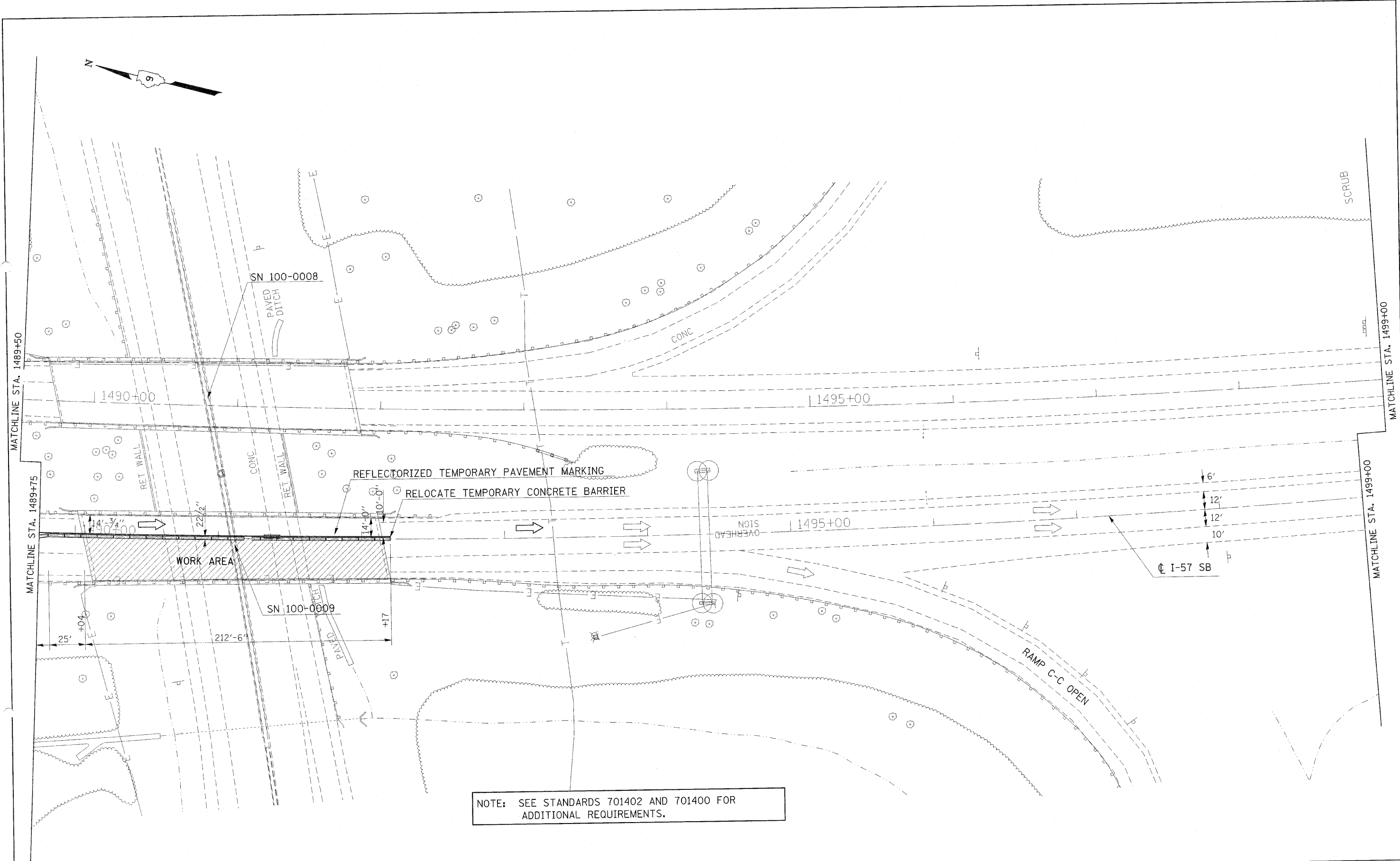

NOTE: SEE STANDARDS 701402 AND 701400 FOR ADDITIONAL REQUIREMENTS.

FILE NAME = c:\pwwork\pudoc\halseedtw\0235583\100-0009-0009_sht-traffic.dgn	USER NAME = halseedtw	DESIGNED - TWH	REVISED -	STATE OF ILLINOIS DEPARTMENT OF TRANSPORTATION	STAGE 2 TRAFFIC				F.A.I. RTE. 57	SECTION D9 BSMART 2011-1	COUNTY WILLIAMSON	TOTAL SHEETS 11	SHEET NO. 7
	PLOT SCALE = 30.0000 / IN. PLOT DATE = 9/20/2010	DRAWN - TWH CHECKED - MAS DATE - 8/30/10	REVISED - REVISED - REVISED - REVISED -		SCALE:	SHEET NO. OF SHEETS STA. TO STA.	ILLINOIS FED. AID PROJECT CONTRACT NO. 78226						

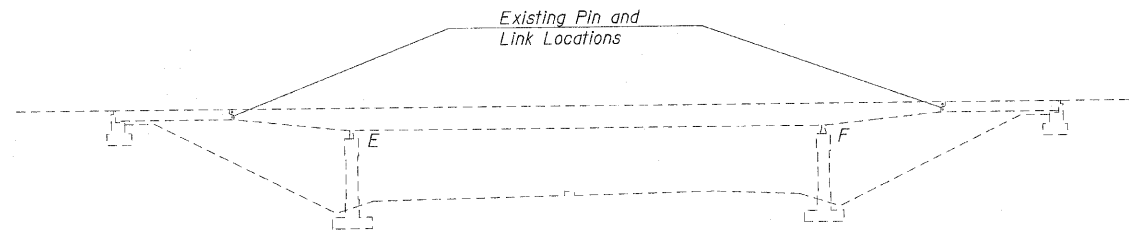

ELEVATION

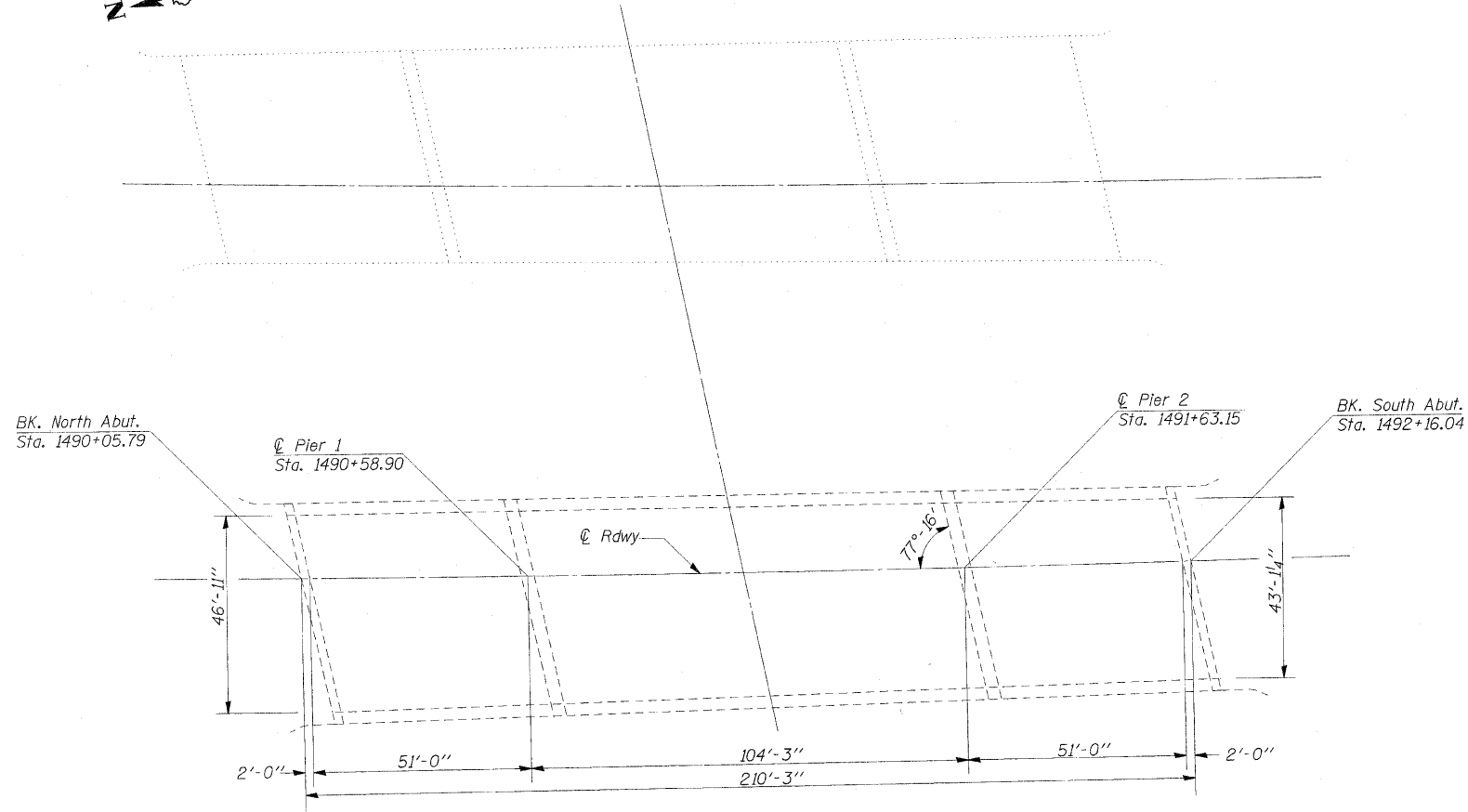

PLAN

Design Stresses

FIELD UNITS (Existing Construction)
 $f_c = 1,400$ psi (super & sub.)
 $f_s = 18,000$ psi (structural steel)
 $f_s = 20,000$ psi (reinforcement)
 $V_{max} = 75$ psi (Ftgs.)
 $n = 10$



Expires 11/30/2012

GENERAL NOTES

Plan dimensions and details relative to existing plans are subject to nominal construction variations. The Contractor shall field verify existing dimensions and details affecting new construction and make necessary approved adjustments prior to construction or ordering of materials. Such variations shall not be cause for additional compensation for a change in scope of the work, however, the Contractor will be paid for the quantity actually furnished at the unit price bid for the work.

The existing structural steel coating contains lead. The Contractor shall take appropriate precautions to deal with the presence of lead on this project.

TOTAL BILL OF MATERIAL

ITEM	UNIT	QUANTITY
Bridge Deck Grooving	Sq. Yd.	998
HMA Surface Removal (Asbestos)	Sq. Yd.	1030
Bridge Deck Microsilica Concrete Overlay 3"	Sq. Yd.	1030
Bridge Deck Hydro-Scarification 3/4"	Sq. Yd.	1030
Deck Slab Repair (Full Depth, Type I)	Sq. Yd.	1
Deck Slab Repair (Full Depth, Type II)	Sq. Yd.	21
Polymer Concrete	Cu. Ft.	5.8
Protective Coat	Sq. Yd.	1030

BRIDGE REPAIR
 FAI RT 57 OVER
 IL RTE. 13
 WILLIAMSON COUNTY
 STA. 1491+10.38
 SN 100-0009 (SB)

FILE NAME = c:\pwwork\pwwork\haldstead\10235583\102-0008-0009.sht-plan.dgn	USER NAME = haldsteadw	DESIGNED - TWH	REVISED -	STATE OF ILLINOIS DEPARTMENT OF TRANSPORTATION	GENERAL PLAN & ELEVATION	F.A.I. RTE. 57	SECTION D9 BSMART 2011-1	COUNTY WILLIAMSON	TOTAL SHEETS 11	SHEET NO. 8
	PLOT SCALE = 20,000 / IN. PLOT DATE = 9/20/2010	DRAWN - TWH CHECKED - MAS DATE - 8/10/10	REVISED - REVISED - REVISED -			SCALE:	SHEET NO. 1 OF 4 SHEETS	STA. TO STA.	ILLINOIS FED. AID PROJECT CONTRACT NO. 78226	

STAGING TYPICAL SECTION - 100-0009

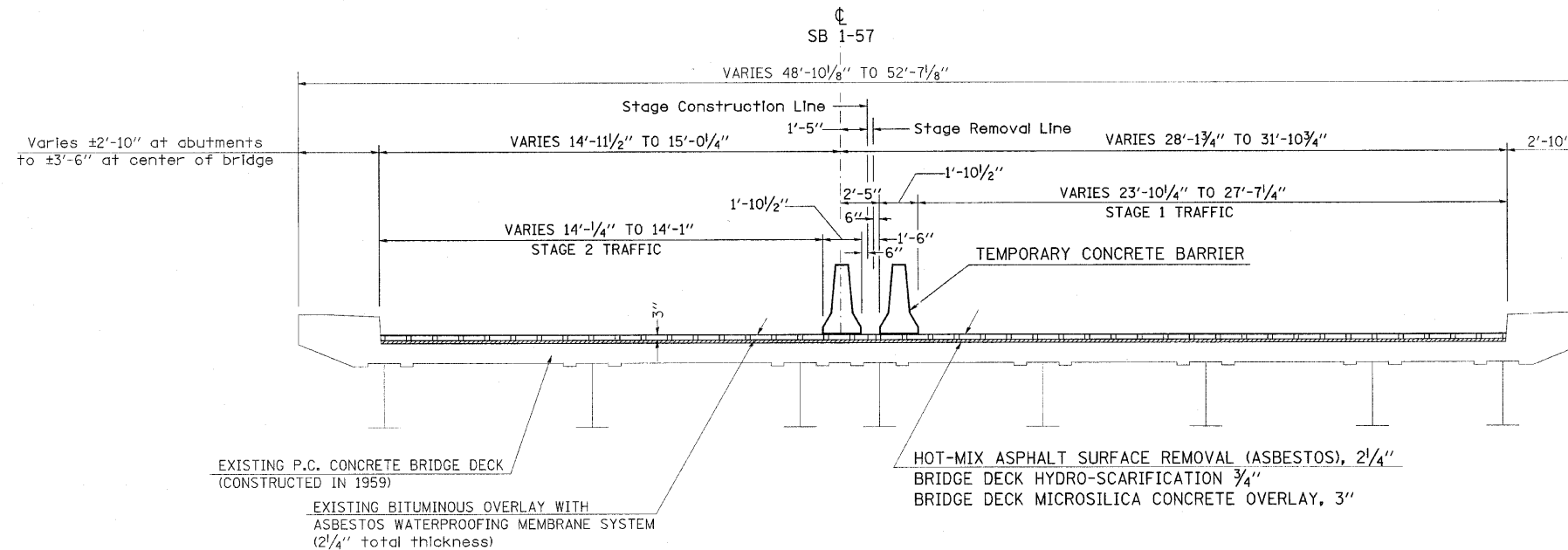

STAGING - TYPICAL SECTION

100-0009

(LOOKING SOUTH)

TO BE USED:

BK. ABUT. STA. 1490+05.79 TO BK. ABUT. STA. 1492+16.04 @ SB 1-57

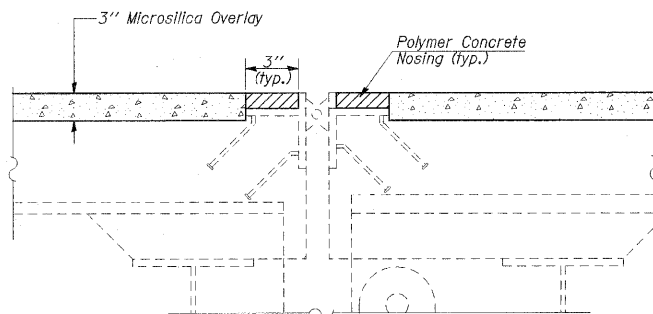

TYPICAL SECTION AT EXPANSION JOINTS

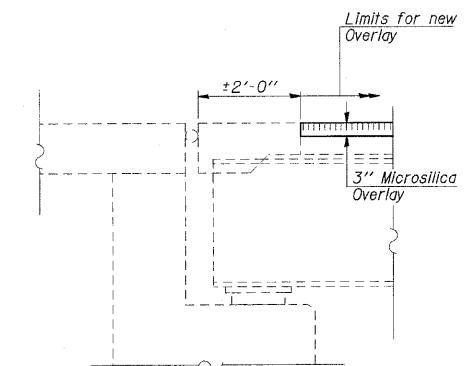

TYPICAL SECTION AT ABUTMENTS

FILE NAME =	USER NAME = halsteadtw	DESIGNED - TWH	REVISED -	STATE OF ILLINOIS DEPARTMENT OF TRANSPORTATION	TYPICAL STAGING SECTION	F.A.I. RTE.	SECTION	COUNTY	TOTAL SHEETS	SHEET NO.
c:\pw\work\pwwork\halsteadtw\d0235583\100-0200-0009.sht-traffic.dgn		DRAWN - TWH	REVISED -			57	D9 BSMART 2011-1	WILLIAMSON	11	9
	PLOT SCALE = 50,0000' / IN.	CHECKED - MAS	REVISED -		SCALE:					
	PLOT DATE = 9/20/2010	DATE - 8/30/10	REVISED -		SHEET NO. 2 OF 4 SHEETS	STA.	TO STA.			
										ILLINOIS FED. AID PROJECT
										CONTRACT NO. 78226

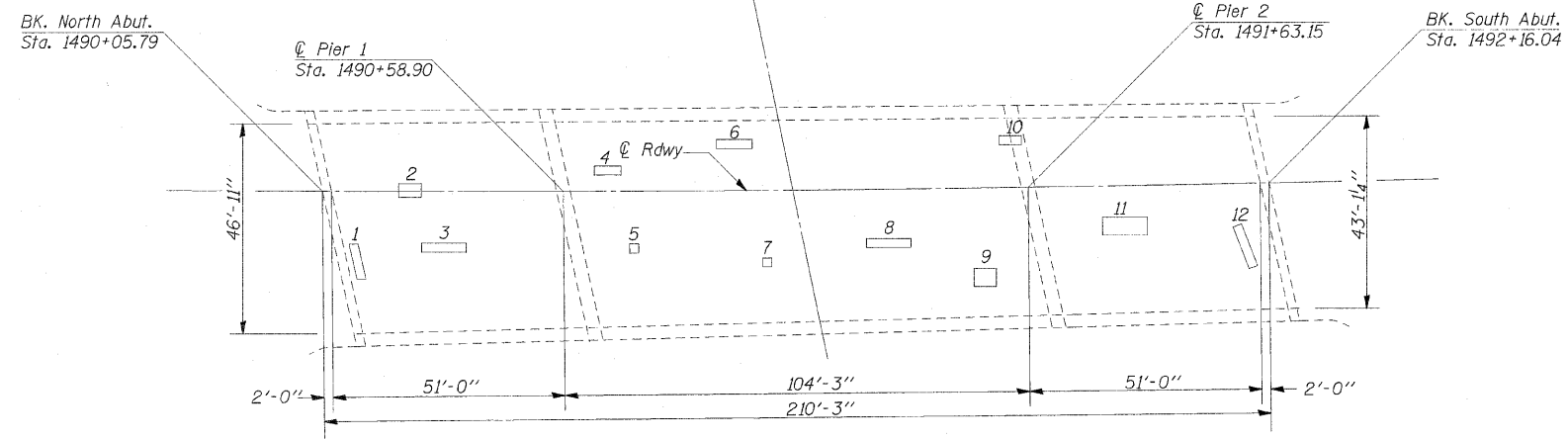

PLAN

NUMBER	LENGTH (FT)	WIDTH (FT)	AREA (SQ YD)
1	8	2	1.8
2	5	3	1.7
3	10	2	2.2
4	6	2	1.3
5	2	2	0.4
6	8	2	1.8
7	2	2	0.4
8	10	2	2.2
9	5	4	2.2
10	5	2	1.1
11	10	4	4.5
12	10	2	2.2

* Indicates Type I patches

Notes: Deck Survey was performed in June 2010
 The Resident Engineer will determine final patch locations and quantities in the field before bridge deck patching operations begin.
 Areas of deck repairs shown are estimated. The Engineer shall show actual locations of deck repairs on As-built Plans.
 The existing protective shield shall remain in place.

BILL OF MATERIAL

Item	Unit	Total
Deck Slab Repair (Full Depth, Type I)	Sq Yd	1
Deck Slab Repair (Full Depth, Type II)	Sq Yd	21

**DECK SLAB REPAIRS
 WILLIAMSON COUNTY
 STRUCTURE NO. 100-0009 (S.B.)**

FILE NAME =	USER NAME = halsteadtw	DESIGNED - TWH	REVISED -	STATE OF ILLINOIS DEPARTMENT OF TRANSPORTATION	DECK SLAB REPAIRS	F.A.I. RTE.	SECTION	COUNTY	TOTAL SHEETS	SHEET NO.
ct:\pwork\pwork\halsteadtw\100-0009-0209.sht-plan.dgn	DRAWN - TWH	REVISED -	57			D9 BSMART 2011-1	WILLIAMSON	11	10	
PLOT SCALE = 20.0000' / IN.	CHECKED - MAS	REVISED -	CONTRACT NO. 78226							
PLOT DATE = 9/28/2010	DATE - 8/10/10	REVISED -	ILLINOIS FED. AID PROJECT							
				SCALE: SHEET NO. 3 OF 4 SHEETS STA. TO STA.						

