

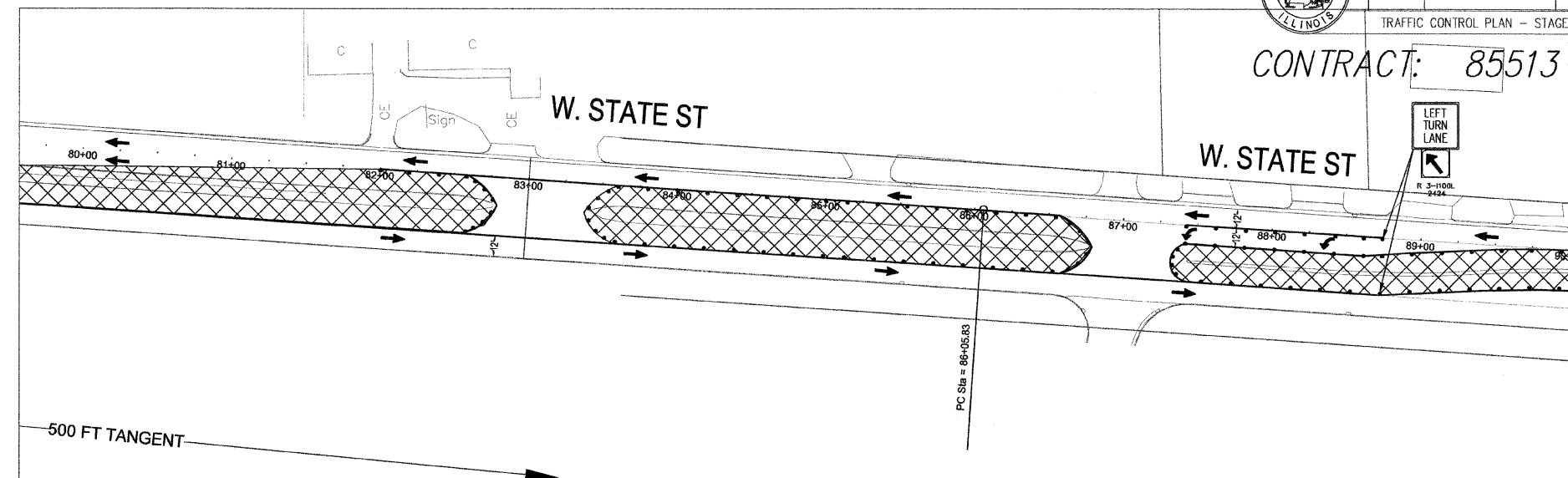

CONTRACT: 85513

MATCHLINE STA. 90+00

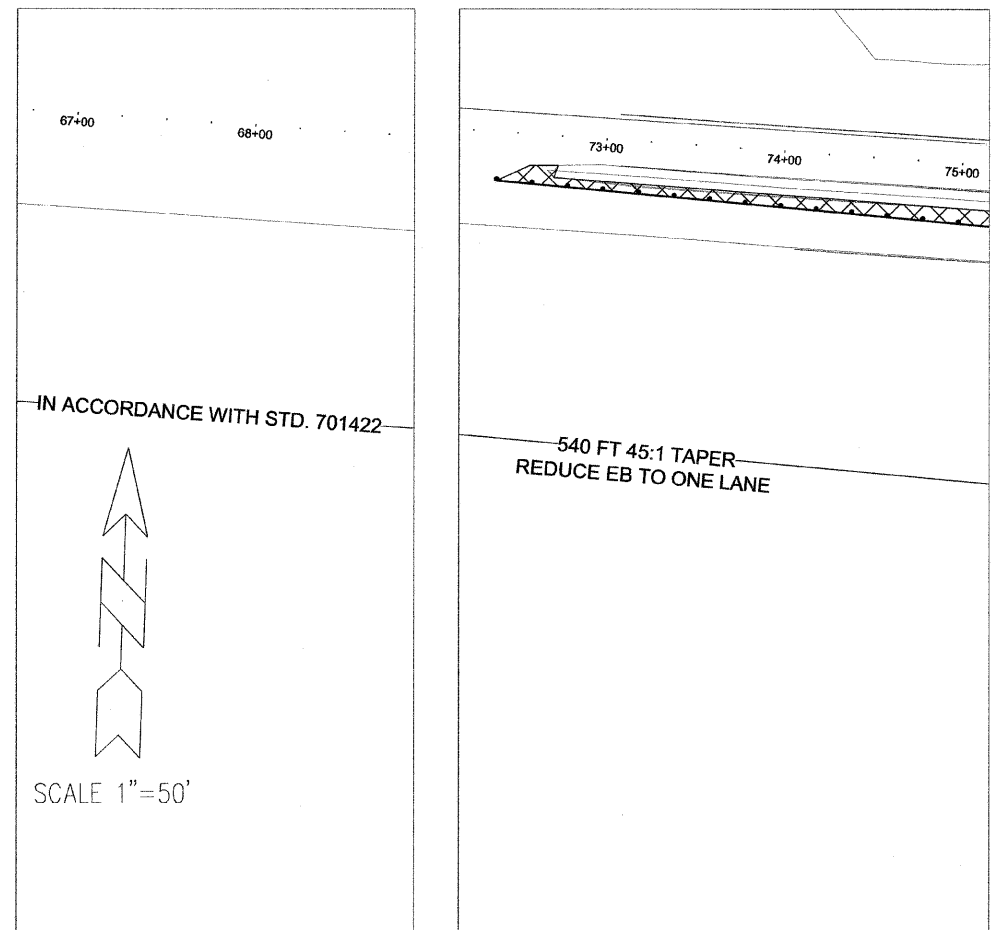

- STAGE I
1. RELOCATE OR COVER EXISTING REGULATORY SIGNS AS APPLICABLE
  2. PLACE SIGNING, FLAGGERS AND TRAFFIC CONTROL DEVICES PER STD. 701422, 701701, 701901, 701922 AND IDOT DIST II DETAIL # 94.2 (ALL TEMPORARY TRAFFIC CONTROL PLACEMENT BASED ON 45 MPH DESIGN)
  3. REMOVE & RECONSTRUCT MEDIAN IN AREAS SHOWN, CLOSE SIDE ROADS AS DIRECTED BY ENGINEER
  4. POST AN ADVISORY SPEED LIMIT OF 35 MPH THROUGH CONSTRUCTION AREA

MATCHLINE STA. 90+00

