

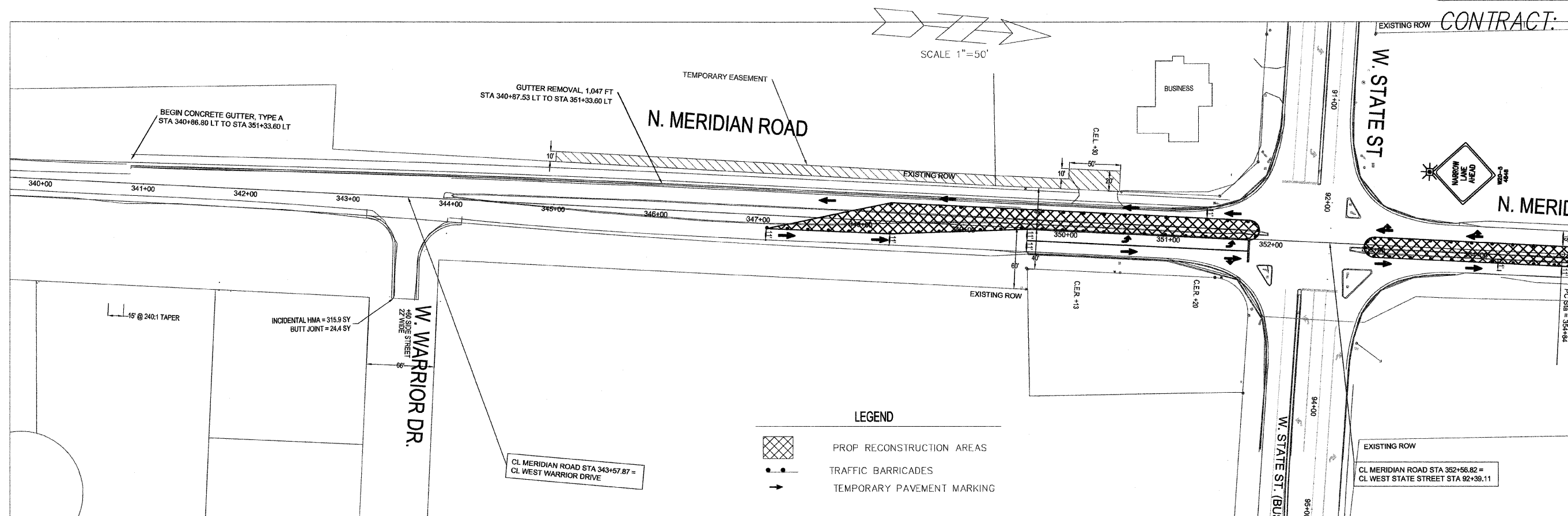

CONTRACT: 85513

MATCHLINE STA. 355+00



LEGEND

- PROP RECONSTRUCTION AREAS
- TRAFFIC BARRICADES
- TEMPORARY PAVEMENT MARKING

MATCHLINE STA. 355+00

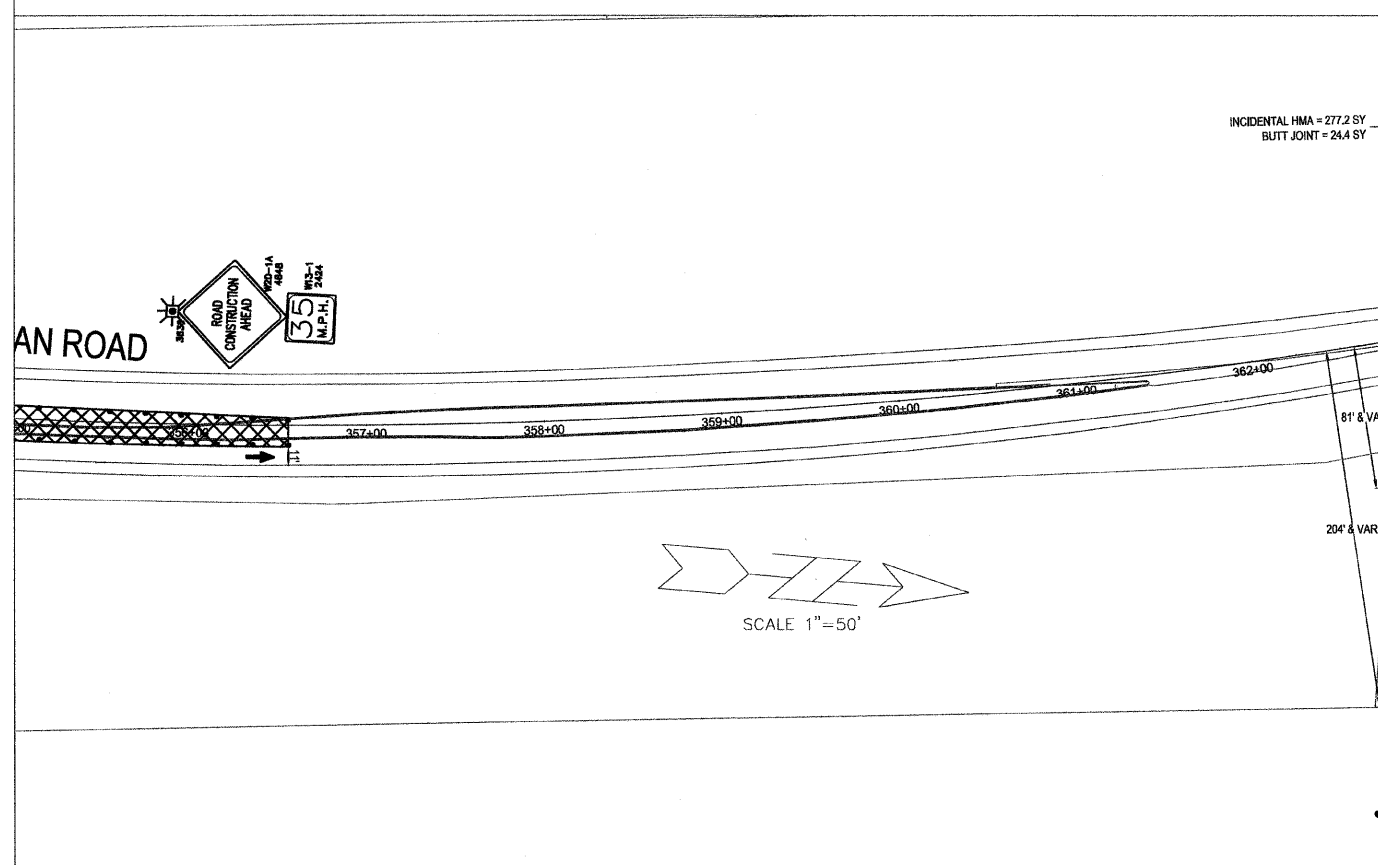

STAGE II PHASE II

1. RELOCATE OR COVER EXISTING REGULATORY SIGNS AS APPLICABLE
2. PLACE SIGNING, FLAGGERS AND TRAFFIC CONTROL DEVICES PER STD. 701701 AND AS SHOWN (ALL TEMPORARY TRAFFIC CONTROL PLACEMENT BASED ON 45 MPH DESIGN)
3. REMOVE & RECONSTRUCT EXISTING MEDIAN CURB IN AREAS SHOWN, CLOSE SIDE ROADS AS DIRECTED BY ENGINEER
4. POST AN ADVISORY SPEED LIMIT OF 35 MPH THROUGH CONSTRUCTION AREA

STAGE III

1. RELOCATE OR COVER EXISTING REGULATORY SIGNS AS APPLICABLE
2. PLACE SIGNING, FLAGGERS AND TRAFFIC CONTROL DEVICES PER STD. 701701
3. REMOVE CORNER ISLANDS AND EXISTING TRAFFIC SIGNALS AT THE INTERSECTION USING STD. 701701.
4. POST AN ADVISORY SPEED LIMIT OF 35 MPH THROUGH CONSTRUCTION AREA