

SCALE:
PLAN: 1" = 30'
0 30 60
Scale in Feet

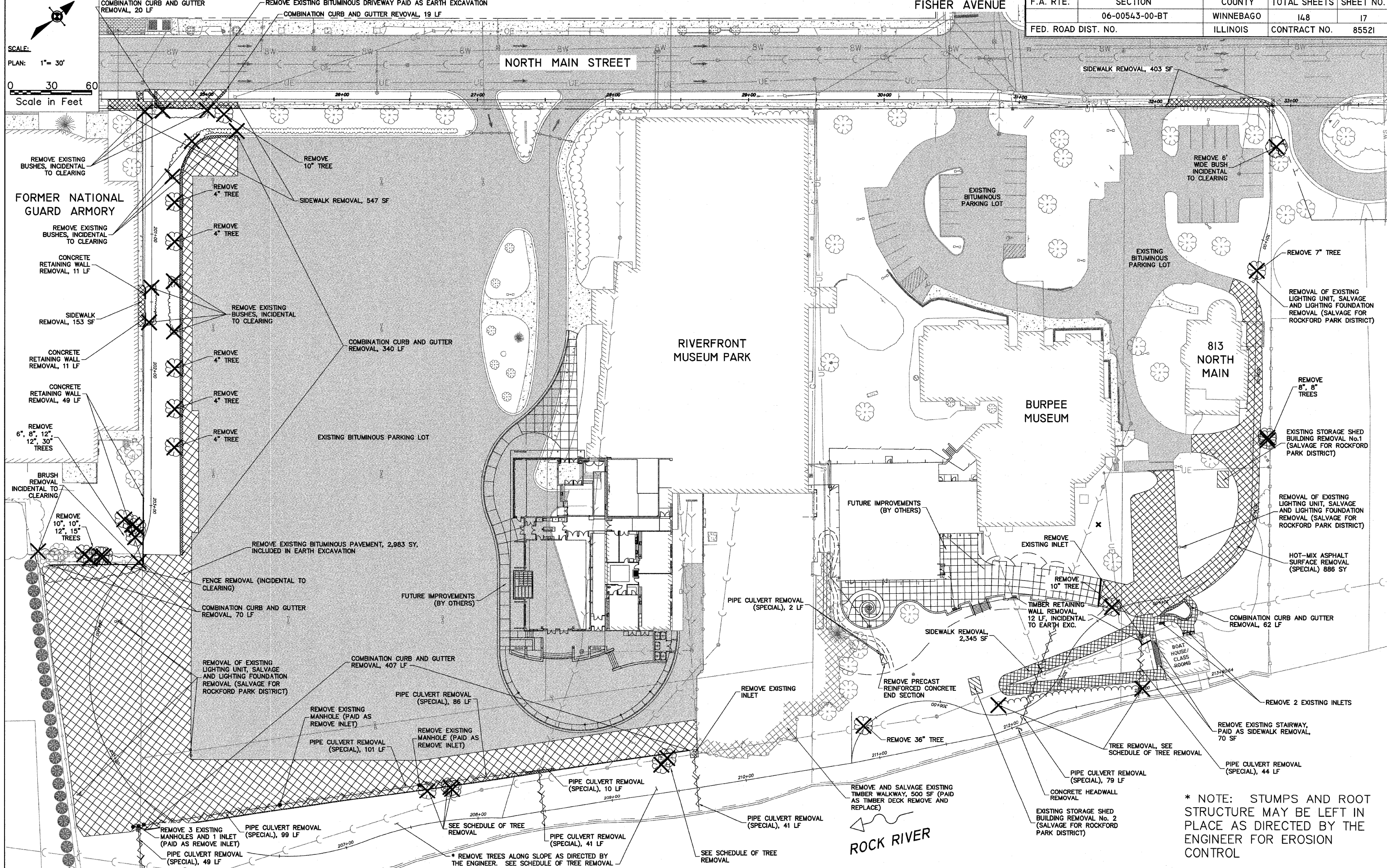

* NOTE: STUMPS AND ROOT STRUCTURE MAY BE LEFT IN PLACE AS DIRECTED BY THE ENGINEER FOR EROSION CONTROL

SHEET REVIEW	
AGENCY	DATE

REVISIONS			
NO.	ITEM	DATE	

SCALE: Hor. 1"=30'
DRAWN BY: MS
CHECKED BY: JWH
DATE: AUGUST 13, 2010

McClure
Engineering Associates, Inc.
7282 Argus Drive Rockford, Illinois 61107-5837
(615) 398-2332 FAX (615) 398-2496
Design Firm License: Illinois 184-000816
Copyright 2010 By McClure Engineering Associates, Inc.

REMOVAL PLAN
RIVERWALK MUSEUM CAMPUS
711 NORTH MAIN STREET ROCKFORD, IL
FILE: H:\08-008 RIVERWALK MUSEUM\DESIGN\DRAWINGS\08-008 REMOVAL PLAN.DWG JOB: 08-28-10-008

H:\08-008 RIVERWALK MUSEUM\DESIGN\DRAWINGS\08-008 REMOVAL PLAN.DWG, REMOVAL PLAN, 11/1/2010 3:37:59 PM, 11, JWH