

INDEX OF SHEETS

1. TITLE SHEET
2. GENERAL NOTES AND UTILITY CONTACTS
3. SUMMARY OF QUANTITIES
4. SCHEDULES OF QUANTITIES
5. TYPICAL SECTIONS
6. ALIGNMENTS, TIES AND BENCHMARKS
7. REMOVAL PLANS
8. PLAN AND PROFILE
9. MULTI-USE PATH PLAN AND SECTION
10. MISCELLANEOUS ROADWAY DETAILS
- 11 - 13. EROSION CONTROL PLAN
- 14 - 15. DETOUR ROUTE AND ROAD CLOSURE
- 16 - 62. BRIDGE PLANS (INCLUDING BORING LOGS AND EXISTING DRAWINGS)
- 63 - 66. CROSS SECTIONS

LIST OF STANDARDS

- | | |
|-----------|---|
| 280001-05 | TEMPORARY EROSION CONTROL SYSTEMS |
| 420401-08 | BRIDGE APPROACH PAVEMENT CONNECTOR |
| 515001-03 | NAME PLATE FOR BRIDGES |
| 542401-01 | METAL END SECTIONS FOR PIPE CULVERTS |
| 601101-01 | CONCRETE HEADWALL FOR PIPE DRAIN |
| 606001-04 | CONCRETE CURB TYPE B AND COMBINATION CONCRETE CURB AND GUTTER |
| 609006-05 | BRIDGE APPROACH PAVEMENT (DRAIN DETAIL) |
| 610001-05 | SHOULDER INLET WITH CURB |
| 630001-09 | STEEL PLATE BEAM GUARDRAIL |
| 631026-05 | TRAFFIC BARRIER TERMINAL TYPE 5 |
| 631031-09 | TRAFFIC BARRIER TERMINAL TYPE 6 |
| 635006-03 | REFLECTOR AND TERMINAL MARKER PLACEMENT |
| 635011-02 | REFLECTOR MARKER AND MOUNTING DETAILS |
| 664001-02 | CHAIN LINK FENCE |
| 701006-03 | OFF-RD OPERATIONS, 2L, 2W, 15' TO 24' FROM PAVEMENT EDGE |
| 701201-04 | LANE CLOSURE, 2L, 2W, DAY ONLY, FOR SPEEDS 45 MPH |
| 701301-04 | LANE CLOSURE, 2L, 2W, SHORT TIME OPERATIONS |
| 701311-03 | LANE CLOSURE, 2L, 2W MOVING OPERATIONS - DAY ONLY |
| 701901-01 | TRAFFIC CONTROL DEVICES |
| 720001-01 | SIGN PANEL MOUNTING DETAILS |
| 720006-02 | SIGN PANEL ERECTION DETAILS |
| 720011-01 | METAL POSTS FOR SIGN, MARKERS & DELINEATORS |
| 728001-01 | TELESCOPING STEEL SIGN SUPPORTS |
| 729001-01 | APPLICATIONS OF TYPES A AND B METAL POSTS (FOR SIGNS AND MARKERS) |
| 731001-01 | BASE FOR TELESCOPING STEEL SIGN SUPPORT |
| 780001-02 | TYPICAL PAVEMENT MARKINGS |
| BLR 21-8 | TYPICAL APPLICATION OF TRAFFIC CONTROL DEVICES FOR CONSTRUCTION ON RURAL LOCAL HIGHWAYS |
| BLR 22-6 | TYPICAL APPLICATION OF TRAFFIC CONTROL DEVICES FOR CONSTRUCTION ON RURAL LOCAL HIGHWAYS (2L, 2W, ROAD CLOSED TO THRU TRAFFIC) |

STATE OF ILLINOIS
DEPARTMENT OF TRANSPORTATION
DIVISION OF HIGHWAYS
PLANS FOR PROPOSED
MAJOR BRIDGE PROGRAM
F.A.U. ROUTE 5103 (KISHWAUKEE ROAD)
OVER KISHWAUKEE RIVER
SECTION 03-00337-00-BR
WINNEBAGO COUNTY
PROJECT BRM-5099(080)
JOB NUMBER C-92-096-09
CONTRACT NO. 85523



LOCATION OF SECTION INDICATED THUS: - ■ -

APPROVED *October 26/2010*
 COUNTY ENGINEER

PASSED *Nov. 16 2010*
 DISTRICT ENGINEER OF LOCAL ROADS & STREET

RELEASING FOR BID BASED ON LIMITED REVIEW *Nov. 16 2010*
 DEPUTY DIRECTOR OF HIGHWAYS REGION 2 ENGINEER

STATE OF ILLINOIS
DEPARTMENT OF TRANSPORTATION

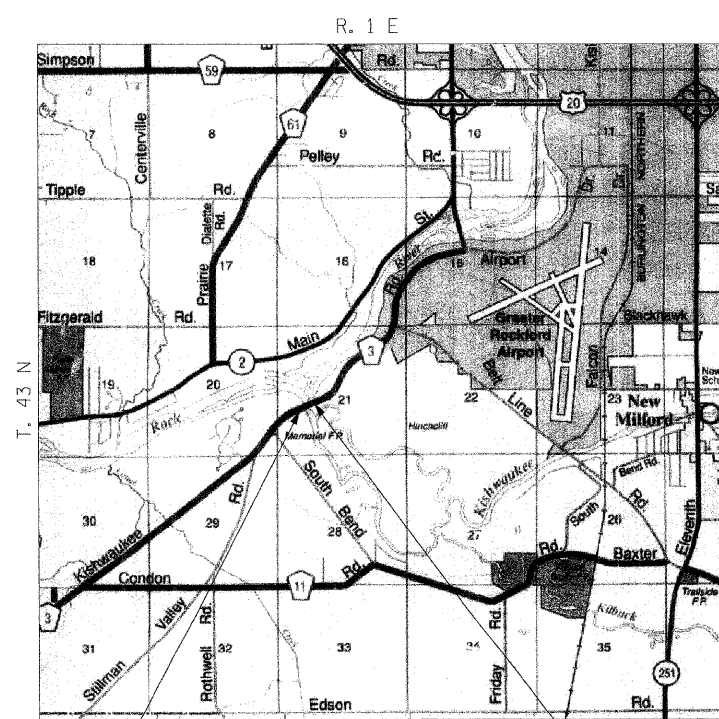

IMPROVEMENT ENDS STATION 93+85
 3rd P.M.
 IMPROVEMENT BEGINS STATION 83+50

LOCATION PLAN

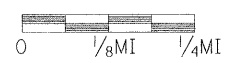

SCALE OF LAYOUT
 NET LENGTH = 1035 FEET (0.20 MI)

TRAFFIC DATA
 HIGHWAY CLASSIFICATION: MINOR ARTERIAL (URBAN)
 2010 ADT: 6,400
 2030 ADT: 8,600
 5% TRUCKS
 DESIGN SPEED: 55 MPH
 POSTED SPEED: 55 MPH

PROPOSED IMPROVEMENTS
 REMOVAL AND REPLACEMENT OF THE EXISTING BRIDGE CARRYING F.A.U. ROUTE 5103 (KISHWAUKEE ROAD) OVER KISHWAUKEE RIVER AT STATION 88+44. NEW BRIDGE CONSISTS OF A THREE-SPAN COMPOSITE CONTINUOUS WELDED STEEL PLATE GIRDER SUPERSTRUCTURE SUPPORTED ON PILE BENT ABUTMENTS AND CONCRETE WALL PIERS. EXISTING STRUCTURE NUMBER 101-3018. PROPOSED STRUCTURE NUMBER 101-3100.

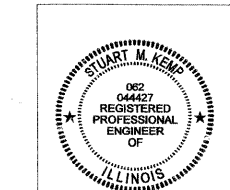

Stuart M. Kemp
 SIGNATURE
 10/26/10
 DATE
 L.C. EXP. DATE: 11/30/11

J.U.L.I.E.
JOINT UTILITY LOCATION
INFORMATION FOR EXCAVATION
1-800-892-0123 OR 811



UTILITY NOTE

THE LOCATIONS OF THOSE BURIED AND ABOVEGROUND UTILITIES SHOWN ARE APPROXIMATE, ARE SHOWN FOR CONTRACTOR INFORMATIONAL USE ONLY, AND ARE NOT TO BE REFERENCED FOR CONSTRUCTION PURPOSES. THE IMPLIED PRESENCE OR ABSENCE OF UTILITIES IS NOT TO BE CONSTRUED BY THE OWNER, ENGINEER, CONTRACTOR, OR SUBCONTRACTORS TO BE AN ACCURATE AND COMPLETE REPRESENTATION OF UTILITIES THAT MAY OR MAY NOT EXIST ON THE CONSTRUCTION SITE. BURIED AND ABOVEGROUND UTILITY LOCATION, IDENTIFICATION, AND MARKING ARE THE SOLE RESPONSIBILITY OF THE CONTRACTOR. REROUTING, DISCONNECTION, PROTECTION, ETC. OF ANY UTILITIES MUST BE COORDINATED AMONG THE CONTRACTOR, UTILITY COMPANY, AND OWNER. SITE SAFETY, INCLUDING THE AVOIDANCE OF HAZARDS, ASSOCIATED WITH BURIED AND ABOVEGROUND UTILITIES REMAIN THE SOLE RESPONSIBILITY OF THE CONTRACTOR.

03R1807	© Copyright Hanson Professional Services Inc. 2009	F.A.U. ROUTE	SECTION	COUNTY	TOTAL SHEETS	SHEET NO.
10/26/10		5103	03-00337-00-BR	Winnebago	66	1
						CONTRACT NO. 85523
FED. ROAD DIST. NO. 2 ILLINOIS FED. AID PROJECT						

Corporate License Number 184-001-084

10/26/2010
 I:\03\030337\0807_Struct\Sheet\5-000-711e.dgn
 LAYOUT
 DRAWN
 REVIEWED
 SMK
 MGM
 SMK
 01/28/10
 01/28/10
 01/28/10