

8.19' in top of Concrete Parapet of W. Abutment of the existing bridge - US 50 mark 14.75.11  
 Existing Bridge two Steel Truss Spans 18'9" & 18'6" - 4" Wood Floor Superstructure.  
 Stone Masonry Pier & abutments to be removed - see special provisions and sheet 7 of the plans.

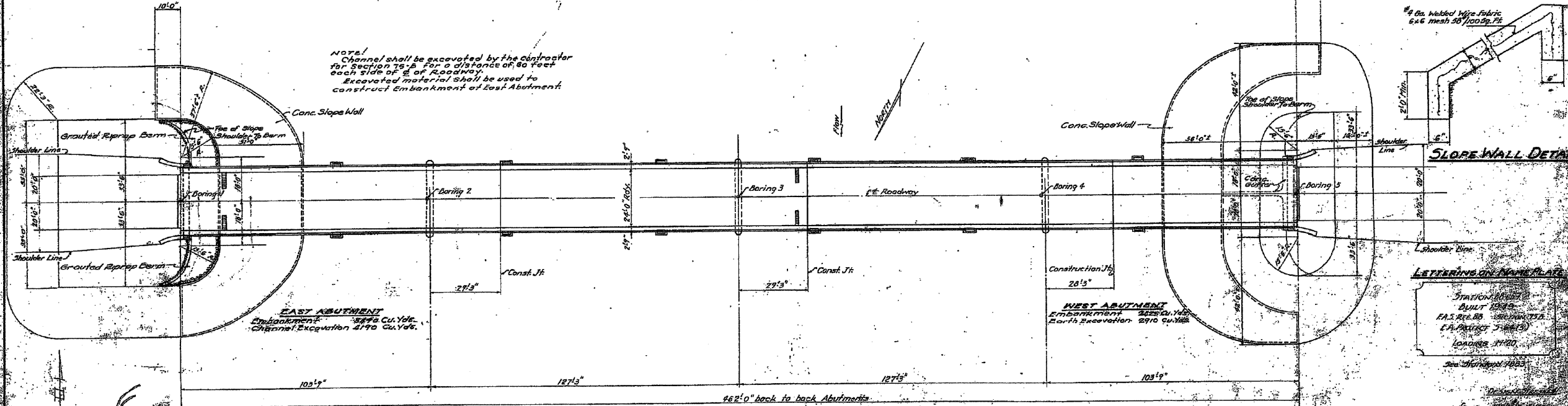
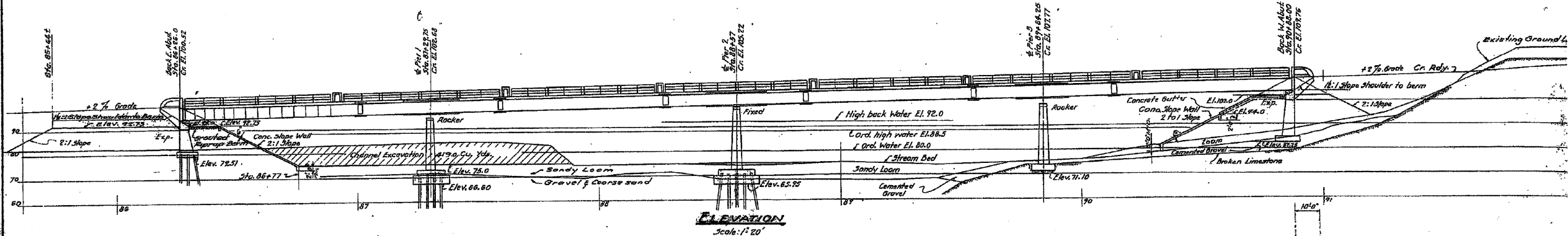

NOTE:  
 Channel shall be excavated by the contractor for Section 75-B for a distance of 80 feet each side of E of Roadway.  
 Excavated material shall be used to construct Embankment of East Abutment.

SLOPE WALL DETAIL

LETTERING ON NAME PLATE

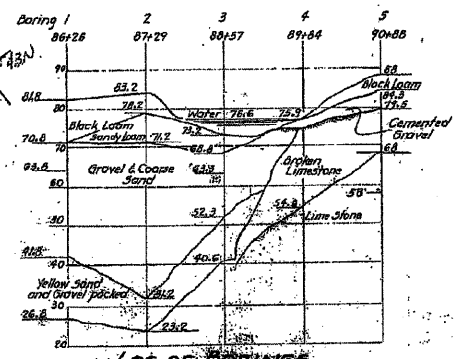
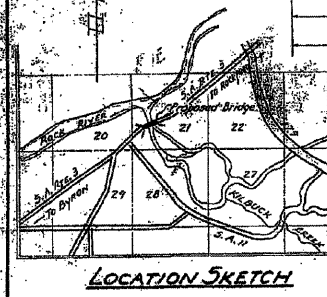

BILL OF MATERIAL

ITEM	UNIT	QUANT.	UNIT PRICE	TOTAL
Class 'C' Concrete	Cu Yds	3425.5	120.00	411,060.00
Class 'A' Concrete	Cu Yds	682.1	80.00	54,568.00
Structural Steel	Lbs.	276,990	2.50	692,475.00
Reinforcement Bars	Lbs.	66,820	1.20	80,184.00
Handrail Concrete	Cu Yds	4.1	5.2	21.32
Untreated Piling (25' long)	Lin Ft.	3,310	1.50	4,965.00
Untreated Test Piles	Each	4	1.00	4.00
Slope Wall	Sq Yds	1,000	1.00	1,000.00
Channel Excavation	Cu Yds	1,190	1.00	1,190.00
Removal Existing Structure	Each	1	1.00	1.00
Tree Removal	Wches	2.2	1.00	2.20
C&G Frames & Grapes	Each	1	1.00	1.00
Gravel for Paving	Cu Yds	1	1.00	1.00
Gravel for Excavation	Cu Yds	877	1.00	877.00
Steel Deck Concrete	Cu Yds	196.0	1.00	196.00
Wagon Plates	Each	1	1.00	1.00
Gravel for Paving	Cu Yds	1	1.00	1.00
Treated Piling (25' long)	Lin Ft.	1	1.00	1.00

GENERAL NOTES

Class 'C' Concrete shall be used throughout except in Rail Piles & Piers 1 & 2. Class 'A' Concrete shall be used in Piers 2 & 3. The concrete floor shall be poured in one continuous pour between construction joints shown and shall be finished in accordance with Art. 61.3 (c) of the Standard Specifications. No additional concrete joints will be allowed without the written permission of the Engineer. All concrete shall be used in Piers & Abutments. All concrete shall be finished in accordance with Art. 61.3 (c) of the Standard Specifications. All concrete shall be finished in accordance with Art. 61.3 (c) of the Standard Specifications. All concrete shall be finished in accordance with Art. 61.3 (c) of the Standard Specifications.

PROFILE OF ROADWAY AT BRIDGE

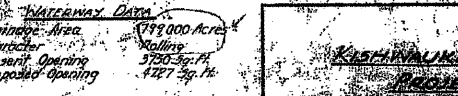

APPROVED: [Signature]  
 COUNTY SUPERVISOR FOR HIGHWAYS  
 EXAMINED: [Signature]  
 BRIDGE ENGINEER  
 PASSED: [Signature]  
 COUNTY ENGINEER  
 APPROVED: [Signature]  
 COUNTY ENGINEER  
 Revised 12/19/14 Supplement Pay Items

ALFRED BENESCH & ASSOCIATES  
 CONSULTING ENGINEERS

KISHNAWAKE RIVER BRIDGE  
 REGIONAL J. C. G. S.  
 HANSON PROFESSIONAL SERVICES INC.  
 SECTION 75-B  
 WINNEBAGO COUNTY  
 STATION 114.75

FOR REFERENCE ONLY

EXISTING DRAWING  
 STRUCTURE NUMBER 101-3100

PROFESSIONAL DESIGN FIRM LICENSE #184-001084

© Copyright Hanson Professional Services Inc. 2010



JOB NO. 03R1807  
 DATE 10/26/10

SHEET NO. 38  
 47 SHEETS

F.A.U. RTE. 5103

SECTION 03-00337-00-BR

COUNTY Winnebago

TOTAL SHEETS 66  
 SHEET NO. 53  
 CONTRACT NO. 85523

ILLINOIS FED. AID PROJECT

LAYOUT: [Signature]  
 DRAWN: [Signature]  
 REVIEWED: [Signature]