

SECTION 5, TOWNSHIP 33, RANGE 4  
SECTION 8, TOWNSHIP 33, RANGE 4

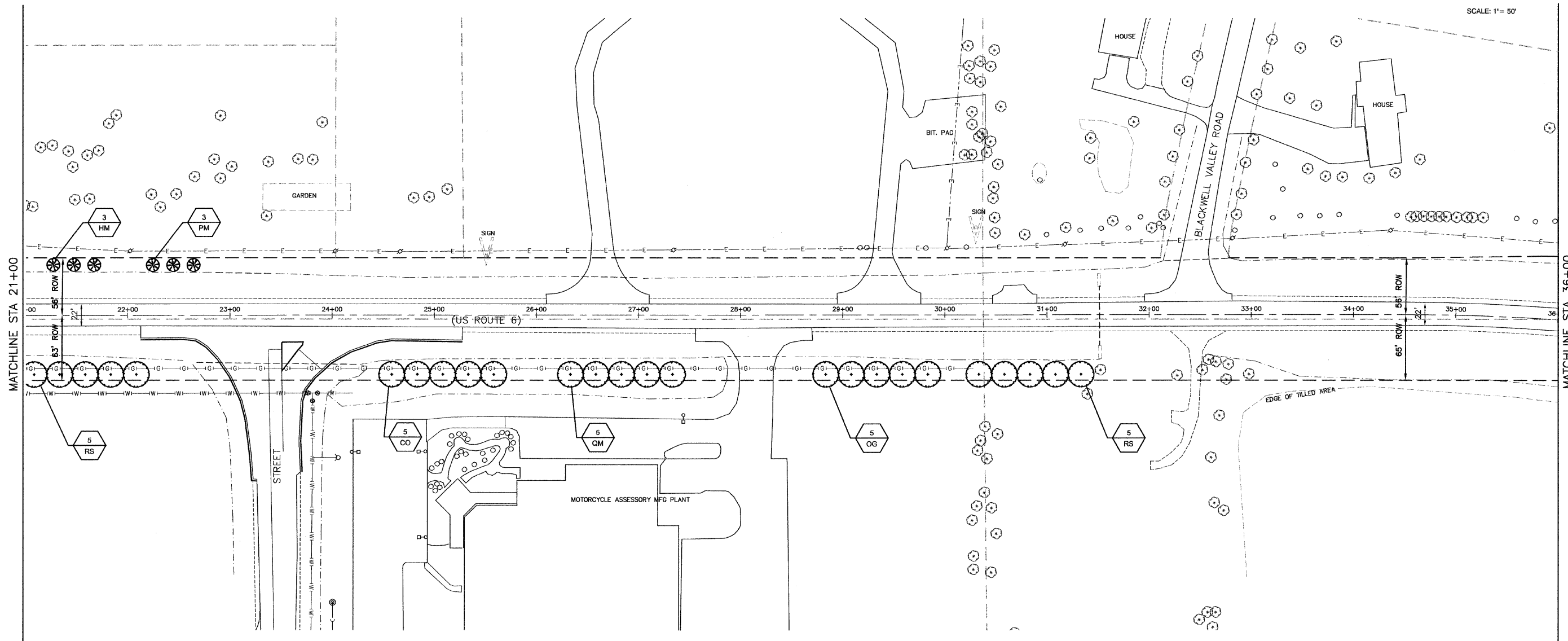
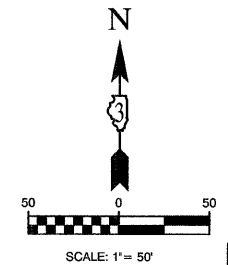

LINE & SYMBOL LEGEND	
	EXISTING FIRE HYDRANT
	EXISTING VALVE
	EXISTING INLET
	EXISTING CATCH BASIN
	EXISTING MANHOLE
	EXISTING LIGHT POLE
	EXISTING POWER POLE
	EXISTING TREE
	EXISTING BUSH / HEDGE
	EXISTING EVERGREEN
	EXISTING TRAFFIC SIGNAL POST
	EXISTING TRAFFIC SIGNAL MAST ARM
	EXISTING CONTROL CABINET
	EXISTING BURIED TELEPHONE
	EXISTING STEEL LIGHT POLE
	EXISTING TREE LINE
	EXISTING DITCH SWALE
	EXISTING STORM SEWER
	EXISTING SANITARY SEWER
	EXISTING FORCEMAIN
	EXISTING WATER MAIN
	EXISTING OVERHEAD ELECTRIC
	EXISTING BURIED ELECTRIC
	EXISTING GAS MAIN
	EXISTING BURIED TELEPHONE
	EXISTING CHAIN LINK FENCE
	PROPOSED CONIFEROUS EVERGREEN TREE
	PROPOSED DECIDUOUS SHADE TREE
	PROPOSED ORNAMENTAL TREE
	TREE REMOVAL & REPLACEMENT
	PLANT QUANTITY
	PLANT CODE NUMBER
	APPARENT RIGHT-OF-WAY (PER CITY OF OTTAWA)

**NOTES**

ALL PLANTINGS SHALL FOLLOW IDOT BUREAU OF DESIGN & ENVIRONMENT MANUAL - CHAPTER 59 - LANDSCAPE DESIGN AND EROSION CONTROL 59-7.09 PLANTING IN URBANIZED AREA FOR SIGHT DISTANCES.

ALL AREAS TO BE LANDSCAPED SHALL BE EXCAVATED TO THE DEPTH APPROPRIATE FOR THE PROPOSED PLANTINGS. NO SOD SHALL REMAIN IN NEW PLANTING AREAS.

PLANT QUANTITIES SHOWN ON DRAWINGS ARE APPROXIMATE. CONTRACTOR SHALL PROVIDE PLANT MATERIALS SUFFICIENT TO COVER AREAS SHOWN ON PLANS AT THE REQUIRED SPACING.

FOR LANDSCAPE PLANTING DETAILS AND ADDITIONAL PLANTING NOTES, SEE SHEET 27.

NO PLANTING SHALL BE CLOSER THAN 18' FROM BACK OF CURB OR EDGE OF PAVEMENT. NO TREES SHALL BE CLOSER THAN 4' FROM BACK OF MEDIAN CURB.

FOR PLANT SCHEDULE SEE SHEET 2.

CONTRACTOR SHALL REPAIR TO ITS ORIGINAL CONDITION ANY AREA OR ITEM DAMAGED AS A RESULT OF THEIR WORK. ANY EXISTING LANDSCAPE THAT IS DAMAGED OR REMOVED DURING CONSTRUCTION SHALL BE REPAIRED AND/OR REPLACED IN KIND AND EQUIVALENT SIZE. CONTRACTOR SHALL REPAIR AND SEED IN KIND, AT HIS COST, ALL TURF AREAS DAMAGED AS A RESULT OF PROJECT CONSTRUCTION.

NO SOIL SHALL LEAVE THE JOB SITE. ALL EXISTING MATERIAL IS TO REMAIN AT LOCATION.

FILE NAME = 10159-PLAN-02 - E-NORRIS-US-R16_06	USER NAME =	DESIGNED - JRA	REVISED -
		CHECKED - BDB	REVISED -
	PLOT SCALE =	DRAWN - JJB/JRA	REVISED -
	PLOT DATE = 10-29-2010	CHECKED - BDB	REVISED -

STATE OF ILLINOIS  
DEPARTMENT OF TRANSPORTATION

CITY OF OTTAWA  
ENTRY CORRIDOR TREE PLANTING PROJECT  
LANDSCAPING PLAN

F.A.P. RTE. 68,623	SECTION 10-00164-00-LS	COUNTY LASALLE	TOTAL SHEETS 27	SHEET NO. 14
SCALE: 1"=50'		SHEET NO. 14 OF 27 SHEETS		STA. TO STA.
FED. ROAD DIST. NO. 3		ILLINOIS		FED. AID PROJECT TE-003(061)

LAST SAVED: 10/29/2010 11:29:19 AM  
PLOT DATE: 10/29/2010