

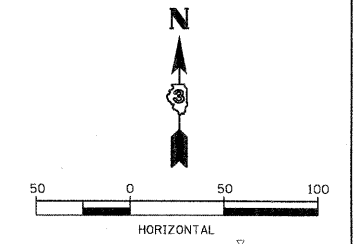

LAYOUT MWH 09/20/10 Almp01238
 DRAWN MWH 09/20/10 Almp01238
 REVIEWED CRC 10/01/10 1436 1246 06R1593 C:ADD:RoadSheetC-148-GRD.dgn

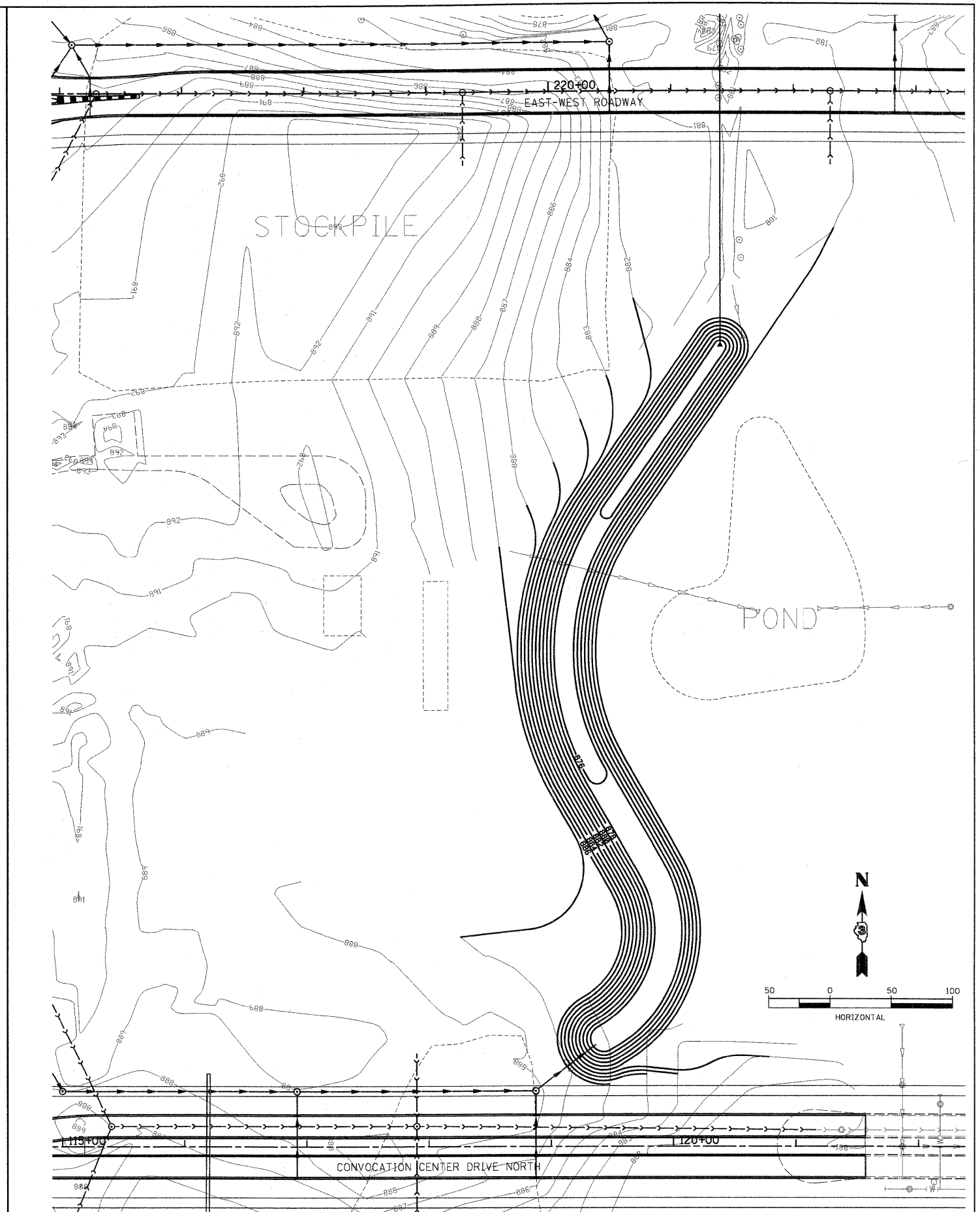
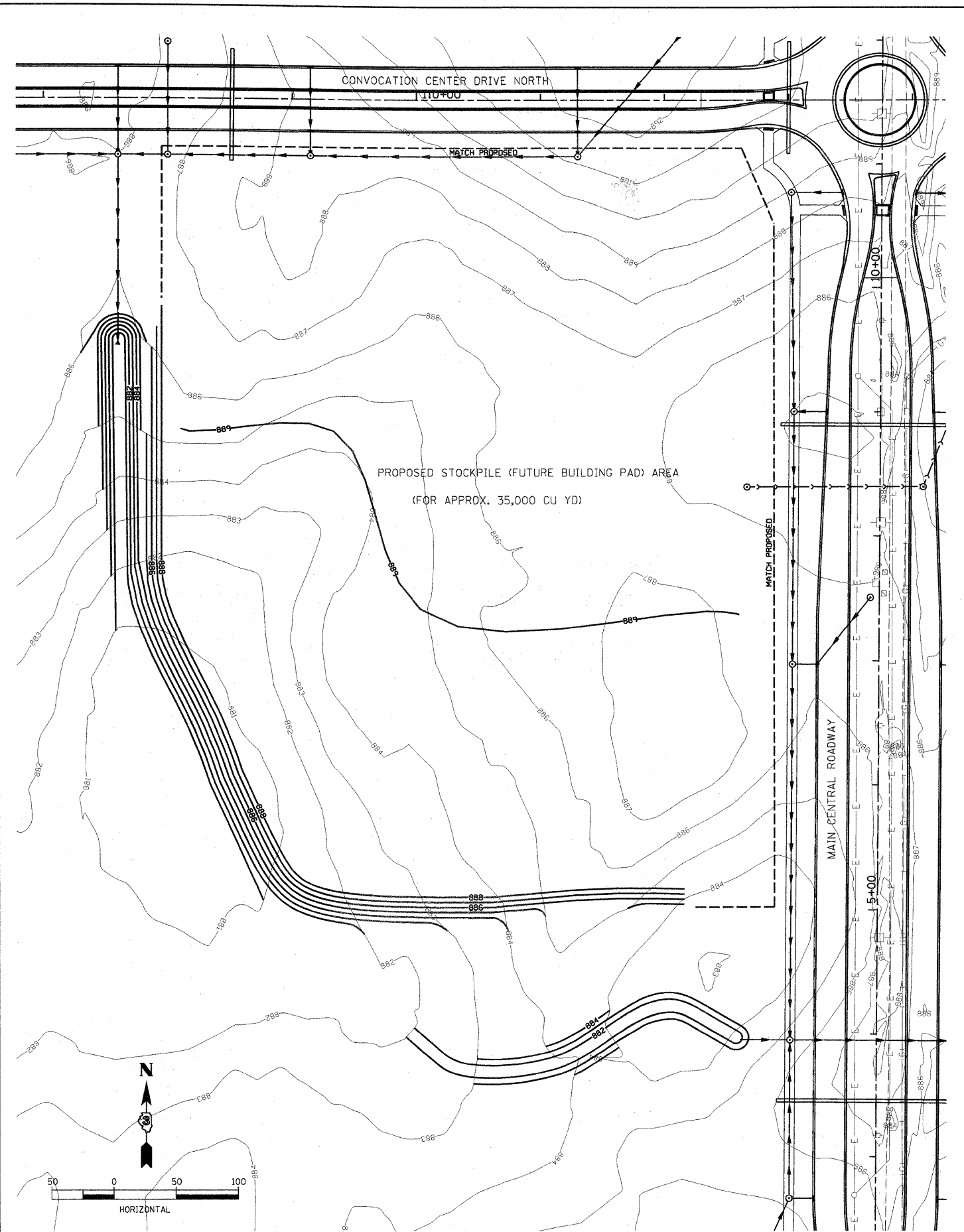

FILE NAME = C:148-GRD.dgn

USER NAME = Almp01238
 PLOT SCALE = 50.000' / 1" = 11/04/2010

DESIGNED - CRC
 DRAWN - MWH
 CHECKED - CRC
 DATE - 11/04/10

REVISED -
 REVISED -
 REVISED -
 REVISED -

STATE OF ILLINOIS
 DEPARTMENT OF TRANSPORTATION

NORTHERN ILLINOIS UNIVERSITY
 FAR WEST CAMPUS EXPANSION
 DETENTION GRADING AND DRAINAGE PLAN

SCALE: 1" = 50' SHEET NO. OF SHEETS STA. 200+00 TO STA. 207+00

F.A.P. RTE. 567	SECTION 06-00002-00-PV	COUNTY DEKALB	TOTAL SHEETS 148	SHEET NO. 69
CONTRACT NO. 87476				ILLINOIS FED. AID PROJECT