

ROUTE NO.	SECTION	COUNTY	TOTAL SHEETS	THIS SHEET
F.A.U. 6739	*	TAZEWELL	36	13

FED. ROAD DIST. NO. 7 | ILLINOIS | PROJECT | M-5093-129
 *05-00103-00-FP
 CONTRACT NO. 89493

PI Sta = 64+90.36
 N = 448061.53
 E = 288528.44
 I = 01°26'21"R

CURVE #1
 PI = 62+14.08
 N = 448785.25
 E = 288532.43
 I = 03°16'43"L

CIRCULAR
 Dc = 07°38'42"
 Dc = 07°38'22"
 T = 21.46
 R = 750.00
 L = 42.92
 C = 42.91
 E = 0.31
 M = 0.31
 SE = 0%

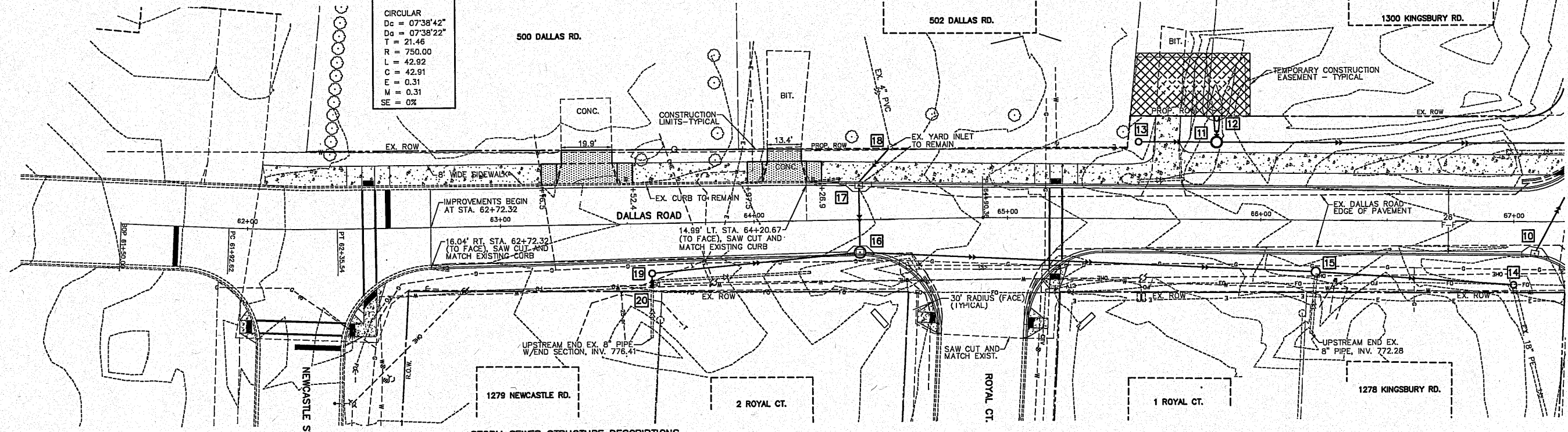

STORM SEWER STRUCTURE DESCRIPTIONS

- 19 INLETS, TYPE A, TYPE 8 GRATE, 19.90' RT. STA. 63+59.40, T/CONC. 778.40, INV. 776.12 (12"N), INV. 776.20 (EX. 8" VERIFY)
- 18 EX. YARD INLET, 28.71' LT., STA. 64+54.22, FIELD VERIFY INVERT (EX. 4" PVC)
- 17 INLETS, TYPE G-1, 13.72' LT. STA. 64+41.58, T/C 777.47, E/P 777.03, INV. 773.99 (12"E), INV. 774.09 (4"NW)
- 16 INLET MANHOLE, TY. A, 4' DIA., TY. G-1 FRAME & GRATE 13.00' RT. STA. 64+41.59, T/C 777.49, E/P 777.05, INV. 773.65 (12"N), INV. 773.75 (12"S), INV. 773.75 (12"W)
- 15 INLETS, TYPE B, TYPE 8 GRATE, 20.56' RT. STA. 66+21.80, T/CONC. 772.80, INV. 770.12 (15"N), INV. 770.22 (12"S), INV. 771.80 (EX. 8"E)
- 14 INLETS, TYPE B, TYPE 8 GRATE, 25.20' RT. STA. 67+00.06, T/CONC. 771.75, INV. 769.65 (EX. 18"PE-E), INV. 769.75 (15"S)
- 13 INLETS, TYPE B, TYPE 8 GRATE, 30.58' LT. STA. 65+51.58, T/CONC. 774.50, INV. 771.02 (12"N)
- 12 PRECAST REINFORCED CONCRETE FLARED END SECTION, 15' x 43.70' LT. STA. 65+82.31, INV. 770.66
- 11 MANHOLES, TY. A, 4' DIA., TYPE 8 GRATE W/12" RING 30.70' LT. STA. 65+82.31, T/CONC. 774.00, INV. 770.14 (18"N), INV. 770.24 (18"W), INV. 770.74 (12"S)

STORM SEWER PIPE SCHEDULE

- 20 - 19 STORM SEWER, (WATER MAIN REQUIREMENTS) 8"-6 FT. @ 3.50%, T.B.(ST.S.) = 0 C.Y.
- 19 - 16 STORM SEWERS, CLASS A, TYPE 1, 12"-79 FT. @ 3.00%, T.B.(ST.S.) = 11 C.Y.
- 16 - 15 STORM SEWERS, CLASS A, TYPE 1, 12"-176 FT. @ 1.95%, T.B.(ST.S.) = 16 C.Y.
- 15 - 14 STORM SEWERS, CLASS A, TYPE 1, 15"-75 FT. @ 0.50%, T.B.(ST.S.) = 0 C.Y.
- 18 - 17 STORM SEWER, (WATER MAIN REQUIREMENTS) 4" 19 FT., FIT IN THE FIELD, T.B.(ST.S.) = 2 C.Y.
- 17 - 16 STORM SEWERS, CLASS A, TYPE 1, 12"-24 FT. @ 1.00%, T.B.(ST.S.) = 4 C.Y.
- 13 - 11 STORM SEWERS, CLASS A, TYPE 1, 12"-28 FT. @ 1.00%, T.B.(ST.S.) = 7 C.Y.
- 12 - 11 STORM SEWERS, CLASS A, TYPE 1, 18"-6 FT. PLUS END SECTION @ 3.50%
- 11 - 8 STORM SEWERS, CLASS A, TYPE 1, 18"-144 FT. @ 2.00%, T.B. = 5 C.Y.

NOTE: ALL EXIST. UTILITIES ARE APPROXIMATE AND SHOWN FOR INFORMATION ONLY AND ARE TO BE VERIFIED IN THE FIELD BY THE CONTRACTOR.

STORM SEWER QUANTITIES ARE MEASURED FROM INSIDE WALL OF STRUCTURE TO INSIDE WALL OF STRUCTURE.

SCALES:
 1" = 20' HOR
 1" = 5' VER

