

ROUTE NO.	SECTION	COUNTY	TOTAL SHEETS	THIS SHEET
F.A.U. 6739	*	TAZEWELL	36	14

FED. ROAD DIST. NO. 7 ILLINOIS PROJECT M-5093-129
 * 05-00103-00-FP
 CONTRACT NO. 89493

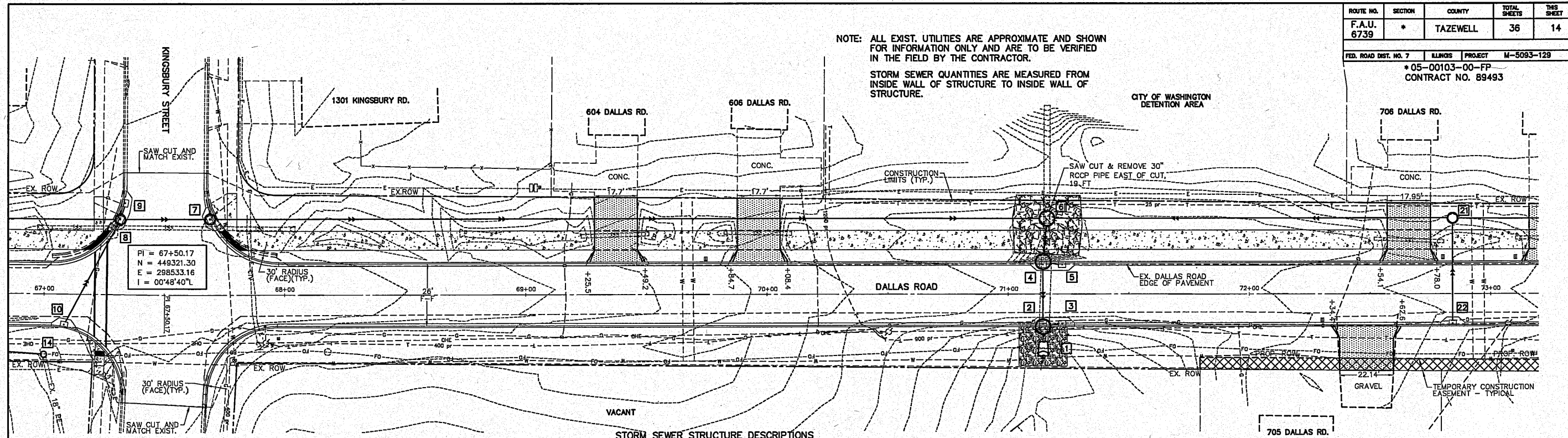

NOTE: ALL EXIST. UTILITIES ARE APPROXIMATE AND SHOWN FOR INFORMATION ONLY AND ARE TO BE VERIFIED IN THE FIELD BY THE CONTRACTOR.

STORM SEWER QUANTITIES ARE MEASURED FROM INSIDE WALL OF STRUCTURE TO INSIDE WALL OF STRUCTURE.

STORM SEWER STRUCTURE DESCRIPTIONS

- 10 INLETS, TYPE G-1, 12.76' RT. STA. 67+08.32, T/C 772.03, E/P 771.59, INV. 768.50 (12"NW)
- 9 INLETS, TYPE G-1, 38.15' LT. STA. 67+33.19, T/C 771.48, E/P 771.04, INV. 767.89 (12"E)
- 8 INLET MANHOLE, TY. A, 4' DIA., TY. G-1 FRAME & GRATE 31.27' LT. STA. 67+31.24, T/C 771.36, E/P 770.92, INV. 767.16 (18"N), INV. 767.26 (18"S), INV. 767.79 (2-12")
- 7 INLET MANHOLE, TY. A, 4' DIA., TY. G-1 FRAME & GRATE 31.58' LT. STA. 67+69.03, T/C 771.32, E/P 770.88, INV. 766.38 (18"N), INV. 766.48 (18"S)
- 6 MANHOLES, TY. A, 6' DIA., TYPE 1 FRAME, CLOSED LID 31.60' LT. STA. 71+16.03, T/CAST. 766.90, INV. 760.07 (42"E), INV. 760.42 (30"W VERIFY), INV. 761.25 (18"S), INV. 761.50 (15"N)
- 5 INLETS, TYPE G-1, 12.33' LT. STA. 71+21.43, T/C 766.48, E/P 766.04, INV. 762.05 (15"S)
- 4 INLET MANHOLE, TY. A, 6' DIA., TY. G-1 FRAME & GRATE 13.58' LT. STA. 71+14.43, T/C 766.49, E/P 766.05, INV. 759.83 (42"E), INV. 759.93 (42"W), INV. 761.75 (15"N)
- 3 INLETS, TYPE G-1, 12.33' RT. STA. 71+21.43, T/C 766.48, E/P 766.04, INV. 762.05 (15"S)
- 2 INLET MANHOLE, TY. A, 6' DIA., TY. G-1 FRAME & GRATE 13.58' RT. STA. 71+14.43, T/C 766.49, E/P 766.05, INV. 759.50 (42"E), INV. 759.60 (42"W), INV. 761.75 (15"N)
- 1 PRECAST REINFORCED FLARED END SECTION, 42" W/ GRATE, 25.84' RT. STA. 71+14.43, INV. 759.30
- 21 MANHOLE, TY. A, 4' DIA., TYPE 1 FRAME, OPEN LID 31.60' LT. STA. 72+84.22, T/CAST. 769.95, INV. 764.12 (15"S), INV. 764.22 (15"N), INV. 764.37 (12"E)
- 22 INLETS, TYPE G-1, 12.33' RT. STA. 72+84.22, T/C 769.02, E/P 768.58, INV. 765.60 (12"W)

STORM SEWER PIPE SCHEDULE

- 10 - 8 STORM SEWERS, CLASS A, TYPE 1, 12"-47 FT. @ 1.50% T.B.(ST.S.) = 9 C.Y.
- 9 - 8 STORM SEWERS, CLASS A, TYPE 1, 12"-5 FT. @ 2.00% T.B.(ST.S.) = 1 C.Y.
- 8 - 7 STORM SEWERS, CLASS A, TYPE 1, 18"-34 FT. @ 2.00% T.B.(ST.S.) = 9 C.Y.
- 7 - 6 STORM SEWERS, CLASS A, TYPE 2, 18"-342 FT. @ 1.50% T.B.(ST.S.) = 50 C.Y.
- 6 - 21 STORM SEWERS, CLASS A, TYPE 2, 15"-164 FT. @ 1.60% T.B.(ST.S.) = 20 C.Y.
- 21 - 22 STORM SEWERS, CLASS A, TYPE 1, 12"-41 FT. @ 3.00% T.B.(ST.S.) = 12 C.Y.
- 6 - 4 STORM SEWERS, CLASS A, TYPE 2, 42"-14 FT. @ 1.00% T.B.(ST.S.) = 12 C.Y.
- 4 - 5 STORM SEWERS, CLASS A, TYPE 2, 15"-5 FT. @ 6.00% T.B.(ST.S.) = 2 C.Y.
- 4 - 2 STORM SEWERS, CLASS A, TYPE 2, 42"-23 FT. @ 1.00% T.B.(ST.S.) = 16 C.Y.
- 2 - 3 STORM SEWERS, CLASS A, TYPE 2, 15"-5 FT. @ 6.00% T.B.(ST.S.) = 2 C.Y.
- 2 - 1 STORM SEWERS, CLASS A, TYPE 2, 42"-4 FT. PLUS END SECTION @ 2.00% T.B.(ST.S.) = 3 C.Y.

SCALES:
 1" = 20' HOR
 1" = 5' VER

