

T.R.	SECTION	COUNTY	TOTAL SHEETS	SHEET NO.
160	09-09123-00-BR	VERMILION	19	1
FED. AID PROJECT ILLINOIS		CONTRACT NO. 91437		

INDEX OF SHEETS

- 1 COVER SHEET
- 2 SUMMARY OF QUANTITIES
- 3 TYPICAL SECTIONS / GENERAL NOTES / DETAILS
- 4 ALIGNMENT AND TIES
- 5-6 PLAN AND PROFILE
- 7 GENERAL PLAN & ELEVATION
- 8 SUPERSTRUCTURE
- 9 SUPERSTRUCTURE DETAILS
- 10 BRIDGE RAIL DETAILS
- 11-12 ABUTMENT DETAILS
- 13 PILE DETAILS
- 14 BORING LOGS
- 15-19 CROSS SECTIONS

HIGHWAY STANDARDS

- 000001-05 STANDARD SYMBOLS
- 280001-05 TEMPORARY EROSION CONTROL SYSTEMS
- 515001-03 NAME PLATE FOR BRIDGES
- 635006-03 REFLECTOR AND TERMINAL MARKER PLACEMENT
- 701001-02 OFF-ROAD OPERATIONS LESS THAN 15'
- 701006-02 OFF-ROAD OPERATIONS GREATER THAN 15'
- 701901-01 TRAFFIC CONTROL DEVICES
- BLR 21-8 APPLICATION OF TRAFFIC CONTROL DEVICES

STATE OF ILLINOIS DEPARTMENT OF TRANSPORTATION DIVISION OF HIGHWAYS

PROPOSED HIGHWAY PLANS

**TOWNSHIP ROAD 160
SECTION 09-09123-00-BR
PROJECT BROS-0183(303)
BRIDGE REPLACEMENT OVER SWANK CREEK
VERMILION COUNTY**

C-95-327-10

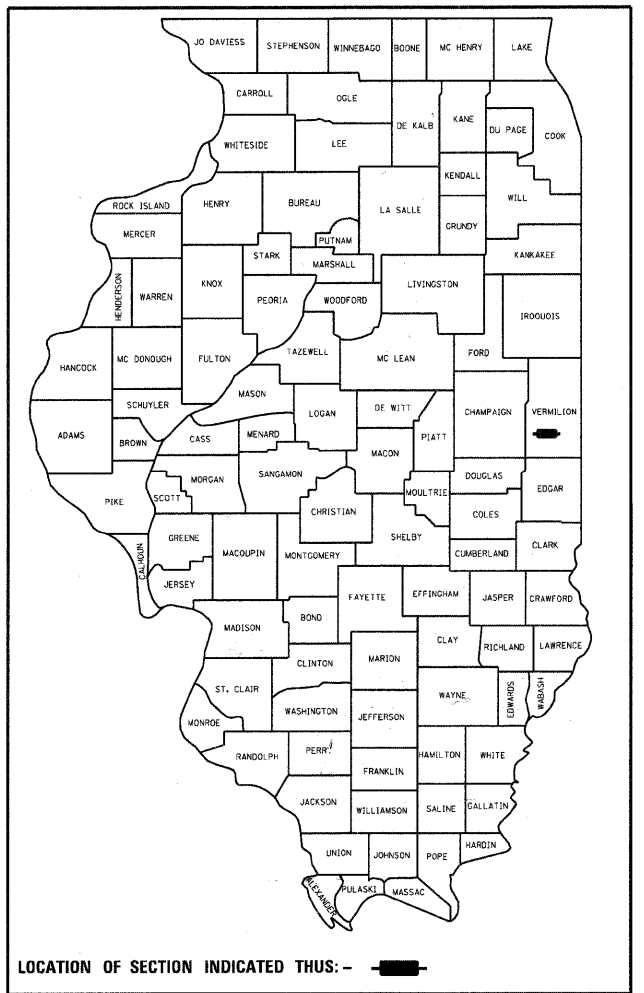

**ROADWAY OMISSION
FROM STA 9+68.90
TO STA 10+31.09**

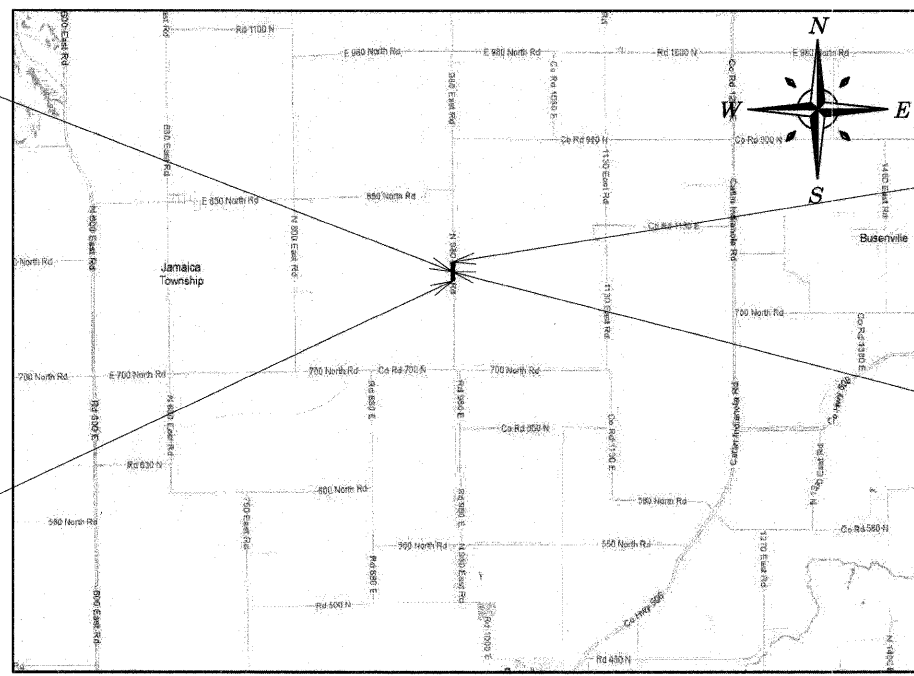

**PROJECT ENDS
STA 14+00.0**

**PROJECT BEGINS
STA 5+00.0**

**PROPOSED STRUCTURE
REPLACEMENT OVER
SWANK CREEK
STATION 10+00
NEW SN: 092-3123
OLD SN: 092-3518**

ENGINEERING PLAN SUBMITTAL	
THESE ENGINEERING PLANS AND SUPPORTING DOCUMENTS ARE ISSUED FOR THE FOLLOWING PURPOSE ONLY	
<input type="checkbox"/>	PRELIMINARY PLAN REVIEW NO. 1
<input type="checkbox"/>	PRE-FINAL PLAN REVIEW NO. 1
<input checked="" type="checkbox"/>	FINAL PLAN REVIEW NO. 1
<input type="checkbox"/>	PERMIT APPLICATION
<input type="checkbox"/>	BIDDING
<input type="checkbox"/>	CONSTRUCTION

DATE: 10-15-2010

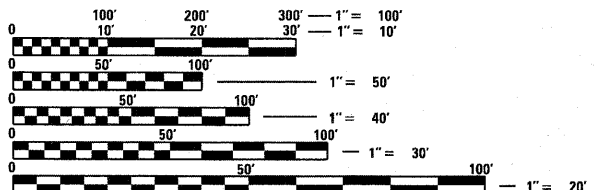

FULL SIZE PLANS HAVE BEEN PREPARED USING STANDARD ENGINEERING SCALES. REDUCED SIZED PLANS WILL NOT CONFORM TO STANDARD SCALES. IN MAKING MEASUREMENTS ON REDUCED PLANS, THE ABOVE SCALES MAY BE USED.

**J.U.L.I.E.
JOINT UTILITY LOCATION INFORMATION FOR EXCAVATION
1-800-892-0123
OR 811**

R12W LOCATION MAP

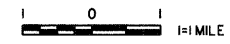

GROSS LENGTH = 900.00 FT. = 0.170 MILE
NET LENGTH = 837.81 FT. = 0.159 MILE
ADT = 50
FUNCTIONAL CLASSIFICATION = LOCAL ROAD (NON-URBAN)

ESI ESI CONSULTANTS, LTD
753 WINDSOR ROAD
CHARLESTON, IL 61920
(217) 348-1900
WWW.ESI-CONSULTANTS.COM

ILLINOIS DEPARTMENT OF PROFESSIONAL REGULATION REGISTRATION #184-003885
** THIS DOCUMENT IS THE PROPERTY OF ESI CONSULTANTS, LTD. AND NO PART HEREIN SHALL BE USED **
EXCEPT FOR THIS SPECIFIC PROJECT WITHOUT THE WRITTEN CONSENT OF ESI CONSULTANTS, LTD.

**VERMILION COUNTY
HIGHWAY DEPARTMENT**

APPROVED October 18 20 10
Daniel R. Feuerborn
COUNTY ENGINEER

PASSED 10-27 20 10
D. H. Spill
DISTRICT 5 ENGINEER OF LOCAL ROADS & STREETS

RELEASING FOR BID BASED
ON LIMITED REVIEW 10-27 20 10
[Signature]
DEPUTY DIRECTOR OF HIGHWAYS, REGION 3 ENGINEER



[Signature] 10/19/2010
Date
License Expires 11-30-2011

**ESI PROJECT ENGINEER - JOE HICKOX
ESI PROJECT MANAGER - DANIEL FEUERBORN**

CONTRACT NO. 91437

PRINTED DATE: 10/15/2010
FILE NAME: N:\Projects\VerMilion_County\10-348_TR160 - Swank_C-ROAD\Drawings\Sheets\01-TR160-C5.dwg