

EXISTING TYPICAL CROSS SECTION

MAIN STREET
STA. 56+53 TO STA. 58+20
STA. 59+05 TO STA. 59+75.50

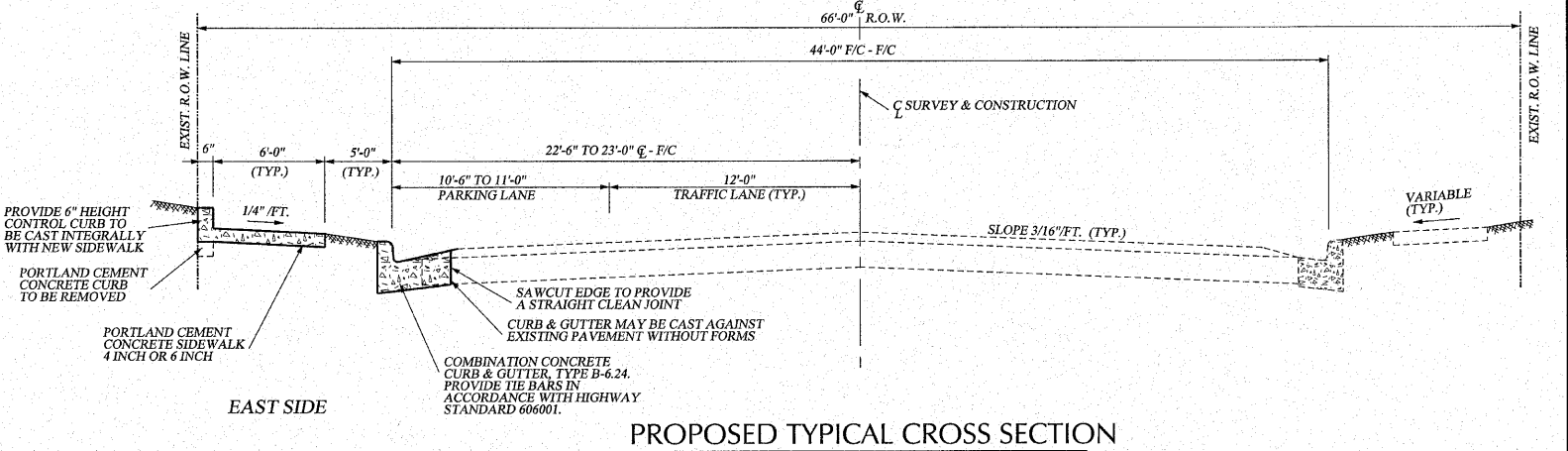

PROPOSED TYPICAL CROSS SECTION

MAIN STREET
STA. 56+53 TO STA. 58+20
STA. 59+05 TO STA. 59+75.50

NOTE:
PROVIDE MAXIMUM TRANSVERSE SLOPE
OF 1/4" / FT. AT ALL C.E. AND ALLEYS
FOR ADA ROUTE

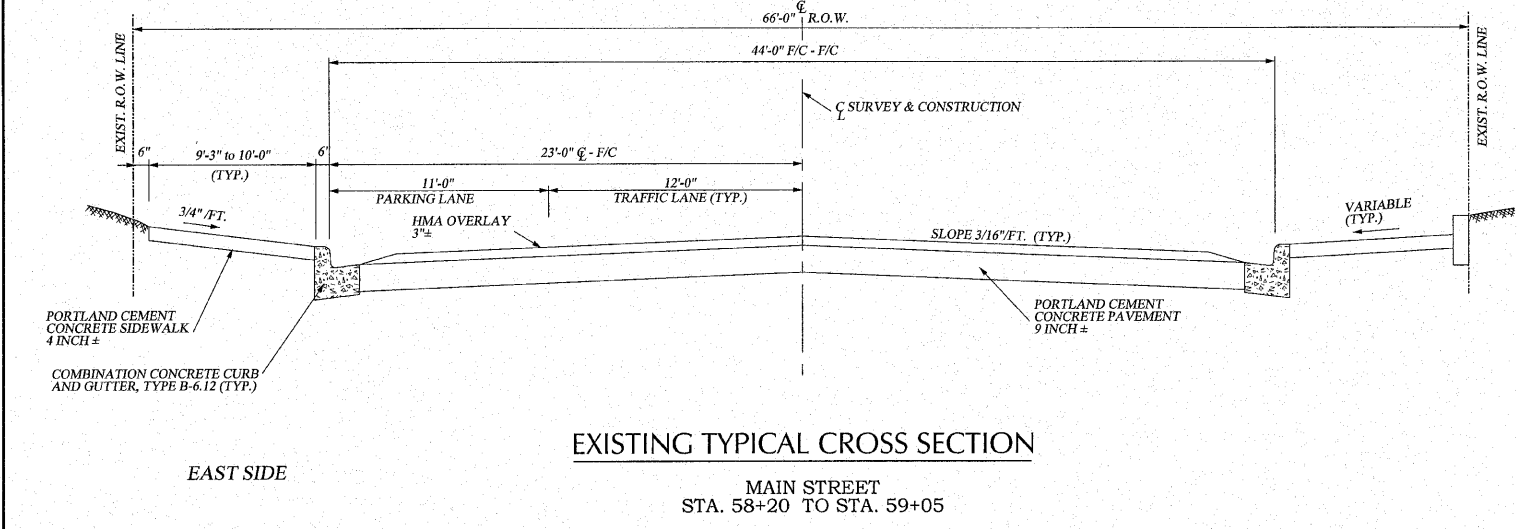

EXISTING TYPICAL CROSS SECTION

MAIN STREET
STA. 58+20 TO STA. 59+05

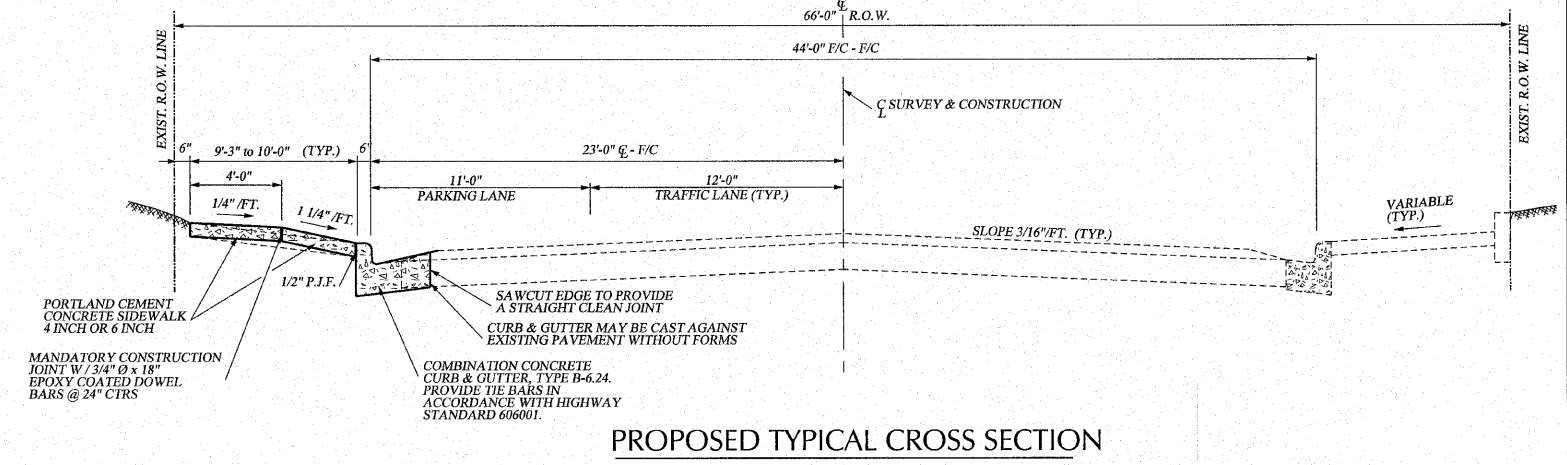

PROPOSED TYPICAL CROSS SECTION

MAIN STREET
STA. 58+20 TO STA. 59+05

NOTE:
PROVIDE MAXIMUM TRANSVERSE SLOPE
OF 1/4" / FT. AT ALL C.E. AND ALLEYS
FOR ADA ROUTE

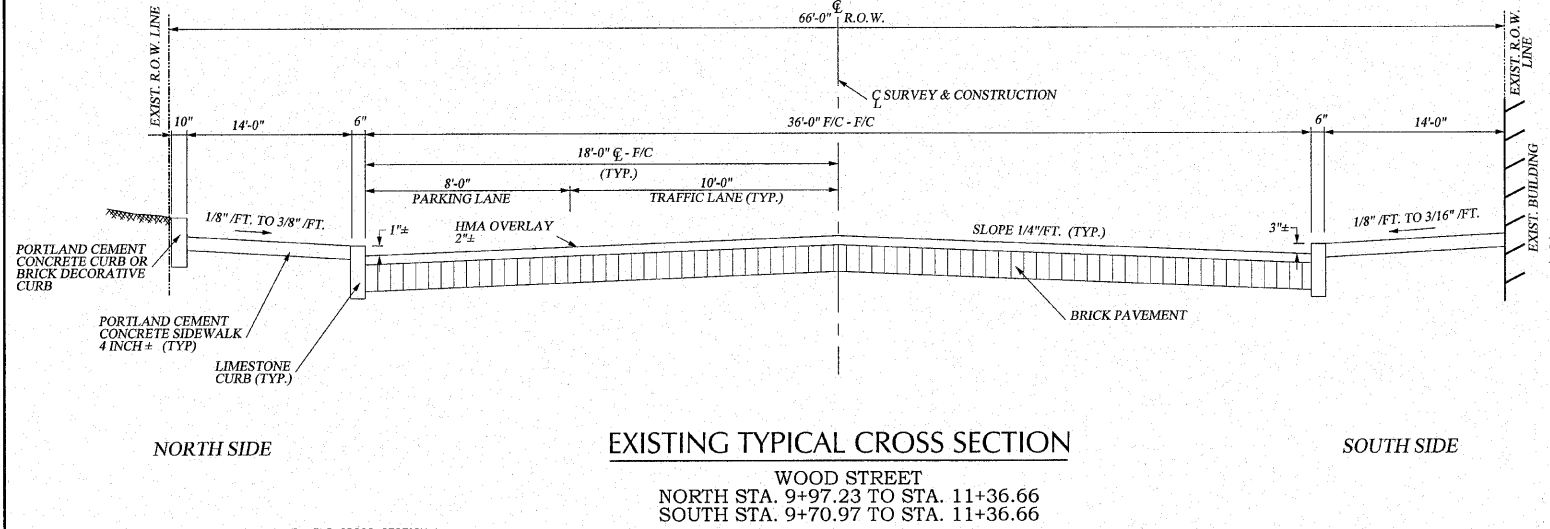

EXISTING TYPICAL CROSS SECTION

WOOD STREET
NORTH STA. 9+97.23 TO STA. 11+36.66
SOUTH STA. 9+70.97 TO STA. 11+36.66

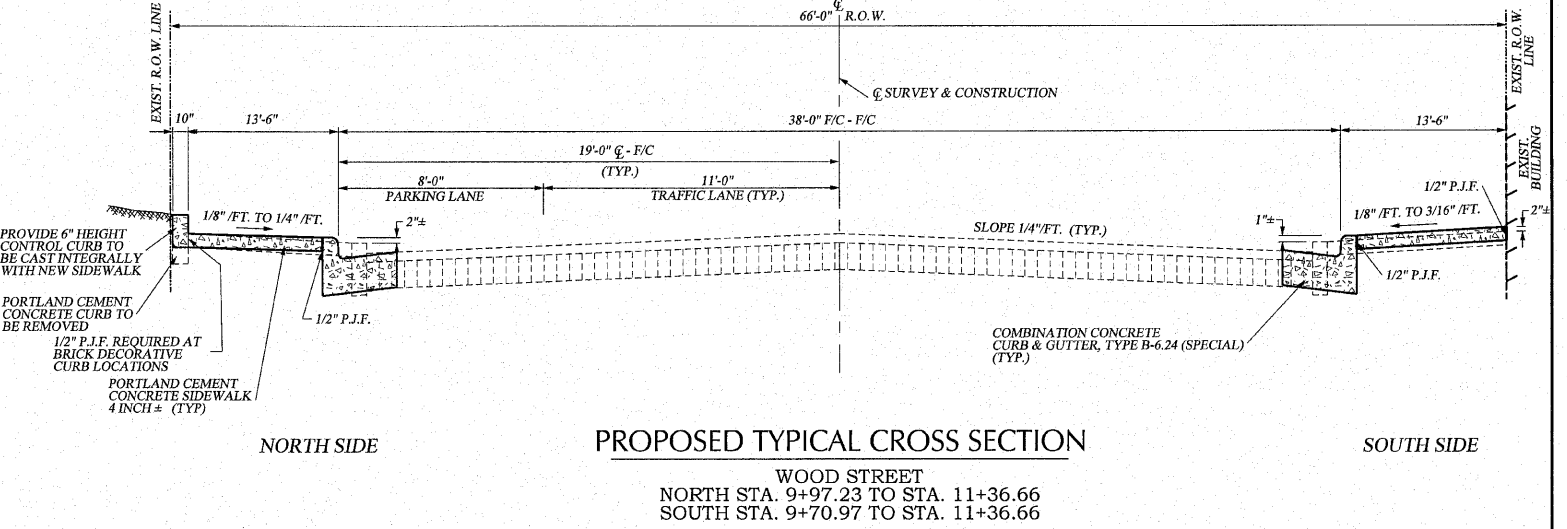

PROPOSED TYPICAL CROSS SECTION

WOOD STREET
NORTH STA. 9+97.23 TO STA. 11+36.66
SOUTH STA. 9+70.97 TO STA. 11+36.66

FRANCIS ASSOCIATES
CONSULTING ENGINEERS
LAND SURVEYORS
330 NORTH CENTRAL AVENUE
PARIS, ILLINOIS 61944
PH: (217) 465-5306
PROFESSIONAL DESIGN FIRM #184-001406

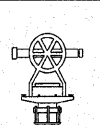

SCALES	DRAWN: TLT	DATE: 8/20/10
PLAN: N-T-S	CHECKED: _____	DATE: _____
REVISED: _____	APPROVED: _____	DATE: _____
REVISED: _____	REVISED: _____	DATE: _____

FRANCIS ASSOC.
FILE NO.
P-414

EXISTING AND PROPOSED TYPICAL CROSS SECTIONS
DOWNTOWN SIDEWALK IMPROVEMENTS - PHASE 2
CITY OF PARIS, ILLINOIS, EDGAR COUNTY

SHEET NO.
3
OF 7 SHEETS

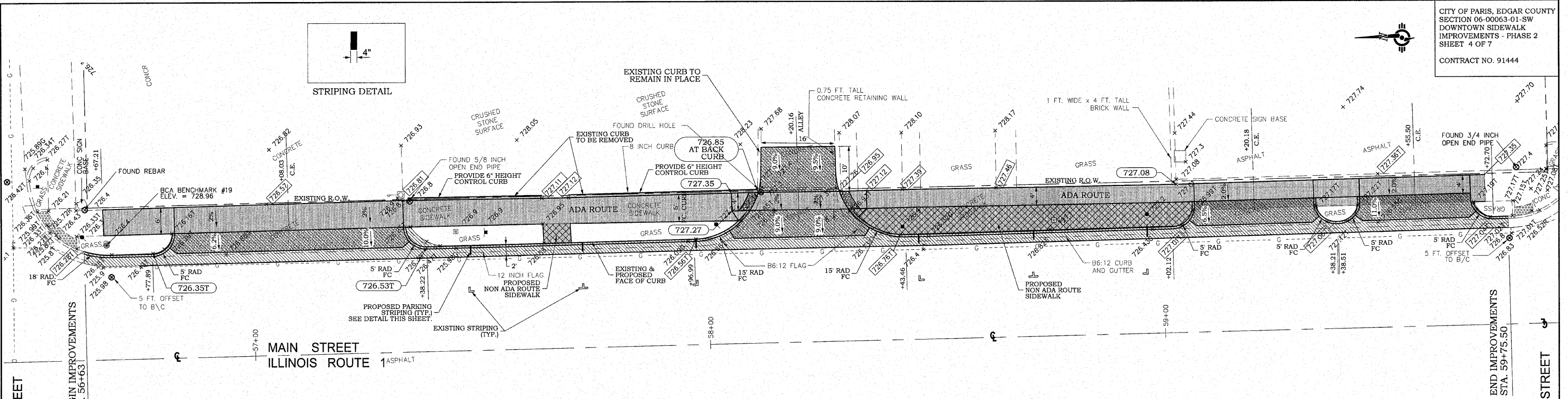

SIDEWALK REMOVAL	
LT STA. 56+67.21 TO STA. 59+70.92	2,088 SQ. FT.
SHEET TOTAL =	2,088 SQ. FT.

PORTLAND CEMENT CONCRETE DRIVEWAY PAVEMENT, 6 INCH	
LT STA. 57+08.03	25.8 SQ. YD.
LT STA. 58+20.16	37.0 SQ. YD.
LT STA. 59+20.18	16.7 SQ. YD.
LT STA. 59+55.50	15.4 SQ. YD.
TOTAL=	94.9 SQ. YD.

PORTLAND CEMENT CONCRETE SIDEWALK 4 INCH	
LT STA. 56+67.21 TO STA. 56+83	91 SQ. FT.
LT STA. 57+33 TO STA. 58+09	472 SQ. FT.
LT STA. 58+31 TO STA. 59+07	715 SQ. FT.
LT STA. 59+33 TO STA. 59+43	40 SQ. FT.
LT STA. 59+68 TO STA. 59+70.92	19 SQ. FT.
SHEET TOTAL =	1,337 SQ. FT.

COMBINATION CONCRETE CURB AND GUTTER, TYP. B-6.24	
LT STA. 56+63 TO STA. 56+81.5	19.6 FOOT
LT STA. 57+34.3 TO STA. 58+04.8	71.4 FOOT
LT STA. 58+35.6 TO STA. 59+05.9	71.4 FOOT
LT STA. 59+34.4 TO STA. 59+42.3	9.0 FOOT
LT STA. 59+68.8 TO STA. 59+75.9	7.6 FOOT
TOTAL =	179.0 FOOT

DOMESTIC WATER SERVICE BOXES TO BE ADJUSTED	
25.5 LT STA. 58+76	1 EACH
26.4 LT STA. 57+44	1 EACH
SHEET TOTAL =	2 EACH

PROVIDE 1/2" P.J.F. AROUND PERIMETER OF POWER POLES, LIGHT BASES, AND TRAFFIC CONTROLLERS AND AT ALL LOCATIONS WHERE NEW SIDEWALK IS ADJACENT TO NEW CURB AND GUTTER.

PAVEMENT REMOVAL	
LT STA. 56+63 TO STA. 59+75.5	168.8 SQ. YD.
LT STA. 58+12 TO STA. 58+28.4	18.2 SQ. YD.
SHEET TOTAL =	187.0 SQ. YD.

THERMOPLASTIC PAVEMENT MARKING - LINE 4"	
LT STA. 57+47.7	3 FOOT
LT STA. 57+72.7	3 FOOT
LT STA. 57+97.6	3 FOOT
LT STA. 58+46.2	3 FOOT
LT STA. 58+71.5	3 FOOT
LT STA. 58+96.6	3 FOOT
SHEET TOTAL =	18 FOOT

PORTLAND CEMENT CONCRETE SIDEWALK 6 INCH	
LT STA. 56+83 TO STA. 57+33	297 SQ. FT.
LT STA. 58+09 TO STA. 58+31	78 SQ. FT.
LT STA. 59+07 TO STA. 59+33	105 SQ. FT.
LT STA. 59+43 TO STA. 59+68	97 SQ. FT.
SHEET TOTAL =	577 SQ. FT.

DETECTABLE WARNINGS	
LT STA. 58+06.9 TO STA. 58+11.3	8.0 SQ. FT.
LT STA. 58+29.1 TO STA. 58+33.5	8.0 SQ. FT.
SHEET TOTAL =	16.0 SQ. FT.

POROUS GRANULAR BACKFILL	
LT STA. 56+63 TO STA. 59+75.5	6.0 CU. YD.
SHEET TOTAL =	6.0 CU. YD.

LEGEND	
XXX.XX	EXISTING SPOT ELEV.
XXX.XXT	EXISTING TOP OF CURB ELEV.
XXX.XXG	EXISTING GUTTER ELEV.
XXX.XX	EXISTING SPOT ELEV. TO MATCH
XXX.XX	PROPOSED SPOT ELEV.
XXX.XXT	PROPOSED TOP OF CURB ELEV.

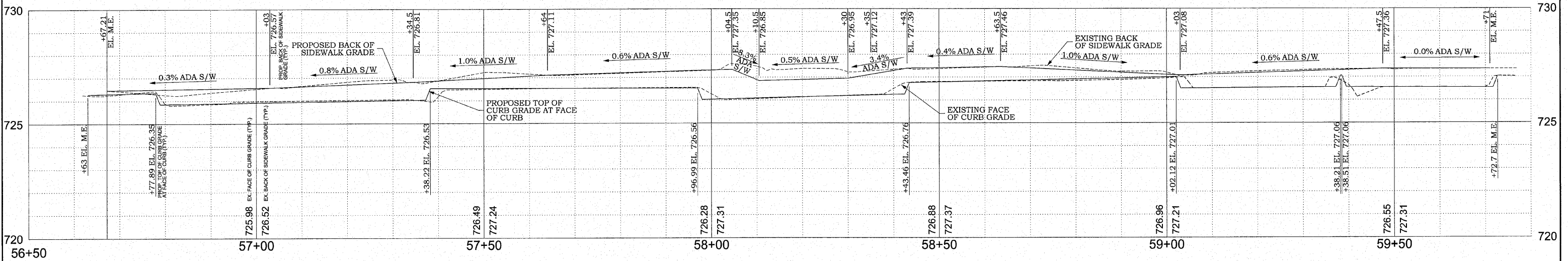

FRANCIS ASSOCIATES
CONSULTING ENGINEERS
LAND SURVEYORS
330 NORTH CENTRAL AVENUE
PARIS, ILLINOIS 61944
PH. (217) 465-5306
PROFESSIONAL DESIGN FIRM #184-001406

SCALES	
PLAN: HOR. 1"=10'	CHECKED DATE
VERT. 1"=5'	DATE
REVISION	DATE
REVISION	DATE

FRANCIS ASSOC.
FILE NO.
P-414

PLAN AND PROFILE - MAIN STREET

DOWNTOWN SIDEWALK IMPROVEMENTS - PHASE 2
CITY OF PARIS, ILLINOIS, EDGAR COUNTY

SHEET NO.
4
OF 7 SHEETS

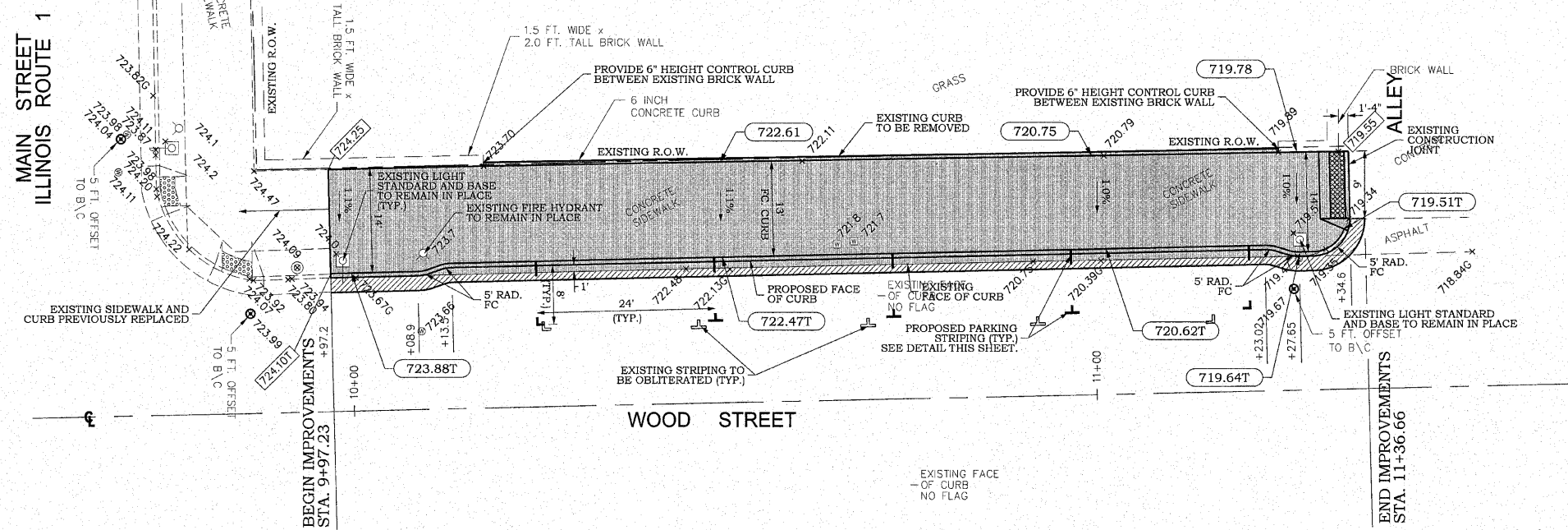

	SIDEWALK REMOVAL
LT STA. 9+97.2 TO STA. 11+34.6	2,012 SQ. FT.
SHEET TOTAL =	2,012 SQ. FT.

	PORTLAND CEMENT CONCRETE SIDEWALK 4 INCH
LT STA. 9+97.2 TO STA. 11+34.6	1,761 SQ. FT.
SHEET TOTAL =	1,761 SQ. FT.

	COMBINATION CONCRETE CURB AND GUTTER, TYP. B-6.24 (SPECIAL)
LT STA. 9+97.2 TO STA. 11+34.6	150.0 FOOT
SHEET TOTAL =	150.0 FOOT

	DOMESTIC WATER SERVICE BOXES TO BE ADJUSTED
21.1 LT STA. 10+65.49	1 EACH
21.5 LT STA. 10+67.77	1 EACH
SHEET TOTAL =	2 EACH

PROVIDE 1/2" P.J.F. AROUND PERIMETER OF POWER POLES, LIGHT BASES, AND TRAFFIC CONTROLLERS AND AT ALL LOCATIONS WHERE NEW SIDEWALK IS ADJACENT TO NEW CURB AND GUTTER.

	PAVEMENT REMOVAL
LT STA. 9+97.2 TO STA. 11+34.6	20.3 SQ. YD.
SHEET TOTAL =	20.3 SQ. YD.

	DETECTABLE WARNINGS
STA. 11+32 TO STA. 11+34	18 SQ. FT.
SHEET TOTAL =	18 SQ. FT.

	THERMOPLASTIC PAVEMENT MARKING - LINE 4"
LT STA. 10+24.9	5 FOOT
LT STA. 10+48.9	6 FOOT
LT STA. 10+72.9	6 FOOT
LT STA. 10+96.9	6 FOOT
LT STA. 11+20.9	5 FOOT
SHEET TOTAL =	28 FOOT

	POROUS GRANULAR BACKFILL
LT STA. 9+97.2 TO STA. 11+34.6	20.0 CU. YD.
SHEET TOTAL =	20.0 CU. YD.

LEGEND

xxx.xx	EXISTING SPOT ELEV.
xxx.xxt	EXISTING TOP OF CURB ELEV.
xxx.xxg	EXISTING GUTTER ELEV.
xxx.xx	EXISTING SPOT ELEV. TO MATCH
xxx.xx	PROPOSED SPOT ELEV.
xxx.xxt	PROPOSED TOP OF CURB ELEV.

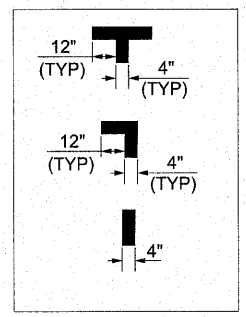
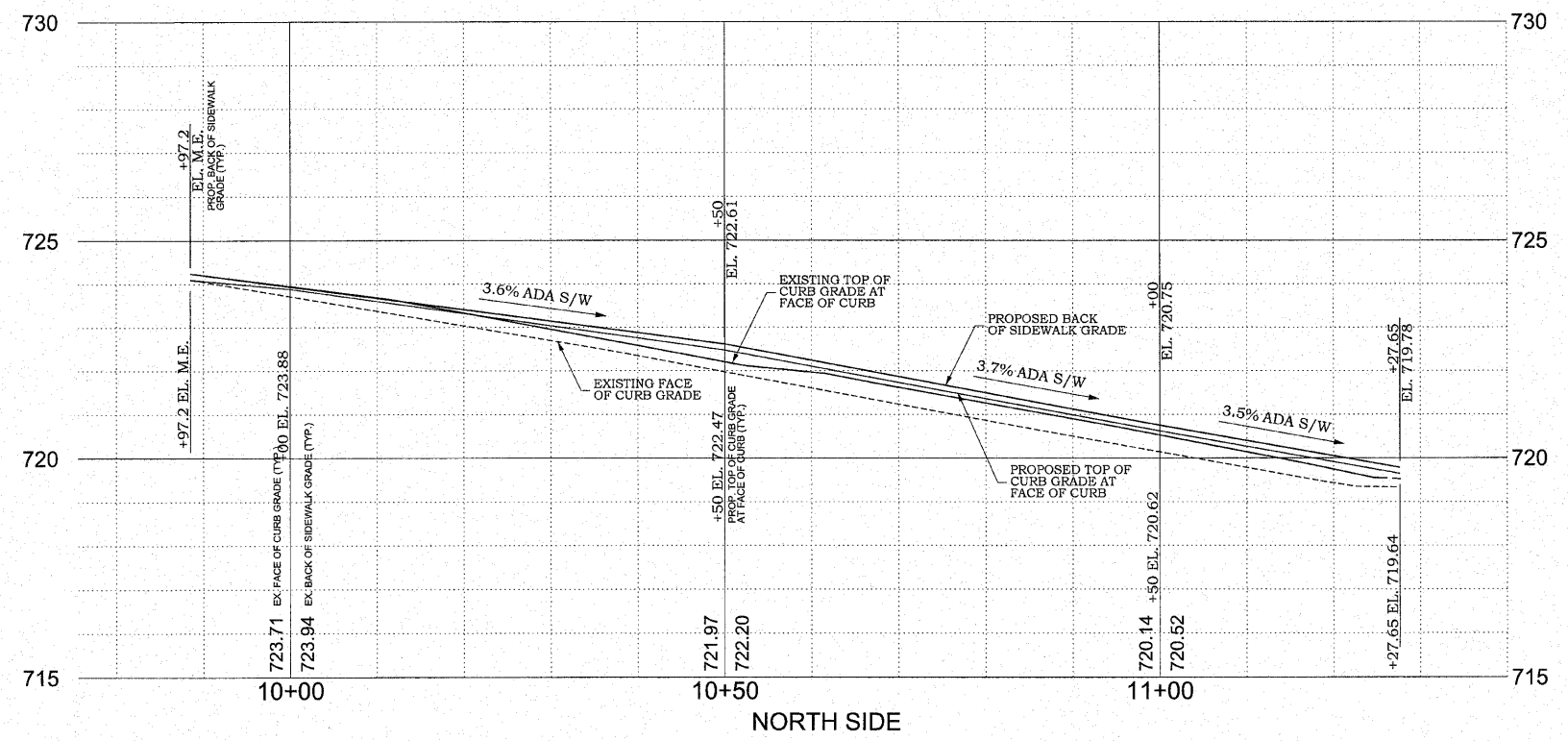

STRIPING DETAILS

File Name: c:\bentley\projects\p-xxx\RCp018xx.dgn

FRANCIS ASSOCIATES
CONSULTING ENGINEERS
LAND SURVEYORS
330 NORTH CENTRAL AVENUE
PARIS, ILLINOIS 61944
PH: (217) 465-5306
PROFESSIONAL DESIGN FIRM #184-001406

SCALES	DRAWN: TLT DATE: 8/20/10
PLAN: HOR. 1"=10' VERT. 1"=5'	CHECKED: _____ DATE: _____
REVISED: _____ DATE: _____	APPROVED: _____ DATE: _____
REVISED: _____ DATE: _____	REVISED: _____ DATE: _____

FRANCIS ASSOC.
FILE NO.
P-414

PLAN AND PROFILE - WOOD STREET (NORTH SIDE)

DOWNTOWN SIDEWALK IMPROVEMENTS - PHASE 2
CITY OF PARIS, ILLINOIS, EDGAR COUNTY

SHEET NO.
6
OF 7 SHEETS

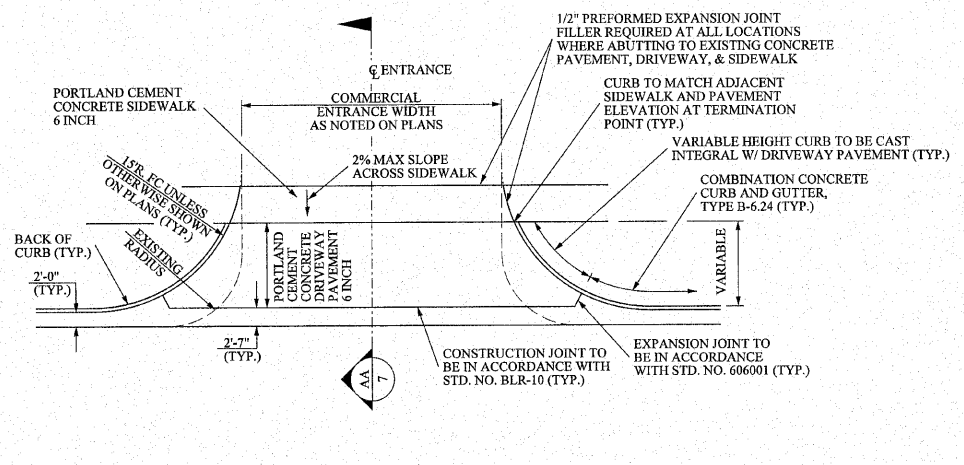

DETAIL OF COMMERCIAL/ ALLEY ENTRANCES WITH NEW SIDEWALK

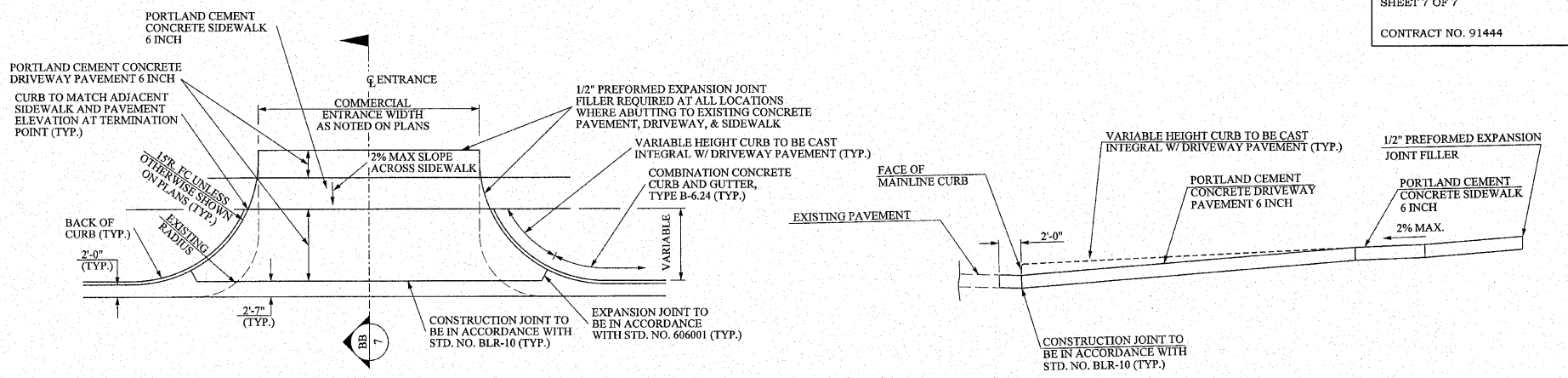

DETAIL OF COMMERCIAL/ ALLEY ENTRANCES WITH NEW PAVEMENT BEHIND NEW SIDEWALK

COMMERCIAL/ ALLEY ENTRANCES SECTION WITH NEW PAVEMENT BEHIND NEW SIDEWALK
NTS

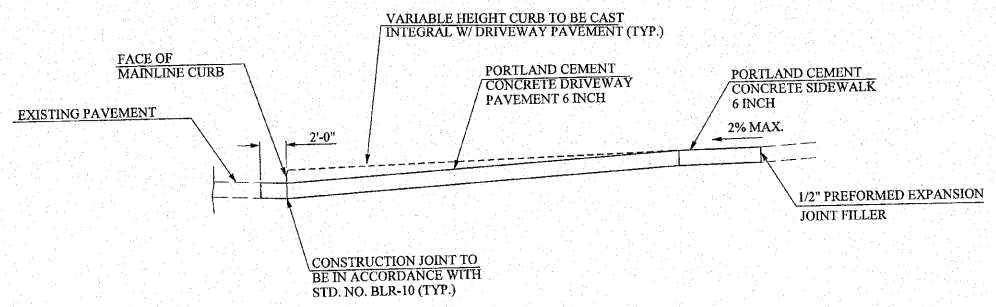

COMMERCIAL/ ALLEY ENTRANCES SECTION WITH NEW SIDEWALK
NTS

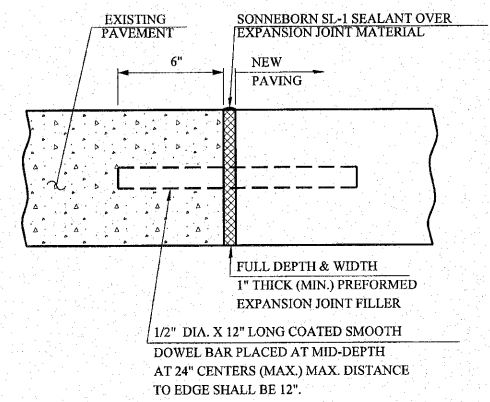

SIDEWALK EXPANSION JOINT SECTION
N.T.S.

