

NORTH EDGE OF APPROACH PAVEMENT

Location	Station	Offset	Theoretical Grade Elevations
End W. App. Pvmt.	2672.99	-12.00	632.45
A	2682.99	-12.00	632.40
B	2692.99	-12.00	632.35
Bk W. Abutment	2702.99	-12.00	632.31

PROFILE GRADE

Location	Station	Offset	Theoretical Grade Elevations
End W. App. Pvmt.	2679.92	0.00	632.60
A	2689.92	0.00	632.55
B	2699.92	0.00	632.51
Bk W. Abutment	2709.92	0.00	632.48

SOUTH EDGE OF APPROACH PAVEMENT

Location	Station	Offset	Theoretical Grade Elevations
End W. App. Pvmt.	2686.85	12.00	632.38
A	2696.85	12.00	632.34
B	2706.85	12.00	632.30
Bk W. Abutment	2716.85	12.00	632.28

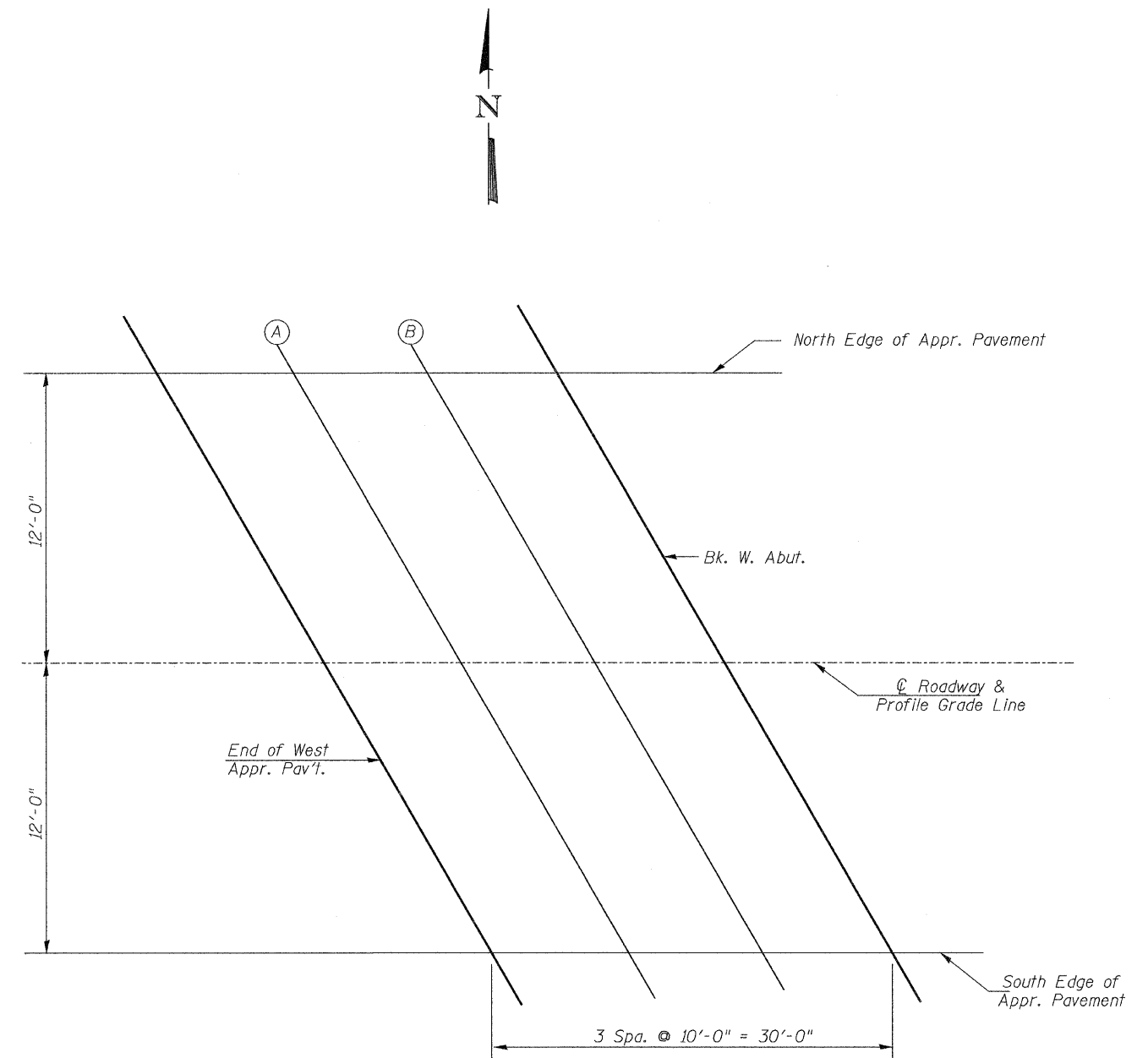

PLAN WEST APPROACH PAVEMENT

TOP OF WEST APPROACH PAVEMENT ELEVATIONS  
C.H. 12 OVER HICKS CREEK  
SECTION 07-00090-00-BR  
MACOUPIN COUNTY

SHEET NO. 5	ROUTE NO.	SECTION	COUNTY	TOTAL SHEETS	SHEET NO.
	CH 12	07-00090-00-BR	MACOUPIN	77	15
19 SHEETS	SN 059-3556		CONTRACT NO. 93538		
	FED. ROAD DIST. NO. 7 ILLINOIS		FED. AID PROJECT BRS-0732(148)		