

NORTH EDGE OF APPROACH PAVEMENT

Location	Station	Offset	Theoretical Grade Elevations
Bk E. Abutment	2793.99	-12.00	632.44
A	2803.99	-12.00	632.51
B	2813.99	-12.00	632.59
End E. App. Pvmt.	2823.99	-12.00	632.67

PROFILE GRADE

Location	Station	Offset	Theoretical Grade Elevations
Bk E. Abutment	2800.92	0.00	632.68
A	2810.92	0.00	632.75
B	2820.92	0.00	632.83
End E. App. Pvmt.	2830.92	0.00	632.92

SOUTH EDGE OF APPROACH PAVEMENT

Location	Station	Offset	Theoretical Grade Elevations
Bk E. Abutment	2807.85	12.00	632.54
A	2817.85	12.00	632.62
B	2827.85	12.00	632.71
End E. App. Pvmt.	2837.85	12.00	632.81

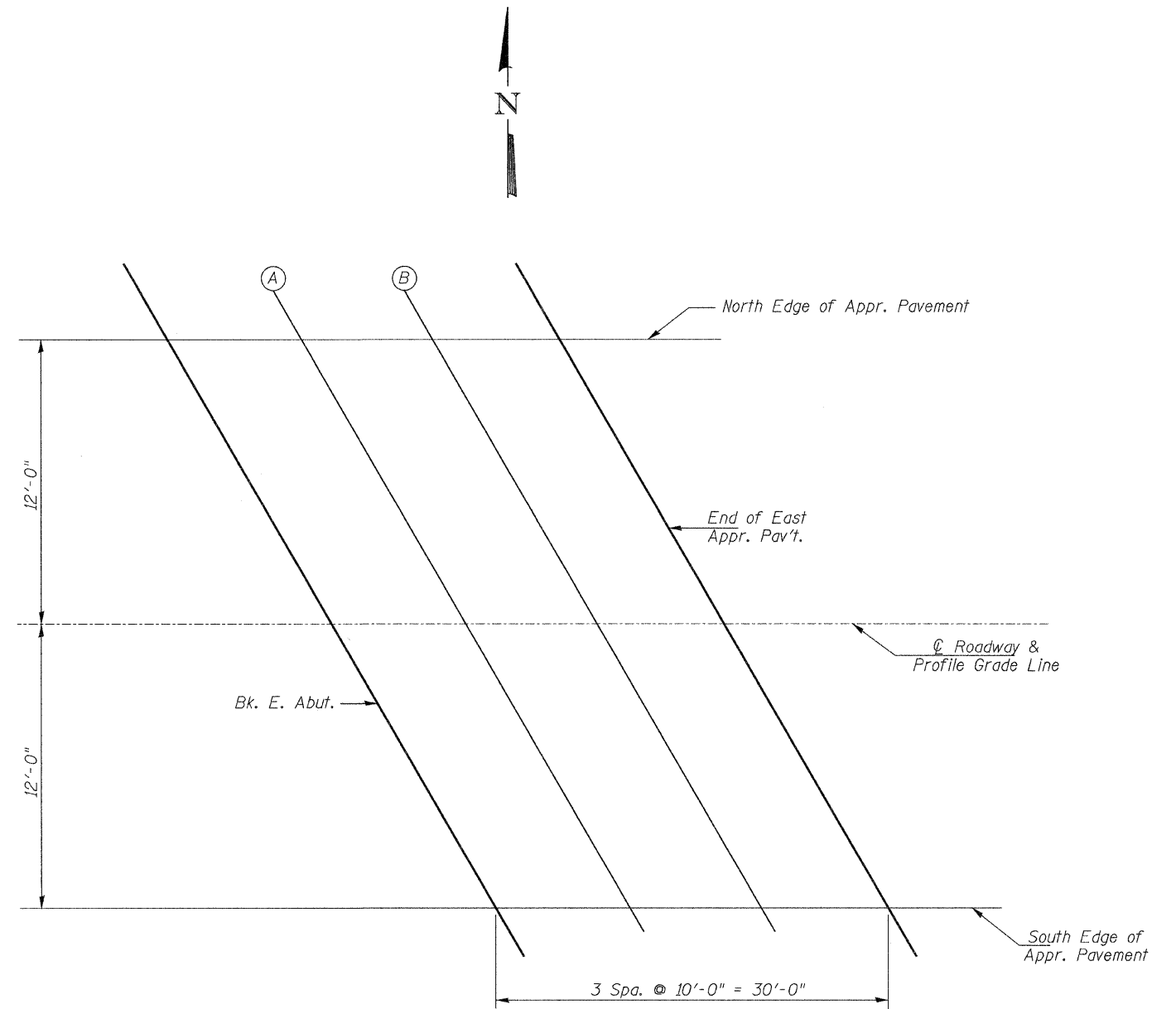

PLAN EAST APPROACH PAVEMENT

TOP OF EAST APPROACH PAVEMENT ELEVATIONS
C.H. 12 OVER HICKS CREEK
SECTION 07-00090-00-BR
MACOUPIN COUNTY

SHEET NO. 6	ROUTE NO.	SECTION	COUNTY	TOTAL SHEETS	SHEET NO.
	CH 12	07-00090-00-BR	MACOUPIN	77	16
19 SHEETS	SN 059-3556		CONTRACT NO. 93538		
	FED. ROAD DIST. NO. 7 ILLINOIS		FED. AID PROJECT BRS-0732(148)		