

PLAN

Notes:  
 See Sheet 8 of 22 for Superstructure Details and Bill of Material.  
 Bars indicated thus 20 x 3-#5 etc. indicates 20 lines of bars with 3 lengths per line.  
 See Sheets 9 & 10 of 22 for Section A-A and Diaphragm Details.

MIN. BAR LAP

#5 = 1'-8"

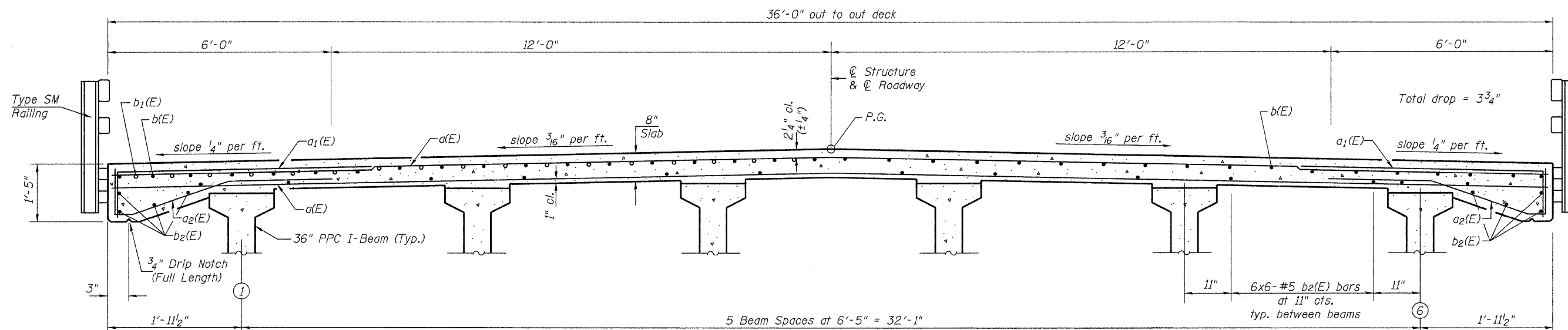

CROSS SECTION  
 (Looking East)

SUPERSTRUCTURE  
 C.H. 12 OVER JOES CREEK  
 SECTION 07-00090-00-BR  
 MACOUPIN COUNTY

SHEET NO. 7 22 SHEETS	ROUTE NO.	SECTION	COUNTY	TOTAL SHEETS	SHEET NO.
	CH 12	07-00090-00-BR	MACOUPIN	77	36
SN 059-3557			CONTRACT NO. 93538		
FED. ROAD DIST. NO. 7 ILLINOIS		FED. AID PROJECT BRS-0732(148)			