

PLAN ROUTE 9257  
 SECTION 06-00011-02-RP  
 COUNTY ST CLAIR  
 CONTRACT NO. 97448 ILLINOIS

**THOUVENOT, WADE & MOERCHEN, INC.**  
 ENGINEERS • SURVEYORS • PLANNERS



- CORPORATE OFFICE  
4940 OLD COLLINSVILLE RD.  
SPANGLA, ILLINOIS 62226  
TEL (618) 624-4488  
FAX (618) 624-6688  
info@twm-inc.com
- CARBONDALE OFFICE  
208 WEST COLLEGE STREET  
CARBONDALE, ILLINOIS 62901  
TEL (618) 549-8844  
FAX (618) 549-8450  
info@twm-inc.com
- EDWARDSVILLE OFFICE  
1015B CENTURY DRIVE  
EDWARDSVILLE, ILLINOIS 62025  
TEL (618) 656-4040  
FAX (618) 656-4343  
info@twm-inc.com
- ST. CHARLES OFFICE  
400 NORTH 5TH ST., SUITE 101  
ST. CHARLES, MISSOURI 63301  
TEL (636) 724-8300  
FAX (636) 724-8304  
info@twm-inc.com
- WATERLOO OFFICE  
113 SOUTH MAIN STREET  
WATERLOO, ILLINOIS 62298  
TEL (618) 939-0500  
FAX (618) 939-3938  
info@twm-inc.com

PROFESSIONAL REGISTRATIONS LICENSE NO.  
 ILLINOIS PROFESSIONAL DESIGN FIRM 184-001202  
 PROFESSIONAL ENGINEERING CORP. 62-053370  
 ILLINOIS PROFESSIONAL ENGINEERING CORP. 81-002022  
 MISSOURI PROFESSIONAL ENGINEERING CORP. 040-000029  
 MISSOURI PROFESSIONAL ENGINEERING CORP. NC 001538  
 MISSOURI LAND SURVEYING CORP. NC 000346

**EROSION CONTROL PLAN**  
**FULLERTON ROAD WIDENING**  
**VILLAGE OF SWANSEA**  
**ST CLAIR CO., ILLINOIS**

REV	DATE	DESCRIPTION

PLAN STATUS: **FINAL**  
 ISSUED FOR REVIEW     ISSUED FOR BIDDING  
 ISSUED FOR CONSTRUCTION     RECORD DRAWINGS  
 DRAWN BY: JUV    SHEET: **22**  
 DESIGNED BY: JUV    OF 63 SHEETS  
 CHECKED BY: RSD    PROJECT DESCRIPTION:  
 APPROVED BY: JUV  
 FILED NUMBER: T07050149

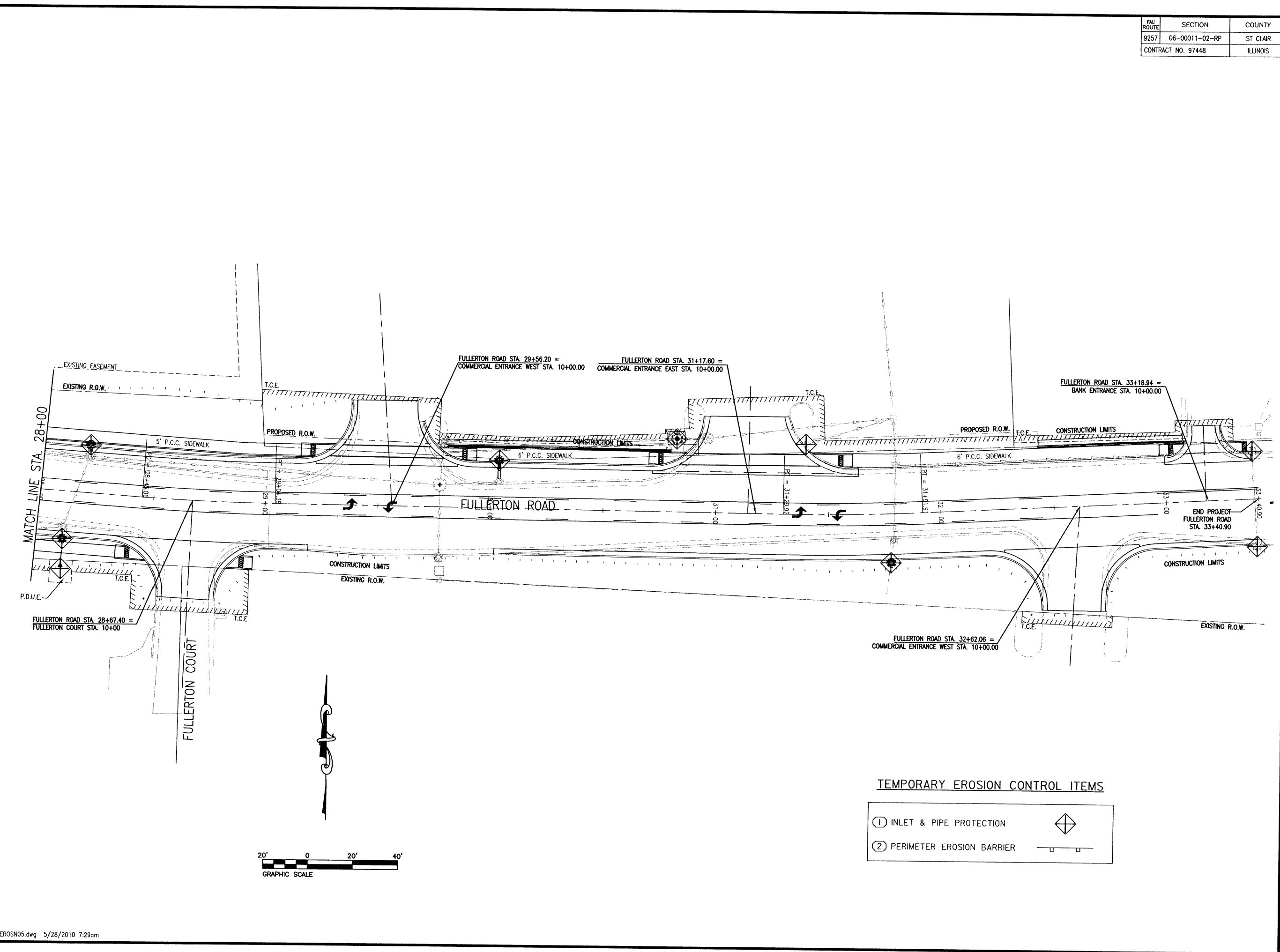

**TEMPORARY EROSION CONTROL ITEMS**

- ① INLET & PIPE PROTECTION
- ② PERIMETER EROSION BARRIER

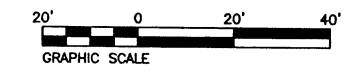

2:\050149\Fullerton Road\Construction Plans\050149EROSION.dwg Plotted By: mlzhu@twm.com 5/28/2010 7:29am