

STATE OF ILLINOIS
DEPARTMENT OF TRANSPORTATION

F.A.P. RTE.	SECTION	COUNTY	TOTAL SHEETS	SHEET NO.
653	(50-1HB)BRR	LASALLE	23	1
		ILLINOIS	CONTRACT NO. 66L98	

INDEX OF SHEETS

- 1. COVER SHEET
- 2. GENERAL NOTES
- 3 - 4. SUMMARY OF QUANTITIES
- 5 - 6. TYPICAL SECTIONS
- 7. SCHEDULES
- 8 - 10. TRAFFIC CONTROL AND PROTECTION FOR STAGE I CONSTRUCTION
- 11 - 13. TRAFFIC CONTROL AND PROTECTION FOR STAGE II CONSTRUCTION
- 14. GENERAL PLAN AND ELEVATION FOR STRUCTURE NO. 050-0215
- 15. DECK SLAB REPAIR DETAILS
- 16. DECK SLAB REPAIR "AS-BUILT" PLAN
- 17. PAVEMENT MARKING
- 18. TEMPORARY INFORMATION SIGNING
- 19 - 23. EXISTING STRUCTURE PLANS FOR STRUCTURE NO. 050-0215 "FOR INFORMATION ONLY"

STANDARDS

- 000001-08 STANDARD SYMBOLS, ABBREVIATIONS AND PATTERNS
- 001001-02 AREAS OF REINFORCEMENT BARS
- 001006 DECIMAL OF AN INCH AND OF A FOOT
- 482006-03 HMA SHOULDER ADJACENT TO RIGID PAVEMENT
- 701001-02 OFF-ROAD OPERATIONS 2L, 2W, MORE THAN 15' (4.5 m) AWAY
- 701006-05 OFF-ROAD OPERATIONS 2L, 2W, 15' (4.5 m) TO 24" (600 mm) FROM PAVEMENT EDGE
- 701011-04 OFF-ROAD MOVING OPERATIONS 2L, 2W, DAY ONLY
- 701101-05 OFF-ROAD OPERATIONS, MULTILANE, 15' (4.5 m) TO 24" (600 mm) FROM PAVEMENT EDGE
- 701106-02 OFF-ROAD OPERATIONS, MULTILANE, MORE THAN 15' (4.5 m) AWAY
- 701301-04 LANE CLOSURE, 2L, 2W, SHORT TIME OPERATIONS
- 701306-04 LANE CLOSURE, 2L, 2W, SLOW MOVING OPERATIONS DAY ONLY, FOR SPEEDS ≥ 45 MPH
- 701400-11 APPROACH TO LANE CLOSURE, FREEWAY/EXPRESSWAY
- 701406-13 LANE CLOSURE, FREEWAY/EXPRESSWAY, DAY OPERATIONS ONLY
- 701428-01 TRAFFIC CONTROL, SETUP AND REMOVAL, FREEWAY/EXPRESSWAY
- 701901-08 TRAFFIC CONTROL DEVICES

**PROPOSED
HIGHWAY PLANS**

**F.A.P. ROUTE 653 (IL 18)
SECTION (50-1HB)BRR
BRIDGE REPAIRS
LASALLE COUNTY**

C-93-100-21

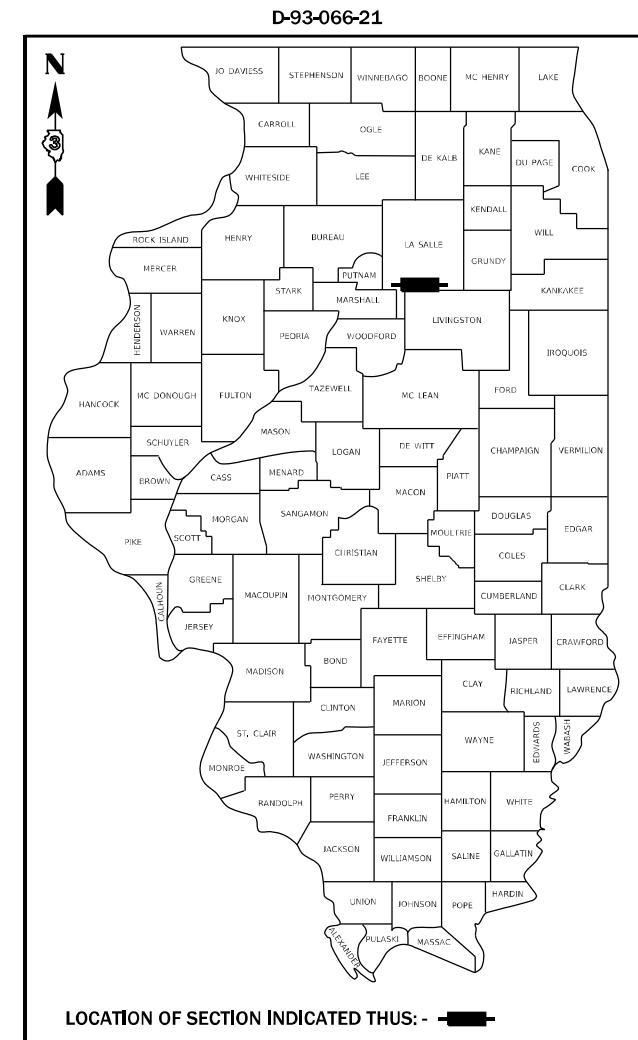

LOCATION OF SECTION INDICATED THIS: - [highlighted area]

FUNCTIONAL CLASSIFICATION

RURAL OTHER PRINCIPAL ARTERIAL

F.A.P. ROUTE 653 (IL 18)

2019 ADT = 3350

P.V. 84.8 % S.U. 4.8 % M.U. 10.4 %

STATE OF ILLINOIS
DEPARTMENT OF TRANSPORTATION

SUBMITTED October 19, 2021

David Arnold
REGIONAL ENGINEER

December 10, 2021
[Signature]
ENGINEER OF DESIGN AND ENVIRONMENT

December 10, 2021
Stephen M. Frank
DIRECTOR OF HIGHWAYS PROJECT IMPLEMENTATION

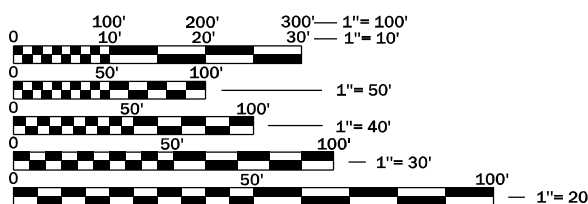

FULL SIZE PLANS HAVE BEEN PREPARED USING STANDARD ENGINEERING SCALES. REDUCED SIZED PLANS WILL NOT CONFORM TO STANDARD SCALES. IN MAKING MEASUREMENTS ON REDUCED PLANS, THE ABOVE SCALES MAY BE USED.

J.U.L.I.E.
JOINT UTILITY LOCATION INFORMATION FOR EXCAVATION
1-800-892-0123
OR 811

PROJECT ENGINEER: YOGESH PATEL P.E.
UNIT CHIEF: RON WOODSHANK
DISTRICT 3 NO. (815) 434-6131
CONTRACT NO. 66L98

PROJECT LOCATION
STRUCTURE NO. 050-0215
CARRYING F.A.P. ROUTE 653 (IL 18)
OVER F.A.I. ROUTE 39
STA. 486+61.56
APPROXIMATELY 1.05 MILES NORTH
OF THE MARSHALL COUNTY LINE

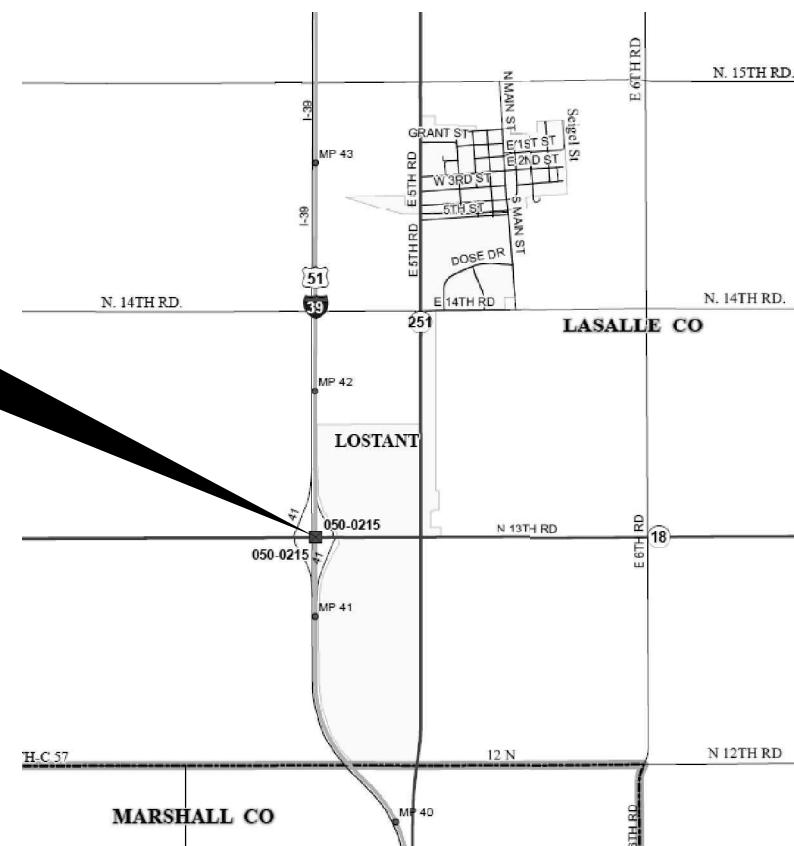

GENERAL NOTES

THE ENGINEER WILL BE THE SOLE JUDGE CONCERNING CURING TIME FOR THE VARIOUS HMA LIFTS.

ALL EXCAVATED MATERIALS SHALL BE REMOVED AND DISPOSED OF ACCORDING TO ARTICLE 202.03 OF THE STANDARD SPECIFICATIONS.

TRAFFIC CONTROL AND PROTECTION, STANDARD 701400, 701401 SHALL BE USED WHENEVER A LANE CLOSURE IS REQUIRED ON I-39 TO INSTALL AND REMOVE THE PROTECTIVE SHIELD.

THE FOLLOWING RATES OF APPLICATION HAVE BEEN USED IN CALCULATING PLAN QUANTITIES:

GRANULAR MATERIALS	2.05	TONS / CU YD
HMA RESURFACING	112	LBS / SQ YD / IN

MEMBERS OF JULIE KNOWN TO BE WITHIN THE LIMITS OF THE IMPROVEMENT ARE:

COMMITMENTS

THE ENGINEER SHALL SUBMIT TO THE BRIDGE OFFICE IN SPRINGFIELD A COPY OF THE "AS-BUILT" DECK SLAB REPAIR" PLANS WHEN ALL DECK SLAB REPAIRS HAVE BEEN COMPLETED. CONTACT PERSON IS VICTOR VELIZ PHONE (217) 782-2708 EMAIL Victor.Veliz@illinois.gov

HMA MIXTURE REQUIREMENT TABLE

LOCATION(S):	ENTIRE PROJECT	ENTIRE PROJECT
MIXTURE USE(S):	HMA SHOULDERS BOTTOM LIFT(S)	HMA SHOULDERS TOP LIFT
BINDER GRADE (PG):	PG64-22	PG64-22
DESIGN AIR VOIDS:	4.0% @ N70	4.0% @ N70
MIXTURE COMPOSITION: (MIXTURE GRADATION)	IL-19.0	IL 9.5
FRICTION AGGREGATE:		MIXTURE D
MIXTURE WEIGHT:	112.0 LB/SY/IN	112.0 LB/SY/IN
QUALITY MANAGEMENT PROGRAM:	QC/QA	QC/QA
SUBLOT SIZE:	N/A	N/A
DENSITY TEST METHOD:	CORES/CORRELATION	CORES/CORRELATION

STATE OF ILLINOIS
DEPARTMENT OF TRANSPORTATION
DISTRICT THREE
AS BUILT INFORMATION

SUPERVISING CONSTRUCTION FIELD ENGINEER

RESIDENT ENGINEER / TECHNICIAN

START & END DATES
OF CONSTRUCTION:

INSPECTORS:

STATE OF ILLINOIS
DEPARTMENT OF TRANSPORTATION
DISTRICT THREE

PREPARED BY: _____
DISTRICT STUDIES & PLANS ENGINEER

DATE: _____

EXAMINED BY: _____
DISTRICT CONSTRUCTION ENGINEER

DISTRICT MATERIALS ENGINEER

DISTRICT OPERATIONS ENGINEER

**STATE OF ILLINOIS
DEPARTMENT OF TRANSPORTATION**

GENERAL NOTES

SCALE: 50 SHEET 1 OF 1 SHEETS STA. TO STA.

F.A.P. RTE.	SECTION	COUNTY	TOTAL SHEETS	SHEET NO.
653	(50-1HB)BRR	LASALLE	23	2
			CONTRACT NO. 66L98	
		ILLINOIS FED. AID PROJECT		

MODEL: Default
 FILE NAME: p:\u0000\paw\bea\paw.com\FW\DOT\Documents\DOT Office\District 3\Project\31866198\CADD\31866198 - PLANS.dgn

CONSTRUCTION CODE
CONTRACT MAINTENANCE
100% STATE
BRIDGE
0047
S.N. 050-0215

CODE NO.	ITEM	UNIT	TOTAL QUANTITY	
20200500	EARTH EXCAVATION (WIDENING)	CU YD	76	76
40600290	BITUMINOUS MATERIALS (TACK COAT)	POUND	613	613
44004250	PAVED SHOULDER REMOVAL	SQ YD	1087	1087
48203037	HOT-MIX ASPHALT SHOULDERS, 10"	SQ YD	1357	1357
50157300	PROTECTIVE SHIELD	SQ YD	1138	1138
67100100	MOBILIZATION	L SUM	1	1
70100460	TRAFFIC CONTROL AND PROTECTION, STANDARD 701306	L SUM	1	1
70100700	TRAFFIC CONTROL AND PROTECTION, STANDARD 701406	L SUM	1	1
70103815	TRAFFIC CONTROL SURVEILLANCE	CAL DA	30	30
70107025	CHANGEABLE MESSAGE SIGN	CAL DA	30	30
70306120	TEMPORARY PAVEMENT MARKING - LINE 4" - TYPE III TAPE	FOOT	5097	5097
* 78008200	POLYUREA PAVEMENT MARKING TYPE I - LETTERS AND SYMBOLS	SQ FT	163	163
* 78008210	POLYUREA PAVEMENT MARKING TYPE I - LINE 4"	FOOT	3172	3172
* 78008240	POLYUREA PAVEMENT MARKING TYPE I - LINE 8"	FOOT	464	464

*= SPECIALTY ITEM

MODEL: Default
FILE: M:\cadd\p11\110524\w_bentley.com\PROJECTS\DOT\CHICAGO\DIR\CD\PROJECTS\DOT\CHICAGO\DIR\CD\0366L98 - PLANS.dgn

USER NAME = woodshankri	DESIGNED - RW	REVISED - RW 10/27/2021
	DRAWN - RW	REVISED -
PLOT SCALE = 100.0000' / in.	CHECKED - YP	REVISED -
PLOT DATE = 10/27/2021	DATE - 5/27/2021	REVISED -

**STATE OF ILLINOIS
DEPARTMENT OF TRANSPORTATION**

SUMMARY OF QUANTITIES

SCALE: 50 SHEET 1 OF 3 SHEETS STA. TO STA.

F.A.P. RTE.	SECTION	COUNTY	TOTAL SHEETS	SHEET NO.
653	(50-1H)BRR	LASALLE	23	3
			CONTRACT NO. 66L98	
ILLINOIS FED. AID PROJECT				

CODE NO.	ITEM	UNIT	TOTAL QUANTITY	CONSTRUCTION CODE	
				CONTRACT MAINTENANCE 100% STATE	BRIDGE
				0047	
				S.N. 050-0215	
78300202	PAVEMENT MARKING REMOVAL - WATER BLASTING	SQ FT	838		838
X7010216	TRAFFIC CONTROL AND PROTECTION, (SPECIAL)	L SUM	1		1
X7030005	TEMPORARY PAVEMENT MARKING REMOVAL	SQ FT	4329		4329
X7200201	WIDTH RESTRICTION SIGNING	L SUM	1		1
Z0016002	DECK SLAB REPAIR (FULL DEPTH, TYPE II)	SQ YD	107		107
Z0016200	DECK SLAB REPAIR (PARTIAL)	SQ YD	254		254
Z0030850	TEMPORARY INFORMATION SIGNING	SQ FT	42		42

MODEL: Default
 FILE NAME: p:\ultra-cw-beadby.com\FW\DOT\Documents\DOT Office\District 3\Project\3666\8\CADD\3666\08 - PLANS.dgn

USER NAME = woodshank1	DESIGNED - RW	REVISED - RW 10/27/2021
	DRAWN - RW	REVISED -
PLOT SCALE = 100,0000 ' / in.	CHECKED - YP	REVISED -
PLOT DATE = 10/27/2021	DATE - 5/27/2021	REVISED -

**STATE OF ILLINOIS
DEPARTMENT OF TRANSPORTATION**

SUMMARY OF QUANTITIES

SCALE: 50 SHEET 2 OF 3 SHEETS STA. TO STA.

F.A.P. RTE.	SECTION	COUNTY	TOTAL SHEETS	SHEET NO.
653	(50-1HB)BRR	LASALLE	23	4
			CONTRACT NO. 66L98	
		ILLINOIS	FED. AID PROJECT	

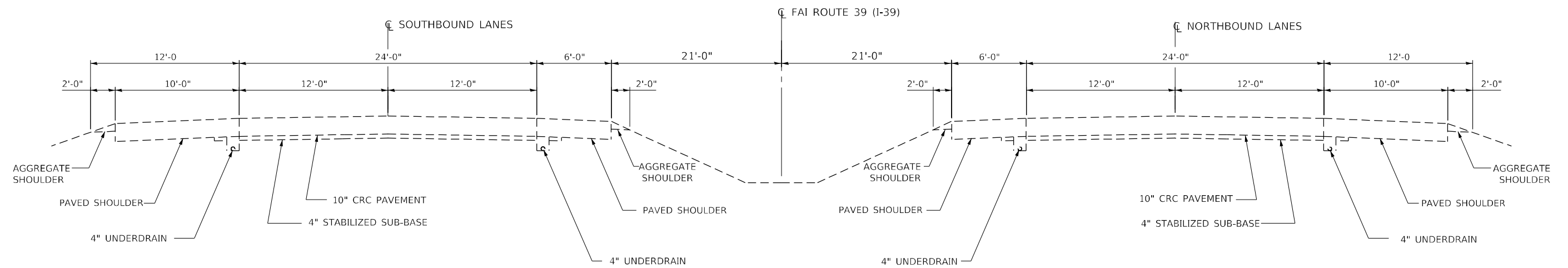

TYPICAL SECTION

INTERSTATE ROUTE 39

USER NAME = woodshank1 PLOT SCALE = 100,0000' / in. PLOT DATE = 10/27/2021	DESIGNED - RW DRAWN - RW CHECKED - YP DATE - 5/27/2021	REVISED - RW 10/27/2021 REVISED - REVISED - REVISED -	STATE OF ILLINOIS DEPARTMENT OF TRANSPORTATION	TYPICAL SECTION F.A.I. ROUTE 39 (I-39)	F.A.P. RTE. 653 SECTION (50-1HB)BRR COUNTY LASALLE TOTAL SHEETS 23 SHEET NO. 5 CONTRACT NO. 66L98	SCALE: 50 SHEET 1 OF 2 SHEETS STA. TO STA.	ILLINOIS FED. AID PROJECT
--	---	--	---	---	--	--	---------------------------

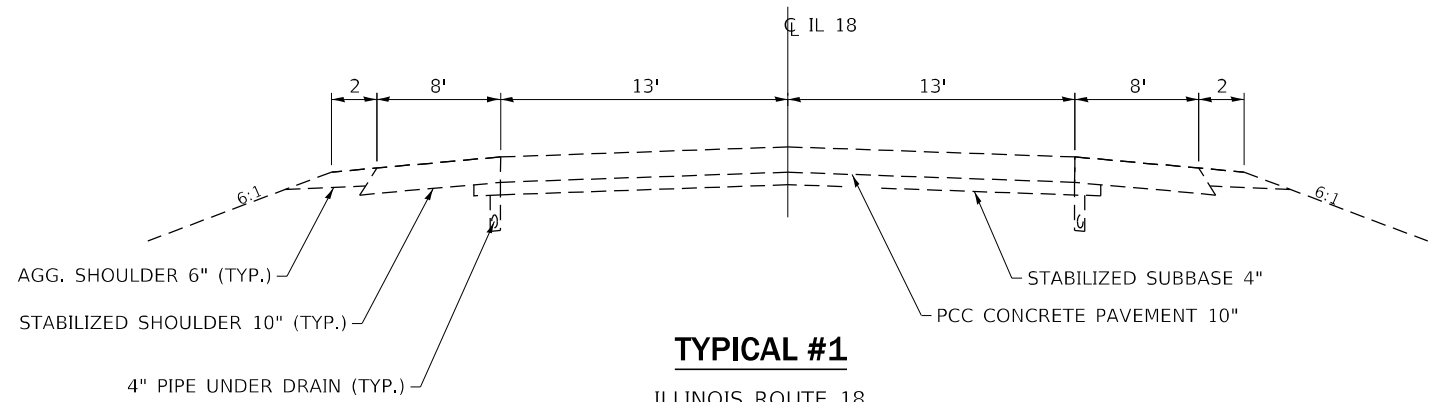

TYPICAL #1

ILLINOIS ROUTE 18
 STA. 332+15 TO STA. 338+00
 STA. 360+00 TO STA. 365+00

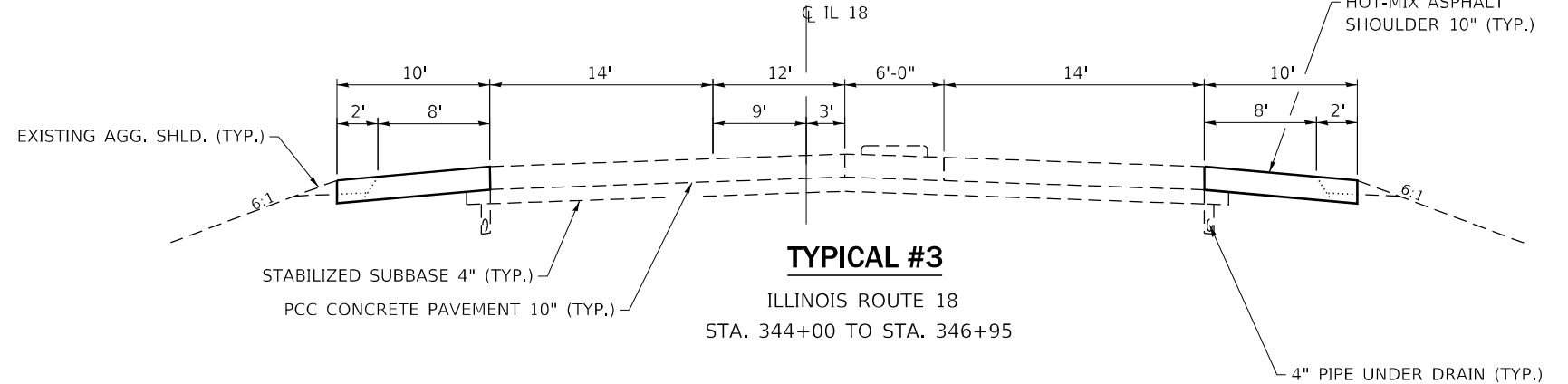

TYPICAL #3

ILLINOIS ROUTE 18
 STA. 344+00 TO STA. 346+95

STRUCTURE NO. 050-0215: STA. 346+95 TO STA. 349+64

STATIONING INCLUDES BRIDGE APPROACH SLABS

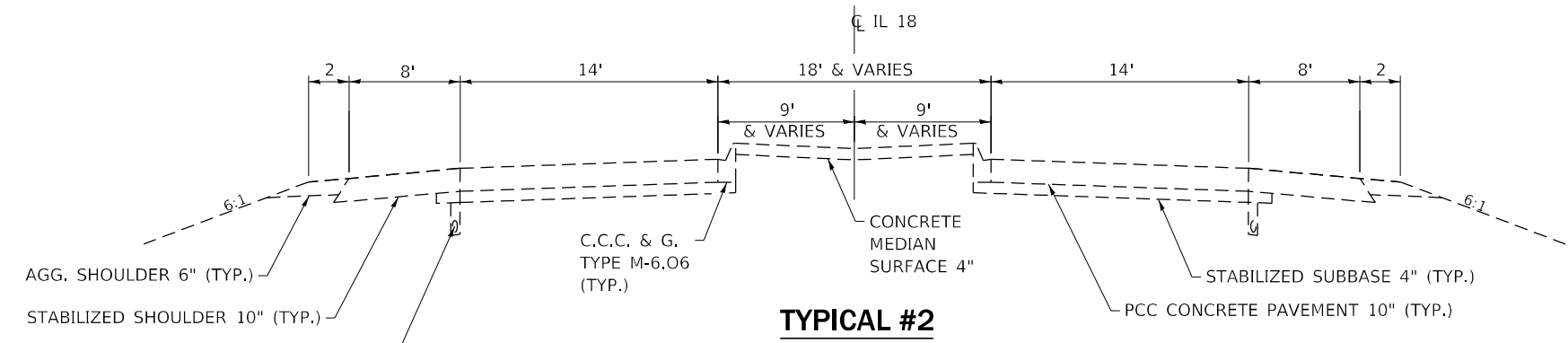

TYPICAL #2

ILLINOIS ROUTE 18
 STA. 338+00 TO STA. 344+00
 STA. 352+70 TO STA. 360+00

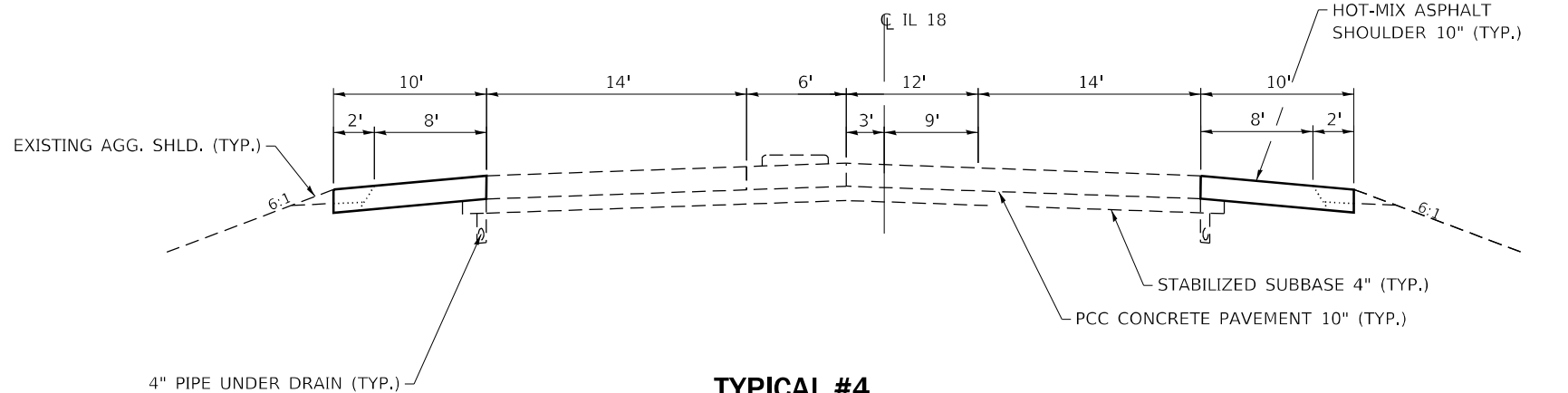

TYPICAL #4

ILLINOIS ROUTE 18
 STA. 349+64 TO STA. 363+70

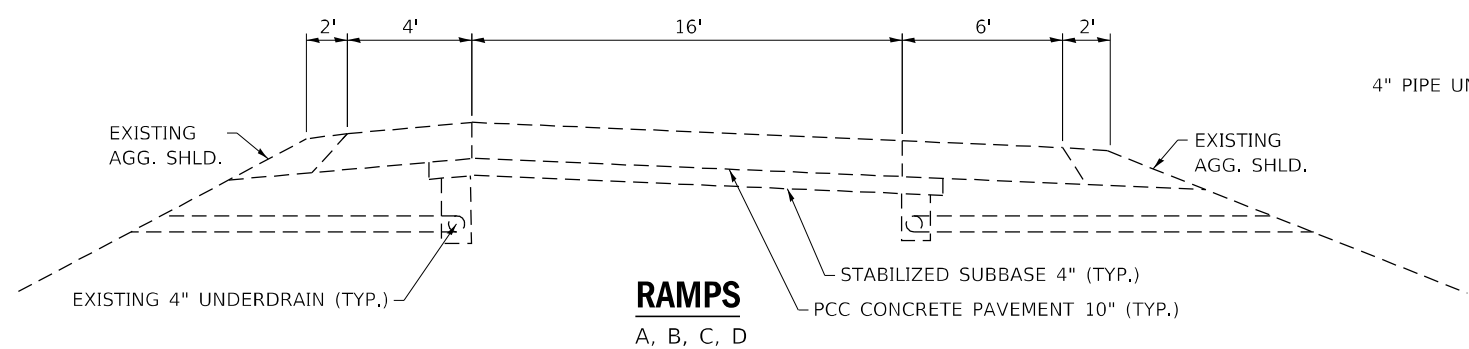

RAMPS

A, B, C, D

MODEL: Default
 FILE NAME: p:\project-cw-beadefy.com\FWIDOT\Documents\DOT Office\Dir\drct_3\Project\ID366198\CADD\Drawn\ID366198 - PLANS.dwg
 PROJECT: ID366198

USER NAME = woodshank1	DESIGNED - RW	REVISED - RW 10/27/2021
DRAWN - RW	CHECKED - YP	REVISED -
PLOT SCALE = 100,0000' / in.	DATE - 5/27/2021	REVISED -
PLOT DATE = 10/27/2021		

**STATE OF ILLINOIS
 DEPARTMENT OF TRANSPORTATION**

**TYPICAL SECTIONS
 F.A.P. ROUTE 653 (IL 18)**

SCALE: 50 SHEET 2 OF 2 SHEETS STA. TO STA.

F.A.P. RTE.	SECTION	COUNTY	TOTAL SHEETS	SHEET NO.
653	(50-1HB)BRR	LASALLE	23	6
CONTRACT NO. 66L98				
ILLINOIS FED. AID PROJECT				

SCHEDULES - PAVEMENT MARKING

LOCATION	PAVEMENT MARKING REMOVAL - WATERBLASTING				TEMPORARY PAVEMENT MARKING LINE 4" TYPE III TAPE		TEMPORARY PAVEMENT MARKING REMOVAL		POLYUREA PAVEMENT MARKING TYPE 1					
	SQ FT				FOOT		SQ FT		SQ FT		FOOT			
	L & S	LINE 4"		LINE 8"		YELLOW	WHITE	LINE 4"		L & S	LINE 4"		LINE 8"	
		YELLOW	WHITE	SOLID	SKIP-DASH			YELLOW	WHITE		YELLOW	WHITE	SOLID	SKIP-DASH
STAGE I	163		279	310	86		1692	0	558					
STAGE II						1414	1991	467	657	163	1478	1694	464 128	
TOTALS			838			5097		1682		163	3172		464	

SCHEDULE - SHOULDERS

LOCATION				EARTH EXCAVATION WIDENING	PAVED SHOULDER REMOVAL	BITUMINOUS MATERIALS (TACK COAT)	HOT-MIX ASPHALT SHOULDER 10"
STA.	TO	ST.	LT/RT	CU YD	SQ YD	POUND	SQ YD
PRESTAGE							
344+03	-	347+04	RT	19	268	151	334
349+56	-	352+67	RT	19	276	156	346
SUBTOTAL				38	544	307	680
STAGE I							
343+95	-	347+04	LT	19	275	155	343
349+56	-	352+57	LT	19	268	151	334
SUBTOTAL				38	543	306	677
TOTALS				76	1087	613	1357

MODEL: Default
 FILE NAME: p:\ultra-cw-bead-fy.com\FW\DOT\Documents\DOT Office\District 3\Project\366698\CADD\366698 - PLANS.dwg
 PROJECT: 366698

USER NAME = woodshank1	DESIGNED - RW	REVISED - RW 10/27/2021
	DRAWN - RW	REVISED -
PLOT SCALE = 100,0000' / in.	CHECKED - YP	REVISED -
PLOT DATE = 11/4/2021	DATE - 5/27/2021	REVISED -

**STATE OF ILLINOIS
DEPARTMENT OF TRANSPORTATION**

SCHEDULES			
SCALE: 50	SHEET 1 OF 1 SHEETS	STA.	TO STA.

F.A.P. RTE. 653	SECTION (50-1HB)BRR	COUNTY LASALLE	TOTAL SHEETS 23	SHEET NO. 7
			CONTRACT NO. 66L98	
ILLINOIS FED. AID PROJECT				

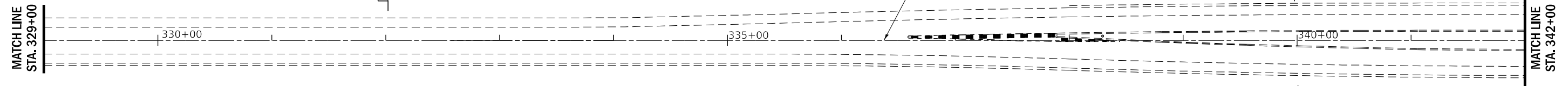
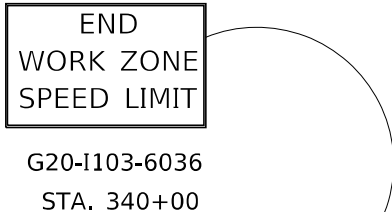
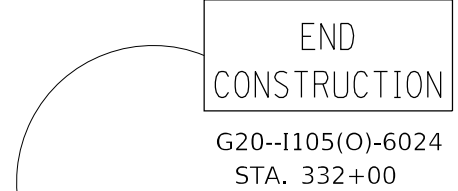
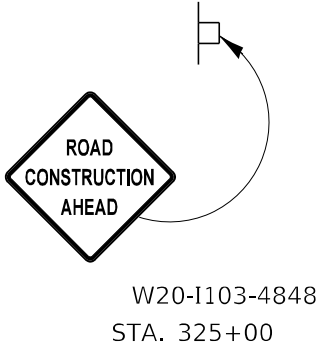
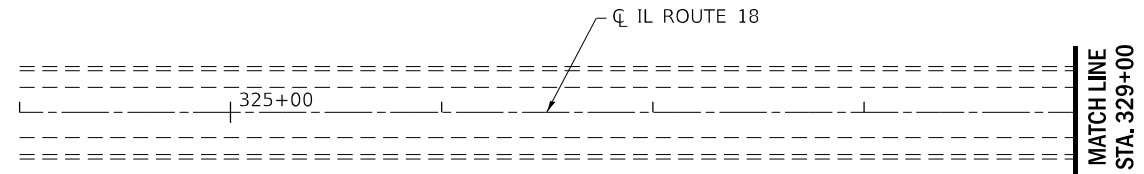

- W2-I115(FO)-3618
- R2-1-3648
- R10-19aP-3618
- R2-I106-3618
- STA. 335+00

WORK ZONE
SPEED LIMIT
45
PHOTO ENFORCED
\$XXX FINE MINIMUM

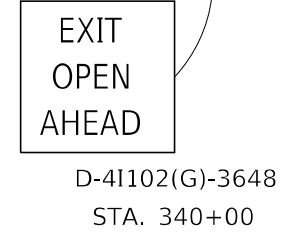

MODEL: Default
 FILE NAME: p:\ultra-cw-beadefy.com\FW\DOT\Documents\DOT Office\District 3\Project\I10366198\CADD\3618\10366198 - PLANS.dgn

USER NAME = woodshank1	DESIGNED - RW	REVISED - RW 10/27/2021
	DRAWN - RW	REVISED -
PLOT SCALE = 100,0000' / in.	CHECKED - YP	REVISED -
PLOT DATE = 10/27/2021	DATE - 5/27/2021	REVISED -

STATE OF ILLINOIS
DEPARTMENT OF TRANSPORTATION

TRAFFIC CONTROL AND PROTECTION FOR STAGE I CONSTRUCTION		
SCALE: 50	SHEET 1 OF 3 SHEETS	STA. 348+30 TO STA. 390+00

F.A.P. RTE.	SECTION	COUNTY	TOTAL SHEETS	SHEET NO.
653	(50-1H8)BRR	LASALLE	23	8
CONTRACT NO. 66L98			ILLINOIS FED. AID PROJECT	

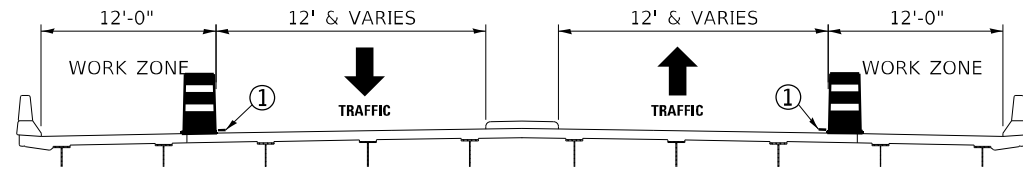

CROSS SECTION

① TEMPORARY PAVEMENT MARKING - LINE 4" (WHITE)

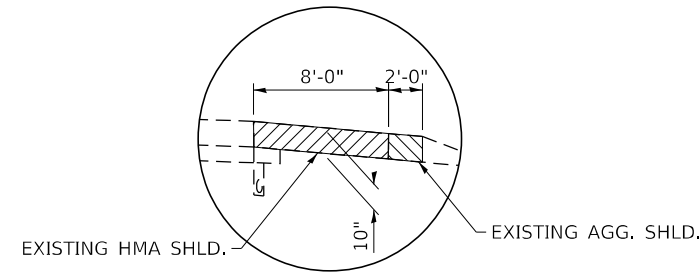

EXISTING SHOULDER CROSS SECTION

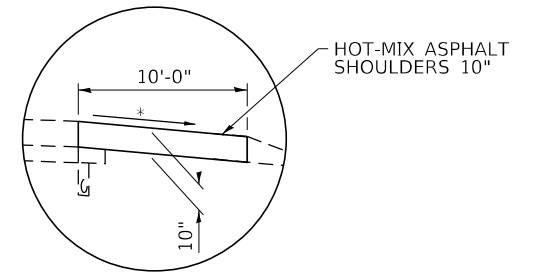

PROPOSED SHOULDER CROSS SECTION

*MATCH EXISTING SLOPE

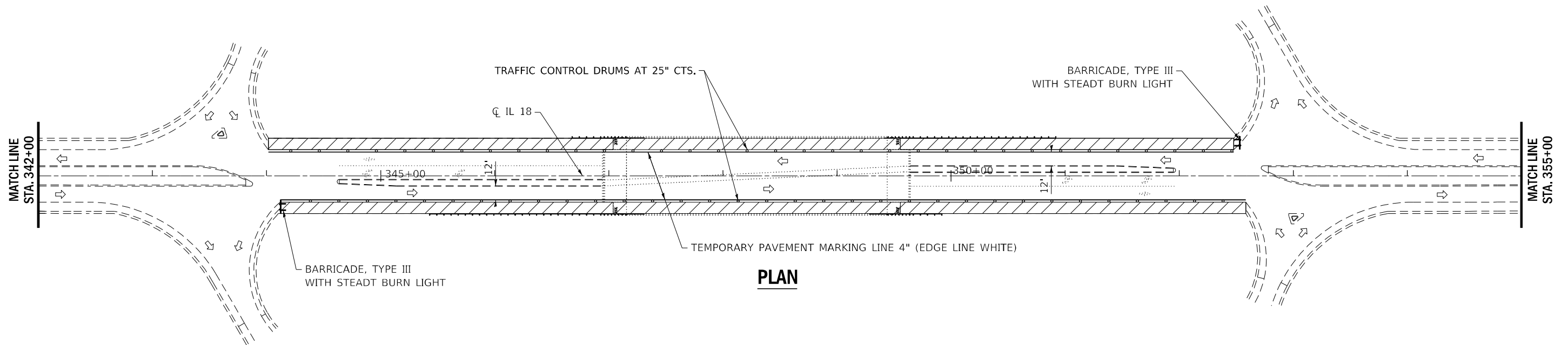

PLAN

NOTE:
TRAFFIC CONTROL AND PROTECTION, STANDARD 701306 SHALL BE UTILIZED IN CONJUNCTION WITH SHOULDER REMOVAL AND REPLACEMENT OPERATIONS.

MODEL: Default
 FILE NAME: p:\project-aw-beadley.com\FW\DOT\Documents\DOT Office\District 3\Project\366698\CADD\366698 - PLANS.dwg
 PROJECT: 366698

USER NAME = woodshank1	DESIGNED - RW	REVISED - RW 10/27/2021
DRAWN - RW	CHECKED - YP	REVISED -
PLOT SCALE = 100,0000' / in.	DATE - 5/27/2021	REVISED -
PLOT DATE = 10/27/2021		

**STATE OF ILLINOIS
DEPARTMENT OF TRANSPORTATION**

**TRAFFIC CONTROL AND PROTECTION
FOR STAGE I CONSTRUCTION**

SCALE: 50 SHEET 2 OF 3 SHEETS STA. TO STA.

F.A.P. RTE.	SECTION	COUNTY	TOTAL SHEETS	SHEET NO.
653	(50-1HB)BRR	LASALLE	23	9
CONTRACT NO. 66L98			ILLINOIS FED. AID PROJECT	



EXIT
OPEN
AHEAD

D-41102(G)-3648
STA. 356+00

WORK
ZONE
SPEED
LIMIT
45
PHOTO
ENFORCED
\$XXX FINE
MINIMUM

W2-I115(FO)-3618
R2-1-3648
R10-19aP-3618
R2-I106-3618
STA. 361+00



W3-5-4848
STA. 366+00

MATCH LINE
STA. 355+00

MATCH LINE
STA. 368+00

END
WORK ZONE
SPEED LIMIT

G20-I103-6036
STA. 358+00

END
CONSTRUCTION

G20-I105(O)-6024
STA. 365+00



W20-I103-4848
STA. 371+00

MATCH LINE
STA. 368+00

MATCH LINE
STA. 374+00

MODEL: Default
 FILE NAME: p:\ultra-cw-beadby.com\FW\DOT\Documents\DOT Office\District 3\Project\36668\36668\CD\36668\09 - PLANS.dgn
 PROJECT: 36668

USER NAME = woodshank1	DESIGNED - RW	REVISED - RW 10/27/2021
	DRAWN - RW	REVISED -
PLOT SCALE = 100,0000' / in.	CHECKED - YP	REVISED -
PLOT DATE = 10/27/2021	DATE - 5/27/2021	REVISED -

**STATE OF ILLINOIS
DEPARTMENT OF TRANSPORTATION**

**TRAFFIC CONTROL AND PROTECTION
FOR STAGE I CONSTRUCTION**

SCALE: 50 SHEET 3 OF 3 SHEETS STA. TO STA.

F.A.P. RTE.	SECTION	COUNTY	TOTAL SHEETS	SHEET NO.
653	(50-1HB)BRR	LASALLE	23	10
ILLINOIS FED. AID PROJECT			CONTRACT NO. 66L98	

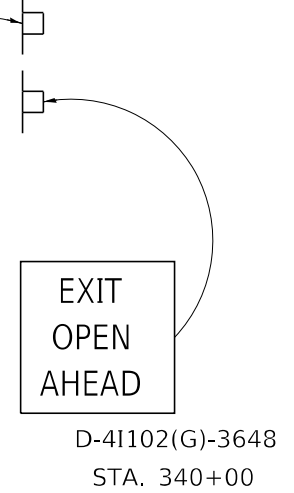
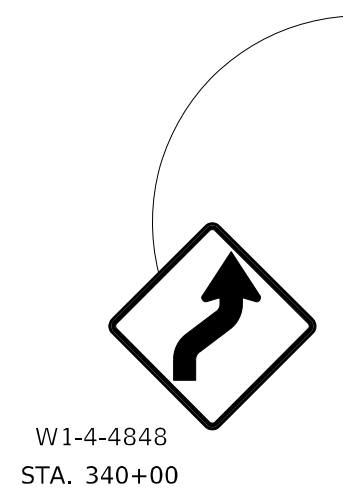
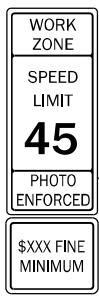
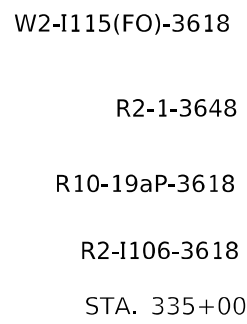
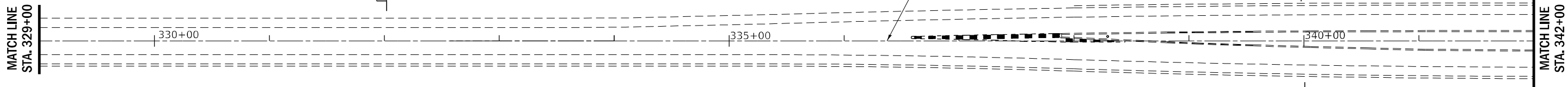
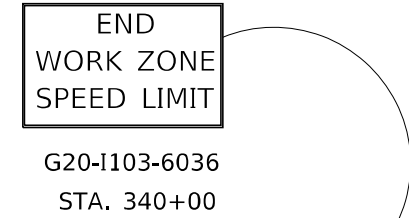
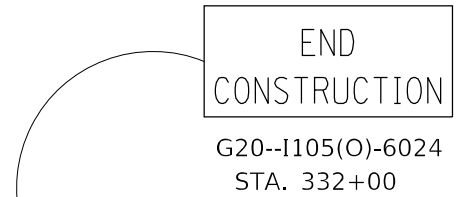
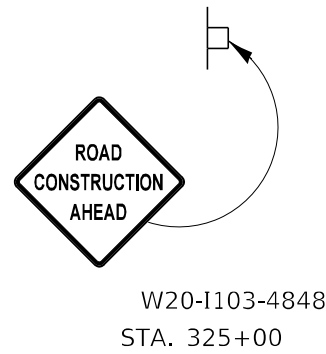
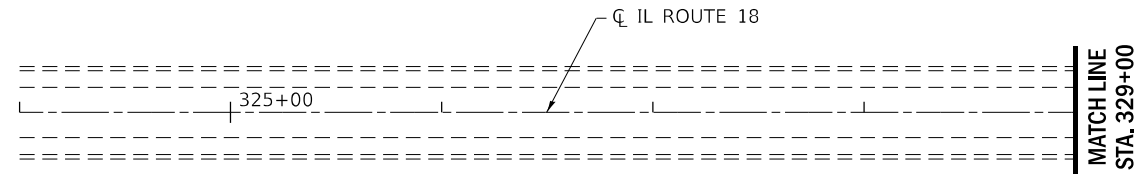

MODEL: Default
 FILE NAME: p:\ilidct-cw-beadefy.com\FW\DOT\Documents\DOT Office\District 3\Project\366698\CADD\366698 - PLANS.dgn

USER NAME = woodshank1	DESIGNED - RW	REVISED - RW 10/27/2021
	DRAWN - RW	REVISED -
PLOT SCALE = 100,0000' / in.	CHECKED - YP	REVISED -
PLOT DATE = 10/27/2021	DATE - 5/27/2021	REVISED -

**STATE OF ILLINOIS
DEPARTMENT OF TRANSPORTATION**

**TRAFFIC CONTROL AND PROTECTION
FOR STAGE II CONSTRUCTION**

SCALE: 50 SHEET 1 OF 3 SHEETS STA. TO STA.

F.A.P. RTE.	SECTION	COUNTY	TOTAL SHEETS	SHEET NO.
653	(50-1H8)BRR	LASALLE	23	11
CONTRACT NO. 66L98			ILLINOIS FED. AID PROJECT	

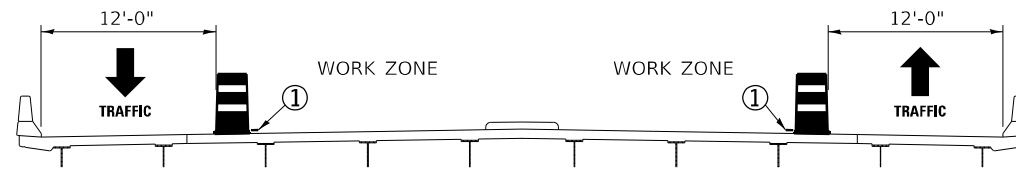

CROSS SECTION

- ① TEMPORARY PAVEMENT MARKING - LINE 4" (EDGE LINE WHITE)
- ② TEMPORARY PAVEMENT MARKING - LINE 4" (EDGE LINE YELLOW)
- ③ TEMPORARY PAVEMENT MARKING - LINE 4" (LANE LINE WHITE)

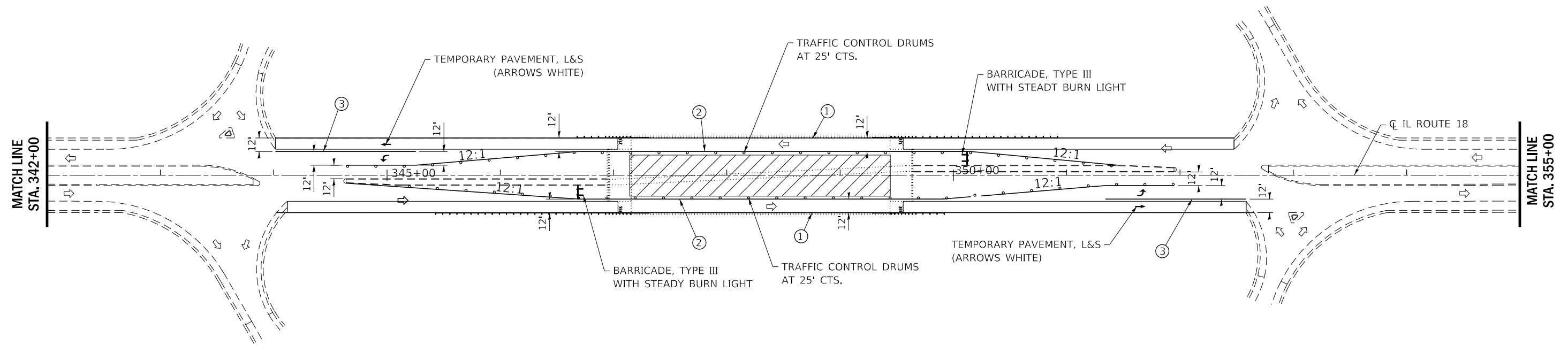

MODEL: Default
 FILE NAME: p:\ultra-cw-bead\paw.com\FW\DOT\Documents\DOT Office\District 3\Project\366698\CADD\366698 - PLANS.dwg
 PROJECT: 366698

USER NAME = woodshank1	DESIGNED - RW	REVISED - RW 10/27/2021
	DRAWN - RW	REVISED -
PLOT SCALE = 100,0000' / in.	CHECKED - YP	REVISED -
PLOT DATE = 10/27/2021	DATE - 5/27/2021	REVISED -

STATE OF ILLINOIS
DEPARTMENT OF TRANSPORTATION

TRAFFIC CONTROL AND PROTECTION
FOR STAGE II CONSTRUCTION

SCALE: 50 SHEET 2 OF 3 SHEETS STA. TO STA.

F.A.P. RTE. 653	SECTION (50-1HB)BRR	COUNTY LASALLE	TOTAL SHEETS 23	SHEET NO. 12
			CONTRACT NO. 66L98	
ILLINOIS FED. AID PROJECT				



EXIT
OPEN
AHEAD

D-41102(G)-3648
STA. 356+00

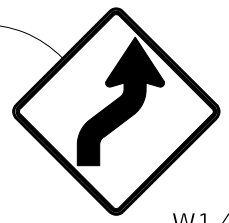

W1-4-4848
STA. 356+00

WORK
ZONE
SPEED
LIMIT
45
PHOTO
ENFORCED
\$XXX FINE
MINIMUM

W2-I115(FO)-3618
R2-1-3648
R10-19aP-3618
R2-I106-3618
STA. 361+00



W3-5-4848
STA. 366+00

END
WORK ZONE
SPEED LIMIT

G20-I103-6036
STA. 358+00

END
CONSTRUCTION

G20-I105(O)-6024
STA. 365+00



W20-I103-4848
STA. 371+00

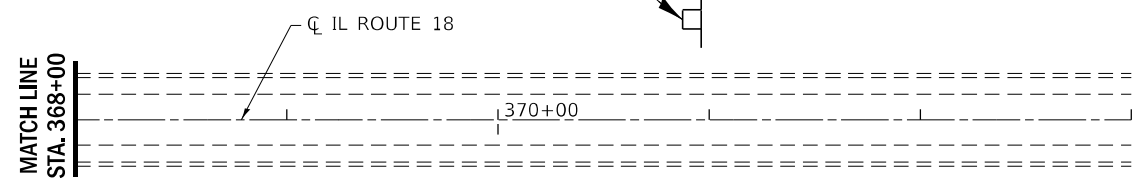
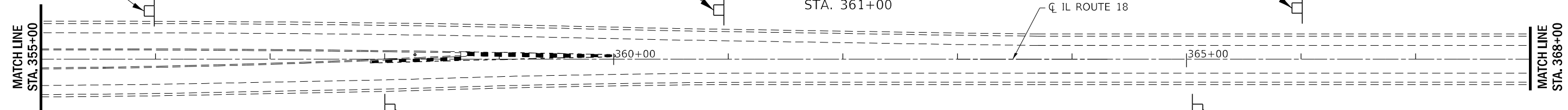

MODEL: Default
 FILE NAME: p:\ultra-cw-beadefy.com\FW\DOT\Documents\DOT Office\District 3\Project\366698\CADD\366698 - PLANS.dgn

USER NAME = woodshank1	DESIGNED - RW	REVISED - RW 10/27/2021
	DRAWN - RW	REVISED -
PLOT SCALE = 100,0000' / in.	CHECKED - YP	REVISED -
PLOT DATE = 10/27/2021	DATE - 5/27/2021	REVISED -

**STATE OF ILLINOIS
DEPARTMENT OF TRANSPORTATION**

**TRAFFIC CONTROL AND PROTECTION
FOR STAGE II CONSTRUCTION**

SCALE: 50 SHEET 3 OF 3 SHEETS STA. TO STA.

F.A.P. RTE.	SECTION	COUNTY	TOTAL SHEETS	SHEET NO.
653	(50-1HB)BRR	LASALLE	23	13
ILLINOIS FED. AID PROJECT			CONTRACT NO. 66L98	

GENERAL NOTES

PLAN DIMENSIONS AND DETAILS RELATIVE TO EXISTING PLANS ARE SUBJECT TO NOMINAL CONSTRUCTION VARIATIONS. THE CONTRACTOR SHALL FIELD VERIFY EXISTING DIMENSIONS AND DETAILS AFFECTING NEW CONSTRUCTION AND MAKE NECESSARY APPROVED ADJUSTMENTS PRIOR TO CONSTRUCTION OR ORDERING OF MATERIALS. SUCH VARIATIONS SHALL NOT BE CAUSE FOR ADDITIONAL COMPENSATION FOR A CHANGE IN SCOPE OF THE WORK, HOWEVER, THE CONTRACTOR WILL BE PAID FOR THE QUANTITY ACTUALLY FURNISHED AT THE UNIT PRICE BID FOR THE WORK.

PROTECTIVE COAT SHALL BE APPLIED TO THE SURFACES OF ALL NEW CONCRETE. REINFORCEMENT BARS DESIGNATED (E) SHALL BE EPOXY COATED.

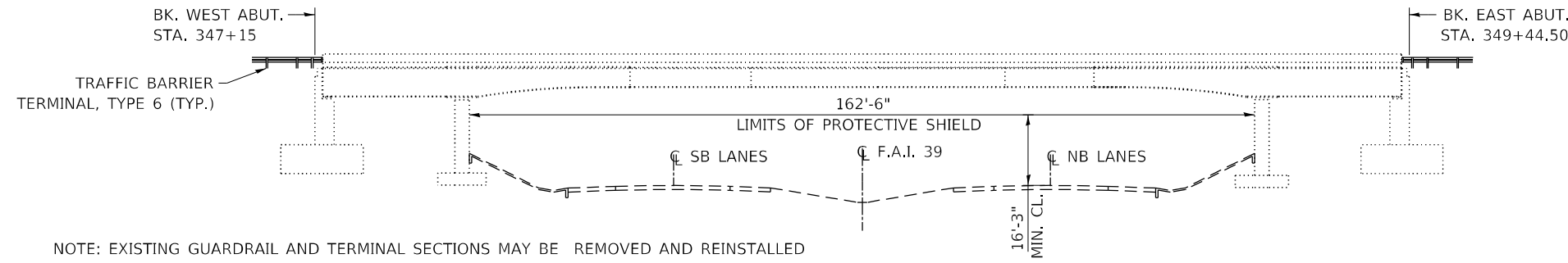

ELEVATION

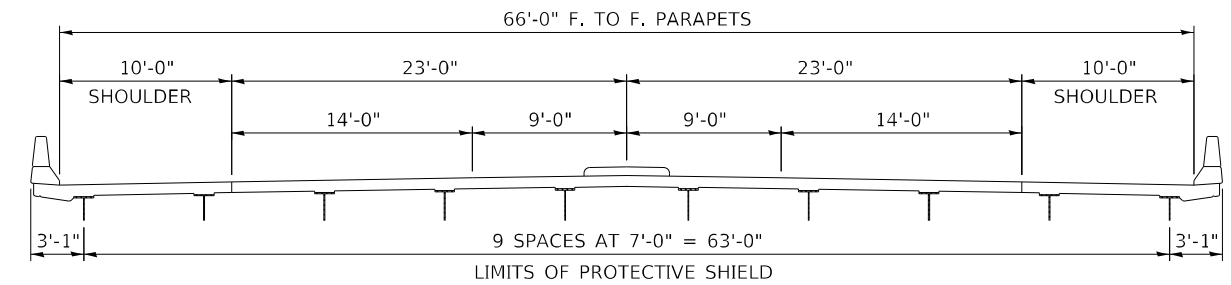

CROSS SECTION

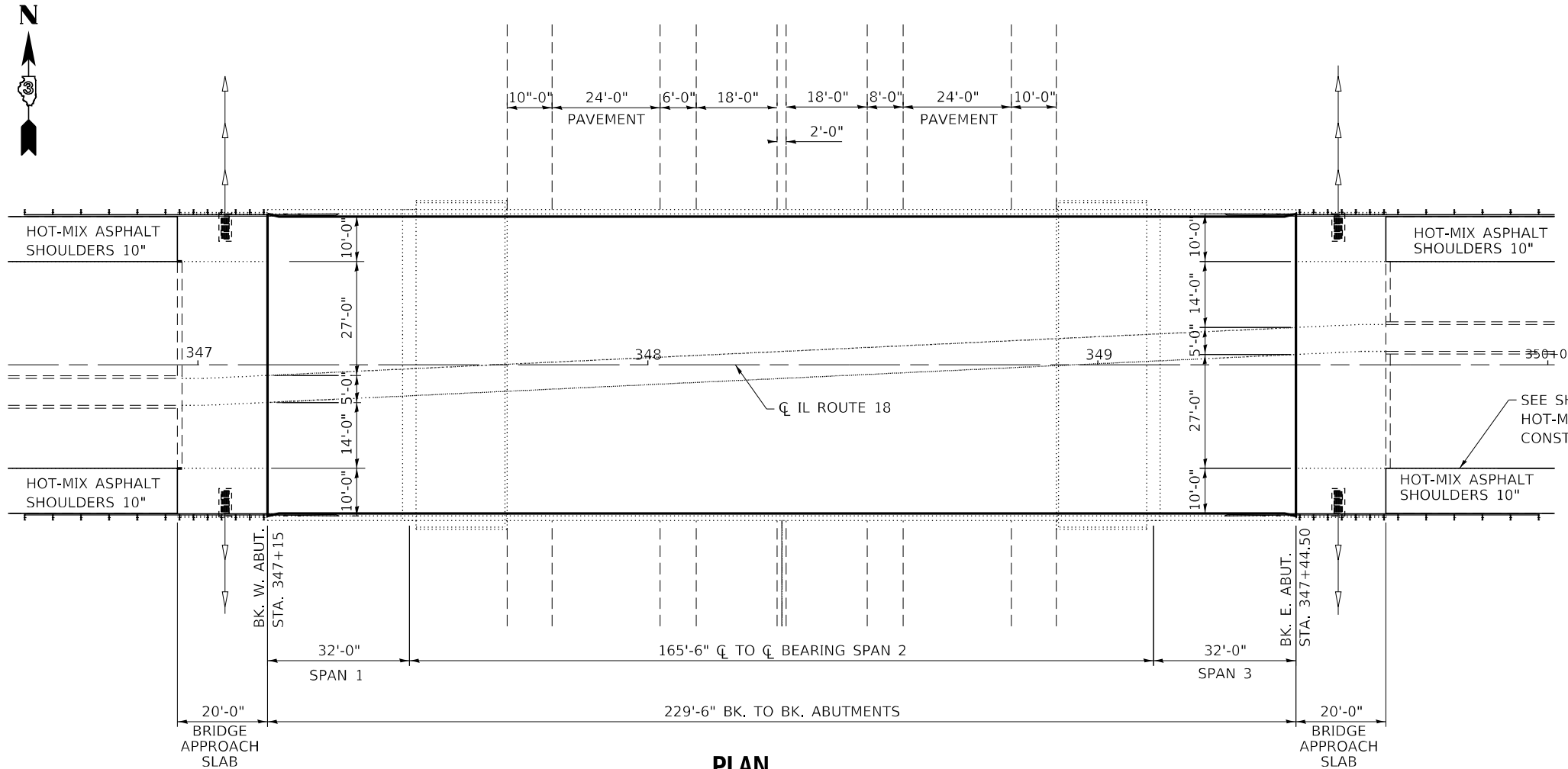

PLAN STRUCTURE NO. 050-0215



Expires 11-30-2022

David Carl Puzev

TOTAL BILL OF MATERIAL

ITEM	UNIT	TOTAL
PROTECTIVE SHIELD	SQ. YD.	1138
DECK SLAB REPAIR (FULL DEPTH, TYPE II)	SQ. YD.	107
DECK SLAB REPAIR (PARTIAL)	SQ. YD.	254

MODEL: Default
FILE NAME: p:\projects\paw_bentley.com\FWIDOT\Documents\DOT Office\Drawings\Projects\050-0215\050-0215-PLANS.dwg

USER NAME = woodshank1	DESIGNED - RW	REVISED - RW 10/27/2021
PLOT SCALE = 100,0000 ' / in.	DRAWN - RW	REVISED - RW 11/20/2021
PLOT DATE = 11/20/2021	CHECKED - YP	REVISED -
	DATE - 5/27/2021	REVISED -

STATE OF ILLINOIS
DEPARTMENT OF TRANSPORTATION

GENERAL PLAN AND ELEVATION
STRUCTURE NO. 050-0215
STA. 486 + 61.56

SCALE: 50 SHEET 1 OF 3 SHEETS STA. TO STA.

F.A.P. RTE. 653	SECTION (50-1HB)BRR	COUNTY LASALLE	TOTAL SHEETS 23	SHEET NO. 14
ILLINOIS FED. AID PROJECT			CONTRACT NO. 66L98	

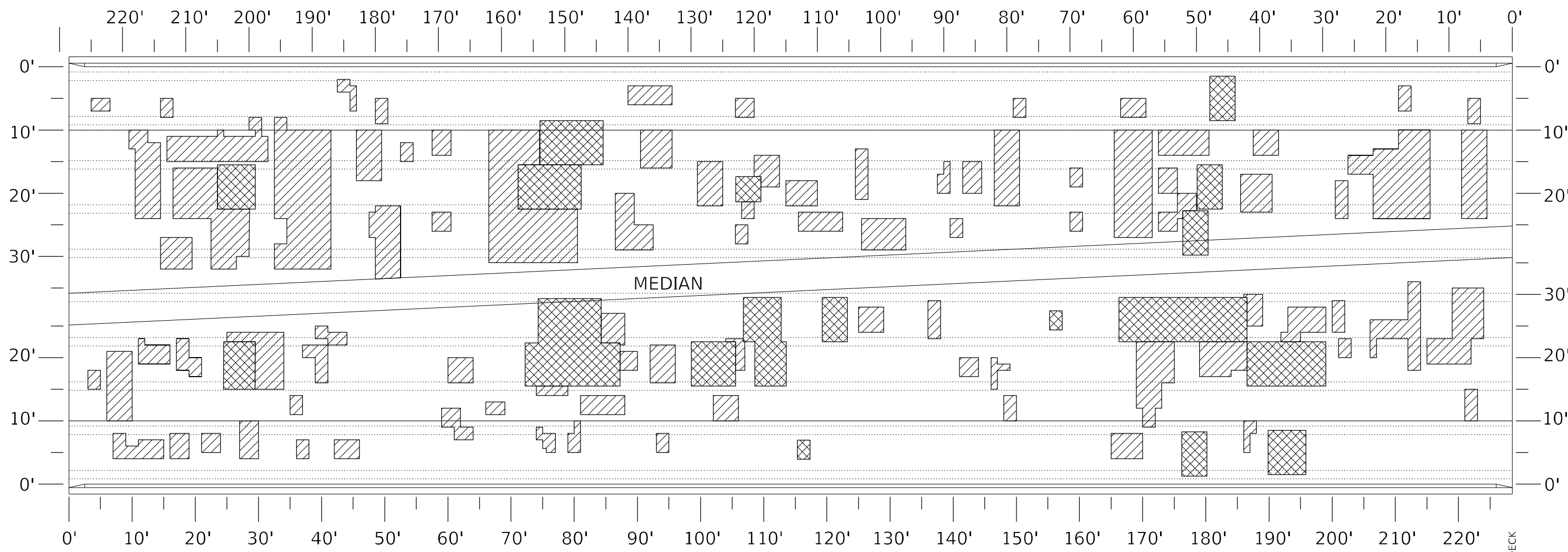

WEST END OF DECK
STA. 347+15

EAST END OF DECK
STA. 349+44

LEGEND

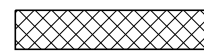

DECK SLAB REPAIR (FULL DEPTH, TYPE II)



DECK SLAB REPAIR (PARTIAL DEPTH)

NOTE:
THE DECK SLAB REPAIR LOCATION AREAS SHOWN ARE APPROXIMATE
AND THE QUANTITIES ARE ESTIMATED.
THE ENGINEER SHALL SOUND THE ENTIRE DECK SLAB AREA
AT TIME OF CONSTRUCTION FOR ACTUAL REPAIR AREAS.

SEE COMMITMENTS.

**DECK SLAB REPAIRS
BILL OF MATERIAL**

ITEM	UNIT	TOTAL
DECK SLAB REPAIR (FULL DEPTH, TYPE II)	SQ. YD.	107
DECK SLAB REPAIR (PARTIAL)	SQ. YD.	254

MODEL: Default
 FILE NAME: p:\project-cw\beadwy.com\FWIDOT\Documents\DOT Office\District 3\Project\346668\CADD\346668 - PLANS.dwg

USER NAME = woodshank1	DESIGNED - RW	REVISED - RW 10/27/2021
	DRAWN - RW	REVISED - RW 11/20/2021
PLOT SCALE = 100,0000' / in.	CHECKED - YP	REVISED -
PLOT DATE = 11/20/2021	DATE - 5/27/2021	REVISED -

**STATE OF ILLINOIS
DEPARTMENT OF TRANSPORTATION**

DECK SLAB REPAIR DETAILS

SCALE: 50 SHEET 2 OF 3 SHEETS STA. TO STA.

F.A.P. RTE.	SECTION	COUNTY	TOTAL SHEETS	SHEET NO.
653	(50-1HB)BRR	LASALLE	23	15
			CONTRACT NO. 66L98	
ILLINOIS FED. AID PROJECT				

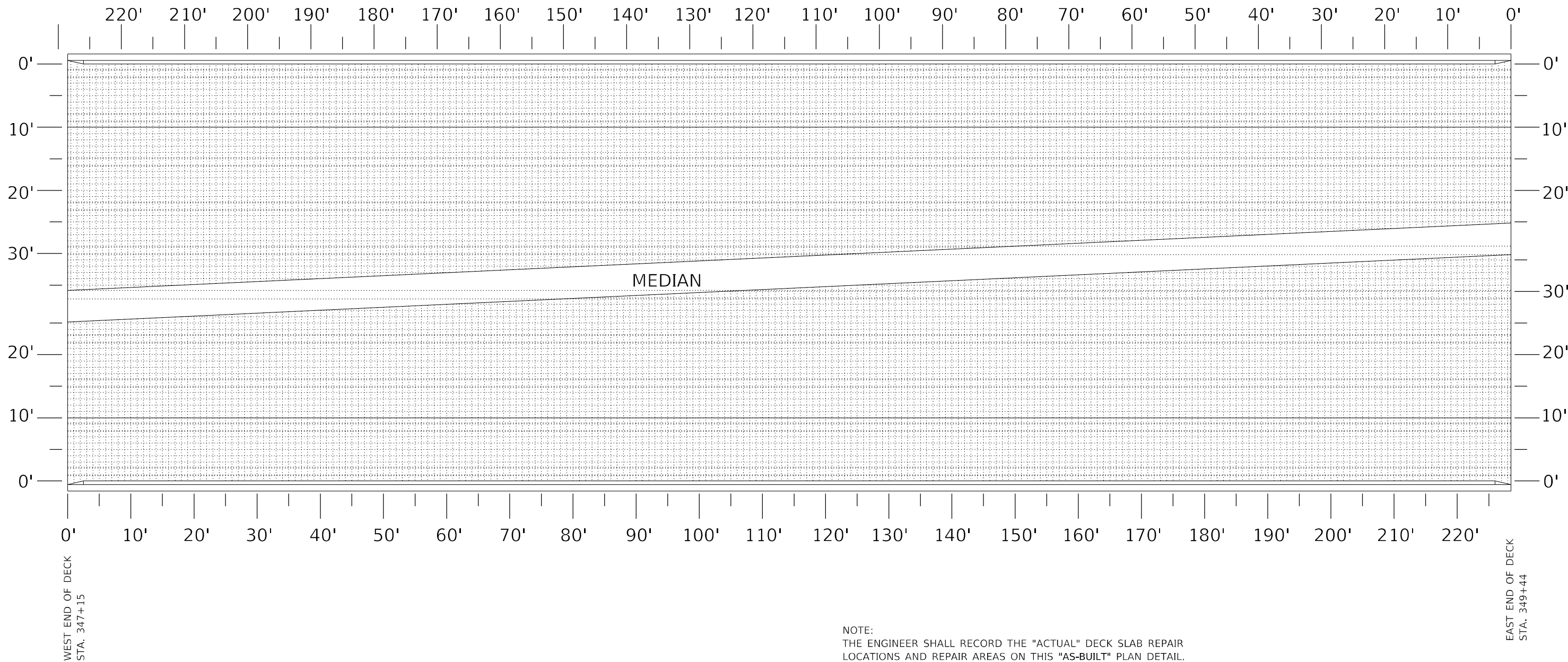

NOTE:
 THE ENGINEER SHALL RECORD THE "ACTUAL" DECK SLAB REPAIR
 LOCATIONS AND REPAIR AREAS ON THIS "AS-BUILT" PLAN DETAIL.
 SEE COMMITMENTS.

MODEL: Default
 FILE NAME: p:\ultra-cw-beadby.com\FWIDOT\Documents\DOT Office\District 3\Project\366198\CADD\366198 - PLAN.dwg

USER NAME = woodshank1	DESIGNED - RW	REVISED - RW 10/27/2021
PLOT SCALE = 100,0000' / in.	DRAWN - RW	REVISED - RW 11/20/2021
PLOT DATE = 11/20/2021	CHECKED - YP	REVISED -
	DATE - 5/27/2021	REVISED -

STATE OF ILLINOIS
DEPARTMENT OF TRANSPORTATION

DECK SLAB REPAIR
"AS-BUILT" PLAN

SCALE: 50 SHEET 3 OF 3 SHEETS STA. TO STA.

F.A.P. RTE.	SECTION	COUNTY	TOTAL SHEETS	SHEET NO.
653	(50-1HB)BRR	LASALLE	23	16
CONTRACT NO. 66L98				
ILLINOIS FED. AID PROJECT				

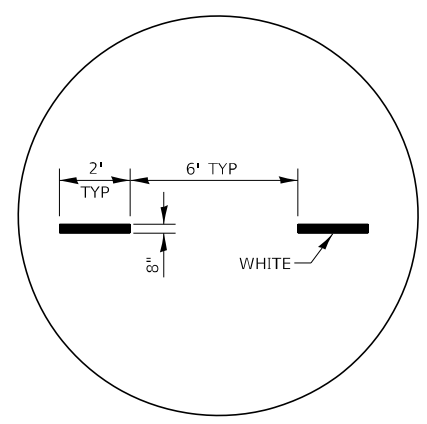
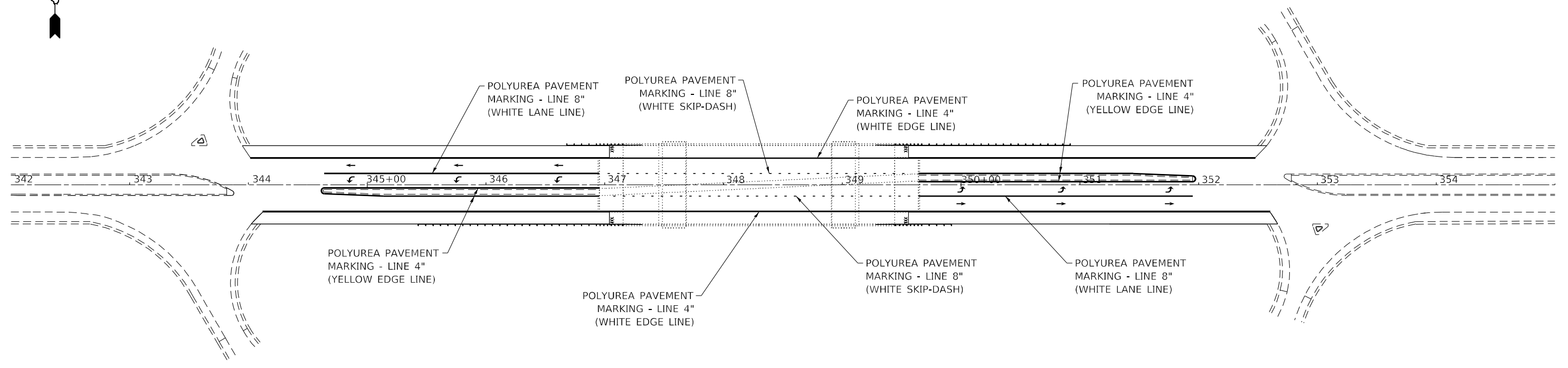

LANE LINE (SKIP-DASH)

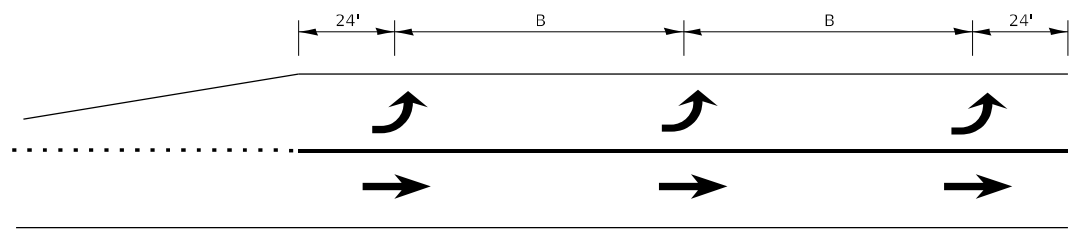

150' AND LONGER

**TYPICAL PLACEMENT OF ARROWS
IN TURN LANES**

MODEL: Default
 FILE NAME: p:\ultra-cw-beadby.com\FW\DOT\Documents\DOT Office\District 3\Project\ID366198\CADD\Drawn\ID366198 - PLANS.dwg
 PROJECT: ID366198

USER NAME = woodshank1	DESIGNED - RW	REVISED - RW 10/27/2021
PLOT SCALE = 100,0000' / in.	DRAWN - RW	REVISIED -
PLOT DATE = 10/27/2021	CHECKED - YP	REVISIED -
	DATE - 5/27/2021	REVISIED -

**STATE OF ILLINOIS
DEPARTMENT OF TRANSPORTATION**

PAVEMENT MARKING

SCALE: 50 SHEET 1 OF 1 SHEETS STA. TO STA.

F.A.P. RTE.	SECTION	COUNTY	TOTAL SHEETS	SHEET NO.
653	(50-1HB)BRR	LASALLE	23	17
CONTRACT NO. 66L98				
ILLINOIS FED. AID PROJECT				

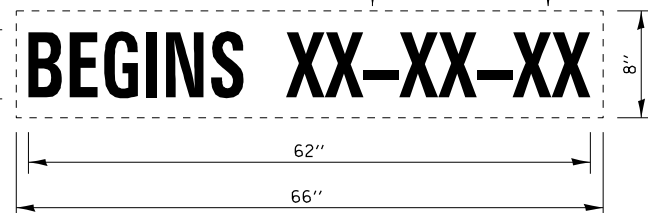
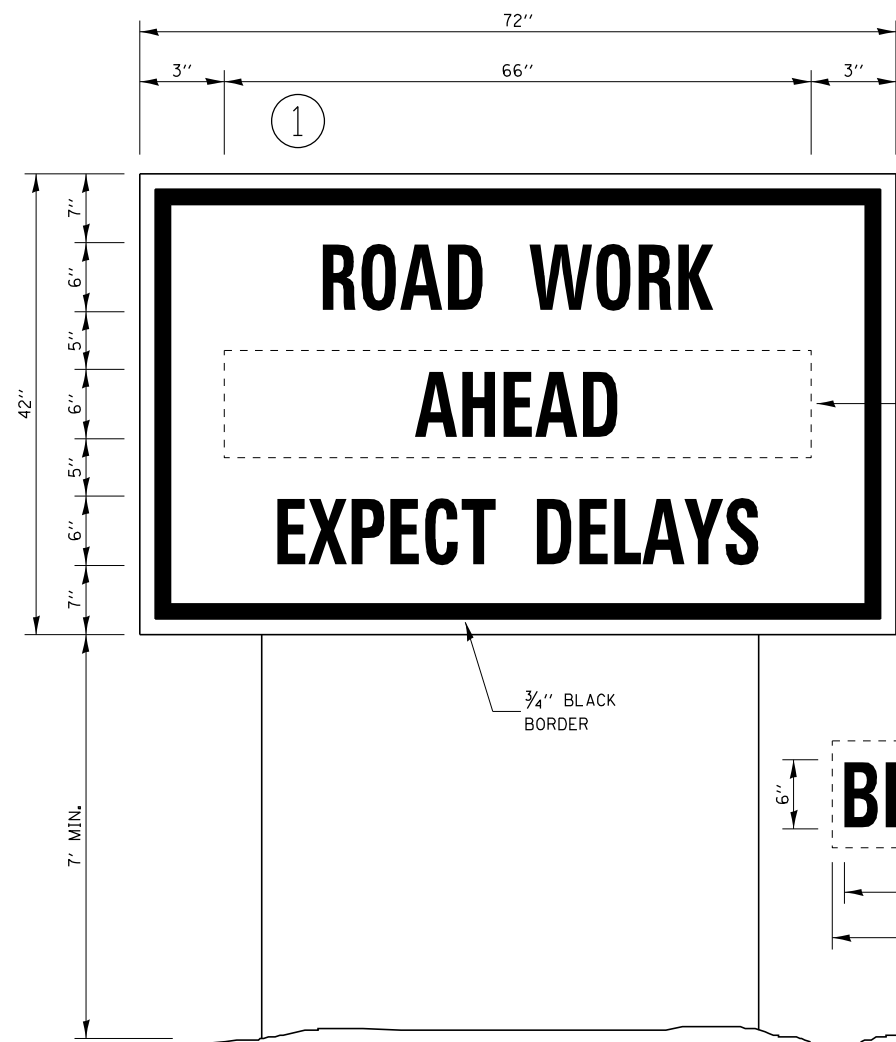

TEMPORARY INFORMATION SIGNING

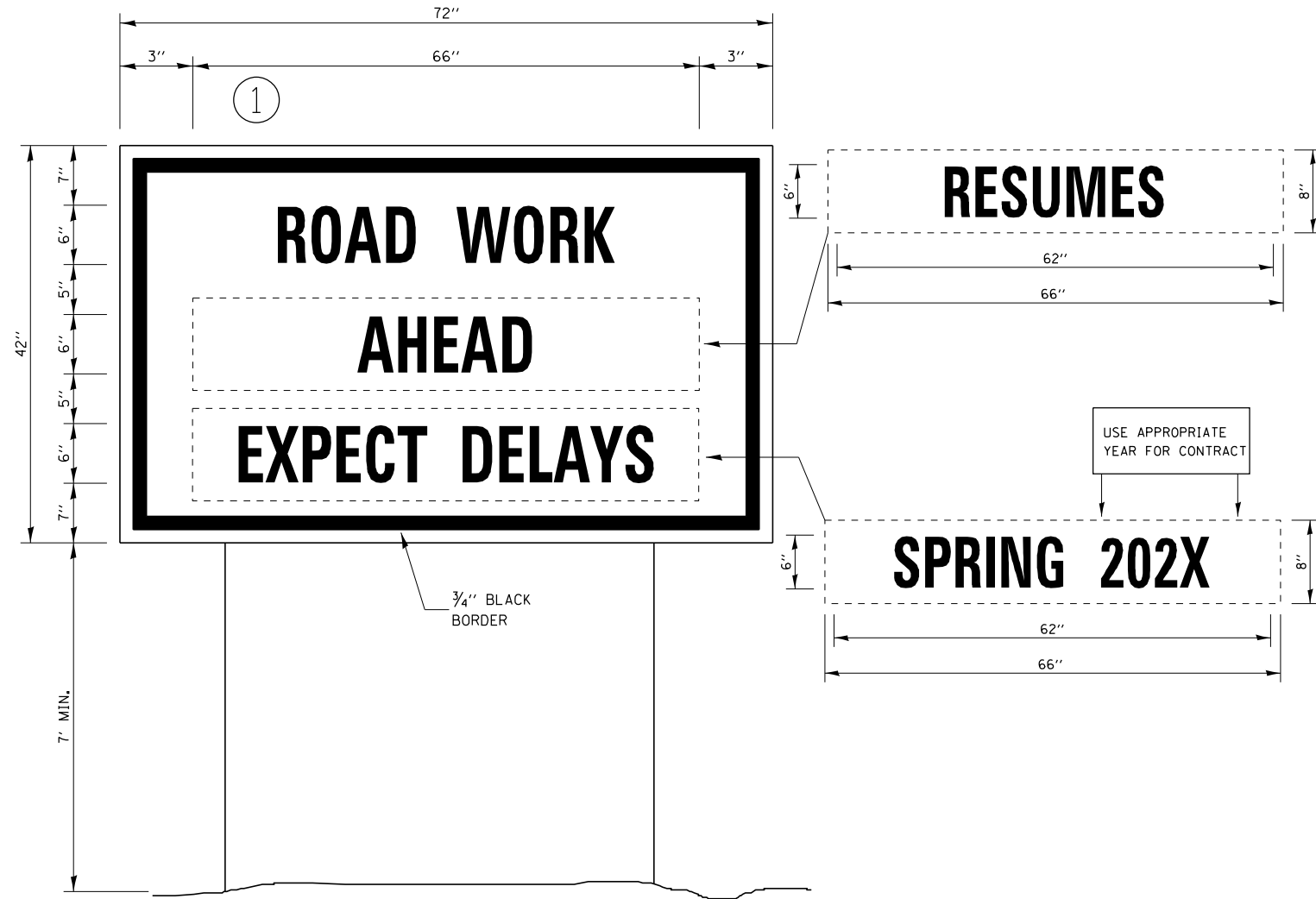

WINTER SHUT DOWN SIGNING

NOTES:

1. USE 6" D BLACK LETTERING ON FLOURESENT ORANGE BACKGROUND.
2. ERECT SIGNS AT LOCATIONS IN ADVANCE OF THE "ROAD CONSTRUCTION AHEAD" SIGNS AS DIRECTED BY THE ENGINEER.
3. ERECT SIGN ① WITH INSTALLED PANEL ② A MINIMUM OF ONE WEEK PRIOR TO THE START OF THE LANE CLOSURE.
4. REMOVE PANEL ② ON THAT DATE.
5. SEE SPECIAL PROVISION "TEMPORARY INFORMATION SIGNING" FOR ADDITIONAL INFORMATION.
6. WILL BE PAID FOR PER SO FT AS "TEMPORARY INFORMATION SIGNING". EACH SIGN = 21 SO FT AND THE DATE PANEL ② WILL NOT BE MEASURED SEPARATELY FOR PAYMENT.

MODEL: Default
 FILE NAME: p:\project-cw-beadefy.com\FW\DOT\Documents\DOT Office\District 3\Project\ID366198\CADD\Sign\ID366198 - PLANS.dgn

USER NAME = woodshank1	DESIGNED - RW	REVISED - RW 10/27/2021
PLOT SCALE = 100,0000' / in.	DRAWN - RW	REVISIONS -
PLOT DATE = 10/27/2021	CHECKED - YP	REVISIONS -
	DATE - 5/27/2021	REVISIONS -

**STATE OF ILLINOIS
DEPARTMENT OF TRANSPORTATION**

TEMPORARY INFORMATION SIGNING

SCALE: 50 SHEET 1 OF 1 SHEETS STA. TO STA.

F.A.P. RTE.	SECTION	COUNTY	TOTAL SHEETS	SHEET NO.
653	(50-1HB)BRR	LASALLE	23	18
			CONTRACT NO. 66L98	
ILLINOIS FED. AID PROJECT				

STATE OF ILLINOIS
DEPARTMENT OF TRANSPORTATION

PROJECT NO.	SECTION NO.	COUNTY	SHEETS
412	50-1HB	LASALLE	29
FED. ROAD DIST. NO. 7	ILLINOIS		

BILL OF MATERIAL Dwg No. 18 of 17

Bar No.	Size	Length	Shape
a ₁ (E)	1454 #5	7'-3"	
a ₂ (E)	1454 #5	29'-0"	
a ₃ (E)	422 #6	4'-0"	
b ₁ (E)	1269 #5	27'-0"	
b ₂ (E)	284 #6	34'-2"	
b ₃ (E)	16 #5	15'-6"	
b ₄ (E)	16 #6	15'-6"	
b ₅ (E)	8 #5	19'-9"	
b ₆ (E)	8 #8	19'-9"	
b ₇ (E)	16 #3	32'-8"	
b ₈ (E)	16 #8	33'-0"	
b ₉ (E)	24 #5	13'-6"	
b ₁₀ (E)	24 #5	32'-8"	
c ₁ (E)	132 #5	4'-0"	
c ₂ (E)	229 #5	4'-0"	
c ₃ (E)	458 #5	2'-9"	
d ₁ (E)	500 #5	3'-0"	
d ₂ (E)	458 #5	5'-2"	
e ₁ (E)	48 #4	13'-6"	
e ₂ (E)	24 #4	19'-9"	
e ₃ (E)	96 #4	18'-5"	
h ₁	84 #5	23'-2"	
v ₁ (E)	270 #5	5'-0"	
v ₂	134 #5	7'-8"	
v ₃ (E)	136 #5	5'-8"	
v ₄	136 #5	3'-6"	
v ₅ (E)	134 #5	4'-6"	

Item	Unit	Quantity
Class + Core Superstr.	Cu. Yd.	509
Reinforcement Bars	Pound	3,600
Reinforcement Bars (Epoxy coated)	Pound	124,310

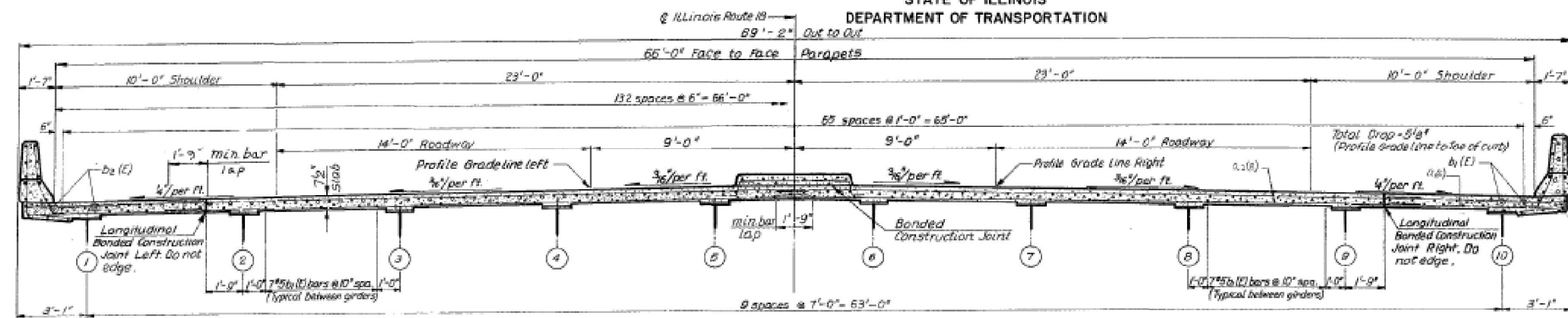

NEAR ABUTMENTS

NEAR MIDSPAN

CROSS SECTION LOOKING EAST

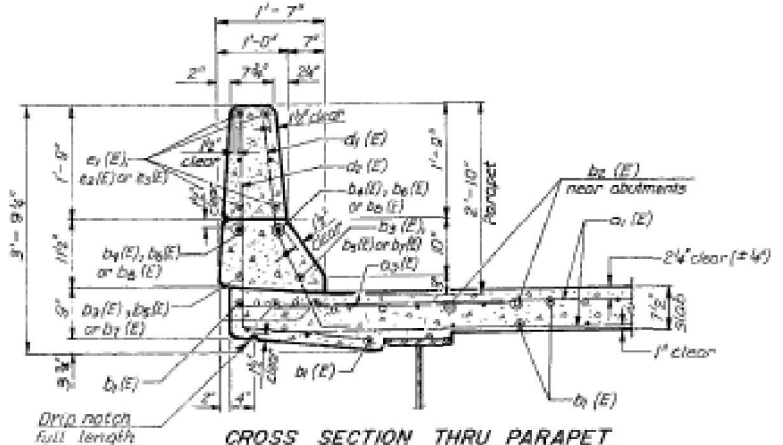

CROSS SECTION THRU PARAPET

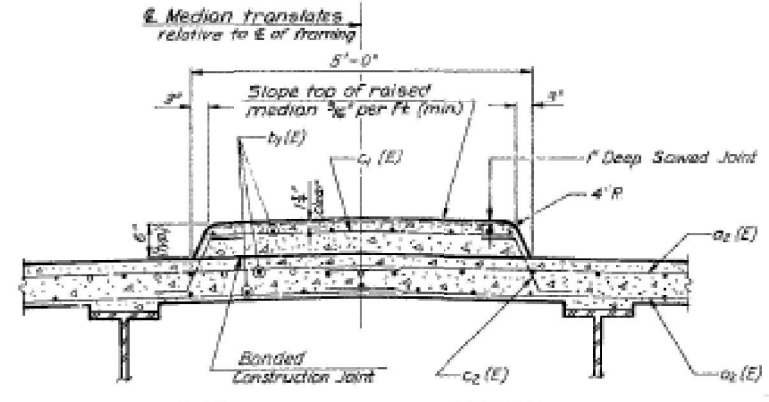

CROSS SECTION THRU MEDIAN

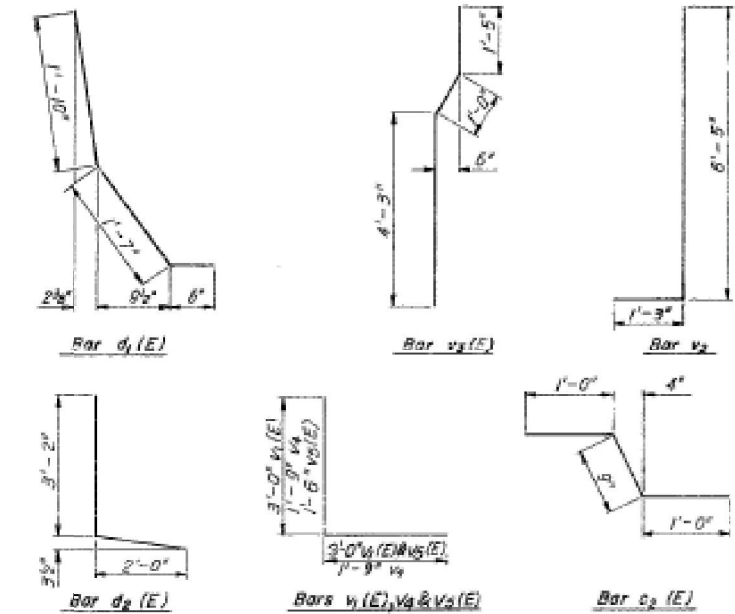

BAR BENDING DIAGRAMS

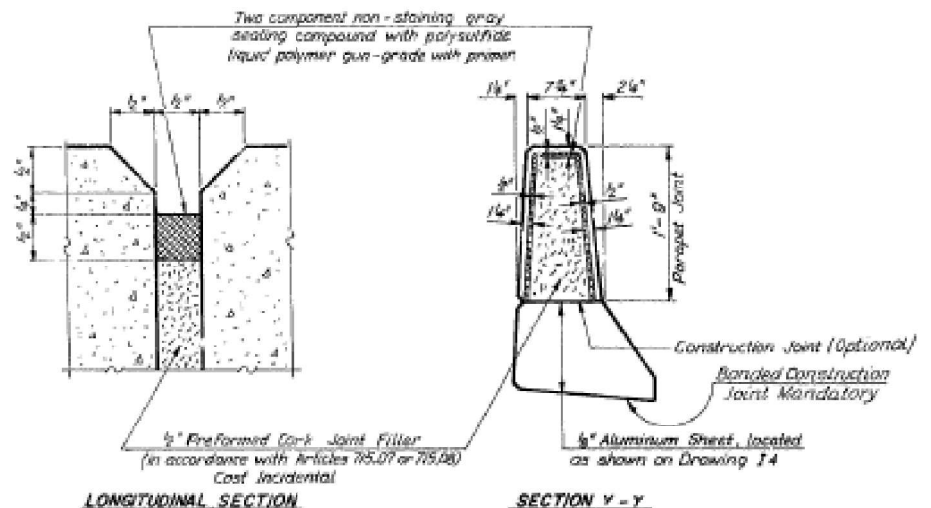

LONGITUDINAL SECTION THRU JOINT

SECTION Y-Y

PARAPET JOINT DETAILS

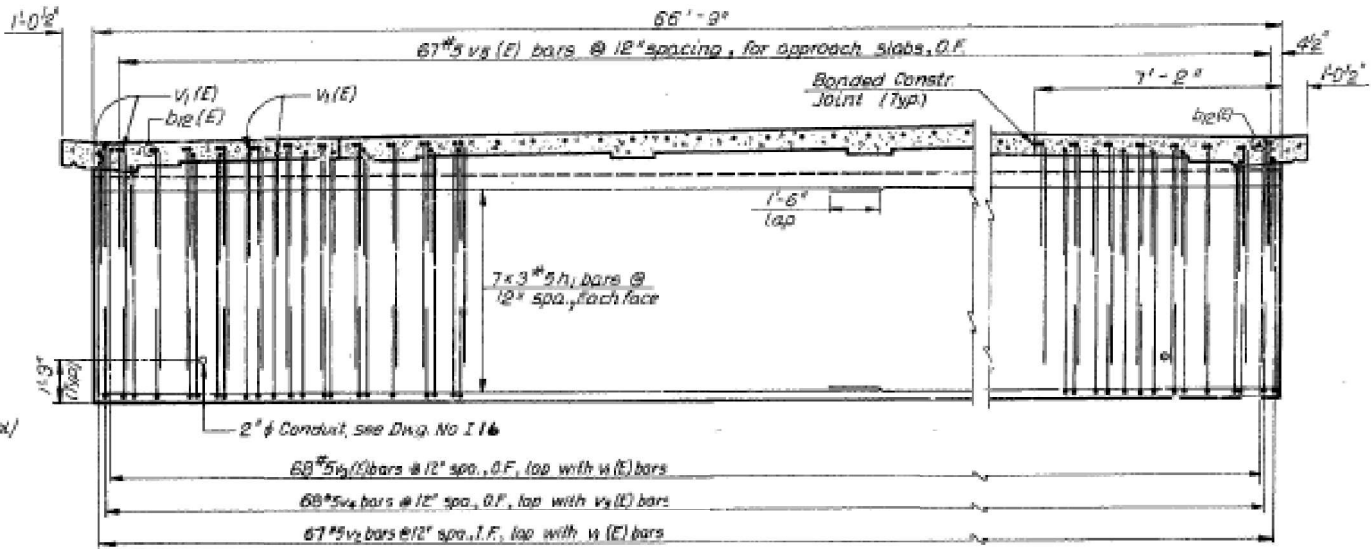

ABUTMENT DIAPHRAGM ELEVATION (SECTION Z-Z)

Notes:
For location of sections Y-Y and Z-Z see Drawing No. 17

MINIMUM BAR LAPS

- #5 bars = 1'-9"
- #6 bars = 2'-4"

DECK CROSS SECTION, DIAPHRAGM, PARAPET DETAILS AND BILL OF MATERIAL
ILLINOIS ROUTE 18 OVER F.A.P. ROUTE 412
F.A.P. 412-SECTION 50-1HB
LASALLE COUNTY
STA. 486+61.56
STRUCTURE NUMBER 050-0215

FOR INFORMATION ONLY

NO.	REVISION DESCRIPTION	BY	DATE
2			
1			

Designed by	B.S.K.	HDR Infrastructure, Inc. A Centerra Company	Drawing No. 18
Drawn by	F.J.M.		
Checked by			
Date	Aug. 1, 1986		

USER NAME = woodshank1	DESIGNED - RW	REVISED - RW 10/27/2021
	DRAWN - RW	REVISED -
PLOT SCALE = 100,000' / in.	CHECKED - YP	REVISED -
PLOT DATE = 10/27/2021	DATE - 5/27/2021	REVISED -

STATE OF ILLINOIS
DEPARTMENT OF TRANSPORTATION

EXISTING STRUCTURE PLANS - STRUCTURE NO. 050-0215
"FOR INFORMATION ONLY"

SCALE: 50 SHEET 3 OF 5 SHEETS STA. TO STA.

F.A.P. RTE.	SECTION	COUNTY	TOTAL SHEETS	SHEET NO.
653	(50-1HB)BRR	LASALLE	23	21
			CONTRACT NO. 66L98	
ILLINOIS FED. AID PROJECT				

MODEL: Default
FILE NAME: p:\projects\aw_beach\paw\paw\DOT Documents\DOT Office\Drawn: 31\project\036689\CADD\036689_09 - PLANS.dwg

F.A.P. ROUTE NO.	SECTION NO.	COUNTY	SHEETS	NO.
412	50-1HB	LASALLE	30	
FED. ROAD DIST. NO. 7		ILLINOIS		

Dwg. No. I 9 of 17

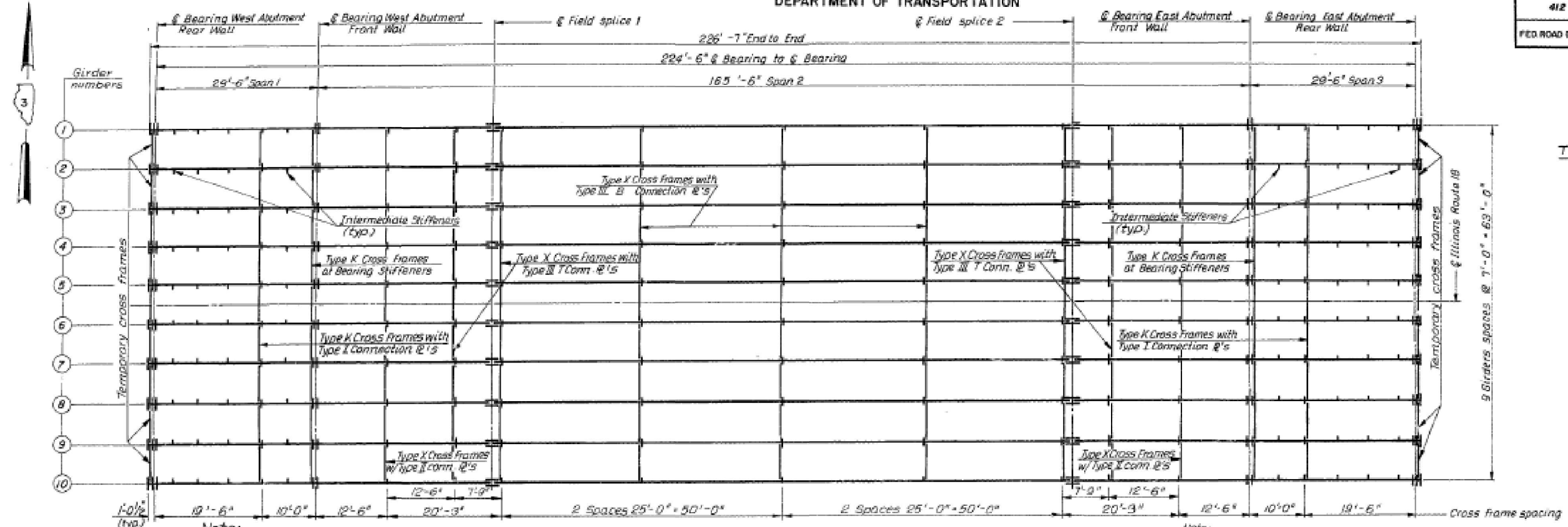

Note:
All structural steel fabricators performing work on the main load carrying components of steel structures shall be certified under Category III (ATSC) of the Quality Certification Program.

FRAMING PLAN

Note:
Temporary cross frames are to be placed during steel erection and removed after slab has cured.

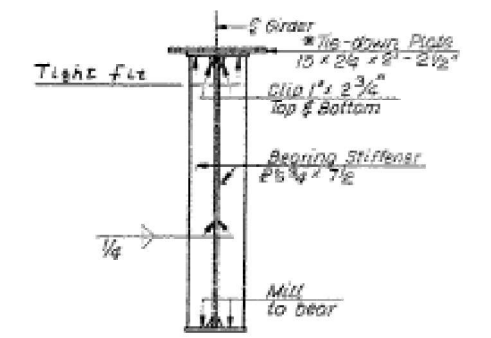

BEARING STIFFENER AT REAR WALL

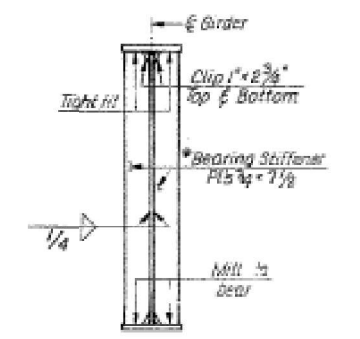

BEARING STIFFENER AT FRONT WALL

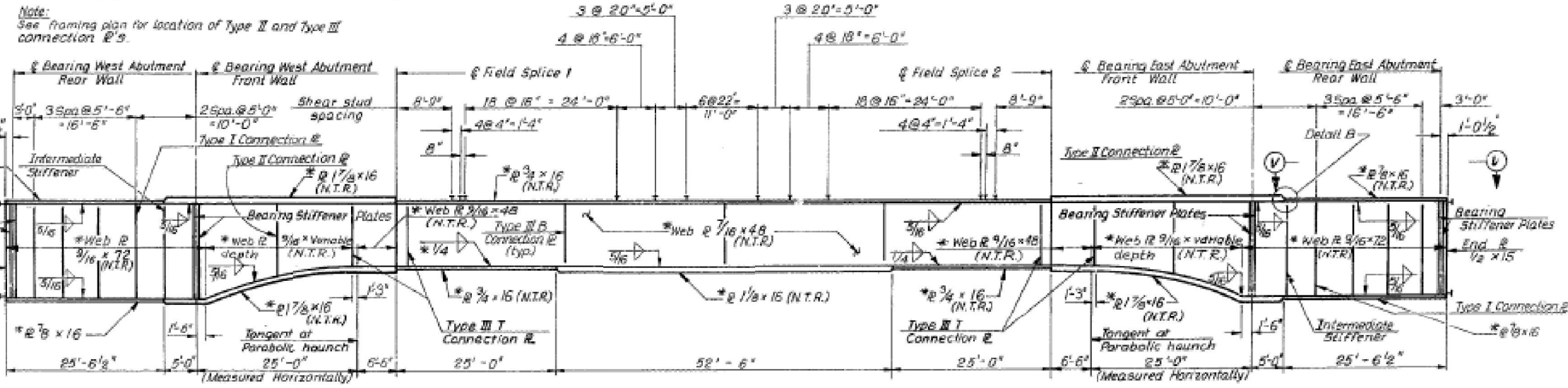

GIRDER ELEVATION

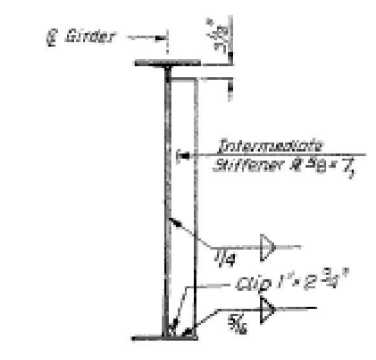

INTERMEDIATE STIFFENER

Note:
See framing plan for location of Type II and Type III connection @'s.

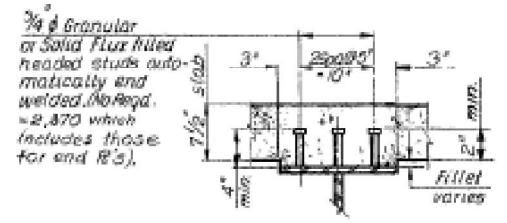

SHEAR STUDS



FLANGE SPLICE (DETAIL B)

Notes:
For View V, and End View W-W, see Dwg. No. I II
See Dwg. I II for connections @ details
N.T.R. indicates notch toughness requirement, See General Notes.
* Indicates M223, Gr. 50 Steel

FRAMING PLAN AND STRUCTURAL STEEL
ILLINOIS ROUTE 1B OVER F.A.P. ROUTE 412
F.A.P. 412-SECTION 50-1HB
LASALLE COUNTY
STA. 466 + 61.56
STRUCTURE NUMBER 050-0215

Designed by	MCB	HCR Infrastructure, Inc. A Centerra Company	Drawing No.	19
Drawn by	FBM			
Checked by				

FOR INFORMATION ONLY

USER NAME = woodshank1	DESIGNED - RW	REVISED - RW 10/27/2021
	DRAWN - RW	REVISED -
PLOT SCALE = 100,0000' / in.	CHECKED - YP	REVISED -
PLOT DATE = 10/27/2021	DATE - 5/27/2021	REVISED -

STATE OF ILLINOIS
DEPARTMENT OF TRANSPORTATION

EXISTING STRUCTURE PLANS - STRUCTURE NO. 050-0215
"FOR INFORMATION ONLY"

SCALE: 50	SHEET 4 OF 5 SHEETS	STA.	TO STA.
-----------	---------------------	------	---------

F.A.P. RTE.	SECTION	COUNTY	TOTAL SHEETS	SHEET NO.
653	(50-1HB)BRR	LASALLE	23	22
			CONTRACT NO. 66L98	
ILLINOIS FED. AID PROJECT				

STATE OF ILLINOIS
DEPARTMENT OF TRANSPORTATION

FAP ROUTE NO.	SECTION NO.	COUNTY	TOTAL SHEETS	SHEET NO.
412	50-1HB	LASALLE		31
FED. ROAD DIST. NO. 7	ILLINOIS			

Dwg. No. I 10 of 17

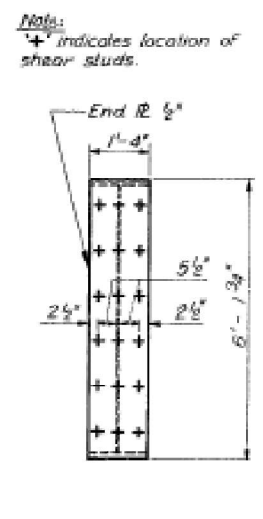
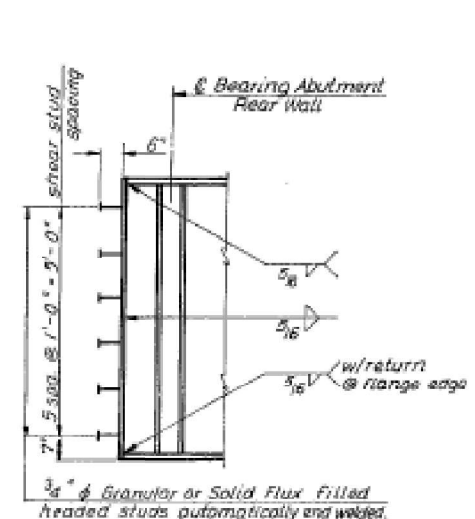
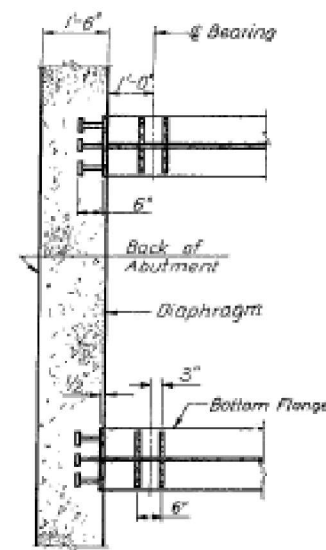
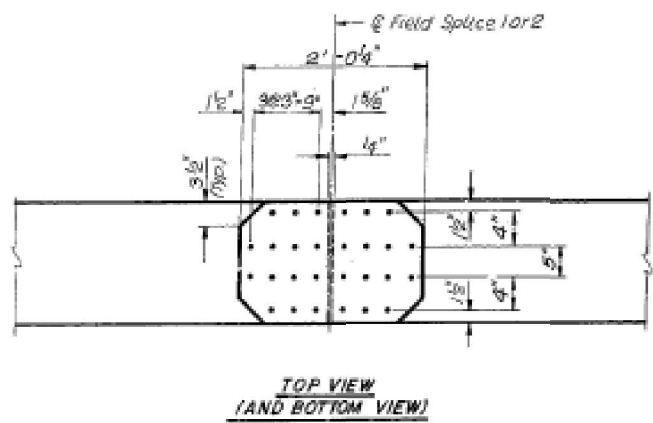

GIRDER END DETAILS

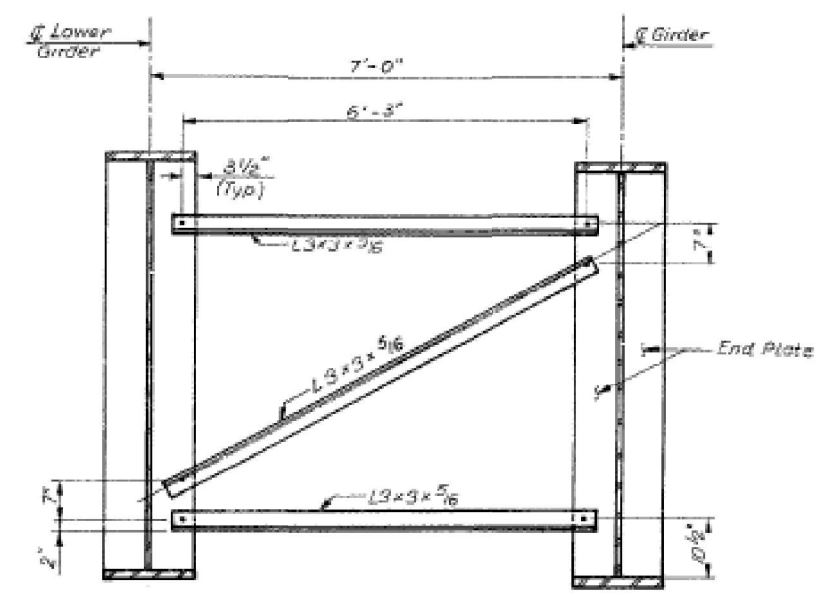
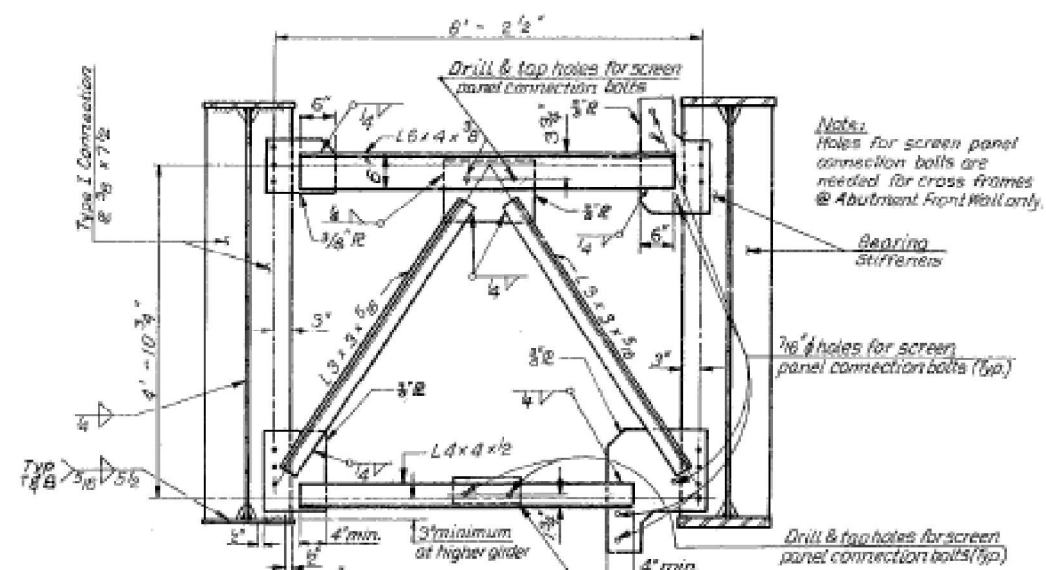
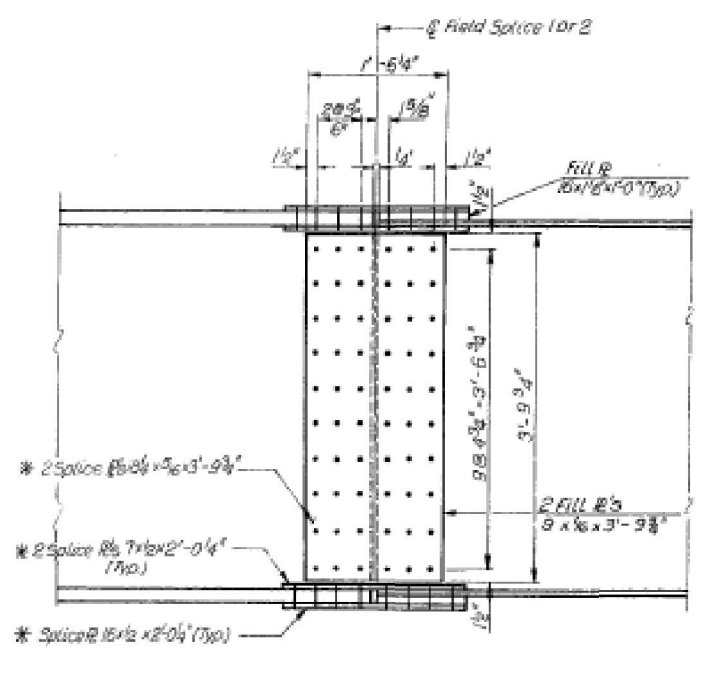

FOR INFORMATION ONLY

Note:
* Type III B connection @'s have gap @ bottom and tight fit with weld @ top. Type III T connection @'s have these treatments reversed.

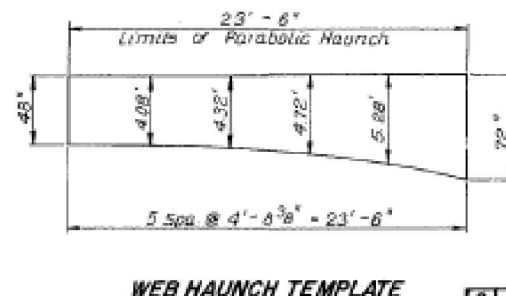
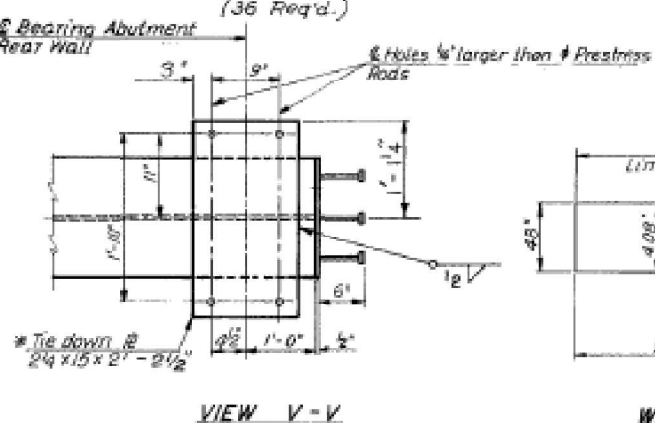
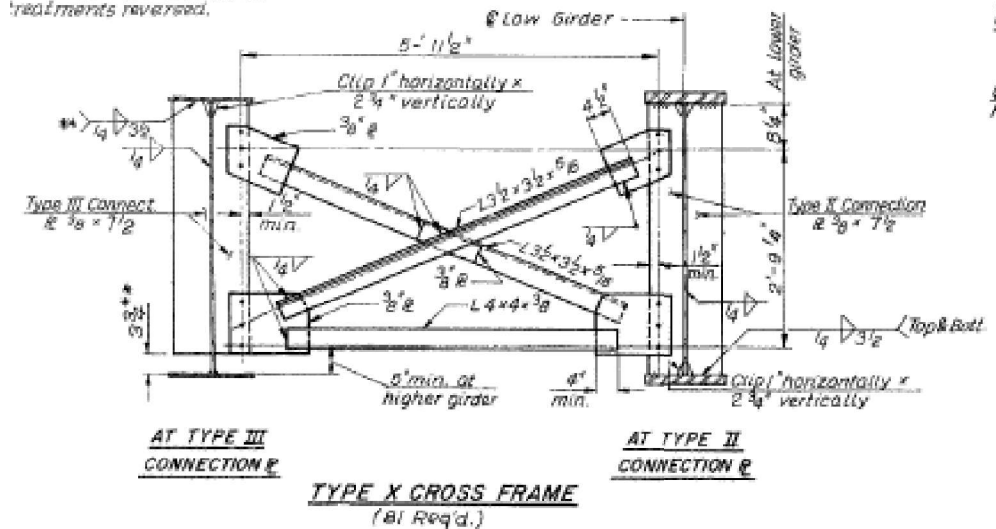

Notes:
For location of Section X-X, see Dwg. No. I 7
For location of End View W-W, see Dwg. No. I 9
End welded studs shall conform to article 710.36 of the Standard Specifications
For location of View V-V, see Dwg. No. I 9 & I 16
Connections of cross frames to connection @'s and bearing stiffeners shall be made with 3/4" φ Bolts, 1/2" φ over sized holes & hardened washers.
* Indicates M223, Gr. 50 Steel.

STRUCTURAL STEEL DETAILS

ILLINOIS ROUTE 18 OVER F.A.P. ROUTE 412
F.A.P. 412-SECTION 50-1 HB
LASALLE COUNTY
STA. 486+61.56
STRUCTURE NUMBER 050-0215

Designed by: **EBB**
Drawn by: **EBB**
Checked by: **EBB**
Date: **22.1988**

HDR Infrastructure, Inc.
A Centura Company

Drawing No. **110**

NO.	REVISION DESCRIPTION	BY	DATE
2			
1			

USER NAME = woodshank1	DESIGNED - RW	REVISED - RW 10/27/2021
PLOT SCALE = 100,000' / in.	DRAWN - RW	REVISED -
PLOT DATE = 10/27/2021	CHECKED - YP	REVISED -
	DATE - 5/27/2021	REVISED -

STATE OF ILLINOIS
DEPARTMENT OF TRANSPORTATION

EXISTING STRUCTURE PLANS - STRUCTURE NO. 050-0215
"FOR INFORMATION ONLY"

SCALE: 50 SHEET 5 OF 5 SHEETS STA. TO STA.

F.A.P. RTE.	SECTION	COUNTY	TOTAL SHEETS	SHEET NO.
653	(50-1HB)BRR	LASALLE	23	23
			CONTRACT NO. 66L98	
		ILLINOIS	FED. AID PROJECT	