

STATE OF ILLINOIS
DEPARTMENT OF TRANSPORTATION

F.A.P. RTE.	SECTION	COUNTY	TOTAL SHEETS	SHEET NO.
562	(116) BDR, BRR, BJR	SCOTT	31	1
		ILLINOIS	CONTRACT NO. 72M65	

D-96-018-21

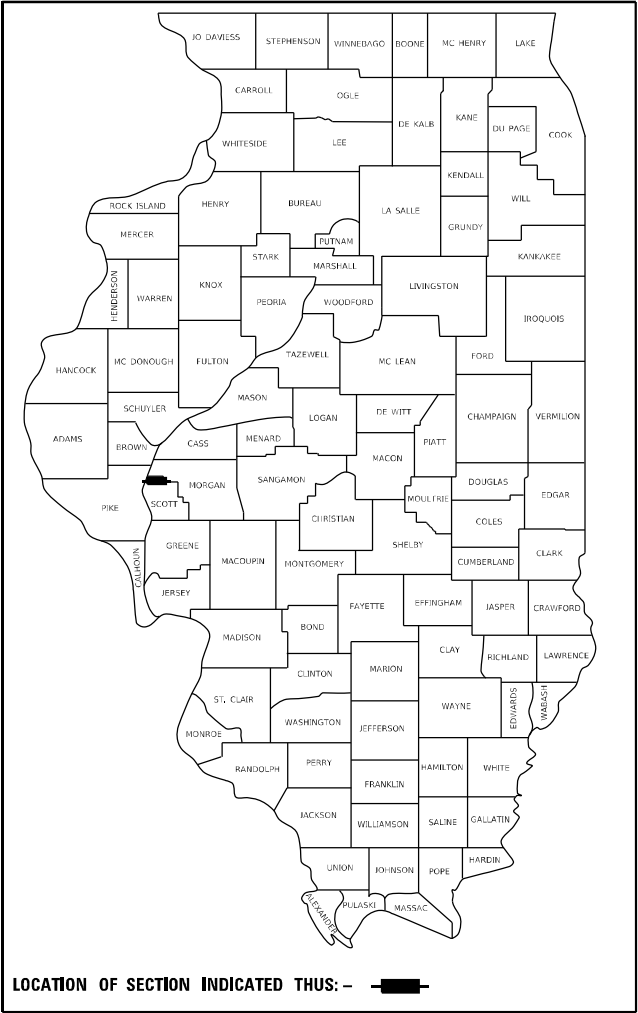

LOCATION OF SECTION INDICATED THUS: - [black rectangle] -

FOR LIST OF HIGHWAY STANDARDS, SEE SHEET 2

INDEX OF SHEETS

- 1 COVER SHEET
- 2 GENERAL NOTES, COMMITMENTS AND LIST OF STANDARDS
- 3-6 SUMMARY OF QUANTITIES
- 7 TYPICAL SECTIONS
- 8 SCHEDULES OF QUANTITIES
- 9-10 PLAN SHEETS
- 11-14 STAGING PLANS
- 15-26 STRUCTURE PLANS (086-0006)
- 27-29 STRUCTURE PLANS (086-0046)
- 30 APPROACH SLABS GUARDRAIL/INLET PLAN (086-0046)
- 31 INLET BOX ADJUSTMENT

PROPOSED
HIGHWAY PLANS

FAP ROUTE 562 (IL 100)
SECTION (116) BDR, BRR, BJR
PROJECT STP-IEFF(595)
BRIDGE DECK OVERLAY
SCOTT COUNTY

BEGIN IMPROVEMENT

STA. 184 + 23

END IMPROVEMENT

STA. 187 + 05



BEGIN IMPROVEMENT

STA. 273 + 61

END IMPROVEMENT

STA. 276 + 43

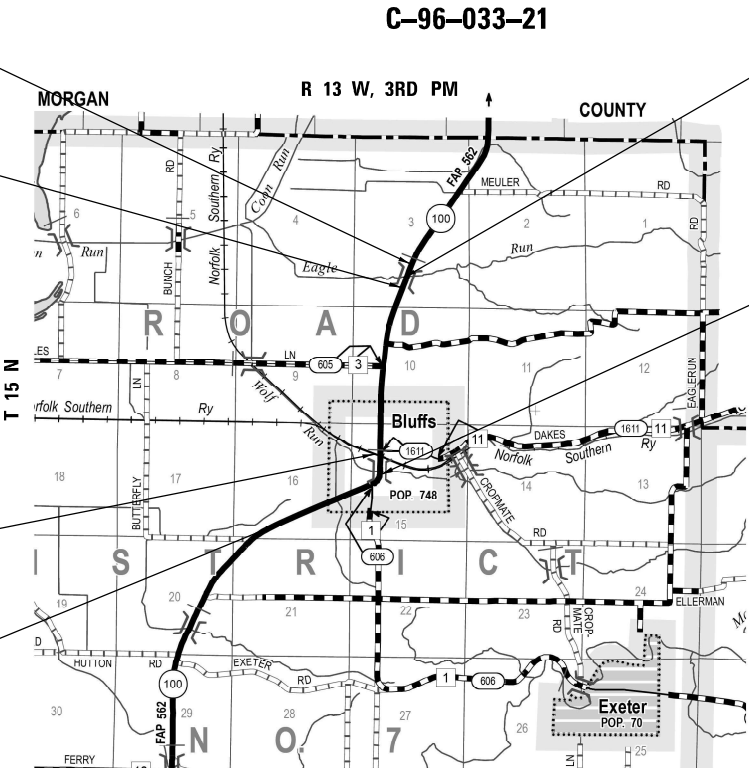

MODEL Default
FILE NAME: J:\13040.06\DOT D6 - PTB 187-011 - W06 - Scott County 72M65\CADD\Drawn\72M65.dwg
Professional Design Firm No. 184-006516

CODE NO.	ITEM	UNIT	TOTAL QUANTITY	CONSTRUCTION CODE	
				6 - 00606 - 0000 80% FED, 20% STATE	
				BRIDGE 0059	BRIDGE 0059
				086-0006	086-0046
40600290	BITUMINOUS MATERIALS (TACK COAT)	POUND	480	270	210
40600982	HOT-MIX ASPHALT SURFACE REMOVAL - BUTT JOINT	SQ YD	879	405	474
40600985	PORTLAND CEMENT CONCRETE SURFACE REMOVAL - BUTT JOINT	SQ YD	62	62	
40600990	TEMPORARY RAMP	SQ YD	156	78	78
40604050	HOT-MIX ASPHALT SURFACE COURSE, IL-9.5, MIX "C", N50	TON	110	60	50
44004250	PAVED SHOULDER REMOVAL	SQ YD	20		20
48102100	AGGREGATE WEDGE SHOULDER, TYPE B	TON	4		4
48300500	PORTLAND CEMENT CONCRETE SHOULDERS 10"	SQ YD	12		12
50102400	CONCRETE REMOVAL	CU YD	16.2	16.2	
50105220	PIPE CULVERT REMOVAL	FOOT	32		32
50200100	STRUCTURE EXCAVATION	CU YD	3	3	
50300225	CONCRETE STRUCTURES	CU YD	2.3	2.3	
50300255	CONCRETE SUPERSTRUCTURE	CU YD	14.8	14.8	
50300260	BRIDGE DECK GROOVING	SQ YD	783	316	467
50300300	PROTECTIVE COAT	SQ YD	839	344	495

* DENOTES SPECIALTY ITEM



KUHN & TRELLO
CONSULTING ENGINEERS
A Limited Liability Company
209 N. 7th Street, 3rd Floor
Springfield, IL 62702
Phone: 217-618-0244

USER NAME = myoung
PLOT SCALE = 0.1667 ' / in.
PLOT DATE = 10/14/2021

DESIGNED - CDI/KTCE
DRAWN - CDI/MMY
CHECKED - JS
DATE - 10/14/2021

REVISED -
REVISED -
REVISED -
REVISED -

**STATE OF ILLINOIS
DEPARTMENT OF TRANSPORTATION**

SUMMARY OF QUANTITIES

SCALE: 0.1667 ' / in. SHEET 1 OF 4 SHEETS STA. TO STA.

F.A.P. RTE.	SECTION	COUNTY	TOTAL SHEETS	SHEET NO.
562	(116) BDR, BRR, BJR	SCOTT	31	3
CONTRACT NO. 72M65				
ILLINOIS FED. AID PROJECT				

MODEL: Default
FILE NAME: I:\110000.06 [DOT D6 - RTB 187-011 - W06 - SCOT County 72M65]CADDraw\CADSheet\0672M65.dwt:500.dgn

CODE NO.	ITEM	UNIT	TOTAL QUANTITY	CONSTRUCTION CODE	
				6-00606-0000 80% FED, 20% STATE	
				BRIDGE 0059	BRIDGE 0059
				086-0006	086-0046
67100100	MOBILIZATION	L SUM	1	0.5	0.5
70100100	TRAFFIC CONTROL AND PROTECTION, STANDARD 701316	EACH	1		1
70100405	TRAFFIC CONTROL AND PROTECTION, STANDARD 701321	EACH	1	1	
70100450	TRAFFIC CONTROL AND PROTECTION, STANDARD 701201	L SUM	1	0.5	0.5
70102640	TRAFFIC CONTROL AND PROTECTION, STANDARD 701801	L SUM	1	1	
70106500	TEMPORARY BRIDGE TRAFFIC SIGNALS	EACH	2	1	1
70106700	TEMPORARY RUMBLE STRIPS	EACH	6		6
70107025	CHANGEABLE MESSAGE SIGN	CAL DA	120	60	60
70300100	SHORT TERM PAVEMENT MARKING	FOOT	88	44	44
70300150	SHORT TERM PAVEMENT MARKING REMOVAL	SQ FT	30	15	15
70400100	TEMPORARY CONCRETE BARRIER	FOOT	312.5	312.5	
70400200	RELOCATE TEMPORARY CONCRETE BARRIER	FOOT	312.5	312.5	
70600241	IMPACT ATTENUATORS, TEMPORARY (NON-REDIRECTIVE, NARROW), TEST LEVEL 2	EACH	2	2	
70600341	IMPACT ATTENUATORS, RELOCATE (NON-REDIRECTIVE, NARROW), TEST LEVEL 2	EACH	2	2	
* 72501000	TERMINAL MARKER - DIRECT APPLIED	EACH	5	1	4

* DENOTES SPECIALTY ITEM

KT

KUHN & TRELLO

CONSULTING ENGINEERS

A Limited Liability Company

109 N. 7th Street, 3rd Floor

Springfield, IL 62702

Phone: 217-678-0044

Professional Design Firm No. 184-006516

USER NAME = myyoung	DESIGNED - CDI/KTCE	REVISED -
	DRAWN - CDI/MMY	REVISED -
PLOT SCALE = 0.1667 ' / in.	CHECKED - JS	REVISED +
PLOT DATE = 10/14/2021	DATE - 10/14/2021	REVISED -

STATE OF ILLINOIS
DEPARTMENT OF TRANSPORTATION

SUMMARY OF QUANTITIES			
SCALE: 0.1667 ' / in.	SHEET 3	OF 4 SHEETS	STA. TO STA.

F.A.P. RTE.	SECTION	COUNTY	TOTAL SHEETS	SHEET NO.
562	(116) BDR, BRR, BJR	SCOTT	31	5
CONTRACT NO. 72M65				
ILLINOIS FED. AID PROJECT				

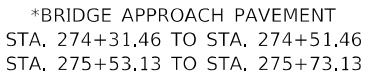
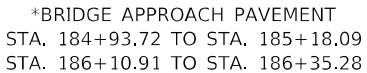

- ① EXISTING CONCRETE PAVEMENT
- ② EXISTING HOT-MIX ASPHALT OVERLAY $\pm 4"$
- ③ EXISTING HOT-MIX ASPHALT WIDENING 9"
- ④ EXISTING HOT-MIX ASPHALT WIDENING 9"
- ⑤ EXISTING HOT-MIX ASPHALT SHOULDERS 8"
- ⑥ EXISTING HOT-MIX ASPHALT OVERLAY $\pm 3"$
- ⑦ EXISTING COMBINATION CONCRETE CURB AND GUTTER TYPE B-6.24
- ⑧ EXISTING CONCRETE SIDEWALK 4"
- ⑨ PROPOSED HOT-MIX ASPHALT SURFACE COURSE, IL-9.5, MIX "C" N50 (1¾")
- ⑩ PROPOSED AGGREGATE WEDGE
- ⑪ VARIABLE DEPTH SURFACE REMOVAL IN GUTTER

USER NAME = myoung	DESIGNED - CDI/KTCE	REVISED -
	DRAWN - CDI/MMY	REVISED -
PLOT SCALE = 0.1667 ' / in.	CHECKED - JS	REVISED -
PLOT DATE = 10/14/2021	DATE - 10/14/2021	REVISED -

STATE OF ILLINOIS
DEPARTMENT OF TRANSPORTATION

TYPICAL SECTIONS

SCALE: 0.1667' / in.	SHEET 1	OF 1	SHEETS	STA.	TO STA.
----------------------	---------	------	--------	------	---------

F.A.P. RTE.	SECTION	COUNTY	TOTAL SHEETS	SHEET NO.
562	(116) BDR, BRR, BJR	SCOTT	31	7
		CONTRACT NO. 72M65		
ILLINOIS		FED. AID PROJECT		

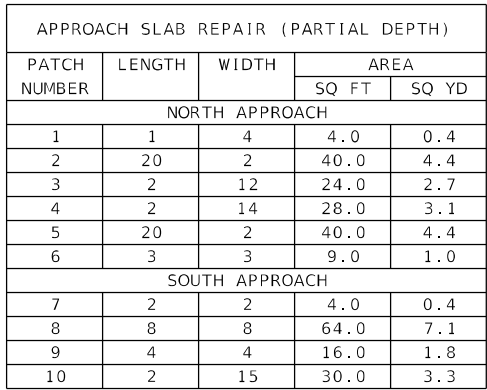
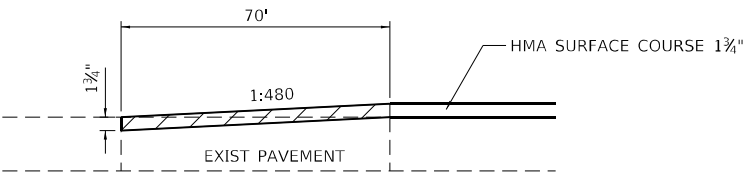

SOUTH APPROACH PAVEMENT PATCHING

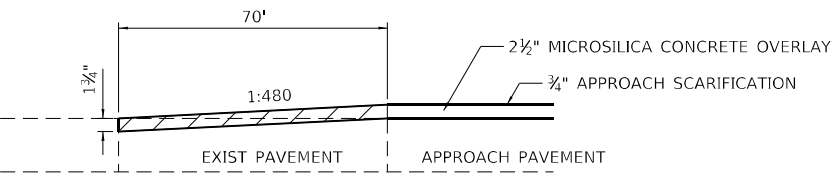

HOT-MIX ASPHALT SURFACE REMOVAL BUTT-JOINT DETAIL

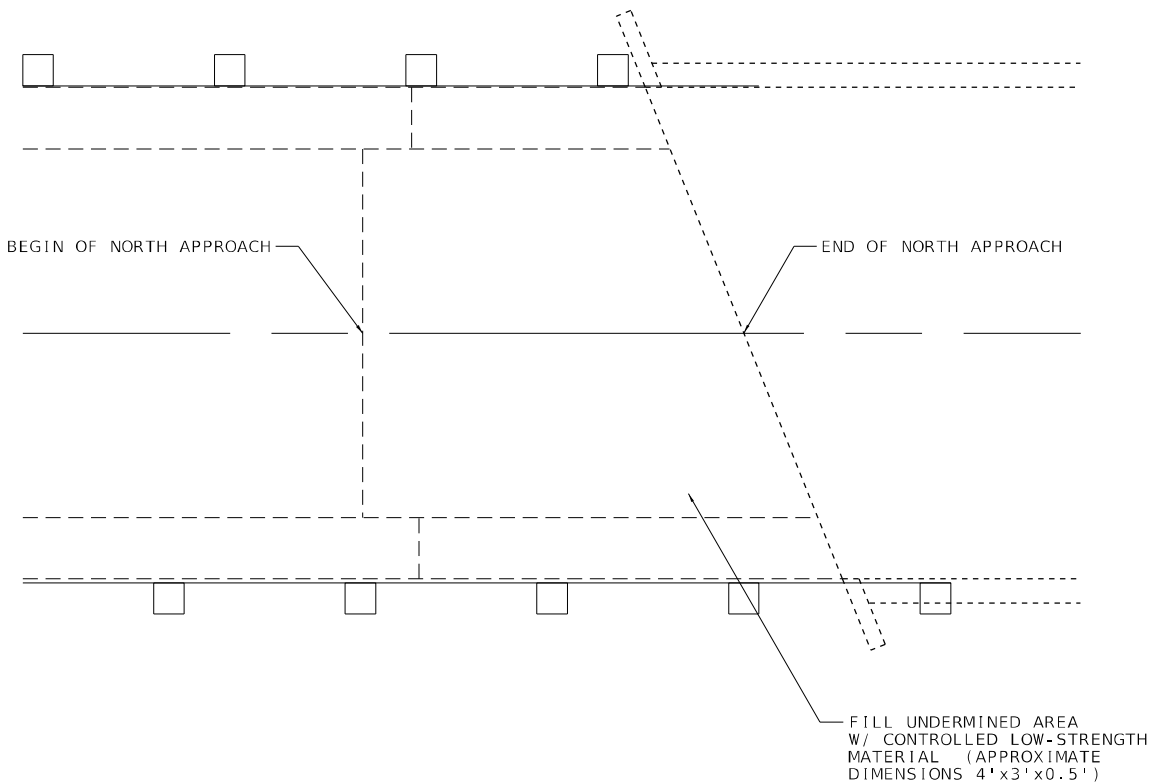
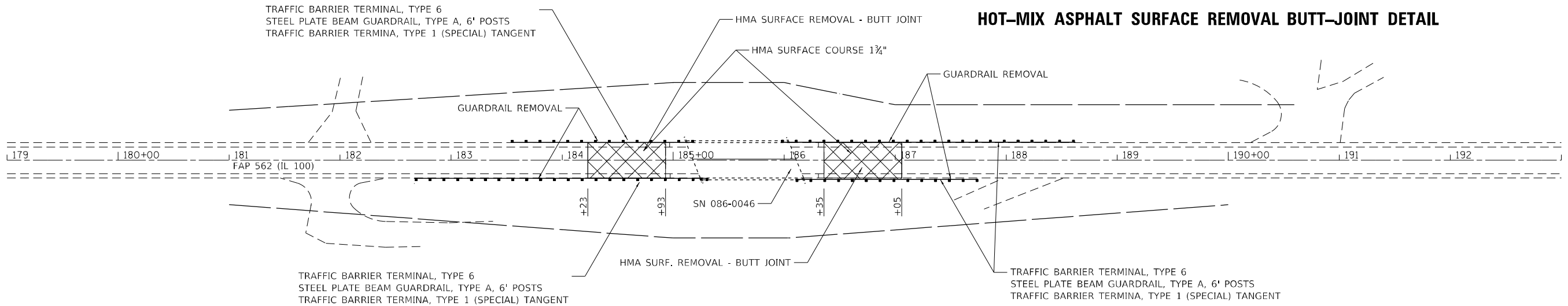

NORTH APPROACH PAVEMENT PATCHING

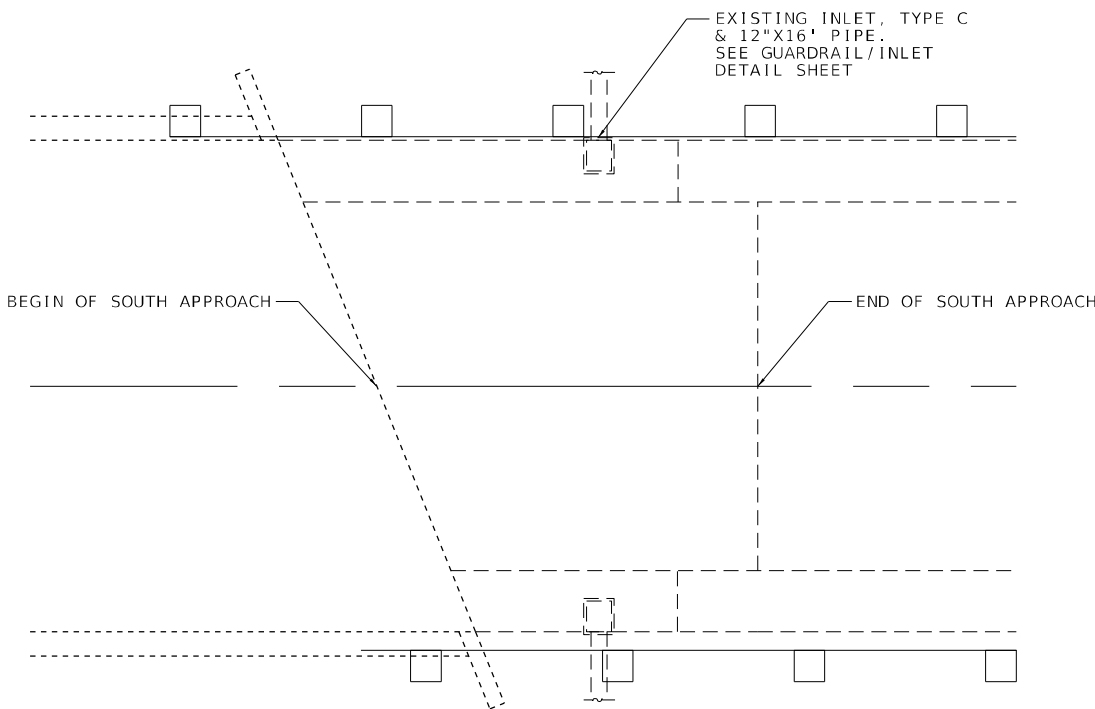

SOUTH APPROACH PAVEMENT PATCHING

MODEL: Default
FILE NAME: 20110406.D6 - PTB 187-011 - W06 - Scott County 72M65(CADD)3(CAD)SheetID672M65.dwg
Professional Design Firm No. 184-006516

 KUHN & TRELLO CONSULTING ENGINEERS A Limited Liability Company 209 N. 7th Street, 3rd Floor Springfield, IL 62701 Phone: 217-618-0244 Professional Design Firm No. 284-06856	USER NAME = myoung		DESIGNED - CDI/KTCE	REVISED -	STATE OF ILLINOIS DEPARTMENT OF TRANSPORTATION	ROADWAY PLAN SN 086-0046					F.A.P. RTE.	SECTION	COUNTY	TOTAL SHEETS	SHEET NO.
	DRAWN - CDI/MMY		CHECKED - JS	REVISED -							562	(116) BDR, BRR, BJR	SCOTT	31	10
	PLOT SCALE = 100,0000 ' / in.		DATE = 10/14/2021	REVISED -		CONTRACT NO. 72M65									
	PLOT DATE = 10/14/2021					ILLINOIS FED. AID PROJECT									
			SCALE: 100,0000 ' / in. SHEET 1 OF 1 SHEETS STA. TO STA.												

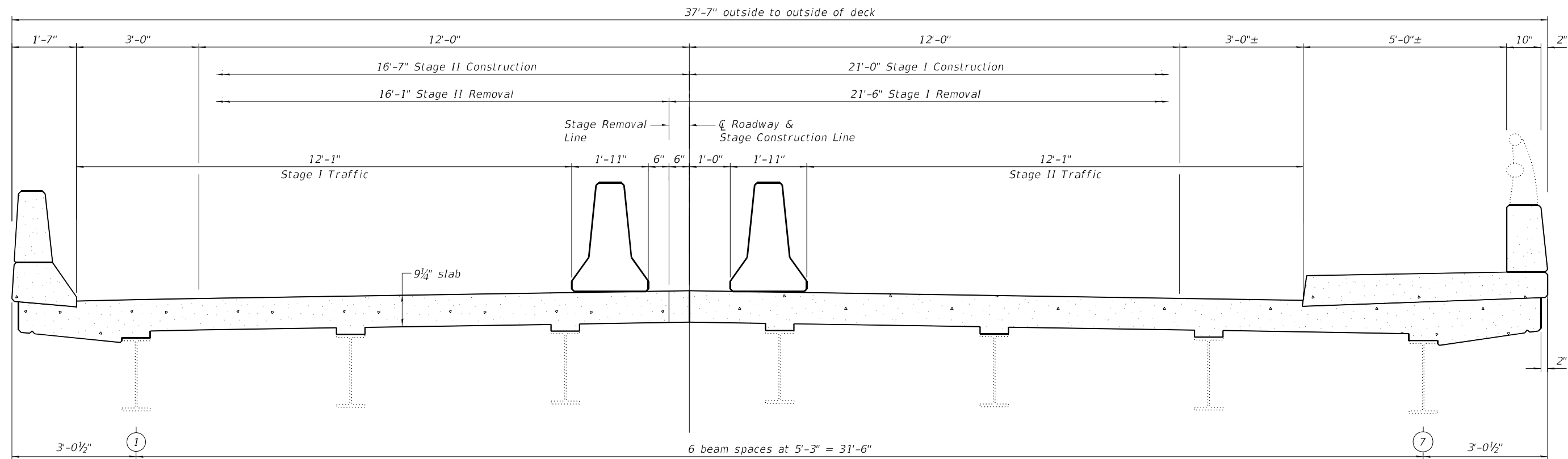

CROSS SECTION AT JOINT REPLACEMENT LOCATIONS
(Looking South)

MODEL: Default
FILE NAME: I:\13040.06\DOT D6 - RTB 187-011 - W06 - Scott County 72M65\CADD\Drawings\72M65.dwg, Staging_0860006-2.dgn

 KUHN & TRELLO CONSULTING ENGINEERS A Limited Liability Company 109 N. 7th Street, 3rd Floor Springfield, IL 62701 Phone: 217-678-0244 Professional Design Firm No. 184-005316	USER NAME = myoung		DESIGNED - SPN	REVISED -	STATE OF ILLINOIS DEPARTMENT OF TRANSPORTATION	STAGING CROSS SECTION SN 086-0006			F.A.P. RTE.	SECTION	COUNTY	TOTAL SHEETS	SHEET NO.
	DRAWN - MJT		CHECKED - MMY	REVISED -					562	(116) BDR, BRR, BJR	SCOTT	31	12
	PLOT SCALE = 0:2,000 1" = 100'		DATE - SPN/MJT/21	REVISED -		SCALE: 0:2,000 1" = 100'			CONTRACT NO. 72M65				
	PLOT DATE = 10/14/2021					SHEET 1 OF 1 SHEETS			ILLINOIS FED. AID PROJECT				

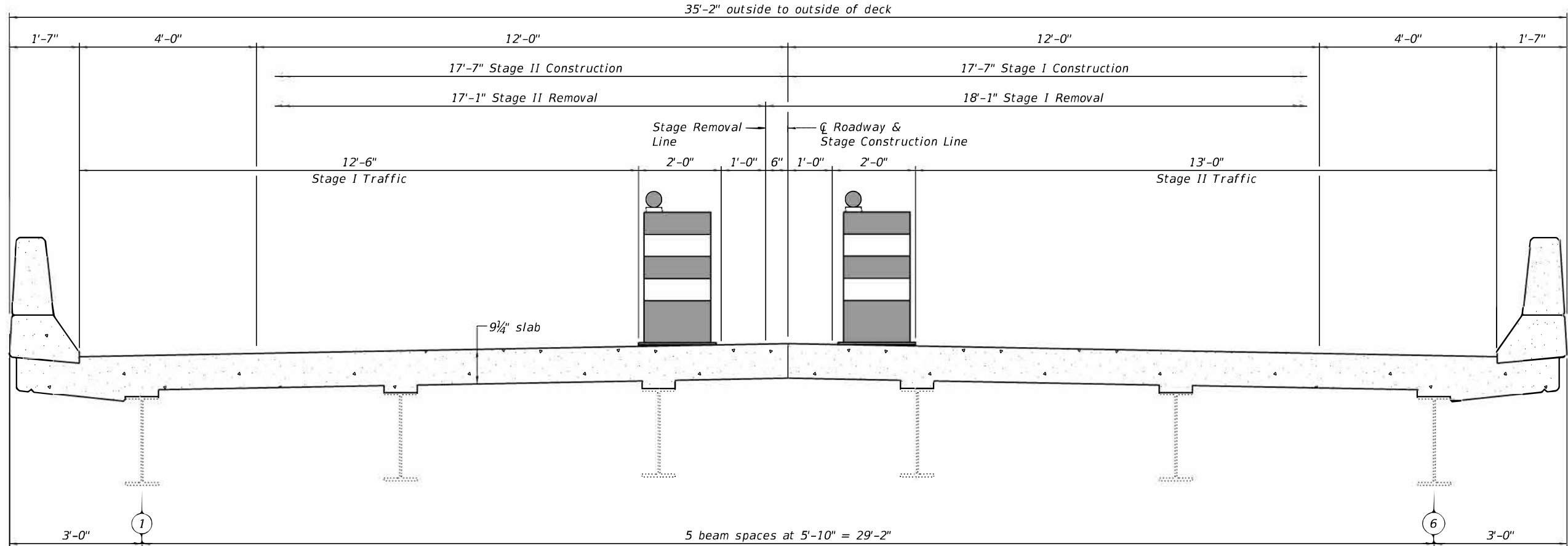

STAGING CROSS SECTION
(Looking South)

REV. - MS

MODEL: Default
FILE NAME: J:\10040.06\DOT D6 - PTB 187-011 - W06 - Scott County 72M65\CADD\Sheet\0860046 2.dgn
STAGING CROSS SECTION FOR 086-0046

FILE NAME: 141

<

MODEL: Default
FILE NAME: J:\18040.06 IDOT D6 - PTB 187-011 - W06 - Scott County 72M65\CADD\Sheet\0860006-72M65-001-GPE-rev10-29-2021.dgn
11/4/2021 12:59:21 PM



Expires: November 30, 2022



USER NAME	=	DESIGNED -	SPN	REVISED -	
		CHECKED -	MJT	REVISED -	
PLOT SCALE	=	DRAWN -	MMY	REVISED -	
PLOT DATE	=	CHECKED -	SPN/MJT	REVISED -	

STATE OF ILLINOIS
DEPARTMENT OF TRANSPORTATION

GENERAL PLAN & ELEVATION
STRUCTURE NO. 086-0006

SHEET 1 OF 12 SHEETS

F&P RTE.	SECTION	COUNTY	TOTAL SHEETS	SHEET NO.
562	(116) BDR, BRR, BJR	SCOTT	31	15
CONTRACT NO. 72M65				
ILLINOIS FED. AID PROJECT				

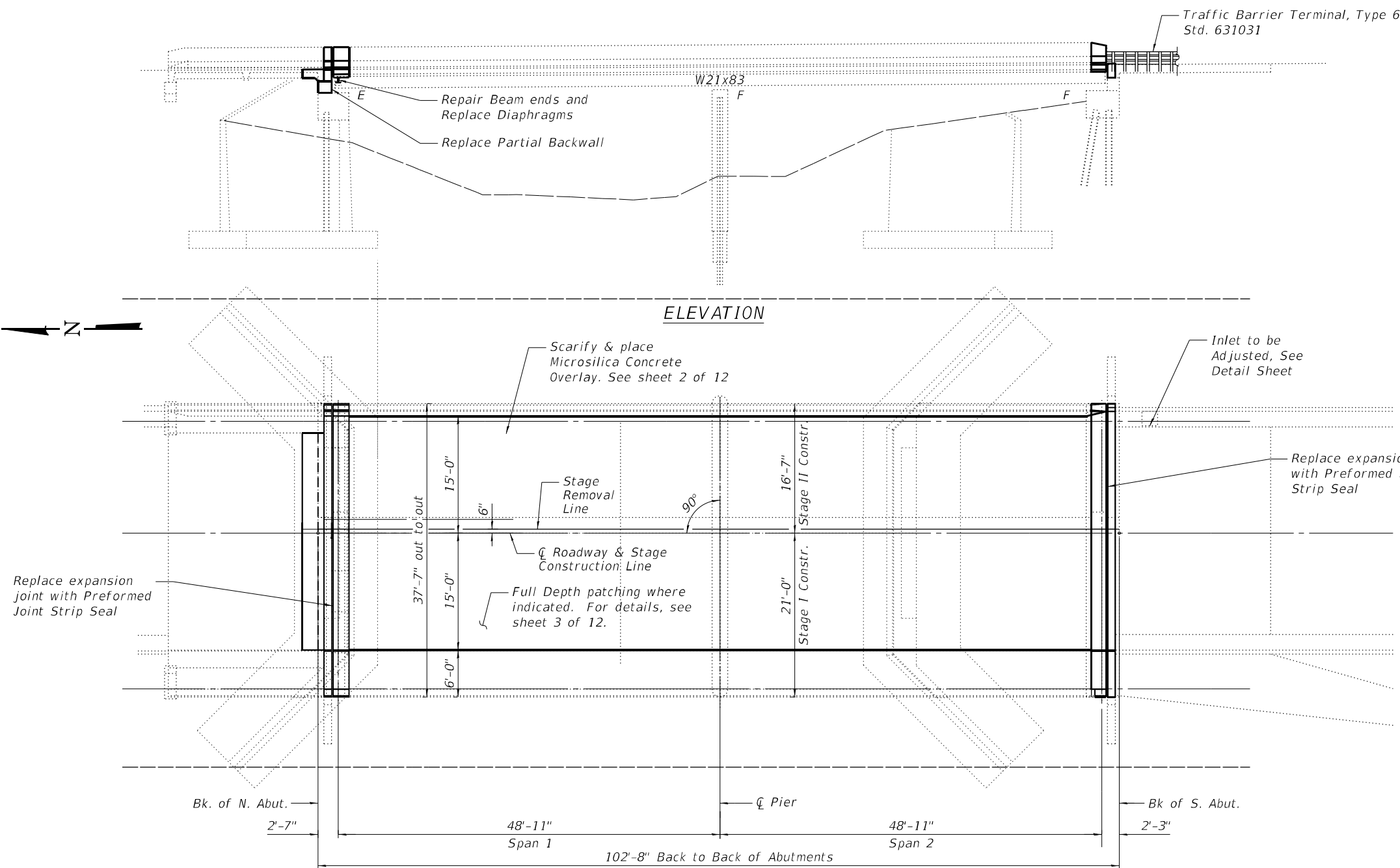

GENERAL NOTES

- All structural steel shall be AASHTO M 270 Grade 50, unless otherwise noted.
- Fasteners shall be high strength bolts. Bolts $\frac{3}{4}$ " \varnothing , open holes $\frac{13}{16}$ " \varnothing , unless otherwise noted.
- The existing structural steel coating contains lead. The Contractor shall take appropriate precautions to deal with the presence of lead on this project.
- Plan dimensions and details relative to existing plans are subject to nominal construction variations. The Contractor shall field verify existing dimensions and details affecting new construction and make necessary approved adjustments prior to construction or ordering of materials. Such variations shall not be cause for additional compensation for a change in scope of the work, however, the Contractor will be paid for the quantity actually furnished at the unit price bid for the work.
- Reinforcement bars designated (E) shall be epoxy coated.
- Prior to pouring the new concrete deck, all heavy or loose rust, loose mill scale, and other loose or potentially detrimental foreign material shall be removed from the surfaces in contact with concrete. Tightly adhered paint may remain unless otherwise noted. Removal shall be accomplished by methods that will not damage the steel and the cost will be included in the pay item covering removal of the existing concrete.
- Existing reinforcement bars extending into the removal area shall be cleaned, straightened and incorporated into the new construction. Any reinforcement bars that are damaged during concrete removal shall be replaced with an approved bar splicer or anchorage system. Cost included with Concrete Removal.
- Joint openings shall be adjusted according to Article 520.04 of the Std. Specs. when the deck is poured at an ambient temperature other than 50° F.
- Areas of deck slab repair shown are estimated. The Engineer shall show actual locations of deck repairs on As-Built plans.
- All new structural steel shall be hot-dip galvanized. See Special Provisions for "Hot Dip Galvanizing for Structural Steel".
- Cost of removal and re-installation of all members necessary to complete the work as detailed on the plans and as specified in the Special Provisions shall be included with Furnishing and Erecting Structural Steel.
- Existing structural steel that will be in contact with new structural steel shall be cleaned and painted prior to erection as required by the special provision "Cleaning and Painting Contact Surface Areas of Existing Steel Structures".
- Diaphragm connection holes shall be $\frac{15}{16}$ " dia. for $\frac{3}{4}$ " dia. bolts. Two hardened washers shall be required at diaphragm connections.

TOTAL BILL OF MATERIAL

ITEM	UNIT	QUANTITY
Concrete Removal	Cu. Yd.	16.2
Structure Excavation	Cu. Yd.	2.4
Concrete Structures	Cu. Yd.	2.3
Concrete Superstructure	Cu. Yd.	14.8
Bridge Deck Grooving	Sq. Yd.	316
* Protective Coat	Sq. Yd.	344
Furnishing and Erecting Structural Steel	Pound	1470
Reinforcement Bars, Epoxy Coated	Pound	2160
Bar Splicers	Each	40
Preformed Joint Strip Seal	Foot	75
Controlled Low-Strength Material	Cu. Yd.	2.4
Structural Steel Removal	Pound	1170
Bridge Deck Scarification, $\frac{3}{4}$ "	Sq. Yd.	317
Bridge Deck Microsilica Concrete Overlay, 2½"	Sq. Yd.	317
Deck Slab Repair (Full Depth, Type II)	Sq. Yd.	10
Structural Repair of Concrete, Depth ≤5"	Sq. Ft.	17

* On new deck surface & top & inside face of new parapet concrete only

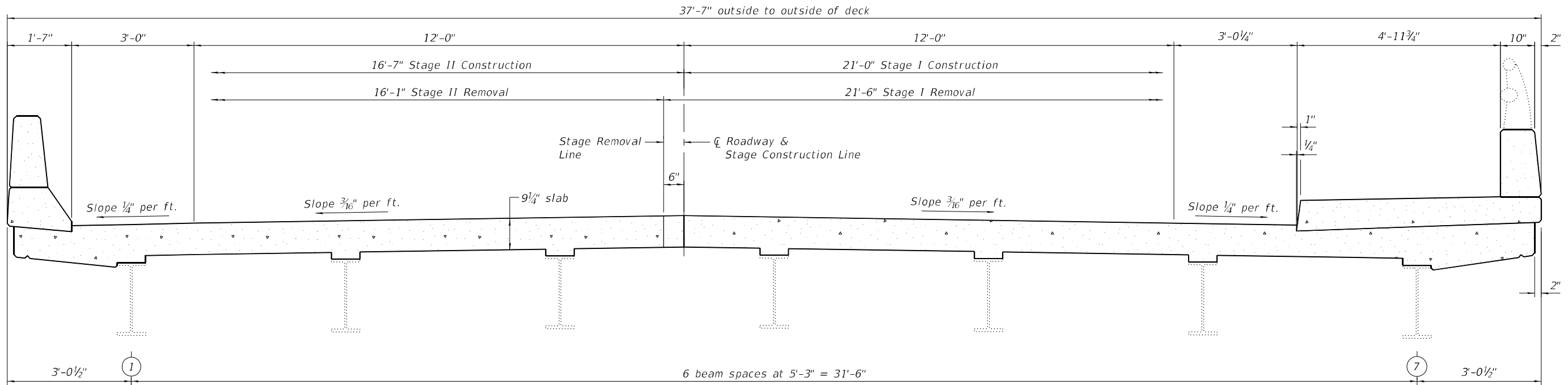

CROSS SECTION AT JOINT REPLACEMENT LOCATIONS
(Looking South)

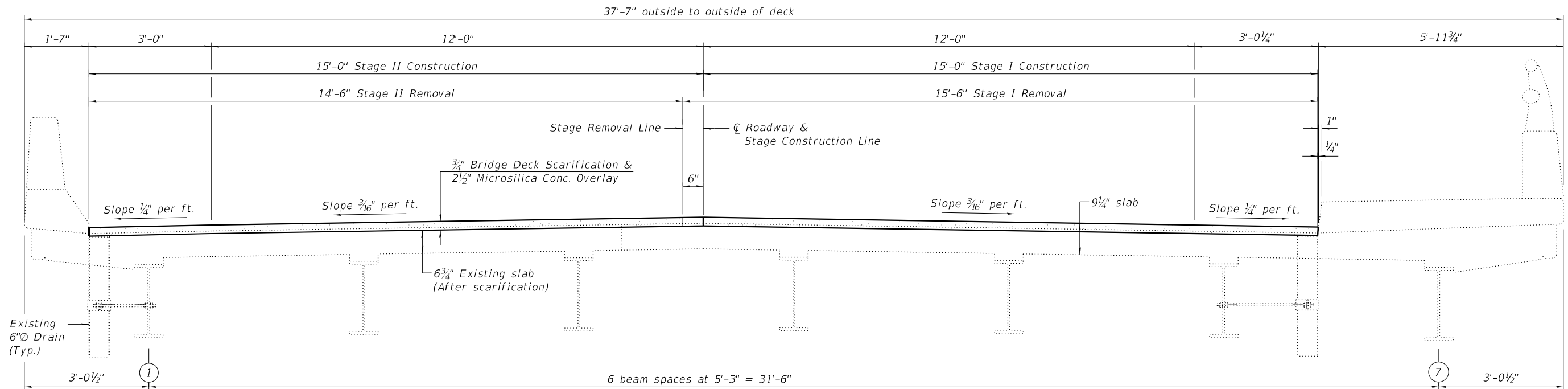

CROSS SECTION AT MID SPANS
(Looking South)

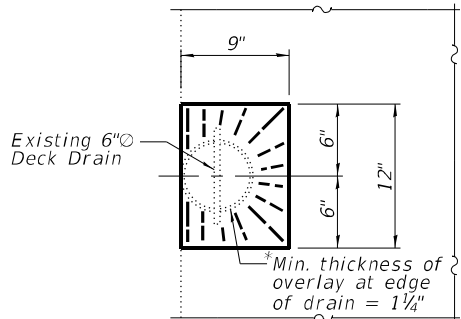

OVERLAY TREATMENT AT DRAINS

MODEL: Default
FILE NAME: J:\18040.06 IDOT D6 - PTB 187-011 - W06 - Scott County 72M65\CADDData\CADSheets\0860006-72M65-002-Staging-Sec-rev.10-29-2021.dgn
10/29/2021 11:35:15 AM

 KUHN & TRELLO CONSULTING ENGINEERS A Limited Liability Company 109 N. 7th Street, 3rd Floor Springfield, IL 62702 Phone: 217-618-0244 Professional Design Firm No. 184-006516	USER NAME =		DESIGNED - SPN	REVISED -	STATE OF ILLINOIS DEPARTMENT OF TRANSPORTATION	STAGING DETAILS & CROSS SECTION STRUCTURE NO. 086-0006				F&P RTE.	SECTION	COUNTY	TOTAL SHEETS	SHEET NO.				
	CHECKED - MJT		DRAWN - MMY	REVISED -						562	(116) BDR, BRR, BJR	SCOTT	31	16				
	PLOT SCALE =		CHECKED - SPN/MJT	REVISED -						CONTRACT NO. 72M65								
	PLOT DATE =									ILLINOIS FED. AID PROJECT								
										SHEET 2 OF 12 SHEETS								

MODEL: Default
FILE NAME: \\18040.06 \DOT D6 - PTB 187-011 - WO6 - Scott County 72M65\CADDData\CADSheets\0860006-72M65-004-Joint plan-N-rev10-29-2021.dgn
10/29/2021 11:34:08 AM

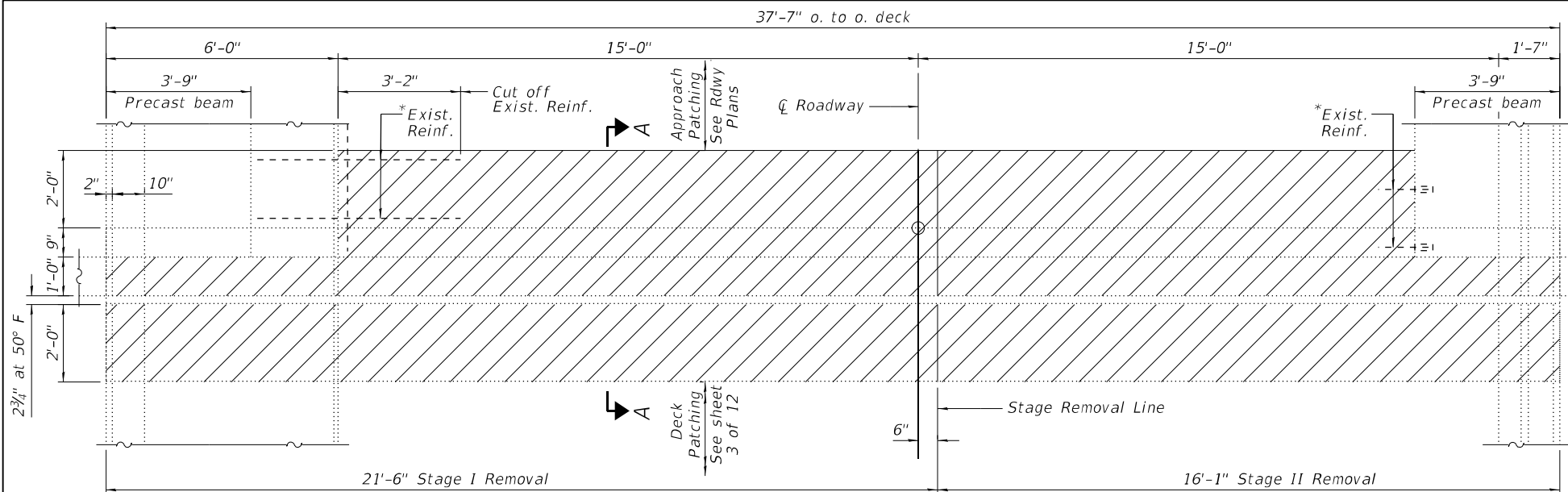

*Existing reinforcement extending into the removal area shall be cleaned, straightened & incorporated into the new construction unless noted otherwise. Any reinforcement bars that are damaged during concrete removal shall be replaced with an approved bar splicer or anchorage system. Cost shall be included with Concrete Removal.

CONCRETE REMOVAL PLAN

MIN. LAP

#4 bars = 2'-5"
#5 bars = 3'-0"
#6 bars = 4'-0"

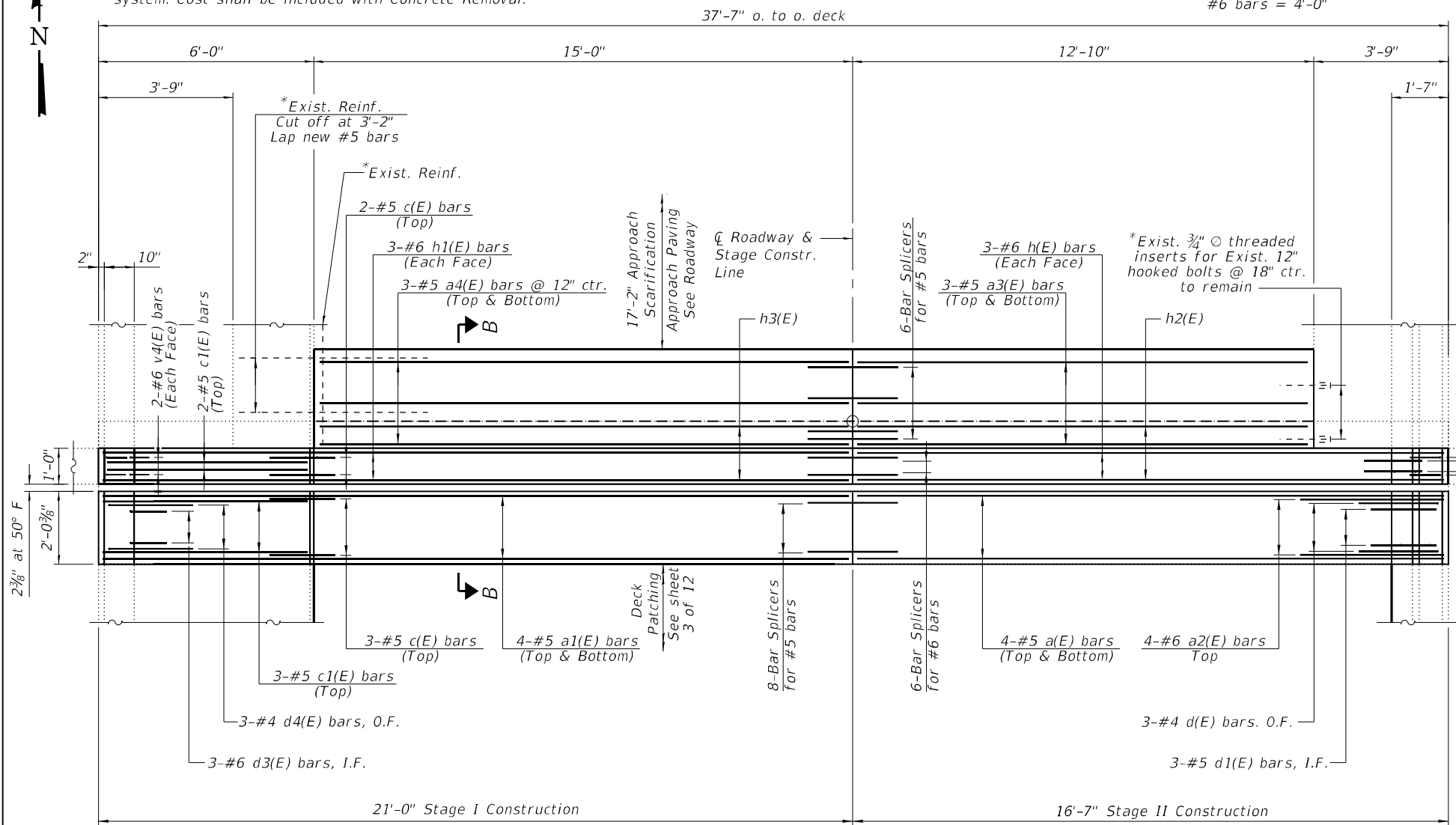

PROPOSED CONCRETE PLAN

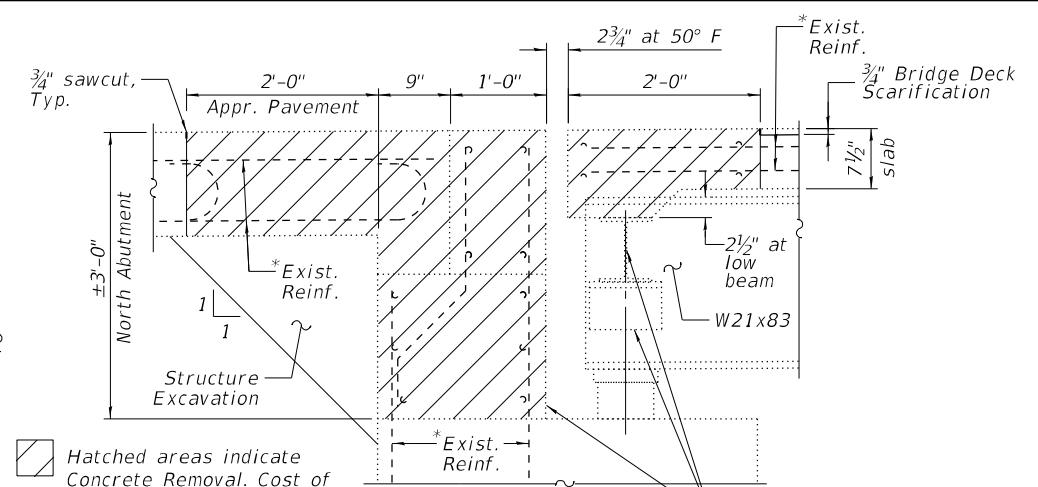

SECTION A-A

Remove existing backwall, diaphragm & angle seats See Sheet 6 of 12

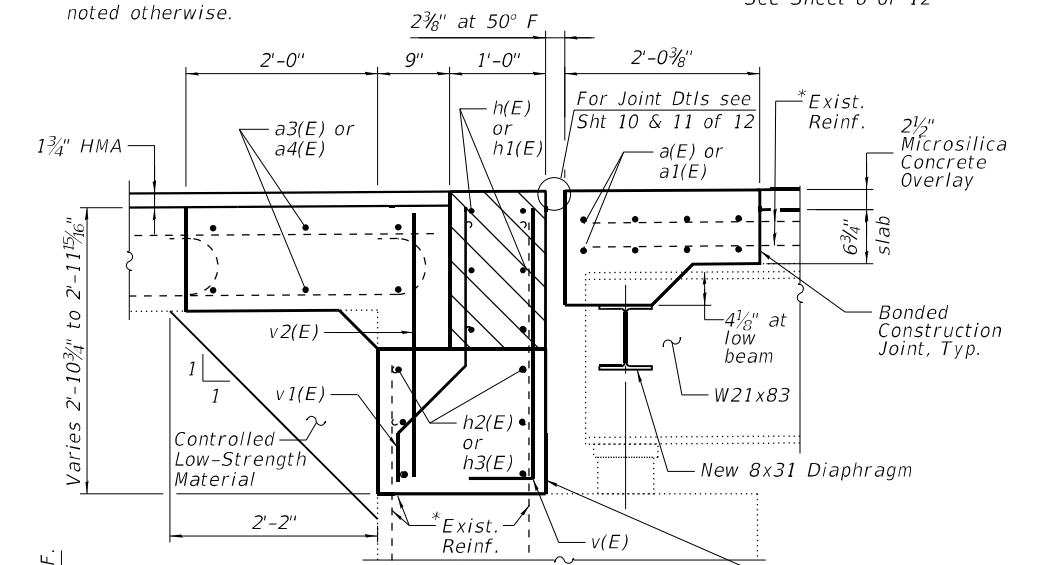

SECTION B-B

Abutment backwall See Sheet 6 of 12

Indicates Hatch block area

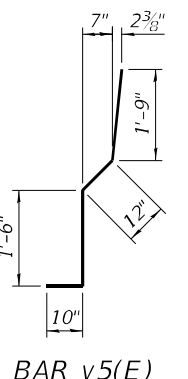
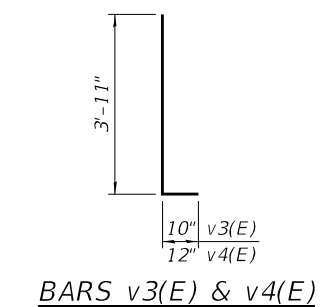
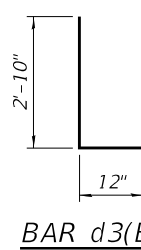
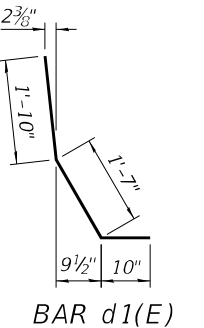
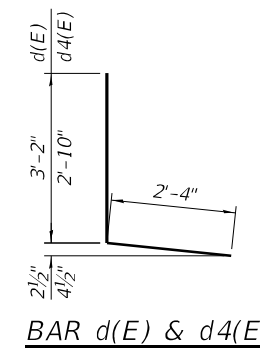
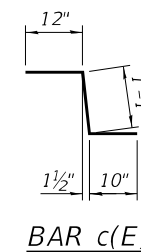

JOINT REMOVAL & REPLACEMENT DETAILS AT NORTH ABUTMENT STRUCTURE NO. 086-0006

SHEET 4 OF 12 SHEETS

USER NAME =	DESIGNED - SPN	REVISED -
PLOT SCALE =	CHECKED - MJT	REVISED -
PLOT DATE =	DRAWN - MMY	REVISED -
	CHECKED - SPN/MJT	REVISED -

STATE OF ILLINOIS
DEPARTMENT OF TRANSPORTATION

F&P RTE.	SECTION	COUNTY	TOTAL SHEETS	SHEET NO.
562	(116) BDR, BRR, BJR	SCOTT	31	18
CONTRACT NO. 72M65				
ILLINOIS FED. AID PROJECT				

MODEL: Default
FILE NAME: J:\180406_06 IDOT D6 - PTB 187-011 - W06 - Scott County 72M65\CADD\Sheet\0860006-72M65-005-Elev-N.dgn
10/14/2021 1:28:38 PM

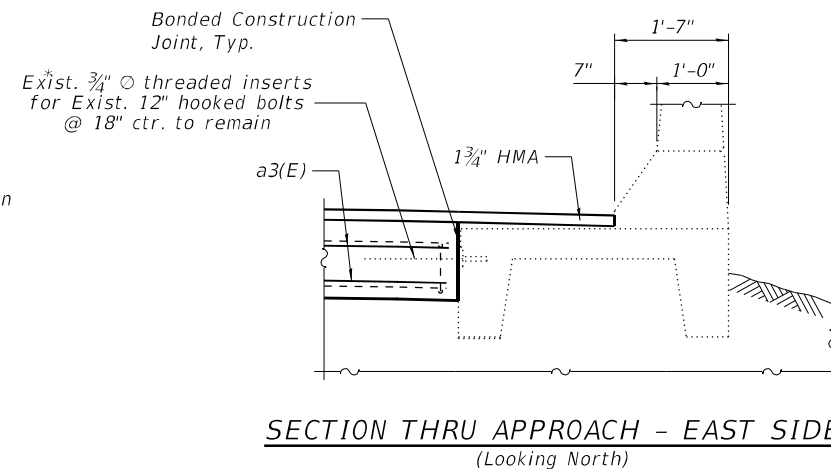
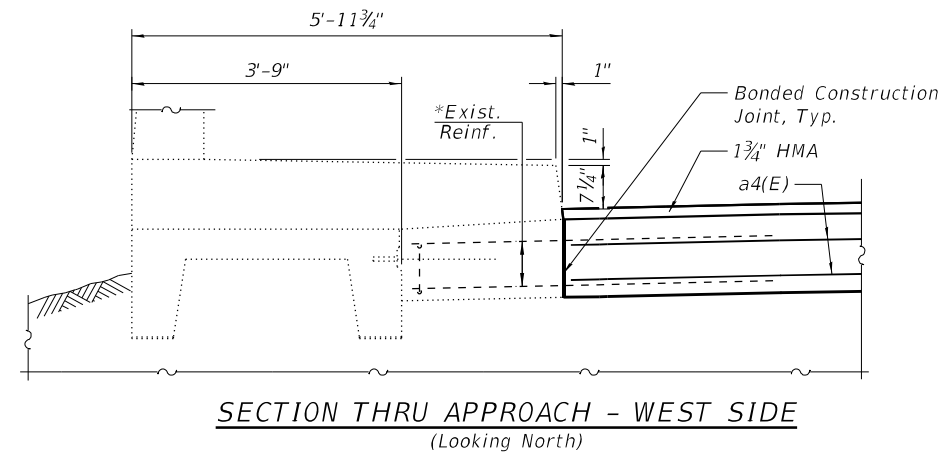
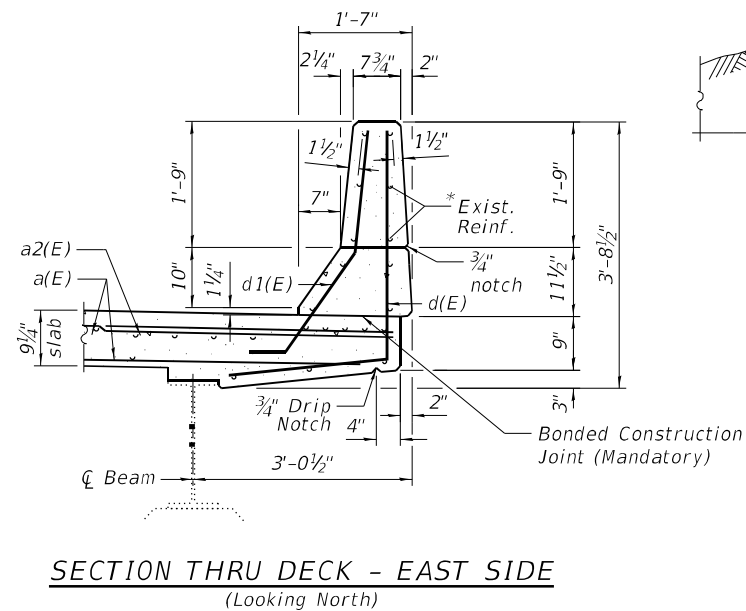
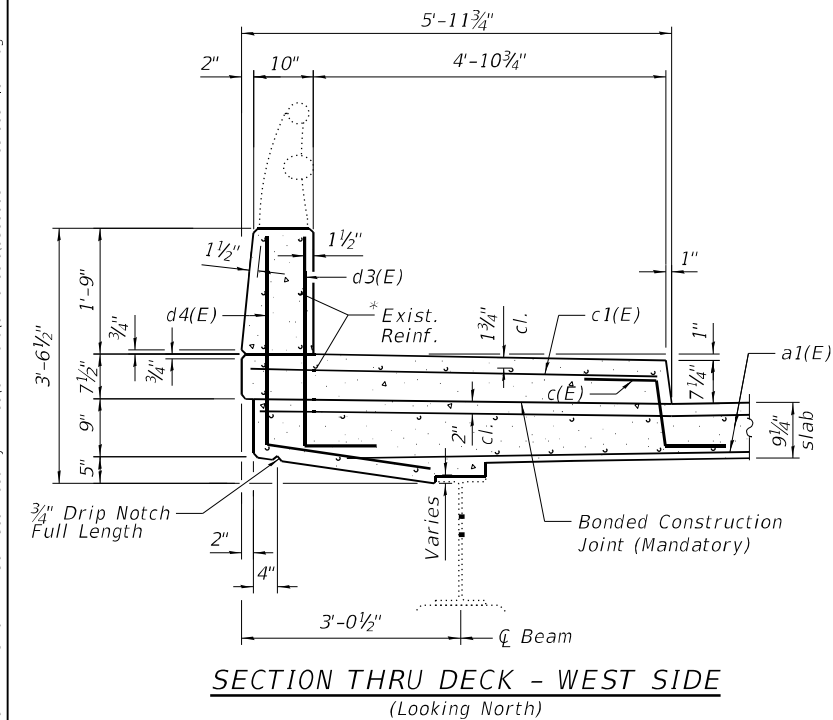
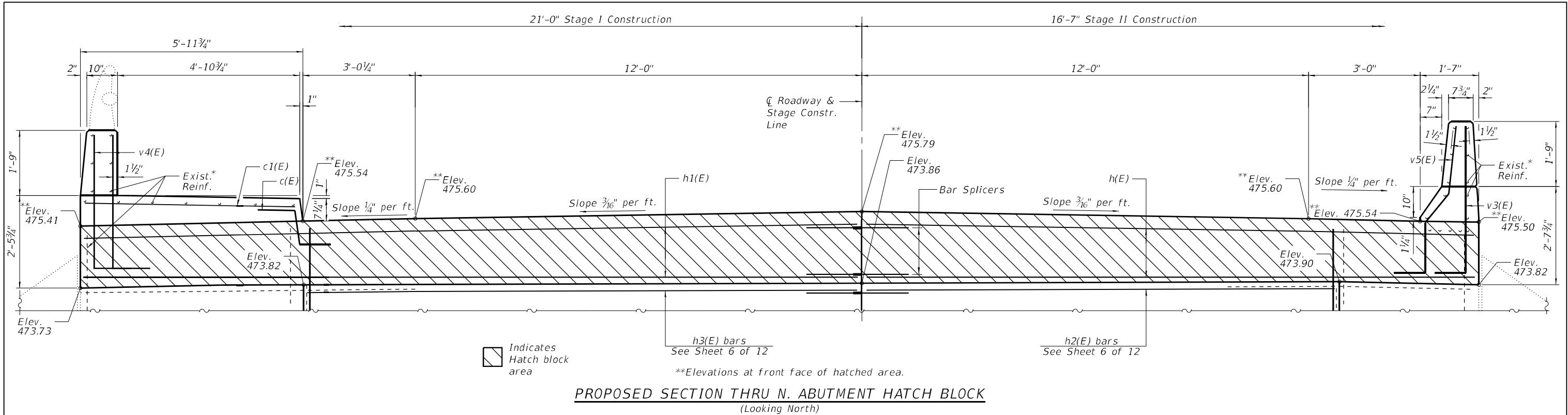

BILL OF MATERIAL
NORTH JOINT

Bar	No.	Size	Length	Shape
a(E)	8	#5	16'-3"	—
a1(E)	8	#5	20'-8"	—
a2(E)	8	#6	4'-0"	—
a3(E)	6	#5	12'-6"	—
a4(E)	6	#5	14'-8"	—
c(E)	5	#5	2'-11"	~
c1(E)	5	#5	5'-7"	—
d(E)	3	#4	5'-6"	L
d1(E)	3	#5	4'-3"	~
d3(E)	3	#6	3'-10"	L
d4(E)	3	#4	5'-2"	L
h(E)	6	#6	16'-3"	—
h1(E)	6	#6	20'-8"	—
v3(E)	2	#5	4'-9"	L
v4(E)	4	#6	4'-11"	L
v5(E)	2	#5	5'-1"	~
Structure Excavation			Cu. Yd.	2.4
Controlled Low-Strength Material			Cu. Yd.	2.4
Concrete Removal			Cu. Yd.	8.7
Concrete Superstructure			Cu. Yd.	9.5
Reinforcement Bars, Epoxy Coated			Pound	1010
Bar Splicers			Each	20
Structural Steel Removal			Pound	1170



USER NAME =	DESIGNED - SPN	REVISED -
	CHECKED - MJT	REVISED -
PLOT SCALE =	DRAWN - MMY	REVISED -
PLOT DATE =	CHECKED - SPN/MJT	REVISED -

STATE OF ILLINOIS
DEPARTMENT OF TRANSPORTATION

NORTH JOINT SUPERSTRUCTURE DETAILS
STRUCTURE NO. 086-0006

SHEET 5 OF 12 SHEETS

F&P RITE.	SECTION	COUNTY	TOTAL SHEETS	SHEET NO.
562	(116) BDR, BRR, BJR	SCOTT	31	19
CONTRACT NO. 72M65				
ILLINOIS FED. AID PROJECT				

MODEL: Default
FILE NAME: J:\180406 IDOT D6 - PTB 187-011 - W06 - Scott County 72M65\CADDData\CADSheets\0860006-72M65-006-Abut-N.dgn
10/14/2021 1:28:39 PM

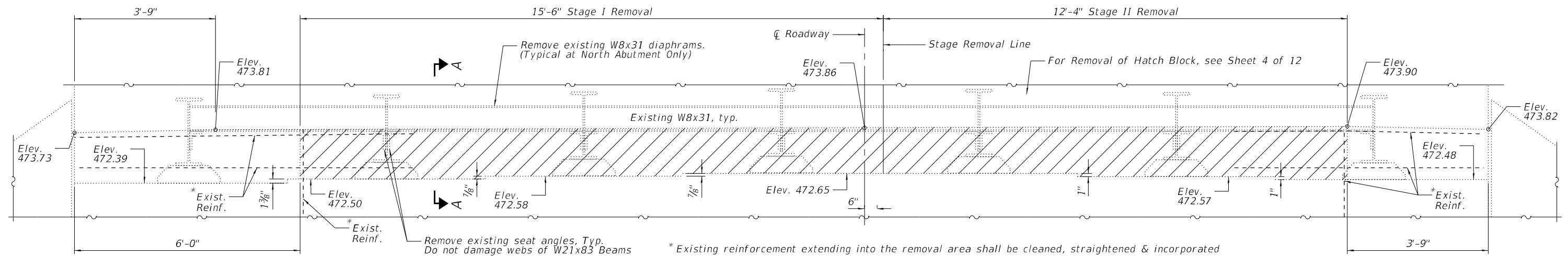

Note:
Existing bearings to remain.

REMOVAL SECTION THRU ABUTMENT BACKWALL (Looking North)

Concrete Removal

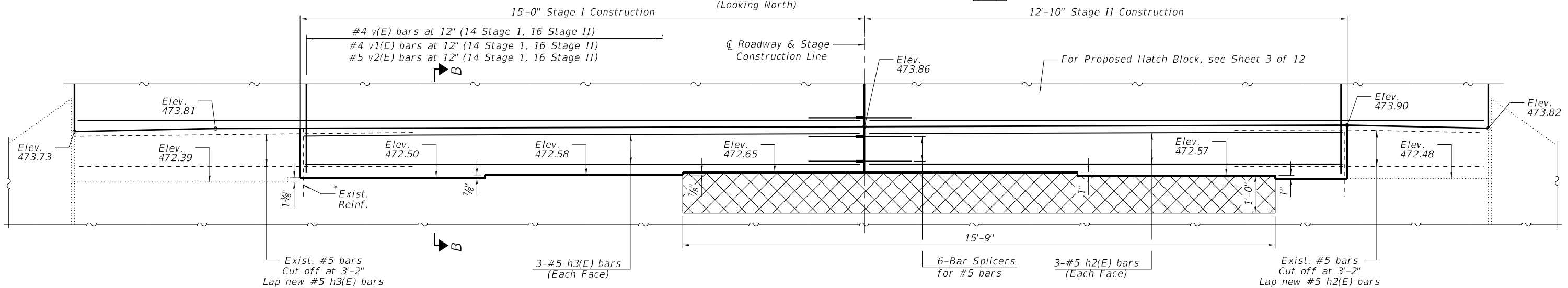

PROPOSED SECTION THRU ABUTMENT BACKWALL (Looking North)

Structural Repair of Concrete
(Depth Equal to or Less than Five Inches)

MIN. LAP
#5 bar 3'-0"

BILL OF MATERIAL NORTH ABUTMENT

Bar	No.	Size	Length	Shape
h2(E)	6	#5	12'-7"	
h3(E)	6	#5	14'-9"	
v(E)	30	#4	3'-4"	L
v1(E)	30	#4	3'-0"	
v2(E)	30	#5	2'-6"	
Concrete Structures				Cu. Yd. 2.3
Concrete Removal				Cu. Yd. 2.3
Reinforcement Bars, Epoxy Coated				Pound 380
Bar Splicers				Each 6
Structural Repair of Concrete (Depth ≤ 5")				Sq. Ft. 17

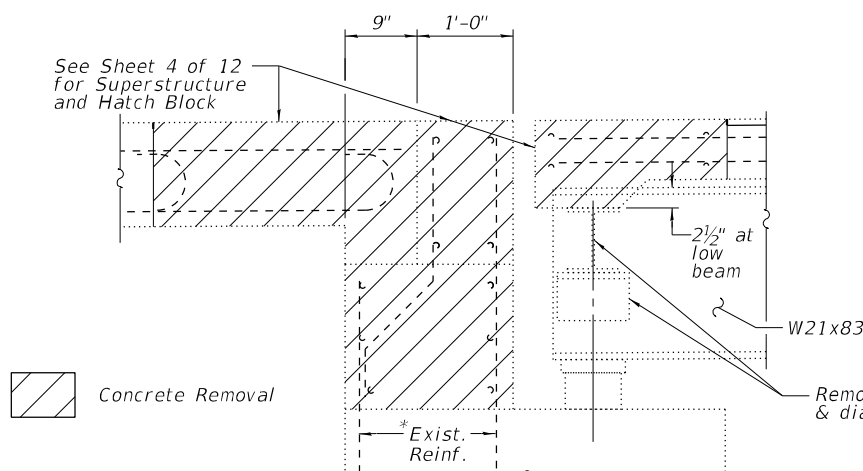

SECTION A-A

Note:
Existing seat angles to be removed using the air-arc method and grind smooth all weld material remaining on the web. Cost included with Structural Steel Removal. Trim Diaphragm as required.

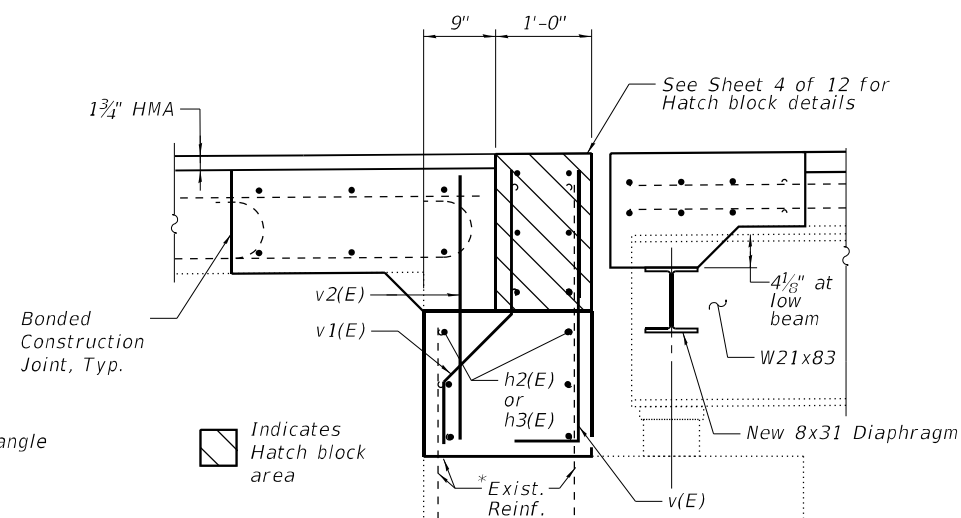

SECTION B-B

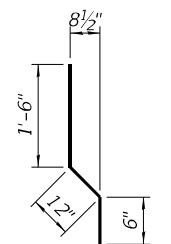
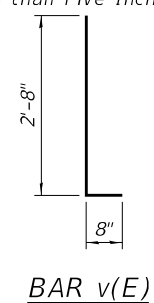

USER NAME =	DESIGNED - SPN	REVISED -
CHECKED - MJT	REVISED -	
PLOT SCALE =	DRAWN - MMY	REVISED -
PLOT DATE =	CHECKED - SPN/MJT	REVISED -

STATE OF ILLINOIS
DEPARTMENT OF TRANSPORTATION

REPAIR DETAILS - NORTH ABUTMENT
STRUCTURE NO. 086-0006

SHEET 6 OF 12 SHEETS

FAP RITE	SECTION	COUNTY	TOTAL SHEETS	SHEET NO.
562	(116) BDR, BRR, BJR	SCOTT	31	20
CONTRACT NO. 72M65				
ILLINOIS FED. AID PROJECT				

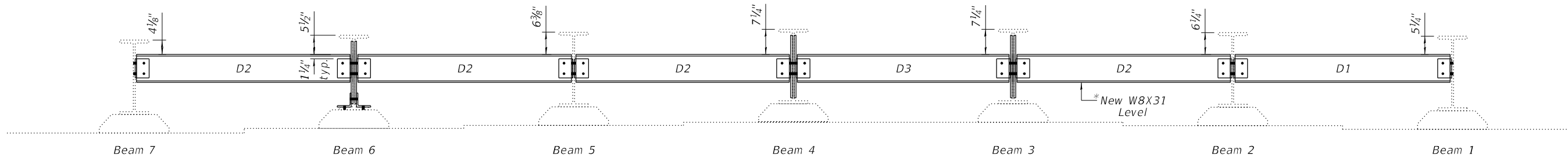

NORTH ABUTMENT ELEVATION
(Looking North)

DIAPHRAGM	LENGTH	# Req'd
D1	5'-1 $\frac{3}{4}$ "	1
D2	5'-1 $\frac{1}{4}$ "	4
D3	5'-0 $\frac{3}{4}$ "	1

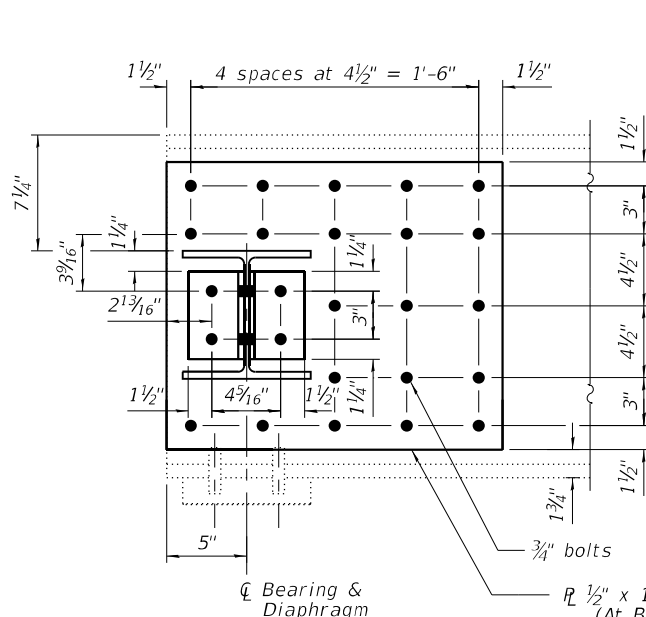

BEAMS 3 & 4

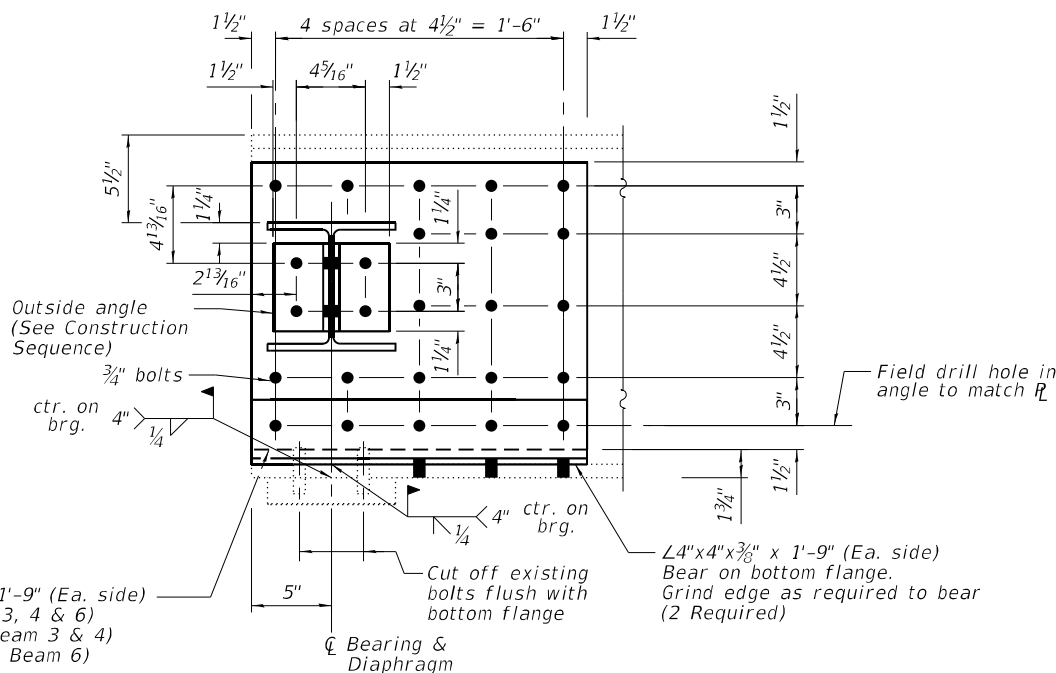

BEAM 6

CONNECTION PLATE DETAILS

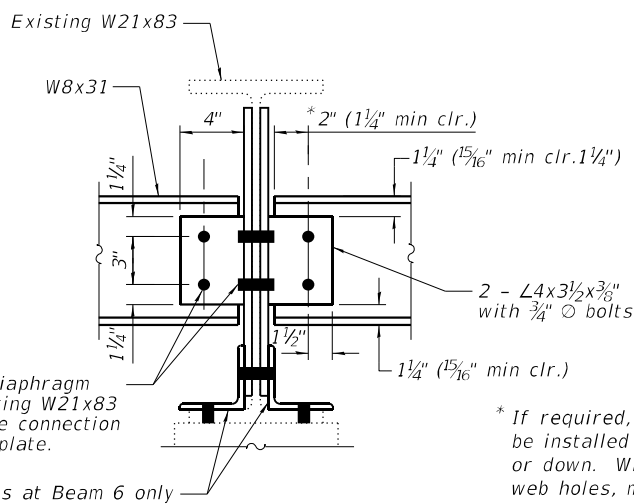

SECTION - BEAMS 3, 4 & 6

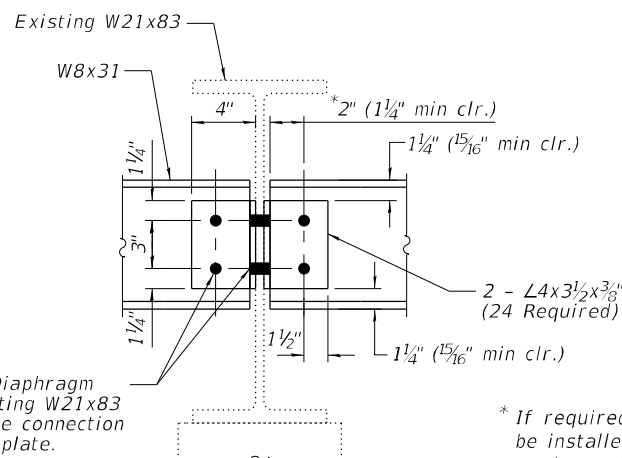

SECTION - BEAMS 2 & 5
(Beam 1 & 7 similar - one side)

CONSTRUCTION SEQUENCE

1. Install repair plates field drilling existing webs using plates as template.
2. Install inside diaphragm connection angles, field drilling existing webs using angles as template.
3. Install diaphragms and outside connection angles, field drilling diaphragm webs using inside angle as template.
4. Field drill holes in existing beams using outside angles as template and connect outside connection angles.

Note:
Contractor required to field check existing conditions before fabrication.
All holes in new plates and angles to be shop drilled except bottom flange angles at bearing, as noted.

**BILL OF MATERIAL
STRUCTURAL STEEL**

ITEM	UNIT	QUANTITY
Furnishing and Erecting Structural Steel	Pound	1470

MODEL: Default
FILE NAME: J:\180406\DOT D6 - PTB 187-011 - W06 - Scott County 72M65\CAD\Struct\0860006-72M65-007-Steel-N-rev10-29-2021.dgn
10/29/2021 1:55:30 PM



USER NAME =	DESIGNED - SPN	REVISED -
CHECKED - MJT	REVISED -	
PLOT SCALE =	DRAWN - MMY	REVISED -
PLOT DATE =	CHECKED - SPN/MJT	REVISED -

**STATE OF ILLINOIS
DEPARTMENT OF TRANSPORTATION**

**REPAIR DETAILS - NORTH ABUTMENT
STRUCTURE NO. 086-0006**

SHEET 7 OF 12 SHEETS

F&P RTE.	SECTION	COUNTY	TOTAL SHEETS	SHEET NO.
562	(116) BDR, BRR, BJR	SCOTT	31	21
CONTRACT NO. 72M65				
ILLINOIS FED. AID PROJECT				

MODEL: Default
FILE NAME: J:\18040.06 IDOT D6 - PTB 187-011 - W06 - Scott County 72M65\CADD\Sheet\0860006-72M65-008-joint-5.dgn
10/14/2021 1:28:43 PM

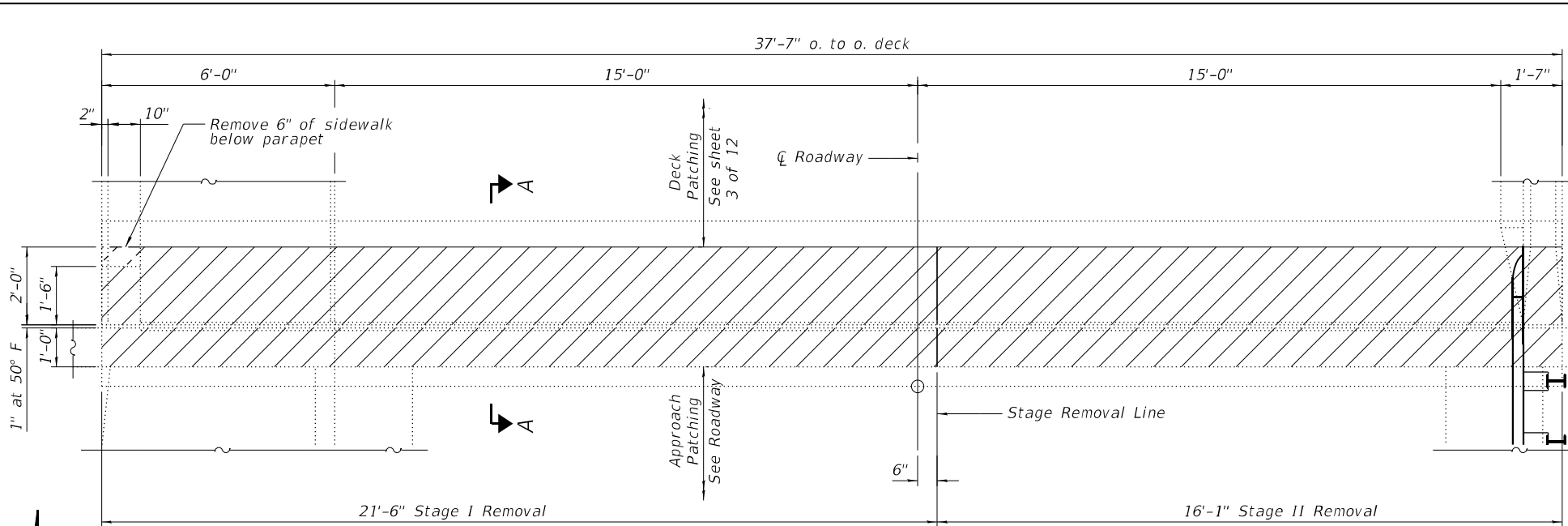

CONCRETE REMOVAL

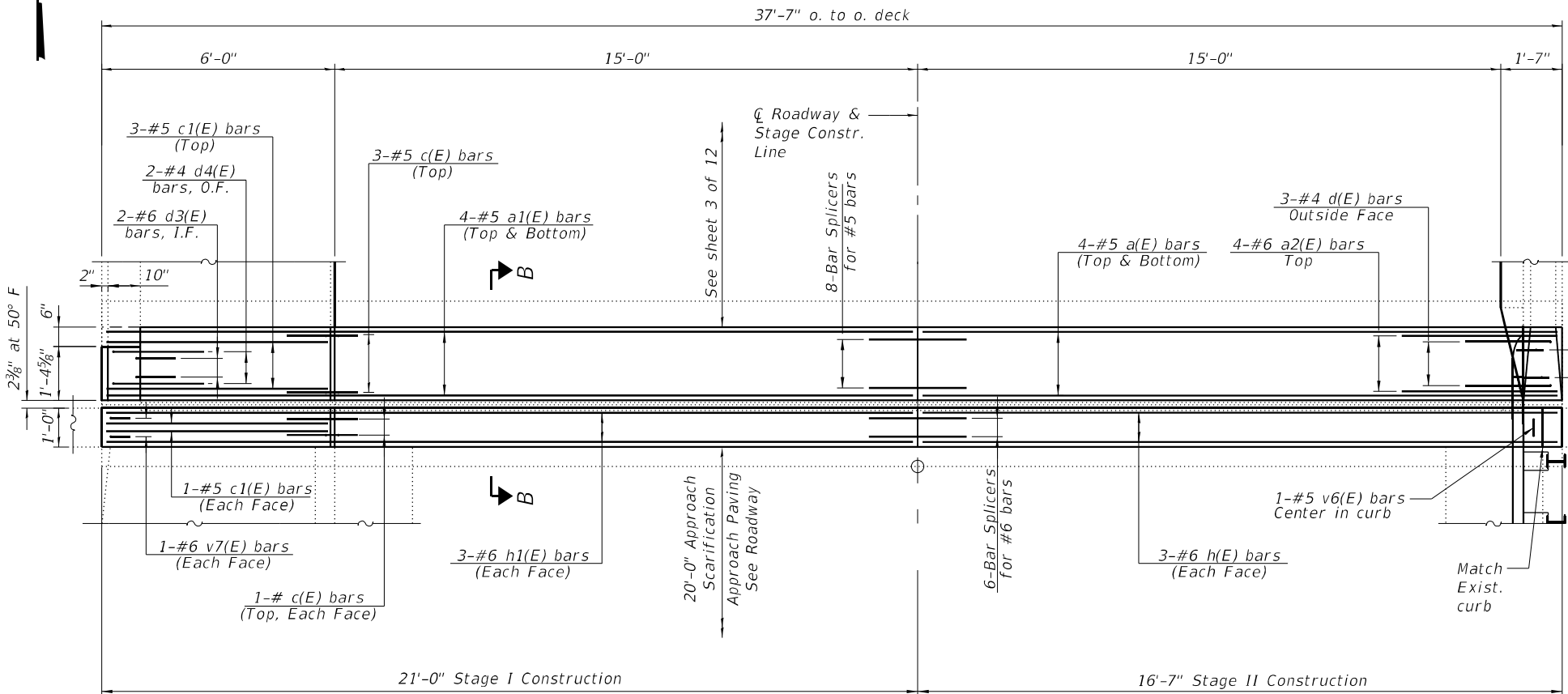

PROPOSED CONCRETE

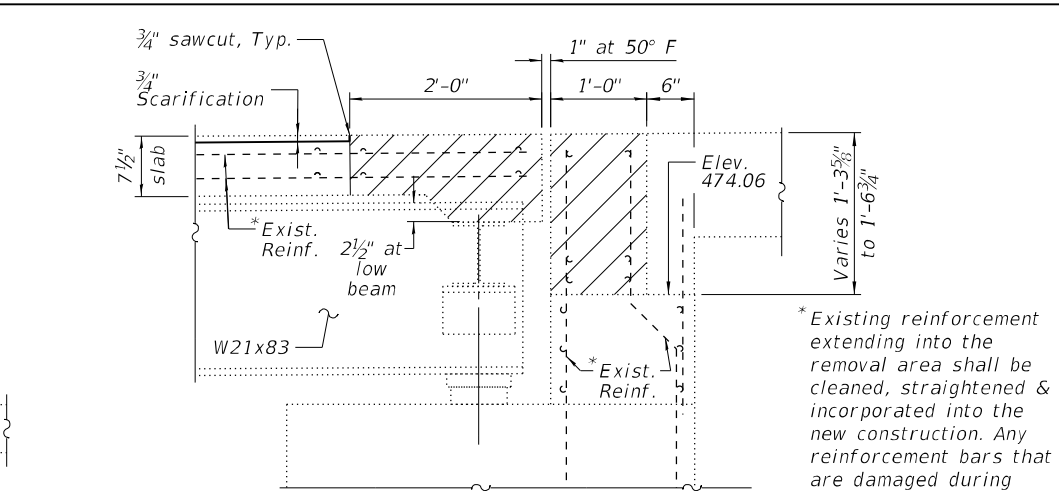

SECTION A-A

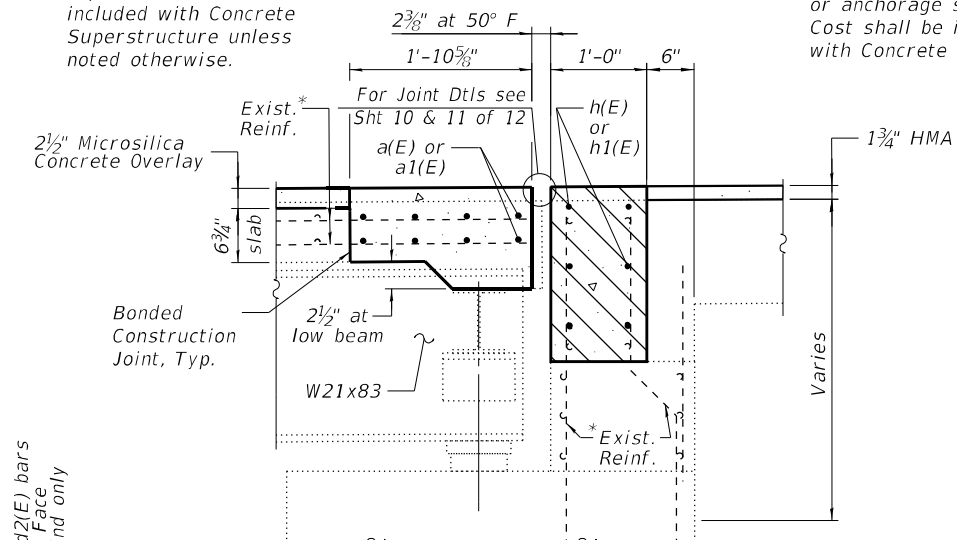

SECTION B-B

**BILL OF MATERIAL
SOUTH ABUTMENT**

Bar	No.	Size	Length	Shape
a(E)	8	#5	16'-3"	—
a1(E)	8	#5	20'-8"	—
a2(E)	4	#6	4'-0"	—
c(E)	5	#5	2'-11"	∩
c1(E)	5	#5	5'-7"	—
d(E)	3	#4	5'-6"	L
d2(E)	3	#5	4'-0"	L
d3(E)	2	#6	3'-10"	L
d4(E)	2	#4	5'-2"	L
h(E)	6	#6	16'-3"	—
h1(E)	6	#6	20'-8"	—
v6(E)	1	#5	4'-3"	Π
v7(E)	2	#5	3'-6"	C
Concrete Removal			Cu. Yd.	5.2
Concrete Superstructure			Cu. Yd.	5.3
Reinforcement Bars, Epoxy Coated			Pound	770
Bar Splicers			Each	14

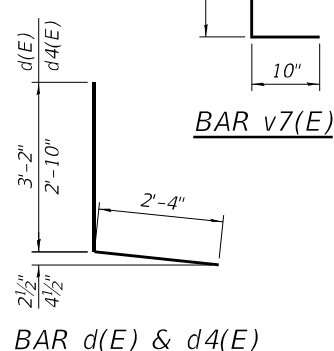
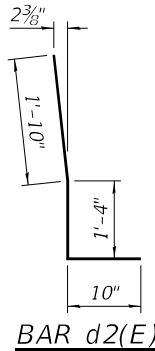
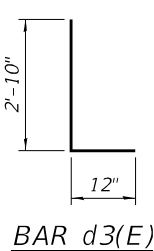
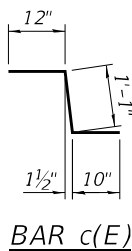

STATE OF ILLINOIS
DEPARTMENT OF TRANSPORTATION

JOINT REMOVAL & REPLACEMENT DETAILS AT SOUTH ABUTMENT
STRUCTURE NO. 086-0006

SHEET 8 OF 12 SHEETS

F&P RITE	SECTION	COUNTY	TOTAL SHEETS	SHEET NO.
562	(116) BDR, BRR, BJR	SCOTT	31	22
CONTRACT NO. 72M65				
ILLINOIS FED. AID PROJECT				

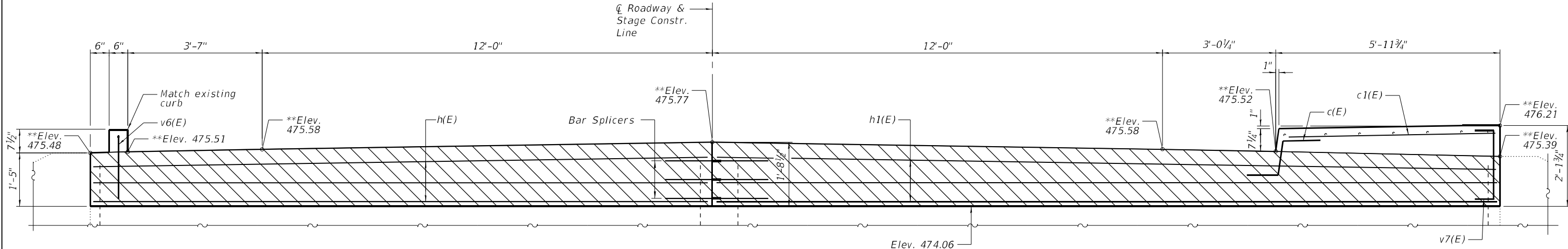

Indicates Hatch block area

Note: **Elevations at front face of hatch area.

PROPOSED SECTION THRU S. ABUTMENT HATCH BLOCK
(Looking South)

Note: Cost for all materials and labor to reconnect the rail is included in Concrete Superstructure.

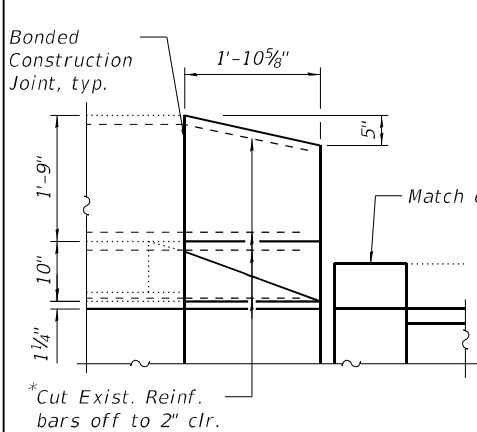

INSIDE ELEVATION OF EAST PARAPET
(Looking East at South Joint)

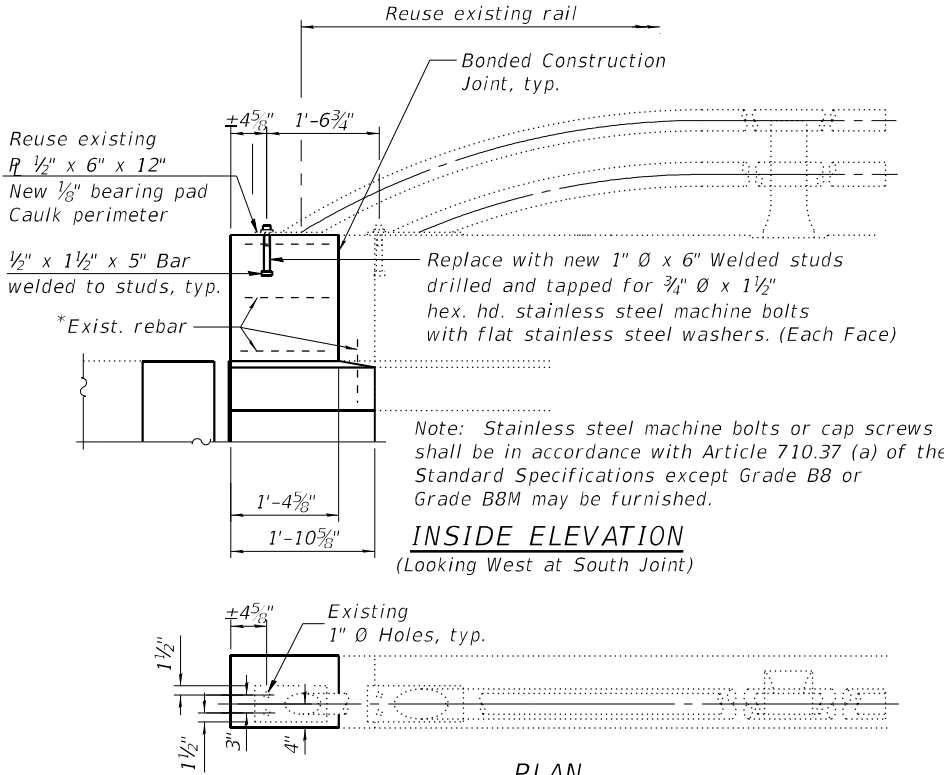
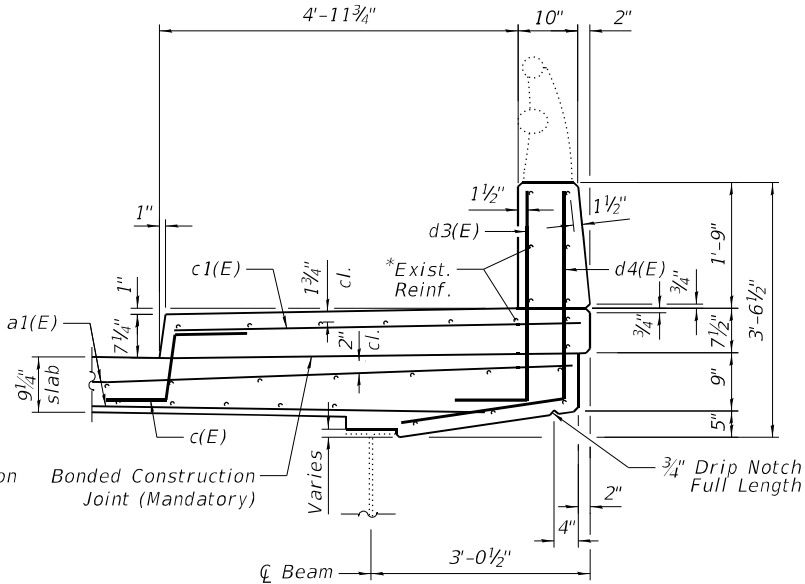
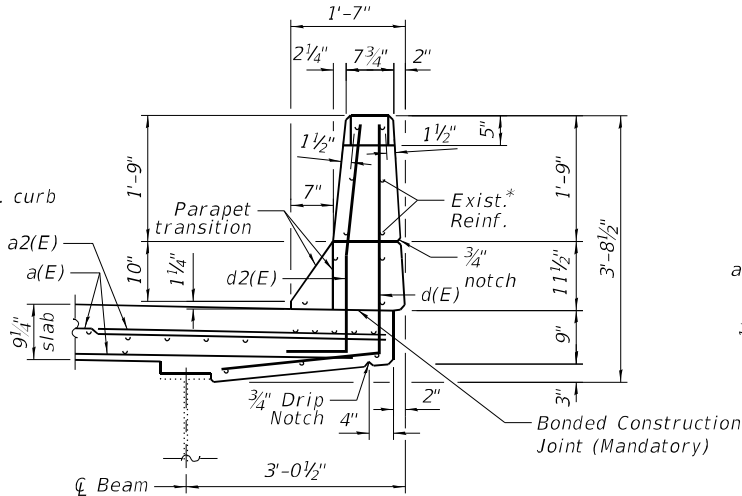

PLAN RAIL TERMINATION SECTION
(Looking West at South Joint)

MODEL: Default
FILE NAME: J:\18040.06 IDOT D6 - PTB 187-011 - W06 - Scott County 72M65\CADD\Sheet\0860006-72M65-009-Det-5.dgn
10/14/2021 1:28:44 PM

<div><div>KUHN & TRELLO CONSULTING ENGINEERS <small>A Limited Liability Company</small> 100 N. 7th Street, 3rd Floor Springfield, IL 62702 Phone: 217-618-0244 Professional Design Firm No. 284-006516</div></div>	USER NAME	=	DESIGNED	-	SPN	REVISED	-	<div>STATE OF ILLINOIS DEPARTMENT OF TRANSPORTATION</div>	<div>JOINT REPLACEMENT DETAILS AT SOUTH ABUTMENT STRUCTURE NO. 086-0006</div>	F.A.P. RTE.	SECTION	COUNTY	TOTAL SHEETS	SHEET NO.
	PLOT SCALE	=	CHECKED	-	MJT	REVISED	-			562	(116) BDR, BRR, BJR	SCOTT	31	23
	PLOT DATE	=	DRAWN	-	MMY	REVISED	-			CONTRACT NO. 72M65				
			CHECKED	-	SPN/MJT	REVISED	-			ILLINOIS FED. AID PROJECT				
	SHEET 9 OF 12 SHEETS													

MODEL: Default
FILE NAME: J:\18040.06 IDOT D6 - PTB 187-011 - WO6 - Scott County 72M65\CADD\Drawings\0860006-72M65-010-Pre\11Det1.dgn
10/14/2021 1:28:46 PM

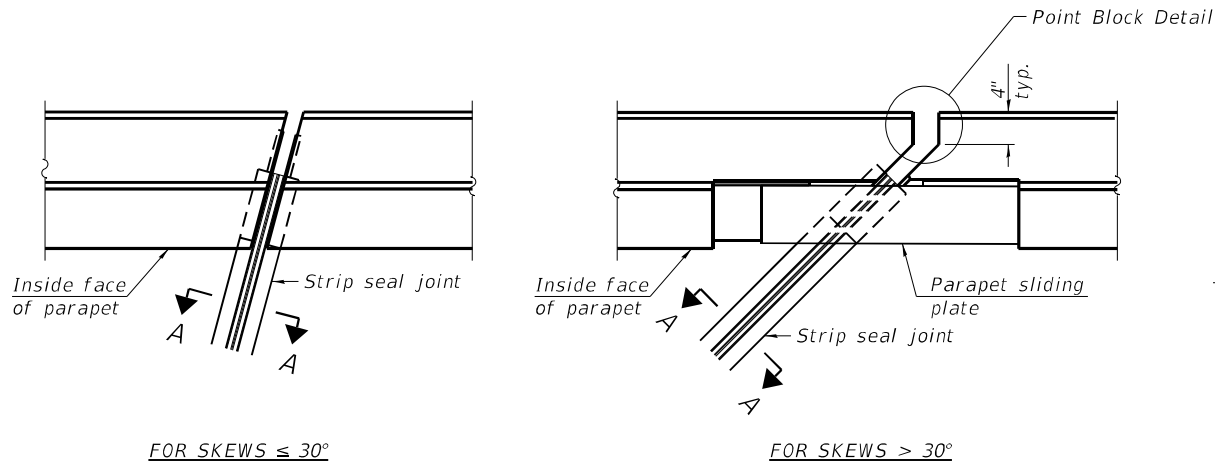

PLAN AT PARAPET

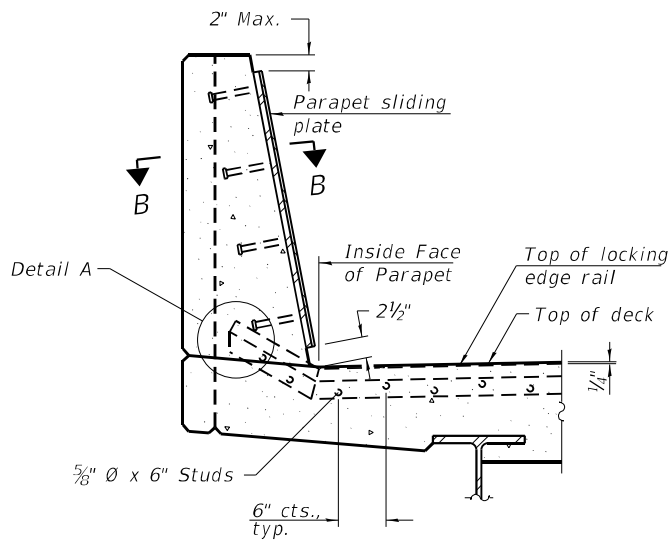

SECTION AT PARAPET

(Skews $> 30^\circ$ shown. Skews $\leq 30^\circ$ similar except as shown in plan view.)

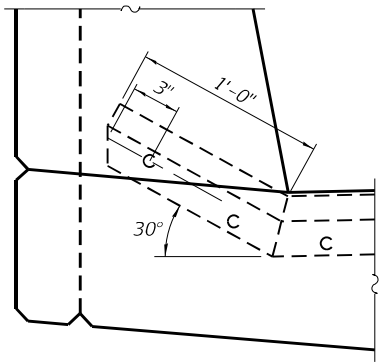

DETAIL A

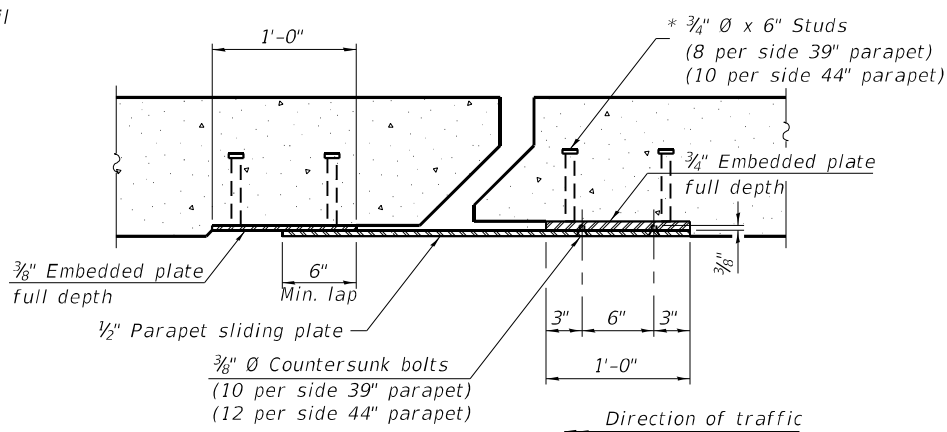

SECTION B-B

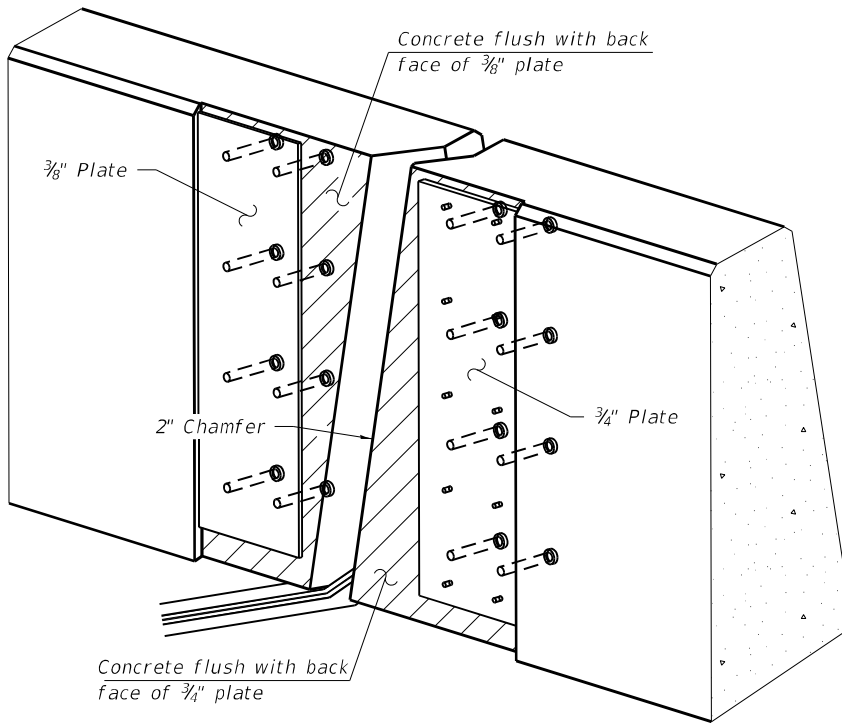

TRIMETRIC VIEW

(Showing embedded plates only)

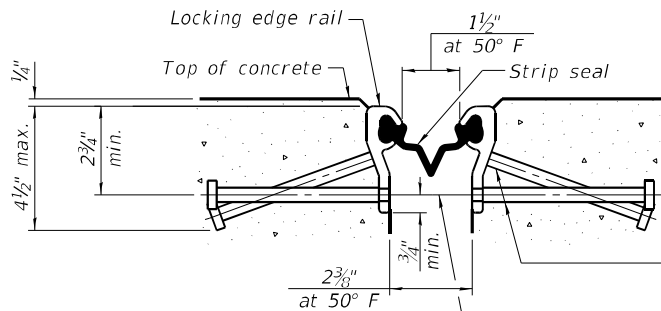

SHOWING ROLLED RAIL JOINT

* 5/8" ϕ x 6" studs @ 6" cts. (alternate angled/bent studs with horizontal studs)

3/8" ϕ threaded rods in 1/16" ϕ holes at ± 4 '-0" cts. for holding the proper joint opening based on the temperature during the deck pour. Place to miss studs. All rods shall be burned, or sawed off flush with the plates after concrete is set.

SECTION A-A

* Granular or solid flux filled headed studs conforming to Article 1006.32 of the Std. Specs., automatically end welded.

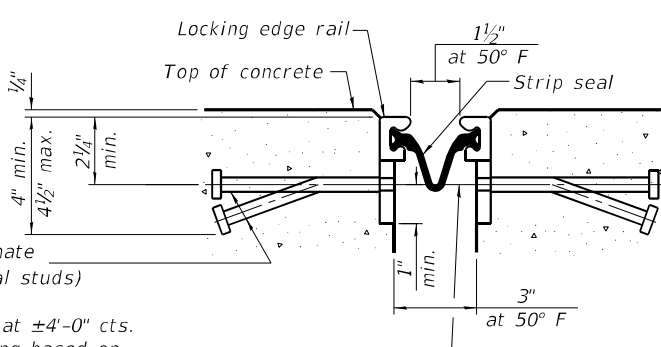

SHOWING WELDED RAIL JOINT

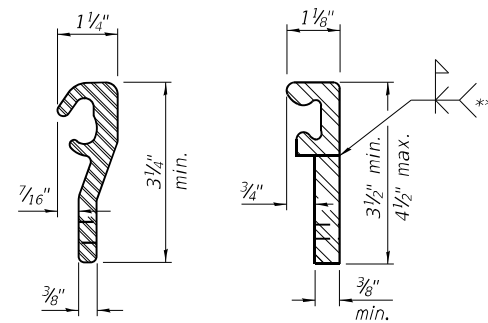

ROLLED (EXTRUDED) RAIL

WELDED RAIL

LOCKING EDGE RAILS

** Back gouge not required if complete joint penetration is verified by mock-up.

LOCKING EDGE RAIL SPLICE

The inside of the locking edge rail groove shall be free of weld residue. Rolled rail shown, welded rail similar.

Notes:

The strip seal shall be made continuous and shall have a minimum thickness of 1/4". The configuration of the strip seal shall match the configuration of the locking edge rails. Open or "webbed" strip seal gland configurations are not permitted. The gland shall be sized for a maximum rated movement of 4 inches.

The locking edge rails depicted are configured for typical applications and are conceptual only. The actual configuration of the locking edge rails and matching strip seal may vary from manufacturer to manufacturer provided they fit the application and meet the minimum anchorage shown. Flanged edge rails, however, will not be allowed. Locking edge rails may exceed the 4 1/2" maximum depth provided the anchorage system is revised according to the manufacturer's recommendation.

The manufacturer's recommended installation methods shall be followed.

All steel components shall be galvanized after fabrication according to Article 520.03 of the Standard Specifications.

The Maximum space between locking edge rail segments shall be 3/16" and sealed with a suitable sealant; however, any rail joint within 10' measured perpendicular to the face of the curb or parapet shall be welded as shown in the locking edge rail splice detail.

The top surface of sidewalk sliding plates shall have a raised pattern according to ASTM A786.

Cost of parapet sliding plates, sidewalk sliding plates, embedded plates, anchorage studs, and expansion anchors included with Preformed Joint Strip Seal.

39" constant slope barrier shown, 44" constant slope barrier similar as noted.

The concrete opening below the strip seal will vary based on the locking edge rail chosen by the Contractor. Deck and parapet lengths shown elsewhere in the plans are dimensioned to the concrete opening, not the joint opening, and are based on the rolled locking edge rail. If the Contractor elects to use a different locking edge rail, dimensional adjustments may be required. One exception to this would be the strip seal joint at the end of the precast bridge approach slab. For these cases the pavement connector length shall be adjusted, not the length of the bridge approach slab.

EJ-SS-S

1-1-2020

(Sheet 1 of 2)

<div><div>KT</div><div>KUHN & TRELLO CONSULTING ENGINEERS A Limited Liability Company 109 N. 7th Street, 3rd Floor Springfield, IL 62702 Phone: 217-678-0244 Professional Design Firm No. 284-006526</div></div>	USER NAME =	DESIGNED - SPN	REVISED -	STATE OF ILLINOIS DEPARTMENT OF TRANSPORTATION	PREFORMED JOINT STRIP SEAL - SIDEWALK STRUCTURE NO. 086-0006	F&P RTE.	SECTION	COUNTY	TOTAL SHEETS	SHEET NO.
		CHECKED - MJT	REVISED -			562	(116) BDR, BRR, BJR	SCOTT	31	24
	PLOT SCALE =	DRAWN - MMY	REVISED -			CONTRACT NO. 72M65				
	PLOT DATE =	CHECKED - SPN/MJT	REVISED -			ILLINOIS FED. AID PROJECT				
SHEET 10 OF 12 SHEETS										

MODEL: Default
FILE NAME: \\18040.06 IDOT D6 - PTB 187-011 - WO6 - Scott County 72M65\CADD\Drawings\0860006-72M65-011-Pre\11Det2.dgn
10/14/2021 1:28:47 PM

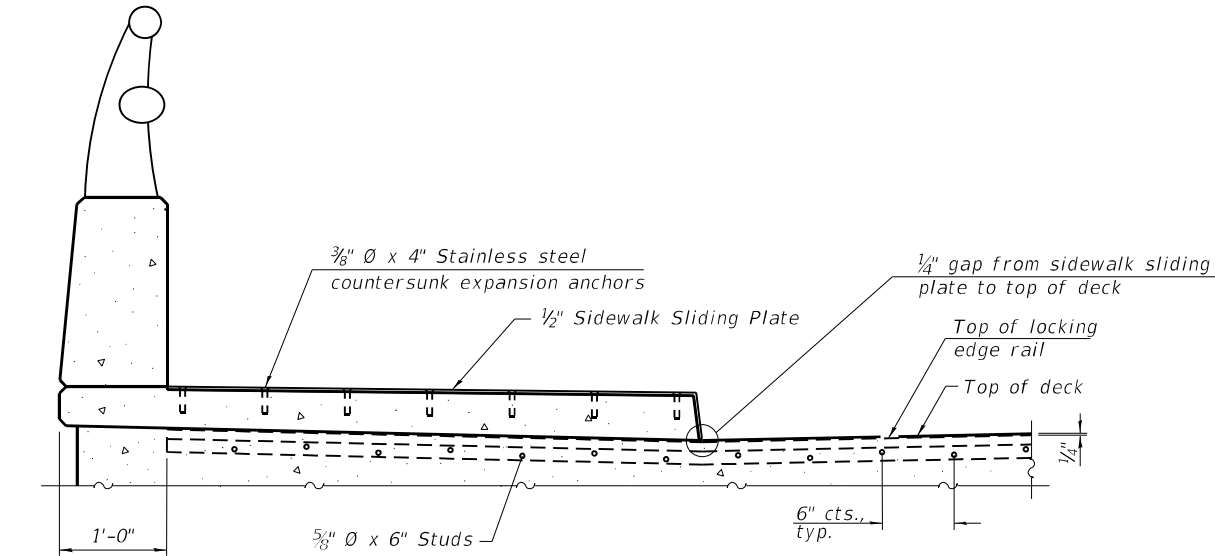

SECTION AT RAISED SIDEWALK

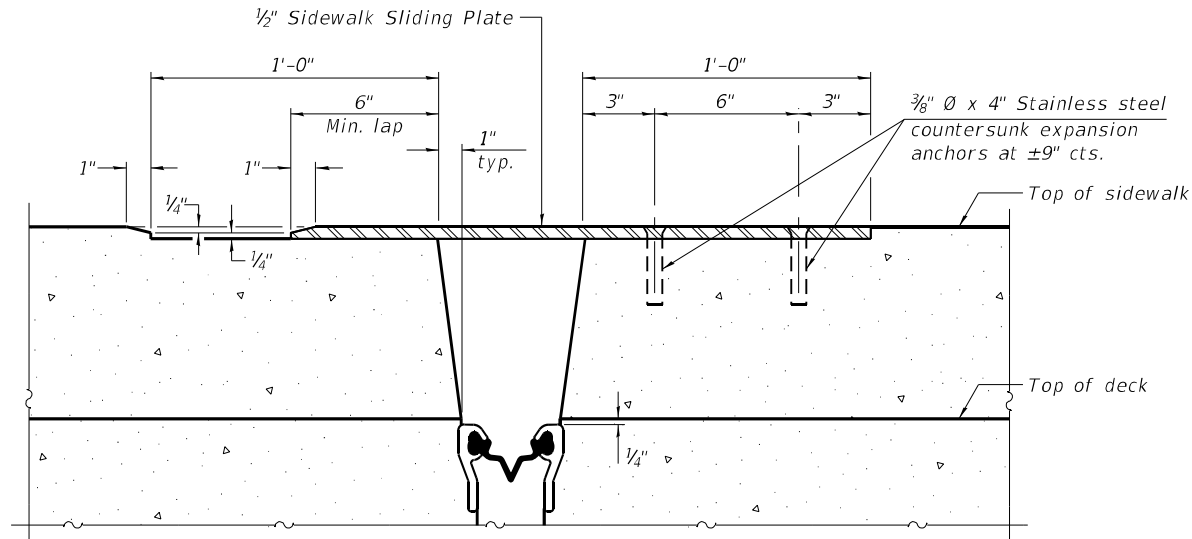

SECTION C-C

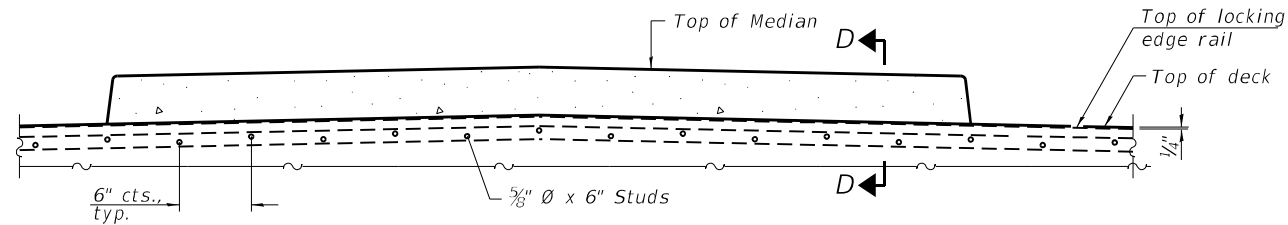

SECTION AT MEDIAN

For skews > 30°, chamfer acute corners 2" similar to sidewalk.

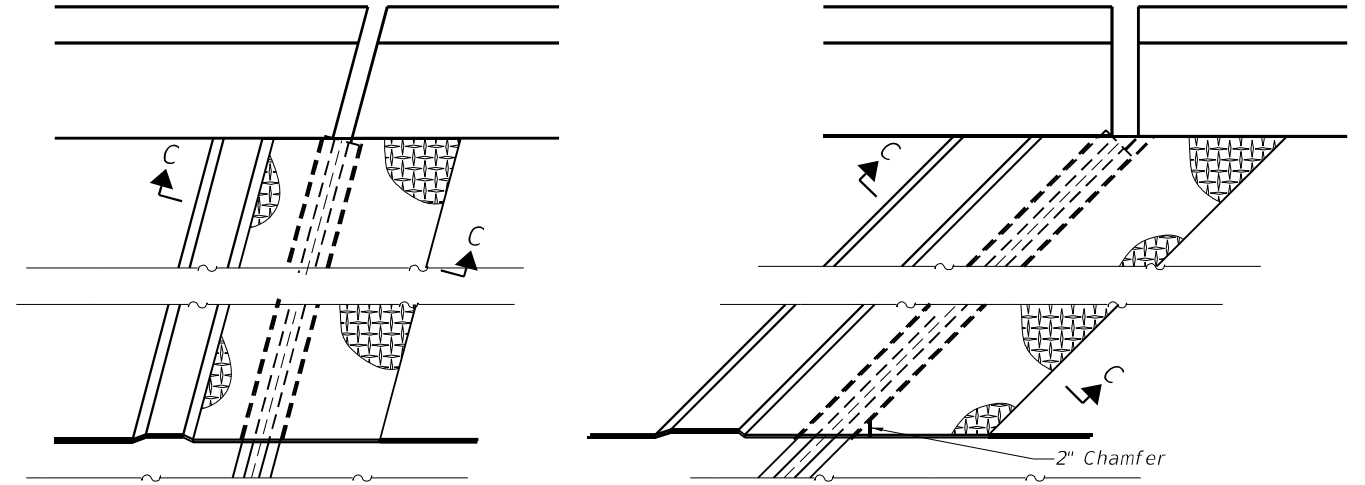

(FOR SKEWS ≤ 30°)

(FOR SKEWS > 30°)

PLAN AT RAISED SIDEWALK

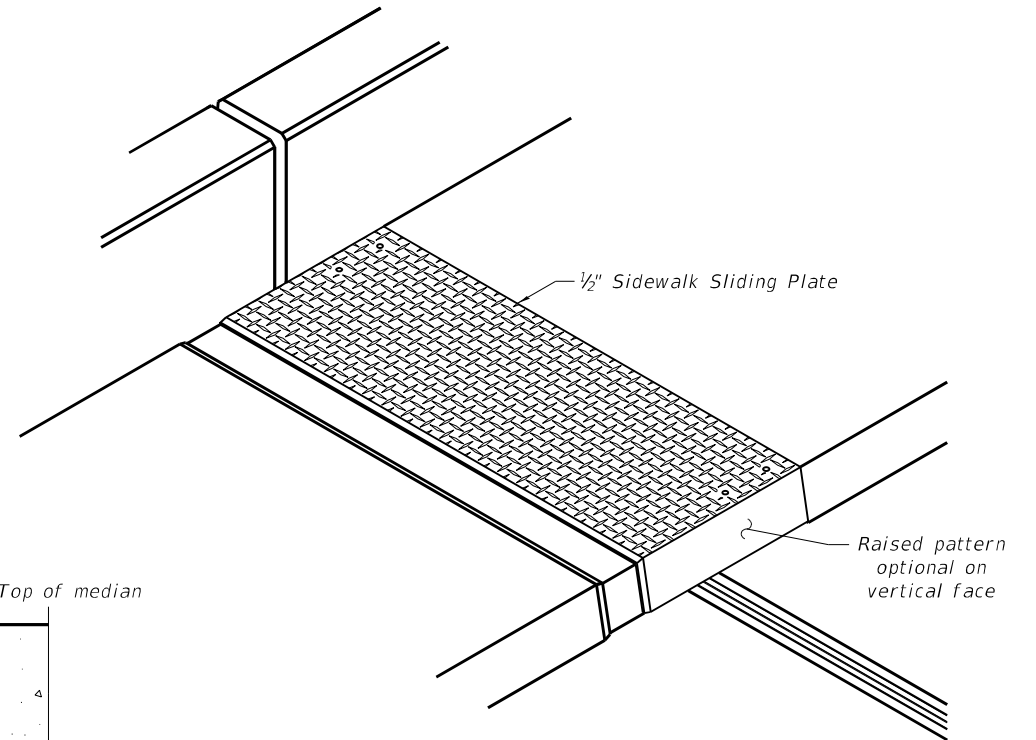

TRIMETRIC VIEW

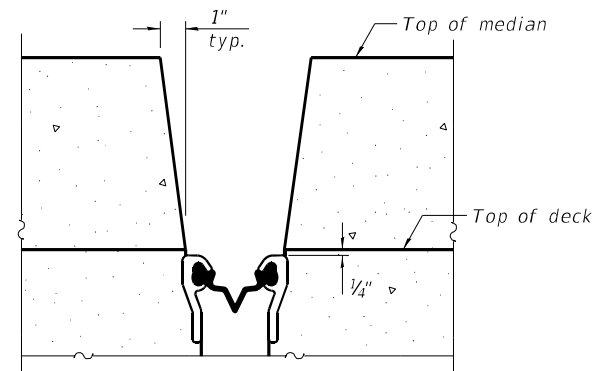

SECTION D-D
(at Rt. L's)

BILL OF MATERIAL

Item	Unit	Total
Preformed Joint Strip Seal	Foot	75

(Sheet 2 of 2)



USER NAME	=	DESIGNED	-	SPN	REVISED	-
PILOT SCALE	=	CHECKED	-	MJT	REVISED	-
PILOT DATE	=	DRAWN	-	MMY	REVISED	-
		CHECKED	-	SPN/MJT	REVISED	-

STATE OF ILLINOIS
DEPARTMENT OF TRANSPORTATION

PREFORMED JOINT STRIP SEAL - SIDEWALK
STRUCTURE NO. 086-0006

SHEET 11 OF 12 SHEETS

F&P RTE.	SECTION	COUNTY	TOTAL SHEETS	SHEET NO.
562	(116) BDR, BRR, BJR	SCOTT	31	25
CONTRACT NO. 72M65				
ILLINOIS FED. AID PROJECT				



* Epoxy not required on Bar Splicer Assembly components used in conjunction with black bars.

<i>Location</i>	<i>Bar size</i>	<i>No. assemblies required</i>	<i>Minimum lap length</i>
<i>N. End Appr. Pavement</i>	<i>#5</i>	<i>6</i>	<i>3'-6"</i>
<i>N. Abut. - Hatch Block</i>	<i>#6</i>	<i>6</i>	<i>4'-0"</i>
<i>N. Abut. - Backwall</i>	<i>#5</i>	<i>6</i>	<i>3'-6"</i>
<i>N. End Bridge Deck</i>	<i>#5</i>	<i>8</i>	<i>3'-6"</i>
<i>S. End Bridge Deck</i>	<i>#5</i>	<i>8</i>	<i>3'-6"</i>
<i>S. Abut. - Hatch Block</i>	<i>#6</i>	<i>6</i>	<i>4'-0"</i>

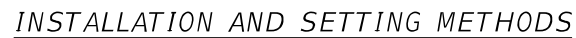

(E) : Indicates epoxy coating.



<i>Location</i>	<i>Bar size</i>	<i>No. assemblies required</i>

See approved list of bar splicer assemblies and mechanical splicers for alternatives.

MODEL: Default
FILE NAME: \\18040.06 IDOT D6 - PTB 187-011 - W06 - Scott County 72M65\CADDData\CADSheets\0860046-72M65-002-Staging-Sec-rev.10-29-2021.dgn

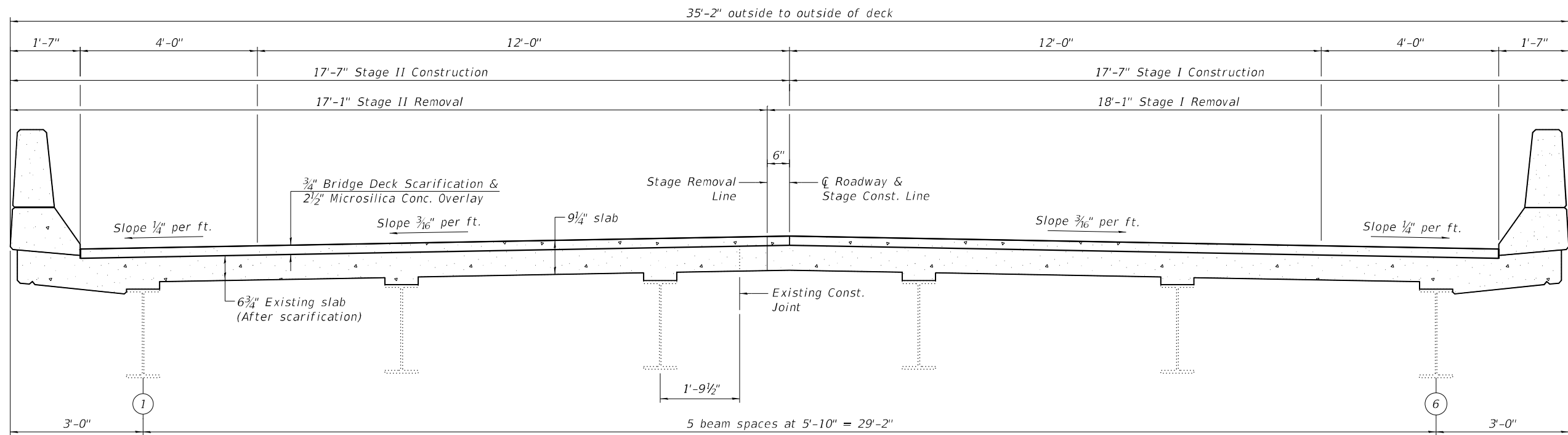

CROSS SECTION AT MID SPANS
(Looking South)

 KUHN & TRELLO CONSULTING ENGINEERS A Limited Liability Company 109 N. 7th Street, 3rd Floor Springfield, IL 62702 Phone: 217-618-0244 Professional Design Firm No. 284-006516	USER NAME =		DESIGNED - SPN	REVISED -	STATE OF ILLINOIS DEPARTMENT OF TRANSPORTATION	STAGING DETAILS & CROSS SECTION STRUCTURE NO. 086-0046		F&P RTE.	SECTION	COUNTY	TOTAL SHEETS	SHEET NO.
	CHECKED - MJT		CHECKED - MJT	REVISED -				562	(116) BDR, BRR, BJR	SCOTT	31	28
	PLOT SCALE =		DRAWN - GW	REVISED -				CONTRACT NO. 72M65				
	PLOT DATE =		CHECKED - SPN/MJT	REVISED -				ILLINOIS FED. AID PROJECT				
			SHEET 2 OF 3 SHEETS									

MODEL: Default
FILE NAME: \\18040.06 IDOT D6 - PTB 187-011 - W06 - Scott County 72M65\CADDData\CADsheets\0860046-72M65-003-SlabRepair.dgn

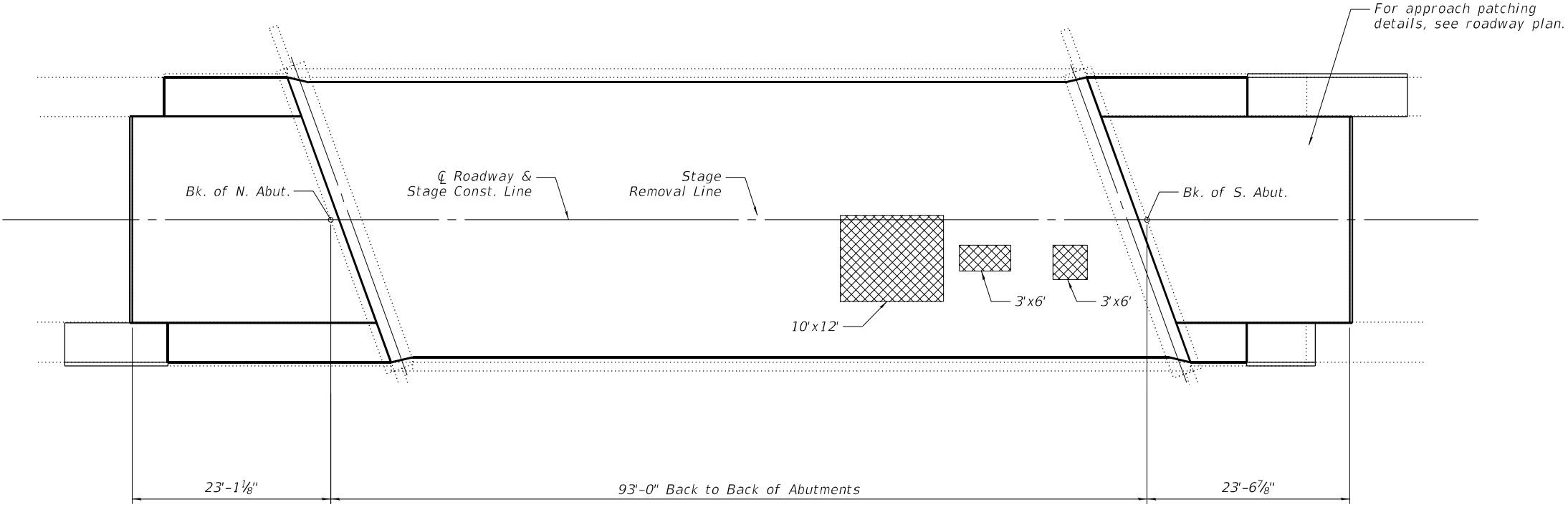

DECK PATCHING REPAIR PLAN



Deck Slab Repair (Full Depth, Type II)

SUPERSTRUCTURE
BILL OF MATERIAL

Item	Unit	Total
Deck Slab Repair (Full Depth, Type II)	Sq. Yd.	18

KT

KUHN & TRELLO
CONSULTING ENGINEERS
A Limited Liability Company
100 N. 7th Street, 3rd Floor
Springfield, IL 62701
Phone: 217-618-0244
Professional Design Firm No. 184-006516

USER NAME	=
DESIGNED	- SPN
CHECKED	- MJT
PLOT SCALE	=
PLOT DATE	=
DRAWN	- GW
CHECKED	- SPN/MJT
REVISED	-
REVISED	-
REVISED	-
REVISED	-

STATE OF ILLINOIS
DEPARTMENT OF TRANSPORTATION

DECK SLAB REPAIR DETAILS
STRUCTURE NO. 086-0046

SHEET 3 OF 3 SHEETS

F&P RTE.	SECTION	COUNTY	TOTAL SHEETS	SHEET NO.
562	(116) BDR, BRR, BJR	SCOTT	31	29
CONTRACT NO. 72M65				
ILLINOIS FED. AID PROJECT				

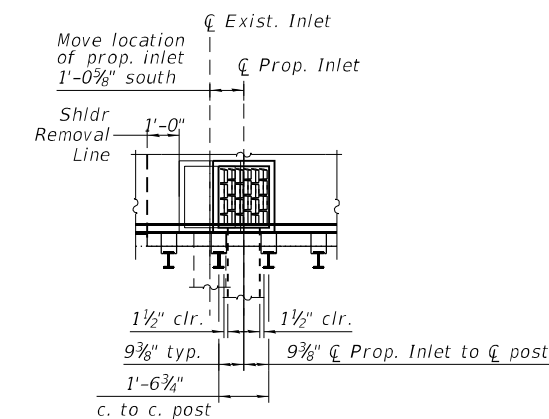
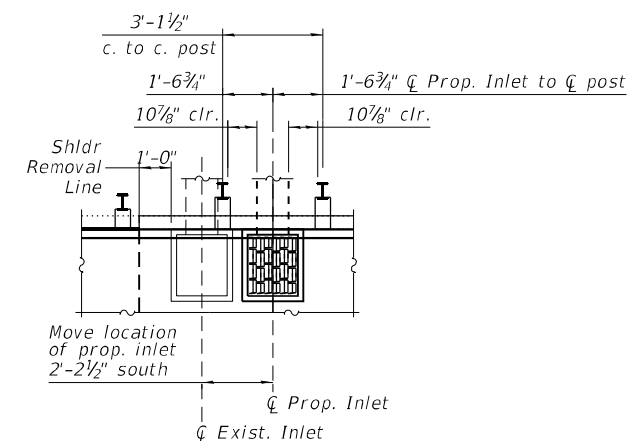
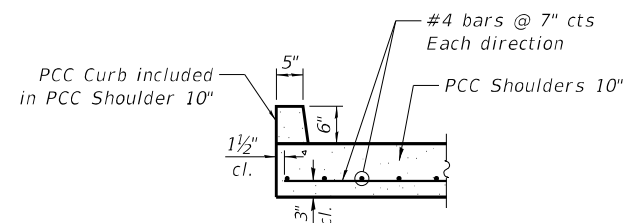
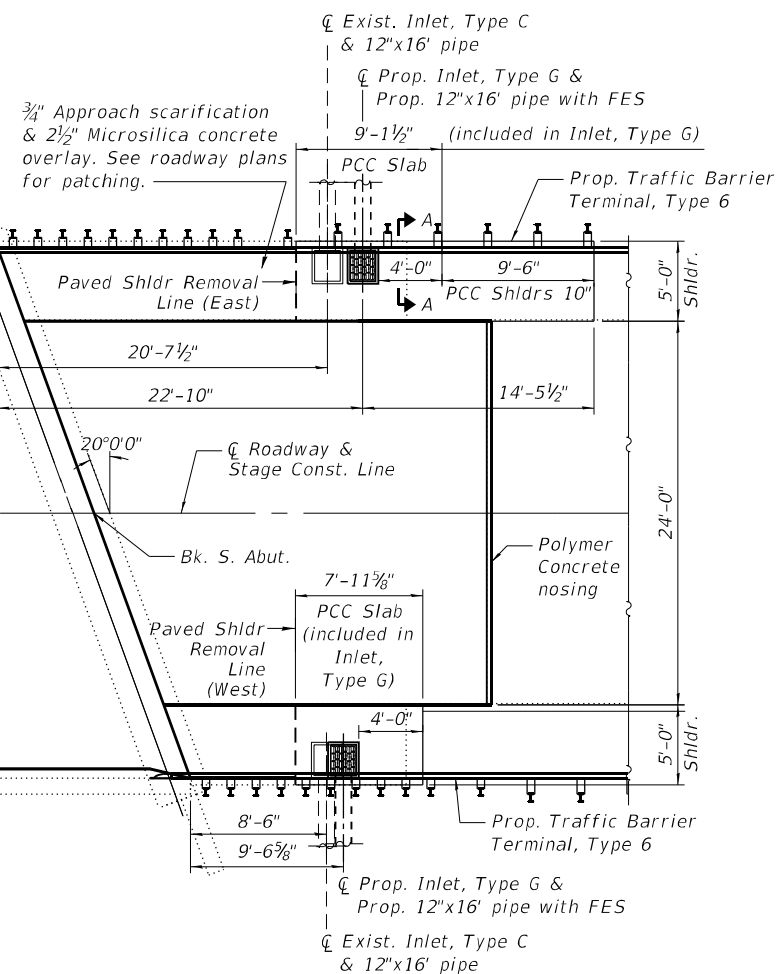
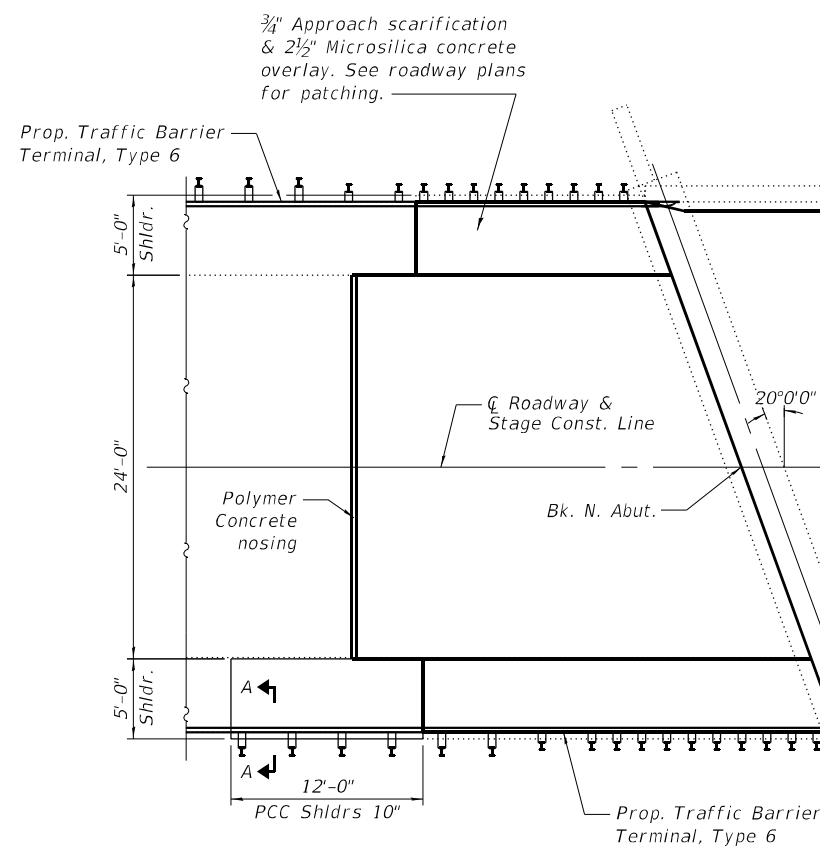

Notes:

1. Any Proposed P.C.C. Slab placed within 5' of 6 Inlet will be paid as incidental to Inlet Type G. Any work beyond 5' will be paid for as P.C.C Shoulder 10".
2. Resident Engineer to field verify location of proposed inlets to avoid conflicts with Proposed Traffic Barrier Terminal, Type 6 posts.
3. See Schedules sheet for quantities.

2. Resident Engineer to field verify location of proposed inlets to avoid conflicts with Proposed Traffic Barrier Terminal, Type 6 posts.

3. See Schedules sheet for quantities.

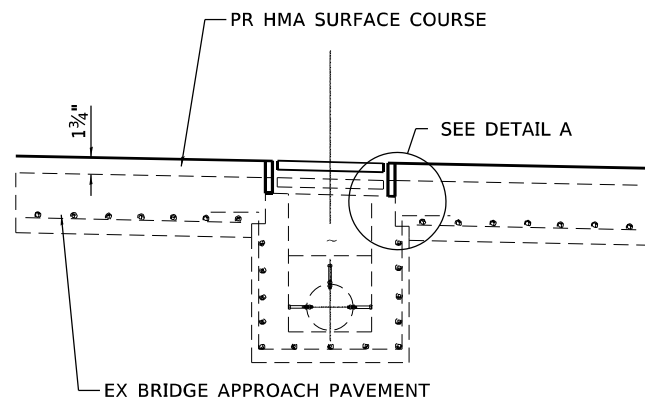

SEC A-A

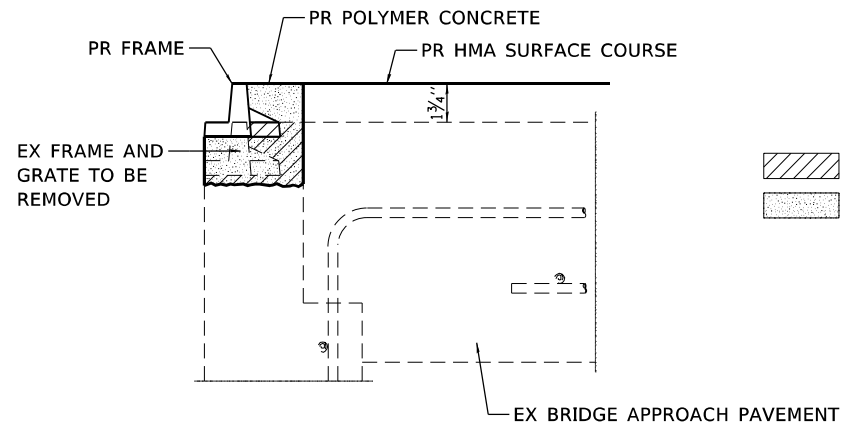

DETAIL A

CONCRETE REMOVAL
POLYMER CONCRETE

GENERAL NOTES

THE CONTRACTOR SHALL FURNISH AND INSTALL A NEW CAST FRAME AND CAST GRATE AS SPECIFIED ON STANDARD 610001 FOR THE TYPE G INLET BOX

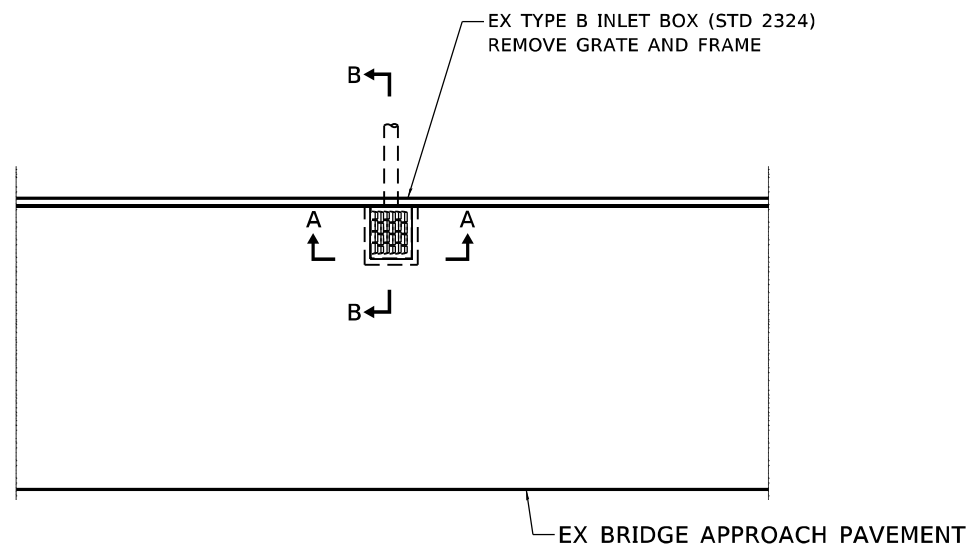

PLAN

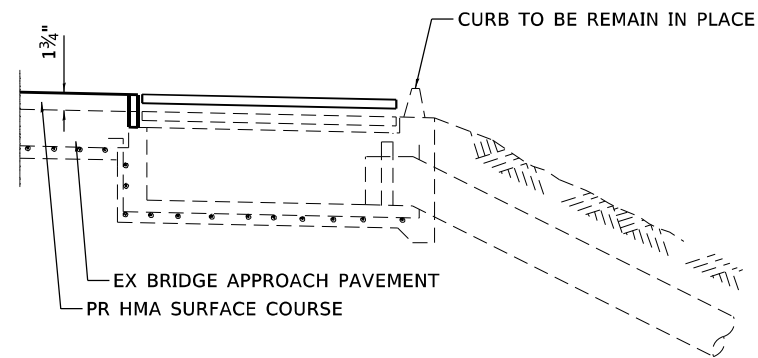

SEC B-B

**STATE OF ILLINOIS
DEPARTMENT OF TRANSPORTATION**

**INLET BOX ADJUSTMENT DETAIL
STRUCTURE NO. 086-0006**

SCALE: 40,000 ' / in. SHEET OF SHEETS STA. TO STA.

F.A.P. RTE.	SECTION	COUNTY	TOTAL SHEETS	SHEET NO.
562	(116) BDR, BRR, BJR	SCOTT	31	31
CONTRACT NO. 72M65				
ILLINOIS FED. AID PROJECT				

USER NAME = myoung	DESIGNED -	REVISED -
DRAWN -	REVISD -	
PLOT SCALE = 40,000 ' / in.	CHECKED -	REVISED -
PLOT DATE = 10/14/2021	DATE - 121	REVISED -