

STATE OF ILLINOIS
DEPARTMENT OF TRANSPORTATION

F.A.S. RTE.	SECTION	COUNTY	TOTAL SHEETS	SHEET NO.
1707	(CF-X, D-X)RS-2	CLARK	27	1
		ILLINOIS	CONTRACT NO. 74966	

FOR INDEX OF SHEETS, SEE SHEET NO. 2

AADT (2022) = 2050

PROPOSED HIGHWAY PLANS

FAS ROUTE 1707 (US 40)
SECTION (CF-X, D-X)RS-2
PROJECT STP-R47Q(292)
RESURFACING
CLARK COUNTY

C-97-044-20

D-97-042-20

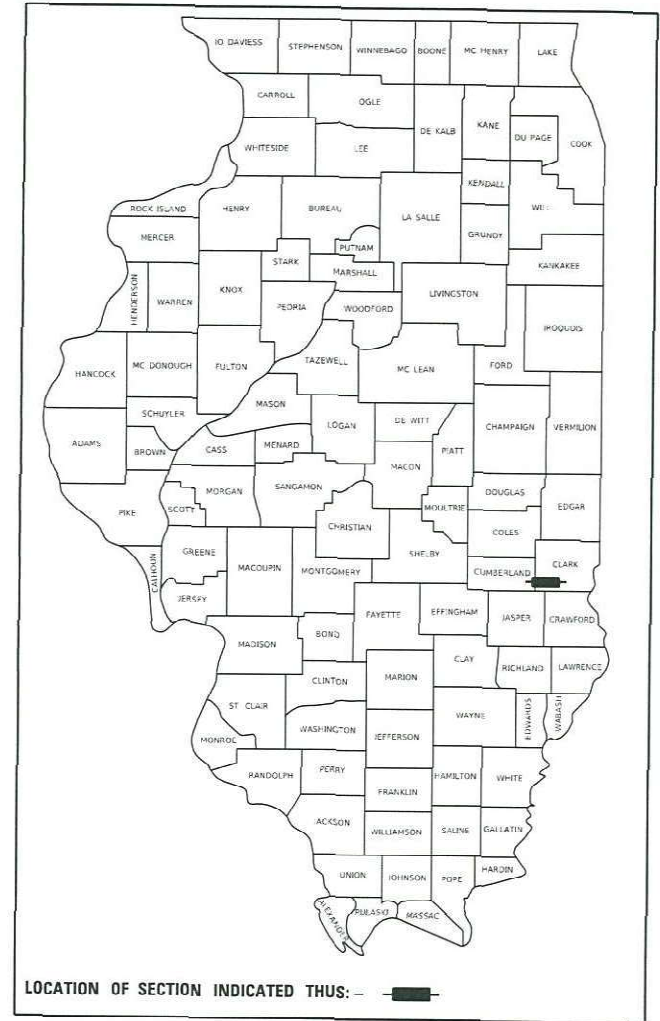

PROJECT ENDS
STA. 2524 + 68.00

PROJECT BEGINS
STA. 2447 + 78.00

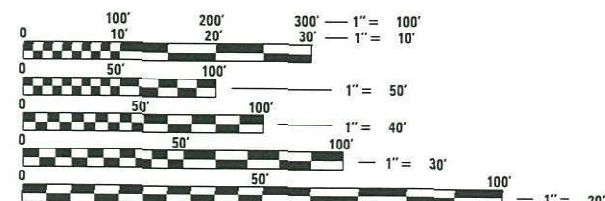
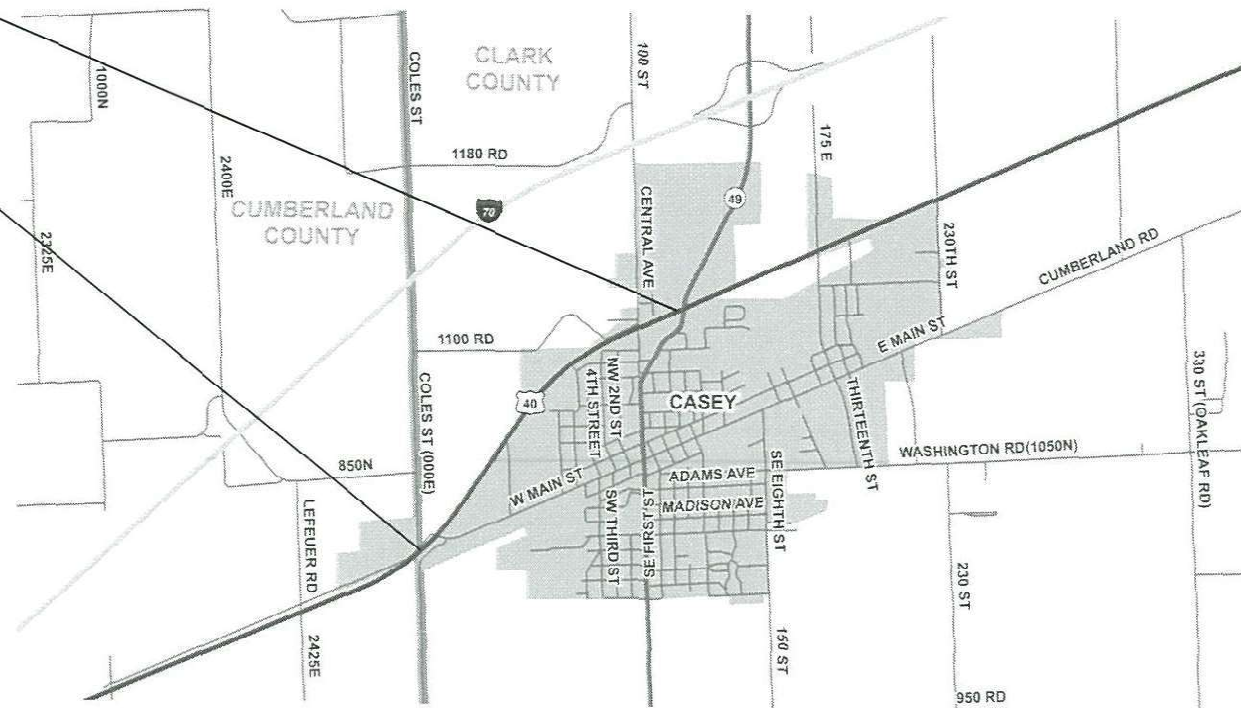

FULL SIZE PLANS HAVE BEEN PREPARED USING STANDARD ENGINEERING SCALES. REDUCED SIZED PLANS WILL NOT CONFORM TO STANDARD SCALES. IN MAKING MEASUREMENTS ON REDUCED PLANS, THE ABOVE SCALES MAY BE USED.

J.U.L.I.E.
JOINT UTILITY LOCATION INFORMATION FOR EXCAVATORS
1-800-892-0123
OR 811

PROJECT ENGINEER: DEBRA G. BARRETT
PROJECT MANAGER: DEBRA G. BARRETT
(217)342-8243
CONTRACT NO. 74966

GROSS LENGTH = 7690.00 FT. = 1.456 MILES
NET LENGTH = 7690.00 FT. = 1.456 MILES

STATE OF ILLINOIS
DEPARTMENT OF TRANSPORTATION

SUBMITTED October 19 2021
Jeffrey P. Myrland
REGIONAL ENGINEER

December 10 2021
[Signature]
ENGINEER OF DESIGN AND ENVIRONMENT

December 10 2021
Stephen M. Travis
DIRECTOR OF HIGHWAYS PROJECT IMPLEMENTATION

PRINTED BY THE AUTHORITY
OF THE STATE OF ILLINOIS

GENERAL NOTES

THE WORK IN THIS SECTION INCLUDES PATCHING, MILLING AND RESURFACING THE EXISTING PAVEMENT AND SHOULDERS, SHOULDER RUMBLE STRIPS, AGGREGATE WEDGE SHOULDERS, PAINT PAVEMENT MARKING, RAISED REFLECTIVE PAVEMENT MARKERS, AND ANY OTHER WORK NECESSARY TO COMPLETE THIS SECTION.

THE WORK INCLUDED IN THIS SECTION IS LOCATED ON US 40, STARTING AT THE CUMBERLAND COUNTY LINE, AND CONTINUES FOR 1.46 MILES TO JUST WEST OF THE IL 49 INTERSECTION.

THE RESIDENT ENGINEER SHALL BE THE SOLE JUDGE CONCERNING THE CURING TIME FOR THE HMA SURFACE COURSE.

MILLED PAVEMENT SHALL BE RESURFACED WITH BINDER WITHIN 5 CALENDAR DAYS.

LONGITUDINAL JOINT SEALANT WILL BE APPLIED AT ALL CENTERLINE AND TURN LANE JOINTS.

MATERIAL FOR AGGREGATE WEDGE SHOULDER, TYPE B SHALL BE CRUSHED STONE, CRUSHED CONCRETE OR RAP.

MATERIAL FOR AGGREGATE SURFACE COURSE, TYPE B SHALL BE CRUSHED STONE, OR CRUSHED CONCRETE.

WHEN APPLYING SHORT TERM PAVEMENT MARKINGS, TEMPORARY TAPE SHALL BE USED ON THE SURFACE AND PAINT SHALL BE USED ON THE MILLED AND BINDER SURFACES.

QUANTITY FOR THERMOPLASTIC PAVEMENT MARKING - LETTERS AND SYMBOLS CONSISTS OF 48 SQUARE FEET OF WHITE.

QUANTITY FOR THERMOPLASTIC PAVEMENT MARKING - LINE 24" CONSISTS OF 134 FEET OF WHITE.

QUANTITY FOR PAINT PAVEMENT MARKING - LINE 4" CONSISTS OF 1,945 FEET OF YELLOW, AND 15,294 FEET OF WHITE.

QUANTITY FOR PAINT PAVEMENT MARKING - LINE 6" CONSISTS OF 155 FEET OF WHITE.

THE FOLLOWING MIXTURE REQUIREMENTS ARE APPLICABLE TO THIS PROJECT:

APPLICATION	PG	DESIGN AIR VOIDS	MIXTURE COMPOSITION	FRICTION AGGREGATE	MIXTURE WEIGHT	QUALITY MGMT PROGRAM	SUBLOT SIZE	MATERIAL TRANSFER DEV
HMA SURFACE COURSE, MIX "C", N70 (2")	PG 64-22	4.0% @ N=70	IL - 9.5	MIXTURE C	112 LB/SQ YD/IN	QC/QA	N/A	NO
HMA BINDER COURSE, IL-9.5FG, N70 (1 3/4")	PG 64-22	4.0% @ N=70	IL - 9.5FG	N/A	112 LB/SQ YD/IN	QC/QA	N/A	NO
INCIDENTAL HMA SURFACE COURSE	PG 64-22	4.0% @ N=70	IL - 9.5	MIXTURE C	112 LB/SQ YD/IN	QC/QA	N/A	NO
CLASS D PATCHING	PG 64-22	4.0% @ N=70	IL - 19.0	N/A	112 LB/SQ YD/IN	QC/QA	N/A	NO

INDEX OF SHEETS

SHEET NO.	ITEM
1	COVER SHEET
2	GENERAL NOTES, INDEX OF SHEETS & LIST OF STANDARDS
3-4	SUMMARY OF QUANTITIES
5	TYPICAL CROSS SECTION
6-7	SCHEDULES OF QUANTITIES
8-21	PLAN SHEETS
22-27	DETAILS

THE FOLLOWING STANDARDS ARE A PART OF THESE PLANS AND ARE INCLUDED FOLLOWING THE LAST NUMBERED SHEET OF THE PLANS.

STD. NO.	DESCRIPTION
000001-08	STANDARD SYMBOLS, ABBREVIATIONS, AND PATTERNS
001006	DECIMAL OF AN INCH AND OF A FOOT
442201-03	CLASS C AND D PATCHES
642006-01	SHOULDER RUMBLE STRIPS, 8 INCH
701001-02	OFF-ROAD OPERATIONS, 2L, 2W, MORE THAN 15' (4.5 M) AWAY
701006-05	OFF-ROAD OPERATIONS, 2L, 2W, 15' (4.5 M) TO 24" (600 MM) FROM PAVEMENT EDGE
701011-04	OFF-ROAD MOVING OPERATIONS, 2L, 2W, DAY ONLY
701201-05	LANE CLOSURE, 2L, 2W, DAY ONLY, FOR SPEEDS > 45 MPH
701301-04	LANE CLOSURE, 2L, 2W, SHORT TIME OPERATIONS
701306-04	LANE CLOSURE, 2L, 2W, SLOW MOVING OPERATIONS DAY ONLY, FOR SPEEDS > 45 MPH
701311-03	LANE CLOSURE, 2L, 2W, MOVING OPERATIONS - DAY ONLY
701701-10	URBAN LANE CLOSURE, MULTILANE INTERSECTION
701901-08	TRAFFIC CONTROL DEVICES
780001-05	TYPICAL PAVEMENT MARKINGS
781001-04	TYPICAL APPLICATIONS RAISED RELECTIVE PAVEMENT MARKERS

**STATE OF ILLINOIS
DEPARTMENT OF TRANSPORTATION**

**GENERAL NOTES, INDEX OF SHEETS
& LIST OF STANDARDS**

F.A.S. RTE.	SECTION	COUNTY	TOTAL SHEETS	SHEET NO.
1707	(CF-X,D-X)RS-2	CLARK	27	2
			CONTRACT NO. 74966	
ILLINOIS		FED. AID PROJECT		

SCALE: SHEET 1 OF 1 SHEETS STA. TO STA.

MODEL: Default
 FILE NAME: p:\ultra\paw\bea\paw.com\FW\DOT\Documents\DOT Office\District 7\Project\74966\CADD\Drawings\Drawings\74966-02-GenNotes.dgn

80% FED
20% STATE

80% FED
20% STATE

SUMMARY OF QUANTITIES			TOTAL QUANTITIES	CONSTRUCTION TYPE CODE		
CODE NO	ITEM	UNIT		0005		
40200800	AGGREGATE SURFACE COURSE, TYPE B	TON	20	20		
40600290	BITUMINOUS MATERIALS (TACK COAT)	POUND	14668	14668		
40600370	LONGITUDINAL JOINT SEALANT	FOOT	8326	8326		
40600990	TEMPORARY RAMP	SO YD	32	32		
40602970	HOT-MIX ASPHALT BINDER COURSE, IL-9.5FG, N70	TON	2130	2130		
40604052	HOT-MIX ASPHALT SURFACE COURSE, IL-9.5, MIX "C", N70	TON	2434	2434		
40800029	BITUMINOUS MATERIALS (TACK COAT)	POUND	971	971		
40800050	INCIDENTAL HOT-MIX ASPHALT SURFACING	TON	226	226		
44000155	HOT-MIX ASPHALT SURFACE REMOVAL, 1 1/2"	SO YD	21730	21730		
44201785	CLASS D PATCHES, TYPE I, 12 INCH	SO YD	4	4		
44201789	CLASS D PATCHES, TYPE II, 12 INCH	SO YD	834	834		
48102100	AGGREGATE WEDGE SHOULDER, TYPE B	TON	1430	1430		
64200108	SHOULDER RUMBLE STRIPS, 8 INCH	FOOT	975	975		

SUMMARY OF QUANTITIES			TOTAL QUANTITIES	CONSTRUCTION TYPE CODE		
CODE NO	ITEM	UNIT		0005		
67000400	ENGINEER'S FIELD OFFICE, TYPE A	CAL MO	4	4		
67100100	MOBILIZATION	L SUM	1	1		
70100450	TRAFFIC CONTROL AND PROTECTION, STANDARD 701201	L SUM	1	1		
70100460	TRAFFIC CONTROL AND PROTECTION, STANDARD 701306	L SUM	1	1		
70102635	TRAFFIC CONTROL AND PROTECTION, STANDARD 701701	L SUM	1	1		
70107025	CHANGEABLE MESSAGE SIGN	CAL DA	28	28		
70300100	SHORT TERM PAVEMENT MARKING	FOOT	2164	2164		
70300150	SHORT TERM PAVEMENT MARKING REMOVAL	SO FT	241	241		
70300211	TEMPORARY PAVEMENT MARKING LETTERS AND SYMBOLS - PAINT	SO FT	48	48		
70300221	TEMPORARY PAVEMENT MARKING - LINE 4" - PAINT	FOOT	17239	17239		
70300241	TEMPORARY PAVEMENT MARKING - LINE 6" - PAINT	FOOT	155	155		
70300281	TEMPORARY PAVEMENT MARKING - LINE 24" - PAINT	FOOT	134	134		

REV. - MS

MODEL: Default
 FILE: M:\MTE_Plan\Project-74966\Drawings\DOT\Office\Drawings\74966\Drawings\74966-sh-500.dgn

USER NAME = steffemk	DESIGNED -	REVISED -
	DRAWN -	REVISED -
PLOT SCALE = 100.0000' / in.	CHECKED -	REVISED -
PLOT DATE = 10/19/2021	DATE -	REVISED -

**STATE OF ILLINOIS
DEPARTMENT OF TRANSPORTATION**

SUMMARY OF QUANTITIES

SCALE: SHEET 1 OF 2 SHEETS STA. TO STA.

F.A.S. RTE.	SECTION	COUNTY	TOTAL SHEETS	SHEET NO.
1707	(CF-X,D-X)RS-2	CLARK	27	3
CONTRACT NO. 74966			ILLINOIS FED. AID PROJECT	

TYPICAL CROSS SECTION

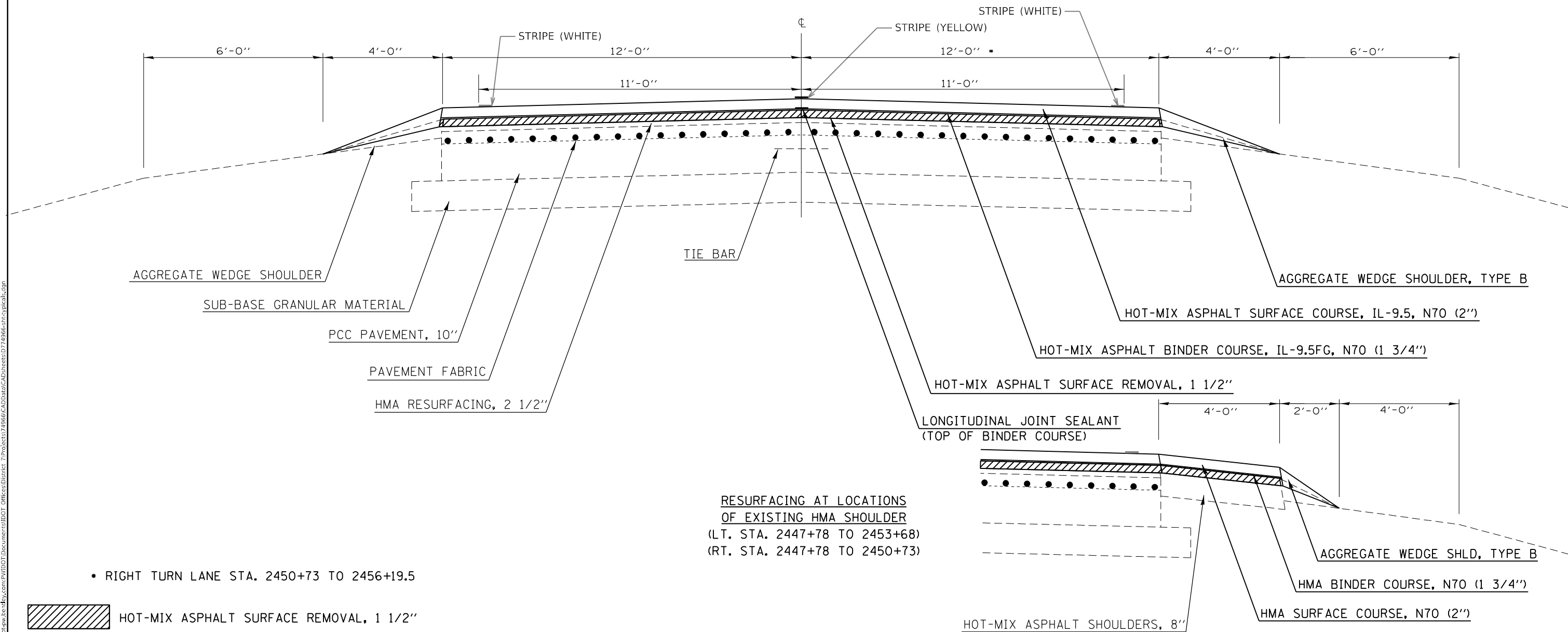

• RIGHT TURN LANE STA. 2450+73 TO 2456+19.5

 HOT-MIX ASPHALT SURFACE REMOVAL, 1 1/2"

MODEL: Default
 FILE NAME: p:\ultra\paw\beadefy.com\PIV\DOT\Documents\DOT Office\Director_7\Projects\74966\CADD\Bldg\CAD\sheet\074966-rlt-typlscale.dgn

USER NAME = steffenmk	DESIGNED -	REVISED -
	DRAWN -	REVISED -
PLOT SCALE = 40,0000 * / in.	CHECKED -	REVISED -
PLOT DATE = 10/19/2021	DATE -	REVISED -

**STATE OF ILLINOIS
DEPARTMENT OF TRANSPORTATION**

TYPICAL CROSS SECTIONS

SCALE: SHEET 1 OF 1 SHEETS STA. TO STA.

F.A.S. RTE.	SECTION	COUNTY	TOTAL SHEETS	SHEET NO.
1707	(CF-X,D-X)RS-2	CLARK	27	5
CONTRACT NO. 74966				
ILLINOIS FED. AID PROJECT				

PAVING SCHEDULE (MAINLINE)

STATION	TO	STATION	LENGTH (FEET)	PAVEMENT WIDTH (FEET)	PAVEMENT AREA (SQ YD)	TEMPORARY RAMP (SQ YD)	BITUMINOUS MATERIALS (TACK COAT) (POUND)	HOT-MIX ASPHALT SURFACE REMOVAL, 1 1/2" (SQ YD)	HOT MIX ASPHALT BINDER COURSE, IL-9.5FG, N70 (TON)	HOT-MIX ASPHALT SURFACE COURSE, IL-9.5, MIX "C", N70 (TON)	SHOULDER RUMBLE STRIPS, 8 INCH (FEET)	AGGREGATE WEDGE SHOULDER, TYPE B (TON)	LONGITUDINAL JOINT SEALANT (FOOT)
2447+33.00	TO	2450+73.00	340	32	1209	18	816	1209	118	135	680	32	340
2450+73.00	TO	2453+68.00	295	28	918		620	918	90	103	295	42	295
2453+68.00	TO	2525+13.00	7145	24	19053	14	12861	19053	1867	2134		1356	7145
2450+73.00	TO	2456+19.00	546	VAR	550		371	550	54	62			546
TOTALS =						32	14668	21730	2130	2434	975	1430	8326

PAVEMENT MARKING SCHEDULE (MAINLINE)

STATION	TO	STATION	LENGTH (FEET)	SHORT TERM PAVEMENT MARKING (FEET)	SHORT TERM PAVEMENT MARKING REMOVAL (SQ FT)	TEMPORARY PAVEMENT MARKING LETTERS AND SYMBOLS - PAINT (WHITE) (SQ FT)	TEMPORARY PAVEMENT MARKING - LINE 4" - PAINT (YELLOW) (FEET)	TEMPORARY PAVEMENT MARKING - LINE 4" - PAINT (WHITE) (FEET)	TEMPORARY PAVEMENT MARKING - LINE 6" - PAINT (WHITE) (FEET)	THERMOPLASTIC PAVEMENT MARKING - LETTERS AND SYMBOLS (WHITE) (SQ FT)	GROOVING FOR RECESSED PAVEMENT MARKING, LETTERS AND SYMBOLS (SQ FT)	PAINT PAVEMENT MARKING - LINE 4" (YELLOW) (FEET)	PAINT PAVEMENT MARKING - LINE 4" (WHITE) (FEET)	PAINT PAVEMENT MARKING - LINE 6" (WHITE) (FEET)	RAISED REFLECTIVE PAVEMENT MARKER (EACH)	RAISED REFLECTIVE PAVEMENT MARKER REMOVAL (EACH)
2447+33.00	TO	2525+13.00	7780.0	2122	236		1945	15294		48	48	1945	15294		98	98
2452+45.00	TO	2454+00.00	155.0	42	5	48			155	48	48			155	3	3
TOTALS =				2164	241	48	17239		155	48	48	17239		155	101	101

ENTRANCES & SIDE ROADS SCHEDULE

LT/RT	STATION	TYPE	AREA (SQ YD)	TEMPORARY RAMP, SPECIAL (SQ YD)	SURFACE REMOVAL, VARIABLE DEPTH (SPECIAL) (SQ YD)	AGGREGATE SURFACE COURSE, TYPE B (TON)	BITUMINOUS MATERIALS (TACK COAT) (POUND)	INCIDENTAL HOT-MIX ASPHALT SURFACING (TON)	TEMPORARY PAVEMENT MARKING - LINE 24" - PAINT (WHITE) (FEET)	THERMOPLASTIC PAVEMENT MARKING - LINE 24" (WHITE) (FEET)	GROOVING FOR RECESSED PAVEMENT MARKING 25" (FEET)
LT	2454+27.00	PRA	149	19	149		67	16	12	12	12
RT	2454+27.00	PRA	198	29	198		89	21	26	26	26
RT	2466+44.00	CE	59	17	59		27	6			
RT	2472+83.00	CE	179			15					
RT	2479+90.00	PRA	196	29	196		88	21	25	25	25
RT	2485+84.00	FE	61			5					
RT	2502+26.00	PRA	446	39	446		201	47	16	16	16
LT	2511+55.00	PRA	212	26	212		95	22	16	16	16
LT	2518+62.00	PRA	371	65	371		167	39	23	23	23
RT	2518+62.00	PRA	526	60	526		237	55	16	16	16
TOTALS =				285	2157	20	971	226	134	134	134

MODEL: Default
FILE NAME: p:\project-pw-bead\paw.com\PIV\DOT\Documents\DOT_Offices\District_7\Projects\74966\CADD\Bids\CAD\sheet\074966-pl-sched.tbl.dgn

USER NAME = steffenmk	DESIGNED -	REVISED -
	DRAWN -	REVISED -
PLOT SCALE = 40,0000 * / in.	CHECKED -	REVISED -
PLOT DATE = 10/19/2021	DATE -	REVISED -

STATE OF ILLINOIS
DEPARTMENT OF TRANSPORTATION

SCHEDULES OF QUANTITIES

SCALE: SHEET 1 OF 2 SHEETS STA. TO STA.

F.A.S. RTE.	SECTION	COUNTY	TOTAL SHEETS	SHEET NO.
1707	(CF-X,D-X)RS-2	CLARK	27	6
CONTRACT NO. 74966				
ILLINOIS		FED. AID PROJECT		

PATCHING SCHEDULE

PATCH NO.	LANE	STATION	LENGTH	WIDTH	CLASS D PATCHES, TYPE I, 12"	CLASS D PATCHES, TYPE II, 12"	CLASS D PATCHES, TYPE III, 12"	CLASS D PATCHES, TYPE IV, 12"
			(FEET)	(FEET)	(SQ YD)	(SQ YD)	(SQ YD)	(SQ YD)
1	FRI	2448+43	4.0	12.0		5.3		
2	EBL	2449+02	4.0	12.0		5.3		
3	EBL	2449+96	4.0	12.0		5.3		
4	EBL	2450+62	8.0	12.0		10.7		
5	EBL	2451+63	6.0	12.0		8.0		
6	CBTL	2451+63	4.0	9.0	4.0			
7	EBL	2452+66	6.0	12.0		8.0		
8	EBTL	2452+66	4.0	12.0		5.3		
9	EBL	2453+68	6.0	12.0		8.0		
10	EBTL	2453+68	4.0	12.0		5.3		
11	EBL	2454+56	4.0	12.0		5.3		
11A	EBL	2454+98	4.0	12.0		5.3		
12	EBL	2456+26	5.0	12.0		6.7		
13	EBL	2458+29	4.0	12.0		5.3		
14	EBL	2459+30	6.0	12.0		8.0		
15	EBL	2460+30	4.0	12.0		5.3		
16	EBL	2462+31	10.0	12.0		13.3		
17	EBL	2463+32	8.0	12.0		10.7		
18	EBL	2464+35	8.0	12.0		10.7		
19	EBL	2465+34	8.0	12.0		10.7		
20	EBL	2466+34	8.0	12.0		10.7		
21	EBL	2467+36	8.0	12.0		10.7		
22	EBL	2468+36	8.0	12.0		10.7		
23	EBL	2469+38	6.0	12.0		8.0		
24	EBL	2469+64	12.0	6.0		8.0		
25	EBL	2470+39	10.0	12.0		13.3		
26	EBL	2471+40	8.0	12.0		10.7		
27	EBL	2472+41	6.0	12.0		8.0		
28	EBL	2473+41	5.0	12.0		6.7		
29	EBL	2474+41	6.0	12.0		8.0		
30	EBL	2476+42	6.0	12.0		8.0		
31	EBL	2477+43	7.0	12.0		9.3		
32	EBL	2479+42	8.0	12.0		10.7		
33	EBL	2481+43	6.0	12.0		8.0		
34	EBL	2483+43	6.0	12.0		8.0		
35	EBL	2484+45	6.0	12.0		8.0		
36	EBL	2485+47	5.0	12.0		6.7		
37	EBL	2486+48	5.0	12.0		6.7		
38	EBL	2487+48	6.0	12.0		8.0		
39	EBL	2488+49	6.0	12.0		8.0		
40	EBL	2490+54	4.0	12.0		5.3		
41	EBL	2492+49	5.0	12.0		6.7		
42	EBL	2494+50	5.0	12.0		6.7		
43	EBL	2496+51	5.0	12.0		6.7		
44	EBL	2498+51	4.0	12.0		5.3		
45	EBL	2499+53	5.0	12.0		6.7		
46	EBL	2502+53	4.0	12.0		5.3		
47	EBL	2504+53	4.0	12.0		5.3		
48	EBL	2506+54	6.0	12.0		8.0		
49	EBL	2507+56	10.0	12.0		13.3		
50	EBL	2508+53	5.0	12.0		6.7		
51	EBL	2509+55	4.0	12.0		5.3		
52	EBL	2511+55	9.0	12.0		12.0		
53	EBL	2514+56	4.0	12.0		5.3		
54	EBL	2515+55	8.0	12.0		10.7		
55	EBL	2516+57	6.0	12.0		8.0		
56	EBL	2520+66	7.0	12.0		9.3		
57	EBL	2524+67	8.0	12.0		10.7		
EB TOTALS =					4	456	0	0

PATCHING SCHEDULE

PATCH NO.	LANE	STATION	LENGTH	WIDTH	CLASS D PATCHES, TYPE I, 12"	CLASS D PATCHES, TYPE II, 12"	CLASS D PATCHES, TYPE III, 12"	CLASS D PATCHES, TYPE IV, 12"
			(FEET)	(FEET)	(SQ YD)	(SQ YD)	(SQ YD)	(SQ YD)
58	WRI	2524+51	8.0	12.0		10.7		
59	WBL	2520+50	7.0	12.0		9.3		
60	WBL	2516+38	6.0	12.0		8.0		
61	WBL	2515+37	4.0	12.0		5.3		
62	WBL	2514+37	4.0	12.0		5.3		
63	WDL	2509+35	4.0	12.0		5.3		
64	WBL	2506+34	4.0	12.0		5.3		
65	WBL	2504+32	4.0	12.0		5.3		
66	WBL	2502+30	4.0	12.0		5.3		
67	WBL	2499+27	4.0	12.0		5.3		
68	WBL	2498+25	4.0	12.0		5.3		
69	WBL	2496+23	4.0	12.0		5.3		
70	WBL	2494+22	4.0	12.0		5.3		
71	WBL	2492+19	4.0	12.0		5.3		
72	WBL	2490+24	4.0	12.0		5.3		
73	WBL	2488+18	5.0	12.0		6.7		
74	WBL	2487+16	4.0	12.0		5.3		
75	WBL	2486+14	5.0	12.0		6.7		
76	WBL	2485+12	5.0	12.0		6.7		
77	WBL	2484+13	6.0	12.0		8.0		
78	WBL	2483+13	6.0	12.0		8.0		
79	WBL	2481+11	6.0	12.0		8.0		
80	WBL	2479+09	8.0	12.0		10.7		
81	WBL	2477+10	7.0	12.0		9.3		
82	WBL	2476+07	4.0	12.0		5.3		
83	WBL	2474+06	4.0	12.0		5.3		
84	WBL	2473+05	4.0	12.0		5.3		
85	WBL	2472+04	6.0	12.0		8.0		
86	WBL	2471+03	7.0	12.0		9.3		
87	WBL	2470+04	6.0	12.0		8.0		
88	WBL	2469+03	6.0	12.0		8.0		
89	WBL	2468+02	8.0	12.0		10.7		
90	WBL	2467+02	8.0	12.0		10.7		
91	WBL	2465+99	6.0	12.0		8.0		
92	WBL	2464+98	8.0	12.0		10.7		
93	WBL	2463+98	8.0	12.0		10.7		
94	WBL	2462+97	8.0	12.0		10.7		
95	WBL	2461+97	6.0	12.0		8.0		
96	WBL	2460+95	4.0	12.0		5.3		
97	WBL	2459+95	4.0	12.0		5.3		
98	WBL	2458+95	7.0	12.0		9.3		
99	WBL	2457+95	4.0	12.0		5.3		
100	WBL	2455+94	5.0	12.0		6.7		
100A	WBL	2454+98	4.0	12.0		5.3		
101	WBL	2454+24	4.0	12.0		5.3		
102	WBL	2453+88	4.0	12.0		5.3		
103	WBL	2453+35	5.0	12.0		6.7		
104	WBL	2452+34	7.0	12.0		9.3		
105	WBL	2451+34	6.0	12.0		8.0		
106	WBL	2450+33	8.0	12.0		10.7		
107	WBL	2449+66	4.0	12.0		5.3		
108	WBL	2448+71	4.0	12.0		5.3		
109	WBL	2448+14	4.0	12.0		5.3		
WB TOTALS =					0	378	0	0
TOTALS =					4	834	0	0

MODEL: Default
 FILE: M:\MIS - Project - 74966\CADD\Drawings\CADD\Sheet\DOT\Office\Drawings\74966-RT-Scene.dwg
 PROJECT: 74966\CADD\Drawings\CADD\Sheet\DOT\Office\Drawings\74966-RT-Scene.dwg

USER NAME = stefenmk	DESIGNED -	REVISED -
	DRAWN -	REVISED -
PLOT SCALE = 40,0000 * / in.	CHECKED -	REVISED -
PLOT DATE = 10/19/2021	DATE -	REVISED -

**STATE OF ILLINOIS
DEPARTMENT OF TRANSPORTATION**

SCHEDULES OF QUANTITIES

SCALE: SHEET 2 OF 2 SHEETS STA. TO STA.

F.A.S. RTE.	SECTION	COUNTY	TOTAL SHEETS	SHEET NO.
1707	(CF-X,D-X)RS-2	CLARK	27	7
CONTRACT NO. 74966				
ILLINOIS FED. AID PROJECT				

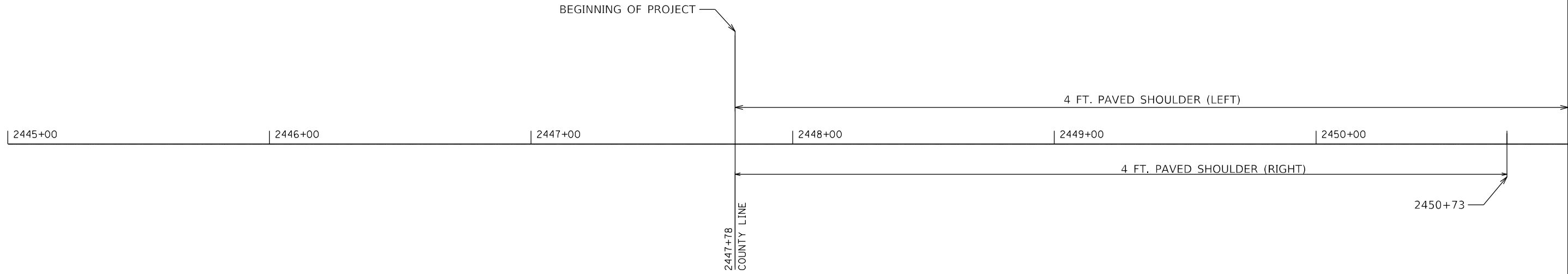

MODEL: Default
 FILE NAME: p:\ultra-cw-beadby.com\PIV\DOT\Documents\DOT Offices\District 7\Projects\74966\CADD\Drawings\CAD\sheet1\74966-sh1.dwg

USER NAME = steffenmk	DESIGNED -	REVISED -
	DRAWN -	REVISED -
PLOT SCALE = 40,0000 * / in.	CHECKED -	REVISED -
PLOT DATE = 10/19/2021	DATE -	REVISED -

STATE OF ILLINOIS
DEPARTMENT OF TRANSPORTATION

PLAN SHEETS			
SCALE:	SHEET 1	OF 14 SHEETS	STA. 2445+00 TO STA. 2450+00

F.A.S. RTE. 1707	SECTION (CF-X,D-X)RS-2	COUNTY CLARK	TOTAL SHEETS 27	SHEET NO. 8
CONTRACT NO. 74966			ILLINOIS FED. AID PROJECT	

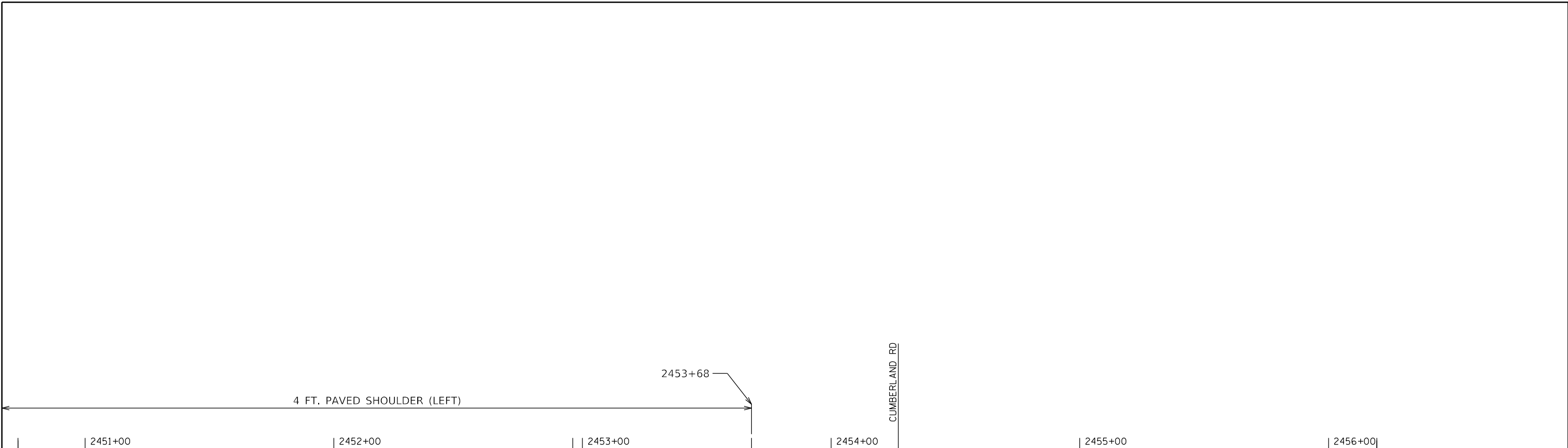

MODEL: Default
 FILE NAME: p:\ultra-cw-beadby.com\PIV\DOT\Documents\DOT Office\District 7\Projects\74966\CADD\Drawings\CAD\sheet\074966-sh-01a.dwg

USER NAME = steffenmk	DESIGNED -	REVISED -
	DRAWN -	REVISED -
PLOT SCALE = 40,0000 * / in.	CHECKED -	REVISED -
PLOT DATE = 10/19/2021	DATE -	REVISED -

STATE OF ILLINOIS
DEPARTMENT OF TRANSPORTATION

PLAN SHEETS
 SCALE: SHEET 2 OF 14 SHEETS STA. 2451+00 TO STA. 2456+00

F.A.S. RTE.	SECTION	COUNTY	TOTAL SHEETS	SHEET NO.
1707	(CF-X,D-X)RS-2	CLARK	27	9
CONTRACT NO. 74966			ILLINOIS FED. AID PROJECT	

2457+00

2458+00

2459+00

2460+00

2461+00

2462+00

MODEL: Default
FILE NAME: p:\ultra-cw-bead-fy.com\FW\DOT\Documents\DOT Office\District 7\Project\74966\CADD\Drawings\CAD\sheet3\DWG\sheet3.DWG

USER NAME = steffenmk	DESIGNED -	REVISED -
	DRAWN -	REVISED -
PLOT SCALE = 40,0000 * / in.	CHECKED -	REVISED -
PLOT DATE = 10/19/2021	DATE -	REVISED -

**STATE OF ILLINOIS
DEPARTMENT OF TRANSPORTATION**

PLAN SHEETS

SCALE: SHEET 3 OF 14 SHEETS STA. 2457+00 TO STA. 2462+00

F.A.S. RTE.	SECTION	COUNTY	TOTAL SHEETS	SHEET NO.
1707	(CF-X,D-X)RS-2	CLARK	27	10
CONTRACT NO. 74966			ILLINOIS FED. AID PROJECT	

2463+00

2464+00

2465+00

2466+00

2467+00

2468+00

2466+44
CE

Model: Default
File Name: p:\ultra-cw-beadby.com\FW\DOT\Documents\DOT Office\District 7\Project\74966\CADD\Drawings\CAD\sheet\074966-sh-04a.dwg

USER NAME = steffenmk	DESIGNED -	REVISED -
	DRAWN -	REVISED -
PLOT SCALE = 40,0000 * / in.	CHECKED -	REVISED -
PLOT DATE = 10/19/2021	DATE -	REVISED -

**STATE OF ILLINOIS
DEPARTMENT OF TRANSPORTATION**

PLAN SHEETS

SCALE: SHEET 4 OF 14 SHEETS STA. 2463+00 TO STA. 2468+00

F.A.S. RTE.	SECTION	COUNTY	TOTAL SHEETS	SHEET NO.
1707	(CF-X,D-X)RS-2	CLARK	27	11
			CONTRACT NO. 74966	
		ILLINOIS	FED. AID PROJECT	

2469+00

2470+00

2471+00

2472+00

2473+00

2474+00

2472+83
CE

Model: Default
File Name: p:\ultra-cw-beadby.com\P\W\DOT\Documents\DOT Offices\District 7\Projects\74966\CADD\Drawings\CAD\sheet5\74966-sh5.dwg

USER NAME = steffenmk	DESIGNED -	REVISED -
	DRAWN -	REVISED -
PLOT SCALE = 40,0000 * / in.	CHECKED -	REVISED -
PLOT DATE = 10/19/2021	DATE -	REVISED -

**STATE OF ILLINOIS
DEPARTMENT OF TRANSPORTATION**

PLAN SHEETS

SCALE: SHEET 5 OF 14 SHEETS STA. 2469+00 TO STA. 2474+00

F.A.S. RTE.	SECTION	COUNTY	TOTAL SHEETS	SHEET NO.
1707	(CF-X,D-X)RS-2	CLARK	27	12
CONTRACT NO. 74966			ILLINOIS FED. AID PROJECT	

2475+00

2476+00

2477+00

2478+00

2479+00

2480+00

2479+90
NW 8TH ST

Model: Default
File Name: p:\ultra-cw-beadby.com\PIV\DOT\Documents\DOT Office\District 7\Project\74966\CADD\Drawings\CAD\sheet\074966-sh-06a.dwg

USER NAME = steffenmk	DESIGNED -	REVISED -
	DRAWN -	REVISED -
PLOT SCALE = 40,0000 * / in.	CHECKED -	REVISED -
PLOT DATE = 10/19/2021	DATE -	REVISED -

**STATE OF ILLINOIS
DEPARTMENT OF TRANSPORTATION**

PLAN SHEETS

SCALE: SHEET 6 OF 14 SHEETS STA. 2475+00 TO STA. 2480+00

F.A.S. RTE.	SECTION	COUNTY	TOTAL SHEETS	SHEET NO.
1707	(CF-X,D-X)RS-2	CLARK	27	13
CONTRACT NO. 74966			ILLINOIS FED. AID PROJECT	

2481+00

2482+00

2483+00

2484+00

2485+00

2486+00

2485+84
FE

Model: Default
File Name: p:\ultra-cw-bead-ey.com\PW\DOT\Documents\DOT Office\District 7\Project\74966\CADD\B1\CAD\sheet\074966-sh-01a.dgn

USER NAME = steffenmk	DESIGNED -	REVISED -
	DRAWN -	REVISED -
PLOT SCALE = 40,0000 * / in.	CHECKED -	REVISED -
PLOT DATE = 10/19/2021	DATE -	REVISED -

**STATE OF ILLINOIS
DEPARTMENT OF TRANSPORTATION**

PLAN SHEETS

SCALE: SHEET 7 OF 14 SHEETS STA. 2481+00 TO STA. 2485+00

F.A.S. RTE.	SECTION	COUNTY	TOTAL SHEETS	SHEET NO.
1707	(CF-X,D-X)RS-2	CLARK	27	14
			CONTRACT NO. 74966	
		ILLINOIS	FED. AID PROJECT	

2487+00

2488+00

2489+00

2490+00

2491+00

2492+00

MODEL: Default
FILE NAME: p:\ultra-cw-bead-fy.com\FW\DOT\Documents\DOT Office\District 7\Project\74966\CADD\Drawings\CAD\Sheet\074966-8-Plan.dwg

USER NAME = steffenmk	DESIGNED -	REVISED -
	DRAWN -	REVISED -
PLOT SCALE = 40,0000 * / in.	CHECKED -	REVISED -
PLOT DATE = 10/19/2021	DATE -	REVISED -

**STATE OF ILLINOIS
DEPARTMENT OF TRANSPORTATION**

PLAN SHEETS

SCALE: SHEET 8 OF 14 SHEETS STA. 2487+00 TO STA. 2492+00

F.A.S. RTE.	SECTION	COUNTY	TOTAL SHEETS	SHEET NO.
1707	(CF-X,D-X)RS-2	CLARK	27	15
CONTRACT NO. 74966			ILLINOIS FED. AID PROJECT	

2493+00

2494+00

2495+00

2496+00

2497+00

2498+00

Model: Default
File Name: p:\ultra-cw-bead-ey.com\FW\DOT\Documents\DOT Offices\District 7\Projects\74966\CADD\Drawings\CAD\sheet\074966-sh-09a.dwg

USER NAME = steffenmk	DESIGNED -	REVISED -
	DRAWN -	REVISED -
PLOT SCALE = 40,0000 * / in.	CHECKED -	REVISED -
PLOT DATE = 10/19/2021	DATE -	REVISED -

**STATE OF ILLINOIS
DEPARTMENT OF TRANSPORTATION**

PLAN SHEETS

SCALE: SHEET 9 OF 14 SHEETS STA. 2493+00 TO STA. 2498+00

F.A.S. RTE.	SECTION	COUNTY	TOTAL SHEETS	SHEET NO.
1707	(CF-X,D-X)RS-2	CLARK	27	16
CONTRACT NO. 74966				
ILLINOIS		FED. AID PROJECT		

2499+00

2500+00

2501+00

2502+00

2503+00

2504+00

2502+26
NW 4TH ST

Model: Default
File Name: p:\ultra-cw-bead-ey.com\FW\DOT\Documents\DOT Office\District 7\Project\74966\CADD\Drawings\CAD\sheet\074966-sh-01a.dwg

USER NAME = steffenmk	DESIGNED -	REVISED -
	DRAWN -	REVISED -
PLOT SCALE = 40,0000 * / in.	CHECKED -	REVISED -
PLOT DATE = 10/19/2021	DATE -	REVISED -

**STATE OF ILLINOIS
DEPARTMENT OF TRANSPORTATION**

PLAN SHEETS

SCALE: SHEET 10 OF 14 SHEETS STA. 2499+00 TO STA. 2504+00

F.A.S. RTE.	SECTION	COUNTY	TOTAL SHEETS	SHEET NO.
1707	(CF-X,D-X)RS-2	CLARK	27	17
CONTRACT NO. 74966			ILLINOIS FED. AID PROJECT	

2505+00

2506+00

2507+00

2508+00

2509+00

2510+00

MODEL: Default
FILE NAME: p:\ultra-cw-bead-ey.com\FW\DOT\Documents\DOT Office\District 7\Project\74966\CADD\Drawings\CAD\Sheet\074966-sh-11a.dwg

USER NAME = steffenmk	DESIGNED -	REVISED -
	DRAWN -	REVISED -
PLOT SCALE = 40,0000 * / in.	CHECKED -	REVISED -
PLOT DATE = 10/19/2021	DATE -	REVISED -

**STATE OF ILLINOIS
DEPARTMENT OF TRANSPORTATION**

PLAN SHEETS

SCALE: SHEET 11 OF 14 SHEETS STA. 2505+00 TO STA. 2510+00

F.A.S. RTE.	SECTION	COUNTY	TOTAL SHEETS	SHEET NO.
1707	(CF-X,D-X)RS-2	CLARK	27	18
CONTRACT NO. 74966				
ILLINOIS		FED. AID PROJECT		

2511+00

2511+55
E 1100TH RD

2512+00

2513+00

2514+00

2515+00

2516+00

MODEL: Default
FILE NAME: p:\ulidect-pw-bead-fwy.com\FWIDOT\Documents\DOT Offices\District 7\Projects\74966\CADD\Drawings\CAD\sheet\074966-sh-12.dwg

USER NAME = steffenmk	DESIGNED -	REVISED -
	DRAWN -	REVISED -
PLOT SCALE = 40,0000 */ in.	CHECKED -	REVISED -
PLOT DATE = 10/19/2021	DATE -	REVISED -

**STATE OF ILLINOIS
DEPARTMENT OF TRANSPORTATION**

PLAN SHEETS

SCALE: SHEET 12 OF 14 SHEETS STA. 2511+00 TO STA. 2516+00

F.A.S. RTE.	SECTION	COUNTY	TOTAL SHEETS	SHEET NO.
1707	(CF-X,D-X)RS-2	CLARK	27	19
CONTRACT NO. 74966			ILLINOIS FED. AID PROJECT	

2517+00

2518+00

2518+62
N CENTRAL AVE

2519+00

2520+00

2521+00

2522+00

MODEL: Default
FILE NAME: p:\ultra-cw-beadby.com\FW\DOT\Documents\DOT Office\District 7\Projects\74966\CADD\Drawings\CAD\sheet13D74966-13.dwg

USER NAME = steffenmk	DESIGNED -	REVISED -
	DRAWN -	REVISED -
PLOT SCALE = 40,0000 * / in.	CHECKED -	REVISED -
PLOT DATE = 10/19/2021	DATE -	REVISED -

**STATE OF ILLINOIS
DEPARTMENT OF TRANSPORTATION**

PLAN SHEETS

SCALE: SHEET 13 OF 14 SHEETS STA. 2517+00 TO STA. 2522+00

F.A.S. RTE.	SECTION	COUNTY	TOTAL SHEETS	SHEET NO.
1707	(CF-X,D-X)RS-2	CLARK	27	20
			CONTRACT NO. 74966	
ILLINOIS			FED. AID PROJECT	

2523+00

2524+00

2525+00

2526+00

2527+00

2528+00

2524+68
END OF PROJECT

MODEL: Default
FILE NAME: p:\ultra-cw-bead-ey.com\FW\DOT\Documents\DOT Office\District 7\Project\74966\CADD\B1\CAD\sheet\074966-sh-01a.dwg

USER NAME = steffenmk	DESIGNED -	REVISED -
	DRAWN -	REVISED -
PLOT SCALE = 40,0000 * / in.	CHECKED -	REVISED -
PLOT DATE = 10/19/2021	DATE -	REVISED -

**STATE OF ILLINOIS
DEPARTMENT OF TRANSPORTATION**

PLAN SHEETS

SCALE: SHEET 14 OF 14 SHEETS STA. 2523+00 TO STA. 2528+00

F.A.S. RTE.	SECTION	COUNTY	TOTAL SHEETS	SHEET NO.
1707	(CF-X,D-X)RS-2	CLARK	27	21
			CONTRACT NO. 74966	
		ILLINOIS	FED. AID PROJECT	

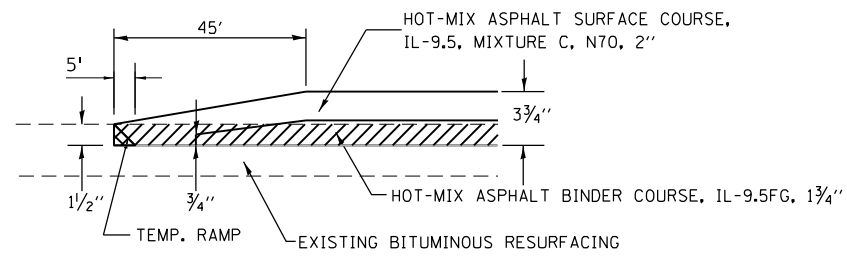

PAVING DETAIL

STATION 2447+33 TO STATION 2447+78

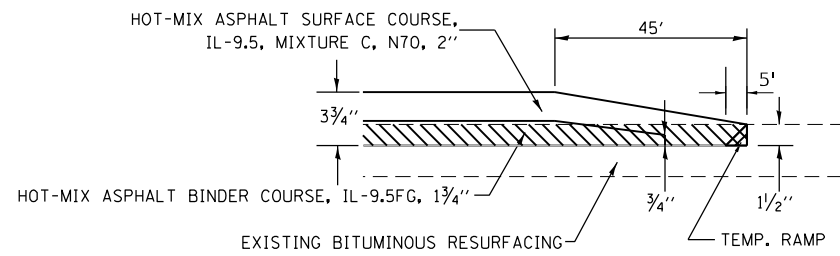

PAVING DETAIL

STATION 2524+68 TO STATION 2525+13

MODEL: Default
 FILE NAME: p:\ultra-cw-beadby.com\PIV\DOT\Documents\DOT Office\District 7\Project\74966\CADD\B1\CAD\sheet\0774966-sh-detail.dgn

USER NAME = steffenmk	DESIGNED -	REVISED -
	DRAWN -	REVISED -
PLOT SCALE = 100,0000' / in.	CHECKED -	REVISED -
PLOT DATE = 10/19/2021	DATE -	REVISED -

**STATE OF ILLINOIS
DEPARTMENT OF TRANSPORTATION**

MILLING/PAVING DETAILS

SCALE: SHEET 1 OF 1 SHEETS STA. TO STA.

F.A.S. RTE.	SECTION	COUNTY	TOTAL SHEETS	SHEET NO.
1707	(CF-X,D-X)RS-2	CLARK	27	22
CONTRACT NO. 74966			ILLINOIS FED. AID PROJECT	

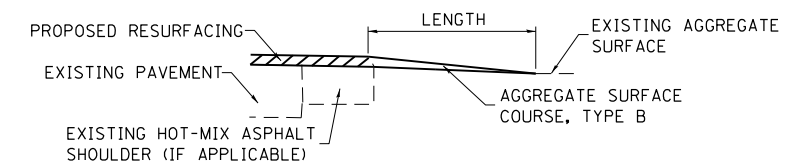
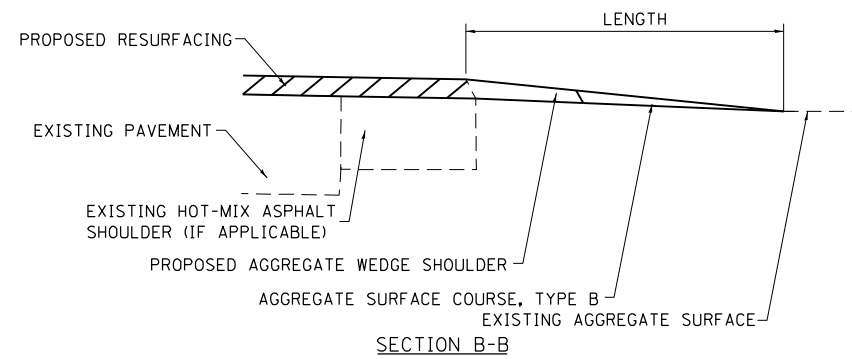
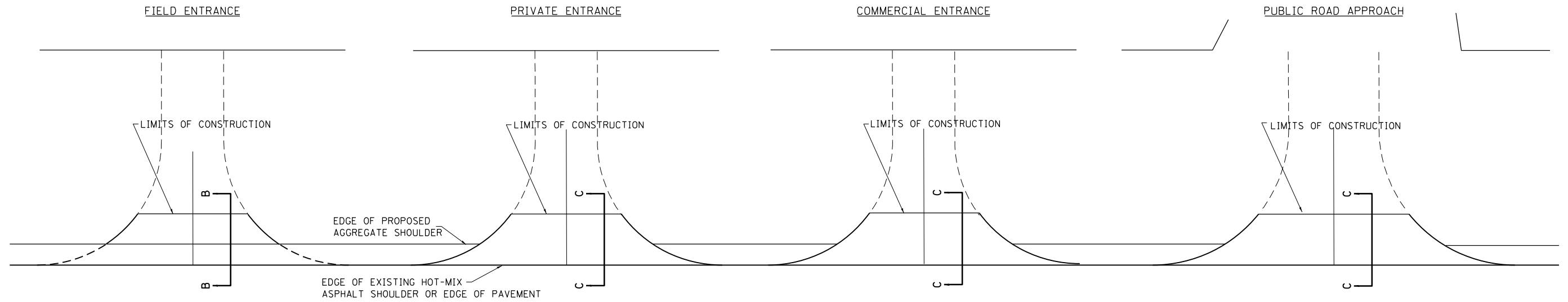

SECTION C-C

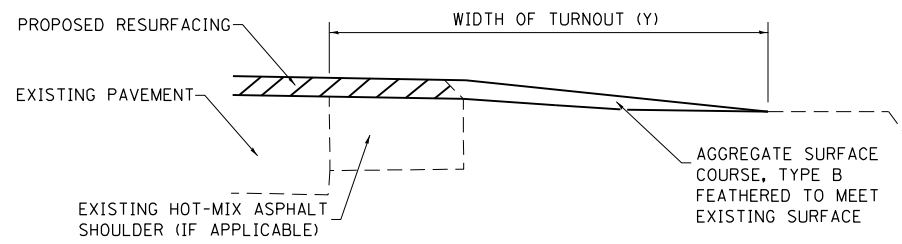

TYPICAL SECTION AT MAILBOX TURNOUT

NOTE: SEE STANDARD 406201 FOR MAILBOX TURNOUT DETAILS

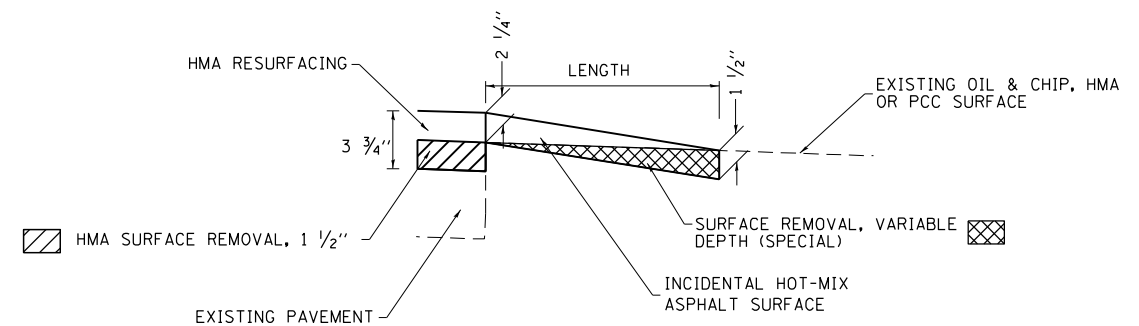

SECTION C-C

NOTES

LENGTH = 10' UNLESS OTHERWISE NOTED ON PLANS

IF THERE IS NOT EXISTING HOT-MIX ASPHALT SHOULDER THEN THE ENTRANCE TAPER STARTS AT THE EDGE OF EXISTING PAVEMENT.

MODEL: Default
 FILE NAME: p:\projects\74966\Drawings\DOT Office\Drawings\74966-RS-Details.dwg
 PROJECT: 74966\Drawings\DOT Office\Drawings\74966-RS-Details.dwg

USER NAME = steffemk	DESIGNED -	REVISED -
	DRAWN -	REVISED -
PLOT SCALE = 100,0000' / in.	CHECKED -	REVISED -
PLOT DATE = 10/19/2021	DATE -	REVISED -

STATE OF ILLINOIS
DEPARTMENT OF TRANSPORTATION

RURAL ENTRANCE AND MAILBOX TURNOUT DETAILS
WITH SHOULDERS

SCALE: SHEET 1 OF 1 SHEETS STA. TO STA.

F.A.S. RTE.	SECTION	COUNTY	TOTAL SHEETS	SHEET NO.
1707	(CF-X,D-X)RS-2	CLARK	27	23
CONTRACT NO. 74966			ILLINOIS FED. AID PROJECT	

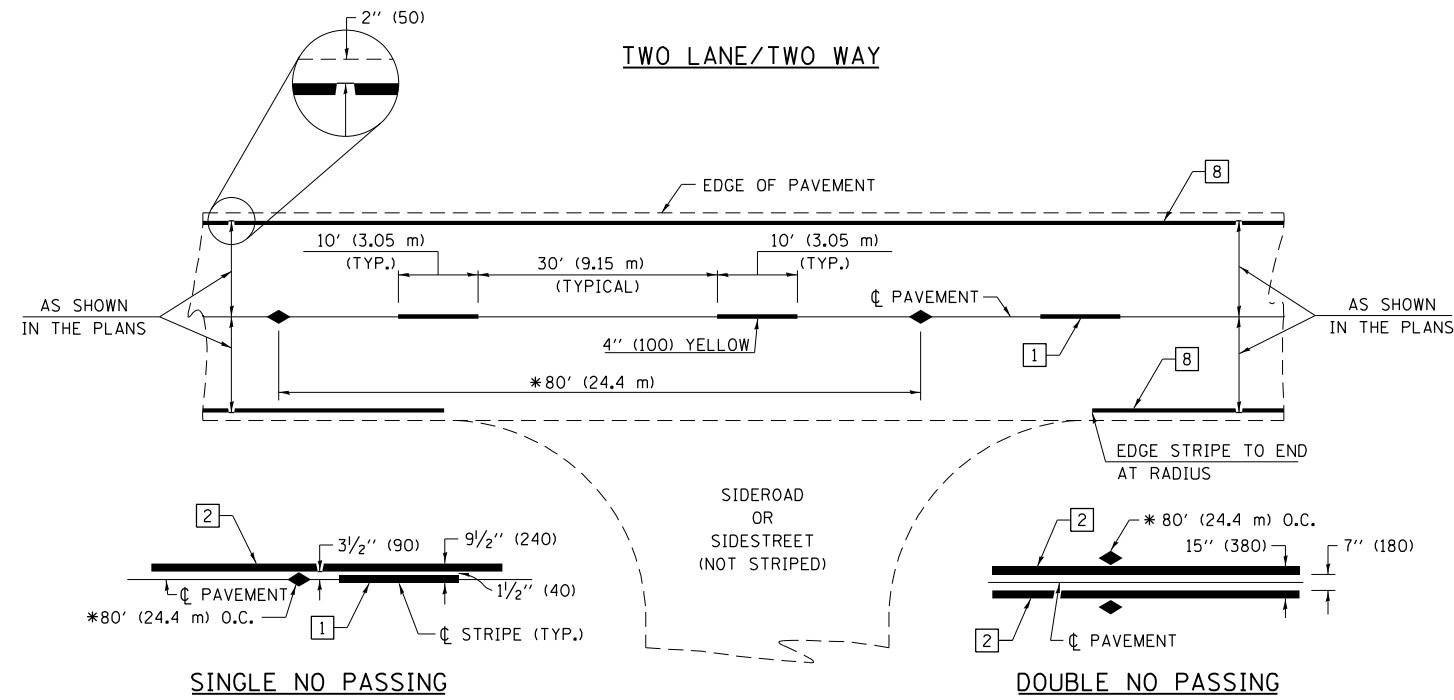

* REDUCE TO 40' (12.2 m) O.C. ON CURVES WITH POSTED OR ADVISORY SPEEDS OF 45 mph (70 km/h) OR LESS.

PAVEMENT MARKING LEGEND

- 1 4" (100) SKIP-DASH (YELLOW)
- 2 4" (100) SOLID (YELLOW)
- 3 12" (300) DIAGONAL (YELLOW)
- 4 4" (100) DOUBLE YELLOW (NARROW)
- 5 12" (300) SOLID WHITE
- 6 RESERVED
- 7 6" (150) SKIP-DASH (WHITE)
- 8 4" (100) SOLID (WHITE)
- 9 12" (300) DIAGONAL (WHITE)
- 10 6" (150) SOLID (WHITE)
- 11 24" (600) STOP BAR (WHITE)
- 12 8" (200) SOLID (WHITE)
- 13 4" (100) PARKING WHITE

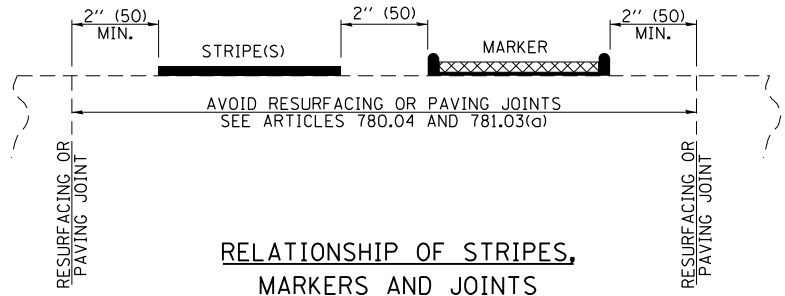

RELATIONSHIP OF STRIPES, MARKERS AND JOINTS

TYPICAL PAVEMENT MARKERS LEGEND

- ◆ TWO-WAY AMBER MARKER
- ▶ ONE-WAY AMBER MARKER
- ▷ ONE-WAY CRYSTAL MARKER

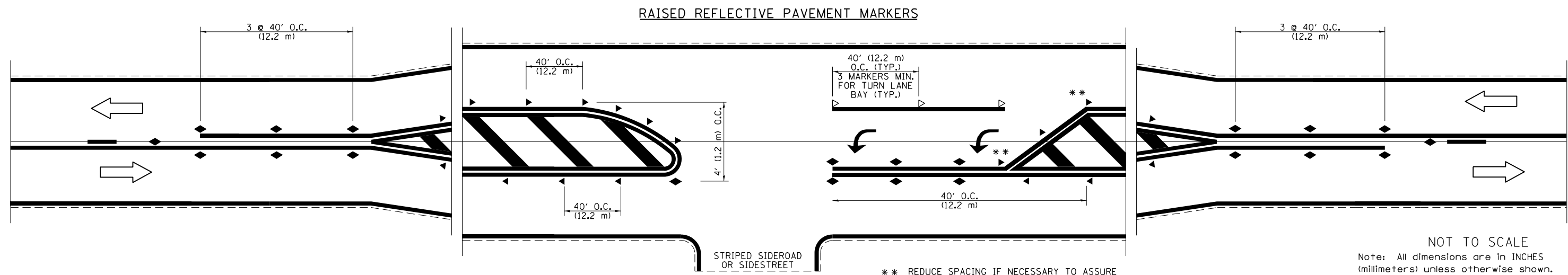

NOT TO SCALE
Note: All dimensions are in INCHES (millimeters) unless otherwise shown.

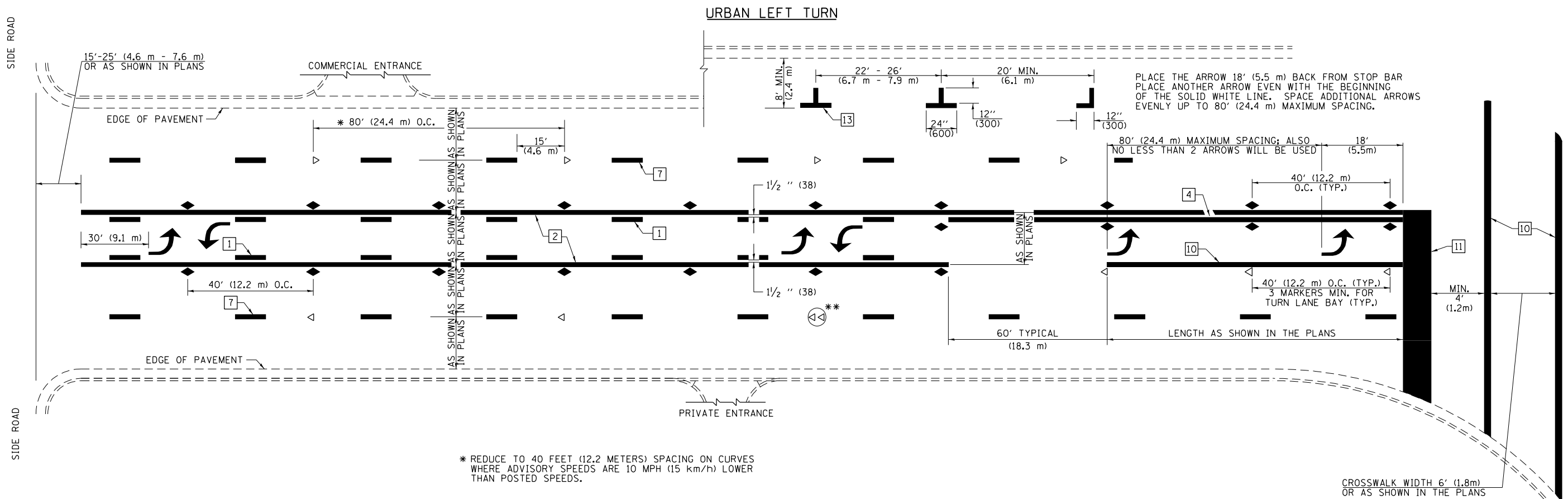

PLACE THE ARROW 18' (5.5 m) BACK FROM STOP BAR
 PLACE ANOTHER ARROW EVEN WITH THE BEGINNING
 OF THE SOLID WHITE LINE. SPACE ADDITIONAL ARROWS
 EVENLY UP TO 80' (24.4 m) MAXIMUM SPACING.

* REDUCE TO 40 FEET (12.2 METERS) SPACING ON CURVES
 WHERE ADVISORY SPEEDS ARE 10 MPH (15 km/h) LOWER
 THAN POSTED SPEEDS.

** DOUBLE LANE LINE MARKERS SHALL BE SPECIFIED
 AND SPACED AS SHOWN IN HIGHWAY STANDARD
 781001 FOR MULTI-LANE DIVIDED AND UNDIVIDED
 HIGHWAYS.

PAVEMENT MARKING LEGEND

- 1 4" (100) SKIP-DASH (YELLOW)
- 2 4" (100) SOLID (YELLOW)
- 3 12" (300) DIAGONAL (YELLOW)
- 4 4" (100) DOUBLE YELLOW (NARROW)
- 5 12" (300) SOLID WHITE
- 6 RESERVED
- 7 6" (150) SKIP-DASH (WHITE)
- 8 4" (100) SOLID (WHITE)
- 9 12" (300) DIAGONAL (WHITE)
- 10 6" (150) SOLID (WHITE)
- 11 24" (600) STOP BAR (WHITE)
- 12 8" (200) SOLID (WHITE)
- 13 4" (100) PARKING WHITE

GENERAL NOTES

1. TURN ARROW PAIRS SHALL BE PLACED AT 250' (75 m) INTERVALS AND SHALL BE EVENLY SPACED BETWEEN BOTH ENDS OF THE BIDIRECTIONAL LEFT TURN LANE. USE A MINIMUM OF TWO PAIRS PER BLOCK.
2. THE SOLID YELLOW PAVEMENT MARKINGS [2] SHOULD GENERALLY START OR END NEAR THE RADIUS POINT OF EACH STREET RETURN EXCEPT WHERE ONE OR BOTH ENDS WOULD INCLUDE STOP BARS.
3. THE SKIP-DASH PAVEMENT MARKINGS [1] OR [7] SHOULD BE CENTERED BETWEEN BOTH ENDS OF EACH CITY BLOCK AND SHALL BE PLACED SO THEY LINE UP ACROSS FROM EACH OTHER.
4. USE LARGE ARROW SIZE FOR BOTH RURAL AND URBAN LOCATIONS. (SEE LAST PAGE OF SECTION 780x FOR SYMBOLS TABLE)
5. LANE LINE EXTENSIONS SHALL BE THE SAME COLOR AND WIDTH AS THE LANE LINE BEING EXTENDED.
6. ALL WHITE SKIP-DASH LINES SHALL BE 6" IN WIDTH.

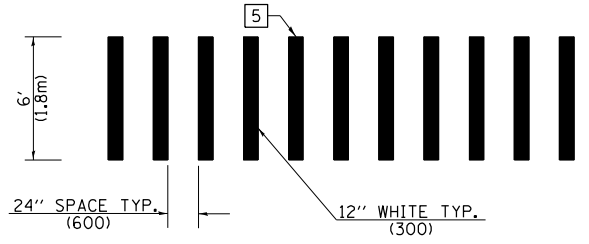

**CROSSWALK DETAIL
 (DECATUR CITY LIMITS ONLY)**

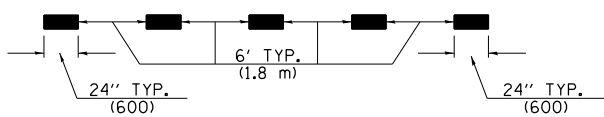

LANE LINE EXTENSIONS

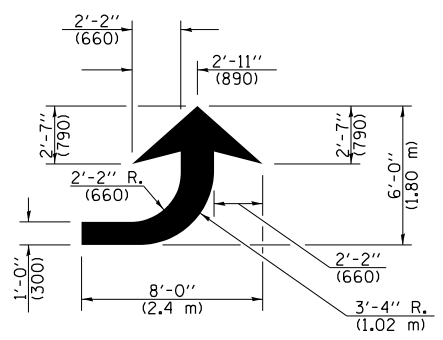

LEFT ARROW

REVERSE FOR RIGHT ARROW
 AREA = 15.6 SQ. FT. (1.47 m²)
 (WHITE)

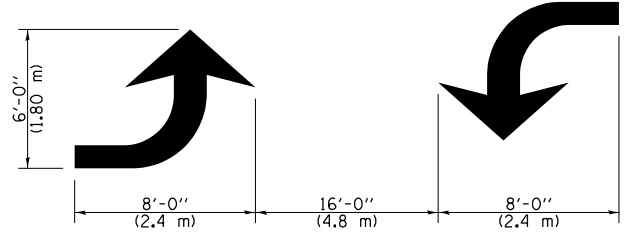

**TYPICAL DOUBLE
 TURN ARROWS (WHITE)**

NOT TO SCALE

Note: All dimensions are in INCHES (millimeters) unless otherwise shown.

DISTRICT 7 DETAIL NO. 7800001

FILE NAME =	USER NAME = steffennk	DESIGNED -	REVISED -	STATE OF ILLINOIS DEPARTMENT OF TRANSPORTATION	PAVEMENT MARKING AND RAISED REFLECTIVE PAVEMENT MARKERS (RURAL & URBAN APPLICATIONS)			F.A.S. RTE.	SECTION	COUNTY	TOTAL SHEETS	SHEET NO.
pw:\idot-pw\bentley.com\PWIDOT\Documents\IDOT Offices\District 7\Projects\74966\CADD\Drawings\74966-sht-details.dgn	PLOT SCALE = 100.0000' / in.	CHECKED -	REVISED -					1707	(CF-X,D-X)RS-2	CLARK	27	25
PLOT DATE = 10/19/2021	DATE -	REVISED -	REVISED -		CONTRACT NO. 74966							
					ILLINOIS FED. AID PROJECT							

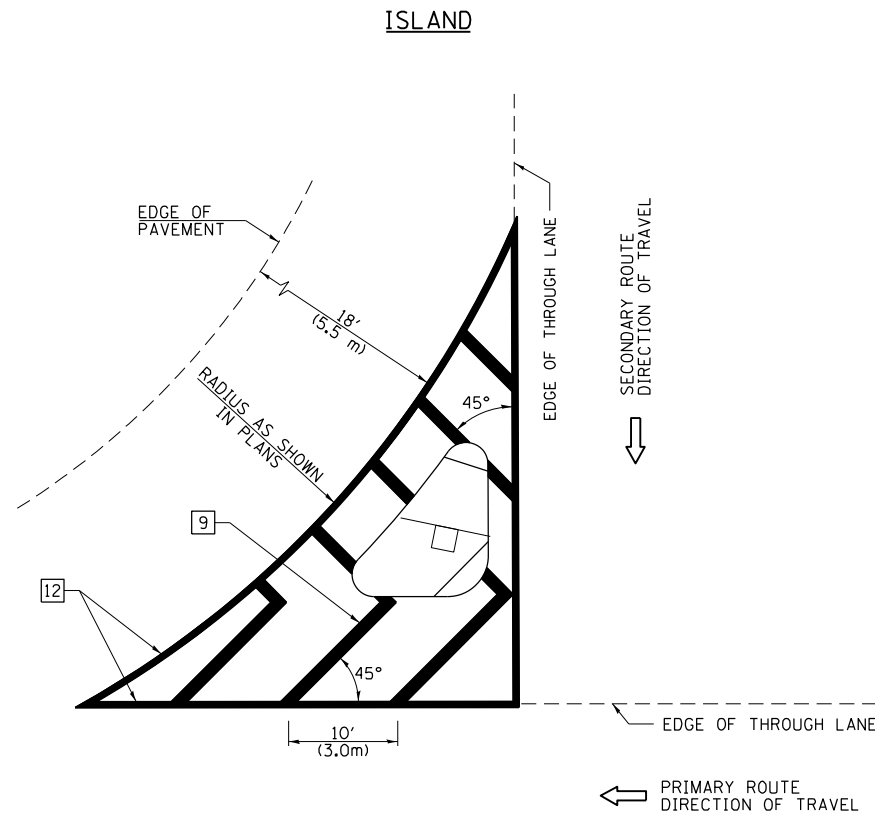

GENERAL NOTES

1. RAISED AND CORRUGATED MEDIANS SHALL BE OUTLINED WITH [2] IF PRESENT.
2. SOME OF THE INFORMATION INCLUDED WITH THIS DETAIL MAY NOT BE APPLICABLE TO THIS IMPROVEMENT.
3. PAVEMENT MARKINGS ARE TO BE EXTENDED THROUGH OMISSIONS WHEN APPLICABLE.
4. FINAL PAVEMENT MARKINGS SHALL BE IN PLACE PRIOR TO PLACING ANY RAISED REFLECTIVE PAVEMENT MARKERS.
5. THE FOLLOWING CRITERIA SHALL BE USED FOR SELECTING THE DIAGONAL PAVEMENT MARKING SPACING:

< 30 MPH (< 50 km/h)	15' (4.5 m)
30-45 MPH (50-75 km/h)	20' (6.0 m)
> 45 MPH (> 75 km/h)	30' (9.0 m)

PAVEMENT MARKING LEGEND

- [1] 4" (100) SKIP-DASH (YELLOW)
 - [2] 4" (100) SOLID (YELLOW)
 - [3] 12" (300) DIAGONAL (YELLOW)
 - [4] 4" (100) DOUBLE YELLOW (NARROW)
 - [5] 12" (300) SOLID WHITE
 - [6] RESERVED
 - [7] 6" (150) SKIP-DASH (WHITE)
 - [8] 4" (100) SOLID (WHITE)
 - [9] 12" (300) DIAGONAL (WHITE)
 - [10] 6" (150) SOLID (WHITE)
 - [11] 24" (600) STOP BAR (WHITE)
 - [12] 8" (200) SOLID (WHITE)
 - [13] 4" (100) PARKING WHITE
-

RURAL LEFT TURN STRIPING

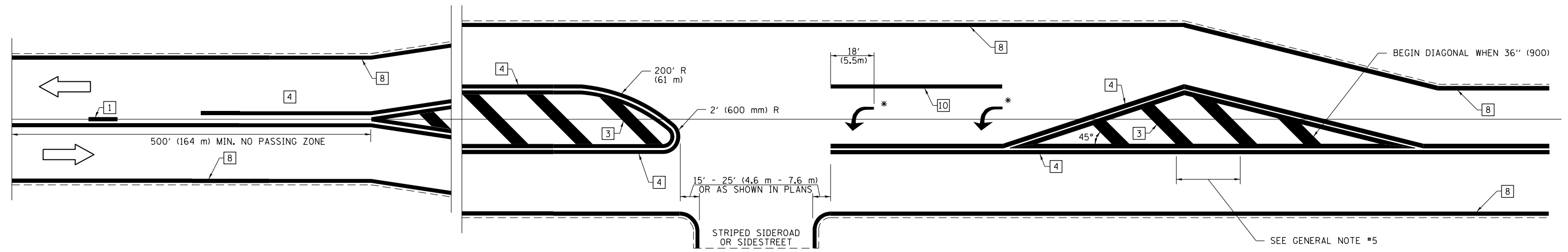

* PLACE AN ARROW 18' (5.5 m) BACK FROM STOP BAR. PLACE ANOTHER ARROW EVEN WITH THE BEGINNING OF THE SOLID WHITE LINE. SPACE ADDITIONAL ARROWS EVENLY UP TO 80' (24.4 m) MAXIMUM SPACING. USE MINIMUM OF 2 ARROWS.

SEE GENERAL NOTE #5

NOT TO SCALE

Note: All dimensions are in INCHES (millimeters) unless otherwise shown.

DISTRICT 7 DETAIL NO. 78000001

FILE NAME =	USER NAME = steffenmk	DESIGNED -	REVISED -
pw:\idot-pw.bentley.com\PWIDOT\Documents\IDOT Offices\District 7\Projects\74966\CADD\Drawings\Drawings\74966-shd-details.dgn		CHECKED -	REVISED -
		DATE -	REVISED -

**STATE OF ILLINOIS
DEPARTMENT OF TRANSPORTATION**

**PAVEMENT MARKING AND RAISED REFLECTIVE PAVEMENT MARKERS
(RURAL & URBAN APPLICATIONS)**

SCALE: SHEET NO. 3 OF 4 SHEETS STA. TO STA.

F.A.S. RTE.	SECTION	COUNTY	TOTAL SHEETS	SHEET NO.
1707	(CF-X,D-X)RS-2	CLARK	27	26
CONTRACT NO. 74966				
ILLINOIS FED. AID PROJECT				

PAVEMENT MARKINGS AT RAILROAD-HIGHWAY GRADE CROSSING

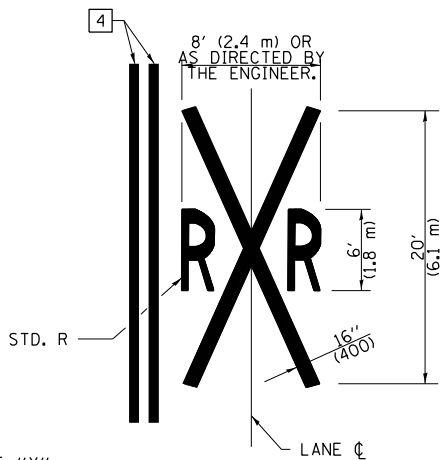
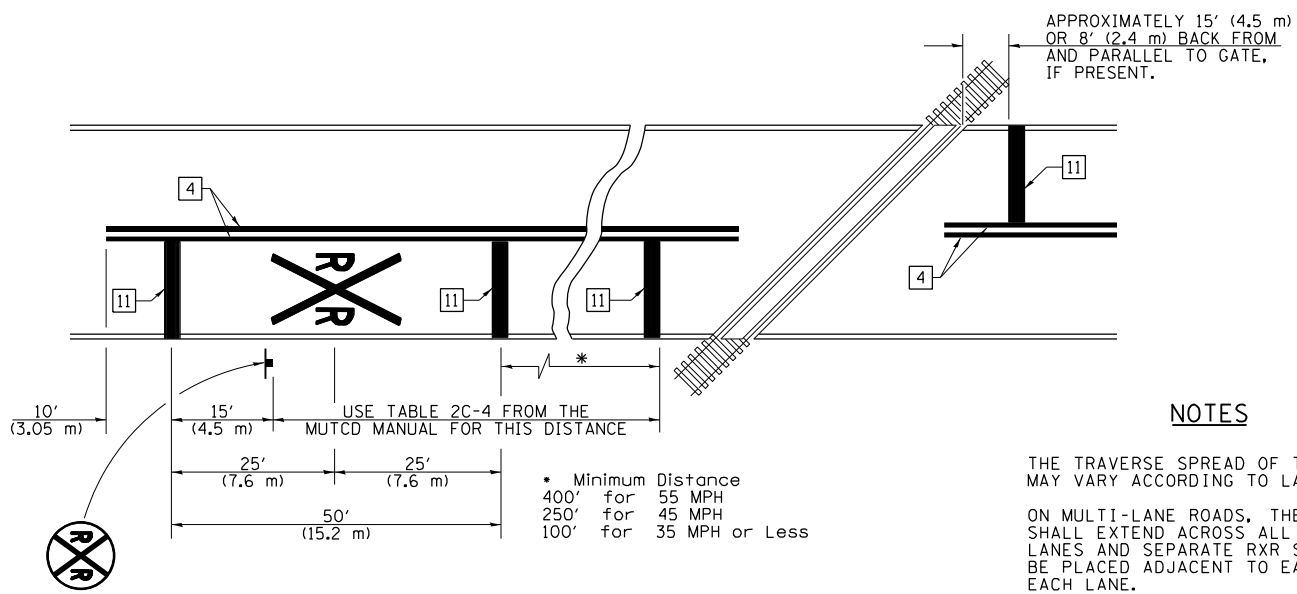

NOTES

THE TRAVERSE SPREAD OF THE "X" MAY VARY ACCORDING TO LANE WIDTH.

ON MULTI-LANE ROADS, THE STOP LINES SHALL EXTEND ACROSS ALL APPROACH LANES AND SEPARATE RXR SYMBOLS SHALL BE PLACED ADJACENT TO EACH OTHER IN EACH LANE.

WHEN THE PAVEMENT MARKING SYMBOL IS USED, A PORTION OF THE SYMBOL SHOULD BE LOCATED DIRECTLY ADJACENT TO THE ADVANCE WARNING SIGN (W10-1) AS PLACED BY TABLE II-1, CONDITION B OF THE MUTCD.

PAVEMENT MARKING LEGEND

- 1 4" (100) SKIP-DASH (YELLOW)
- 2 4" (100) SOLID (YELLOW)
- 3 12" (300) DIAGONAL (YELLOW)
- 4 4" (100) DOUBLE YELLOW (NARROW)
- 5 12" (300) SOLID WHITE
- 6 RESERVED
- 7 6" (150) SKIP-DASH (WHITE)
- 8 4" (100) SOLID (WHITE)
- 9 12" (300) DIAGONAL (WHITE)
- 10 6" (150) SOLID (WHITE)
- 11 24" (600) STOP BAR (WHITE)
- 12 8" (200) SOLID (WHITE)
- 13 4" (100) PARKING WHITE

RAILROAD CROSSING WITH INTERCONNECT ONLY

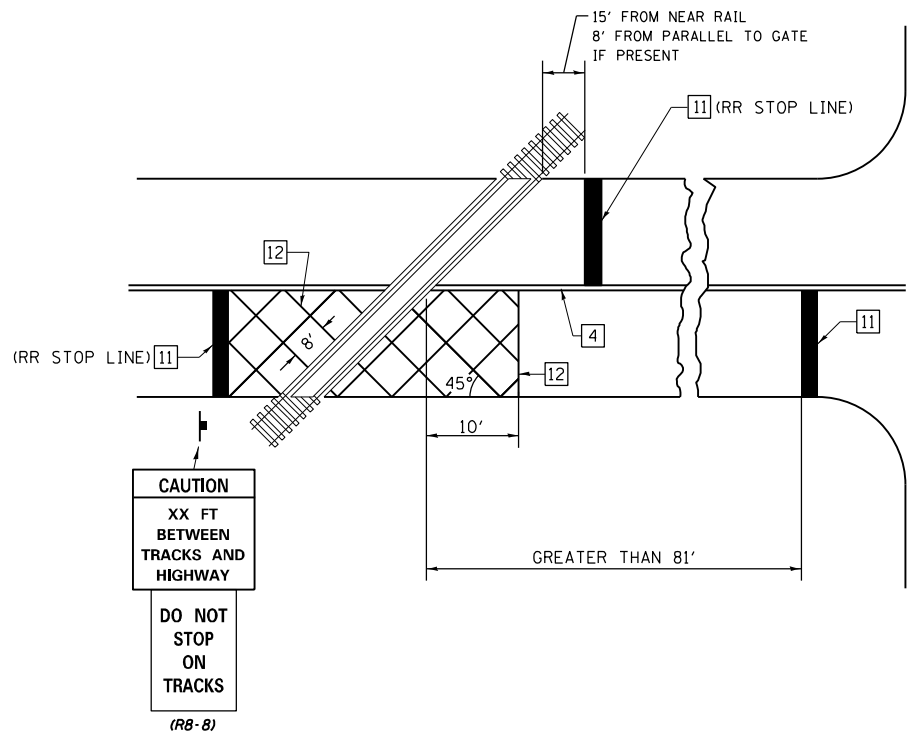

RAILROAD CROSSING WITH INTERCONNECT AND PRE-SIGNALS

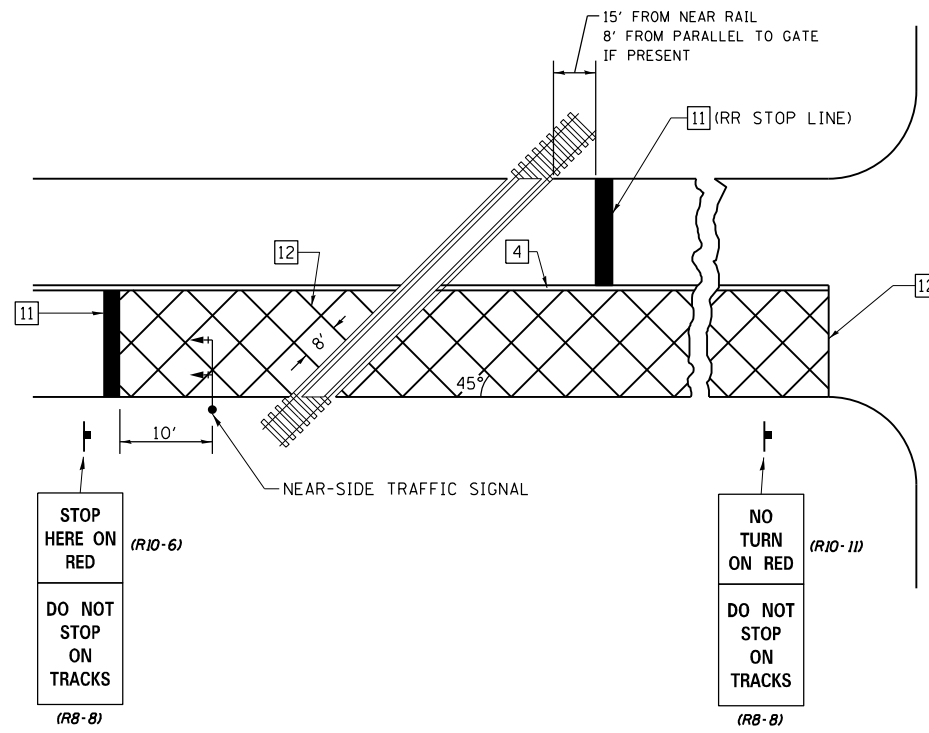

GENERAL NOTES

- SUPPLEMENTAL PAVEMENT MARKINGS TO BE INSTALLED ONLY ON APPROACHES TO INTERSECTIONS CONTROLLED BY TRAFFIC SIGNALS WHICH ARE INTERCONNECTED WITH THE RAILROAD WARNING SIGNALS.
- EXTEND PAVEMENT MARKINGS TO THE INTERSECTION ONLY WHERE NEAR-SIDE TRAFFIC SIGNALS ARE USED.

SUPPLEMENTAL PAVEMENT MARKING TREATMENT FOR RAILROAD-HIGHWAY GRADE CROSSING

NOT TO SCALE

Note: All dimensions are in INCHES (millimeters) unless otherwise shown.

DISTRICT 7 DETAIL NO. 78000001

FILE NAME =	USER NAME = steffenmk	DESIGNED -	REVISED -	STATE OF ILLINOIS DEPARTMENT OF TRANSPORTATION	PAVEMENT MARKING AND RAISED REFLECTIVE PAVEMENT MARKERS (RURAL & URBAN APPLICATIONS)	F.A.S. RTE.	SECTION	COUNTY	TOTAL SHEETS	SHEET NO.
pw:\idot-pw\bentley.com\PIDOT\Documents\IDOT Offices\District 7\Projects\74966\CADD\Drawings\Sheets\774966-sht-details.dgn	PROJECT = 74966	CHECKED -	REVISED -			1707	(CF-X,D-X)RS-2	CLARK	27	27
PLOT SCALE = 100.0000' / in.	DATE = 10/19/2021	DATE -	REVISED -			CONTRACT NO. 74966				
						SCALE:	SHEET NO. 4 OF 4 SHEETS	STA.	TO STA.	