

LEGEND

HMA SURFACE REMOVAL BUTT JOINT, 4.5'

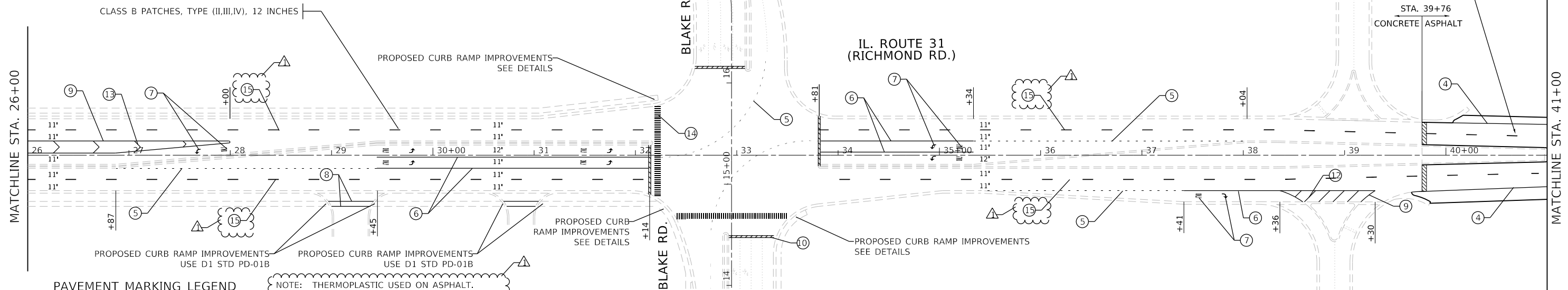

PAVEMENT MARKING LEGEND

NOTE: THERMOPLASTIC USED ON ASPHALT. MODIFIED URETHANE USED ON CONCRETE.

- ① LINE 2 @ 4" SOLID YELLOW, 11" C-C - CENTERLINE (TYP)
- ② LINE 4", SKIP-DASH, WHITE (10' LINE - 30' SPACE) - LANE LINES
- ③ LINE 4", SOLID, YELLOW - EDGE LINE (TYP)
- ④ LINE 4", SOLID WHITE - EDGE LINE (TYP)
- ⑤ LINE 6", SKIP-DASH, WHITE (2' LINE - 6' SPACE) - DOTTED LINES (TYP)
- ⑥ LINE 6", SOLID WHITE - TURN LANE MARKING (TYP)
- ⑦ LETTERS & SYMBOLS, 8", SOLID, WHITE - TURN LANE MARKINGS (TYP)
- ⑧ LINE 2 @ 6", SOLID, WHITE - CROSSWALK LINES (PEDESTRIAN) (TYP)
- ⑨ LINE 8", SOLID, WHITE - GORE MARKING AND CHANNELIZING LINES (TYP)
- ⑩ LINE 24", SOLID, WHITE - STOP LINES (TYP)
- ⑪ LINE 12", SOLID, YELLOW - PAINTED MEDIANS DIAGONALS (TYP) (SEE DISTRICT DETAIL TC-13 FOR SPACING)
- ⑫ LINE 12", SOLID, WHITE - SHOULDER DIAGONALS @ 45° (TYP) (SEE DISTRICT TC-13 FOR SPACING)
- ⑬ LINE 12", SOLID, WHITE - CHANNELIZATION LINES 45° (TYP) (SEE DISTRICT TC-13 FOR SPACING)
- ⑭ LINE 12", SOLID, WHITE - CONTINENTAL CROSSWALK (TYP)
- ⑮ PREFORMED PLASTIC PAVEMENT MARKING, TYPE B - INLAID - LINE 7" ON GROOVING FOR RECESSED PAVEMENT MARKING 8"

② REVISED SHEET 1/7/2022
① REVISED SHEET 1/3/2022

MODEL: Dwg.rvt FILE NAME: P:\2020\4094-00 IDOT Varioris Phase 2 (FPE) 106 Item 16\Network Order 1510GNCADD_Sheets\162\156-SHT-PLAN\01.dgn

<p>INFRASTRUCTURE ENGINEERING INCORPORATED 1 South Wacker Suite 2650 Chicago, IL 60606 P 312.425.9589 F 312.425.9594 www.infrastructure-eng.com</p>	USER NAME = ALane	DESIGNED - IMU	REVISED - ACL 12/17/2021
	PLOT SCALE = 100.0000' / in.	DRAWN - IMU	REVISED - ACL 1/6/2022
	PLOT DATE = 1/6/2022	CHECKED - ACL	REVISED -
		DATE - 08/13/2021	

STATE OF ILLINOIS DEPARTMENT OF TRANSPORTATION

ROADWAY AND PAVEMENT MARKING PLANS	
IL-31 (MCCULLOM LAKE RD TO JOHNSBURG RD)	
SCALE: 1" = 50'	STA. TO STA.

F.A.P. RTE. 336	SECTION 2021-024-R5	COUNTY MCHENRY	TOTAL SHEETS 28	SHEET NO. 9
CONTRACT NO. 62N56				
ILLINOIS FED. AID PROJECT				

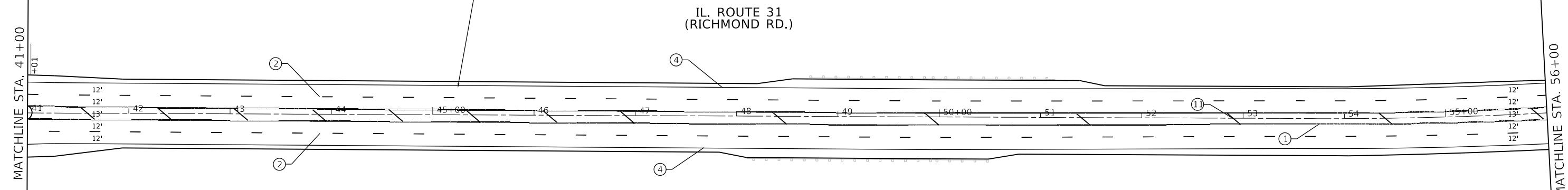
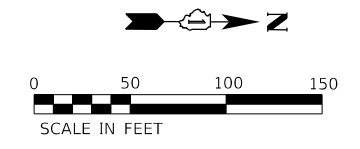

PAVEMENT MARKING LEGEND

- ① LINE 2 @ 4" SOLID YELLOW, 11" C-C - CENTERLINE (TYP)
- ② LINE 4", SKIP-DASH, WHITE (10' LINE - 30' SPACE) - LANE LINES
- ③ LINE 4", SOLID, YELLOW - EDGE LINE (TYP)
- ④ LINE 4", SOLID WHITE - EDGE LINE (TYP)
- ⑤ LINE 6", SKIP-DASH, WHITE (2' LINE - 6' SPACE) - DOTTED LINES (TYP)

NOTE: THERMOPLASTIC USED ON ASPHALT.
MODIFIED URETHANE USED ON CONCRETE.

- ⑥ LINE 6", SOLID WHITE - TURN LANE MARKING (TYP)
- ⑦ LETTERS & SYMBOLS, 8", SOLID, WHITE - TURN LANE MARKINGS (TYP)
- ⑧ LINE 2 @ 6", SOLID, WHITE - CROSSWALK LINES (PEDESTRIAN) (TYP)
- ⑨ LINE 8", SOLID, WHITE - GORE MARKING AND CHANNELIZING LINES (TYP)
- ⑩ LINE 24", SOLID, WHITE - STOP LINES (TYP)

LEGEND

HMA SURFACE REMOVAL BUTT JOINT, 4.5'

- ⑪ LINE 12", SOLID, YELLOW - PAINTED MEDIANS DIAGONALS (TYP) (SEE DISTRICT DETAIL TC-13 FOR SPACING)
- ⑫ LINE 12", SOLID, WHITE - SHOULDER DIAGONALS @ 45° (TYP) (SEE DISTRICT TC-13 FOR SPACING)
- ⑬ LINE 12", SOLID, WHITE - CHANNELIZATION LINES 45° (TYP) (SEE DISTRICT TC-13 FOR SPACING)
- ⑭ LINE 12", SOLID, WHITE - CONTINENTAL CROSSWALK (TYP)
- ⑮ PREFORMED PLASTIC PAVEMENT MARKING, TYPE B - INLAID - LINE 7" ON GROOVING FOR RECESSED PAVEMENT MARKING 8"

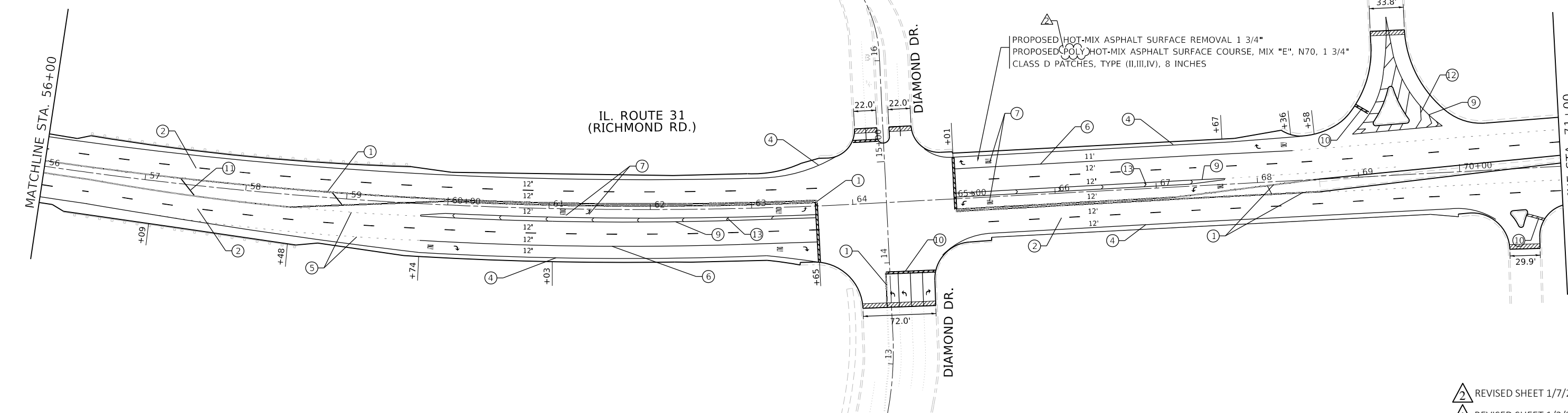

② REVISED SHEET 1/7/2022
① REVISED SHEET 1/3/2022

MODEL: Default
FILE NAME: P:\2020\09-4094-400 IDOT Various Phase 2 (PFE) 106 Item 16\Work Order 151\DCI\CAADD_Sheets\162NS56-SHT-PLN\02.dwg

INFRASTRUCTURE ENGINEERING INCORPORATED	USER NAME = ALane	DESIGNED - IMU	REVISED - ACL 12/17/2021
	PLOT SCALE = 100.0000' / in.	DRAWN - IMU	REVISED - ACL 1/6/2022
	PLOT DATE = 1/6/2022	CHECKED - ACL	REVISED -
		DATE - 08/13/2021	

**STATE OF ILLINOIS
DEPARTMENT OF TRANSPORTATION**

**ROADWAY AND PAVEMENT MARKING PLANS
IL-31 (MCCULLOM LAKE RD TO JOHNSBURG RD)**

F.A.P. RTE.	SECTION	COUNTY	TOTAL SHEETS	SHEET NO.
336	2021-024-R5	MCHENRY	28	10
CONTRACT NO. 62NS56				
ILLINOIS FED. AID PROJECT				

SCALE: 1" = 50' STA. TO STA.

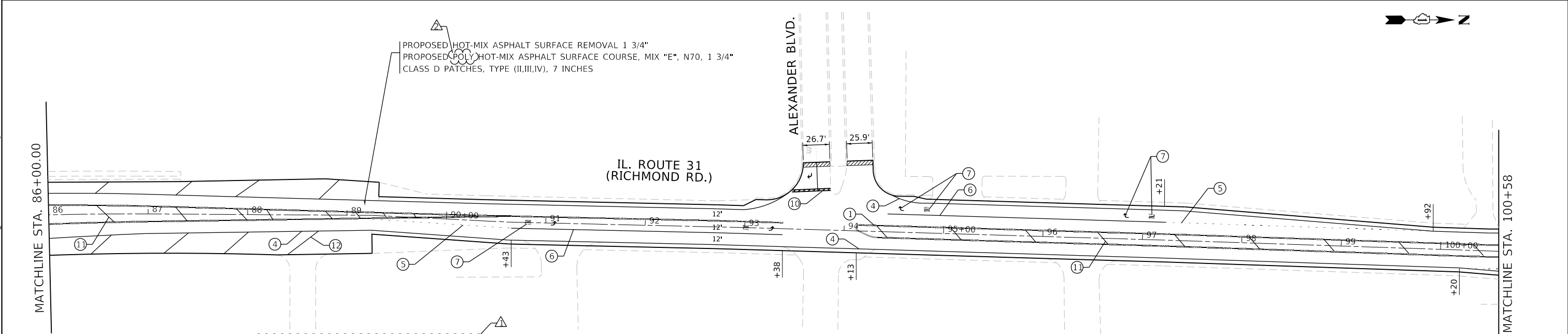
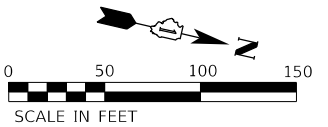
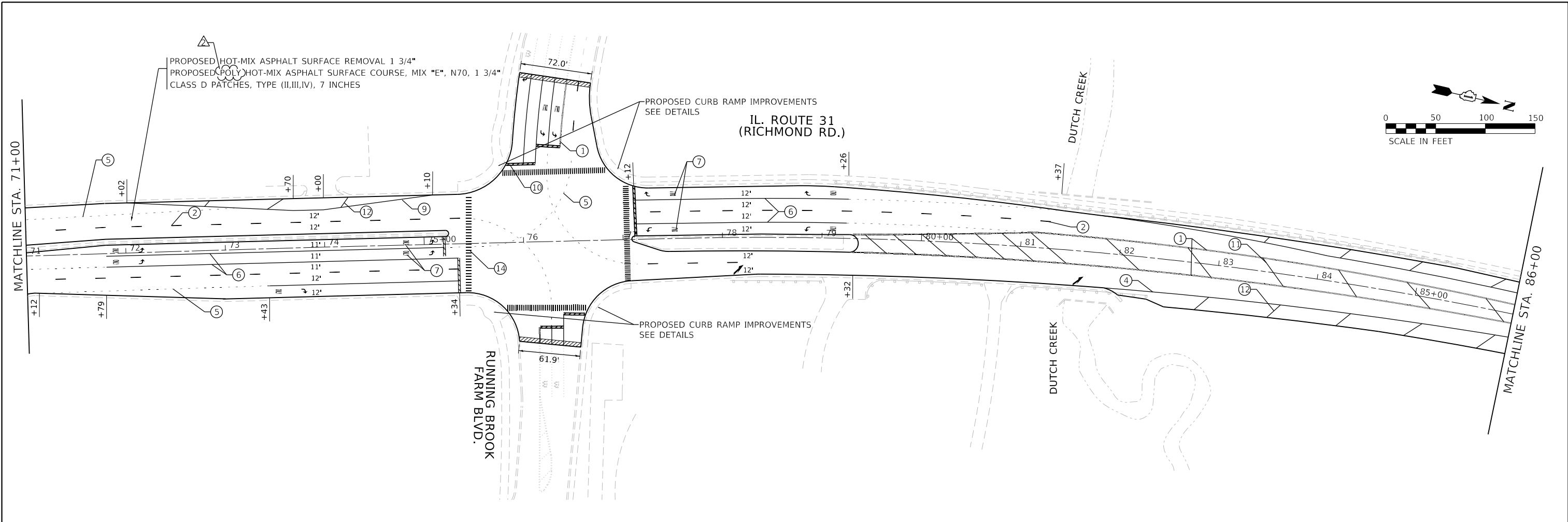

PAVEMENT MARKING LEGEND

- ① LINE 2 @ 4" SOLID YELLOW, 11" C-C - CENTERLINE (TYP)
- ② LINE 4", SKIP-DASH, WHITE (10' LINE - 30' SPACE) - LANE LINES
- ③ LINE 4", SOLID, YELLOW - EDGE LINE (TYP)
- ④ LINE 4", SOLID WHITE - EDGE LINE (TYP)
- ⑤ LINE 6", SKIP-DASH, WHITE (2' LINE - 6' SPACE) - DOTTED LINES (TYP)
- ⑥ LINE 6", SOLID WHITE - TURN LANE MARKING (TYP)
- ⑦ LETTERS & SYMBOLS, 8", SOLID, WHITE - TURN LANE MARKINGS (TYP)
- ⑧ LINE 2 @ 6", SOLID, WHITE - CROSSWALK LINES (PEDESTRIAN) (TYP)
- ⑨ LINE 8", SOLID, WHITE - GORE MARKING AND CHANNELIZING LINES (TYP)
- ⑩ LINE 24", SOLID, WHITE - STOP LINES (TYP)

NOTE: THERMOPLASTIC USED ON ASPHALT.
MODIFIED URETHANE USED ON CONCRETE.

- ⑪ LINE 12", SOLID, YELLOW - PAINTED MEDIANS DIAGONALS (TYP) (SEE DISTRICT DETAIL TC-13 FOR SPACING)
- ⑫ LINE 12", SOLID, WHITE - SHOULDER DIAGONALS @ 45° (TYP) (SEE DISTRICT TC-13 FOR SPACING)
- ⑬ LINE 12", SOLID, WHITE - CHANNELIZATION LINES 45° (TYP) (SEE DISTRICT TC-13 FOR SPACING)
- ⑭ LINE 12", SOLID, WHITE - CONTINENTAL CROSSWALK (TYP)
- ⑮ PREFORMED PLASTIC PAVEMENT MARKING, TYPE B - INLAID - LINE 7" ON GROOVING FOR RECESSED PAVEMENT MARKING 8"

LEGEND

HMA SURFACE REMOVAL BUTT JOINT, 4.5'

MODEL: Dwg.rvt FILE NAME: P:\2020\2020-09-14-00_IDOT_Various Phase 2 (FTEL 196 Item 16)Work Order 1510261CADD_Sheets\162156-SHT-PLN-03.dwg

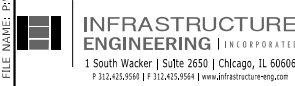

USER NAME = ALane	DESIGNED - IMU	REVISED - ACL 12/17/2021
PLOT SCALE = 100.0000' / in.	DRAWN - IMU	REVISED - ACL 1/6/2022
PLOT DATE = 1/6/2022	CHECKED - ACL	REVISED -
	DATE - 08/13/2021	

**STATE OF ILLINOIS
DEPARTMENT OF TRANSPORTATION**

**ROADWAY AND PAVEMENT MARKING PLANS
IL-31 (MCCULLOM LAKE RD TO JOHNSBURG RD)**
SCALE: 1" = 50' STA. TO STA.

F.A.P. RTE. 336	SECTION 2021-024-R5	COUNTY MCHENRY	TOTAL SHEETS 28	SHEET NO. 11
CONTRACT NO. 62N56				
ILLINOIS FED. AID PROJECT				

REVISED SHEET 1/7/2022
 REVISED SHEET 1/3/2022

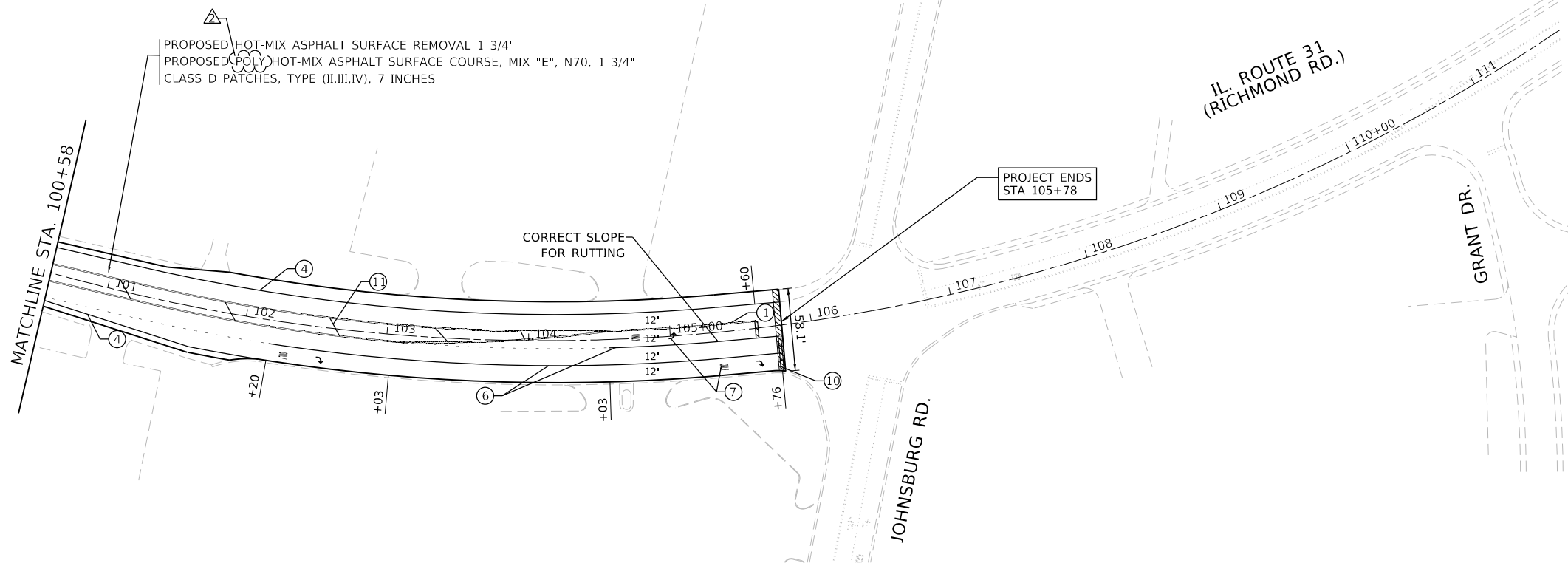
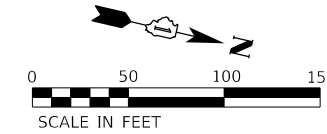

PROPOSED HOT-MIX ASPHALT SURFACE REMOVAL 1 3/4"
 PROPOSED POLY HOT-MIX ASPHALT SURFACE COURSE, MIX "E", N70, 1 3/4"
 CLASS D PATCHES, TYPE (II,III,IV), 7 INCHES

PROJECT ENDS
 STA 105+78

CORRECT SLOPE
 FOR RUTTING

IL. ROUTE 31
 (RICHMOND RD.)

GRANT DR.

JOHNSBURG RD.

PAVEMENT MARKING LEGEND

NOTE: THERMOPLASTIC USED ON ASPHALT.
 MODIFIED URETHANE USED ON CONCRETE.

- ① LINE 2 @ 4" SOLID YELLOW, 11" C-C - CENTERLINE (TYP)
- ② LINE 4", SKIP-DASH, WHITE (10' LINE - 30' SPACE) - LANE LINES
- ③ LINE 4", SOLID, YELLOW - EDGE LINE (TYP)
- ④ LINE 4", SOLID WHITE - EDGE LINE (TYP)
- ⑤ LINE 6", SKIP-DASH, WHITE (2' LINE - 6' SPACE) - DOTTED LINES (TYP)
- ⑥ LINE 6", SOLID WHITE - TURN LANE MARKING (TYP)
- ⑦ LETTERS & SYMBOLS, 8", SOLID, WHITE - TURN LANE MARKINGS (TYP)
- ⑧ LINE 2 @ 6", SOLID, WHITE - CROSSWALK LINES (PEDESTRIAN) (TYP)
- ⑨ LINE 8", SOLID, WHITE - GORE MARKING AND CHANNELIZING LINES (TYP)
- ⑩ LINE 24", SOLID, WHITE - STOP LINES (TYP)
- ⑪ LINE 12", SOLID, YELLOW - PAINTED MEDIANS DIAGONALS (TYP) (SEE DISTRICT DETAIL TC-13 FOR SPACING)
- ⑫ LINE 12", SOLID, WHITE - SHOULDER DIAGONALS @ 45° (TYP) (SEE DISTRICT TC-13 FOR SPACING)
- ⑬ LINE 12", SOLID, WHITE - CHANNELIZATION LINES 45° (TYP) (SEE DISTRICT TC-13 FOR SPACING)
- ⑭ LINE 12", SOLID, WHITE - CONTINENTAL CROSSWALK (TYP)
- ⑮ PREFORMED PLASTIC PAVEMENT MARKING, TYPE B - INLAID - LINE 7" ON GROOVING FOR RECESSED PAVEMENT MARKING 8"

LEGEND

HMA SURFACE REMOVAL BUTT JOINT, 4.5'

2 REVISED SHEET 1/7/2022

1 REVISED SHEET 1/3/2022

MODEL: D:\p4\it...
 FILE NAME: P:\2020\20-0494-00 IDOT Various Phase 2 (PBE_106 Item 16)Work Order 151DGN\CADD_Sheets\162N56-SHT-PLU-04.dgn

<p>INFRASTRUCTURE ENGINEERING INCORPORATED 1 South Wacker Suite 2650 Chicago, IL 60606 P 312.425.9569 F 312.425.9568 www.infrastructure-eng.com</p>	USER NAME = ALane	DESIGNED - IMU	REVISED - ACL 12/17/2021
	PLOT SCALE = 100.0000' / in.	DRAWN - IMU	REVISED - ACL 1/6/2022
	PLOT DATE = 1/6/2022	CHECKED - ACL	REVISED -
		DATE - 08/13/2021	

STATE OF ILLINOIS
DEPARTMENT OF TRANSPORTATION

ROADWAY AND PAVEMENT MARKING PLANS
IL-31 (MCCULLOM LAKE RD TO JOHNSBURG RD)

SCALE: 1" = 50' STA. TO STA.

F.A.P. RTE.	SECTION	COUNTY	TOTAL SHEETS	SHEET NO.
336	2021-024-R5	MCHENRY	28	12
CONTRACT NO. 62N56			ILLINOIS FED. AID PROJECT	