

LONGITUDINAL SECTION

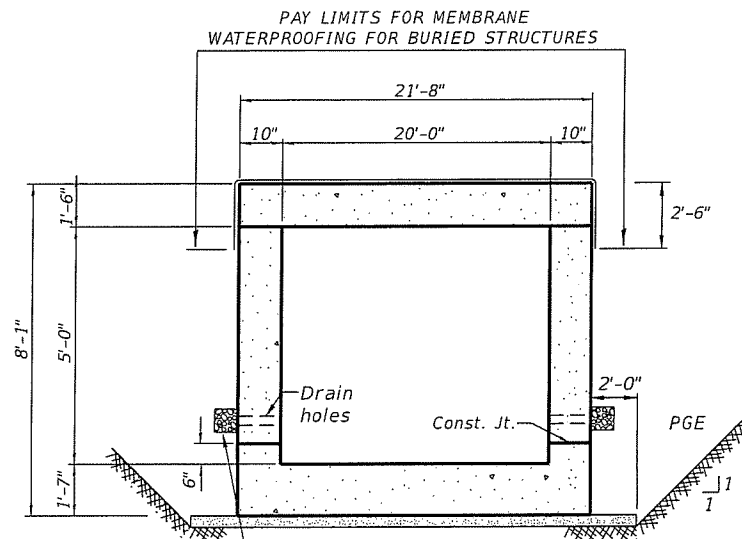

SECTION THRU BARREL

GENERAL NOTES

The design fill height for this box is 1.5 ft.
Plan dimensions and details relative to existing plans are subject to nominal construction variations. The CONTRACTOR shall field verify existing dimensions and details affecting new construction and make necessary approved adjustments prior to construction or ordering of materials. Such variations shall not be cause for additional compensation for a change in scope of the work, however, the CONTRACTOR will be paid for the quantity actually furnished at the unit price bid for the work.

A precast structure is not an option for this project, and will not be allowed.

2

DESIGN SPECIFICATIONS
AASHTO LRFD Bridge Design Specifications
8th Edition with 2018 Interims

DESIGN STRESSES
FIELD UNITS
f'c = 3,500 psi
fy = 60,000 psi (Reinforcement)

LOADING HL-93
Allow 50#/sq. ft. for future wearing surface.

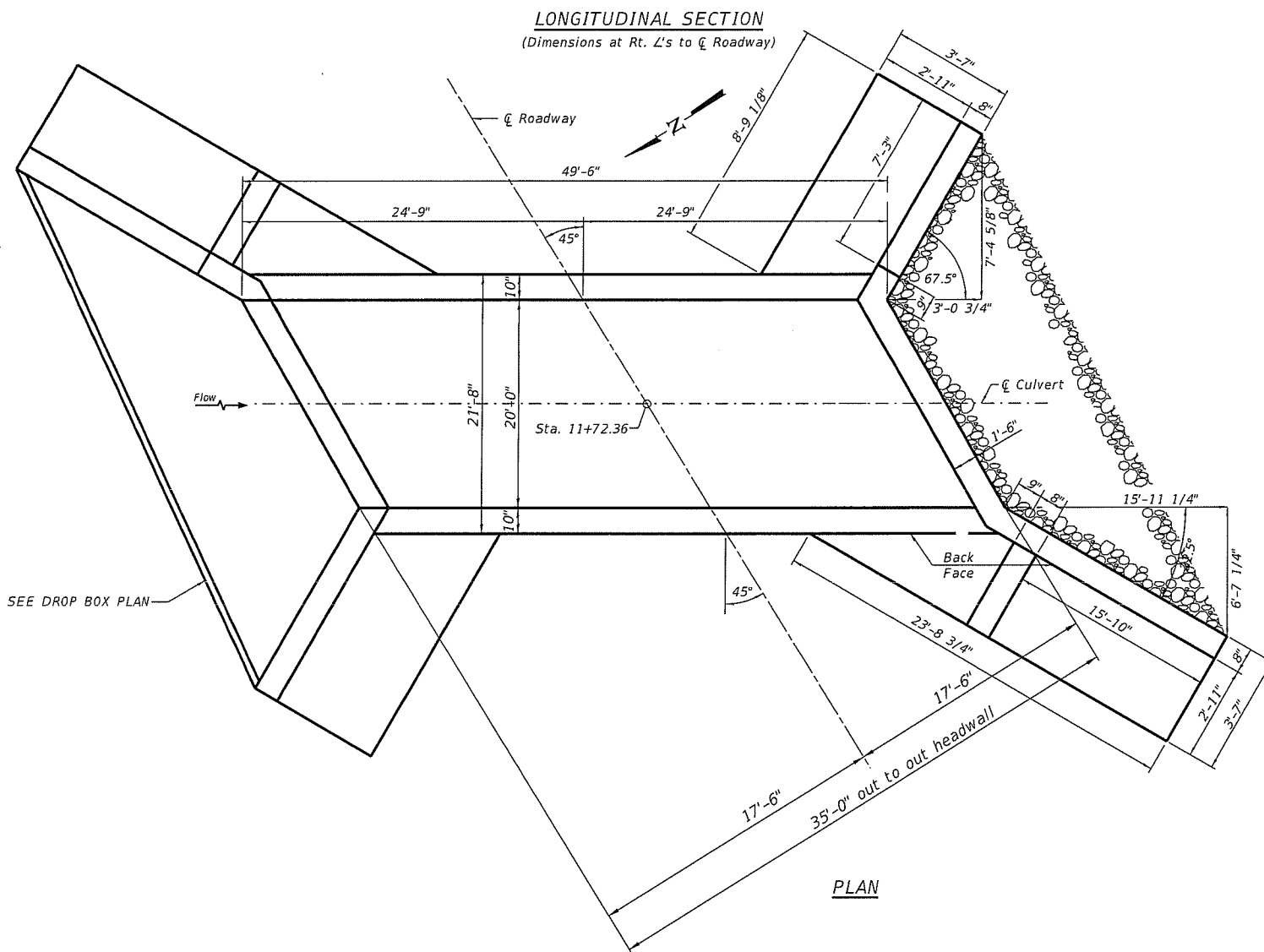

PLAN

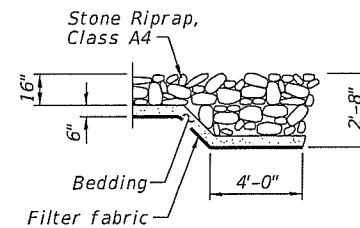

RIPRAP FLANK DETAIL

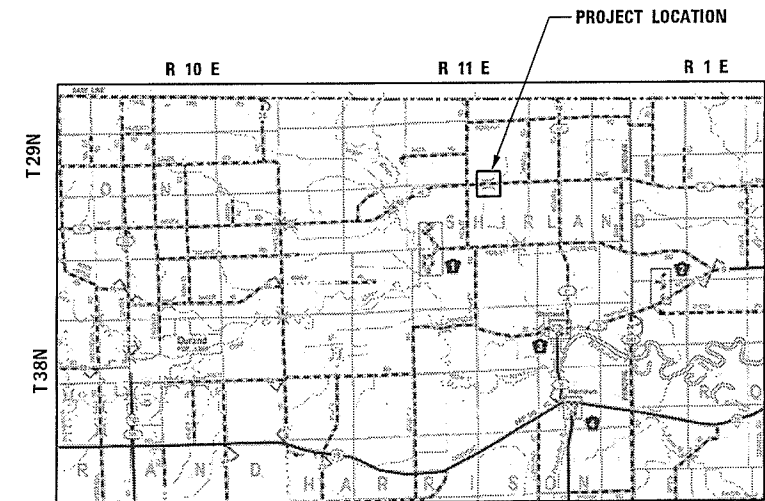

LOCATION SKETCH

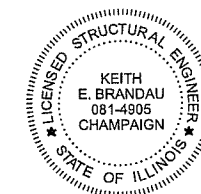

I certify that to the best of my knowledge, information and belief, this bridge/box culvert design is structurally adequate for the design loading shown on the plans. The design is an economical one for the style of structure and complies with requirements of the current 'AASHTO Standard Specifications for Highway Bridges'.

Keith E. Brandau 8/30/21
Date

KEITH E BRANDAU, S.E.,
License Expires 11/30/21

USER NAME =	DESIGNED - TO	REVISED - 1/12/22
PLOT SCALE =	DRAWN - ORG	REVISED -
PLOT DATE =	CHECKED - TO	REVISED -
	DATE - 07/23/2020	REVISED -

CHASTAIN & ASSOCIATES LLC
CONSULTING ENGINEERS

DECATUR (217) 422-8544
SCHAUMBURG (773) 714-0050
ROCKFORD (815) 489-0050
184-001397

GENERAL PLAN AND ELEVATION

SCALE: SHEET NO. OF SHEETS STA. TO STA.

ROUTE	SECTION	COUNTY	TOTAL SHEETS	SHEET NO.
40	19-00671-00-BR	WINNEBAGO	8	5
PROJECT ILLINOIS			CONTRACT NO. 85715	