

BENCHMARK AND CONTROL POINT #1
 STA 11+23.76, 55.67' LT
 N: 476543.27, E: 2528883.80
 ELEV = 391.85
 NGS MONUMENT

LEGEND

- PR BITUMINOUS TACK COAT AND POROUS FRICTION COURSE, 0.10'
- PR BITUMINOUS PAVEMENT MILLING, BITUMINOUS TACK COAT AND BITUMINOUS SURFACE COURSE

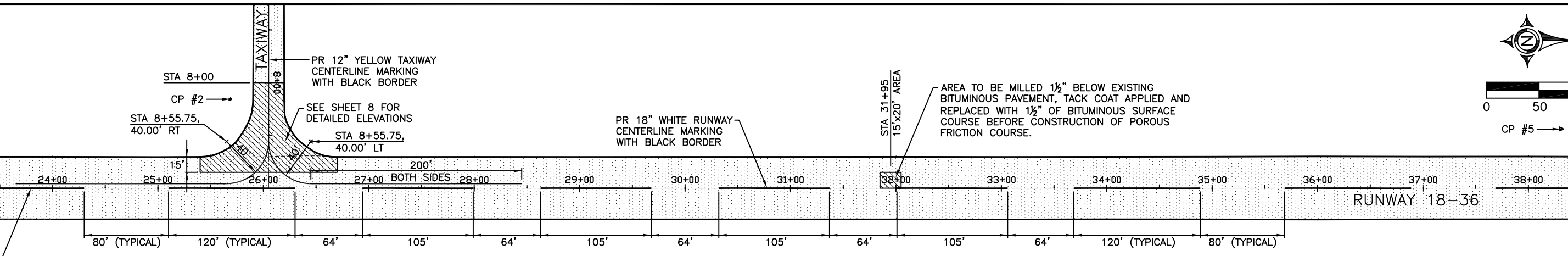

BENCHMARK AND CONTROL POINT #2
 STA 25+68.71, 84.36' LT
 N: 477988.48, E: 2528875.55
 ELEV = 391.64
 NGS MONUMENT

BENCHMARK AND CONTROL POINT #5
 STA 38+30.92, 56.00' LT
 N: 479250.17, E: 2528921.77
 ELEV = 392.30
 IRON PIN WITH CAP

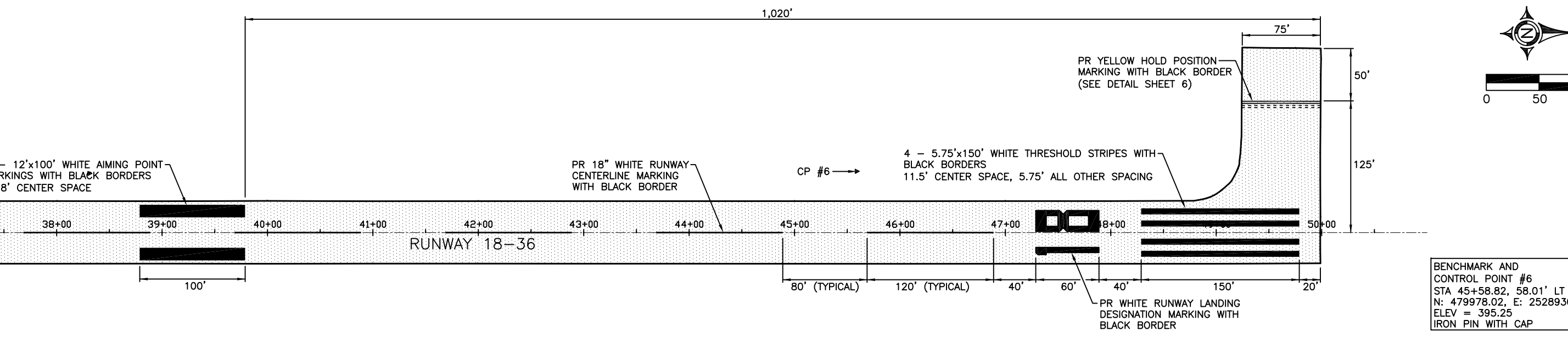

BENCHMARK AND CONTROL POINT #6
 STA 45+58.82, 58.01' LT
 N: 479978.02, E: 2528930.06
 ELEV = 395.25
 IRON PIN WITH CAP

14 Nov 2014 - 10:39am X:\2014\14066\ac\14066 Base.dwg: Layout Tab '05 PLAN'