

LEGEND

- PR BITUMINOUS TACK COAT AND POROUS FRICTION COURSE, 0.10'
- PR BITUMINOUS PAVEMENT MILLING, BITUMINOUS TACK COAT AND BITUMINOUS SURFACE COURSE
- PR PCC PVMT 7"
- PROPOSED/EXISTING ELEVATIONS

NOTE:
 EXISTING BITUMINOUS PAVEMENT SHALL BE MILLED TO 1/2" BELOW PROPOSED FINISHED GRADE USING DOUBLE STRINGLINE GRADE CONTROL. AREAS OF ZERO MILLING WILL REQUIRE ADDITIONAL BITUMINOUS SURFACE COURSE ABOVE THE TYPICAL 1/2" MINIMUM PROPOSED.

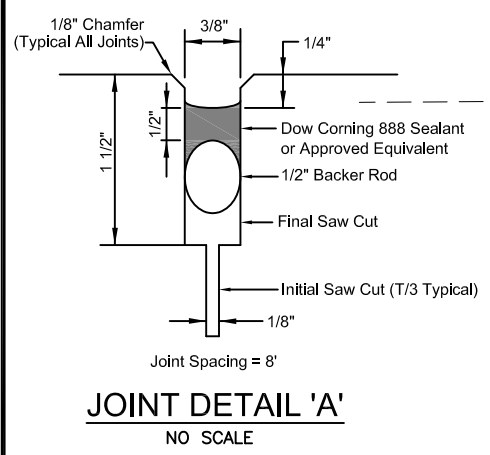
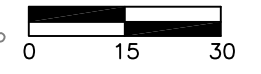

EXISTING MAINTENANCE HANGAR

EXISTING T-HANGAR

EXISTING TURF AREA

EXISTING TERMINAL BUILDING/T-HANGAR

EXISTING TURF AREA

EXISTING TURF AREA

EX FUEL

EX STORM SEWER

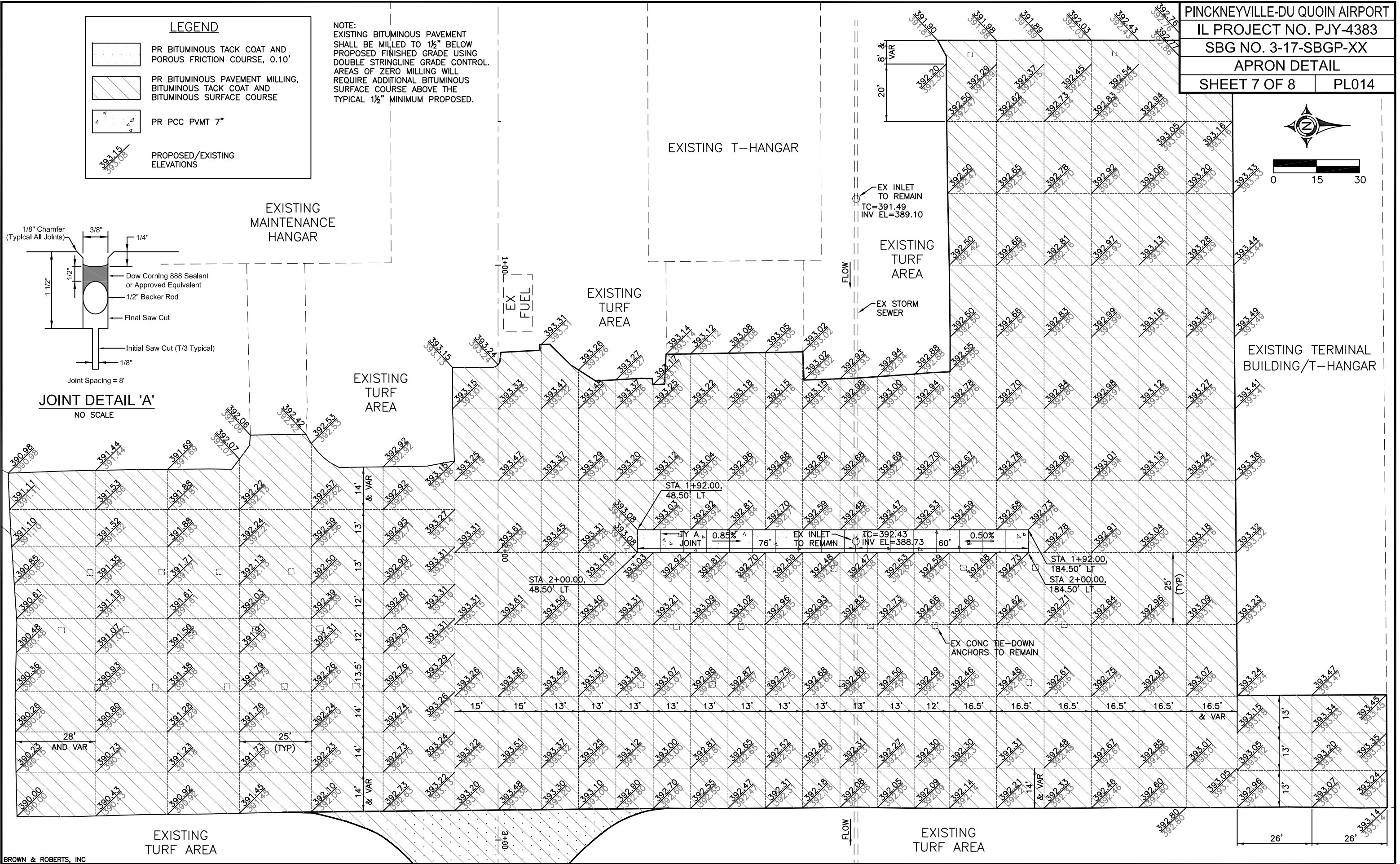

14 Nov 2014 - 10:54am X:\2014\14066\oc\14066 Base.dwg: Layout Tab '07' APRON DETAIL