

02-15-13 SPECIAL LETTING ITEM 001

STATE OF ILLINOIS
DEPARTMENT OF TRANSPORTATION
DIVISION OF HIGHWAYS

PROPOSED HIGHWAY PLANS

FAU ROUTE 9105 (SALISBURY ST.)
SECTION 119B-1DS-1

MCKINLEY BRIDGE
DECK SEALING
MADISON COUNTY, IL
CITY OF ST. LOUIS, MO

C-98-035-11

F.A.U. RTE.	SECTION	COUNTY	TOTAL SHEETS	SHEET NO.
9105	119B-1DS-1	MADISON	15	1
		ILLINOIS	CONTRACT NO. 76E74	

D-98-035-11

FOR INDEX OF SHEETS, SEE SHEET NO. 2

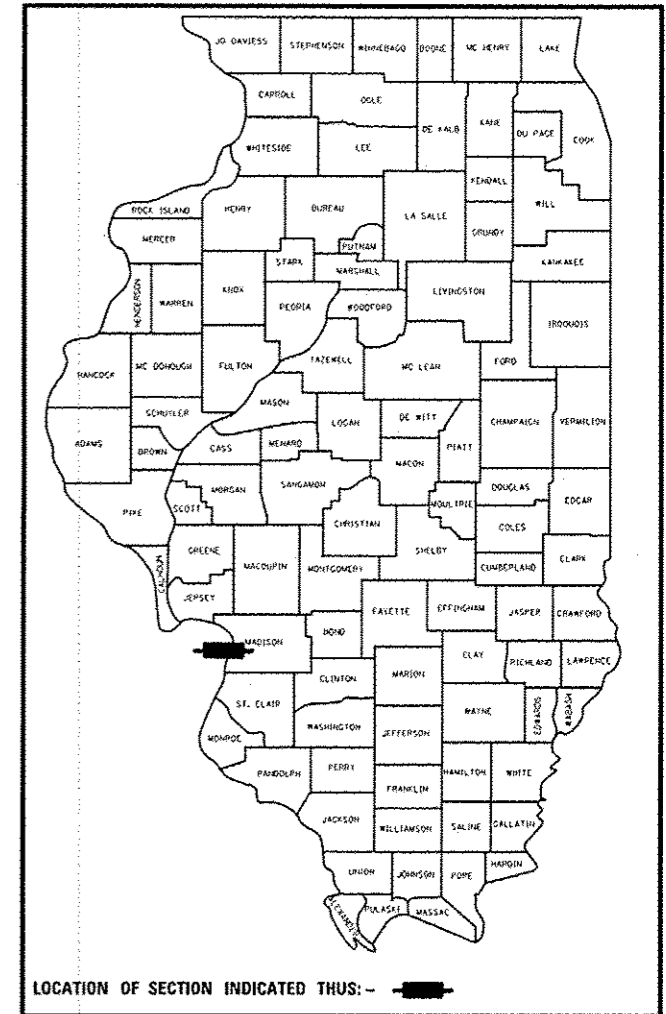

LOCATION: MCKINLEY BRIDGE AND APPROACHES

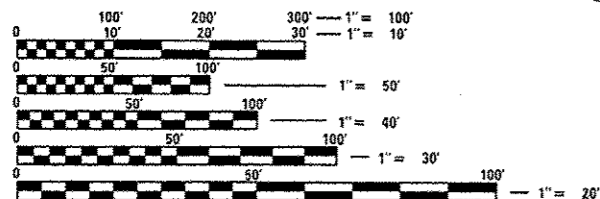

FULL SIZE PLANS HAVE BEEN PREPARED USING STANDARD ENGINEERING SCALES. REDUCED SIZED PLANS WILL NOT CONFORM TO STANDARD SCALES. IN MAKING MEASUREMENTS ON REDUCED PLANS, THE ABOVE SCALES MAY BE USED.

J.U.L.I.E.
JOINT UTILITY LOCATION INFORMATION FOR EXCAVATION
1-800-892-0123
OR 811

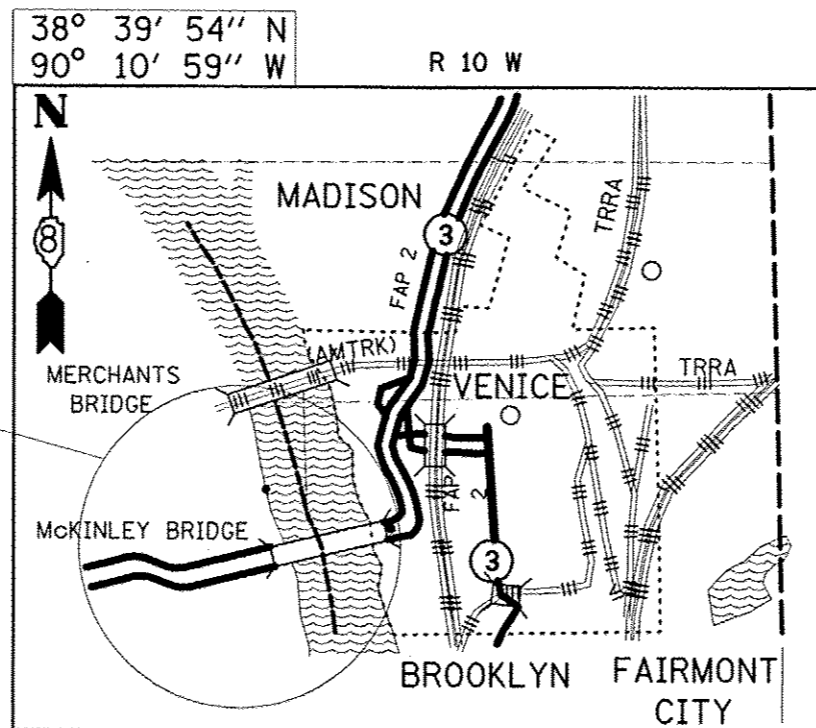

VENICE TOWNSHIP &
CITY OF ST. LOUIS

SCALE: NOT TO SCALE
GROSS LENGTH = 5,734.25 FT. = 1.09 MILE
NET LENGTH = 5,734.25 FT. = 1.09 MILE

PROJECT ENGINEER: MICHAEL PRITCHETT (618) 346-3180

DESIGNER: NINA DEBOISE (618) 346-3141

CONTRACT NO. 76E74

STATE OF ILLINOIS
DEPARTMENT OF TRANSPORTATION
DIVISION OF HIGHWAYS

SUBMITTED *December 7 2012*
[Signature]
DEPUTY DIRECTOR OF HIGHWAYS, REGION ENGINEER

Jan 18 2013
John D. Baranzelli PE, I&E
acting ENGINEER OF DESIGN AND ENVIRONMENT

Jan 18 2013
Omer Osman PE, I&E
DIRECTOR OF HIGHWAYS, CHIEF ENGINEER

PRINTED BY THE AUTHORITY
OF THE STATE OF ILLINOIS

STANDARDS

- 000001-06 STANDARD SYMBOLS, ABBREVIATIONS AND PATTERNS
- 001006 DECIMAL OF AN INCH AND OF A FOOT
- 701901-02 TRAFFIC CONTROL DEVICES
- B.L.R. 21-9 TYPICAL APPLICATION OF TRAFFIC CONTROL DEVICES FOR CONSTRUCTION ON RURAL LOCAL HIGHWAYS

INDEX OF SHEETS

- 1. COVER SHEET
- 2. INDEX OF SHEETS, STANDARDS, AND GENERAL NOTES
- 3. SUMMARY OF QUANTITIES
- 4. SCHEDULE OF QUANTITIES
- 5. EXISTING PLAN AND ELEVATION
- 6.-11. TYPICAL SECTIONS
- 12.-15. TRAFFIC CONTROL AND PROTECTION , SPECIAL

COMMITMENTS

- 1. CONTRACTOR SHALL NOTIFY THE FOLLOWING INDIVIDUALS AT LEAST TWO WEEKS PRIOR TO PROCEEDING WITH THE WORK:

ST.CLAIR COUNTY TRANSIT DISTRICT.(618) 628-8090, ATTN: BILL GROGAN
 MADISON COUNTY TRANSIT DISTRICT. FAX (618) 797-7547
 VENICE POLICE DEPARTMENT, (618) 482-6767
 VENICE FIRE DEPARTMENT, (618) 428-6840
 MADISON COUNTY 911 EMERGENCY TELLPHONE SYSTEM BOARD.(618) 296-5911
 DISTRICT 8 TRAFFIC MANAGEMENT CENTER, (618) 346-3233
 CITY OF ST.LOUIS, (314) 647-3111, ATTN: TODD WALTERMANN
 MISSOURI DEPARTMENT OF TRANSPORTATION, (314) 877-0118, ATTN: DEANNA VENKER
 METRO EAST PARK AND RECREATION DISTRICT, (618) 346-4905
 TRAILNET, (314) 436-1324
 LEAGUE OF ILLINOIS BICYCLISTS, (630)978-0583
 GREAT RIVERS GREENWAY, (314) 436-7009

GENERAL NOTES

1. THE STANDARDS AND REVISION NUMBERS SHALL APPLY TO THIS PROJECT.
2. PLAN DIMENSIONS AND DETAILS RELATIVE TO THE EXISTING STRUCTURE AND ROADWAY HAVE BEEN TAKEN FROM EXISTING PLANS AND ARE SUBJECT TO CONSTRUCTION VARIATIONS. IT SHALL BE THE RESPONSIBILITY OF THE CONTRACTOR TO VERIFY SUCH DIMENSIONS AND DETAILS IN THE FIELD AND MAKE NECESSARY APPROVED ADJUSTMENTS PRIOR TO CONSTRUCTION OR ORDERING OF MATERIALS. SUCH VARIATIONS SHALL NOT BE CAUSE FOR ADDITIONAL COMPENSATION FOR A CHANGE IN THE SCOPE OF WORK. HOWEVER, THE CONTRACTOR WILL BE PAID FOR THE QUANTITY ACTUALLY FURNISHED AT THE UNIT PRICE BID FOR THE WORK.
3. IN ADDITION TO THE REQUIREMENTS OF ARTICLE 107.16, THE CONTRACTOR SHALL PROTECT THE SURFACE OF THE BRIDGE DECK AND BRIDGE APPROACH PAVEMENT IN A MANNER SATISFACTORY TO THE ENGINEER BEFORE ANY EQUIPMENT IS ALLOWED TO CROSS THE STRUCTURE. PROTECTION SHALL BE PROVIDED FOR ALL EQUIPMENT AS DEFINED IN ARTICLE 107.16 REGARDLESS IF TRACK MOUNTED OR WHEELED.
4. UTILITIES INTERFERENCES ARE NOT ANTICIPATED ON THIS CONTRACT. NO ADDITIONAL COST SHALL BE ADDED TO THE CONTRACT RESULTING FROM ANY UNANTICIPATED UTILITY INTERFERENCE. FOR ADDITIONAL INFORMATION, CONTACT THE JOINT UTILITY LOCATING INFORMATION FOR EXCAVATORS (J.U.L.I.E.) SYSTEM AT (800) 892-0123 OR 811.
5. THE DEPARTMENT STRONGLY ENCOURAGES THE PRIME CONTRACTOR AND THEIR APPROVED SUB- CONTRACTOR TO HIRE MINORITY, WOMEN AND DISADVANTAGED INDIVIDUALS FROM ITS FEDERALLY FUNDED HIGHWAY CONSTRUCTION CAREERS TRAINING PROGRAM (HCCTP) TO HELP MEET WORK FORCE AND TRAINEE GOALS. THIS PROGRAM IS TRAINING MINORITIES, WOMEN AND DISADVANTAGED INDIVIDUALS IN HIGHWAY CONSTRUCTION -RELATED SKILLS, E.G., MATH FOR THE TRADES, JOB READINESS, TECHNICAL SKILLS COURSE WORK (CARPENTRY, CONCRETE FLAT WORK, BLUEPRINT READING, SITE PLANS, SITE WORK, TOOLS USE, ETC.) AND OSHA 10 HOUR CERTIFICATION, TO PREPARE THEM FOR A CAREER IN THER HIGHWAY CONSTRUCTION TRADES. GRADUATES ARE WELL-TRAINED AND READY TO BECOME PRODUCTIVE ENTRY-LEVEL CONSTRUCTION WORKERS. CONTACT THE DISTRICT 8 EEO OFFICE AT 618-346-3360 AND/OR THE HCCTP COORDINATOR AT 618-874-6528 TO LEARN MORE ABOUT THE PROGRAM AND FOR ASSISTANCE IN MEETING WORKFORCE AND TRAINEE GOALS.
6. EXISTING PAVEMENT MARKINGS SHALL BE TEMPORARILY COVERED PRIOR TO APPLICATION OF THE DECK SURFACE TREATMENT, TO PREVENT THE SEALER FROM BEING APPLIED TO THE MARKINGS AND TO PROTECT THE REFLECTIVE PROPERTIES OF THE MARKINGS. THE TEMPORARY COVERING MATERIAL USED SHALL BE SUCH THAT IT WILL NOT AFFECT THE MARKING'S REFLECTIVITY WHEN REMOVED AFTER APPLICATION OF THE DECK SURFACE TREATMENT AND PRIOR TO OPENING TO TRAFFIC. THE COST OF THIS WORK SHALL BE INCLUDED IN THE PRICE BID FOR CONCRETE SEALER AND NO ADDITIONAL COMPENSATION WILL BE ALLOWED.
7. THE SEPARATED BIKE TRAIL FACILITY SHALL NOT BE SEALED.
8. THE CANTILEVERED LANES ON THE MAIN SPAN, STA. 92+17.5 TO STA. 107+82.5, SHALL NOT BE SEALED.
9. THE GAP BETWEEN THE IMPACT ATTENUATORS FROM STA. 89+94 TO STA. 90+57 AND FROM STA. 109+47.5 TO STA. 110+12.5 SHALL BE SEALED.

FILE NAME :	USER NAME : #USER#	DESIGNED -	REVISED -	STATE OF ILLINOIS DEPARTMENT OF TRANSPORTATION	INDEX OF SHEETS, STANDARDS AND GENERAL NOTES	F.A.P. RTE.	SECTION	COUNTY	TOTAL SHEETS	SHEET NO.	
#FILE#		DRAWN -	REVISED -			9105	119B-105 -1	MADISON	15	2	
		CHECKED -	REVISED -			CONTRACT NO. 76E74					
		DATE -	REVISED -			FED. ROAD DIST. NO. ILLINOIS FED. AID PROJECT					
					SCALE:	SHEET NO. 1 OF 1 SHEETS		STA.	TO STA.		

STA		STA	LENGTH (FT.)	AVG. WIDTH (FT)	DECK AREA TO BE SEALED (SQ. FT.)	AREA OF PARAPET TO BE SEALED PER LIN. FT. (SQ. FT.)	TOTAL PARAPET AREA TO BE SEALED (SQ. FT.)	GAP TO BE SEALED (SQ. FT.)
61+02.00	To	62+47.50	145.50	44	6,402	3.77	1,096	
62+47.50	To	63+54.50	107.00	38	4,066	3.77	806	
63+54.50	To	89+67.50	2613.00	32	83,616	3.77	19,685	
89+67.50	To	92+17.50	250.00	37.75	9,438	3.77	580	378
92+17.50	To	107+82.50	1565.00	24	37,560	1.67	5,217	
107+82.50	To	110+32.50	250.00	37.75	9,438	3.77	559	390
110+32.50	To	118+36.25	803.75	32	25,720	3.77	6,055	
Subtotal (Sq. Ft.)=					176,239		33,998	768
Bridge Deck Concrete Sealer (Sq. Ft.)=					211,005			

F.H.C. NAME #FILE#	USER NAME : #USER#	DESIGNED -	REVISED -	STATE OF ILLINOIS DEPARTMENT OF TRANSPORTATION	SCHEDULE OF QUANTITIES			F.A.U. RTE.	SECTION	COUNTY	TOTAL SHEETS	SHEET NO.
	PLOT SCALE : #SCALE#	CHECKED -	REVISED -					9105	1198-105-1	MADISON	15	4
PLOT DATE : #DATE#	DATE -	REVISED -	REVISED -		SCALE:	SHEET NO. 1 OF 1 SHEETS	STA.	TO STA.	CONTRACT NO. 76E74			
								FED. ROAD DIST. NO.	ILLINOIS FED. AID PROJECT			

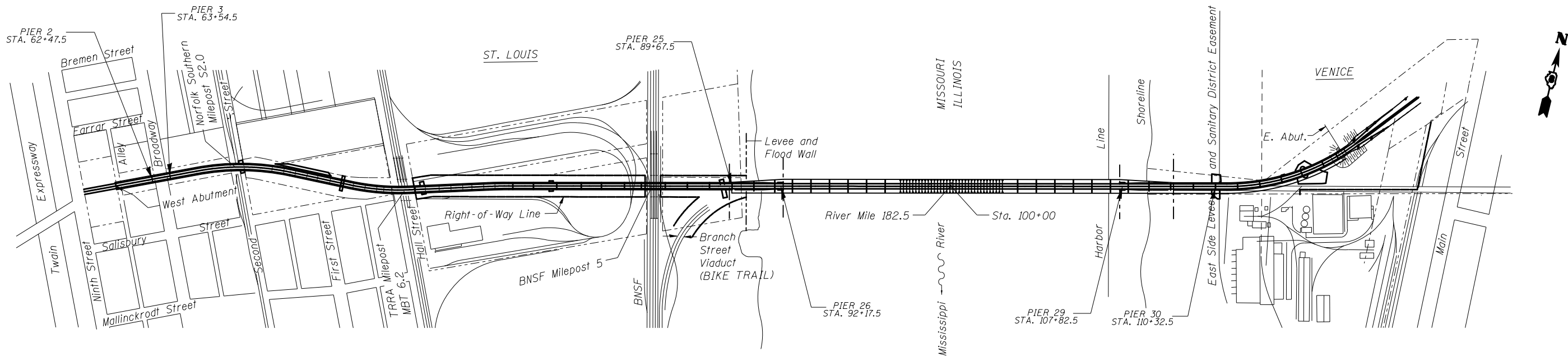

EXISTING PLAN

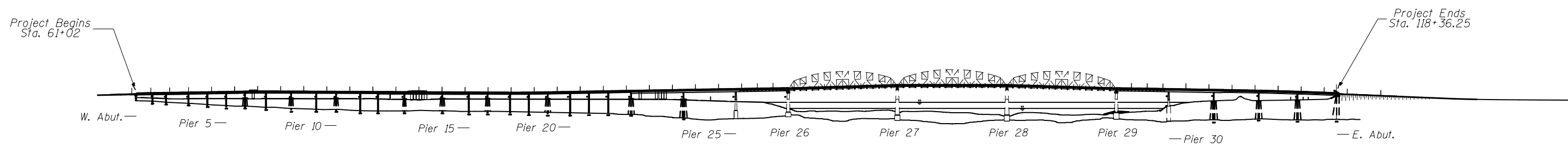

EXISTING ELEVATION

FILE NAME = *FILEL*	USER NAME = *USER*	DESIGNED -	REVISED -	STATE OF ILLINOIS DEPARTMENT OF TRANSPORTATION	EXISTING PLAN AND ELEVATION			F.A. RTE. 9105	SECTION 119B-1DS-1	COUNTY MADISON	TOTAL SHEETS 15	SHEET NO. 5
	PLOT SCALE = *SCALE*	DRAWN -	REVISED -		SCALE:	SHEET NO. 1 OF 1 SHEETS	STA.	TO STA.	CONTRACT NO. 76E74			
	PLOT DATE = *DATE*	CHECKED -	REVISED -		FED. ROAD DIST. NO. ILLINOIS FED. AID PROJECT							
		DATE -	REVISED -									

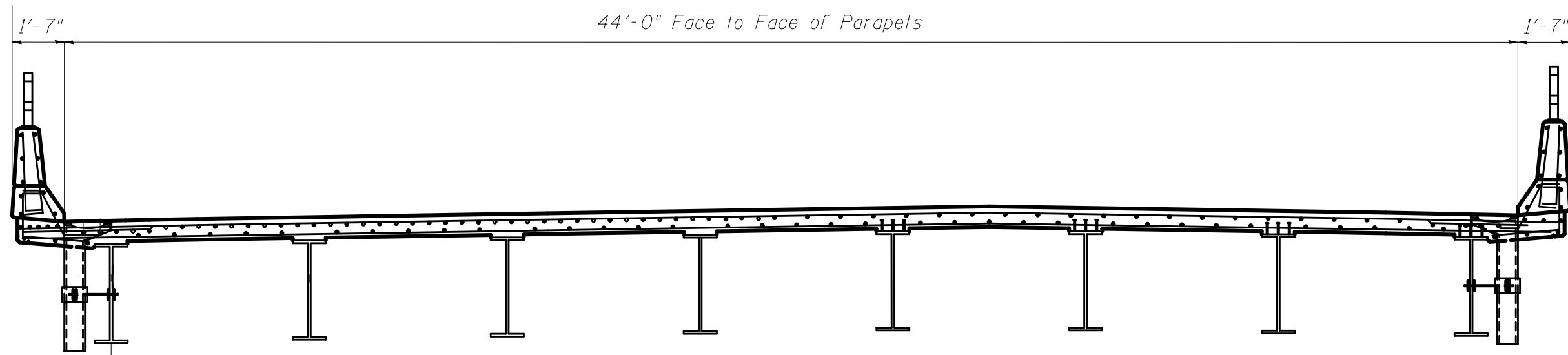

TYPICAL SECTION

STA. 61+02 TO 62+47.5
(NOT TO SCALE)

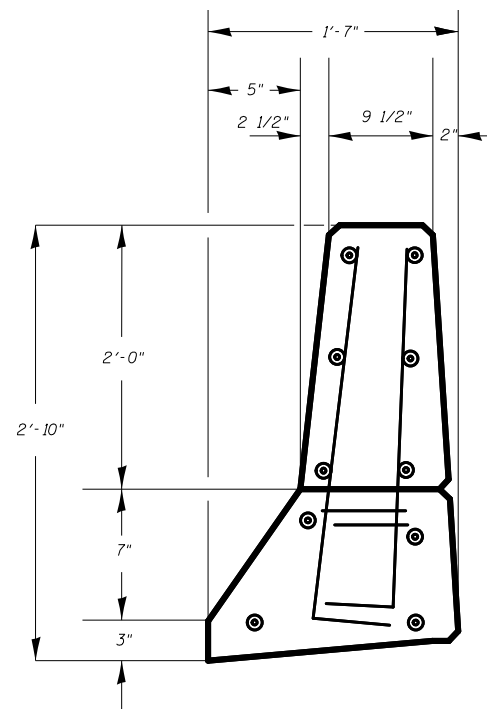

TYPICAL PARAPET SECTION

APPLY SEALER TO TRAFFIC FACE AND TOP OF PARAPET

FILE NAME = *FILEL*	USER NAME = *USER*	DESIGNED -	REVISED -	STATE OF ILLINOIS DEPARTMENT OF TRANSPORTATION	TYPICAL SECTION			F.A.U. RTE.	SECTION	COUNTY	TOTAL SHEETS	SHEET NO.	
		DRAWN -	REVISED -		SCALE:	SHEET NO. 1 OF 6 SHEETS	STA. 61+28	TO STA. 62+35	9105	119B-1DS-1	MADISON	15	6
		CHECKED -	REVISED -		CONTRACT NO. 76E74								
		DATE -	REVISED -		FED. ROAD DIST. NO. ILLINOIS FED. AID PROJECT								

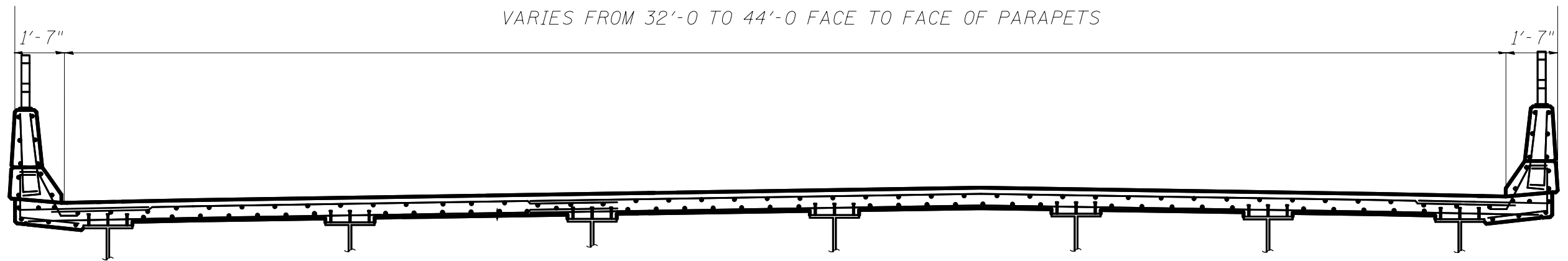

VARIES FROM 32'-0 TO 44'-0 FACE TO FACE OF PARAPETS

TYPICAL SECTION

STA. 62+47.5 TO 63+54.5

(NOT TO SCALE)

FILE NAME =	USER NAME = #USER#	DESIGNED -	REVISED -	STATE OF ILLINOIS DEPARTMENT OF TRANSPORTATION	TYPICAL SECTION			F.A.U. RTE.	SECTION	COUNTY	TOTAL SHEETS	SHEET NO.
#FILE#		DRAWN -	REVISED -		9105	119B-IDS-1	MADISON	15	7			
	PLOT SCALE = #SCALE#	CHECKED -	REVISED -		SCALE: SHEET NO. 2 OF 6 SHEETS STA. 62+47.5 TO STA. 63+54.5			CONTRACT NO. 76E74				
	PLOT DATE = #DATE#	DATE -	REVISED -		FED. ROAD DIST. NO. ILLINOIS FED. AID PROJECT							

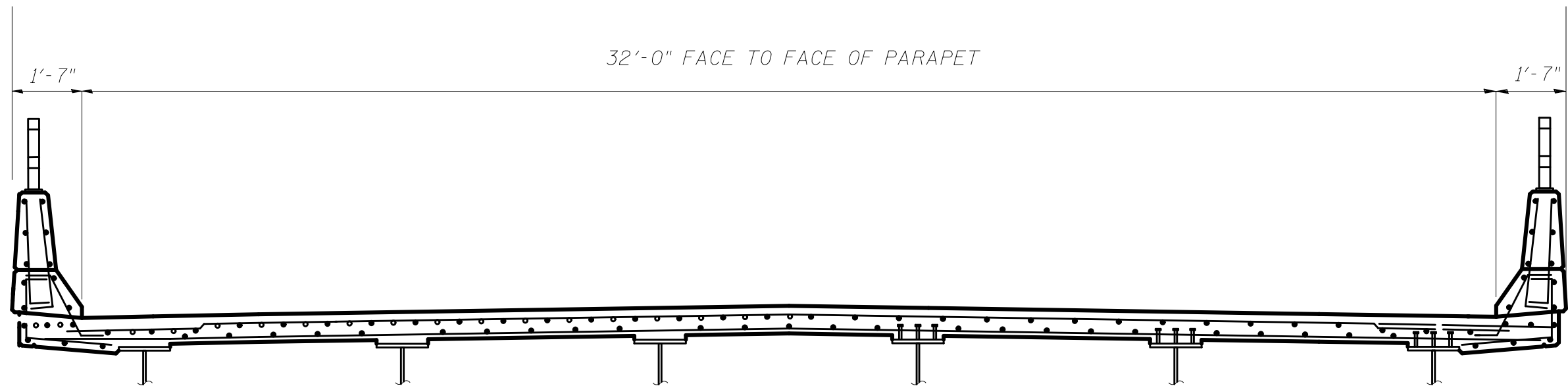

TYPICAL SECTION
 STA. 63+54.5 TO 89+67.5
 (NOT TO SCALE)

FILE NAME = *FILEL*	USER NAME = *USER*	DESIGNED -	REVISED -	STATE OF ILLINOIS DEPARTMENT OF TRANSPORTATION	TYPICAL SECTION			F.A.U RTE.	SECTION	COUNTY	TOTAL SHEETS	SHEET NO.
		DRAWN -	REVISED -		SCALE:	SHEET NO. 3 OF 6 SHEETS	STA. 63+54.5 TO STA. 89+67.5	9105	119B-IDS-1	MADISON	15	8
		CHECKED -	REVISED -					CONTRACT NO. 76E74				
		DATE -	REVISED -		FED. ROAD DIST. NO. ILLINOIS FED. AID PROJECT							

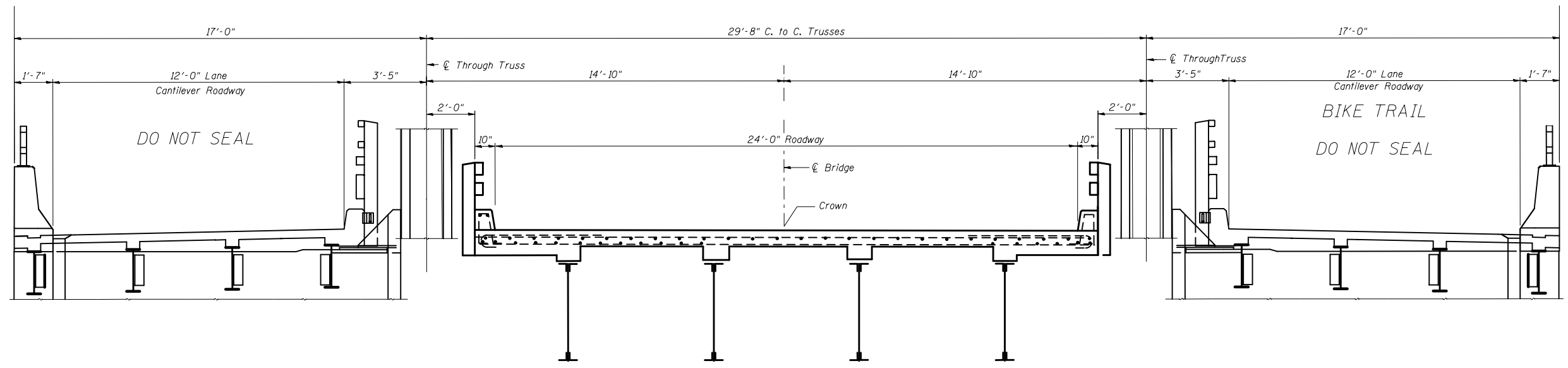

TYPICAL SECTION

STA. 92+17.5 TO STA. 107+82.5

(NOT TO SCALE)

NOTE: APPLY SEALER TO CURBS

FILE NAME =	USER NAME = #USER#	DESIGNED -	REVISED -	STATE OF ILLINOIS DEPARTMENT OF TRANSPORTATION	TYPICAL SECTION			F.A.U. RTE.	SECTION	COUNTY	TOTAL SHEETS	SHEET NO.
#FILE#		DRAWN -	REVISED -		9105	119B-IDS-1	MADISON	15	10	CONTRACT NO. 76E74		
	PLOT SCALE = #SCALE#	CHECKED -	REVISED -		SCALE:	SHEET NO. 5 OF 6 SHEETS	STA. 92+17.5 TO STA. 107+82.5	FED. ROAD DIST. NO.	ILLINOIS FED. AID PROJECT			
	PLOT DATE = #DATE#	DATE -	REVISED -									

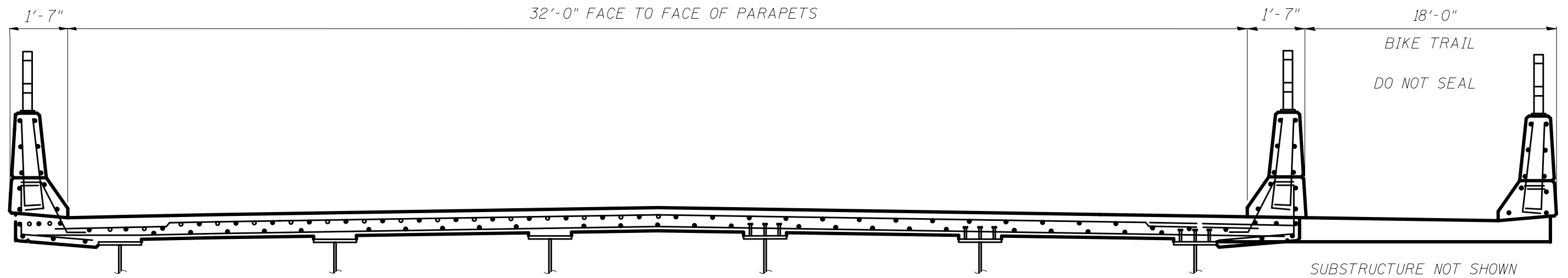

TYPICAL SECTION

STA. 110+32.5 TO STA. 118+36.25

(NOT TO SCALE)

FILE NAME = *FILEL*	USER NAME = *USER*	DESIGNED -	REVISED -	STATE OF ILLINOIS DEPARTMENT OF TRANSPORTATION	TYPICAL SECTION			F.A.U. RTE.	SECTION	COUNTY	TOTAL SHEETS	SHEET NO.
		DRAWN -	REVISED -		SCALE:	SHEET NO. 6 OF 6 SHEETS	STA. 110+32.5 TO STA. 118+36.25	9105	119B-IDS-1	MADISON	15	11
		CHECKED -	REVISED -					CONTRACT NO. 76E74				
		DATE -	REVISED -		FED. ROAD DIST. NO. ILLINOIS FED. AID PROJECT							



PROPOSED CHANGEABLE MESSAGE SIGN TO BE LOCATED ON EB I-70
1/2 MILE BEFORE EXIT 248A

CITY OF ST. LOUIS

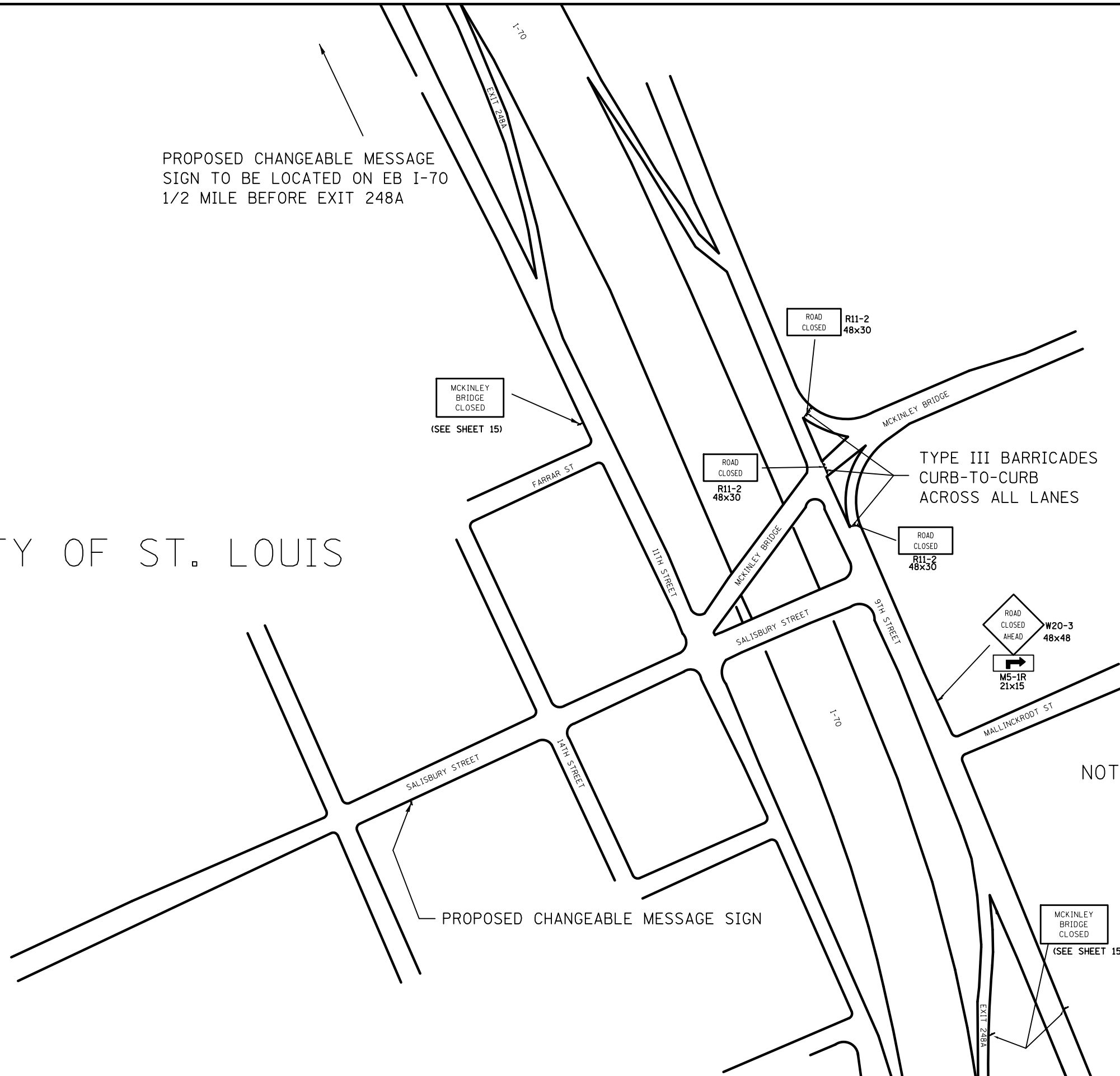

NOTE: ALL SIGN DIMENSIONS IN INCHES

PROPOSED CHANGEABLE MESSAGE SIGN TO BE LOCATED ON WB I-70
1/2 MILE BEFORE EXIT 248A

FILE NAME =	USER NAME = \$USER*	DESIGNED -	REVISED -	STATE OF ILLINOIS DEPARTMENT OF TRANSPORTATION	TRAFFIC CONTROL & PROTECTION, MISSOURI	F.A.U. RTE.	SECTION	COUNTY	TOTAL SHEETS	SHEET NO.	
FILEL		DRAWN -	REVISED -			9105	119B-1DS-1	MADISON	15	12	
MODELNAME		CHECKED -	REVISED -			CONTRACT NO. 76E74					
		DATE -	REVISED -			ILLINOIS FED. AID PROJECT					
					SCALE:	SHEET 1 OF 4 SHEETS		STA.	TO STA.		

TYPE III BARRICADES
CURB-TO-CURB ACROSS
ALL LANES AND MEDIAN

TO MCKINLEY BRIDGE

SUGGESTED CHANGEABLE
MESSAGE SIGN
2 WEEKS BEFORE CLOSURE

PANEL 1

MCKINLEY
BRIDGE
CLOSED

PANEL 2

A/B 9PM
TO
X/Y 5AM

NOTE: ALL SIGN DIMENSIONS IN INCHES

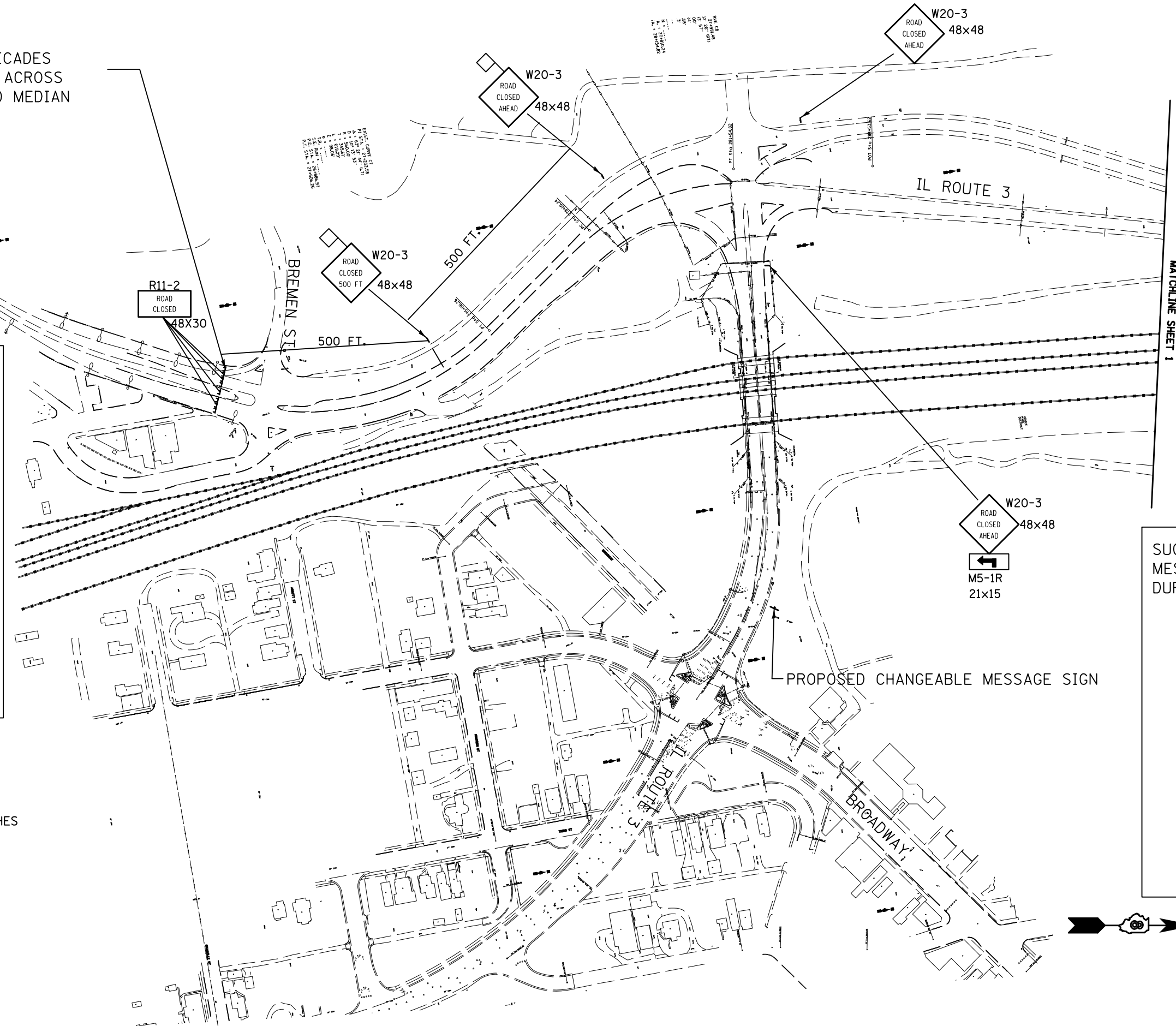

MATCHLINE SHEET 1

SUGGESTED CHANGEABLE
MESSAGE SIGN
DURING CLOSURE

PANEL 1

MCKINLEY
BRIDGE
CLOSED

PANEL 2

USE
ALT
ROUTE

PROPOSED CHANGEABLE MESSAGE SIGN

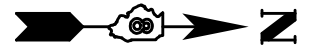

FILE NAME =	USER NAME = #USER#	DESIGNED -	REVISED -	STATE OF ILLINOIS DEPARTMENT OF TRANSPORTATION	TRAFFIC CONTROL & PROTECTION, ILLINOIS		F.A. RTE.	SECTION	COUNTY	TOTAL SHEETS	SHEET NO.	
#FILE#		DRAWN -	REVISED -		SCALE:	SHEET NO. 2 OF 4 SHEETS	STA.	9105	119B-1D5-1	MADISON	15	13
		CHECKED -	REVISED -				TO STA.	CONTRACT NO. 76E74				
		DATE -	REVISED -					FED. ROAD DIST. NO. ILLINOIS FED. AID PROJECT				

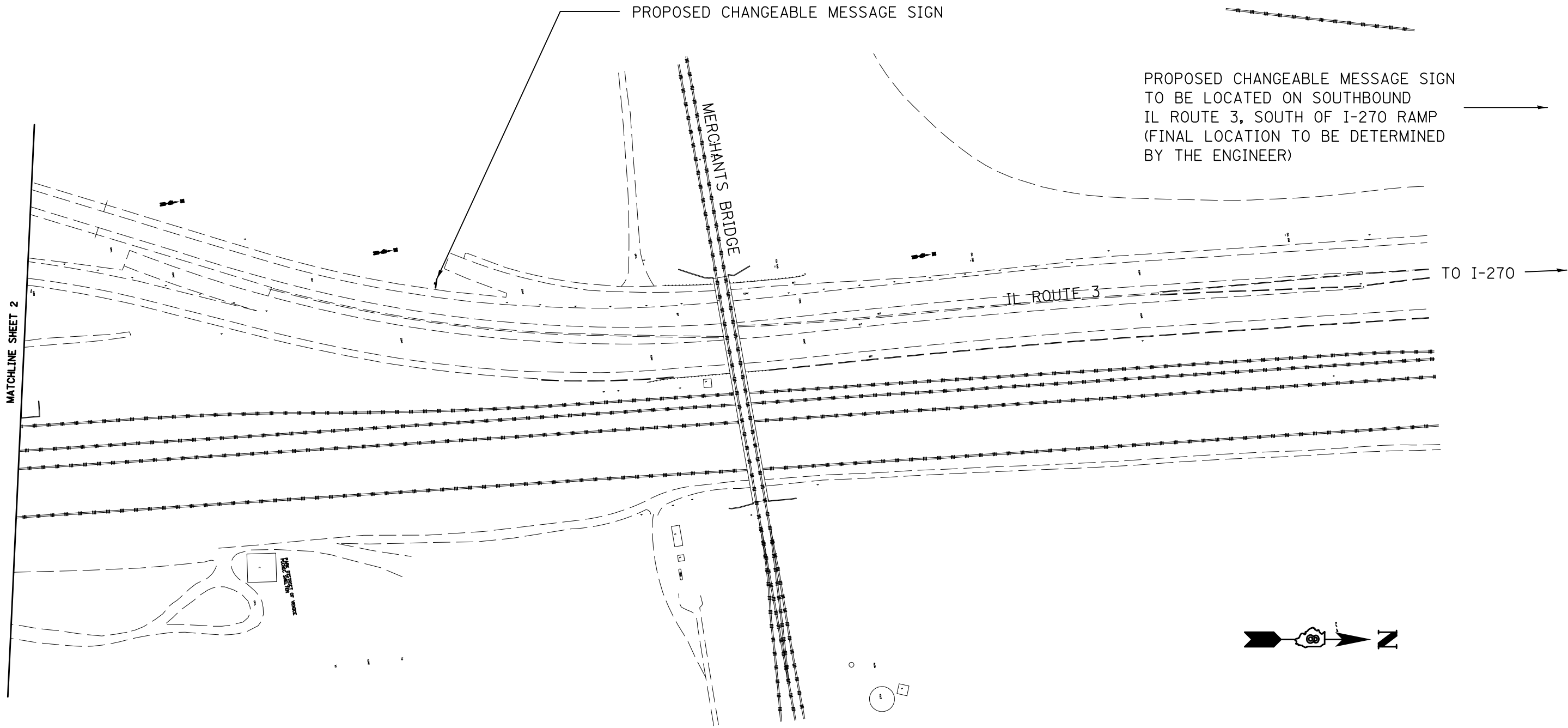

FILE NAME = *FILEL*	USER NAME = *USER*	DESIGNED -	REVISED -
		DRAWN -	REVISED -
	PLOT SCALE = *SCALE*	CHECKED -	REVISED -
	PLOT DATE = *DATE*	DATE -	REVISED -

**STATE OF ILLINOIS
DEPARTMENT OF TRANSPORTATION**

TRAFFIC CONTROL & PROTECTION, ILLINOIS

SCALE: SHEET NO. 3 OF 4 SHEETS STA. TO STA.

F.A. RTE.	SECTION	COUNTY	TOTAL SHEETS	SHEET NO.
9105	119B-1DS-1	MADISON	15	14
CONTRACT NO. 76E74				
FED. ROAD DIST. NO.		ILLINOIS FED. AID PROJECT		

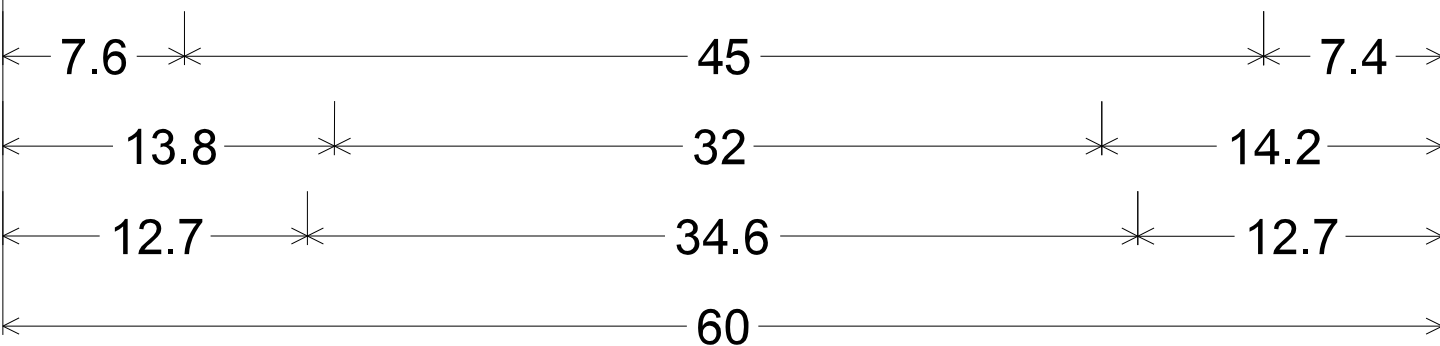
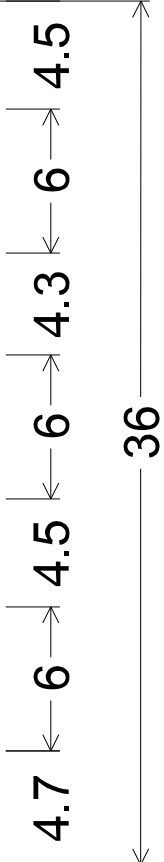

2.3" Radius, 0.9" Border, 0.6" Indent, Black on Orange;
 [MCKINLEY] E; [BRIDGE] E; [CLOSED] E;

FILE NAME = *FILEL*	USER NAME = *USER*	DESIGNED -	REVISED -	STATE OF ILLINOIS DEPARTMENT OF TRANSPORTATION	McKINLEY BRIDGE CLOSED SIGN DETAIL			F.A.U. RTE.	SECTION	COUNTY	TOTAL SHEETS	SHEET NO.	
		DRAWN -	REVISED -		SCALE:	SHEET NO. 4 OF 4 SHEETS	STA.	TO STA.	9105	119B-1DS-1	MADISON	15	15
		PLOT SCALE = *SCALE*	REVISED -		CONTRACT NO. 76E74								
		PLOT DATE = *DATE*	REVISED -		FED. ROAD DIST. NO. ILLINOIS FED. AID PROJECT								