

STATE OF ILLINOIS
DEPARTMENT OF TRANSPORTATION

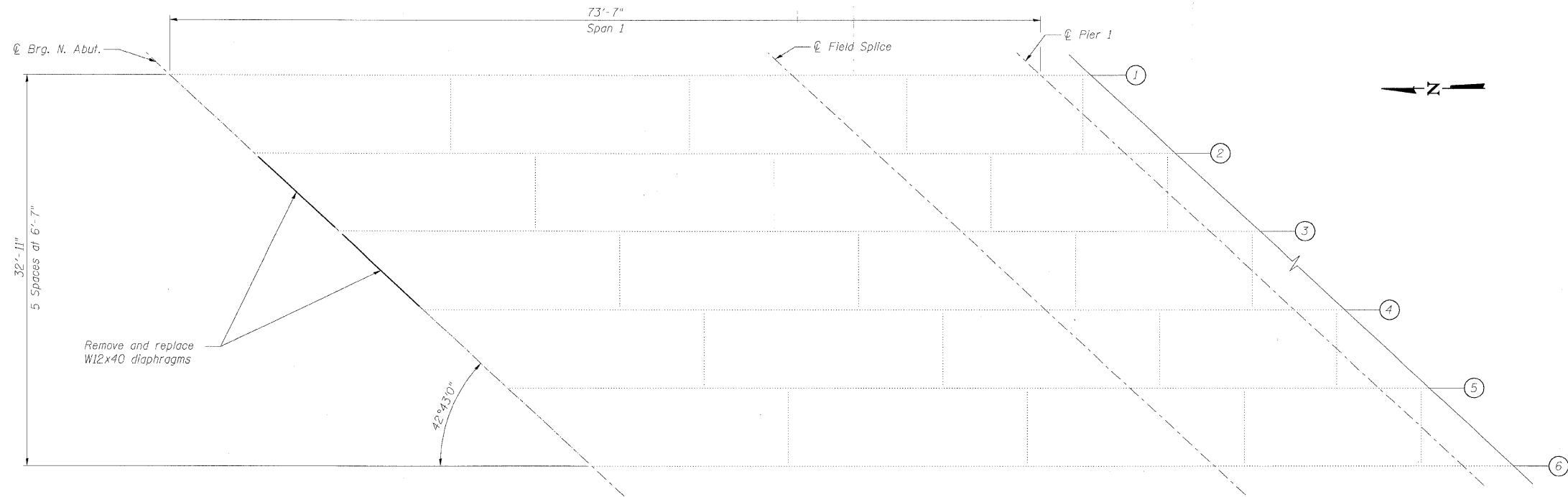

EXISTING STRUCTURAL STEEL PLAN

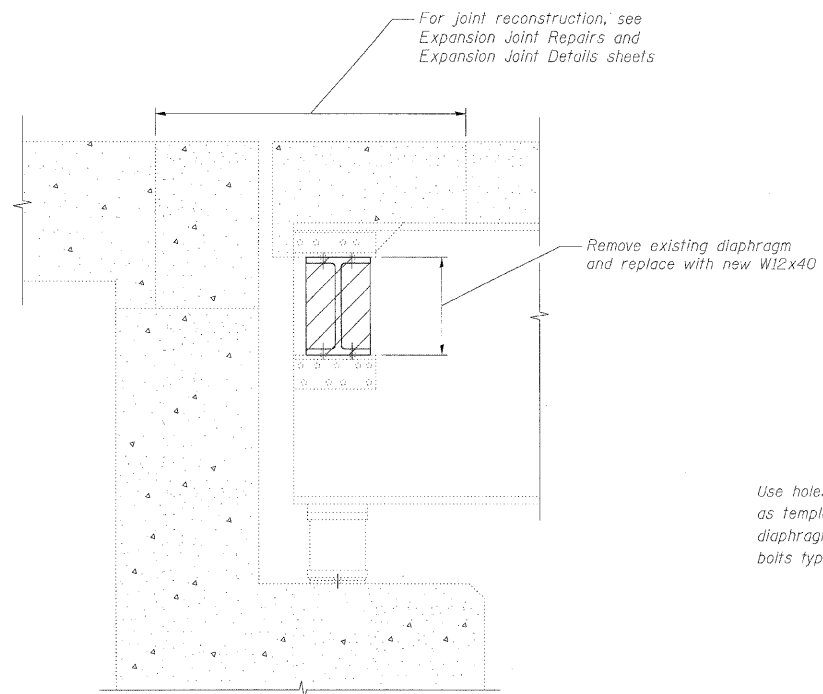

SECTION
AT NORTH ABUTMENT

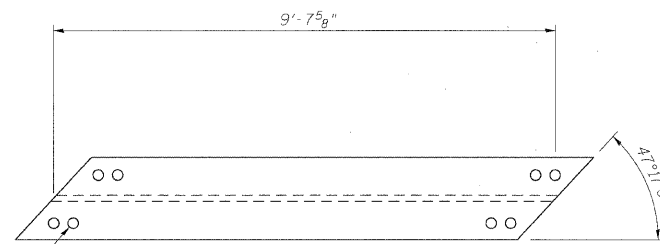

DIAPHRAGM PLAN

Use holes on existing clip angles as template to drill holes in new diaphragm, $\frac{3}{4}$ " ϕ High strength bolts typ.

BILL OF MATERIAL

ITEM	UNIT	TOTAL
Structural Steel Repair	Pound	///

Notes:

- Cost of removal and re-installation of all members necessary to complete the work as detailed on the plans and as specified in the Special Provisions shall be included with Structural Steel Repair.
- Existing structural steel that will be in contact with new structural steel shall be cleaned and painted prior to erection as required by the Special Provision "Cleaning and Painting Contact Surface Areas of Existing Steel Structures".
- Diaphragm connection holes shall be $\frac{15}{16}$ " ϕ for $\frac{3}{4}$ " ϕ bolts. Two hardened washers shall be required at diaphragm connections.
- Work this sheet with Existing Steel Details sheet.

DESIGNED -	TJJ
CHECKED -	AAY
DRAWN -	TJJ
CHECKED -	AAY

STEEL REPAIR DETAILS
STRUCTURE NO. 016-1131

benesch

alfred benesch & company
Engineers • Surveyors • Planners
205 North Michigan Avenue, Suite 2400
Chicago, Illinois 60601
312.565.0450 Job No. 10050

SHEET NO. 8 10 SHEETS	F.A.I. RTE.	SECTION	COUNTY	TOTAL SHEETS	SHEET NO.
	290	2009-099 BR	COOK/DUPAGE	309	188
			CONTRACT NO. 60157		
FED. ROAD DIST. NO.		ILLINOIS	FED. AID PROJECT		