

STATE OF ILLINOIS
DEPARTMENT OF TRANSPORTATION

F.A.P. RTE.	SECTION	COUNTY	TOTAL SHEETS	SHEET NO.
326	FAP 0326 23 RES	KANE	25	1
ILLINOIS			CONTRACT NO. 62V43	

* 25 + 3 = 28 TOTAL SHEETS

FOR INDEX OF SHEETS, SEE SHEET NO.

THE PROJECT IS LOCATED IN THE VILLAGE
HUNTLEY

TRAFFIC DATA

IL RTE. 47 : 2023 ADT = 27400
POSTED SPEED LIMIT = 45 MPH

PROJECT ENDS
STA. 97+65

PROJECT BEGINS
STA. 24+97

PROPOSED HIGHWAY PLANS

F.A.P ROUTE 326: IL 47
KREUTZER RD. TO N OF JIM DHAMER DR.
SECTION: FAP 0326 23 RES
PROJECT: NHPP-MJXS(975)
STANDARD OVERLAY & ADA IMPROVEMENTS
KANE COUNTY

C-91-023-24

R 7 E

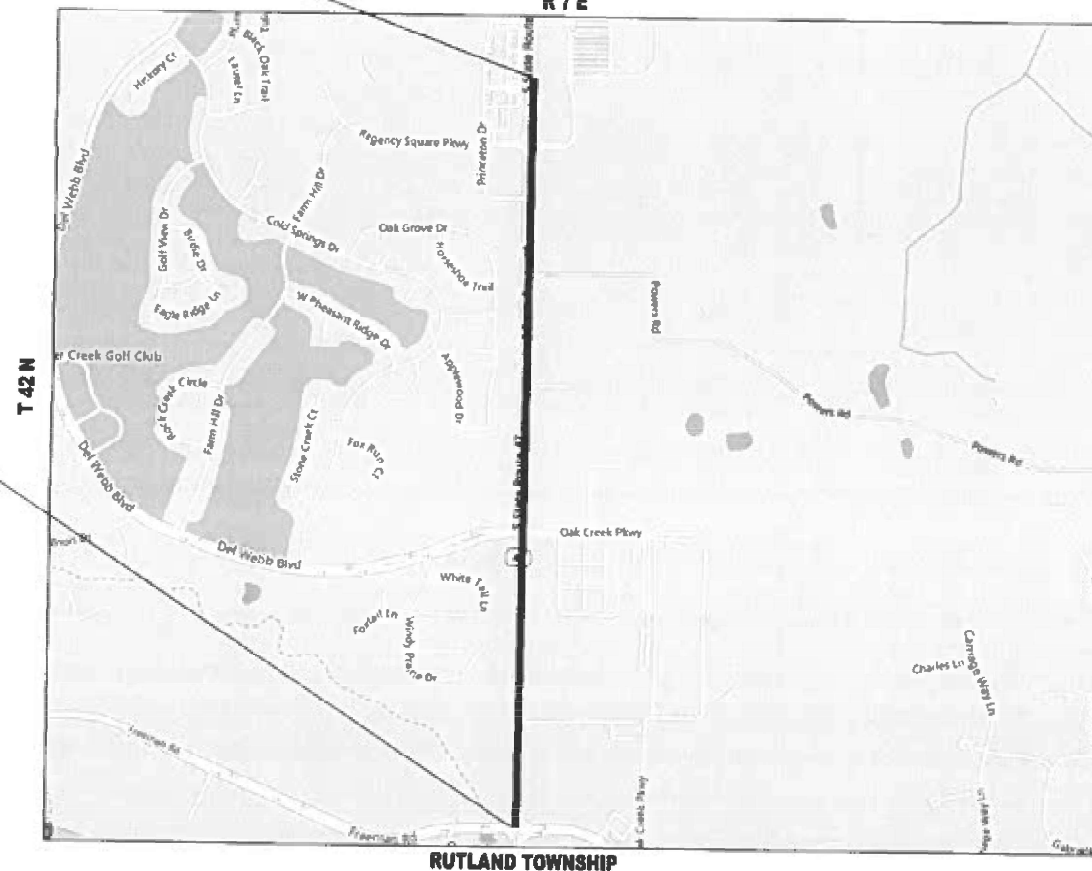

RUTLAND TOWNSHIP

GROSS LENGTH = 7264 FT. = 1.37 MILE

NET LENGTH = 7264 FT. = 1.37 MILE

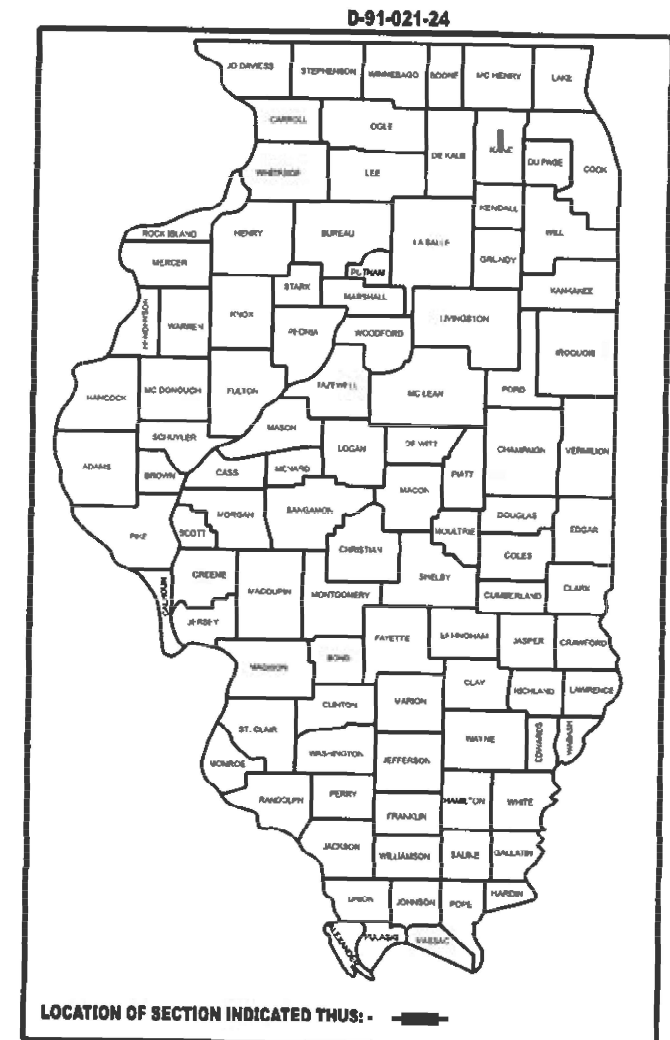

STATE OF ILLINOIS
DEPARTMENT OF TRANSPORTATION

SUBMITTED Nov 25th 2025
Jorge Flores REGIONAL ENGINEER

January 23, 2026
Scott A. Etkin ENGINEER OF DESIGN AND ENVIRONMENT

January 23, 2026
Chad Perry DIRECTOR OF HIGHWAYS PROJECT IMPLEMENTATION

**PRINTED BY THE AUTHORITY
OF THE STATE OF ILLINOIS**

INDEX OF SHEETS

SHEET NO.	DESCRIPTION
1	TITLE SHEET
2	INDEX OF SHEETS, HIGHWAY STANDARDS & GENERAL NOTES
3 - 4	SUMMARY OF QUANTITIES
5 - 5A	TYPICAL SECTIONS
6 - 8	ROADWAY PLANS
9 - 12	DETECTOR LOOP REPLACEMENT PLANS
13	DETAILS FOR FRAMES AND LIDS ADJUSTMENT WITH MILLING (BD-8)
14	PAVEMENT PATCHING FOR HMA SURFACED PAVEMENT (BD-22)
15	CURB OR CURB AND GUTTER REMOVAL AND REPLACEMENT (BD-24)
16	BUTT JOINT AND HMA TAPER DETAILS (BD-32)
17	HMA TAPER AT EDGE OFF PCC PAVEMENT (BD-33)
18	TRAFFIC CONTROL AND PROTECTION FOR SIDE ROADS, INTERSECTIONS, AND DRIVEWAYS (TC-10)
19	TYPICAL APPLICATIONS RAISED REFLECTIVE PAVEMENT MARKERS (SNOW-PLOW RESISTANT) (TC-11)
20	DISTRICT ONE TYPICAL PAVEMENT MARKINGS (TC-13)
21	TRAFFIC CONTROL AND PROTECTION AT TURN BAYS (TO REMAIN OPEN TO TRAFFIC) (TC-14)
22	SHORT TERM PAVEMENT MARKING LETTERS AND SYMBOLS (TC-16)
23	ARTERIAL ROAD INFORMATION SIGN (TC-22)
24	DRIVEWAY ENTRANCE SIGNING (TC-26)
25	DISTRICT 1 DETECTOR LOOP INSTALLATION DETAILS FOR ROADWAY RESURFACING (TS-07)

STATE STANDARDS

STANDARD NO.	DESCRIPTION
000001-09	STANDARD SYMBOLS, ABBREVIATIONS, AND PATTERNS
604001-05	FRAME AND LIDS, TYPE 1
604091-05	FRAME AND GRATE, TYPE 24
606001-09	COMBINATION CONCRETE CURB AND GUTTER
642006-01	SHOULDER RUMBLE STRIPS, 8 IN
701006-05	OFF-ROAD OPERATIONS, 2L , 2W, 15' (4.5 m) to 24" (600 mm) FROM PAVEMENT EDGE
701011-04	OFF-ROAD MOVING OPERATIONS, 2L, 2W, DAY ONLY
701101-05	OFF-ROAD OPERATIONS, MULTILANE, 15' (4.5 m) to 24" (600 mm) FROM PAVEMENT EDGE
701106-02	OFF-ROAD OPERATIONS, MULTILANE, MORE THEN 15' AWAY
701301-04	LANE CLOSURE, 2L, 2W, SHORT TIME OPERATIONS
701311-03	LANE CLOSURE, 2L, 2W, SLOW MOVING OPERATIONS DAY ONLY
701421-08	LANE CLOSURE, MULTILANE, DAY OPERATIONS ONLY, FOR SPEEDS > 45 MPH TO 55 MPH
701422-10	LANE CLOSURE, MULTILANE, FOR SPEEDS ≥ 45 MPH TO 55 MPH
701426-09	LANE CLOSURE, MULTILANE, INTERMITTENT OR MOVING OPERATIONS FOR SPEED ≥ 45 MPH
701501-06	URBAN LANE CLOSURE, 2L, 2W, UNDIVIDED
701601-09	URBAN LANE CLOSURE, MULTILANE, 1W OR 2W WITH NONTRAVERSABLE MEDIAN
701701-10	URBAN LANE CLOSURE, MULTILANE INTERSECTION
701801-06	SIDEWALK, CORNER OR CROSSWALK CLOSURE
701901-11	TRAFFIC CONTROL DEVICES

GENERAL NOTES

- BEFORE STARTING ANY EXCAVATION, THE CONTRACTOR SHALL CALL "JULIE AT (800) 892-0123 OR 811 FOR FIELD LOCATIONS OF BURIED ELECTRIC, TELEPHONE AND GAS FACILITIES, (48 HOURS NOTIFICATION IS REQUIRED). THE CONTRACTOR SHALL COORDINATE CONSTRUCTION ACTIVITIES WITH UTILITY COMPANIES & VILLAGE OF HUNTLEY.
- THE CONTRACTOR WILL NOT BE ALLOWED TO SET UP A YARD OR FIELD OFFICE ON STATE PROPERTY WITHOUT WRITTEN PERMISSION FROM THE DEPARTMENT.
- TEN (10) FOOT TRANSITIONS SHALL BE USED TO MATCH PROPOSED CURB AND GUTTER AND MEDIAN ITEMS OF WORK TO EXISTING CURBS AND GUTTER AND MEDIANS IN THE FIELD UNLESS OTHERWISE SHOWN. THE TRANSITIONS SHALL BE PAID FOR AT THE CONTRACT UNIT PRICE FOR THE PROPOSED ITEMS OF WORK SPECIFIED.
- BEFORE BEGINNING ANY WORK, THE CONTRACTOR SHALL RETAIN AND RECORD FOR FUTURE REFERENCE, ALL EXISTING PAVEMENT MARKING LINES (AND RAISED REFLECTIVE PAVEMENT MARKERS) IN ORDER THAT THESE LOCATIONS CAN BE RE-ESTABLISHED FOR STRIPING. EXACT LOCATIONS OF ALL PAVEMENT MARKINGS SHALL BE AS DIRECTED BY THE ENGINEER.
- BUTT JOINTS WILL BE INSTALLED AT THE ENDS OF ALL RESURFACING (WHERE RESURFACING MEETS EXISTING PAVEMENT) ACCORDING TO THE "BUTT JOINT AND HOT-MIX ASPHALT TAPER DETAILS" SHEET INCLUDED IN THE PLANS, UNLESS OTHERWISE SPECIFIED.
- THE RESIDENT ENGINEER SHALL CONTACT FADI SULTAN AREA TRAFFIC FIELD ENGINEER, AT FADI.SULTAN@ILLINOIS.GOV, A MINIMUM OF TWO (2) WEEKS PRIOR TO THE PLACEMENT OF PERMANENT PAVEMENT MARKINGS.
- ALL PAVEMENT PATCHING LOCATIONS WILL BE DETERMINED IN THE FIELD BY THE ENGINEER.
- FRAMES AND GRATES ADJUSTMENT OF PRIVATE UTILITIES WITHIN THE PROJECT LIMITS SHALL BE DONE BY THEIR RESPECTIVE OWNERS AND ARE NOT PART OF THIS CONTRACT.
- THE CONTRACTOR SHALL CONTACT KALPANA KANNAN-HOSADURGA THE DISTRICT TRAFFIC CONTROL SUPERVISOR AT KALPANA.KANNAN-HOSADURGA@ILLINOIS.GOV A MINIMUM OF 72 HOURS IN ADVANCE OF BEGINNING WORK.
- OVERNIGHT LANE CLOSURE SHALL NOT BE ALLOWED FOR REHABILITATION INVOLVING DAYTIME MILLING AND RESURFACING OPERATIONS AND CLASS D PATCHING UNLESS OTHER CONDITIONS WARRANT EXTENDED LANE CLOSURES AS DETERMINED AND APPROVED IN WRITING BY THE ENGINEER OR AS PROVIDED FOR IN THE CONTRACT SPECIFICATIONS.
- IT SHALL BE THE CONTRACTOR'S RESPONSIBILITY TO VERIFY ALL DIMENSIONS AND CONDITIONS EXISTING IN THE FIELD PRIOR TO ORDERING MATERIALS AND BEGINNING CONSTRUCTION.
- LOCATION OF COMBINATION CONCRETE CURB AND GUTTER REMOVAL AND REPLACEMENT WILL BE DETERMINED IN THE FIELD BY THE ENGINEER.
- DOUBLE LANE MARKERS ARE TO BE USED AS SHOWN ON THE DISTRICT ONE DETAIL TYPICAL APPLICATION RAISED REFLECTION PAVEMENT MARKERS (SNOW-PLOW RESISTANT) SHOWN
- PAVEMENT MARKING TAPE, TYPE IV SHALL BE USED FOR SHORT TERM PAVEMENT MARKINGS ON ALL FINAL SURFACES. IN THE PLANS.
- DRAINAGE ADJUSTMENT OR RECONSTRUCTION LOCATIONS WILL BE DETERMINED IN THE FIELD BY THE ENGINEER.
- EXISTING BROKEN FRAMES AND LIDS SHALL BE REMOVED AND DISPOSED OF BY THE CONTRACTOR AND SHALL BE REPLACED AS DIRECTED BY THE ENGINEER. REPLACEMENT FRAMES AND LIDS WILL BE PAID FOR ACCORDING TO ARTICLE 109.04 OF STANDARD SPECIFICATION UNLESS A SEPARATE PAY ITEM HAS BEEN PROVIDED.
- TEMPORARY PAVEMENT MARKINGS OR SHORT TERM PAVEMENT MARKINGS ON INTERMEDIATE SURFACES SHALL NOT BE REMOVED, UNLESS DIRECTED BY THE ENGINEER.
- ALL MILLED SURFACES SHALL BE A UNIFORM CROSS SLOPE PER LANE AND FREE OF RIDGES BETWEEN PASSES. ANY DEVIATIONS SHALL BE CORRECTED AT NO COST TO THE DEPARTMENT.

MODEL: GenNotesShr01 [Sheet]
FILE NAME: c:\pw_workspace\lathabaw\1006660\102124-shr-gennote.dgn

	USER NAME = Addis.Abebaw	DESIGNED -	REVISED - REV. 12/16/25 A.A	STATE OF ILLINOIS DEPARTMENT OF TRANSPORTATION	IL 47 FROM N. OF PRINCETON DR. TO N OF JIM DHAMER DR. INDEX OF SHEETS, STATE STANDARDS AND GENERAL NOTES	SCALE:	SHEET	OF	SHEETS	STA.	TO STA.	F A P RTE	SECTION	COUNTY	TOTAL SHEETS	SHEET NO.
		DRAWN -	REVISED -									326	FAP 0326 23 RES	KANE	25	2
	PLOT SCALE = \$\$CALE\$	CHECKED -	REVISED -									CONTRACT NO. 62V43				
	PLOT DATE = 12/2/2025	DATE -	REVISED -									ILLINOIS FED. AID PROJECT				

MODEL: SOQ_1 [Sheet]
FILE NAME: c:\pwwork\addis\abebaw\c1006686\102124-sh1-SOQ.dgn

SUMMARY OF QUANTITIES					TYPE CODE					
					URBAN	URBAN	URBAN	URBAN	URBAN	URBAN
					ROADWAY					
					80% FED 20% STATE	100% STATE				
	Code No.	Item	Unit	Total Quantity	0005	0005				
	40600290	BITUMINOUS MATERIALS (TACK COAT)	POUND	52600	52600					
	21101615	TOP SOIL FURNISH AND PLACE, 4"	SQ YD	280	280					
	40600370	LONGITUDINAL JOINT SEALANT	FOOT	24560	24560					
	25200110	SODDING, SALT TOLERANT	SQ YD	280	280					
	40600400	MIXTURE FOR CRACKS, JOINTS, AND FLANGEWAYS	TON	178	178					
	25200200	SUPPLEMENT WATERING	UNIT	3	3					
	40600982	HOT-MIX ASPHALT SURFACE REMOVAL - BUTT JOINT	SQ YD	119	119					
	40600985	PORTLAND CEMENT CONCRETE SURFACE REMOVAL - BUTT JOINT	SQ YD	830	830					
	40603200	POLYMERIZED HOT-MIX ASPHALT BINDER COURSE, IL-4.75, N50	TON	4286	4286					
	40604172	POLYMERIZED HOT-MIX ASPHALT SURFACE COURSE, IL-9.5, MIX "E", N70	TON	7637	7637					
	42001300	PROTECTIVE COAT	SQ YD	280	280					
	44000160	HOT-MIX ASPHALT SURFACE REMOVAL, 2 3/4"	SQ YD	39764	39764					
	44003510	MEDIAN REMOVAL PARTIAL DEPTH	SQ FT	2416	2416					
	44201765	CLASS D PATCHES, TYPE II, 10 INCH	SQ YD	2228	2228					
	44201769	CLASS D PATCHES, TYPE III, 10 INCH	SQ YD	1599	1599					
	44201771	CLASS D PATCHES, TYPE IV, 10 INCH	SQ YD	1260	1260					
	48101200	AGGREGATE SHOULDERS, TYPE B	TON	298	298					
	60300105	FRAMES AND GRATES TO BE ADJUSTED	EACH	30	30					
	60404950	FRAMES AND GRATES, TYPE 24	EACH	5	5					
	60406100	FRAMES AND LIDS, TYPE 1, CLOSED LID	EACH	10	10					
	64200108	SHOULDER RUMBLE STRIPS, 8 INCH	FOOT	11606	11606					
	67100100	MOBILIZATION	L SUM	1	1					
	70100310	TRAFFIC CONTROL AND PROTECTION, STANDARD 701421	L SUM	1	1					
	70100320	TRAFFIC CONTROL AND PROTECTION, STANDARD 701422	L SUM	1	1					
	70102620	TRAFFIC CONTROL AND PROTECTION, STANDARD 701501	L SUM	1	1					
	70102630	TRAFFIC CONTROL AND PROTECTION, STANDARD 701601	L SUM	1	1					
	70102635	TRAFFIC CONTROL AND PROTECTION, STANDARD 701701	L SUM	1	1					

* SPECIALTY ITEM

SUMMARY OF QUANTITIES					TYPE CODE					
					URBAN	URBAN	URBAN	URBAN	URBAN	URBAN
					ROADWAY					
					80% FED 20% STATE	100% STATE				
	Code No.	Item	Unit	Total Quantity	0005	0005				
	70102640	TRAFFIC CONTROL AND PROTECTION, STANDARD 701801	L SUM	1	1					
	70300100	SHORT TERM PAVEMENT MARKING	FOOT	21228	21228					
	70300150	SHORT TERM PAVEMENT MARKING REMOVAL	SQ FT	6188	6188					
	70300211	TEMPORARY PAVEMENT MARKING LETTERS AND SYMBOLS - PAINT	SQ FT	1464	1464					
	70300221	TEMPORARY PAVEMENT MARKING - LINE 4"- PAINT	FOOT	41340	41340					
	70300241	TEMPORARY PAVEMENT MARKING - LINE 6"- PAINT	FOOT	10634	10634					
	70300251	TEMPORARY PAVEMENT MARKING - LINE 8"- PAINT	FOOT	2692	2692					
	70300261	TEMPORARY PAVEMENT MARKING - LINE 12"- PAINT	FOOT	3808	3808					
	70300281	TEMPORARY PAVEMENT MARKING - LINE 24"- PAINT	FOOT	1240	1240					
	70307120	TEMPORARY PAVEMENT MARKING - LINE 4" - TYPE IV TAPE	FOOT	10557	10557					
*	78000100	THERMOPLASTIC PAVEMENT MARKING - LETTERS AND SYMBOLS	SQ FT	732	732					
*	78000200	THERMOPLASTIC PAVEMENT MARKING - LINE 4"	FOOT	20670	20670					
*	78000400	THERMOPLASTIC PAVEMENT MARKING - LINE 6"	FOOT	5317	5317					
*	78000500	THERMOPLASTIC PAVEMENT MARKING - LINE 8"	FOOT	1346	1346					
*	78000600	THERMOPLASTIC PAVEMENT MARKING - LINE 12"	FOOT	2774	2774					
*	78000650	THERMOPLASTIC PAVEMENT MARKING - LINE 24"	FOOT	620	620					
*	78100100	RAISED REFLECTIVE PAVEMENT MARKER	EACH	674	674					
	78300200	RAISED REFLECTIVE PAVEMENT MARKER REMOVAL	EACH	655	655					
	78300202	PAVEMENT MARKING REMOVAL - WATER BLASTING	SQ FT	13474	13474					
*	81028200	UNDERGROUND CONDUIT, GALVANIZED STEEL, 2" DIA.	FOOT	255	255					
*	81400200	HEAVY-DUTY HANDHOLE	EACH	3	3					
	87301305	ELECTRIC CABLE IN CONDUIT, LEAD-IN, NO, 14 PAIR	FOOT	489	489					

	USER NAME = Addis.Abebaw		DESIGNED -	REVISED -	STATE OF ILLINOIS DEPARTMENT OF TRANSPORTATION	SUMMARY OF QUANTITIES			FAP RTE	SECTION	COUNTY	TOTAL SHEETS	SHEET NO.
			DRAWN -	REVISED -					326	FAP 0326 23 RES	KANE	25	3
			CHECKED -	REVISED -					CONTRACT NO. 60V43				
	PLOT DATE = 11/19/2025		DATE -	REVISED -		SCALE:	SHEET SOQ 1 OF	SHEETS	STA.	TO STA.	ILLINOIS FED. AID PROJECT		

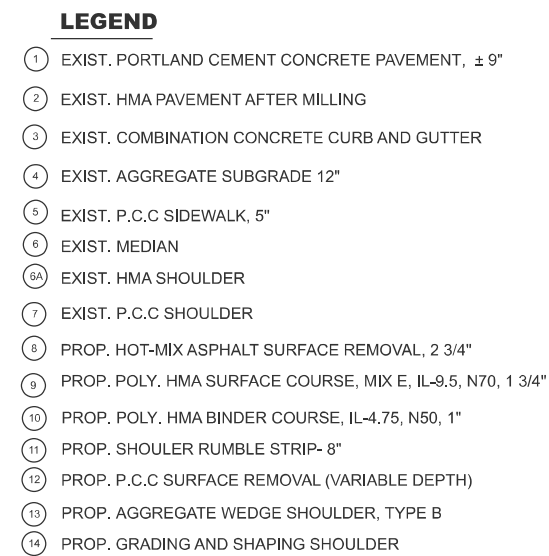

60' MIN. & VARIES

60' MIN. & VARIES

48' & VARIES

48' & VARIES

SOUTH BOUND CONCRETE

NORTH BOUND HMA

12' & VAR.

12' & VAR.

12' & VAR.

6' SHLD. & VAR.

MEDIAN

6' SHLD. & VAR.

12' & VAR.

12' & VAR.

12' & VAR.

± 2 3/4"

MATCH EXIST

MATCH EXIST

EXIST. ROW

EXIST. ROW

5

3

9

10

1

4

3

6

7

11

10

11

9

1

2

10

9

3

5

MIXTURE REQUIREMENTS		QUALITY MANAGEMENT PROGRAM (QMP)
MIXTURE USES	VOIDS @ Ndes	
PAVEMENT RESURFACING		
POLY. HOT-MIX ASPHALT SURFACE COURSE, MIX "E", N70 (IL 9.5 mm), 1 3/4"	4% AT 70 GYR.	QCP
POLY. HOT-MIX ASPHALT BINDER COURSE, IL-4.75, N50, 1"	3.5% AT 50 GYR.	QC/QA
PATCHING		
CLASS D PATCHES (HMA BINDER, IL-19.0)	4% AT 70 GYR.	QC/QA
HOT-MIX REPLACEMENT OVER PATCHES (HMA BINDER, IL-19.0)	4% AT 70 GYR.	QC/QA
QMP Designation: Quality Control/Quality Assurance (QC/QA); Quality Control for Performance (QCP)		

THE CONTRACTOR SHALL MILL FIRST THEN PATCH

NOTE:
THE LONGITUDINAL JOINT SEALANT SHALL BE PLACED OVER
- POLY HMA BINDER COURSE IL-4.75, N50

MODEL: TYPICAL 5A [Sheet]
FILE NAME: c:\paw\work\labebawa\1006686D\102124-sh-typical.dgn

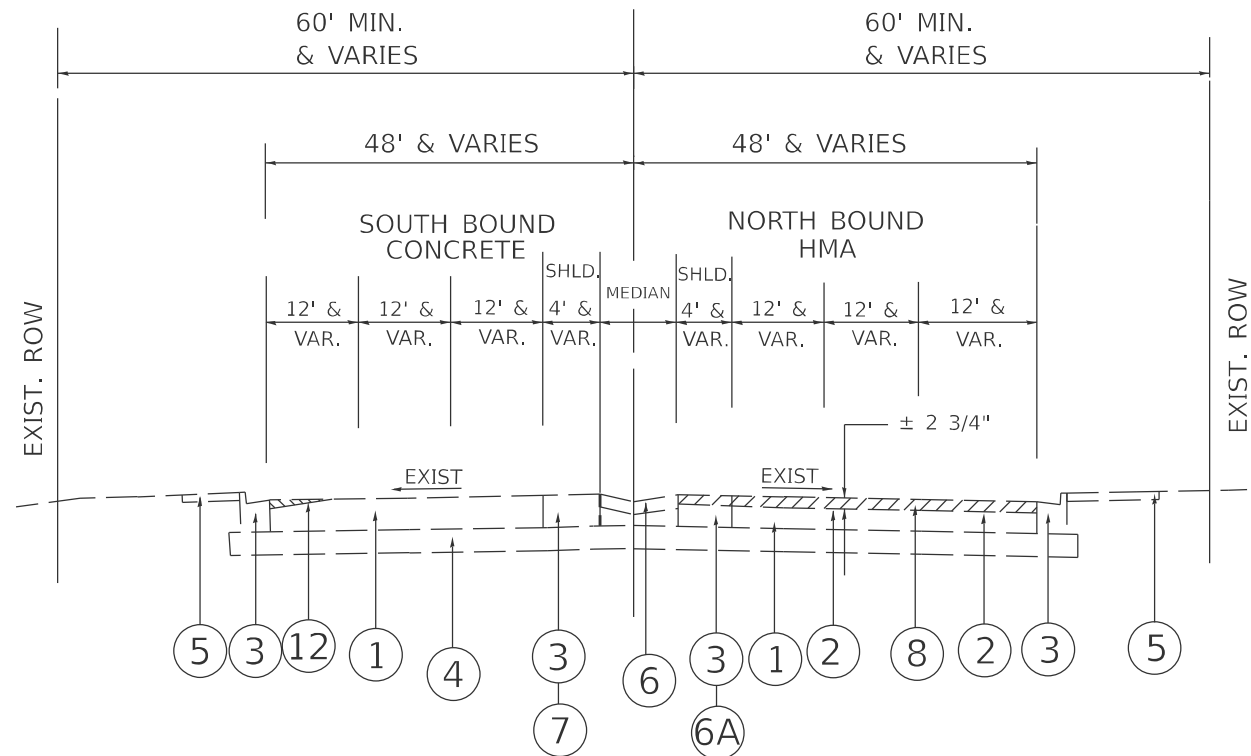

EXISTING TYPICAL SECTION

STA. 24+97 TO STA. 97+65

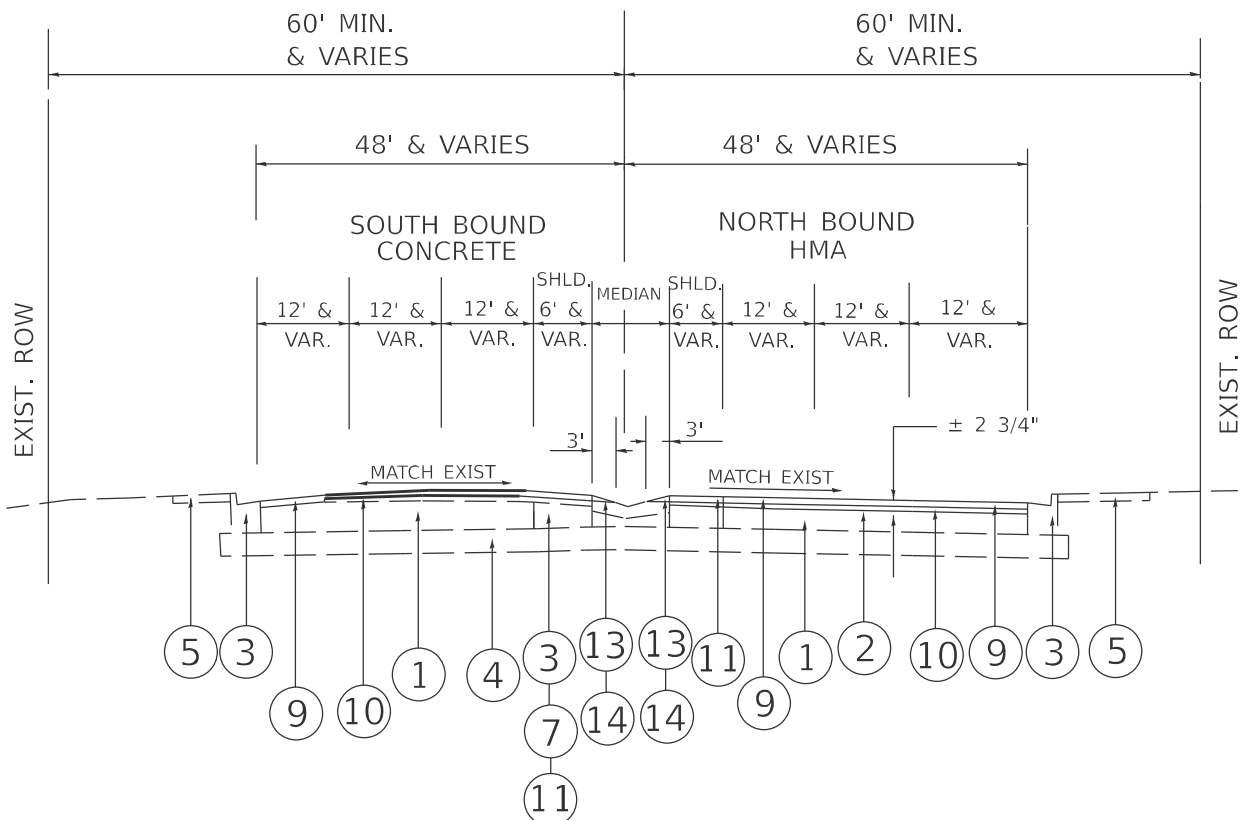

PROPOSED TYPICAL SECTION

STA. 24+97 TO STA. 97+65

LEGEND

- ① EXIST. PORTLAND CEMENT CONCRETE PAVEMENT, $\pm 9"$
- ② EXIST. HMA PAVEMENT AFTER MILLING
- ③ EXIST. COMBINATION CONCRETE CURB AND GUTTER
- ④ EXIST. AGGREGATE SUBGRADE 12"
- ⑤ EXIST. P.C.C SIDEWALK, 5"
- ⑥ EXIST. MEDIAN
- ⑥A EXIST. HMA SHOULDER
- ⑦ EXIST. P.C.C SHOULDER
- ⑧ PROP. HOT-MIX ASPHALT SURFACE REMOVAL, 2 3/4"
- ⑨ PROP. POLY. HMA SURFACE COURSE, MIX E, IL-9.5, N70, 1 3/4"
- ⑩ PROP. POLY. HMA BINDER COURSE, IL-4.75, N50, 1"
- ⑪ PROP. SHOULDER RUMBLE STRIP- 8"
- ⑫ PROP. P.C.C SURFACE REMOVAL (VARIABLE DEPTH)
- ⑬ PROP. AGGREGATE WEDGE SHOULDER, TYPE B
- ⑭ PROP. GRADING AND SHAPING SHOULDER

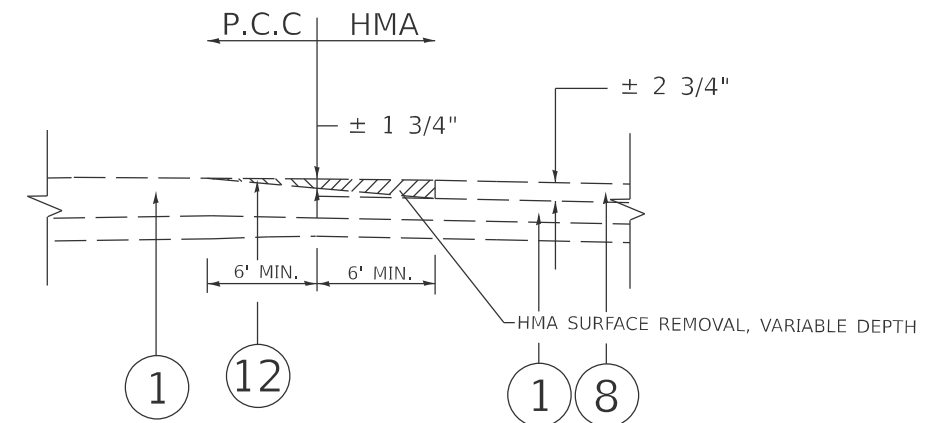

*** EXIST. SUGGESTED INTERSECTION TRANSITION DETAIL**

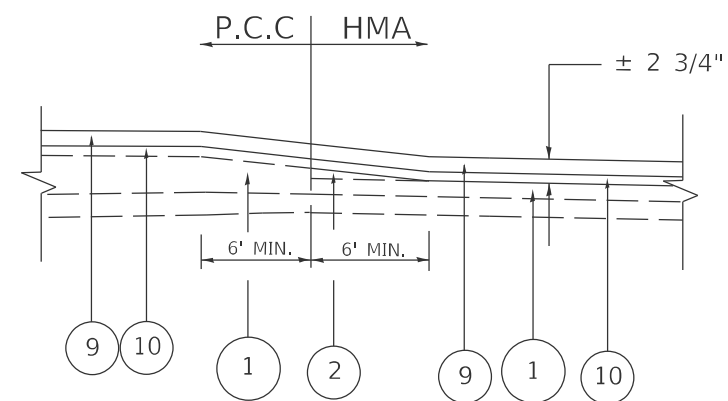

*** PROP. SUGGESTED INTERSECTION TRANSITION DETAIL**

*** NOTE:**

THIS DETAIL IS TYPICAL. THE CONTRACTOR SHALL MATCH THE EXISTING PAVEMENT PROFILE AND CROSS SLOPE AT ALL HMA-PCC TRANSITIONS. DEPTH OF HMA SURFACE REMOVAL, VARIABLE DEPTH SHALL BE ADJUSTED IN THE FIELD AS NECESSARY TO MAINTAIN EXISTING DRAINAGE PATTERNS, AS DIRECTED BY THE ENGINEER.

USER NAME = Addis.Abebew	DESIGNED -	REVISED - REV. 12/16/25 A.A
	DRAWN -	REVISED -
	CHECKED -	REVISED -
PLOT DATE = 12/18/2025	DATE -	REVISED -

STATE OF ILLINOIS
DEPARTMENT OF TRANSPORTATION

TYPICAL SECTION			
IL 47 N. KREUTZER DR. TO N. OF JIM DHAMER DR.			
SCALE:	SHEET	OF SHEETS	STA. TO STA.

F.A.P. RTE.	SECTION	COUNTY	TOTAL SHEETS	SHEET NO.
326	FAP 0326 23 RES	KANE	25	5A
CONTRACT NO. 62V43				
ILLINOIS FED. AID PROJECT				

MODEL: IL47-RoadPlan03
FILE NAME: c:\pwwork\k\labebawa\1006668D102124-shp-plan.dgn

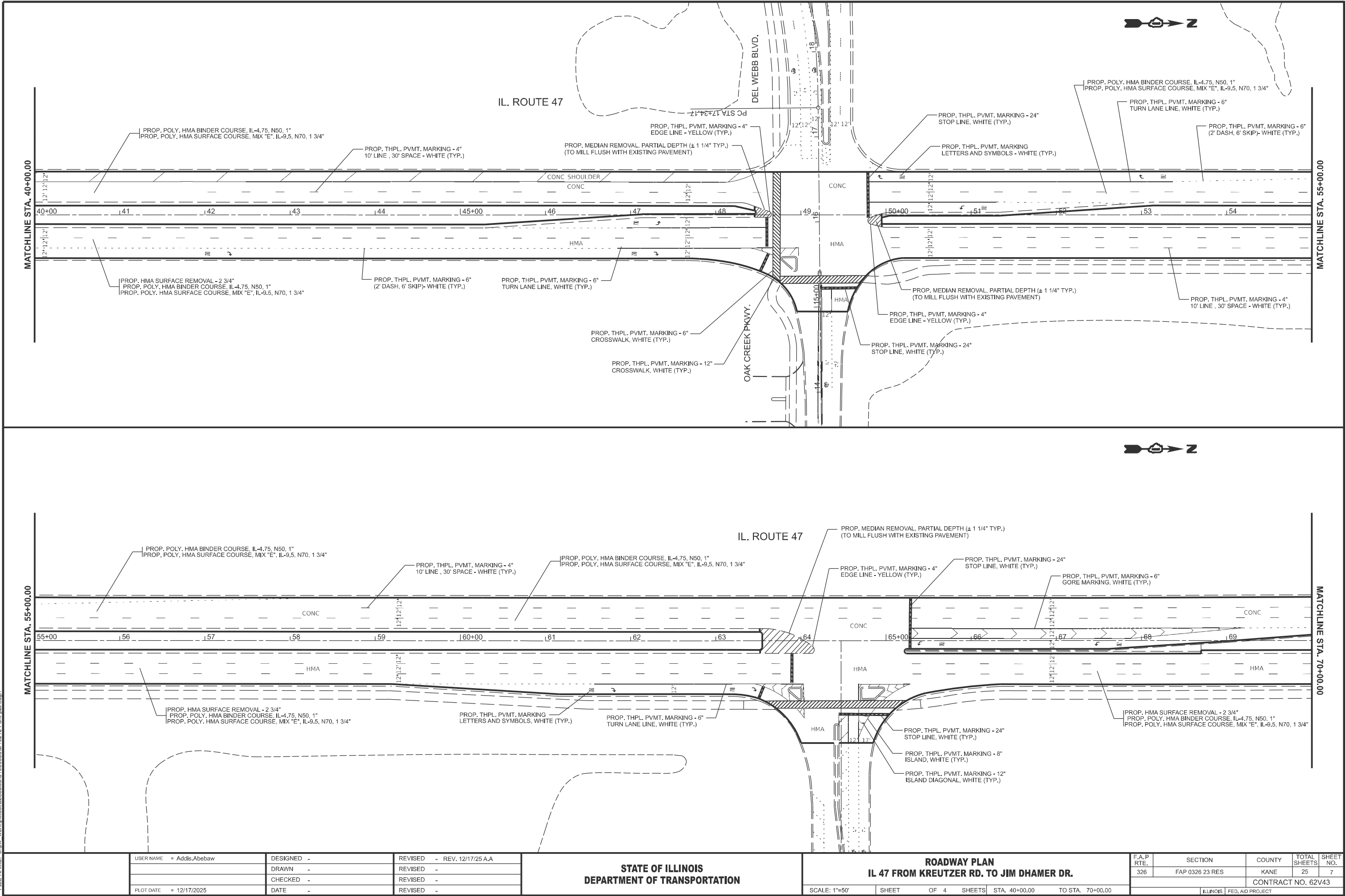

USER NAME	= Addis.Abebaw
PLOT DATE	= 12/17/2025

DESIGNED	-
DRAWN	-
CHECKED	-
DATE	-

REVISED	-	REV. 12/17/25 A.A
REVISED	-	
REVISED	-	
REVISED	-	

STATE OF ILLINOIS
DEPARTMENT OF TRANSPORTATION

ROADWAY PLAN
IL 47 FROM KREUTZER RD. TO JIM DHAMER DR.

SCALE: 1"=50'

SHEET OF 4 SHEETS STA. 40+00.00 TO STA. 70+00.00

F.A.P RTE.	SECTION	COUNTY	TOTAL SHEETS	SHEET NO.
326	FAP 0326 23 RES	KANE	25	7
CONTRACT NO. 62V43				
ILLINOIS FED. AID PROJECT				

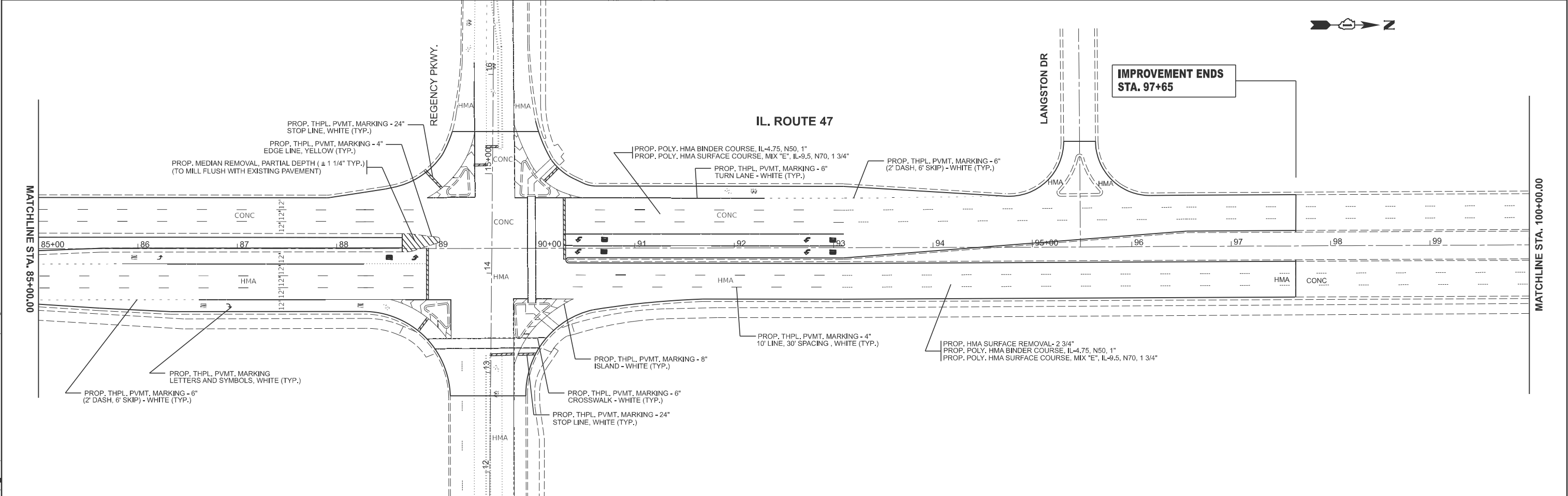
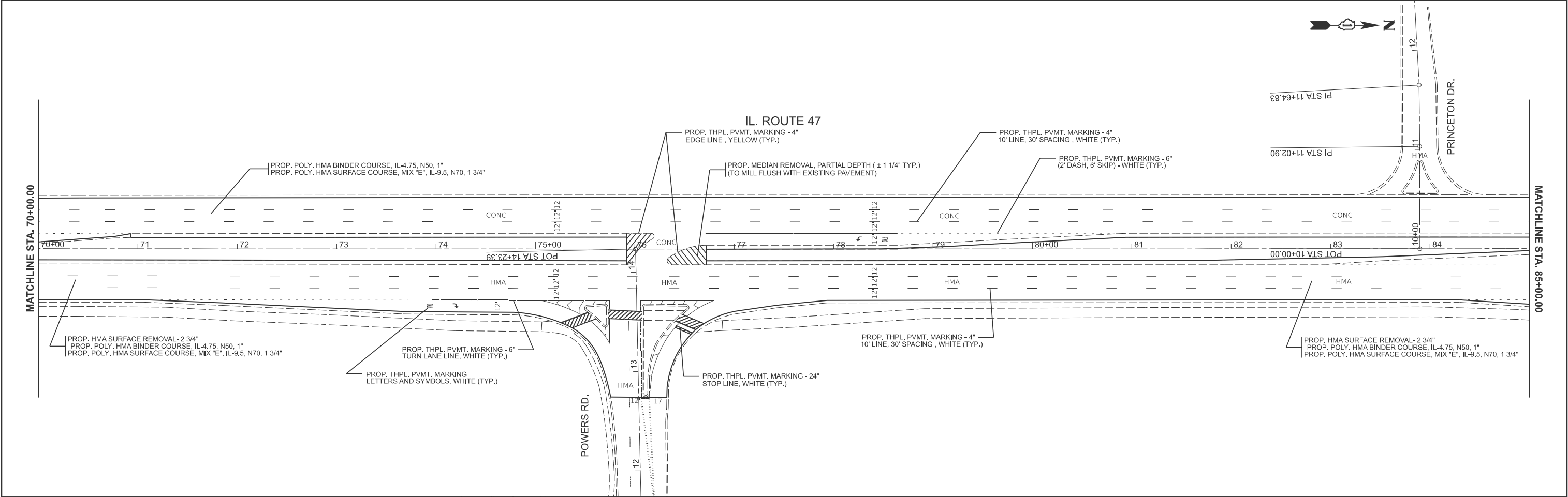

MODEL: IL47-RdwyPlan05
FILE NAME: c:\pw_work\kwtolabebawa\1006686\102124-shr-plan.dgn

PLOT DATE	USER NAME	DESIGNED	REVISED
	= Addis.Abebew	-	-
		DRAWN	REVISED
		-	-
DATE		CHECKED	REVISED
	-	-	-
		DATE	REVISED
	-	-	-

STATE OF ILLINOIS
DEPARTMENT OF TRANSPORTATION

ROADWAY PLAN
IL 47 FROM KREUTZER DR. TO JIM DHAMER DR.

SCALE: 1"=50' SHEET OF 4 SHEETS STA. 70+00.00 TO STA. 100+00.00

F.A.P RTE.	SECTION	COUNTY	TOTAL SHEETS	SHEET NO.
326	FAP 0326 23 RES	KANE	25	8
CONTRACT NO. 62V43				
ILLINOIS FED. AID PROJECT				

EXISTING CONTROLLER SEQUENCE

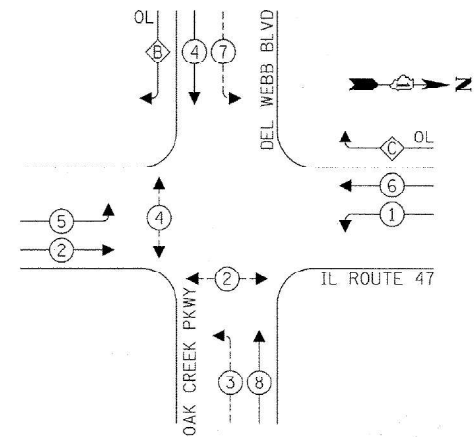

RIGHT TURN OVERLAP
PHASE DESIGNATION:

OVERLAP LETTER	PERMISSIVE PHASE	PROTECTED PHASE
B	= 4	+ 5
C	= 6	+ 7

EXISTING EMERGENCY VEHICLE
PREEMPTION SEQUENCE

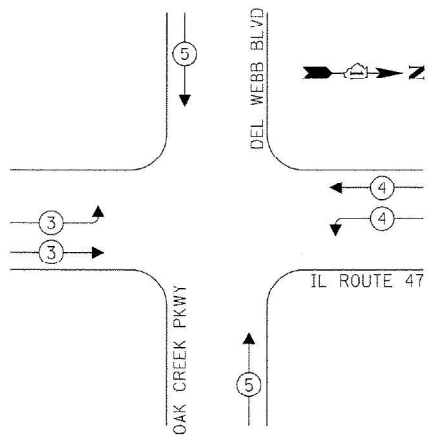

TRAFFIC SIGNAL
ELECTRICAL SERVICE REQUIREMENTS

EQUIPMENT TYPE	QUANTITY	UNIT WATTAGE	TOTAL WATTAGE
SIGNAL HEAD 1 OR 3-SECTION	10	11	110
4-SECTION	-	14	-
5-SECTION	8	13	104
PROGRAMMABLE 3-SECTION	-	22	-
4-SECTION	-	32	-
5-SECTION	-	28	-
PEDESTRIAN SIGNAL	4	15	60
CONTROLLER	1	150	150
MASTER CONTROLLER	-	100	-
UPS	1	25	25
DETECTION RADAR OR VIDEO	-	20	-
BLANK-OUT SIGN	-	25	-
NETWORK SWITCH II OR III	-	35	-
CELLULAR MODEM	-	15	-
TOTAL UPS SIZING			449
UPS CHARGING	1	225	225
BATTERY HEATER MAT	1	180	180
CABINET HEATER	1	200	200
FLASHER	-	15	-
LED STREET NAME SIGN	-	120	-
LUMINAIRE	-	240	-
TOTAL SERVICE WIRE SIZING			1,054

ENERGY COSTS TO:			
ILLINOIS DEPARTMENT OF TRANSPORTATION			
201 W CENTER COURT			
SCHAUMBURG, ILLINOIS 60196			
ENERGY SUPPLY:	CONTACT:	CASSIE EVANS	
	PHONE:	(773) 241-0741	
	COMPANY:	COMED	
	ACCOUNT NUMBER:	---	
	METER NUMBER:	---	

LEGEND:

- ← * → PROTECTED PHASE
- ← * - - - PROTECTED/PERMITTED PHASE
- ← * → PEDESTRIAN PHASE
- ← * OL OVERLAP

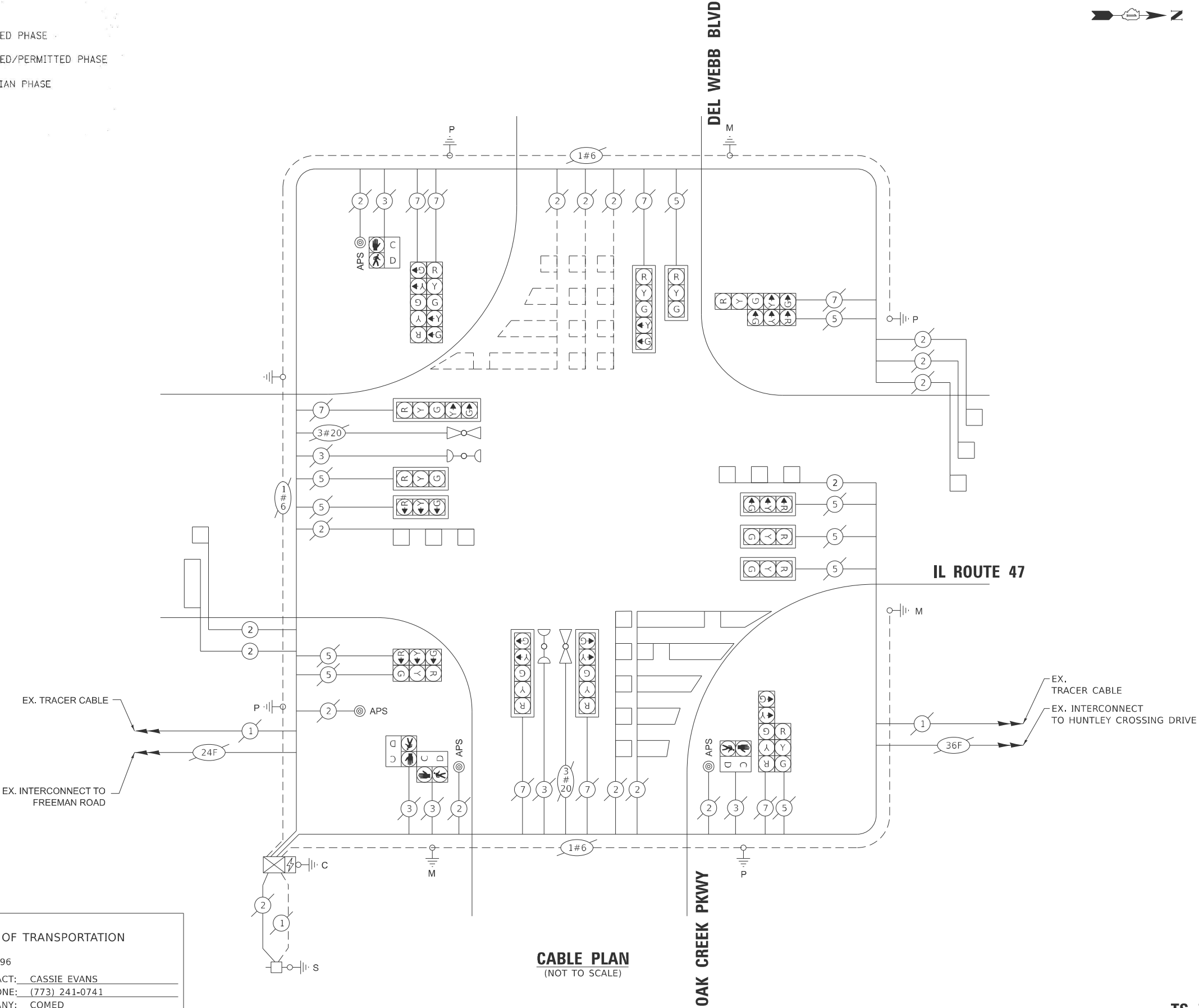

CABLE PLAN
(NOT TO SCALE)

STATE OF ILLINOIS
DEPARTMENT OF TRANSPORTATION

CABLE PLAN, PHASE DESIGNATION DIAGRAM,
AND EMERGENCY PREEMPTION SEQUENCE
ILLINOIS ROUTE 47 AND DEL WEBB BOULEVARD / OAK CREEK PARKWAY

TS 7332
EAGLE 7D

MODEL: Default
FILE NAME: H:\Projects\170001\1780\TechData\CADD\Design\Basic\06-D162\43-border.dgn

USER NAME =	DESIGNED - BWC	REVISED -
	DRAWN - JMH	REVISED -
	CHECKED - KJS	REVISED -
PLOT DATE = 12/17/2025	DATE - 12/17/2025	REVISED -

SCALE: NTS SHEET 2 OF 2 SHEETS STA. TO STA.

F.A.P RTE.	SECTION	COUNTY	TOTAL SHEETS	SHEET NO.
326	FAP 0326 23 RES	KANE	25	9A
CONTRACT NO. 62V43				
ILLINOIS FED. AID PROJECT				



1. WORK SHALL MEET THE REQUIREMENTS OF THE SPECIAL PROVISION, "DETECTOR LOOP REPLACEMENT AND/OR INSTALLATION (ROADWAY GRINDING, RESURFACING & PATCHING OPERATIONS)".
2. THIS PLAN IS FOR THE SOLE PURPOSE OF DETECTOR LOOP REPLACEMENT.
3. SEE ROADWAY PLANS FOR PROPOSED PAVEMENT MARKING CHANGES FOR THE SOUTHBOUND AND WESTBOUND LEFT TURN LANE.

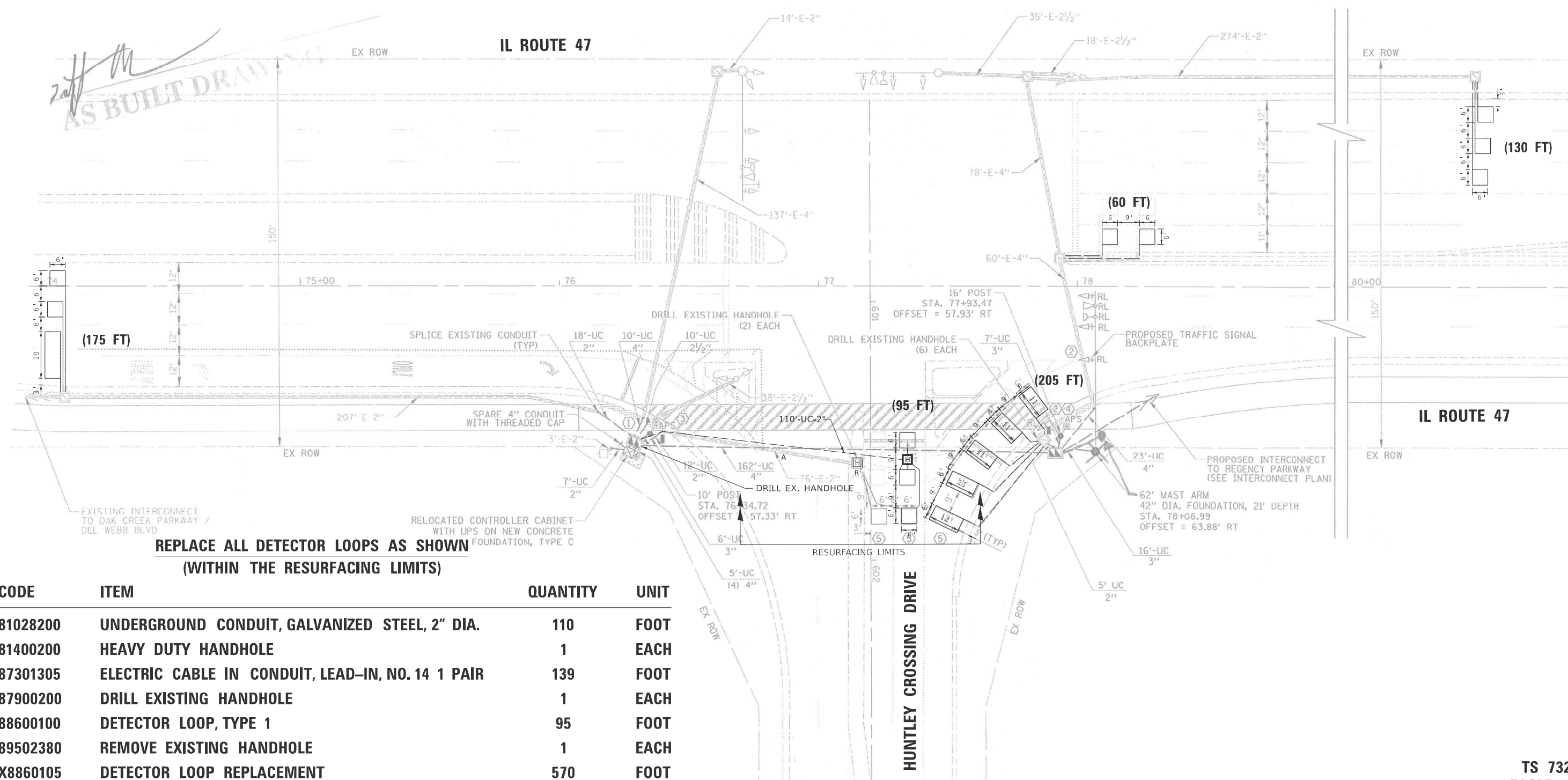

CODE	ITEM	QUANTITY	UNIT
81028200	UNDERGROUND CONDUIT, GALVANIZED STEEL, 2" DIA.	110	FOOT
81400200	HEAVY DUTY HANDHOLE	1	EACH
87301305	ELECTRIC CABLE IN CONDUIT, LEAD-IN, NO. 14 1 PAIR	139	FOOT
87900200	DRILL EXISTING HANDHOLE	1	EACH
88600100	DETECTOR LOOP, TYPE 1	95	FOOT
89502380	REMOVE EXISTING HANDHOLE	1	EACH
X8860105	DETECTOR LOOP REPLACEMENT	570	FOOT

TS 7324
EAGLE 7D

USER NAME	=	DESIGNED	-	BWC	REVISED	-
		DRAWN	-	JMH	REVISED	-
		CHECKED	-	KJS	REVISED	-
PLOT DATE	=	DATE	-	12/17/2025	REVISED	-

STATE OF ILLINOIS
DEPARTMENT OF TRANSPORTATION

DETECTOR LOOP REPLACEMENT PLAN ILLINOIS ROUTE 47 AND HUNTLEY CROSSINGS DRIVE

SCALE: 1"=20'	SHEET 1	OF 2	SHEETS	STA.	TO STA.
---------------	---------	------	--------	------	---------

F.A.P RTE.	SECTION	COUNTY	TOTAL SHEETS	SHEET NO.
326	FAP 0326 23 RES	KANE	25	9B
		CONTRACT NO. 62V43		
ILLINOIS		FED. AID PROJECT		

MODEL: Default
FILE NAME: H:\Projects\17000\17180\TechData\CADDesign\BaseC06-D162V43-border.dgn

EXISTING EMERGENCY VEHICLE
PREEMPTION SEQUENCE

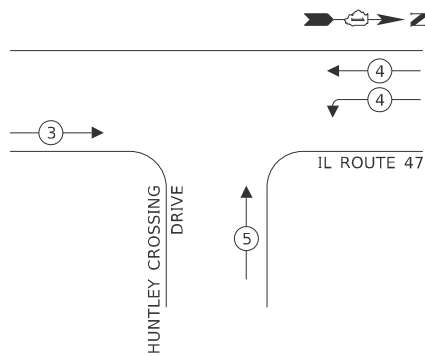

EXISTING CONTROLLER SEQUENCE

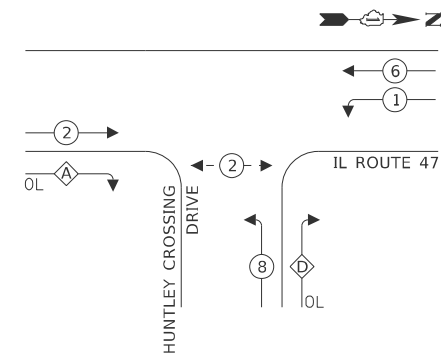

RIGHT TURN OVERLAP

PHASE DESIGNATION:

OVERLAP LETTER	PERMISSIVE PHASE	PROTECTED PHASE
A	2	8
D	8	1

LEGEND:

- PROTECTED PHASE
- PROTECTED/PERMITTED PHASE
- PEDESTRIAN PHASE
- OVERLAP

EX. TRACER CABLE

EX. INTERCONNECT TO
DEL WEBB BLVD / OAK CREEK PKWY

CABLE PLAN
(NOT TO SCALE)

TRAFFIC SIGNAL
ELECTRICAL SERVICE REQUIREMENTS

EQUIPMENT TYPE	QUANTITY	UNIT WATTAGE	TOTAL WATTAGE
SIGNAL HEAD 1 OR 3-SECTION	14	11	154
4-SECTION	-	14	-
5-SECTION	2	13	26
PROGRAMMABLE 3-SECTION	-	22	-
4-SECTION	-	32	-
5-SECTION	-	28	-
PEDESTRIAN SIGNAL	2	15	30
CONTROLLER	1	150	150
MASTER CONTROLLER	-	100	-
UPS	1	25	25
DETECTION RADAR OR VIDEO	-	20	-
BLANK-OUT SIGN	-	25	-
NETWORK SWITCH II OR III	-	35	-
CELLULAR MODEM	-	15	-
TOTAL UPS SIZING			385
UPS CHARGING	1	225	225
BATTERY HEATER MAT	1	180	180
CABINET HEATER	1	200	200
FLASHER	-	15	-
LED STREET NAME SIGN	-	120	-
LUMINAIRE	-	240	-
TOTAL SERVICE WIRE SIZING			990

ENERGY COSTS TO:

ILLINOIS DEPARTMENT OF TRANSPORTATION
201 W CENTER COURT
SCHAUMBURG, ILLINOIS 60196

ENERGY SUPPLY: CONTACT: CASSIE EVANS
PHONE: (773) 241-0741
COMPANY: COMED
ACCOUNT NUMBER: ---
METER NUMBER: ---

STATE OF ILLINOIS
DEPARTMENT OF TRANSPORTATION

CABLE PLAN, PHASE DESIGNATION DIAGRAM,
AND EMERGENCY PREEMPTION SEQUENCE
ILLINOIS ROUTE 47 AND HUNTLEY CROSSINGS DRIVE

F.A.P RTE.	SECTION	COUNTY	TOTAL SHEETS	SHEET NO.
326	FAP 0326 23 RES	KANE	25	10
CONTRACT NO. 62V43				
ILLINOIS FED. AID PROJECT				

TS 7324
EAGLE 7D

REPLACE ALL DETECTOR LOOPS AS SHOWN
(WITHIN THE RESURFACING LIMITS)

CODE	ITEM	QUANTITY	UNIT
81028200	UNDERGROUND CONDUIT, GALVANIZED STEEL, 2" DIA.	65	FOOT
81400200	HEAVY DUTY HANDHOLE	1	EACH
87301305	ELECTRIC CABLE IN CONDUIT, LEAD-IN, NO. 14 1 PAIR	89	FOOT
87900200	DRILL EXISTING HANDHOLE	1	EACH
88600100	DETECTOR LOOP, TYPE 1	280	FOOT
89502380	REMOVE EXISTING HANDHOLE	1	EACH
X8860105	DETECTOR LOOP REPLACEMENT	2065	FOOT

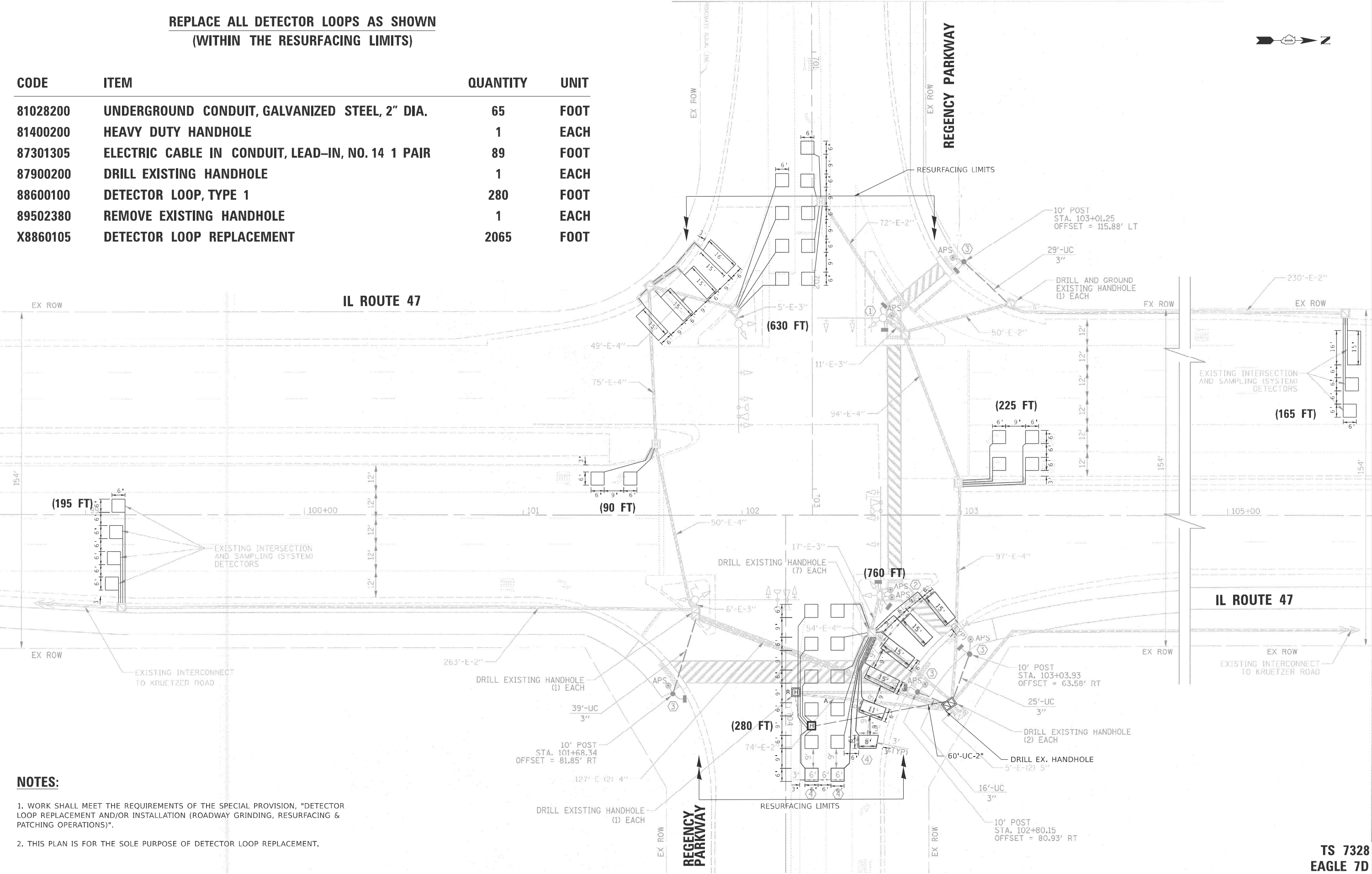

NOTES:

1. WORK SHALL MEET THE REQUIREMENTS OF THE SPECIAL PROVISION, "DETECTOR LOOP REPLACEMENT AND/OR INSTALLATION (ROADWAY GRINDING, RESURFACING & PATCHING OPERATIONS)".
2. THIS PLAN IS FOR THE SOLE PURPOSE OF DETECTOR LOOP REPLACEMENT.

STATE OF ILLINOIS
DEPARTMENT OF TRANSPORTATION

DETECTOR LOOP REPLACEMENT PLAN
ILLINOIS ROUTE 47 AND REGENCY PARKWAY

TS 7328
EAGLE 7D

USER NAME	=	DESIGNED - BWC	REVISED -
		DRAWN - JMH	REVISED -
		CHECKED - KJS	REVISED -
PLOT DATE	= 12/17/2025	DATE - 12/17/2025	REVISED -

SCALE: 1"=20' SHEET 1 OF 2 SHEETS STA. TO STA.

F.A.P. RTE.	SECTION	COUNTY	TOTAL SHEETS	SHEET NO.
326	FAP 0326 23 RES	KANE	25	11
CONTRACT NO. 62V43				
ILLINOIS FED. AID PROJECT				

EXISTING CONTROLLER SEQUENCE

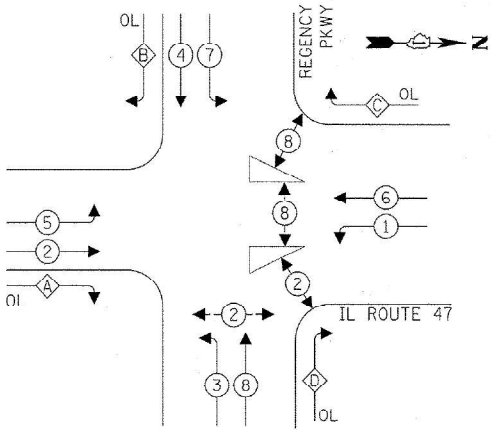

LEGEND:

- PROTECTED PHASE
- PROTECTED/PERMITTED PHASE
- PEDESTRIAN PHASE
- OVERLAP

RIGHT TURN OVERLAP
PHASE DESIGNATION:

OVERLAP LETTER		PERMISSIVE PHASE		PROTECTED PHASE
A	=	2	+	3
B	=	4	+	5
C	=	6	+	7
D	=	8	+	1

EXISTING EMERGENCY VEHICLE
PREEMPTION SEQUENCE

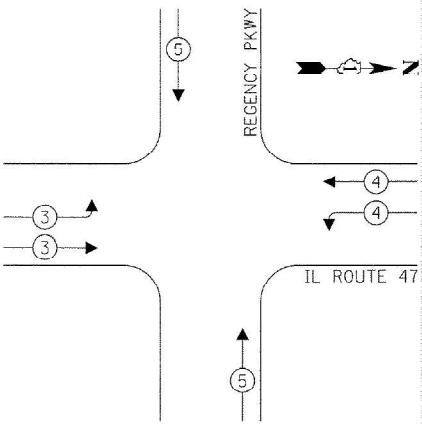

TRAFFIC SIGNAL
ELECTRICAL SERVICE REQUIREMENTS

EQUIPMENT TYPE	QUANTITY	UNIT WATTAGE	TOTAL WATTAGE
SIGNAL HEAD 1 OR 3-SECTION	8	11	88
4-SECTION	-	14	-
5-SECTION	12	13	156
PROGRAMMABLE 3-SECTION	-	22	-
4-SECTION	-	32	-
5-SECTION	-	28	-
PEDESTRIAN SIGNAL	8	15	120
CONTROLLER	1	150	150
MASTER CONTROLLER	-	100	-
UPS	1	25	25
DETECTION RADAR OR VIDEO	-	20	-
BLANK-OUT SIGN	-	25	-
NETWORK SWITCH II OR III	-	35	-
CELLULAR MODEM	-	15	-
TOTAL UPS SIZING			539
UPS CHARGING	1	225	225
BATTERY HEATER MAT	1	180	180
CABINET HEATER	1	200	200
FLASHER	-	15	-
LED STREET NAME SIGN	-	120	-
LUMINAIRE	-	240	-
TOTAL SERVICE WIRE SIZING			1,144

ENERGY COSTS TO:

ILLINOIS DEPARTMENT OF TRANSPORTATION
201 W CENTER COURT
SCHAUMBURG, ILLINOIS 60196

ENERGY SUPPLY: CONTACT: CASSIE EVANS
PHONE: (773) 241-0741
COMPANY: COMED
ACCOUNT NUMBER: ---
METER NUMBER: ---

REGENCY PARKWAY

IL ROUTE 47

CABLE PLAN
(NOT TO SCALE)

STATE OF ILLINOIS
DEPARTMENT OF TRANSPORTATION

CABLE PLAN, PHASE DESIGNATION DIAGRAM,
AND EMERGENCY PREEMPTION SEQUENCE
ILLINOIS ROUTE 47 AND DEL WEBB BOULEVARD / OAK CREEK PARKWAY

TS 7328
EAGLE 7D

F.A.P RTE.	SECTION	COUNTY	TOTAL SHEETS	SHEET NO.
326	FAP 0326 23 RES	KANE	25	12
CONTRACT NO. 62V43				
ILLINOIS FED. AID PROJECT				

MODEL: Default
FILE NAME: H:\Projects\1700017\1800TechData\CADD\Design\Bases\06-D162V43-border.dgn

MODEL: Plan Single (Sheet)
FILE NAME: Z:\DOTCAD_0RD\Folder Master\ Master Files\DOT_CONFIGURATION\Organization-Civil\DOT_Standards\Drawings\Sheet Seeds\Civil_Named_Boundary_SheetSeeds.dgnlib

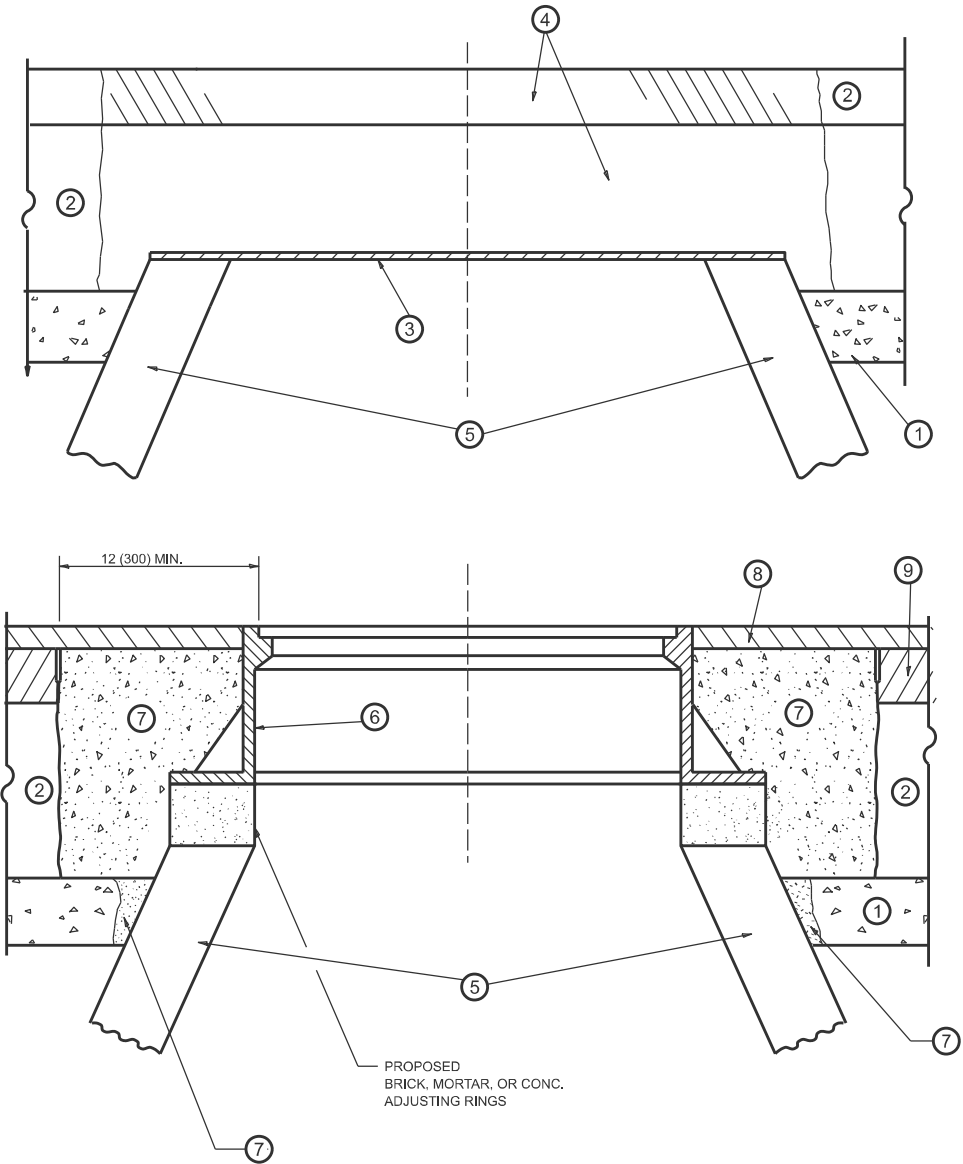

**DETAILS FOR FRAMES AND LIDS ADJUSTMENT
WITH MILLING**

NOTES

- EXISTING BROKEN FRAMES AND LIDS SHALL BE REMOVED AND DISPOSED OF BY THE CONTRACTOR AND SHALL BE REPLACED AS DIRECTED BY THE ENGINEER. REPLACEMENT FRAMES AND LIDS WILL BE PAID FOR IN ACCORDANCE WITH ARTICLE 109.04 OF THE STANDARD SPECIFICATIONS UNLESS A SEPARATE PAY ITEM HAS BEEN PROVIDED.
- IF THE EXISTING LIDS ARE OPEN, THE FRAME WILL BE ADJUSTED TO THE ELEVATION OF THE MILLED PAVEMENT SURFACE PRIOR TO THE MILLING OPERATION. THE FRAME WILL NOT BE REMOVED AND COVERED BY THE METAL PLATE.
- CITY OF CHICAGO CASTINGS ARE THE PROPERTY OF THE CITY AND THE CONTRACTOR SHALL NOTIFY THE CITY FOR REMOVAL AND DISPOSITION OF THE CASTINGS.
- THE METAL PLATE USED TO COVER THE STRUCTURE SHALL REMAIN THE PROPERTY OF THE CONTRACTOR.
- THE CONTRACTOR SHALL REMOVE ALL TRAFFIC CONTROL DEVICES BY THE END OF EACH WORK SHIFT.

CONSTRUCTION PROCEDURES

STAGE 1 (BEFORE PAVEMENT MILLING)

- REMOVE A MINIMUM OF 12 (300) OF THE PAVEMENT FROM AROUND THE STRUCTURE.
- REMOVE THE EXISTING FRAME AND LID FROM THE STRUCTURE.
- COVER THE STRUCTURE OPENING WITH A 36 (900) DIAMETER METAL PLATE.
- BACKFILL WITH CRUSHED STONE AND HMA SURFACE MIX APPROVED BY THE ENGINEER. (MIN. 3 (80) HMA TO REMAIN AFTER MILLING).

STAGE 2 (AFTER PAVEMENT MILLING)

- REMOVE THE HMA SURFACE MIX AND CRUSHED STONE.
- INSTALL THE FRAME AND LID; ADJUST THE FRAME TO ITS FINAL SURFACE ELEVATION.
- THE SURROUNDING SPACE SHALL BE FILLED WITH CLASS PP-2* CONCRETE TO THE ELEVATION OF THE SURFACE OF THE EXISTING BASE COURSE OR THE BINDER COURSE.

*UNLESS OTHERWISE SPECIFIED IN THE PLANS.

THE PROCEDURE EXPLAINED ABOVE SHALL CONFORM TO THE APPLICABLE PORTIONS OF SECTIONS 353, 406, 602, AND 603 OF THE STANDARD SPECIFICATIONS EXCEPT THAT "THE CONTRACTOR SHALL ADJUST THE STRUCTURES TO THE FINISHED PAVEMENT ELEVATION NO MORE THAN 5 CALENDAR DAYS PRIOR TO PLACEMENT OF THE FINAL LIFT OF SURFACE UNLESS APPROVED BY THE ENGINEER."

LEGEND

- | | |
|--|-------------------------------|
| ① SUB-BASE GRANULAR MATERIAL | ⑥ FRAME AND LID (SEE NOTES) |
| ② EXISTING PAVEMENT | ⑦ CLASS PP-2* CONCRETE |
| ③ 36 (900) DIAMETER METAL PLATE | ⑧ PROPOSED HMA SURFACE COURSE |
| ④ PROPOSED CRUSHED STONE AND HMA SURFACE MIX | ⑨ PROPOSED HMA BINDER COURSE |
| ⑤ EXISTING STRUCTURE | |

LOCATION OF STRUCTURES

THE CONTRACTOR WILL BE REQUIRED TO KEEP A RECORD OF THE LOCATIONS OF THE BURIED STRUCTURES ACCORDING TO THE STATION AND DISTANCE LEFT OR RIGHT OF THE CENTERLINE OF PAVEMENT. UPON COMPLETION OF THE WORK, THE CONTRACTOR WILL DELIVER THE RECORD TO THE ENGINEER.

BASIS OF PAYMENT

- REMOVING FRAMES AND LIDS ON DRAINAGE AND UTILITY STRUCTURES IN THE PAVEMENT PRIOR TO MILLING, AND ADJUSTING TO FINAL GRADE PRIOR TO PLACING THE SURFACE COURSE, WILL BE PAID FOR AT THE CONTRACT UNIT PRICE EACH FOR "FRAMES AND LIDS TO BE ADJUSTED (SPECIAL)."
- THIS WORK WILL NOT BE PAID FOR WHEN DRAINAGE AND UTILITY STRUCTURES ARE SPECIFIED FOR PAYMENT AS STRUCTURE RECONSTRUCTION.
- NEW FRAMES AND LIDS, WHEN SPECIFIED, WILL BE PAID FOR SEPARATELY.
- WHEN STRUCTURES ARE TO BE ADJUSTED OR RECONSTRUCTED, THE LOWERING AND RAISING OF THE FRAMES AND LIDS WILL NOT BE PAID FOR SEPARATELY BUT WILL BE INCLUDED IN THE COST OF THE CORRESPONDING PAY ITEM.

ALL DIMENSIONS ARE IN INCHES (MILLIMETERS) UNLESS OTHERWISE SHOWN

USER NAME = Eric.L.thomas	DESIGNED - R. SHAH	REVISED - R. BORO 03-09-11
	DRAWN -	REVISED - R. BORO 12-06-11
	CHECKED -	REVISED - K. SMITH 11-18-22
PLOT DATE = 12/2/2024	DATE - 10-25-94	REVISED - K. SMITH 09-15-23

**STATE OF ILLINOIS
DEPARTMENT OF TRANSPORTATION**

**DETAILS FOR
FRAMES AND LIDS ADJUSTMENT WITH MILLING**

SCALE: NONE SHEET 1 OF 1 SHEETS STA. TO STA.

F.A.P RTE.	SECTION	COUNTY	TOTAL SHEETS	SHEET NO.
326	FAP 0326 23 RES	KANE	25	13
BD600-03 (BD-08)		CONTRACT NO. 62V43		
ILLINOIS		FED. AID PROJECT		

METHOD OF MEASUREMENT

REFER TO SECTION 442 OF THE STANDARD SPECIFICATIONS FOR ROAD AND BRIDGE CONSTRUCTION AND THE RECURRING SPECIAL PROVISION "PATCHING WITH HOT-MIX ASPHALT OVERLAY REMOVAL."

BASIS OF PAYMENT

- 1. REFER TO SECTION 442 OF THE STANDARD SPECIFICATIONS FOR ROAD AND BRIDGE CONSTRUCTION AND THE RECURRING SPECIAL PROVISION "PATCHING WITH HOT-MIX ASPHALT OVERLAY REMOVAL."
- 2. SAW CUT/SCORING OF EXISTING HMA OVERLAY IS INCLUDED IN THE COST OF PAVEMENT PATCHING.
- 3. SAW CUT/SCORING OF EXISTING PAVEMENT IS INCLUDED IN THE COST OF PAVEMENT PATCHING.

* SEE TYPICAL SECTIONS FOR THICKNESS AND MATERIALS

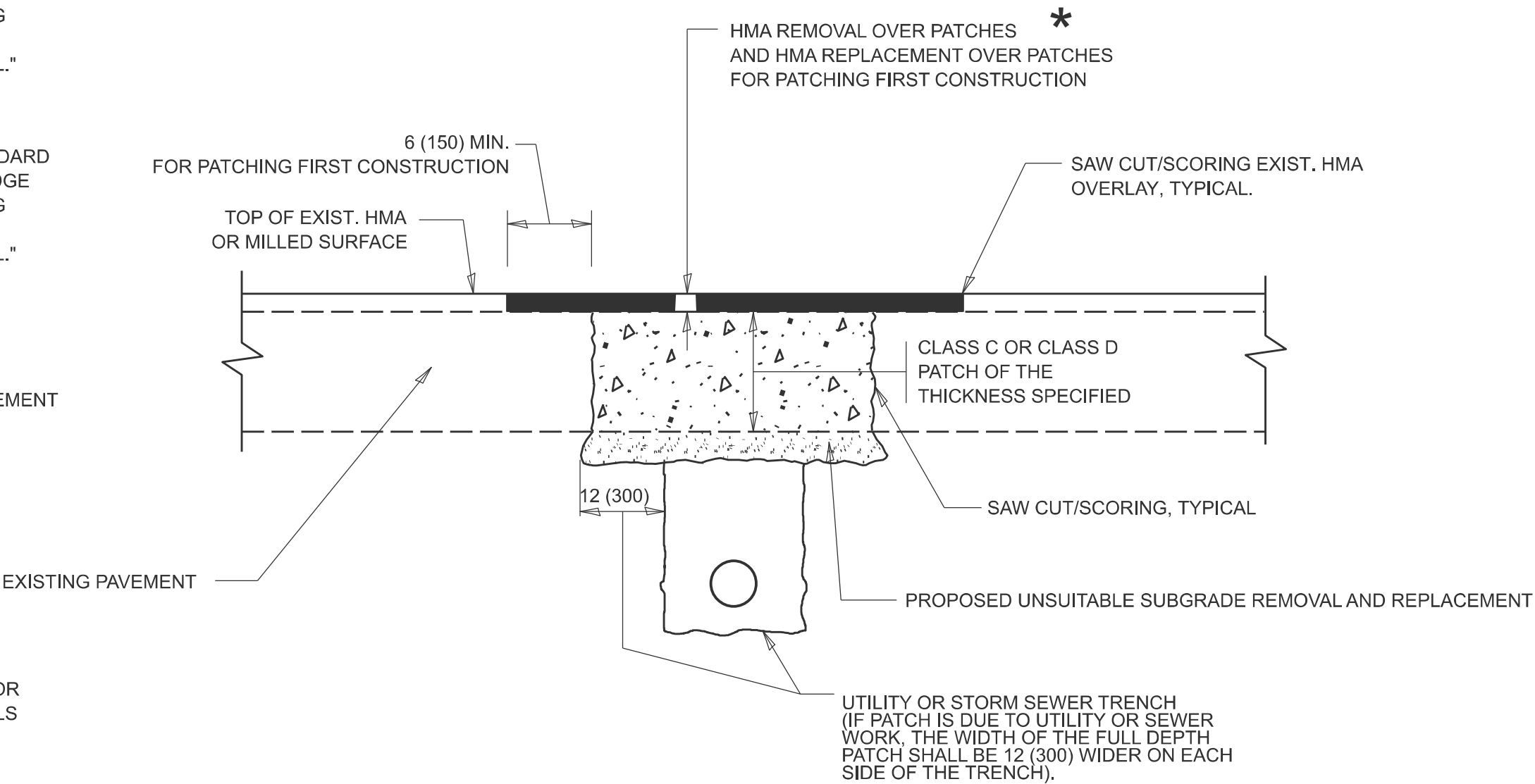

SEQUENCE OF CONSTRUCTION (PATCHING FIRST)

- 1. REMOVE THE EXISTING HMA MATERIAL OVER THE AREA TO BE PATCHED.
- 2. REMOVE AND REPLACE WITH CLASS C OR D PATCH.
- 3. REPLACE HMA MATERIAL OVER THE AREA TO BE PATCHED.

SEQUENCE OF CONSTRUCTION (MILLING FIRST)

- 1. MILL HMA FIRST IF THERE IS AT LEAST 4 1/2 INCHES OR MORE OF HMA MATERIAL ON TOP OF THE EXISTING PAVEMENT OR IF THE PAVEMENT IS FULL DEPTH HMA. A MINIMUM OF 2 INCHES OF HMA MATERIAL SHALL BE IN PLACE AFTER MILLING.
- 2. REMOVE AND REPLACE WITH FULL DEPTH CLASS D PATCHES TO TOP OF MILLED SURFACE.

ALL DIMENSIONS ARE IN INCHES (MILLIMETERS) UNLESS OTHERWISE SHOWN.

MODEL: Plan Single Sheet
FILE NAME: Z:\DOTCAD\ORD Folder Master\Master Files\DOT CONNECT Configuration\Organization-Civil\DOT Standards\Drawings\Sheet Seeds\Civil Named Boundary Sheets\Seeds.dgnlib

	USER NAME = Eric.L.thomas	DESIGNED - R. SHAH	REVISED - R. BORO 01-01-07	STATE OF ILLINOIS DEPARTMENT OF TRANSPORTATION	PAVEMENT PATCHING FOR HMA SURFACED PAVEMENT			F.A.P. RTE.	SECTION	COUNTY	TOTAL SHEETS	SHEET NO.
		DRAWN -	REVISED - R. BORO 09-04-07					326	FAP 0326 23 RES	KANE	25	14
		CHECKED -	REVISED - K. ENG 10-27-08		BD400-04 (BD-22)			CONTRACT NO. 62V43				
	PLOT DATE = 12/2/2024	DATE - 10-25-94	REVISED - K. SMITH 11-18-22		SCALE: NONE	SHEET 1	OF 1 SHEETS	STA.	TO STA.	ILLINOIS FED. AID PROJECT		

MODEL: Plan Single (Sheet)
FILE NAME: Z:\DOTCAD_0RD Folder Master\ Master Files\DOT_CONFIGURATION\Organization\Civil\DOT_Standards\Drawings\Sheet Seals\dm11b

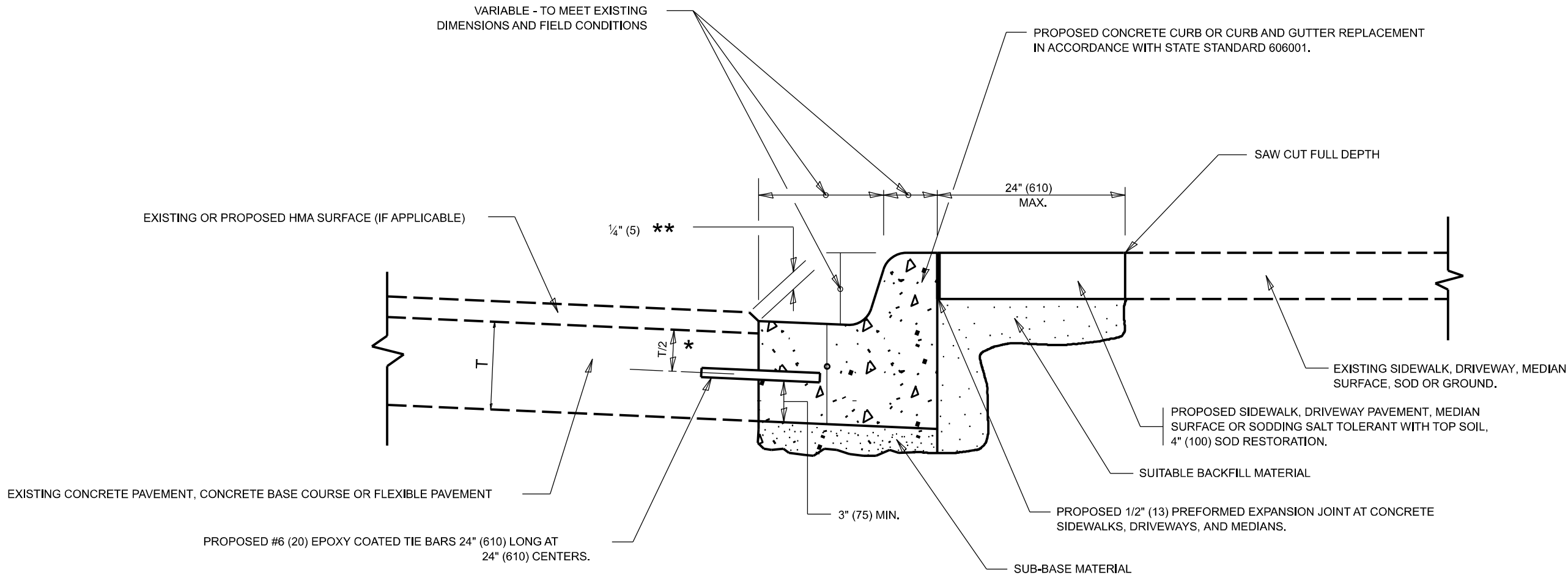

- * 3" (75) MINIMUM FROM TOP AND BOTTOM OF THE CONCRETE PAVEMENT OR BASE COURSE.
- ** IF THE FINAL SURFACE OF THE PAVEMENT IS CONCRETE, THE GUTTER IS TO BE FLUSH WITH THE PAVEMENT.

CURB OR CURB AND GUTTER REMOVAL AND REPLACEMENT

ALL DIMENSIONS ARE IN INCHES (MILLIMETERS)
UNLESS OTHERWISE SHOWN.

	USER NAME = Eric.L.thomas	DESIGNED - A. HOUSEH	REVISED - A. ABBAS 03-21-97	STATE OF ILLINOIS DEPARTMENT OF TRANSPORTATION	CURB OR CURB AND GUTTER REMOVAL AND REPLACEMENT				F.A.P. RTE.	SECTION	COUNTY	TOTAL SHEETS	SHEET NO.	
		DRAWN -	REVISED - M. GOMEZ 01-22-01						326	FAP 0326 23 RES	KANE	25	15	
		CHECKED -	REVISED - R. BORO 12-15-09						BD600-06 (BD-24)					CONTRACT NO. 62V43
	PLOT DATE = 12/2/2024	DATE - 03-11-94	REVISED - K. SMITH 07-11-19		SCALE: NONE		SHEET 1	OF 1	SHEETS	STA.	TO STA.			
							ILLINOIS FED. AID PROJECT							

MODEL: Plan Single (Sheet)
FILE NAME: Z:\DOTCAD_ORD Folder Master\ Master Files\DOT_CONNECT\Configuration\Organization\Civil\DOT_Standards\Drawings\Sheet Seeds\Civil_Named_Boundary_SheetSeeds.dgnlib

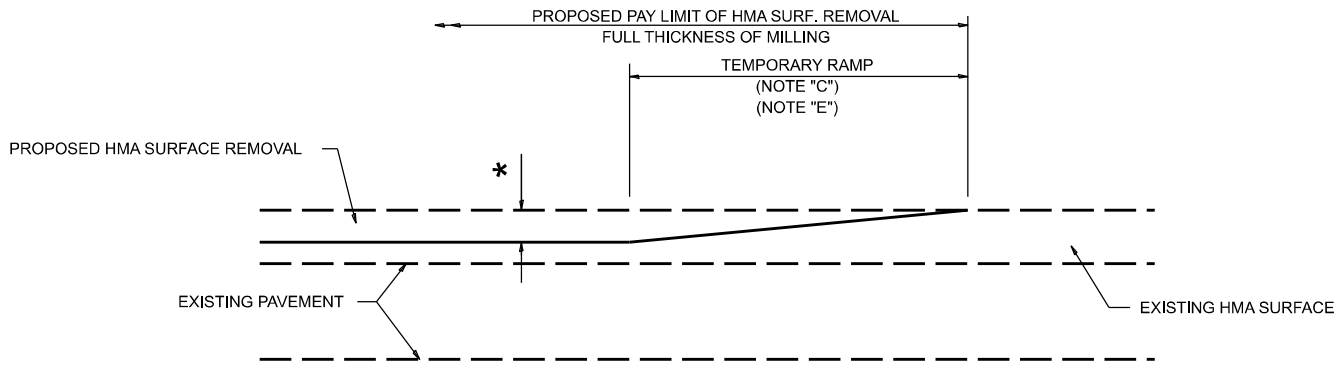

MILLED TEMPORARY RAMP

(FOR BUTT JOINT AND HMA TAPER SEE DETAIL BELOW)

OPTION 1

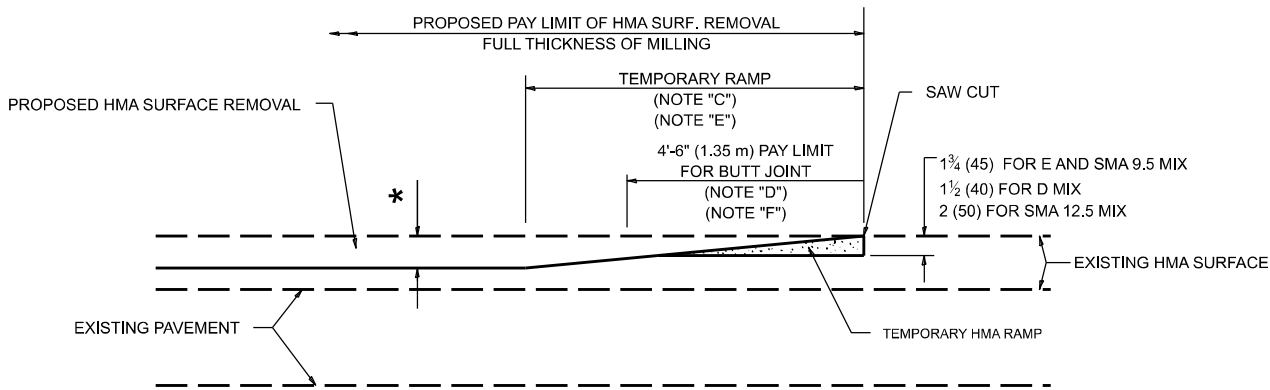

HMA CONSTRUCTED TEMPORARY RAMP

(FOR BUTT JOINT AND HMA TAPER SEE DETAIL BELOW)

OPTION 2

TYPICAL TEMPORARY RAMP

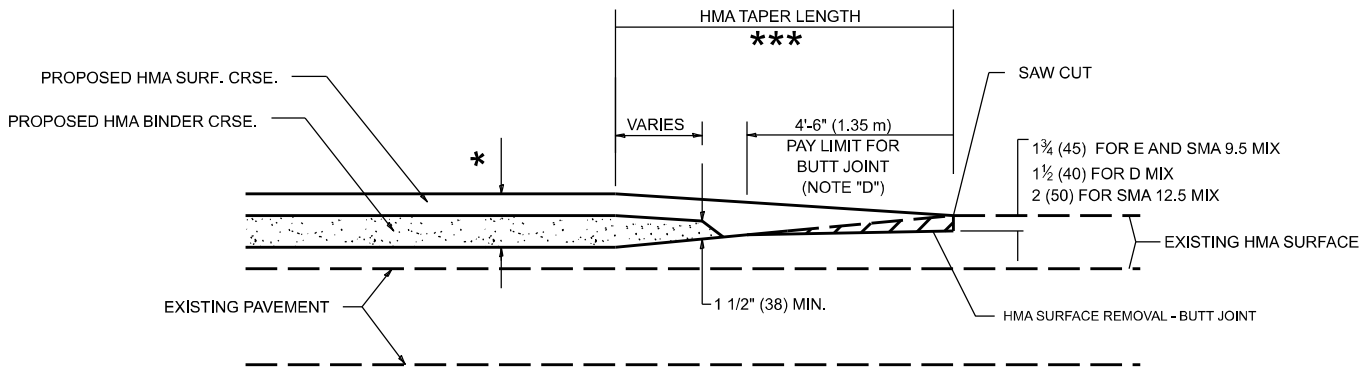

BUTT JOINT AND HMA TAPER

TYPICAL BUTT JOINT AND HMA TAPER FOR MILLING AND RESURFACING

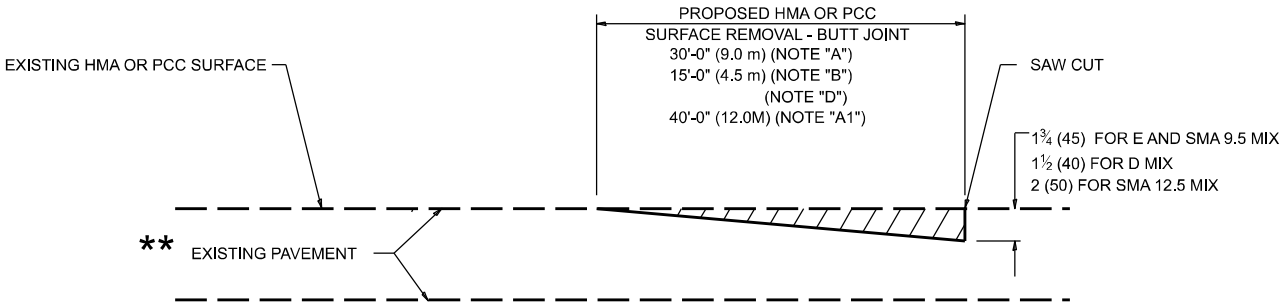

BUTT JOINT DETAIL

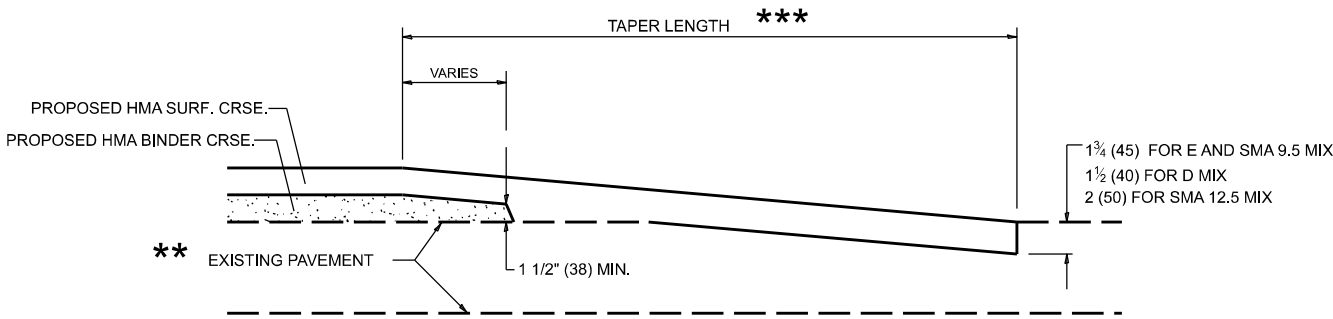

HMA TAPER DETAIL

TYPICAL BUTT JOINT AND HMA TAPER FOR RESURFACING ONLY

** PC CONCRETE, HMA OR HMA RESURFACED PAVEMENT.

GENERAL NOTES

- MAINLINE ARTERIAL ROADWAYS AND MAJOR SIDE ROADS.
- INTERSTATES.
- MINOR SIDE ROADS.
- THE TEMP. RAMP SHALL BE CONSTRUCTED IMMEDIATELY UPON REMOVAL OF THE EXISTING HMA SURFACE.
- THE BUTT JOINT SHALL BE CONSTRUCTED IMMEDIATELY PRIOR TO PLACING THE PROPOSED HMA COURSES.
- TAPER THE TEMP. RAMP AT A RATE OF 3' - 4" (1.02m) PER 1 INCH (25 mm) OF MILLING THICKNESS.
* SEE TYPICAL SECTIONS FOR MILLING THICKNESS.
- SEE ARTICLE 406.08 AND 406.14 OF THE STANDARD SPECIFICATIONS FOR "HMA AND/OR PCC SURFACE REMOVAL, BUTT JOINT".

20'-0" (6.1 m) PER 1 (25) RESURFACING (NOTE "A")
10'-0" (3.0 m) PER 1 (25) RESURFACING (NOTE "B")

BASIS OF PAYMENT

- THE BUTT JOINT WILL BE PAID FOR AT THE CONTRACT UNIT PRICE PER SQUARE YARD (SQUARE METER) FOR "HOT-MIX ASPHALT SURFACE REMOVAL - BUTT JOINT" OR FOR "PORTLAND CEMENT CONCRETE SURFACE REMOVAL- BUTT JOINT".
- THE TEMPORARY RAMP AND SAW CUT SHALL BE INCLUDED IN THE UNIT COST FOR HMA OR PCC SURFACE REMOVAL-BUTT JOINT.

ALL DIMENSIONS ARE IN INCHES (MILLIMETERS) UNLESS OTHERWISE SHOWN.

USER NAME = Eric.L.thomas	DESIGNED - M. DE YONG	REVISED - A. ABBAS 03-21-97
	DRAWN - M. GOMEZ 04-06-01	REVISED - M. GOMEZ 04-06-01
	CHECKED - R. BORO 01-01-07	REVISED - R. BORO 01-01-07
PLOT DATE = 12/2/2024	DATE - 06-13-90	REVISED - K. SMITH 11-18-22

STATE OF ILLINOIS
DEPARTMENT OF TRANSPORTATION

BUTT JOINT AND HMA TAPER DETAILS

SCALE: NONE SHEET 1 OF 1 SHEETS STA. TO STA.

F.A.P RTE.	SECTION	COUNTY	TOTAL SHEETS	SHEET NO.
326	FAP 0326 23 RES	KANE	25	16
BD400-05 BD-32		CONTRACT NO. 62V43		
ILLINOIS		FED. AID PROJECT		

MODEL: Plan Single [Sheet]

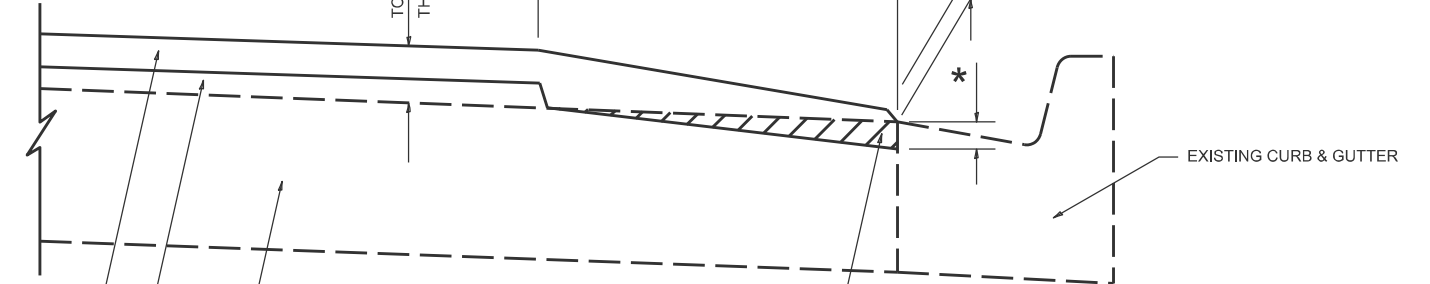

HMA TAPER AT EDGE OF PCC PAVEMENT

HMA SURFACE COURSE		HMA BINDER COURSE	
MIX	THICKNESS	THICKNESS	* MILLING AT GUTTER FLAG
D	1½ (38)	1 (25)	1¼ (33)
E OR SMA 9.5	1¾ (44)	¾ (19)	1½ (38)

ALL DIMENSIONS ARE IN INCHES (MILLIMETERS) UNLESS OTHERWISE SHOWN.

USER NAME = Eric.L.thomas	DESIGNED - R. SHAH	REVISED - R. BORO 01-01-07
	DRAWN - JIS	REVISED - JP CHANG 07-08-16
	CHECKED - A. ABBAS	REVISED - K. SMITH 02-01-22
PLOT DATE = 12/2/2024	DATE - 09-10-94	REVISED - K. SMITH 11-18-22

STATE OF ILLINOIS
DEPARTMENT OF TRANSPORTATION

HMA TAPER AT EDGE OF P.C.C. PAVEMENT

SCALE: NONE	SHEET 1	OF 1	SHEETS	STA.	TO STA.
-------------	---------	------	--------	------	---------

F.A.P RTE.	SECTION	COUNTY	TOTAL SHEETS	SHEET NO.
326	FAP 0326 23 RES	KANE	25	17
BD400-06 BD-33		CONTRACT NO. 62V43		
ILLINOIS		FED. AID PROJECT		

MODEL: Plan Single (Sheet)
FILE NAME: Z:\DOTCAD_ORD Folder Master\ Master Files\DOT CONNECT Configuration\Organization\Civil\DOT Standards\Drawings\Sheet Seeds\Civil_Named_Boundary_SheetSeeds.dgnlib

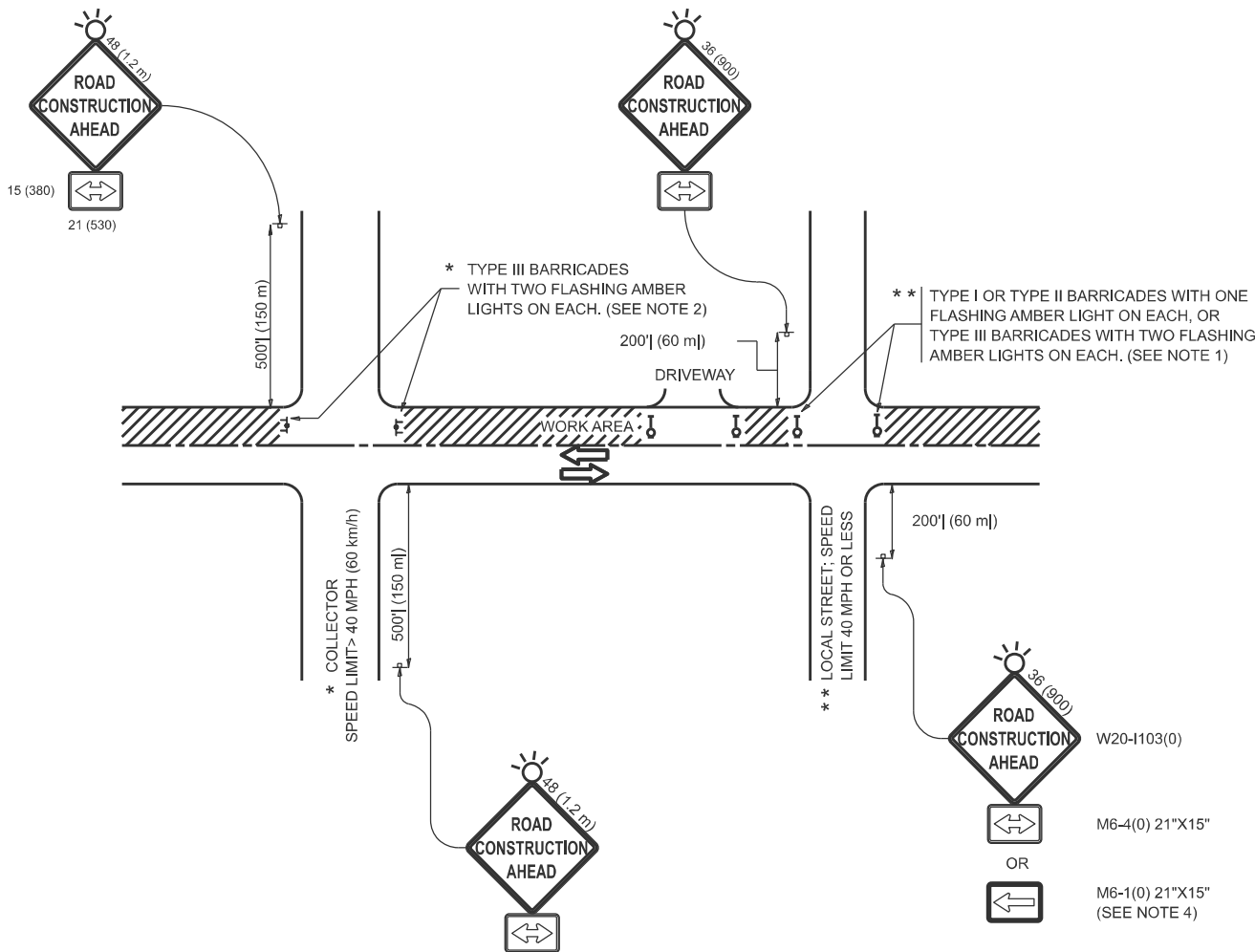

NOTES:

- SIDE ROAD WITH A SPEED LIMIT OF 40 MPH (60 km/h) OR LESS AS SHOWN ON THE DRAWING AND AS DIRECTED BY THE ENGINEER:
 - ONE "ROAD CONSTRUCTION AHEAD" SIGN 36 x 36 (900x900) WITH A FLASHER MOUNTED ON IT APPROXIMATELY 200' (60 m) IN ADVANCE OF THE MAIN ROUTE.
 - THE CLOSED PORTION OF THE MAIN ROUTE SHALL BE PROTECTED BY BLOCKING WITH TYPE I, TYPE II OR TYPE III BARRICADES, 1/3 OF THE CROSS SECTION OF THE CLOSED PORTION.
- SIDE ROAD WITH A SPEED LIMIT GREATER THAN 40 MPH (60 km/h) AS SHOWN ON THE DRAWING AND AS DIRECTED BY THE ENGINEER:
 - ONE "ROAD CONSTRUCTION AHEAD" SIGN 48 x 48 (1.2 m x 1.2 m) WITH A FLASHER MOUNTED ON IT APPROXIMATELY 500' (150 m) IN ADVANCE OF THE MAIN ROUTE.
 - THE CLOSED PORTION OF THE MAIN ROUTE SHALL BE PROTECTED BY BLOCKING WITH TYPE III BARRICADES, 1/2 OF THE CROSS SECTION OF THE CLOSED PORTION.
- CONES MAY BE SUBSTITUTED FOR BARRICADES OR DRUMS AT HALF THE SPACING DURING DAY OPERATIONS. CONES SHALL BE A MINIMUM OF 28 (710) IN HEIGHT.
- WHEN THE SIDE ROAD LIES BETWEEN THE BEGINNING OF THE MAINLINE SIGNING AND THE WORK ZONE, A SINGLE HEADED ARROW (M6-1) SHALL BE USED IN LIEU OF THE DOUBLE HEADED ARROW (M6-4).
- WHEN WORK IS BEING PERFORMED ON A SIDE ROAD OR DRIVEWAY, FOLLOW THE APPLICABLE STANDARD(S). THE DIRECTIONAL ARROW (M6-1 OR M6-4) SHALL BE COVERED OR REMOVED WHEN NO LONGER CONSISTENT WITH THE TRAFFIC CONTROL SET-UP.
- ADVANCE WARNING SIGNS ARE TO BE OMITTED ON DRIVEWAYS UNLESS OTHERWISE SPECIFIED IN THE PLANS OR BY THE ENGINEER.
- THE TRAFFIC CONTROL AND PROTECTION FOR SIDE ROADS, INTERSECTIONS, AND DRIVEWAYS SHALL BE INCLUDED IN THE COST OF SPECIFIED TRAFFIC CONTROL STANDARDS OR ITEMS.

All dimensions are in inches (millimeters) unless otherwise shown.

	USER NAME = Eric.L.thomas	DESIGNED - L.H.A.	REVISED - T. RAMMACHER 01-06-00	STATE OF ILLINOIS DEPARTMENT OF TRANSPORTATION	TRAFFIC CONTROL AND PROTECTION FOR SIDE ROADS, INTERSECTIONS, AND DRIVEWAYS	SCALE:	SHEET	OF	SHEETS	STA.	TO STA.	F.A.P RTE.	SECTION	COUNTY	TOTAL SHEETS	SHEET NO.
		DRAWN -	REVISED - A. SCHUETZE 07-01-13									326	FAP 0326 23 RES	KANE	25	18
		CHECKED -	REVISED - A. SCHUETZE 09-15-06									TC-10		CONTRACT NO. 62V43		
	PLOT DATE = 12/2/2024	DATE - 06-89	REVISED - D. SENDERAK 05-03-24									ILLINOIS FED. AID PROJECT				

MODEL: Pln Single (Sheet)
FILE NAME: Z:\DOTCAD_ORD Folder Master\ Master Files\DOT CONNECT\Configuration\Organization\Civil\DOT Standards\DotbSheet Seeds\Civil_Named_Boundary_Sheets\Seeds.dgnlib

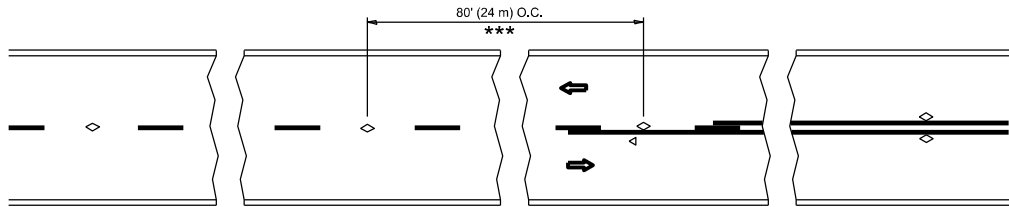

*** REDUCE TO 40' (12 m) O.C. ON CURVES WITH POSTED OR ADVISORY SPEED 45 M.P.H. (70 km/h) OR LESS.

TWO-LANE/TWO-WAY

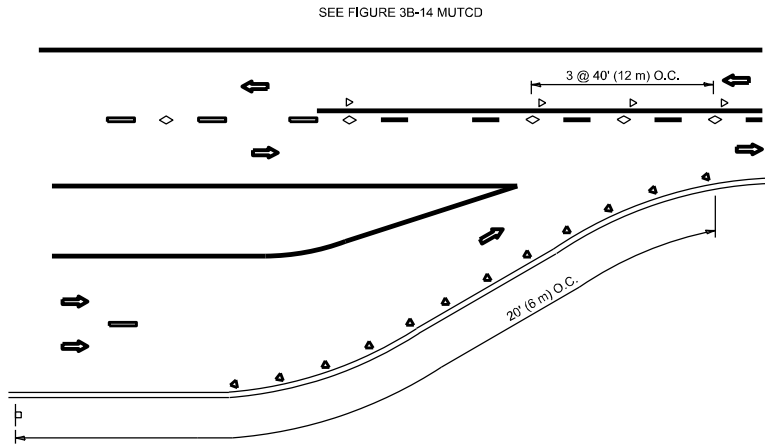

LANE REDUCTION TRANSITION

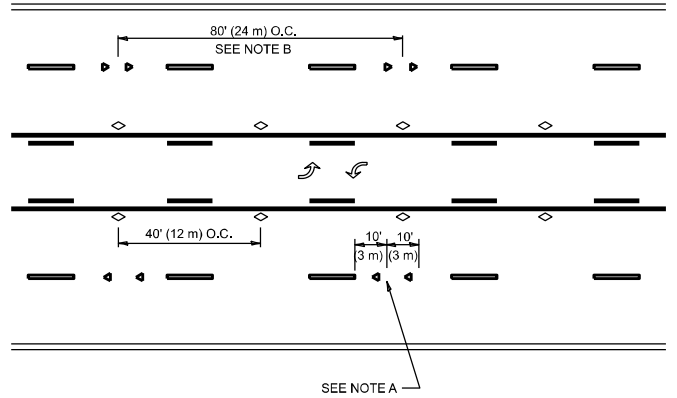

SEE NOTE A

TWO-WAY LEFT TURN

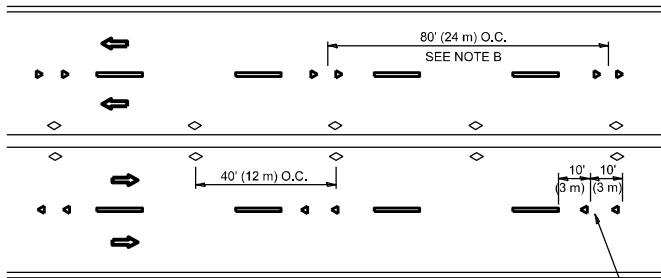

SEE NOTE A

MULTI-LANE/UNDIVIDED

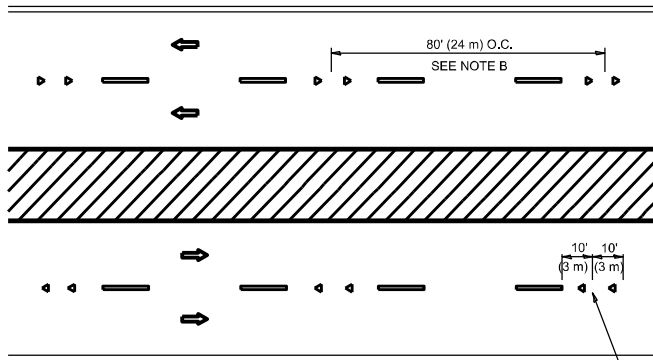

SEE NOTE A

MULTI-LANE/DIVIDED

GENERAL NOTES

- MARKERS USED WITH DASHED LINES SHALL BE CENTERED IN THE GAP BETWEEN SEGMENTS.
- MARKERS USED ADJACENT TO SOLID LINES SHALL BE OFFSET 2 TO 3 (50 TO 75) TOWARD TRAFFIC AS SHOWN.
- MARKERS THROUGH TANGENTS LESS THAN 500' (150 m) IN LENGTH BETWEEN CURVES SHALL BE INSTALLED AT THE LESSER OF THE TWO CURVE SPACINGS.
- MARKERS ARE TO BE USED ADJACENT TO BOTH SOLID WHITE LINES IN DUAL LEFT TURN LANES

SYMBOLS

- YELLOW STRIPE
- WHITE STRIPE
- ONE-WAY AMBER MARKER
- ONE-WAY CRYSTAL MARKER (W/O)
- TWO-WAY AMBER MARKER

LANE MARKER NOTES

- USE DOUBLE LANE LINE MARKERS SPACED AS SHOWN.
- REDUCE TO 40' (12 m) O.C. ON CURVES WHERE ADVISORY SPEEDS ARE 10 M.P.H (20 km/h) LOWER THAN POSTED SPEEDS.

DESIGN NOTES

- DOUBLE LANE LINE MARKERS SHALL BE USED UNLESS SPECIFIED OTHERWISE.
- EXCEPT AS SHOWN ON THE LANE REDUCTION TRANSITION AND FREEWAY EXIT RAMP DETAIL, MARKERS ARE NOT TO BE SPECIFIED ON RIGHT EDGE LINES.
- THE EXACT MARKER LIMITS, SPACING, AND COLOR SHALL BE INCLUDED IN THE PLANS WHEN STANDARD SPECIFICATIONS ARE NOT BEING USED.
- MARKERS SHOULD NOT BE USED ALONGSIDE CURBS EXCEPT FOR EXTREMELY SHORT SECTIONS OF CURBS WHERE NOT MORE THAN TWO MARKERS WOULD BE INVOLVED.

All dimensions are in inches (millimeters) unless otherwise shown.

TURN LANES

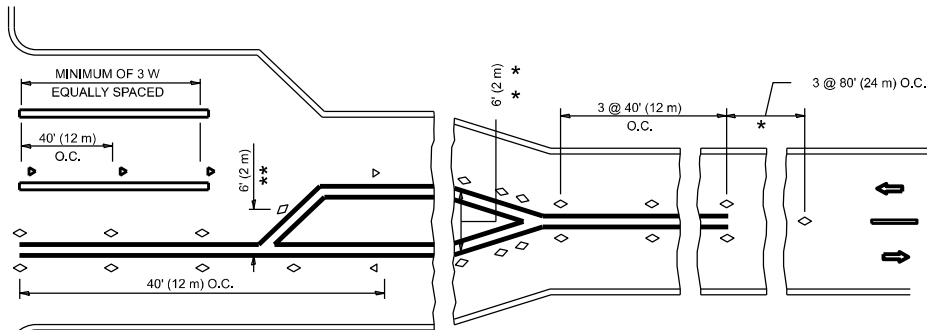
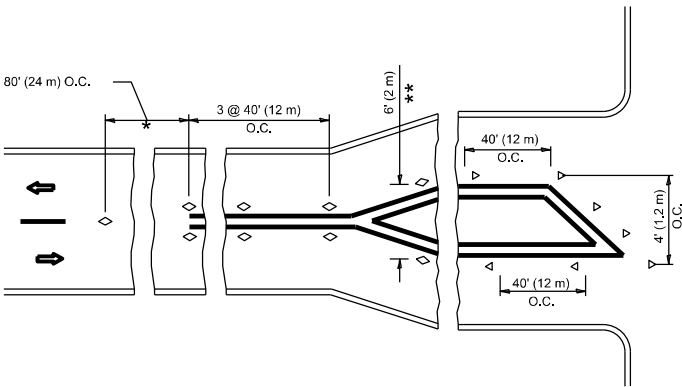

- * SEE TWO-LANE/TWO-WAY WHERE MARKERS CONTINUE
- ** WHERE THE MEDIAN WIDTH IS 6' (2 m) OR LESS USE TWO-WAY MARKERS.

STATE OF ILLINOIS
DEPARTMENT OF TRANSPORTATION

TYPICAL APPLICATIONS
RAISED REFLECTIVE PAVEMENT MARKERS (SNOW-PLOW RESISTANT)

SCALE: NONE SHEET 1 OF 1 SHEETS STA. TO STA.

F.A.P RTE.	SECTION	COUNTY	TOTAL SHEETS	SHEET NO.
326	FAP 0326 23 RES	KANE	25	19
TC-11		CONTRACT NO. 62V43		
ILLINOIS		FED. AID PROJECT		

TURN BAY ENTRANCE AT START
OF LANE CLOSURE TAPER

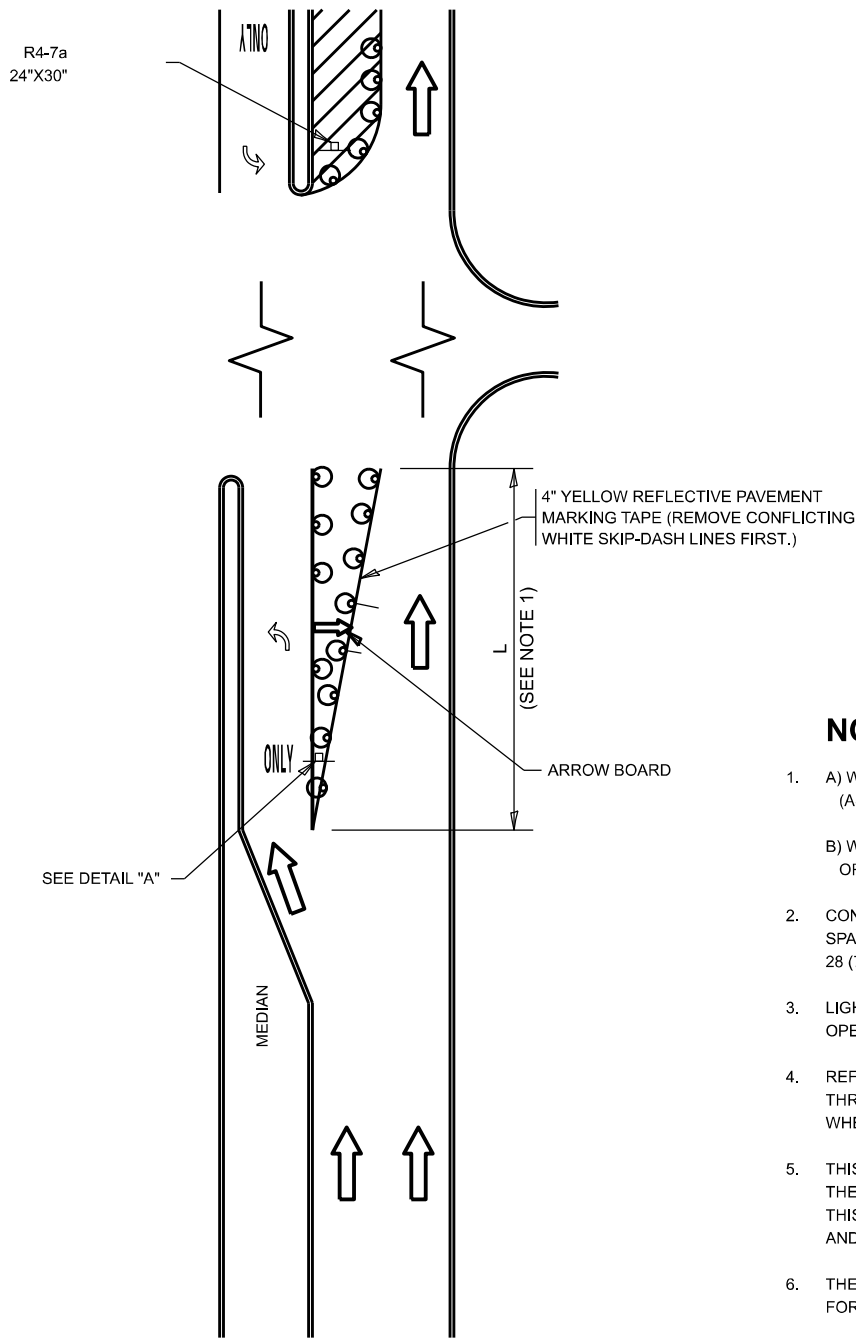

FIGURE 1

LEGEND

- WORK AREA
- LANE OPEN TO TRAFFIC
- ARROW BOARD
- TYPE I OR II BARRICADE OR DRUM WITH STEADY BURN LIGHT
- DRUM WITH STEADY BURN LIGHT
- SIGN ASSEMBLY
- TYPE I OR II CHECK BARRICADE WITH FLASHING LIGHT

NOTES:

- A) WHEN "L" IS \leq THE STORAGE LENGTH OF THE TURN LANE (AS SHOWN IN FIG. 1), USE FIGURE 1.
B) WHEN "L" IS $>$ THE STORAGE LENGTH OF THE TURN LANE OR THE TURN LANE IS WITHIN THE LANE CLOSURE, USE FIGURE 2.
- CONES MAY BE SUBSTITUTED FOR BARRICADES OR DRUMS AT HALF THE SPACING DURING DAY OPERATIONS. CONES SHALL BE A MINIMUM OF 28 (710) IN HEIGHT.
- LIGHTS WILL NOT BE REQUIRED ON BARRICADES OR DRUMS FOR DAY OPERATIONS. ALL LIGHTS SHALL BE MONODIRECTIONAL.
- REFLECTIVE TEMPORARY PAVEMENT MARKINGS SHALL BE PLACED THROUGHOUT THE BARRICADED AREAS OF EACH TURN BAY AS SHOWN WHERE THE CLOSURE TIME IS GREATER THAN FOURTEEN (14) DAYS.
- THIS APPLICATION ALSO APPLIES WHEN WORK IS BEING PERFORMED IN THE RIGHT LANE(S) AND THE RIGHT TURN BAY IS TO REMAIN OPEN. UNDER THIS CONDITION, "RIGHT TURN LANE" R3-I100R 24 x 24 (600 x 600) AND M6-2R 21 x 15 (530 x 380) SHALL BE USED.
- THESE CONTROLS SHALL SUPPLEMENT MAINLINE TRAFFIC CONTROL FOR LANE CLOSURES.
- THE SIGNS SHALL BE MOUNTED ABOVE THE BARRICADES/DRUMS ON SEPARATE SIGN SUPPORTS THAT MEET NCHRP 350 OR MASH REQUIREMENTS.
- TRAFFIC CONTROL AND PROTECTION AT TURN BAYS (TO REMAIN OPEN TO TRAFFIC) SHALL BE INCLUDED IN THE COST OF SPECIFIED TRAFFIC CONTROL STANDARDS OR ITEMS.

TURN BAY ENTRANCE
WITHIN A LANE CLOSURE

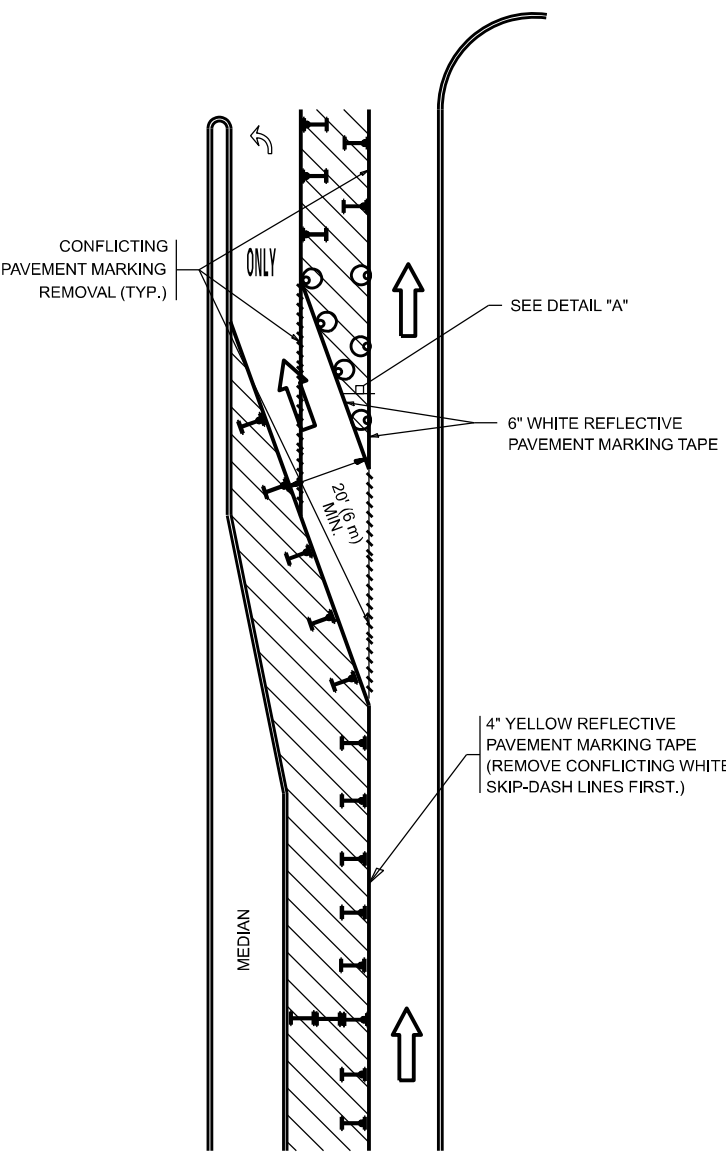
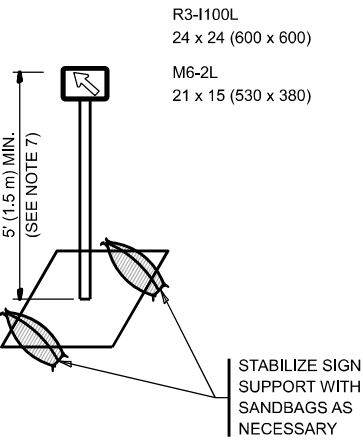

FIGURE 2



DETAIL A

All dimensions are in inches (millimeters) unless otherwise shown.

MODEL: Plan Single (Sheet)
FILE NAME: Z:\DOTCAD\ORD Folder Master\ Master Files\DOT\CONNECT\Configuration\Organization\Civil\DOT_Standards\Drawings\Sheet Seeds\Civil_Named_Boundary_SheetSeeds.dgnlib

USER NAME	= Eric.L.thomas
DESIGNED	- T. RAMMACHER 09-08-94
DRAWN	- A. HOUSEH 11-07-95
CHECKED	- A. HOUSEH 10-12-96
PLOT DATE	= 12/2/2024
DATE	- T. RAMMACHER 01-06-00

REVISED	- R. BORO 09-14-09
REVISED	- A. SCHUETZE 07-01-13
REVISED	- A. SCHUETZE 09-15-16
REVISED	-

STATE OF ILLINOIS
DEPARTMENT OF TRANSPORTATION

TRAFFIC CONTROL AND PROTECTION AT TURN BAYS
(TO REMAIN OPEN TO TRAFFIC)

SCALE: NONE SHEET 1 OF 1 SHEETS STA. TO STA.

F.A.P RTE.	SECTION	COUNTY	TOTAL SHEETS	SHEET NO.
62V23	FAP 0326 23 RES	KANE	25	21
TC-14		CONTRACT NO. 62V43		
ILLINOIS		FED. AID PROJECT		

MODEL: Pln Single Sheet
FILE NAME: Z:\DOTCAD ORD Folder Master\ Master Files\DOT CONNECT Configuration\Organization\Civil\DOT_Standards\Drawlib\Sheet Seeds\Civil_Named_Boundary_Sheet\Seeds.dgnlib

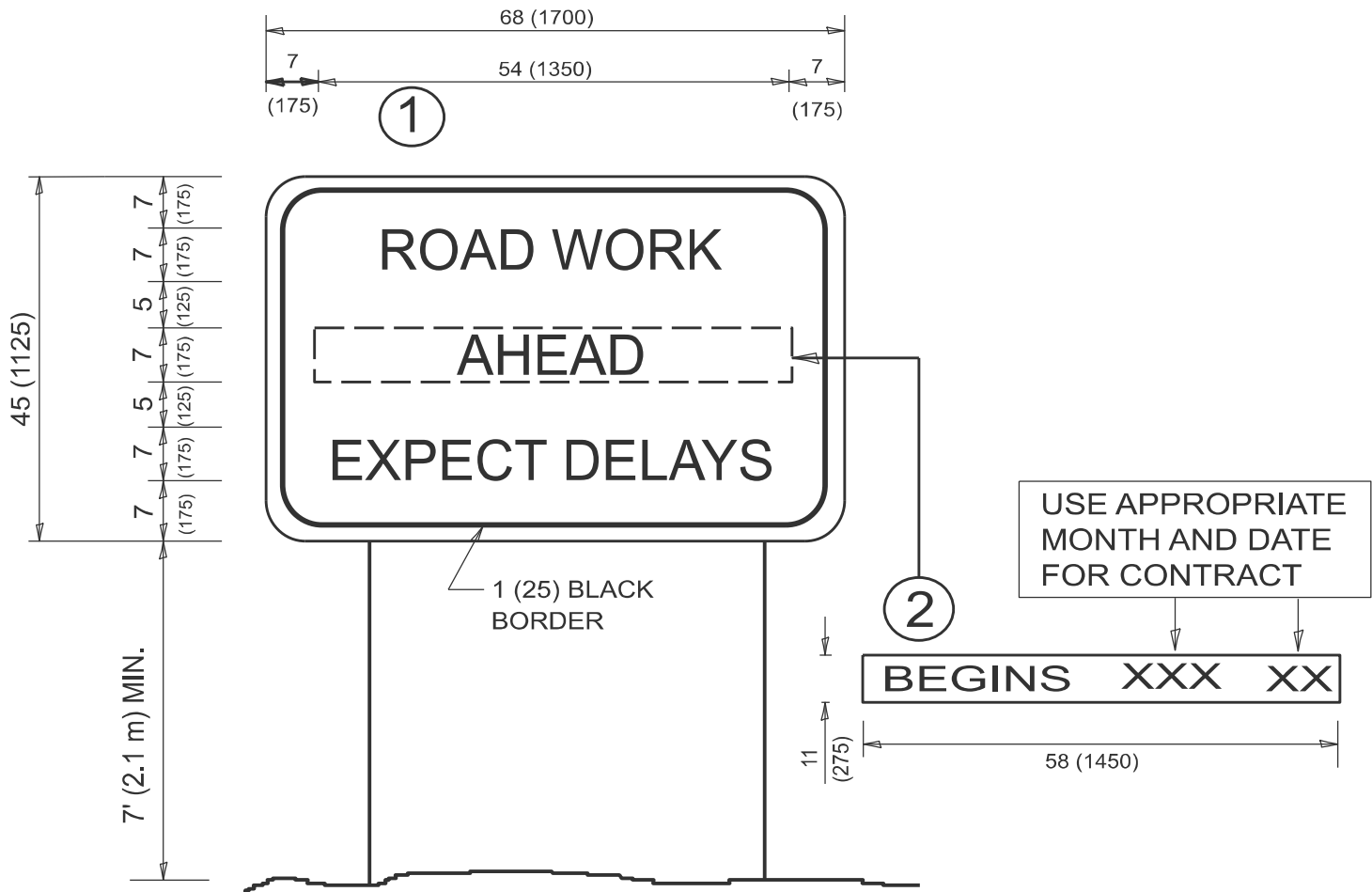

NOTES:

1. USE BLACK LETTERING ON ORANGE BACKGROUND.
2. ERECT SIGNS IN ADVANCE OF THE LOCATION FOR THE "ROAD CONSTRUCTION AHEAD" SIGN AT LOCATIONS AS DIRECTED BY THE ENGINEER.
3. ERECT SIGN ① WITH INSTALLED PANEL ② ONE WEEK PRIOR TO THE START OF CONSTRUCTION.
4. REMOVE PANEL ② SOON AFTER THE START OF CONSTRUCTION.
5. SEE SPECIAL PROVISION FOR "TEMPORARY INFORMATION SIGNING" FOR ADDITIONAL INFORMATION.
6. ONE SIGN ASSEMBLY EQUALS 25.70 SQ. FT. (2.3 SQ. M.)
7. SHALL BE PAID FOR AS TEMPORARY INFORMATION SIGNING.

ALL DIMENSIONS ARE IN INCHES (MILLIMETERS)
UNLESS OTHERWISE SHOWN.

	USER NAME = Eric.L.thomas	DESIGNED -	REVISED - R. MIRS 09-15-97	STATE OF ILLINOIS DEPARTMENT OF TRANSPORTATION	ARTERIAL ROAD INFORMATION SIGN				F.A.P RTE.	SECTION	COUNTY	TOTAL SHEETS	SHEET NO.
		DRAWN -	REVISED - R. MIRS 12-11-97						326	FAP 0326 23 RES	KANE	25	23
		CHECKED -	REVISED - T. RAMMACHER 02-02-99						TC-22		CONTRACT NO. 62V43		
	PLOT DATE = 12/2/2024	DATE -	REVISED - C. JUCIUS 01-31-07						ILLINOIS FED. AID PROJECT				
					SCALE: NONE	SHEET 1	OF 1	SHEETS	STA.	TO STA.			

MODEL: Pln Signls (Sheet)
FILE NAME: Z:\DOTCAD_0RD Folder Master\ Master Files\DOT_CONNECT\Configuration\Organization\Civil\DOT_Standards\Signls\Sheet Seeds\Civil_Named_Boundary_Sheet\Seeds.dgnlib

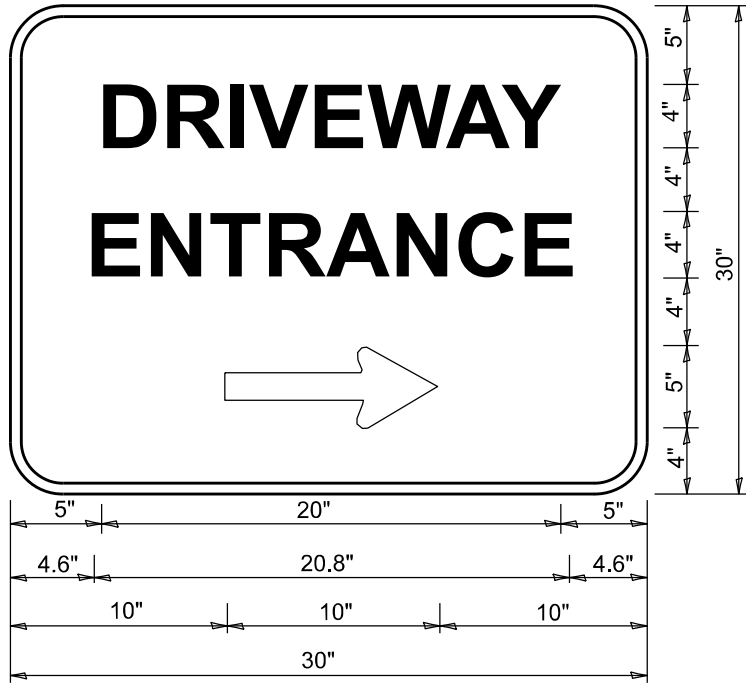

3.0" RADIUS, 0.5" BORDER, WHITE ON GREEN; REFLECTORIZED
"DRIVEWAY" D; "ENTRANCE" D; STANDARD ARROW CUSTOM 12.0" x 5.0"

NOTES:

1. HALF OF THE SIGNS WILL REQUIRE A LEFT HAND FACING ARROW.
2. TWO SIGNS SHALL BE USED AT EACH COMMERCIAL ENTRANCE
PLACED BACK-TO-BACK: ONE WITH A RIGHT HAND ARROW (SHOWN)
SHALL BE PLACED ON THE NEAR RIGHT SIDE THE DRIVEWAY
AND ONE WITH A LEFT HAND ARROW SHALL BE PLACED ON THE
FAR LEFT SIDE OF THE DRIVEWAY.
3. SIGNS TO BE PAID FOR AS ITEM "TEMPORARY INFORMATION SIGNING".

	USER NAME = Eric.L.thomas	DESIGNED -	REVISED - C. JUCIUS 02-15-07	STATE OF ILLINOIS DEPARTMENT OF TRANSPORTATION	DRIVEWAY ENTRANCE SIGNING			F.A.P RTE.	SECTION	COUNTY	TOTAL SHEETS	SHEET NO.
		DRAWN -	REVISED -					326	FAP 0326 23 RES	KANE	25	24
		CHECKED -	REVISED -		TC-26			CONTRACT NO. 62V43				
	PLOT DATE = 12/2/2024	DATE -	REVISED -		SCALE: NONE	SHEET 1	OF 1 SHEETS	STA.	TO STA.	ILLINOIS FED. AID PROJECT		

MODEL: Plan Single (Sheet)
FILE NAME: Z:\DOTCAD_ORD Folder Master\Master Files\DOT CONNECT\Configuration\Organization-Civil\DOT_Standards\Drawings\Sheet Seeds\Civil_Named_Boundary_SheetSeeds.dgnlib

LOOPS NEXT TO SHOULDERS

PROVIDE A PAVEMENT REPLACEMENT
NOTE WHICH SHOULD EQUAL
3' (900 mm) X WIDTH OF
PAVED SHOULDER.

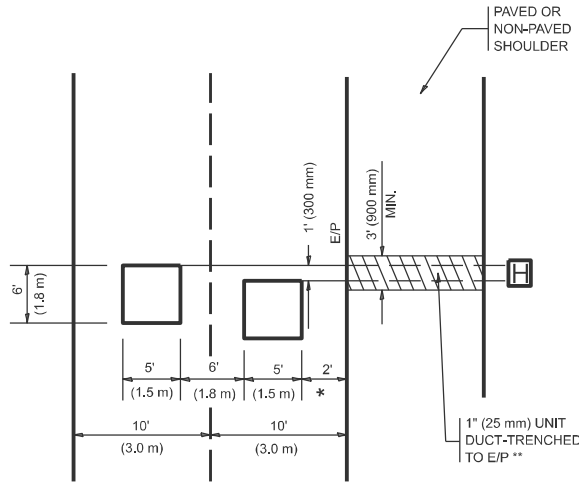

* = (600 mm)

** UNIT DUCT IS TO BE SHOWN ON PLAN SHEETS
BUT SHALL NOT BE INCLUDED IN THE PAY ITEMS.

LEFT TURN LANES WITH MEDIANS

VOLUME DENSITY ("FAR OUT" DETECTION)
ON SAME APPROACH
(PROTECTED / PERMITTED LEFT TURN PHASING)

HANDHOLE LOCATION MAY
VARY DEPENDING ON GEOMETRICS
AND DESIGN OF TRAFFIC SIGNALS.
HEAVY-DUTY HANDHOLES TO BE
USED WHEN THE MEDIAN IS
MOUNTABLE. REFER TO STANDARD
814001 TO ENSURE THAT HANDHOLE
FITS IN MEDIAN.

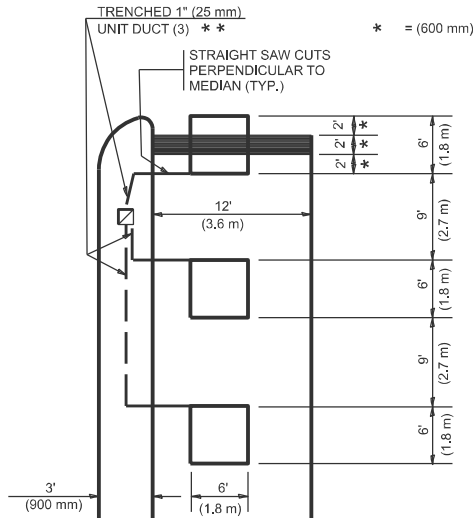

** UNIT DUCT IS TO BE SHOWN ON PLAN SHEETS
BUT SHALL NOT BE INCLUDED IN THE PAY ITEMS.

NOTE: DUAL LEFT TURNS NOT SHOWN REFER TO
PLAN SHEET FOR DETECTOR LOOP REPLACEMENT

LEFT TURN LANES WITHOUT MEDIANS

VOLUME DENSITY ("FAR OUT" DETECTION)
ON SAME APPROACH
(PROTECTED / PERMITTED LEFT TURN PHASING)

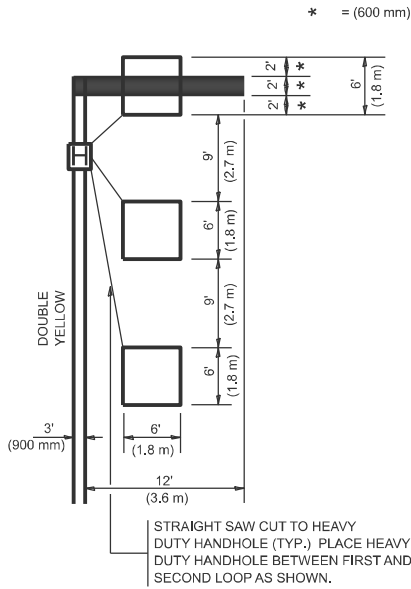

NOTE: DUAL LEFT TURNS NOT SHOWN REFER TO
PLAN SHEET FOR DETECTOR LOOP REPLACEMENT

ARTERIAL-VOLUME DENSITY ("FAR OUT" DETECTION)
CROSS STREET-NON VOLUME DENSITY ("FAR OUT" DETECTION)

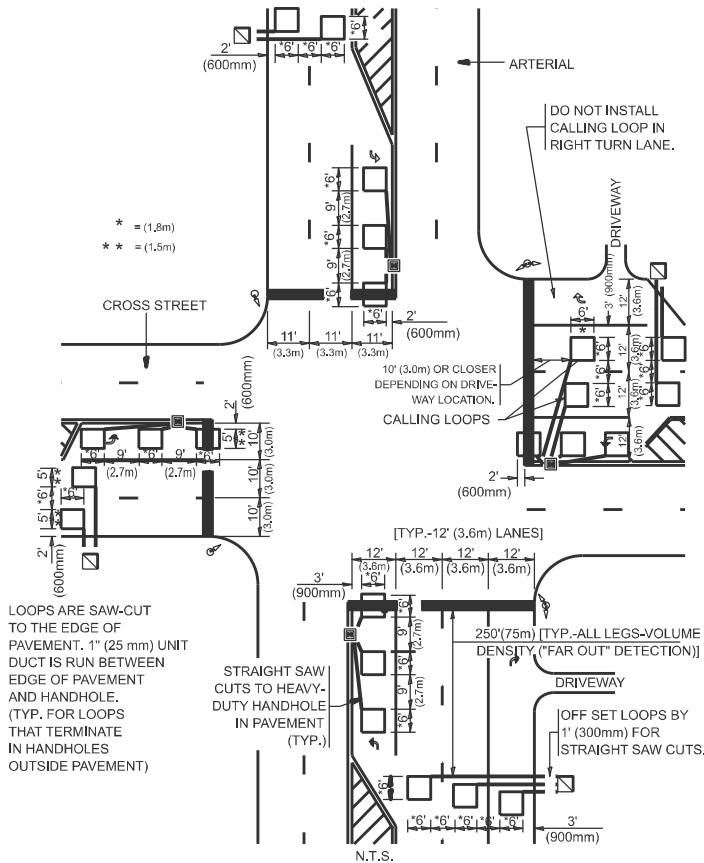

DETAIL 1
N.T.S.

ARTERIAL-VOLUME DENSITY ("FAR OUT" DETECTION)
CROSS STREET-NON VOLUME DENSITY ("UPTIGHT" PRESENCE DETECTION)

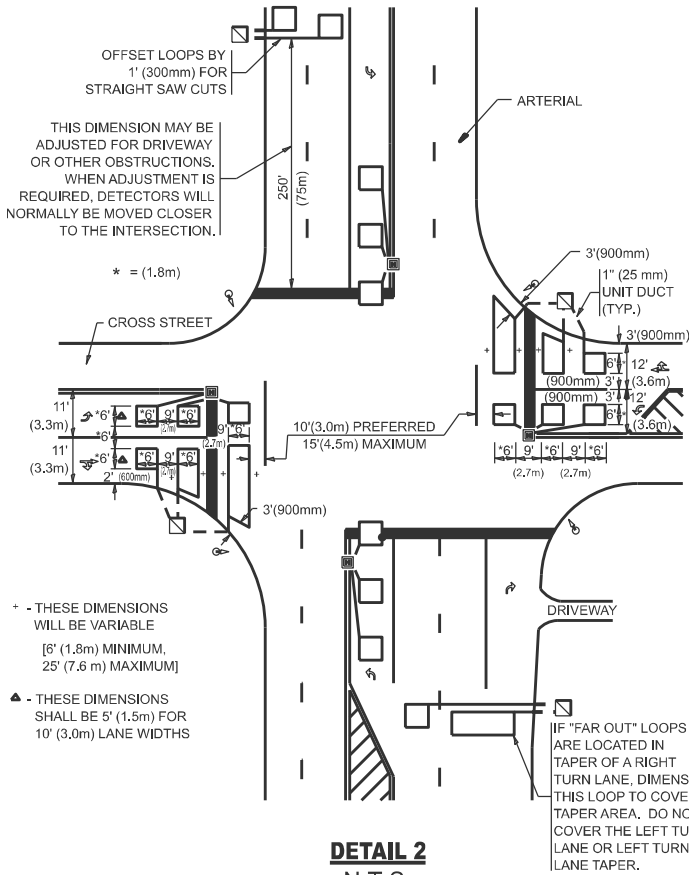

DETAIL 2
N.T.S.

NOTES:

VEHICLES LOOP DETECTORS

- * ALL LEAD IN CABLE SHALL BE TWO CONDUCTOR NO. 14 TWISTED, SHIELDED.
- * EACH DETECTOR LOOP SHALL HAVE ITS OWN SAW CUT FROM THE LOOP TO THE EDGE OF PAVEMENT OR TO A HANDHOLE IN THE PAVEMENT.
- * EACH DETECTOR LOOP SHALL HAVE ITS OWN ONE INCH (25 mm) UNIT DUCT BETWEEN THE EDGE OF PAVEMENT AND THE FIRST HANDHOLE OR JUNCTION BOX. EACH UNIT DUCT RUN SHALL BE SHOWN ON THE PLANS BY THE DESIGNER, BUT SHALL NOT BE PAID FOR SEPARATLY. THIS ITEM IS INCIDENTAL TO THE PAY ITEM FOR DETECTOR LOOPS.
- * ONE DIMENSION OF ALL DETECTOR LOOPS SHALL BE SIX FEET (1.8 m)
- * EACH LANE OF NON-LOCKING, PRESENCE DETECTION AND EACH LANE OF A DOUBLE LEFT TURN LANE REQUIRES A SEPARATE INDUCTIVE LOOP DETECTOR AND LEAD IN CABLE.
- * WHEN NON-LOCKING, PRESENCE DETECTION IS USED, MORE THAN ONE LOOP PER LANE IS REQUIRED BEHIND THE STOP BAR (i.e. 1-1/2, 1-3/4, 2).
- * WHEN SYSTEM LOOPS ARE REQUIRED ON AN APPROACH OF AN INTERSECTION, THE LOOPS USED FOR VOLUME DENSITY AND INTERSECTION TIMING SHALL ALSO BE USED AS SYSTEM DETECTORS. EACH ONE OF THESE TYPE OF LOOPS REQUIRES A SEPARATE TWO CONDUCTOR NO. 14 TWISTED SHIELDED CABLE AND A SEPARATE INDUCTIVE LOOP DETECTOR WHEN NEW CONTROLLERS ARE UTILIZED. THE DESIGNER SHALL LABEL THESE TYPES OF LOOPS AS "INTERSECTION AND SAMPLING (SYSTEM) DETECTORS" ON THE SIGNAL LAYOUT, THE INTERCONNECT PLAN AND THE SYSTEM CABLE PLAN. WHEN AN EXISTING CONTROLLER IS UTILIZED FOR THIS TYPE OF DETECTION, THE PAY ITEM "INDUCTIVE LOOP DETECTOR WITH SYSTEM OUTPUT" SHOULD BE USED.

PLACEMENT OF DETECTORS

THE FOLLOWING FIGURES REPRESENT THE MOST COMMON DETECTOR LOOP LOCATIONS AND SIZES. ADJUSTMENTS WILL BE NECESSARY FOR SPECIFIC GEOMETRIC CONSIDERATIONS.

LOCATIONS AND DEMENSIONS OF DETECTOR LOOPS ARE REQUIRED ON ALL SIGNAL LAYOUT PLAN SHEETS.

"FAR OUT" DETECTION REFERS TO LOCKING, PRESENCE TYPE DETECTION LOCATED IN THRU LANES, RIGHT TURN LANES, AND RIGHT TURN LANE TAPER AREAS (IF APPLICABLE), USUALLY 250' (75 m) IN ADVANCE OF STOP BARS. "UPTIGHT" DETECTION REFERS TO NON-LOCKING PRESENCE TYPE DETECTION LOCATED IN ALL LANES AND 10'-15' (3.0 m-4.5 m) BEHIND THE CROSSING STREET'S EDGE OF PAVEMENT EXTENDED.

NOTE:

ALL DETAILS AND NOTES SHOWN ARE FROM THE I.D.O.T. DISTRICT 1 TRAFFIC SIGNAL DESIGN GUIDELINES DATED JANUARY 1995

THIS DRAWING HAS BEEN PREPARED TO ASSIST THE RESIDENT ENGINEER FOR ALL ROADWAY RESURFACING OR S.M.A.R.T. PROJECTS WHERE THE DIMENSIONS ARE NOT SHOWN ON THE PLANS AND THE FINAL LOCATIONS FOR CROSSWALKS OR STOP BARS ARE NOT DETERMINED.

USER NAME = Eric.L.thomas	DESIGNED -	REVISED -
	DRAWN -	REVISED -
	CHECKED - R.K.F.	REVISED -
PLOT DATE = 12/2/2024	DATE -	REVISED -

STATE OF ILLINOIS
DEPARTMENT OF TRANSPORTATION

DISTRICT 1 - DETECTOR LOOP INSTALLATION
DETAILS FOR ROADWAY RESURFACING

SCALE: NONE SHEET 1 OF 1 SHEETS STA. TO STA.

F.A.P RTE.	SECTION	COUNTY	TOTAL SHEETS	SHEET NO.
326	FAP 0326 23 RES	KANE	25	25
TS-07		CONTRACT NO. 62V43		
ILLINOIS		FED. AID PROJECT		