

STATE OF ILLINOIS
DEPARTMENT OF TRANSPORTATION

F.A. RTE.	SECTION	COUNTY	TOTAL SHEETS	SHEET NO.
VAR	DIST 8 SEAL COAT 2026-1	MONROE, ST CLAIR	8	1
		ILLINOIS	CONTRACT NO. 76U71	

FOR INDEX OF SHEETS, SEE SHEET NO. 2

HILL CASTLE RD 0.00 TO 0.61 TRAFFIC DATA

2024 ADT = 100 (ESTIMATED)
2026 ADT = 100 (ESTIMATED)
2046 ADT = 125 (ESTIMATED)
SU = 0.2% MU = 0.0%

HILL CASTLE RD 0.61 TO 1.05 TRAFFIC DATA

2024 ADT = 300 (ESTIMATED)
2026 ADT = 300 (ESTIMATED)
2046 ADT = 350 (ESTIMATED)
SU = 0.2% MU = 0.0%

HILL CASTLE LN 0.00 TO 0.07 TRAFFIC DATA

2024 ADT = 10 (ESTIMATED)
2026 ADT = 10 (ESTIMATED)
2046 ADT = 10 (ESTIMATED)
SU = 0.0% MU = 0.0%

OLD IL RT 156 0.00 TO 0.96 TRAFFIC DATA

2023 ADT = 200 (ACTUAL)
2026 ADT = 200 (ESTIMATED)
2046 ADT = 225 (ESTIMATED)
SU = 4.5% MU = 2.5%

DOYLE RD 0.00 TO 0.13 TRAFFIC DATA

2025 ADT = 25 (ESTIMATED)
2026 ADT = 25 (ESTIMATED)
2046 ADT = 25 (ESTIMATED)
SU = 6.0% MU = 1.0%

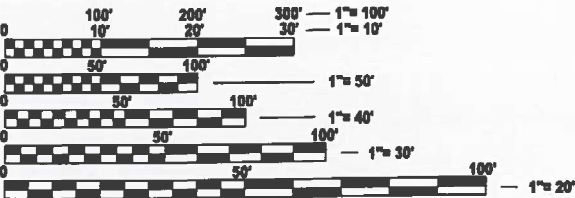

FULL SIZE PLANS HAVE BEEN PREPARED USING STANDARD ENGINEERING SCALES. REDUCED SIZED PLANS WILL NOT CONFORM TO STANDARD SCALES. IN MAKING MEASUREMENTS ON REDUCED PLANS, THE ABOVE SCALES MAY BE USED.

J.U.L.I.E.
JOINT UTILITY LOCATION INFORMATION FOR EXCAVATION
1-800-892-0123
OR 811

PROJECT ENGINEER: CHERYL KEPLAR
PROJECT MANAGER: BRANDON HUMPHREYS

CONTRACT NO. 76U71

**PROPOSED
HIGHWAY PLANS**

VARIOUS ROUTES
DIST 8 SEAL COAT 2026-1
CHIP SEAL - CM
MONROE, ST CLAIR COUNTY

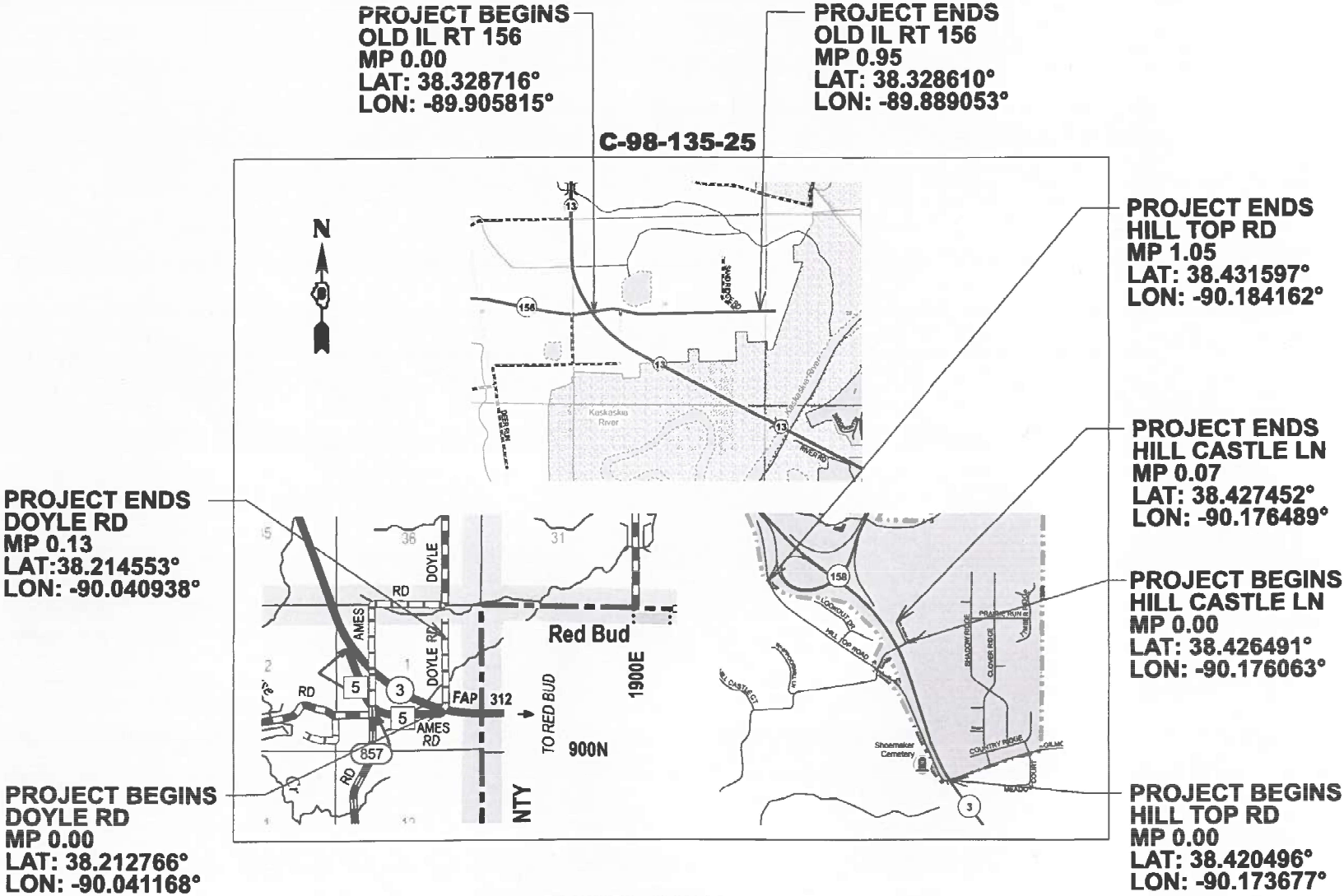

PROJECT BEGINS
OLD IL RT 156
MP 0.00
LAT: 38.328716°
LON: -89.905815°

PROJECT ENDS
OLD IL RT 156
MP 0.95
LAT: 38.328610°
LON: -89.889053°

C-98-135-25

PROJECT ENDS
HILL TOP RD
MP 1.05
LAT: 38.431597°
LON: -90.184162°

PROJECT ENDS
HILL CASTLE LN
MP 0.07
LAT: 38.427452°
LON: -90.176489°

PROJECT BEGINS
HILL CASTLE LN
MP 0.00
LAT: 38.426491°
LON: -90.176063°

PROJECT BEGINS
HILL TOP RD
MP 0.00
LAT: 38.420496°
LON: -90.173677°

PROJECT ENDS
DOYLE RD
MP 0.13
LAT: 38.214553°
LON: -90.040938°

PROJECT BEGINS
DOYLE RD
MP 0.00
LAT: 38.212766°
LON: -90.041168°

GROSS LENGTH = 11,668.8 FT. = 2.21 MILE
NET LENGTH = 11,668.8 FT. = 2.21 MILE

D-98-066-25



LOCATION OF SECTION INDICATED THUS: -

STATE OF ILLINOIS
DEPARTMENT OF TRANSPORTATION

SUBMITTED *Dec 18 20 05*

[Signature] REGIONAL ENGINEER

January 23 20 26

[Signature] ENGINEER OF DESIGN AND ENVIRONMENT

January 23 20 26

[Signature] DIRECTOR OF HIGHWAYS PROJECT IMPLEMENTATION

PRINTED BY THE AUTHORITY
OF THE STATE OF ILLINOIS

MODEL: General Note Sheet (Sheet)
FILE NAME: c:\pwworking\prijusha.ujoodha@illinois.gov\d1154445\0876\71-shi-gennotes.dgn

INDEX OF SHEETS

- 1COVER SHEET
- 2INDEX OF SHEETS, HIGHWAY STANDARDS, GENERAL NOTES, & COMMITMENTS
- 3SUMMARY OF QUANTITIES
- 4-6TYPICAL SECTIONS
- 7SCHEDULE OF QUANTITIES
- 8LOCATION MAP SHEET

COMMITMENTS

NONE

HIGHWAY STANDARDS

- 000001-09STANDARD SYMBOLS, ABBREVIATIONS AND PATTERNS
- 001006DECIMAL OF AN INCH AND OF A FOOT
- 701006-05OFF-RD OPERATIONS, 2L, 2V, 15'(4.5 M) TO 24"(600mm) FROM PAVEMENT EDGE
- 701201-05LANE CLOSURE, 2L, 2V, DAY ONLY FOR SPEEDS ≥ 45 MPH
- 701301-04LANE CLOSURE, 2L, 2W, SHORT TIME OPERATIONS
- 701306-04LANE CLOSURE, 2 LANE 2 WAY SLOW MOVING OPERATION, DAY ONLY 45MPH OR MORE
- 701901-11TRAFFIC CONTROL DEVICES
- 780001-05TYPICAL PAVEMENT MARKINGS

GENERAL NOTES

1. AGENCIES KNOWN TO HAVE FACILITIES WITHIN THE PROJECT AREA ARE AS FOLLOWS:

UTILITY	ABOVE GROUND	BELOW GROUND
AMEREN ILLINDIS (GAS & ELECTRIC)	X	X
AT&T ILLINOIS	X	X
CHARTER COMMUNICATIONS, INC	X	X
CLEARWAVE FIBER LLC	X	X
CITY OF COLUMBIA (WATER & SANITARY SEWER)		X
HARRISONVILLE TELEPHONE COMPANY	X	X
ILLINOIS AMERICAN WATER COMPANY		X
MONROE COUNTY ELECTRIC CO-OPERATIVE, INC (ELECTRIC)	X	X
NEWWAVE COMMUNICATIONS	X	X
RED BUD UTILITIES PLANT (WATER & SANITARY SEWER)		X
RED BUD UTILITIES PLANT (GAS & ELECTRIC)	X	X

2. THE RESIDENT ENGINEER SHALL VERIFY THE EXISTENCE OF HIGHWAY LIGHTING, INTELLIGENT TRANSPORTATION SYSTEMS (I.T.S.) UTILITIES, AND/OR ELECTRICAL CABLES ASSOCIATED WITH TRAFFIC SIGNALS WITHIN THE PROJECT LIMITS. IF ANY OF THESE EXIST WITHIN THE PROJECT LIMITS, AND IF THESE ITEMS REQUIRE LOCATING, THE CONTRACTOR SHALL BE DIRECTED TO DO SO ACCORDING TO SECTION 803 OF THE STANDARD SPECIFICATIONS. THIS WORK SHALL BE PAID FOR ACCORDING TO ARTICLE 109.04 OF THE STANDARD SPECIFICATIONS.
3. NO SURVEY WAS PERFORMED FOR THIS PROJECT AND THE PLANS WERE CREATED USING MICROFILM AND FIELD MEASUREMENTS.
4. ALL TURF AREAS DISTURBED BY THE CONTRACTOR SHALL BE SEEDED WITH THE APPROPRIATE EROSION CONTROL, AS DIRECTED BY THE ENGINEER, AT THE CONTRACTOR'S EXPENSE.
5. THE DEPARTMENT STRONGLY ENCOURAGES THE PRIME CONTRACTOR AND THIER APPROVED SUB-CONTRACTORS TO HIRE MINORITY, WOMEN AND DISADVANTAGED INDIVIDUALS FROM ITS FEDERALLY FUNDED HIGHWAY CONSTRUCTION CAREERS TRAINING PROGRAM (HCCTP) TO HELP MEET WORKFORCE AND TRAINEE GOALS. THIS PROGRAM IS TRAINING MINORITIES, WOMEN AND DISADVANTAGED INDIVIDUALS IN HIGHWAY CONSTRUCTION RELATED SKILLS, E.G., MATH FOR THE TRADES, JOB READINESS, TECHNICAL SKILLS COURSEWORK (CARPENTRY, CONCRETE FLATWORK, BLUEPRINT READING, SITE PLANS, SITE WORK, TOOLS USE, ECT.) AND OSHA 10 HOUR CERTIFICATION, TO PREPARE THEM FOR A CAREER IN THE HIGHWAY CONSTRUCTION TRADES. GRADUATES ARE WELL-TRAINED AND READY TO BECOME PRODUCTIVE ENTRY-LEVEL CONSTRUCTION WORKERS. CONTRACT THE DISTRICT 8 EEO OFFICE AT 618-346-3360 AND/OR THE HCCTP COORDINATOR AT 618-674-6528 TO LEARN MORE ABOUT THE PROGRAM AND FOR ASSISTANCE IN MEETING WORKFORCE AND TRAINEE GOALS.
6. THE CONTRACTOR SHALL USE CA-16 FOR THE SEAL AND COVER AGGREGATE.

REV - MS

	USER NAME = priyusha.ujoodha	DESIGNED -	REVISED -	STATE OF ILLINOIS DEPARTMENT OF TRANSPORTATION	INDEX OF SHEETS, HIGHWAY STANDARDS, GENERAL NOTES, AND COMMITMENTS	F.A RTE.	SECTION	COUNTY	TOTAL SHEETS	SHEET NO.	
		DRAWN -	REVISED -			VAR	DIST 8 SEAL COAT 2026-1	MONROE, ST CLAIR	8	2	
		CHECKED -	REVISED -			CONTRACT NO. 76U71					
	PLOT DATE = 12/9/2025	DATE -	REVISED -			SCALE:	SHEET 1	OF 1	SHEETS	STA.	TO STA.
								ILLINOIS FED. AID PROJECT			

MODEL - Summary Of Quantity (Sheet)
FILE NAME: c:\pva_work\pva\td\pvyusha.ujhoda@illinois.gov\1154445\0876\U71-sh-SOQ.dgn

CODE NO.	ITEM	UNIT	TOTAL QUANTITY	CONSTRUCTION CODE		
				100% STATE ST. CLAIR COUNTY	100% STATE MONROE COUNTY	100% STATE MONROE COUNTY
				ROADWAY	ROADWAY	ROADWAY
				0005	0005	0005
				RURAL	RURAL	URBAN
67100100	MOBILIZATION	L SUM	1	0.25	0.25	0.5
70100450	TRAFFIC CONTROL AND PROTECTION, STANDARD 701201	L SUM	1			1
70100460	TRAFFIC CONTROL AND PROTECTION, STANDARD 701306	L SUM	1	0.5	0.5	
70300100	SHORT TERM PAVEMENT MARKING	FOOT	456	456		
70300150	SHORT TERM PAVEMENT MARKING REMOVAL	SQ FT	152	152		
70300241	TEMPORARY PAVEMENT MARKING - LINE 6"- PAINT	FOOT	11286	11286		
70300251	TEMPORARY PAVEMENT MARKING - LINE 8"- PAINT	FOOT	97	97		
* 78001130	PAINT PAVEMENT MARKING - LINE 6"	FOOT	11286	11286		
* 78001140	PAINT PAVEMENT MARKING - LINE 8"	FOOT	97	97		
* 78100100	RAISED REFLECTIVE PAVEMENT MARKER	EACH	63	63		
78300200	RAISED REFLECTIVE PAVEMENT MARKER REMOVAL	EACH	32	32		
78300202	PAVEMENT MARKING REMOVAL - WATER BLASTING	SQ FT	5708	5708		
X1500005	BITUMINOUS SURFACE TREATMENT, A2	SQ YD	33885	16280	1374	16231
X4060107	BITUMINOUS MATERIALS (FOG SEAL)	POUND	1696	814	69	813
X7810400	TEMPORARY RAISED PAVEMENT MARKER	EACH	230	230		

* SPECIALTY ITEM

	USER NAME = priyusha.ujhoda	DESIGNED -	REVISED -	STATE OF ILLINOIS DEPARTMENT OF TRANSPORTATION	SUMMARY OF QUANTITY			F.A. RTE.	SECTION	COUNTY	TOTAL SHEETS	SHEET NO.
		DRAWN -	REVISED -					VAR	DIST 8 SEAL COAT 2026-1	MONROE, ST CLAIR	8	3
		CHECKED -	REVISED -					CONTRACT NO. 76U71				
	PLOT DATE = 12/12/2025	DATE -	REVISED -		SCALE:	SHEET 1	OF 1 SHEETS	STA.	TO STA.	ILLINOIS FED. AID PROJECT		

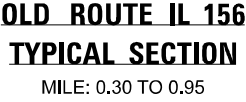
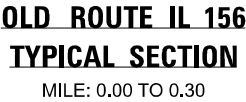

- 1 EXISTING AGGREGATE (PRIME COAT), 0.75"
- 2 EXISTING BITUMINOUS MATERIALS (PRIME COAT), 0.75"
- 3 EXISTING BITUMINOUS MATERIALS (PRIME COAT), 1.50"
- 4 EXISTING BITUMINOUS CONCRETE BINDER COURSE, 1.50"
- 5 EXISTING BITUMINOUS CONCRETE BINDER COURSE, 2.00"
- 6 EXISTING BITUMINOUS CONCRETE SURFACE COURSE, 1.00"
- 7 EXISTING BITUMINOUS CONCRETE SURFACE COURSE, 1.50"

- | | |
|----|--|
| 8 | EXISTING BITUMINOUS SURFACE, 3.00" |
| 9 | EXISTING BITUMINOUS SURFACE TREATMENT, SUBCLASS A-3 |
| 10 | EXISTING BITUMINOUS CONCRETE BINDER COURSE WIDENING, 6.00" |
| 11 | EXISTING AGGREGATE SHOULDER |
| 12 | EXISTING BITUMINOUS SHOULDER |
| 13 | EXISTING SUB-BASE GRANULAR MATERIAL, TYPE A, 3.00" |
| 14 | EXISTING SUB-BASE GRANULAR MATERIAL, TYPE A, 5.00" |

- | | |
|----|---|
| 15 | EXISTING GRAVEL OR CRUSHED STONE BASE COURSE, TYPE A, 6.00" |
| 16 | EXISTING GRAVEL OR CRUSHED STONE BASE COURSE, TYPE A, 8.00" |
| 17 | EXISTING P.C.C PAVEMENT, 8.00" |
| 18 | EXISTING P.C.C WIDENING, 8.00" |
| 19 | EXISTING GRAVEL OR CRUSHED STONE SURFACE COURSE, 1.50" |
| 20 | PROPOSED A-2 BITUMINOUS SURFACE TREATMENT |
| 21 | PROPOSED FOG SEAL TREATMENT |

USER NAME = priyusha.ujoodha	DESIGNED -	REVISED -
	DRAWN -	REVISED -
	CHECKED -	REVISED -
PLOT DATE = 12/11/2025	DATE -	REVISED -

STATE OF ILLINOIS
DEPARTMENT OF TRANSPORTATION

TYPICAL SECTIONS

SCALE:	SHEET 1	OF 3	SHEETS	STA.	TO STA.
--------	---------	------	--------	------	---------

F.A. RTE.	SECTION	COUNTY	TOTAL SHEETS	SHEET NO.
VAR	DIST 8 SEAL COAT 2026-1	MONROE, ST CLAIR	8	4
		CONTRACT NO. 76U71		
ILLINOIS		FED. AID PROJECT		

MODEL: Typical Section 1 [Sheet]
FILE NAME: c:\pw_work\pwidot\priyusha.ujhooda@illinois.gov\d1154445\ID876U71-sh1-typical.dgn



MILE: 0.00 TO 0.13



TYPICAL SECTION

LEGEND

- | | | | | | |
|---|--|----|--|----|---|
| 1 | EXISTING AGGREGATE (PRIME COAT), 0.75" | 8 | EXISTING BITUMINOUS SURFACE, 3.00" | 15 | EXISTING GRAVEL OR CRUSHED STONE BASE COURSE, TYPE A, 6.00" |
| 2 | EXISTING BITUMINOUS MATERIALS (PRIME COAT), 0.75" | 9 | EXISTING BITUMINOUS SURFACE TREATMENT, SUBCLASS A-3 | 16 | EXISTING GRAVEL OR CRUSHED STONE BASE COURSE, TYPE A, 8.00" |
| 3 | EXISTING BITUMINOUS MATERIALS (PRIME COAT), 1.50" | 10 | EXISTING BITUMINOUS CONCRETE BINDER COURSE WIDENING, 6.00" | 17 | EXISTING P.C.C PAVEMENT, 8.00" |
| 4 | EXISTING BITUMINOUS CONCRETE BINDER COURSE, 1.50" | 11 | EXISTING AGGREGATE SHOULDER | 18 | EXISTING P.C.C WIDENING, 8.00" |
| 5 | EXISTING BITUMINOUS CONCRETE BINDER COURSE, 2.00" | 12 | EXISTING BITUMINOUS SHOULDER | 19 | EXISTING GRAVEL OR CRUSHED STONE SURFACE COURSE, 1.50" |
| 6 | EXISTING BITUMINOUS CONCRETE SURFACE COURSE, 1.00" | 13 | EXISTING SUB-BASE GRANULAR MATERIAL, TYPE A, 3.00" | 20 | PROPOSED A-2 BITUMINOUS SURFACE TREATMENT |
| 7 | EXISTING BITUMINOUS CONCRETE SURFACE COURSE, 1.50" | 14 | EXISTING SUB-BASE GRANULAR MATERIAL, TYPE A, 5.00" | 21 | PROPOSED FOG SEAL TREATMENT |

	USER NAME = priyusha.ufoodha	DESIGNED -	REVISED -	STATE OF ILLINOIS DEPARTMENT OF TRANSPORTATION	TYPICAL SECTIONS				F.A. RTE.	SECTION	COUNTY	TOTAL SHEETS	SHEET NO.
		DRAWN -	REVISED -						VAR	DIST 8 SEAL COAT 2026-1	MONROE, ST CLAIR	8	5
		CHECKED -	REVISED -						CONTRACT NO. 76U71				
	PLOT DATE = 12/9/2025	DATE -	REVISED -		SCALE:	SHEET 2	OF 3 SHEETS	STA.	TO STA.	ILLINOIS FED. AID PROJECT			

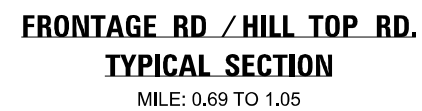
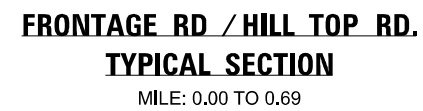

1	EXISTING AGGREGATE (PRIME COAT), 0.75"	8	EXISTING BITUMINOUS SURFACE, 3.00"	15	EXISTING GRAVEL OR CRUSHED STONE BASE COURSE, TYPE A, 6.00"
2	EXISTING BITUMINOUS MATERIALS (PRIME COAT), 0.75"	9	EXISTING BITUMINOUS SURFACE TREATMENT, SUBCLASS A-3	16	EXISTING GRAVEL OR CRUSHED STONE BASE COURSE, TYPE A, 8.00"
3	EXISTING BITUMINOUS MATERIALS (PRIME COAT), 1.50"	10	EXISTING BITUMINOUS CONCRETE BINDER COURSE WIDENING, 6.00"	17	EXISTING P.C.C PAVEMENT, 8.00"
4	EXISTING BITUMINOUS CONCRETE BINDER COURSE, 1.50"	11	EXISTING AGGREGATE SHOULDER	18	EXISTING P.C.C WIDENING, 8.00"
5	EXISTING BITUMINOUS CONCRETE BINDER COURSE, 2.00"	12	EXISTING BITUMINOUS SHOULDER	19	EXISTING GRAVEL OR CRUSHED STONE SURFACE COURSE, 1.50"
6	EXISTING BITUMINOUS CONCRETE SURFACE COURSE, 1.00"	13	EXISTING SUB-BASE GRANULAR MATERIAL, TYPE A, 3.00"	20	PROPOSED A-2 BITUMINOUS SURFACE TREATMENT
7	EXISTING BITUMINOUS CONCRETE SURFACE COURSE, 1.50"	14	EXISTING SUB-BASE GRANULAR MATERIAL, TYPE A, 5.00"	21	PROPOSED FOG SEAL TREATMENT

FILE NAME:	USER NAME = priyusha.ujoodha	DESIGNED -	REVISED -	STATE OF ILLINOIS DEPARTMENT OF TRANSPORTATION	TYPICAL SECTIONS								F.A. RTE.	SECTION		COUNTY	TOTAL SHEETS	SHEET NO.
		DRAWN -	REVISED -										VAR.	DIST 8 SEAL COAT 2026-1		MONROE, ST CLAIR	8	6
		CHECKED -	REVISED -										CONTRACT NO. 76U71					
	PLOT DATE = 12/11/2025	DATE -	REVISED -		SCALE: SHEET 3 OF 3 SHEETS STA. TO STA.								ILLINOIS FED. AID PROJECT					

MODEL: Typical Section 3 [Sheet]
FILE NAME: c:\pw_work\pwidot\priyusha.ujhoda@illinois.gov\d1154445\D876U71-sht-typical.dgn

MODEL: Schedule of Quantity [Sheet]
FILE NAME: c:\pawork\pawork\priyusha.ujooda@illinois.gov\154445\0876\071-sh-schedule.dgn

RESURFACING SCHEDULE							
MILE POINT	TO	MILE POINT	LENGTH	WIDTH	AREA	BITUMINOUS MATERIALS SURFACE TREATMENT	BITUMINOUS MATERIALS FOG SEAL
MILES		MILES	FT	FT	SQ FT	SQ YD	LBS
OLD ROUTE IL 156							
0.00	TO	0.30	1584	34	53856	5984	299
0.30	TO	0.95	3432	27	92664	10296	515
DOYLE RD							
0.00	TO	0.13	687	18	12366	1374	69
HILL CASTLE LANE							
0.00	TO	0.07	370	24	8880	987	50
HILL TOP RD							
0.00	TO	0.69	3644	22	80168	8908	446
0.69	TO	1.05	1901	30	57030	6337	317
TOTAL				155	304964	33885	1696

PAVEMENT MARKINGS SCHEDULE															
MILE POINT	TO	MILE POINT	LENGTH	PAINT PAVEMENT MARKER			TEMPORARY PAINT PAVEMENT MARKER			PAVEMENT MARKING REMOVAL - WATER BLASTING	TEMPORARY RAISED PAVEMENT MARKER	RAISED REFLECTIVE PAVEMENT MARKER	RAISED REFLECTIVE PAVEMENT MARKER REMOVAL	SHORT TERM PAVEMENT MARKING	SHORT TERM PAVEMENT MARKING REMOVAL
				6 INCH SOLID LINE - WHITE	6 INCH SKIP DASH - YELLOW	8 INCH SOLID LINE- WHITE	6 INCH SOLID LINE - WHITE	6 INCH SKIP DASH - YELLOW	8 INCH SOLID LINE- WHITE						
MILES		MILES	FT	FT	FT	FT	FT	FT	FT	SQ FT	EACH	EACH	EACH	FT	SQ FT
OLD ROUTE IL 156															
0.00	TO	0.30	1584	3168	396	97	3168	396	97	1847	74	20	10	144	48
0.30		0.95	3432	6864	858		6864	858		3861	156	43	22	312	104
SUBTOTAL				10032	1254	97	10032	1254	97	5708	230	63	32	456	152
TOTAL				11286		97	11286		97	5708	230	63	32	456	152

	USER NAME = priyusha.ujooda	DESIGNED -	REVISED -	STATE OF ILLINOIS DEPARTMENT OF TRANSPORTATION	SCHEDULE OF QUANTITY			F.A. RTE.	SECTION	COUNTY	TOTAL SHEETS	SHEET NO.
		DRAWN -	REVISED -					VAR	DIST 8 SEAL COAT 2026-1	MONROE, ST CLAIR	8	7
		CHECKED -	REVISED -					CONTRACT NO. 76U71				
	PLOT DATE = 12/11/2025	DATE -	REVISED -		SCALE:	SHEET 1	OF 1 SHEETS	STA.	TO STA.	ILLINOIS FED. AID PROJECT		

MODEL: location_map [Sheet]
FILE NAME: c:\pwwork\work\priyusha.ujooda@illinois.gov\1154445\0876\U71-sht-location.dgn

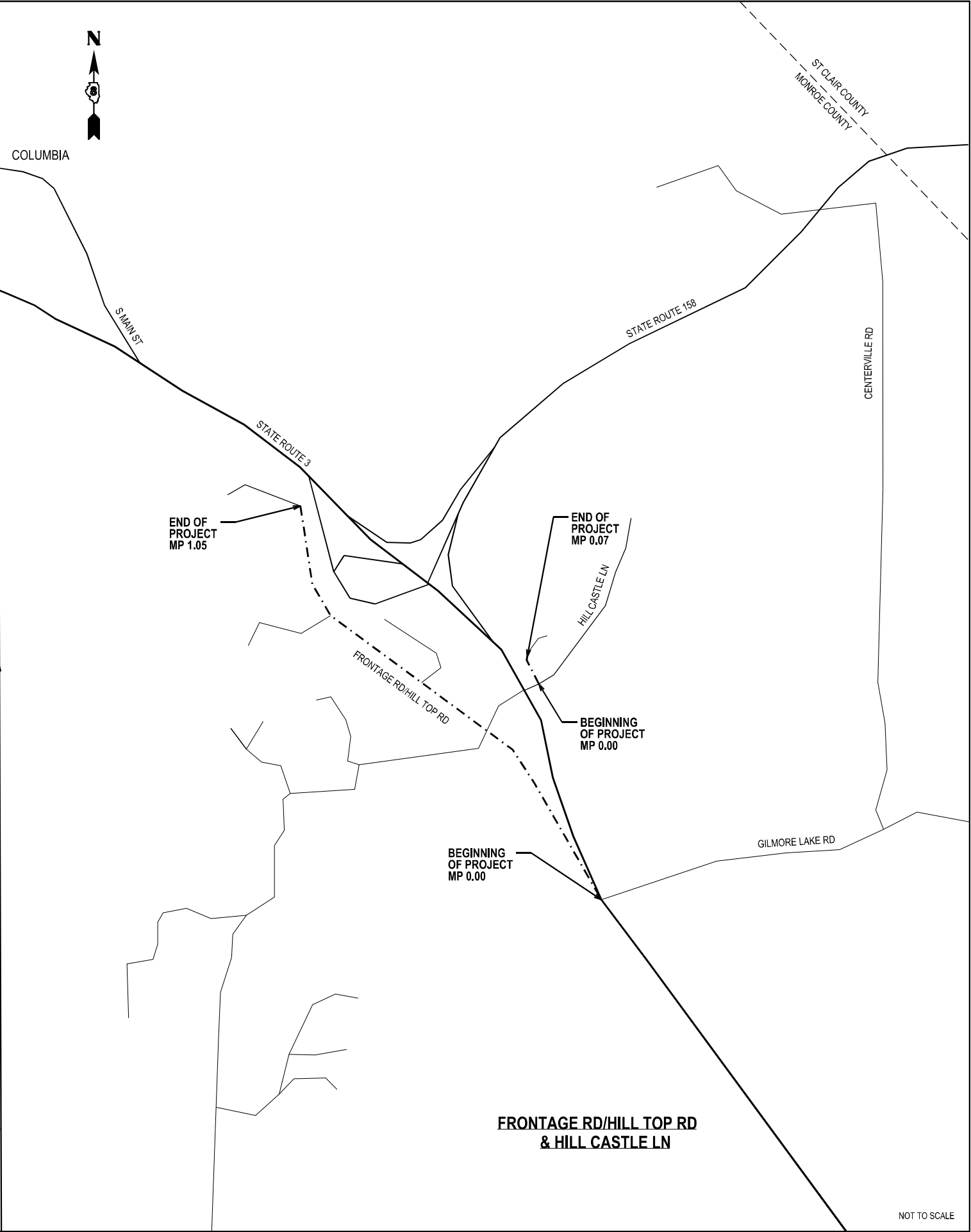
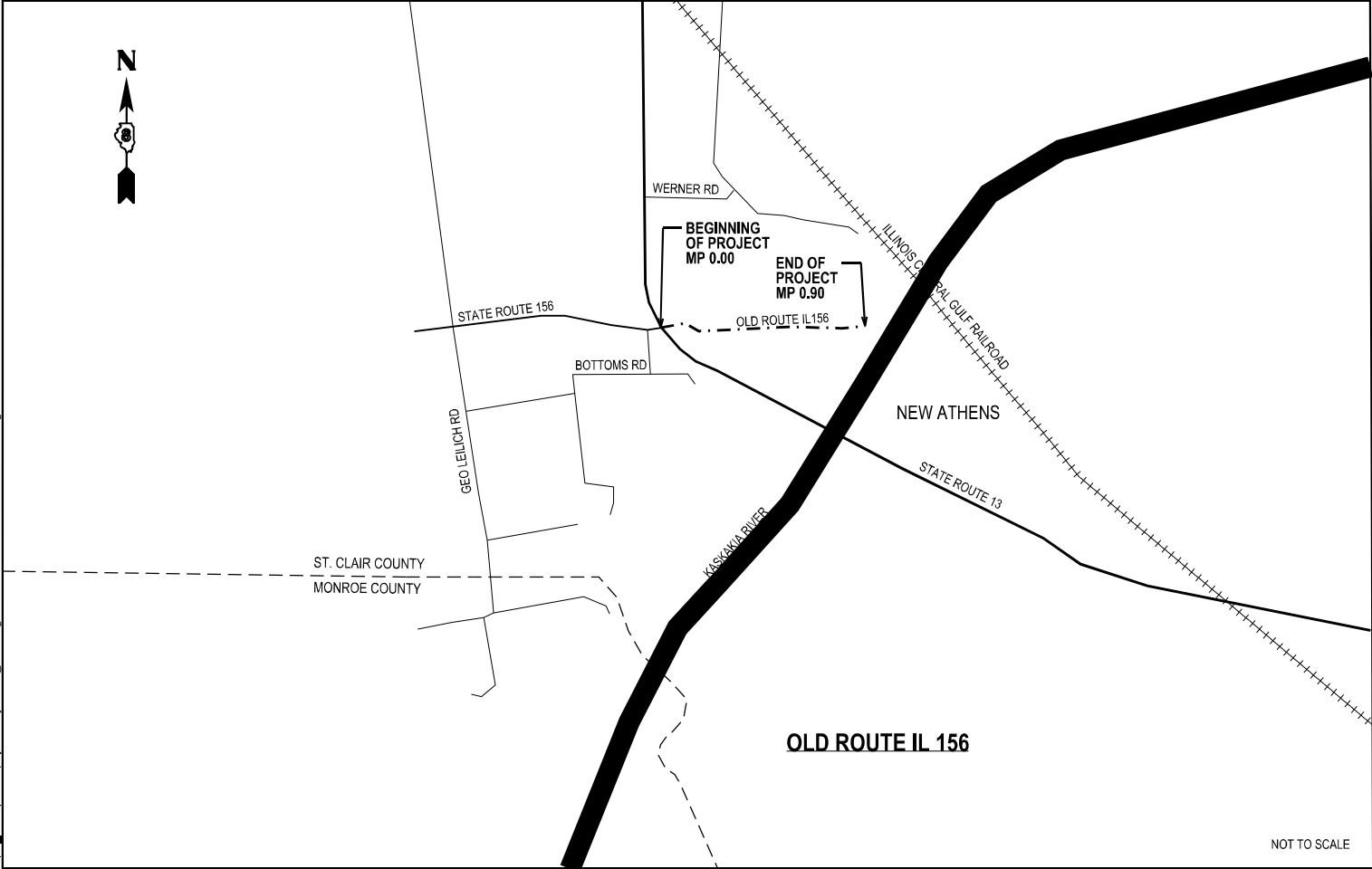
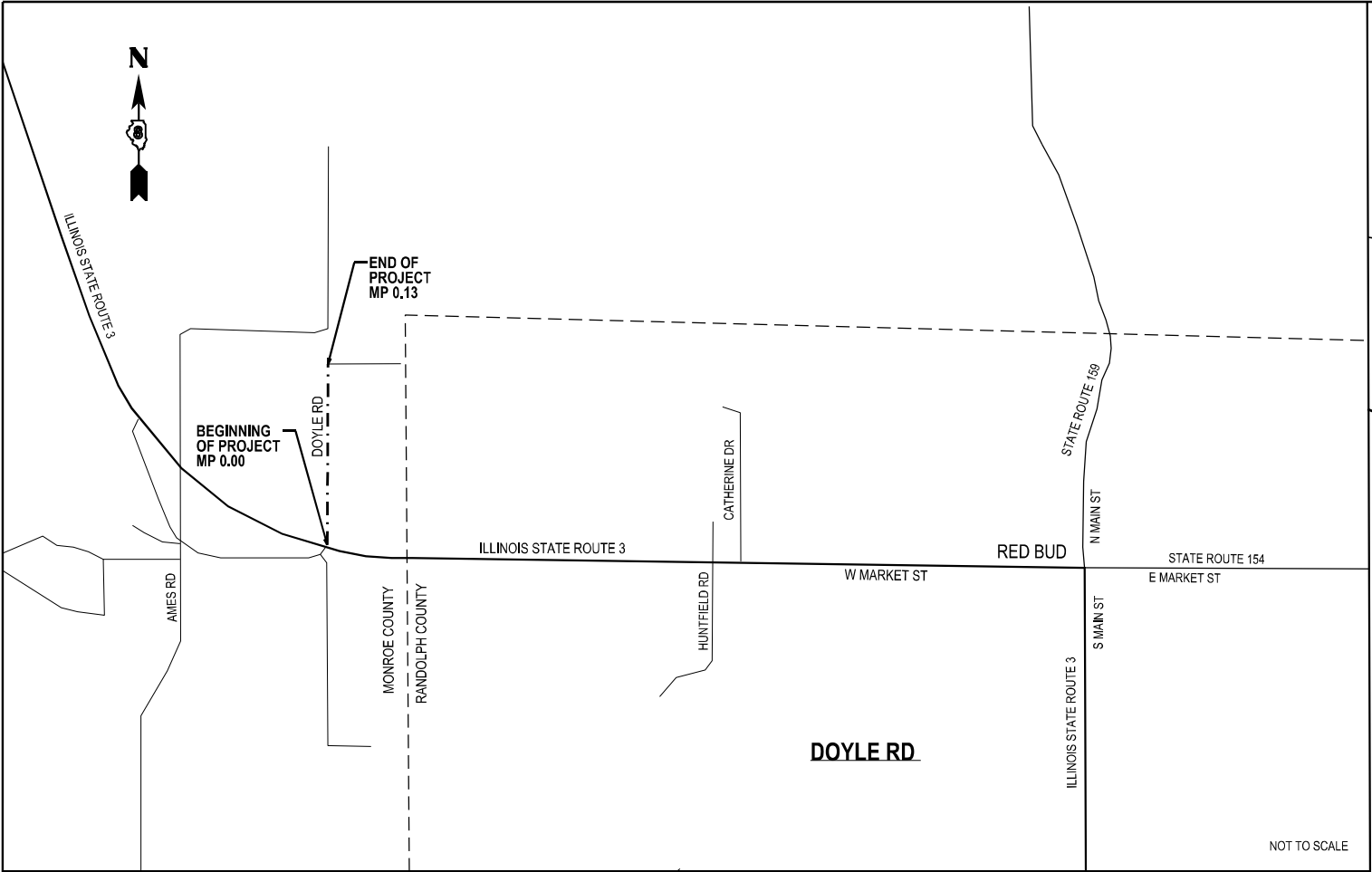

USER NAME = priyusha.ujooda	DESIGNED -	REVISED -
	DRAWN -	REVISED -
	CHECKED -	REVISED -
PLOT DATE = 12/11/2025	DATE -	REVISED -

STATE OF ILLINOIS
DEPARTMENT OF TRANSPORTATION

LOCATION MAPS

SCALE: SHEET 1 OF 1 SHEETS STA. TO STA.

F.A.P. RTE.	SECTION	COUNTY	TOTAL SHEETS	SHEET NO.
VAR	DIST 8 SEAL COAT 2026-1	MONROE, ST. CLAIR	8	8
CONTRACT NO. 76U71				
ILLINOIS FED. AID PROJECT				