

PLAN	SURVEYED	DATE
	PLOTTED	
	GRADES CHECKED	
	STRUCTURE NOTATIONS OK'D	
	NOTE BOOK NO.	
	CADD FILE NAME	

PROFILE	SURVEYED	DATE
	PLOTTED	
	GRADES CHECKED	
	STRUCTURE NOTATIONS OK'D	
	NOTE BOOK NO.	
	CADD FILE NAME	

FILE NAME = W:\191-130-IDD1_IL6A\CADD_Sheets\0608111-shr-drain2.dgn

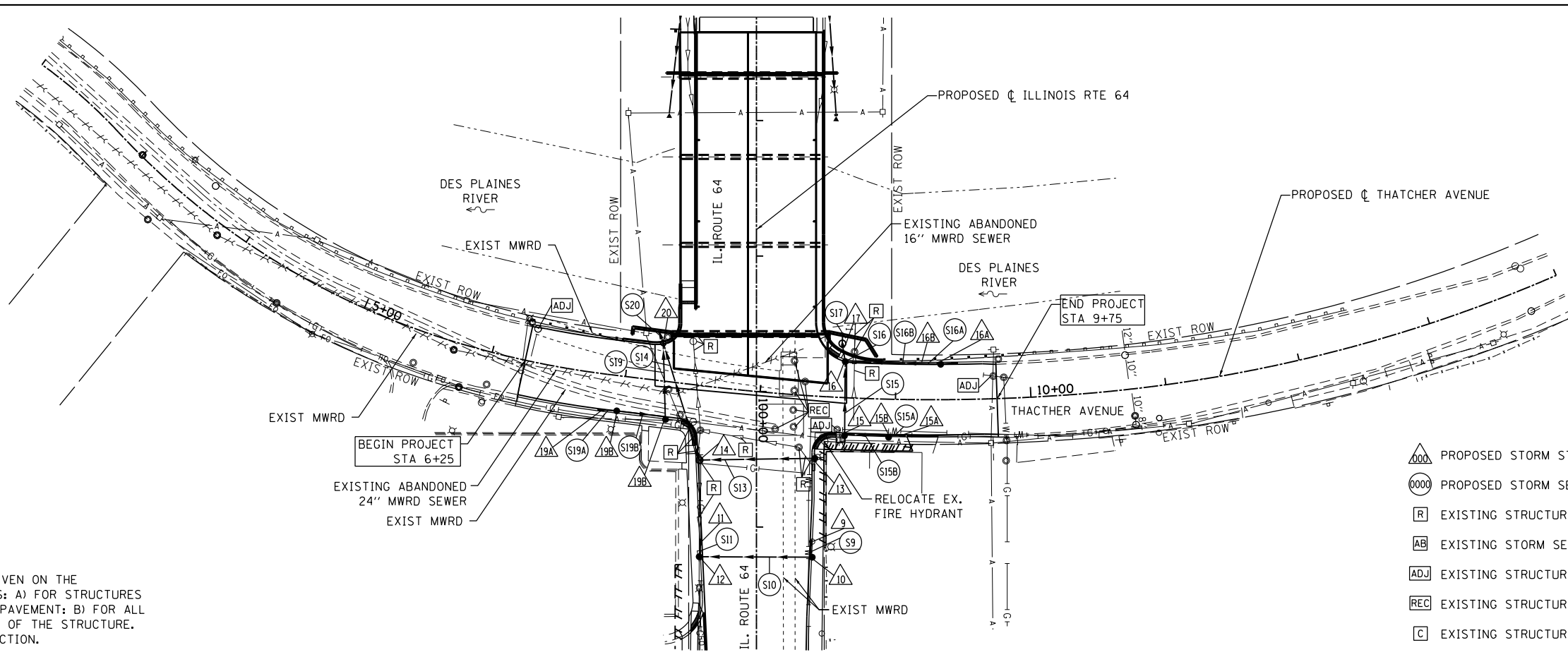

NOTE:
 STORM WATER STRUCTURE OFFSET LOCATIONS GIVEN ON THE DETAILED PLANS ARE TO THE FOLLOWING POINTS: A) FOR STRUCTURES FALLING IN THE CURB LINE - TO THE EDGE OF PAVEMENT; B) FOR ALL OTHER STRUCTURE LOCATIONS - TO THE CENTER OF THE STRUCTURE. C) FLARED END SECTION - FES AND PIPE CONNECTION.

- ▲ PROPOSED STORM STRUCTURE
- PROPOSED STORM SEWER
- R EXISTING STRUCTURE TO BE REMOVED
- AB EXISTING STORM SEWER TO BE ABANDONED
- ADJ EXISTING STRUCTURE TO BE ADJUSTED
- REC EXISTING STRUCTURE TO BE RECONSTRUCTED
- C EXISTING STRUCTURE TO BE CLEANED

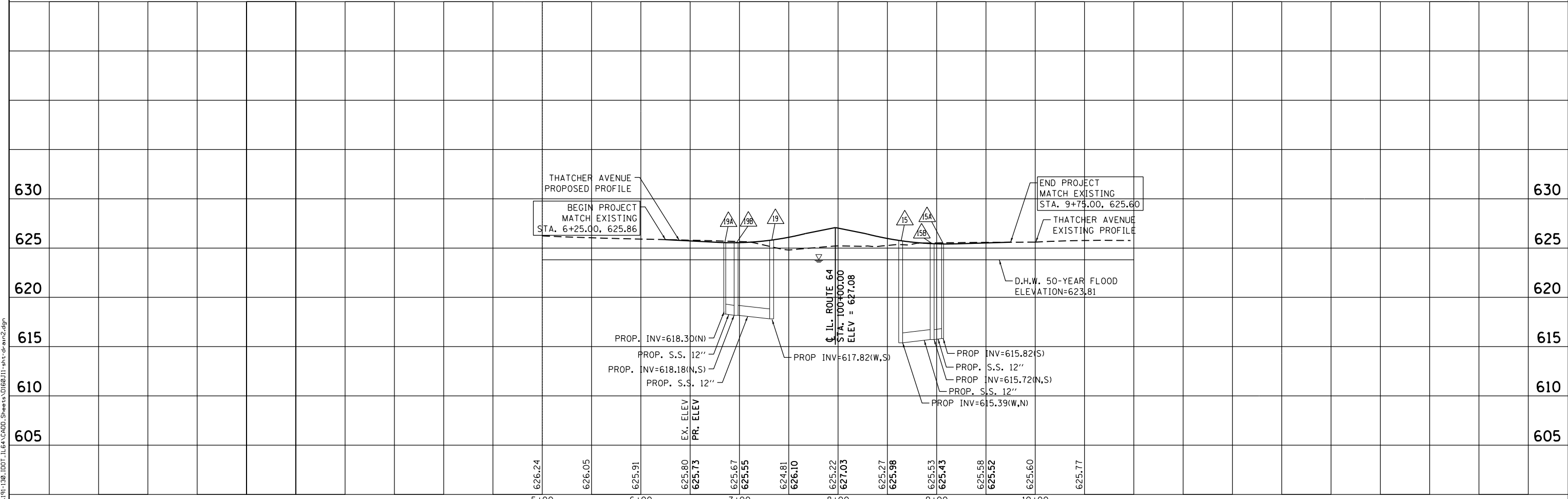

Bollinger, Lach & Associates, Inc.
 ITASCA, ILLINOIS

USER NAME = cesario	DESIGNED - MTC	REVISED -
	DRAWN - MTC	REVISED -
PLOT SCALE = 100.0000' / in.	CHECKED - JIP	REVISED -
PLOT DATE = 8/15/2013	DATE - 06/07/2013	REVISED -

**STATE OF ILLINOIS
 DEPARTMENT OF TRANSPORTATION**

**ILLINOIS ROUTE 64 (NORTH AVE) OVER THE DES PLAINES RIVER
 DRAINAGE PLAN AND UTILITIES**

HORIZ 1"=50'
 SCALE: VERT 1"=5' SHEET NO. 2 OF 3 SHEETS STA. TO STA.

F.A. RTE.	SECTION	COUNTY	TOTAL SHEETS	SHEET NO.
307	541Y-3-B	COOK	143	35
CONTRACT NO. 60J11				
ILLINOIS FED. AID PROJECT				