

THE FOLLOWING EXISTING TRAFFIC SIGNAL EQUIPMENT SHALL BE REMOVED BY THE CONTRACTOR AND SHALL REMAIN THE PROPERTY OF THE AGENCY LISTED BELOW. THE CONTRACTOR SHALL SAFELY STORE AND ARRANGE FOR PICK UP OF ALL EQUIPMENT TO BE RETURNED TO THE LISTED AGENCY AS PER THE TRAFFIC SIGNAL SPECIFICATIONS.

AGENCY: IDOT, VILLAGE OF RIVER FOREST, VILLAGE OF ELMWOOD PARK

- 2 EACH LIGHT DETECTOR
- 1 EACH LIGHT DETECTOR AMPLIFIER
- 1 EACH PHASING UNIT

THE FOLLOWING ITEMS SHALL BE REMOVED BY THE CONTRACTOR AND SHALL BE DISPOSED OF BY THE CONTRACTOR OUTSIDE THE RIGHT-OF-WAY AT THEIR EXPENSE. THE SALVAGE VALUE OF THE REMOVED EQUIPMENT SHALL BE REFLECTED IN THE CONTRACT BID PRICE.

- 1 EACH CONTROLLER AND CABINET (COMPLETE)
- 15 EACH TRAFFIC SIGNAL BACKPLATE
- 8 EACH SIGNAL HEAD, 1-FACE
- 4 EACH MAST ARM ASSEMBLY AND POLE
- 4 EACH TRAFFIC SIGNAL POST
- 1 EACH SERVICE INSTALLATION
- 7 EACH SIGNAL HEAD, 3-FACE
- 8 EACH SIGNAL HEAD, 5-FACE
- TO BE RE-USED FOR PERMANENT SIGNAL INSTALLATION

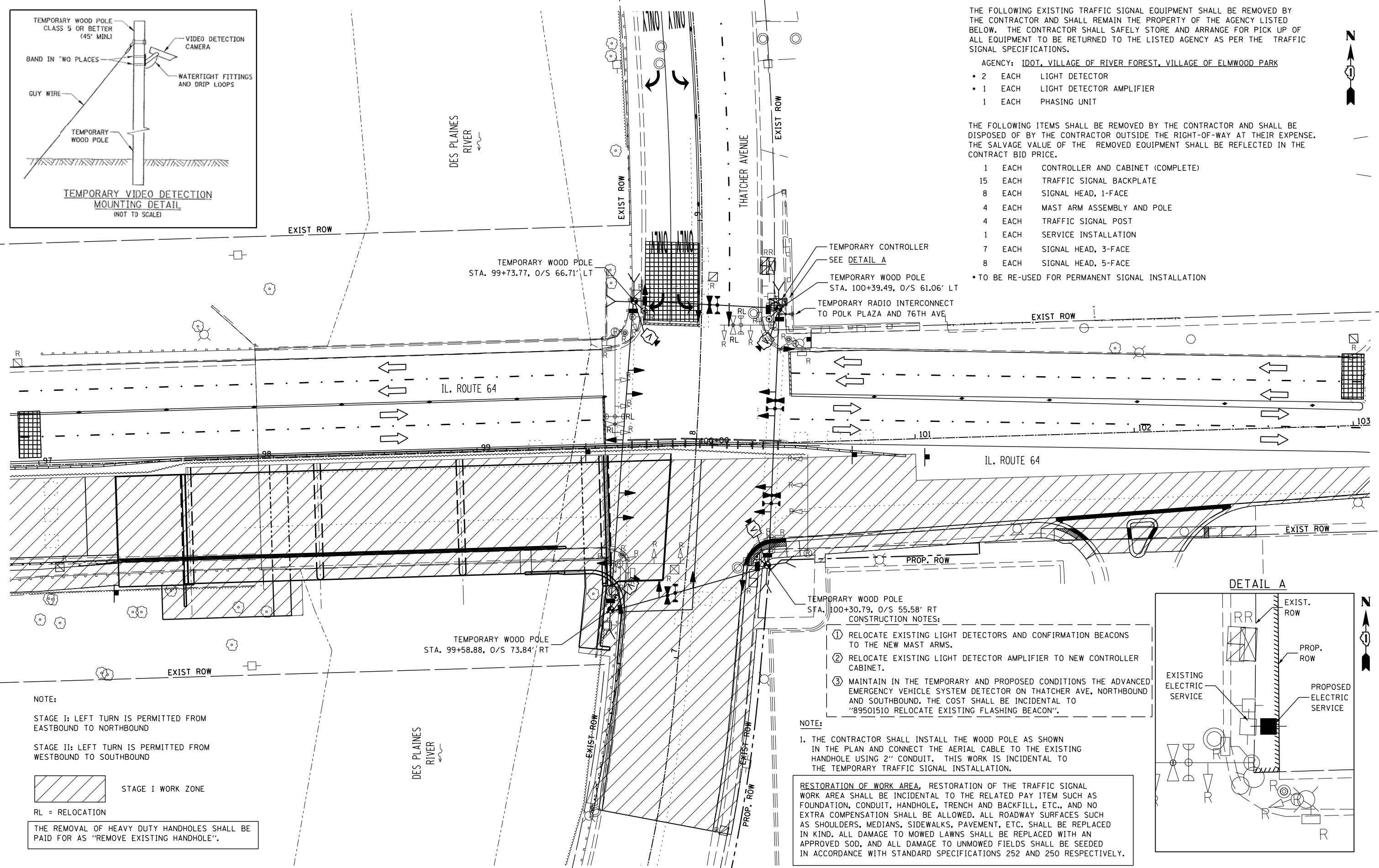

TEMPORARY CONTROLLER
SEE DETAIL A

TEMPORARY WOOD POLE
STA. 100+39.49, 0/S 61.06' LT

TEMPORARY RADIO INTERCONNECT
TO POLK PLAZA AND 76TH AVE

TEMPORARY WOOD POLE
STA. 100+30.79, 0/S 55.58' RT

CONSTRUCTION NOTES:

- ① RELOCATE EXISTING LIGHT DETECTORS AND CONFIRMATION BEACONS TO THE NEW MAST ARMS.
- ② RELOCATE EXISTING LIGHT DETECTOR AMPLIFIER TO NEW CONTROLLER CABINET.
- ③ MAINTAIN IN THE TEMPORARY AND PROPOSED CONDITIONS THE ADVANCED EMERGENCY VEHICLE SYSTEM DETECTOR ON THATCHER AVE, NORTHBOUND AND SOUTHBOUND. THE COST SHALL BE INCIDENTAL TO "89501510 RELOCATE EXISTING FLASHING BEACON".

NOTE:

1. THE CONTRACTOR SHALL INSTALL THE WOOD POLE AS SHOWN IN THE PLAN AND CONNECT THE AERIAL CABLE TO THE EXISTING HANDHOLE USING 2" CONDUIT. THIS WORK IS INCIDENTAL TO THE TEMPORARY TRAFFIC SIGNAL INSTALLATION.

RESTORATION OF WORK AREA, RESTORATION OF THE TRAFFIC SIGNAL WORK AREA SHALL BE INCIDENTAL TO THE RELATED PAY ITEM SUCH AS FOUNDATION, CONDUIT, HANDHOLE, TRENCH AND BACKFILL, ETC., AND NO EXTRA COMPENSATION SHALL BE ALLOWED. ALL ROADWAY SURFACES SUCH AS SHOULDERS, MEDIANS, SIDEWALKS, PAVEMENT, ETC. SHALL BE REPLACED IN KIND. ALL DAMAGE TO MOWED LAWNS SHALL BE REPLACED WITH AN APPROVED SOD, AND ALL DAMAGE TO UNMOWED FIELDS SHALL BE SEED IN ACCORDANCE WITH STANDARD SPECIFICATIONS 252 AND 250 RESPECTIVELY.

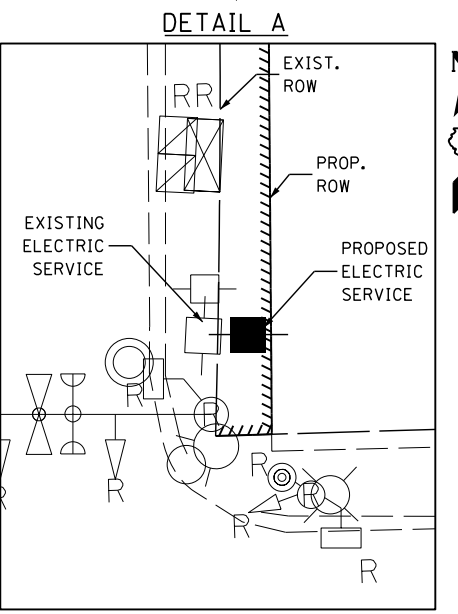

NOTE:

STAGE I: LEFT TURN IS PERMITTED FROM EASTBOUND TO NORTHBOUND

STAGE II: LEFT TURN IS PERMITTED FROM WESTBOUND TO SOUTHBOUND

STAGE I WORK ZONE

RL = RELOCATION

THE REMOVAL OF HEAVY DUTY HANDHOLES SHALL BE PAID FOR AS "REMOVE EXISTING HANDHOLE".

FILE NAME = \$FILES\$

Bollinger, Lach & Associates, Inc.
ITASCA, ILLINOIS

USER NAME = \$USER\$	DESIGNED - MTC	REVISED -
PLOT SCALE = \$SCALE\$	DRAWN - MTC	REVISED -
PLOT DATE = \$DATE\$	CHECKED - JIP	REVISED -
	DATE - 12/20/2013	REVISED -

STATE OF ILLINOIS
DEPARTMENT OF TRANSPORTATION

ILLINOIS ROUTE 64 (NORTH AVE) OVER THE DES PLAINES RIVER
TEMPORARY TRAFFIC SIGNAL INSTALLATION PLAN - STAGE 1 & 2

SCALE: 1"=20' SHEET NO. 8 OF 21 SHEETS STA. TO STA.

F.A.P. RTE.	SECTION	COUNTY	TOTAL SHEETS	SHEET NO.
307	541Y-3-B	COOK	143	48
CONTRACT NO. 60J11			ILLINOIS FED. AID PROJECT	