

PLAN  
 REVISIONS  
 NO. DATE  
 1  
 2  
 3  
 4  
 5  
 6  
 7  
 8  
 9  
 10  
 11  
 12  
 13  
 14  
 15  
 16  
 17  
 18  
 19  
 20  
 21  
 22  
 23  
 24  
 25  
 26  
 27  
 28  
 29  
 30  
 31  
 32  
 33  
 34  
 35  
 36  
 37  
 38  
 39  
 40  
 41  
 42  
 43  
 44  
 45  
 46  
 47  
 48  
 49  
 50  
 51  
 52  
 53  
 54  
 55  
 56  
 57  
 58  
 59  
 60  
 61  
 62  
 63  
 64  
 65  
 66  
 67  
 68  
 69  
 70  
 71  
 72  
 73  
 74  
 75  
 76  
 77  
 78  
 79  
 80  
 81  
 82  
 83  
 84  
 85  
 86  
 87  
 88  
 89  
 90  
 91  
 92  
 93  
 94  
 95  
 96  
 97  
 98  
 99  
 100

PROF. I.L.C.  
 DATE  
 05/10/2013

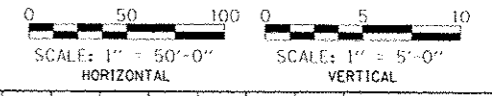
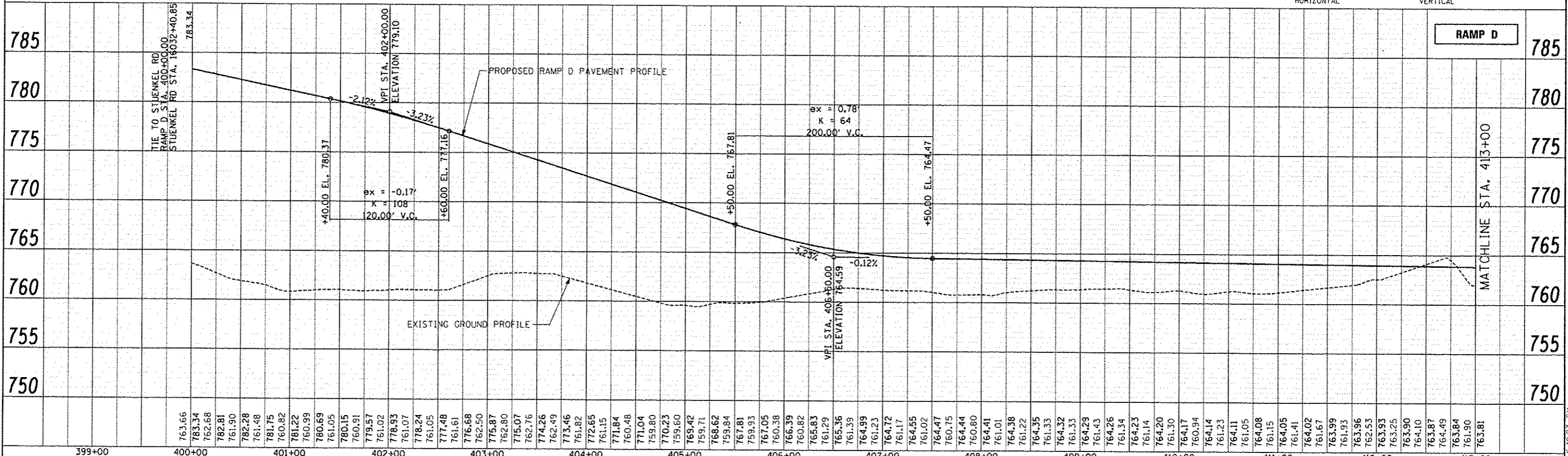
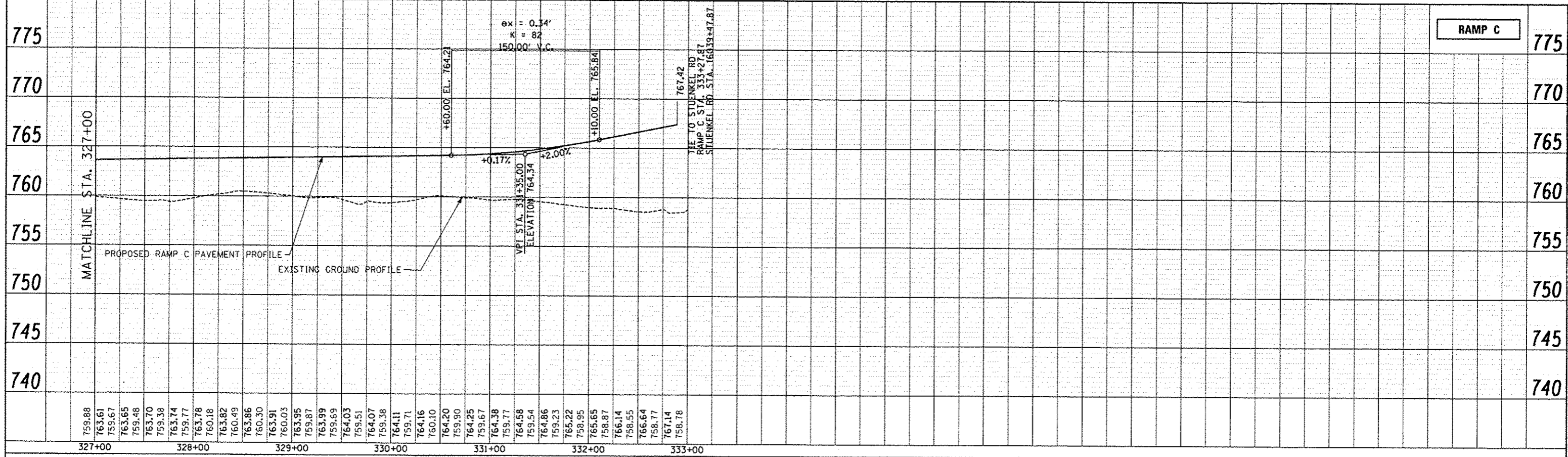

<b>TYLIN INTERNATIONAL</b> ENGINEER PROJECT SCALE PROJECT NUMBER	DESIGNED	JTP	REVISED		<b>STATE OF ILLINOIS</b> <b>DEPARTMENT OF TRANSPORTATION</b> <b>STUENKEL ROAD AT I-57 RIDGELAND AVENUE TO CENTRAL AVENUE</b> <b>RAMP C &amp; D PROPOSED PROFILE</b> SCALE: 1" = 50' SHEET 20 OF 23 SHEETS STA. 328+00(C) TO STA. 414+00(D)	F.A.I. RTE. 57 SECTION 99-1HB-RI COUNTY WILL TOTAL SHEETS 679 SHEET NO. 92 CONTRACT NO. 60L69
	DRAWN	JTP	REVISED			
	CHECKED	JPM	REVISED			
	DATE	05/10/2013	REVISED			